

BOSE[®]

 Lifestyle[®] SoundTouch[™] 135
entertainment system



Set Up Guide • คู่มือการติดตั้ง • 설치 안내서
安裝指南 • 安裝指南 • دليل الإعداد

Important Safety Instructions

Please read this guide

Please take the time to follow the instructions in this owner's guide carefully. It will help you set up and operate your system properly and enjoy its advanced features. Please save this guide for future reference.



The lightning flash with arrowhead symbol within an equilateral triangle alerts the user to the presence of uninsulated, dangerous voltage within the system enclosure that may be of sufficient magnitude to constitute a risk of electric shock.



The exclamation point within an equilateral triangle, as marked on the system, is intended to alert the user to the presence of important operating and maintenance instructions in this owner's guide.



WARNING: Contains small parts which may be a choking hazard. Not suitable for children under age 3.



WARNINGS:

- To reduce the risk of fire or electrical shock, do not expose the product to rain or moisture.
 - Do not expose this apparatus to dripping or splashing, and do not place objects filled with liquids, such as vases, on or near the apparatus. As with any electronic products, use care not to spill liquids into any part of the system. Liquids can cause a failure and/or a fire hazard.
 - To prevent electric shock, match the wide blade of the line cord plug to the wide slot of the AC (mains) receptacle. Insert fully.
 - Do not place any naked flame sources, such as lighted candles, on or near the apparatus.
-



CAUTIONS:

- Make no modifications to the system or accessories. Unauthorized alterations may compromise safety, regulatory compliance, and system performance.
 - Long-term exposure to loud music may cause hearing damage. It is best to avoid extreme volume when using headphones, especially for extended periods.
-

NOTES:

- The product label is located on the bottom or the back of the product.
- Where the mains plug or appliance coupler is used as the disconnect device, such disconnect device shall remain readily operable.
- The product must be used indoors. It is neither designed nor tested for use outdoors, in recreation vehicles, or on boats.
- This product is intended to be used only with the power supply provided.
- The speaker wire and interconnect cables included with the system are not approved for in-wall installation. Please check your local building codes for the correct type of wire and cable required for in-wall installation.
- Changes or modifications not expressly approved by Bose Corporation could void the user's authority to operate this equipment.

Important Safety Instructions

1. Read these instructions.
2. Keep these instructions.
3. Heed all warnings.
4. Follow all instructions.
5. Do not use this apparatus near water.
6. Clean only with a dry cloth.
7. Do not block any ventilation openings. Install in accordance with the manufacturer's instructions.
8. Do not install near any heat sources such as radiators, heat registers, stoves, or other apparatus (including amplifiers) that produce heat.

Important Safety Instructions

9. Do not defeat the safety purpose of the polarized or grounding-type plug. A polarized plug has two blades with one wider than the other. A grounding type plug has two blades and a third grounding prong. The wide blade or the third prong are provided for your safety. If the provided plug does not fit into your outlet, consult an electrician for replacement of the obsolete outlet.
10. Protect the power cord from being walked on or pinched particularly at plugs, convenience receptacles, and the point where they exit from the apparatus.
11. Only use attachments/accessories specified by the manufacturer.
12.  Use only with the cart, stand, tripod, bracket, or table specified by the manufacturer, or sold with the apparatus. When a cart is used, use caution when moving the cart/apparatus combination to avoid injury from tip-over.
13. Unplug this apparatus during lightning storms or when unused for long periods of time.
14. Refer all servicing to qualified personnel. Servicing is required when the apparatus has been damaged in a way, such as power-supply cord or plug is damaged, liquid has been spilled or objects have fallen into the apparatus, the apparatus has been exposed to rain or moisture, does not operate normally, or has been dropped.



廢電池請回收

Please dispose of used batteries properly, following local regulations. Do not incinerate.



This symbol means the product must not be discarded as household waste, and should be delivered to an appropriate collection facility for recycling. Proper disposal and recycling helps protect natural resources, human health and the environment. For more information on disposal and recycling of this product, contact your local municipality, disposal service, or the shop where you bought this product.



Bose Corporation hereby declares that this product is in compliance with the essential requirements and other relevant provisions of Directive 1999/5/EC and all other applicable EU directive requirements. The complete declaration of conformity can be found at: www.Bose.com/compliance

Names and Contents of Toxic or Hazardous Substances or Elements						
Part Name	Toxic or Hazardous Substances and Elements					
	Lead (Pb)	Mercury (Hg)	Cadmium (Cd)	Hexavalent (CR(VI))	Polybrominated Biphenyl (PBB)	Polybrominated diphenylether (PBDE)
PCBs	X	O	O	O	O	O
Metal parts	X	O	O	O	O	O
Plastic parts	O	O	O	O	O	O
Speakers	X	O	O	O	O	O
Cables	X	O	O	O	O	O
This table is prepared in accordance with the provisions of SJ/T 11364.						
O: Indicates that said hazardous substance contained in all of the homogeneous materials for this part is below the limit requirement of GB/T 26572.						
X: Indicates that said hazardous substance contained in at least one of the homogeneous materials used for this part is above the limit requirement of GB/T 26572.						

Important Safety Instructions

Please complete and retain for your records.

The serial and model numbers can be found on the bottom panel of the product.

Lifestyle® SoundTouch™ model: _____

Control console serial number: _____

Acoustimass® serial number: _____

Soundbar serial number: _____

Purchase date: _____

Please keep your receipt together with this Setup Guide and the Operating Guide.

Date of manufacture

The four bolded digits in the serial number indicate the date of manufacture. The first digit is the year of manufacture; "5" is 2005 or 2015. Digits 2-4 are the month and date; "001" is January 1 and "365" is December 31.

China Importer: Bose Electronics (Shanghai) Company Limited, Part C, Plan 9, No. 353 North Riyang Road, China (Shanghai) Pilot Free Trade Zone

EU Importer: Bose GP, Castleblayney Road, Carrickmacross, Ireland

Taiwan Importer: Bose Taiwan Branch, Room 905, 9F, Worldwide House, 131 Min Sheng East Rd, Section 3, Taipei, Taiwan, 105

App Store is a service mark of Apple Inc.

Amazon, Kindle and Fire are trademarks of Amazon.com, Inc. or its affiliates.

Android and Google Play are trademarks of Google Inc.

Blu-ray Disc™ and Blu-ray™ are trademarks of the Blu-ray Disc Association.

The *Bluetooth*® word mark and logos are registered trademarks owned by Bluetooth SIG, Inc. and any use of such marks by Bose Corporation is under license.

 **DOLBY TRUEHD** Manufactured under license from Dolby Laboratories. Dolby and the double-D symbol are trademarks of Dolby Laboratories.

 **dts**™ For DTS patents, see <http://patents.dts.com>. Manufactured under license from Digital Theater Systems, INC. DTS, the Symbol, & DTS and the Symbol together are registered trademarks, and DTS Digital Surround is a trademark of DTS, Inc. ©DTS, Inc. All Rights Reserved.

 **HDMI**™ The terms HDMI and HDMI High-Definition Multimedia Interface, and the HDMI Logo are trademarks or registered trademarks of HDMI Licensing LLC in the United States and other countries.



iHeartRadio is a registered trademark of iHeartMedia, Inc.

This product incorporates Spotify software which is subject to 3rd party licenses found here: www.spotify.com/connect/third-party-licenses.

Spotify is a registered trademark of Spotify AB.

SoundTouch and the wireless note design are trademarks of Bose Corporation in the U.S. and other countries.

Wi-Fi is a registered trademark of Wi-Fi Alliance®

© 2015 Bose Corporation. No part of this work may be reproduced, modified, distributed, or otherwise used without prior written permission.

Introduction

About your Lifestyle® SoundTouch™ system	6
SoundTouch™	6
About your SoundTouch™ wireless adapter	6

Unpacking the System

Carton contents	7
Accessories boxes	7
Cables and power cords box	7
Essentials box	8
Control console box	8

Setting Up the Soundbar

Connecting the soundbar	9
Attaching the optional extension feet to the Soundbar	12

Setting Up the Control Console

Connecting the control console.....	13
-------------------------------------	----

Setting Up the Acoustimass® Module

Connecting the Acoustimass module	16
---	----

Starting up the System

Installing the remote control's batteries	18
Powering on the system	19
Completing setup with UNIFY®	20

Care and Maintenance

Troubleshooting	21
Contacting customer service	21

Appendix: Using UNIFY® to connect SoundTouch™

Adding the system to your Wi-Fi® network	22
To add the system to an existing SoundTouch™ account	22
Download and install the SoundTouch™ app	22

Introduction

About your Lifestyle® SoundTouch™ system

The Lifestyle® SoundTouch™ system is elegant and easy-to-use, delivering superior performance for both music and video. This guide provides step-by-step instructions for setting up your new system.

Your new home entertainment system includes a soundbar, control console, Acoustimass® module, SoundTouch™ wireless adapter and a universal remote control.

SoundTouch™

With SoundTouch™, you can stream Internet radio, music services and your music library. If you have Wi-Fi® at home, you're ready to enjoy your favorite music in any room you want. Refer to the operating guide for SoundTouch™ features.

About your SoundTouch™ wireless adapter

The SoundTouch™ wireless adapter in the Essentials box enables SoundTouch™ and *Bluetooth*® technology on your entertainment system. Setting up your wireless adapter is part of the UNIFY® setup process. Do not connect your wireless adapter until prompted by UNIFY®. See page 20.

For system and SoundTouch™ features, refer to the operating guide.

Carton contents

Carefully unpack the carton and confirm that the following parts are included. Save the carton and packaging materials for transporting or storing the system.

Note: If part of the system is damaged, do not use it. Contact your authorized Bose® dealer or Bose customer service. Refer to the contact sheet in the carton.

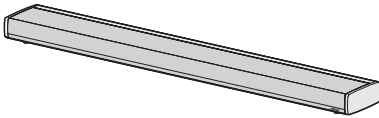

Soundbar

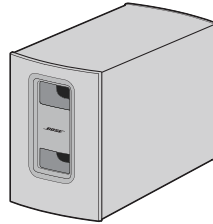

Acoustimass® module

Accessories boxes

Each box is identified by an icon on the box. These icons appear in the system setup steps to indicate where parts are located.

Cables and power cords box

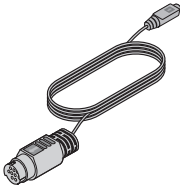
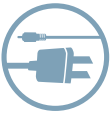

Audio input cable

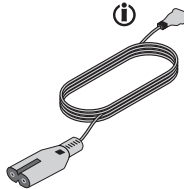

AC power cord



AM antenna

i Use the appropriate power cord for your region.

Unpacking the System

Essentials box

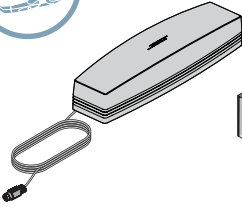

SoundTouch™ series II wireless adapter



ADAPTiQ® audio calibration headset



Operating guide



FM antenna

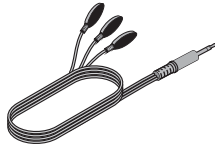

IR emitter cable

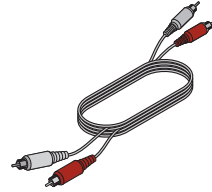

Stereo audio cable

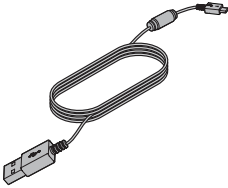

USB cable



USB drive (for system updating only)



Acoustimass module feet and Soundbar feet

Control console box

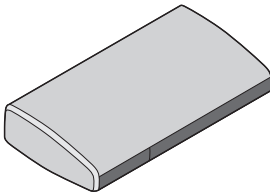

Control console

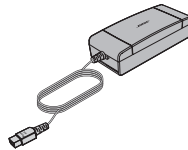

Power supply

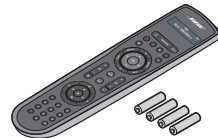

Remote control and Batteries

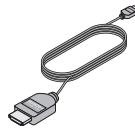

HIGH SPEED HDMI™ cable

Connecting the soundbar

The Lifestyle® SoundTouch™ entertainment system uses the reflective surfaces of your room to deliver wide, spacious sound. For best sound quality, the soundbar should not be placed inside a cabinet, or diagonally in a corner.

To avoid wireless interference, keep other wireless equipment away from the system. Place the system outside of and away from metal cabinets, away from other audio/video components and away from direct heat sources.

Note: Remove all protective films. These may affect acoustic performance if left in place.

What you need:

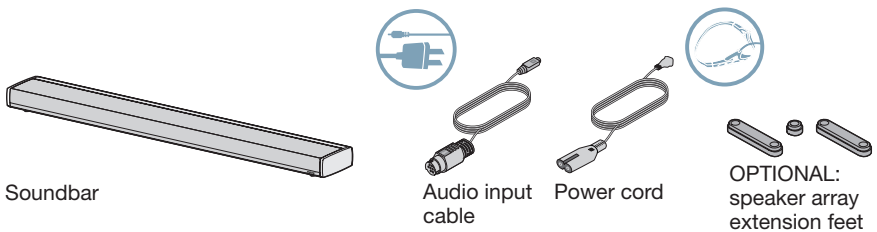

1. Lay the soundbar grille-side down on the table in front of your TV.

Tip: Lay the soundbar on a soft surface to protect it from being damaged.

2. Insert the audio input cable into the **Audio In** connector on the soundbar with the flat surface and arrow on the plug facing up.

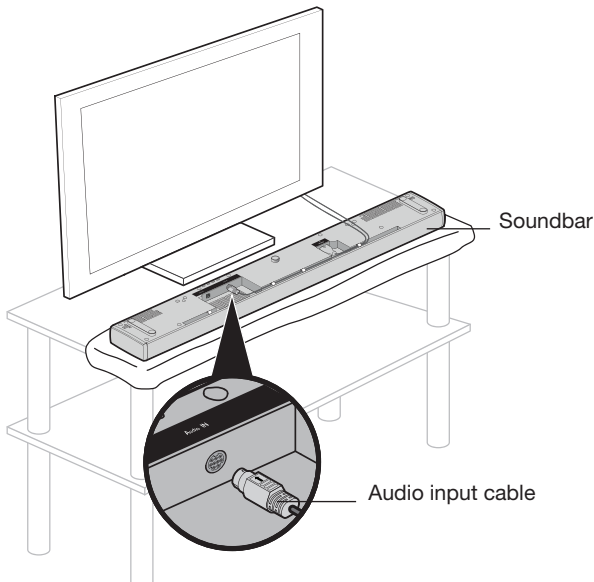

Setting Up the Soundbar

3. Insert the small end of the power cord into the **Power** connector.

Note: Do not plug the power cord into an AC power outlet until instructed to do so.

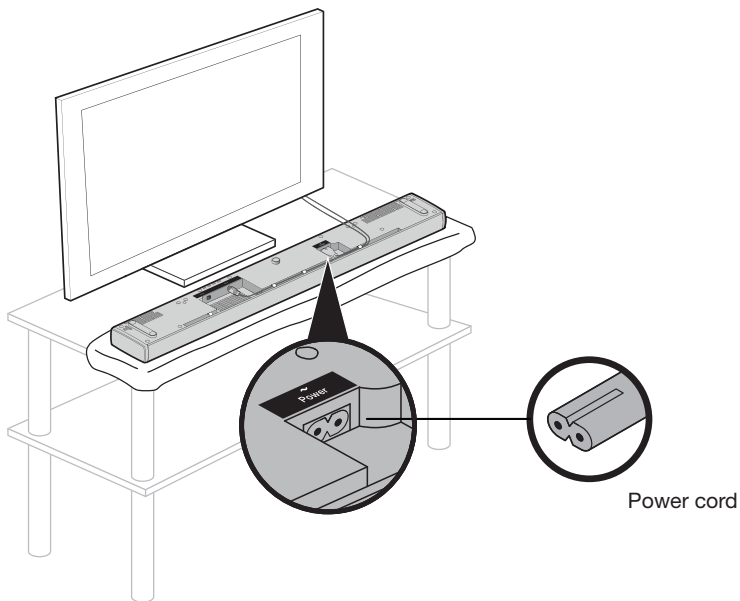

4. Arrange the cables as needed for your setup location.

OPTIONAL: Secure cables under the clips in the channel running along the length of the soundbar and attach the extension feet (page 12).

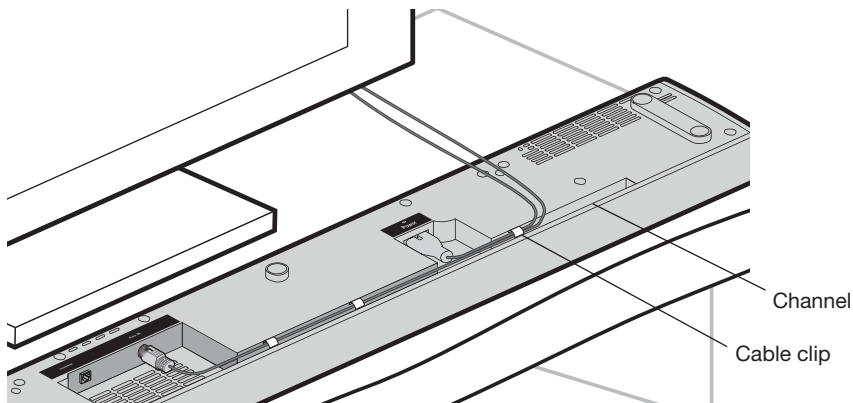

Setting Up the Soundbar

5. Turn the soundbar over and place it in front of your TV with the speaker grille facing into the room.

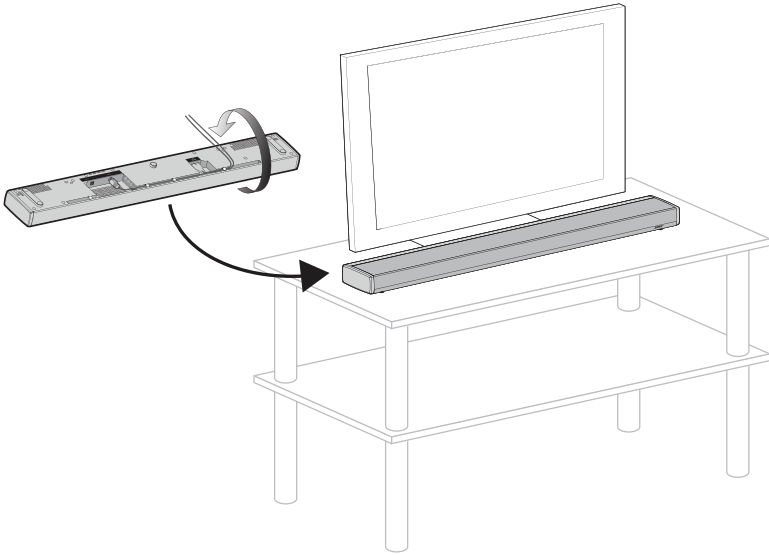

Setting Up the Soundbar

Attaching the extension feet to the Soundbar (optional)

Attach the optional extension feet to raise the soundbar.

1. Turn the soundbar upside down onto a soft surface to protect it from being damaged.
2. Attach the extension feet to the bottom of the soundbar.

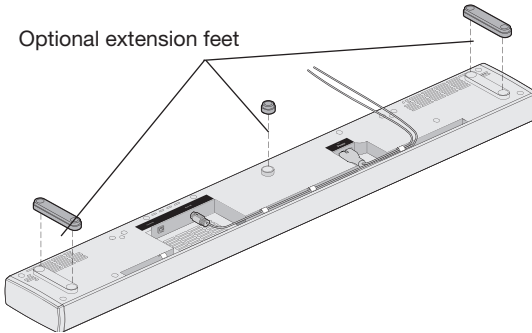

3. Place the soundbar on its feet.

Wall mounting the soundbar

You can mount the soundbar on a wall. To purchase the WB-135 Wall Mount Kit, contact your local Bose dealer or visit www.Bose.com

CAUTION: Do not use any other hardware to mount the soundbar.

Setting Up the Control Console

Connecting the control console

What you need:

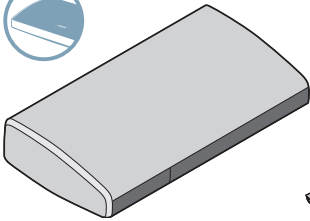

Control console

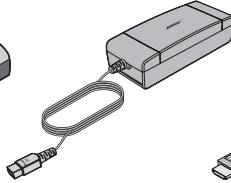

Power supply



HIGH-SPEED
HDMI™ cable



Power cord

1. Place the control console on a flat, stable surface near your TV.

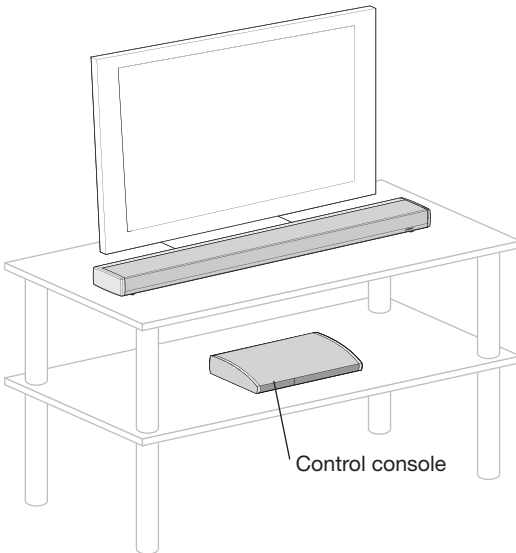

Control console

Note: Until your system is completely installed, keep the control console positioned for easy access to the rear connector panel.

Setting Up the Control Console

4. Insert the soundbar's audio input cable into the **Audio OUT** connector on the control console with the flat surface and arrow on the plug facing up.

Note: Do not connect the audio input cable to a Bose link connector.

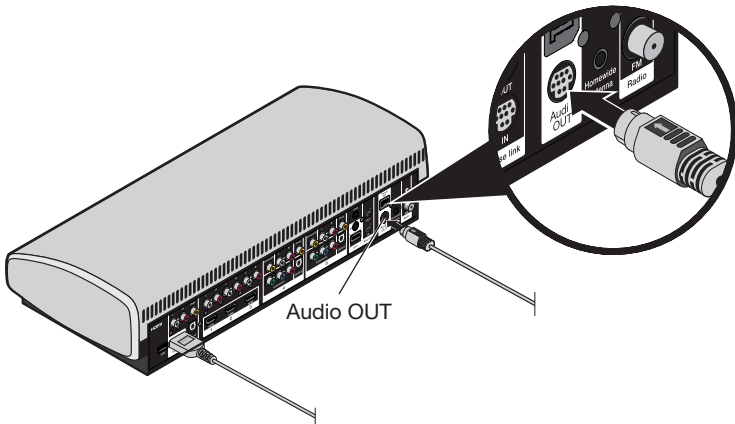

5. Insert the power supply output cord into the **Power** connector.

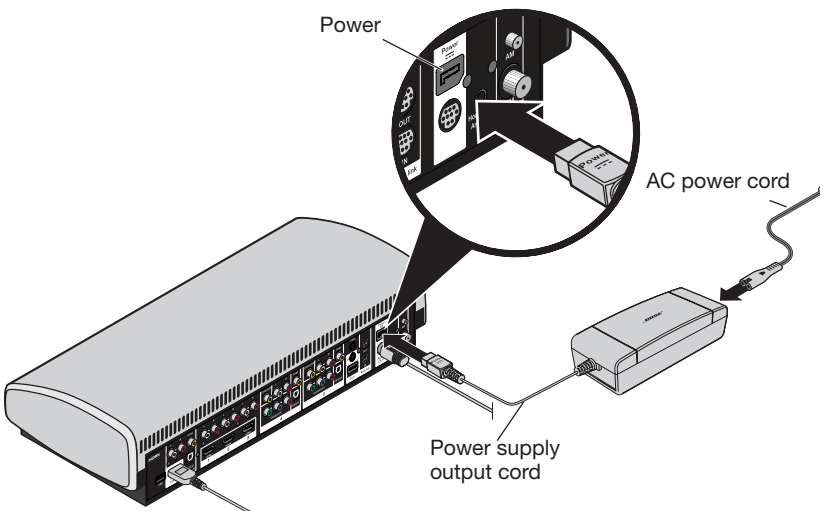

6. Insert a power cord into the power supply.
7. Plug the power cords from the soundbar and the control console into an AC (mains) power outlet.

Setting Up the Acoustimass® Module

Connecting the Acoustimass® module

What you need:

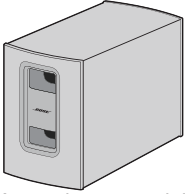

Acoustimass module



Rubber feet



Power cord

CAUTION: Choose a stable and level surface for the Acoustimass module. Vibration can cause the module to move, particularly on smooth surfaces like marble, glass or highly polished wood.

1. Attach the rubber feet to the bottom of the acoustimass module.

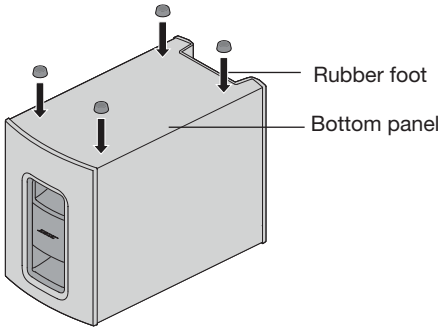

2. Insert the small end of the power cord into the **Power** connector.

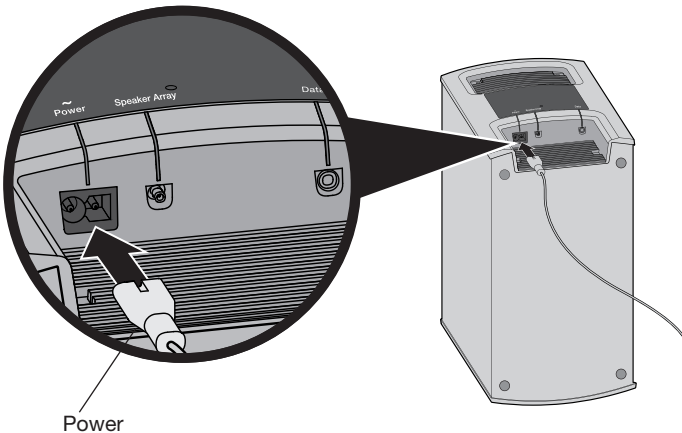

Setting Up the Acoustimass® Module

3. Place the Acoustimass® module according to the following guidelines:
- For best sound quality, stand the Acoustimass module on its feet along the same wall as your TV, or along any other wall in the front third of the room.
 - The front opening of the module can face any direction.
 - Make sure there is an AC (mains) power outlet nearby.

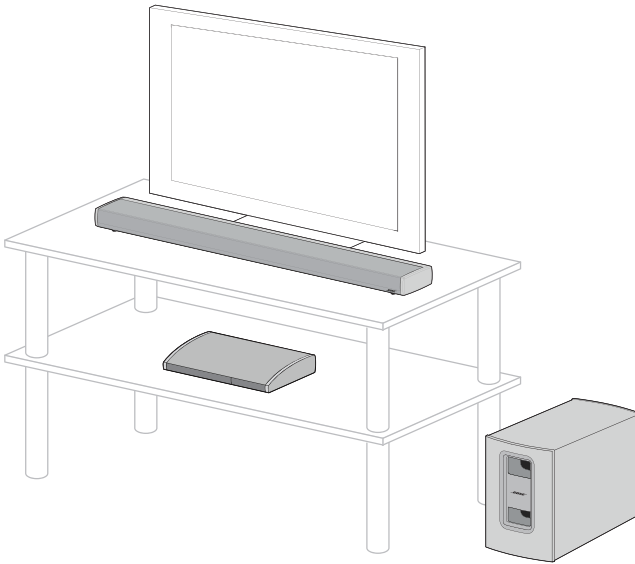

CAUTION: Do not operate the Acoustimass module on its front end, back end, side, or top.

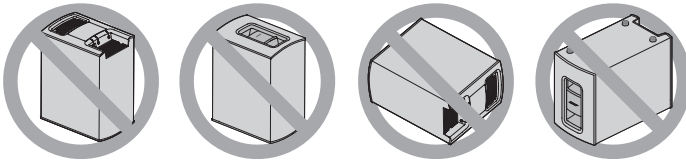

Note: Remove all protective films. These may affect acoustic performance if left in place.

4. Plug the Acoustimass module's power cord into an AC (mains) power outlet.

Starting Up the System

What you need:

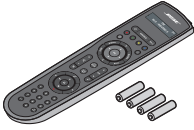

Remote control
and batteries



ADAPTiQ® audio
calibration headset

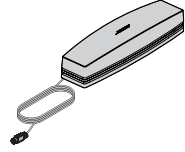

SoundTouch™ series II
wireless adapter

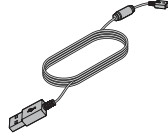

USB cable

Before you start:

- Do not connect any devices to the control console until instructed by UNIFY®.
- Make sure the soundbar and Acoustimass® module are in their final positions.

Installing the remote control's batteries

1. Slide open the battery compartment cover on the back of the remote control.

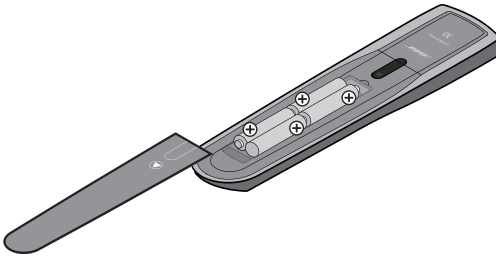

2. Install the four provided AA (IEC LR6) batteries. Match the + and – symbols on the batteries with the + and – markings inside the compartment.
3. Slide the battery cover back into place.

Powering on the system

1. Press the power button on the control console.

Note: The system operates in a power saving mode when it is off to keep energy consumption low, so it may take several seconds to start.

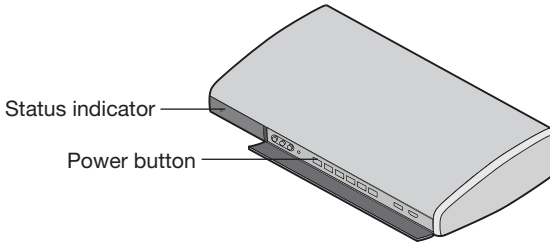

2. Check that the status indicator on the soundbar is off.

Note: If the status indicator is blinking amber, there is no wireless connection between the speaker and the Acoustimass® module. Refer to “Troubleshooting” in the operating guide.

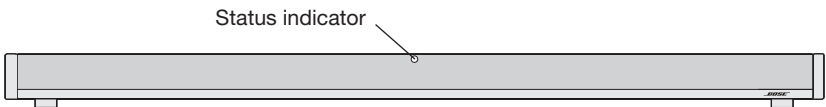

3. Power on your TV.
4. Using your TV's remote control, change the TV input to the one that is connected to your Lifestyle® SoundTouch™ system.

Starting Up the System

Completing setup with UNIFY®

The UNIFY intelligent integration system guides you through the initial process of setting up your system. It guides you through choosing the right cables and inputs, and programming the Bose® remote to operate your connected devices.

Follow the instructions on your TV screen to complete the following:

- Select your language.
- Run the ADAPTiQ® audio calibration system.
- Connect the SoundTouch™ wireless adapter to your system and your Wi-Fi® network using a smartphone or tablet.

Note: If you are unable to complete setup with a smartphone or tablet, see “Appendix: Using UNIFY® to set up SoundTouch™” on page 22.

- Connect and set up external audio/video devices
- Configure your Bose® remote to control your connected devices.

After completing the initial setup, you can use the UNIFY system at any time to change your system setup. Refer to the operating guide.

Troubleshooting

If you experience any difficulties during the setup process, such as an unrecognized device remote or a connection error, go to the UNIFY® menu and correct or change part of your system setup. See “Changing Your System Setup” in the operating guide.

Refer to “Troubleshooting” in the operating guide.

Contacting customer service

For additional help using the system:

- Visit SoundTouch.com
- Contact Bose® Customer Service. Refer to the contact sheet in the carton.

Appendix: Using UNIFY® to set up SoundTouch™

Adding the system to your Wi-Fi® network

You can set up the SoundTouch™ wireless adapter using Network Setup in the UNIFY menu if you are unable to complete setup with a smartphone or tablet.

1. Press **Setup** on the control console.
2. Select **Network Setup** in the UNIFY menu.
3. Press **OK** on the remote.
4. Follow the onscreen instructions to connect the adapter.

To add the system to an existing SoundTouch™ account

If you have already set up SoundTouch™ for another system, you do not need to download the SoundTouch™ app again.

1. On your smartphone, tablet or computer select the SoundTouch™ icon  to launch the app.
2. Select **EXPLORE > SETTINGS > Systems > ADD SYSTEM** to add another system.
3. Select **IT IS ALREADY CONNECTED**.

Download and install the SoundTouch™ app

If this is your first time setting up a SoundTouch™ system, you must install the app. On your smartphone or tablet, download the **SoundTouch™ controller app**.

1. On your smartphone or tablet, download the **SoundTouch™ controller app**.



Bose® SoundTouch™ controller app

- iOS users: download from the App Store
 - Android™ users: download on the Google Play™ store
 - Amazon Kindle Fire users: download from the Amazon Appstore for Android
2. Select  to launch the app.
 3. Click **CONTINUE**.
The SoundTouch™ system setup screen appears.
 4. Select **IT IS ALREADY CONNECTED**.
 5. Follow the instructions in the app to complete setup, including creating a SoundTouch™ account, adding a music library and music services.



744562-0010

BOSE[®]
Better sound through research[®]

©2015 Bose Corporation, The Mountain,
Framingham, MA 01701-9168 USA
AM744562 Rev. 00