

# SITRANS F flowmeters

## SITRANS F M

### MAGFLO MAG 1100 Food

4

#### Overview



The electromagnetic sensor SITRANS F M MAGFLO MAG 1100 Food is designed to meet applications in the food and beverage industry.

#### Benefits

- Sensor sizes: DN 10 to DN 100 (3/8" to 4")
- AISI 316 stainless steel enclosure
- Sensor: Hygienic connection, 3A and EHEDG authorized construction
- Sanitary design for CIP / SIP cleaning
- Conforms to FDA
- Easy commissioning, the SENSORPROM unit automatically updates settings
- Hose proof IP67/NEMA 4X/6 enclosure rating
- Designed that patented in-situ verification can be conducted. Using SENSORPROM fingerprints

#### Application

The main applications of the SITRANS F M MAGFLO electromagnetic sensors can be found in the following fields:

- Food industry
- Beverage industry
- Pharmaceutical industry

#### Design

- Unique mechanical design with a wide range of customer specified sanitary connection
- Compact or remote mounting possible easy "plug & play" field changeable
- Simple on site upgrade to IP68/NEMA 6P
- Ex ATEX 2G D version for hazardous areas (ceramic liner)

#### Mode of operation

The flow measuring principle is based on Faraday's law of electromagnetic induction where the sensor converts the flow into an electrical voltage proportional to the velocity of the flow.

#### Integration

The complete flowmeter consists of a sensor and an associated transmitter SITRANS F M MAGFLO MAG 5000, 6000 and 6000 I. The flexible communication concept USM II simplifies integration and update to a variety of fieldbus systems such as PROFIBUS DP & PA, MODBUS RTU/RS485, HART.

#### Technical specifications

<b>Measuring principle</b>	Electromagnetic induction
Excitation frequency	DN 10 ... 65 (1/4" ... 2 1/2"): 12.5 Hz DN 80 ... 100 (3", 4"): 6.25 Hz

#### Process connection

Nominal size	DN 10 ... DN 100 (3/8" ... 4")
Process connection	Hygienic adapters available for: <ul style="list-style-type: none"> <li>• Direct welding onto pipe</li> <li>• Clamp fitting</li> <li>• Threaded fitting</li> </ul>

#### Rated operating conditions

##### Ambient conditions

##### Ambient temperature<sup>1)</sup>

• Sensor	-40 ... +100 °C (-40 ... +212 °F)
• Compact transmitter MAG 5000/6000	-20 ... +50 °C (-4 ... +122 °F)
• Transmitter MAG 6000 I	-20 ... +60 °C (-4 ... +140 °F)
• Compact transmitter MAG 6000 I Ex d	-10 ... +60 °C (+14 ... +140 °F)

##### Temperature of medium

MAG 1100 Food (Ceramic)	-20 ... +150 °C (-4 ... +300 °F) Suitable for steam sterilization
MAG 1100 Food (PFA)	-30 ... +130 °C (-20 ... +270 °F) Suitable for steam sterilization at 150 °C (300 °F)

##### Temperature shock

##### MAG 1100 Food

• Duration ≤ 1 min, followed by 10 min rest	<ul style="list-style-type: none"> <li>• DN 10, 15, 25: Max. ΔT ≤ 80 °C/min (3/8", 1/2", 1"): Max. ΔT ≤ 80 K/min</li> <li>• DN 40, 50, 65: Max. ΔT ≤ 70 °C/min (1 1/2", 2", 2 1/2"): Max. ΔT ≤ 70 K/min</li> <li>• DN 80, 100: Max. ΔT ≤ 60 °C/min (3", 4"): Max. ΔT ≤ 60 K/min</li> </ul>
---	--

##### MAG 1100 Food (PFA)

Max. ± 100 °C (210 °F) momentarily

##### Operating pressure

MAG 1100 Food (Ceramic)	DN 10 ... 65: 40 bar (3/8" ... 2 1/2": 580 psi) DN 80: 37.5 bar (3": 540 psi) DN 100: 30 bar (4": 435 psi) Vacuum: 1 x 10 <sup>-6</sup> bar (1.5 x 10 <sup>-5</sup> psi)
MAG 1100 Food (PFA)	20 bar (290 psi) Vacuum: 0.02 bar (0.3 psi)

<sup>1)</sup> Conditions are also dependent on liner characteristics

# SITRANS F flowmeters

## SITRANS F M

### MAGFLO MAG 1100 Food

#### Technical specifications (continued)

<u>Mechanical load</u>	18 ... 1000 Hz random in x, y, z, directions for 2 hours according to EN 60068-2-36 Sensor: 3.17 grms Sensor with compact MAG 5000/6000 mounted transmitter: 3.17 grms Sensor with compact MAG 6000 I/MAG 6000 I Ex mounted transmitter: 1.14 grms For compact installation with the MAG 6000 I/MAG 6000 I Ex, transmitter to be supported to avoid tension on sensor part.
------------------------	---

<u>Enclosure rating</u>	
Standard	IP67 to EN 60529 (NEMA 4X), 1 mH <sub>2</sub> O for 30 min
Option on sensor (not for ATEX)	IP68 to EN 60529 (NEMA 6), 10 mH <sub>2</sub> O cont.

EMC	89/336 EEC
-----	------------

#### Design

Weight	See Dimensional drawings
--------	--------------------------

#### Material

Enclosure	
• MAG 1100 Food	Stainless steel AISI 316L (1.4404)
Terminal box (remote version only)	
• Standard	Fibre glass-reinforced polyamide
• Option	Stainless steel AISI 316 (1.4436)
• Ex ATEX (remote version only)	Stainless steel AISI 316 (1.4436)

#### Liner

MAG 1100 Food (Ceramic)	Aluminium oxide Al <sub>2</sub> O <sub>3</sub> (ceramics)
MAG 1100 Food (PFA)	Reinforced PFA (teflon) (no ATEX)

#### Electrodes

MAG 1100 Food (Ceramic)	Platinum with gold / Titanium brazing alloy
MAG 1100 Food (PFA)	Hastelloy C276

#### Cable entries

- Remote installation 2 x M20 or 2 x 1/2 NPT
- Compact installation
  - MAG 5000/MAG 6000: 4 x M20 or 4 x 1/2"NPT
  - MAG 6000I: 2 x M25 (for supply/output)
  - MAG 6000I Ex. d: 2 x M20 (for supply/output)

#### Certificates and approvals

MAG 1100 Food (Ceramic)	3A (sensor with Polyamid terminal box ), transmitter not part of the approval EHEDG
• Ex ATEX approvals for sensor or compact with Mag 6000 I Ex	ATEX 2G D sensor EEx d e ia IIB T3 - T6
• Sensor with/without MAG 5000/6000/ 6000 I	FM/CSA Class 1 div 2
MAG 1100 Food (PFA)	3A (sensor with Polyamid terminal box ), transmitter not part of the approval EHEDG in preparation FM/CSA Class 1 div 2
Conforms to	PED – 97/23/EC and CRN (PFA) FDA

#### Accessories

##### Weld-in adapter

Adapter for welding onto dairy pipe	Tri-Clover ISP 2037, DIN 11850, SMS 3008, BS 4825-1
• DN 10, 15, 25, 40, 50, 65 and 80 (3/8", 1/2", 1", 1 1/2", 2", 2 1/2" and 3")	PN 40 (600 psi)
• DN 100 (4")	PN 25 (350 psi)

##### Clamp adapter

	Tri-Clamp ISP 2852, DIN 32676, SMS 3016, BS 4825-3
DN 10, 15, 25, 40 and 50 (3/8", 1/2", 1", 1 1/2", and 2")	PN 16 (200 psi)
DN 65, 80 and 100 (2 1/2", 3" and 4")	PN 10 (150 psi)

##### Thread adapter

DIN 11851	
• DN 10, 15, 25, and 40 (3/8", 1/2", 1", and 1 1/2")	PN 40 (600 psi)
• DN 50, 65, 80 and 100 (2", 2 1/2", 3" and 4")	PN 25 (350 psi)
ISO 2853, SS 3351, BS 4825-4	
• DN 10, 15, 25, 40, 50, 65 and 80 (3/8", 1/2", 1", 1 1/2", 2", 2 1/2" and 3")	PN 16 (200 psi)
SMS 1145	
• DN 25, 40, 50, 65 and 80 (1", 1 1/2", 2", 2 1/2" and 3")	PN 6 (80 psi)

##### Design

##### Material

Adapter	Stainless steel AISI 316/Stainless steel AISI 304 (ISO 2852)
Gasket	
• Standard	EPDM (-20 ... +150 °C (-4 ... +302 °F))
• Option	NBR (-20 ... +100 °C (-4 ... +212 °F))

##### Note:

When combined sensor and adapter, the operating pressure is the lower rated of the pair.

# SITRANS F flowmeters

## SITRANS F M

### MAGFLO MAG 1100 Food

Selection and Ordering data	Order No.
<b>Sensor SITRANS F M MAGFLO MAG 1100 Food F)</b>	<b>7ME6140-</b>
<b>Diameter</b>	
DN 10 (3/8")	▶ 1 R
DN 15 (1/2")	▶ 1 V
DN 25 (1")	▶ 2 D
DN 40 (1 1/2")	▶ 2 R
DN 50 (2")	▶ 2 Y
DN 65 (2 1/2")	▶ 3 F
DN 80 (3")	▶ 3 M
DN 100 (4")	▶ 3 T
<b>Process connections</b>	
No adaptors (specials see accessories)	▶ A
<b>Weld in</b>	
DIN 11850	▶ B
DS/ISO 2037	▶ C
BS 4825-1	▶ D
Tri-Clover™	▶ E
<b>Clamp type</b>	
DIN 32676	G
ISO 2852	H
BS 4825-3	J
Tri-Clamp™	K
<b>Threaded type</b>	
DIN 11851	M
SMS 1145	N
<b>Liner material</b>	
PFA (no ATEX)	▶ 1
Ceramic	▶ 2
<b>Gasket material</b>	
EPDM (FDA)	▶ 0
NBR	▶ 1
<b>Electrode material</b>	
Hastelloy C276 (only with PFA liner)	▶ 1
Platinum (only with ceramic liner)	▶ 2
<b>Transmitter</b>	
Sensor for remote transmitter (order transmitter separately) 3A	A
Sensor ATEX 2G D for remote transmitter (order transmitter separately) 3A	B
MAG 6000 I, Alu. 18 ... 90 V DC, 115 ... 230 V AC	C
MAG 6000 I, Aluminium 18 ... 30 V DC, ATEX 2G D	D
MAG 6000 I Aluminium 115 ... 230 V, ATEX 2G D	E
MAG 6000, Polyamid, 11 ... 30 V DC/11 ... 24 V AC	H
MAG 6000, Polyamid, 115/230 V AC	J
MAG 5000, Polyamid, 11 ... 30 V DC/11 ... 24 V AC	K
MAG 5000, Polyamid, 115/230 V AC	L
<b>Communication</b>	
No communication, add-on possible	▶ A
HART	B
PROFIBUS PA Profile 3	F
PROFIBUS DP Profile 3 (no ATEX)	G
MODBUS RTU/RS 485 (no ATEX)	E

Selection and Ordering data	Order No.
<b>Sensor SITRANS F M MAGFLO MAG 1100 Food F)</b>	<b>7ME6140-</b>
<b>Cable glands/terminal box</b>	
Metric	1
1/2" NPT	2
Metric: SS terminal box (mandatory for Stainless steel MAG 6000 Transmitter)	3
1/2" NPT: SS terminal box (mandatory for Stainless steel MAG 6000 Transmitter)	4
▶ Available ex stock.	

Selection and Ordering data	Order code
<b>Additional information</b>	
Please add "-Z" to Order No. and specify Order code(s) and plain text.	
Customer specific converter setup	<b>Y20</b>
Tag name plate, stainless steel fixed with SS wire (add plain text)	<b>Y17</b>
Tag name plate, plastic (self adhesive)	<b>Y18</b>
Factory certificate according to EN 10204-2.1	<b>C15</b>
Factory certificate according to EN 10204-2.2	<b>C14</b>
Sensor cables wired (specify cable order no.)	<b>Y40</b>
Sensor for remote transmitter's junction box potted to IP68 with wired cable (specify cable order no.) (no ATEX sensors)	<b>Y41</b>
Other postproduction requirements (add desired text)	<b>Y99</b>

MAG 5000/6000 transmitters and sensors are packed in separate boxes, the final assembly takes place during installation at the customer's place. MAG 6000 I/MAG 6000 I EX ATEX 2G D transmitters and sensors are delivered compact mounted from factory. Communication module will be pre-mounted in the transmitter.

Please use online Product selector to get latest updates. Product selector link: [www.pia-selector.com/its\\_main\\_en.asp](http://www.pia-selector.com/its_main_en.asp)

Please also see [www.siemens.com/SITRANSOrdering](http://www.siemens.com/SITRANSOrdering) for practical examples of ordering

# SITRANS F flowmeters

## SITRANS F M

### MAGFLO MAG 1100 Food

#### Accessories

Order No.<sup>F)</sup>

#### Weld in connection fittings for MAG 1100 Food

Each of the following accessory order nos.  
comprises:

- 2 pcs. fittings
- 2 pcs. clamps (to join flow sensor and fitting)
- 2 pcs. EPDM gaskets

#### DIN 11850

Adapter		Sensor	
DN (mm)	D <sub>o</sub> (mm)	D <sub>i</sub> (mm)	DN (mm)

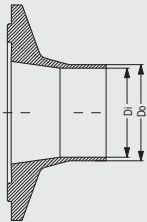

10	13	10	10	▶	<b>FDK-083G2116</b>
15	19	16	15	▶	<b>FDK-083G2117</b>
20	23	20	15	▶	<b>FDK-083G2118</b>
25	29	26	25	▶	<b>FDK-083G2119</b>
32	35	32	25	▶	<b>FDK-083G2120</b>
40	41	38	40	▶	<b>FDK-083G2121</b>
50	53	50	50	▶	<b>FDK-083G2122</b>
65	70	66	65	▶	<b>FDK-083G2123</b>
80	85	81	80	▶	<b>FDK-083G2124</b>
100	104	100	100	▶	<b>FDK-083G2125</b>

#### DS/ISO 2037

Adapter		Sensor	
DN (mm)	D <sub>o</sub> (mm)	D <sub>i</sub> (mm)	DN (mm)

10	13	10	10	▶	<b>FDK-083G2116</b>
15	19	16	15	▶	<b>FDK-083G2117</b>
20	23	20	15	▶	<b>FDK-083G2118</b>
25	25.6	22.6	25	▶	<b>FDK-083G2109</b>
28	28.6	25.6	25	▶	<b>FDK-083G2100</b>
33.7	34.3	31.3	25	▶	<b>FDK-083G2110</b>
38	38.6	35.6	40	▶	<b>FDK-083G2111</b>
40	40.6	37.6	40	▶	<b>FDK-083G2101</b>
51	51.6	48.6	50	▶	<b>FDK-083G2112</b>
63.5	64.1	60.3	65	▶	<b>FDK-083G2113</b>
70	70.6	66.8	65	▶	<b>FDK-083G2103</b>
76.1	76.7	72.9	80	▶	<b>FDK-083G2114</b>
88.9	88.9	84.9	80	▶	<b>FDK-083G2104</b>
101.6	102.5	97.6	100	▶	<b>FDK-083G2115</b>
114.3	115.6	110.3	100	▶	<b>FDK-083G2105</b>

#### SMS 3008

Adapter		Sensor	
DN (mm)	D <sub>o</sub> (mm)	D <sub>i</sub> (mm)	DN (mm)

10	13	10	10	▶	<b>FDK-083G2116</b>
15	19	16	15	▶	<b>FDK-083G2117</b>
20	23	20	15	▶	<b>FDK-083G2118</b>
25	25.6	22.6	25	▶	<b>FDK-083G2109</b>
32	32	29.6	25	▶	<b>FDK-083G2102</b>
33.7	34.3	31.3	25	▶	<b>FDK-083G2110</b>
38	38.6	35.6	40	▶	<b>FDK-083G2111</b>
51	51.6	48.6	50	▶	<b>FDK-083G2112</b>
63.5	64.1	60.3	65	▶	<b>FDK-083G2113</b>
76	76	72	65	▶	<b>FDK-083G2106</b>
76.1	76.7	72.9	80	▶	<b>FDK-083G2114</b>
88.9	88.9	84.9	80	▶	<b>FDK-083G2104</b>
101.6	102.5	97.6	100	▶	<b>FDK-083G2115</b>
114.3	115.6	110.3	100	▶	<b>FDK-083G2105</b>

#### Accessories

Order No.<sup>F)</sup>

#### Weld in connection fittings for MAG 1100 Food

Each of the following accessory order nos.  
comprises:

- 2 pcs. fittings
- 2 pcs. clamps (to join flow sensor and fitting)
- 2 pcs. EPDM gaskets

#### BS 4825-1

Adapter		Sensor	
DN (mm)	D <sub>o</sub> (mm)	D <sub>i</sub> (mm)	DN (mm)

10	13	10	10	▶	<b>FDK-083G2116</b>
15	19	16	15	▶	<b>FDK-083G2117</b>
20	23	20	15	▶	<b>FDK-083G2118</b>
25	25.6	22.6	25	▶	<b>FDK-083G2109</b>
38	38.6	35.6	40	▶	<b>FDK-083G2111</b>
51	51.6	48.6	50	▶	<b>FDK-083G2112</b>
63.5	64.1	60.3	65	▶	<b>FDK-083G2113</b>
76.1	76.7	72.9	80	▶	<b>FDK-083G2114</b>
101.6	102.5	97.6	100	▶	<b>FDK-083G2115</b>
114.3	115.6	110.3	100	▶	<b>FDK-083G2105</b>

#### Tri-Clover®

Adapter		Sensor	
DN (mm)	D <sub>o</sub> (mm)	D <sub>i</sub> (mm)	DN (mm)

10	12.7	9.4	10	▶	<b>FDK-083G2276</b>
15.9	19.05	15.75	15	▶	<b>FDK-083G2277</b>
25	25.4	22.1	25	▶	<b>FDK-083G2279</b>
38	38.1	34.8	40	▶	<b>FDK-083G2281</b>
51	50.8	47.5	50	▶	<b>FDK-083G2282</b>
63.5	63.5	60.2	65	▶	<b>FDK-083G2283</b>
76.1	76.2	72.9	80	▶	<b>FDK-083G2284</b>
102	101.6	97.38	100	▶	<b>FDK-083G2285</b>

Tri-Clover® is a registered trademark of  
Ladish Co.

▶ Available ex stock.

D<sub>o</sub>: outer diameter  
D<sub>i</sub>: inner diameter

# SITRANS F flowmeters

## SITRANS F M

### MAGFLO MAG 1100 Food

4

#### Accessories

Order No.<sup>F)</sup>

##### Clamp-type connection fittings for MAG 1100 Food

##### Sanitary pipe fittings for Clamp types

Each of the following accessory order nos.  
comprises:

2 pcs. fittings  
2 pcs. clamps (to join flow sensor and fitting)  
2 pcs. EPDM gaskets

#### DIN 32676

Adapter			Sensor
DN (mm)	D <sub>o</sub> (mm)	D <sub>i</sub> (mm)	DN (mm)

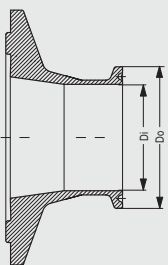

10	34	10	10
15	34	16	15
20	34	20	15
25	50.5	26	25
33.7	50.5	31.3	25
40	50.5	38	40
50	64	50	50
65	91	66	65
80	106	81	80
100	119	100	100

**FDK-083G2186**  
**FDK-083G2187**  
**FDK-083G2188**  
**FDK-083G2179**  
**FDK-083G2190**  
**FDK-083G2181**  
**FDK-083G2182**  
**FDK-083G2183**  
**FDK-083G2184**  
**FDK-083G2185**

#### ISO 2852

Adapter			Sensor
DN (mm)	D <sub>o</sub> (mm)	D <sub>i</sub> (mm)	DN (mm)

10	34	10	10
15	34	16	15
20	34	20	15
25	50.5	22.6	25
25	50.5	26	25
33.7	50.5	31.3	25
38	50.5	35.6	40
40	50.5	38	40
51	64	48.6	50
63.5	77.5	60.3	65
76.1	91	72.9	80
101.6	119	97.6	100

**FDK-083G2186**  
**FDK-083G2187**  
**FDK-083G2188**  
**FDK-083G2189**  
**FDK-083G2179**  
**FDK-083G2190**  
**FDK-083G2191**  
**FDK-083G2181**  
**FDK-083G2192**  
**FDK-083G2193**  
**FDK-083G2194**  
**FDK-083G2195**

#### SMS 3016

Adapter			Sensor
DN (mm)	D <sub>o</sub> (mm)	D <sub>i</sub> (mm)	DN (mm)

10	34	10	10
15	34	16	15
25	50.5	22.6	25
33.7	50.5	31.3	25
38	50.5	35.6	40
51	64	48.6	50
63.5	77.5	60.3	65
76.1	91	72.9	80
101.6	119	97.6	100

**FDK-083G2186**  
**FDK-083G2187**  
**FDK-083G2189**  
**FDK-083G2190**  
**FDK-083G2191**  
**FDK-083G2192**  
**FDK-083G2193**  
**FDK-083G2194**  
**FDK-083G2195**

#### Accessories

Order No.<sup>F)</sup>

##### Clamp-type connection fittings for MAG 1100 Food

##### Sanitary pipe fittings for Clamp types

Each of the following accessory order nos.  
comprises:

2 pcs. fittings  
2 pcs. clamps (to join flow sensor and fitting)  
2 pcs. EPDM gaskets

#### BS 4825-3

Adapter			Sensor
DN (mm)	D <sub>o</sub> (mm)	D <sub>i</sub> (mm)	DN (mm)

25	50.5	22.6	25
38	50.5	35.6	40
51	64	48.6	50
63.5	77.5	60.3	65
76.1	91	72.9	80
101.6	119	97.6	100

**FDK-083G2189**  
**FDK-083G2191**  
**FDK-083G2192**  
**FDK-083G2193**  
**FDK-083G2194**  
**FDK-083G2195**

#### Tri-Clamp®

Adapter			Sensor
DN (mm)	D <sub>o</sub> (mm)	D <sub>i</sub> (mm)	DN (mm)

10	34	10	10
15	34	16	15
25	50.5	22.6	25
38	50.5	35.6	40
51	64	48.6	50
63.5	77.5	60.3	65
76.1	91	72.9	80
101.6	119	97.6	100

**FDK-083G2286**  
**FDK-083G2287**  
**FDK-083G2289**  
**FDK-083G2291**  
**FDK-083G2292**  
**FDK-083G2293**  
**FDK-083G2294**  
**FDK-083G2295**

Tri-Clamp® is a registered trademark of  
Ladish Co.

D<sub>o</sub>: outer diameter  
D<sub>i</sub>: inner diameter

F) All products on this page subject to export regulations AL: 9I999, ECCN: N.

# SITRANS F flowmeters

## SITRANS F M

### MAGFLO MAG 1100 Food

#### Accessories

Order No.<sup>F)</sup>

##### Threaded type connection fittings for MAG 1100 Food

##### Sanitary pipe fittings for Threaded types

Each of the following accessory order nos. comprises:

- 2 pcs. fittings
- 2 pcs. clamps (to join flow sensor and fitting)
- 2 pcs. EPDM gaskets

#### DIN 11851

Adapter		Sensor	
DN (mm)	D <sub>o</sub> (mm)	D <sub>i</sub> (mm)	DN (mm)

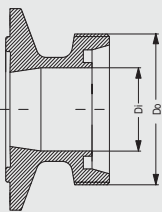

10	28	10	10
15	34	16	15
20	44	20	15
25	52	26	25
32	58	32	25
40	65	38	40
50	78	50	50
65	95	66	65
80	110	81	80
100	130	100	100

**FDK-083G2156**  
**FDK-083G2157**  
**FDK-083G2158**  
**FDK-083G2159**  
**FDK-083G2160**  
**FDK-083G2161**  
**FDK-083G2162**  
**FDK-083G2163**  
**FDK-083G2164**  
**FDK-083G2165**

#### ISO 2853

Adapter		Sensor	
DN (mm)	D <sub>o</sub> (mm)	D <sub>i</sub> (mm)	DN (mm)

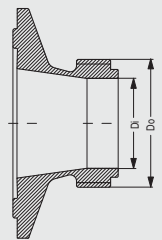

25	37	22.6	25
38	51	35.6	40
51	64	48.6	50
63.5	78	60.3	65
76.1	91	72.9	80
101.6	118	97.6	100

**FDK-083G2149**  
**FDK-083G2151**  
**FDK-083G2152**  
**FDK-083G2153**  
**FDK-083G2154**  
**FDK-083G2155**

#### SS 3351

Adapter		Sensor	
DN (mm)	D <sub>o</sub> (mm)	D <sub>i</sub> (mm)	DN (mm)

25	37	22.6	25
38	51	35.6	40
51	64	48.6	50
63.5	78	60.3	65
76.1	91	72.9	80
101.6	118	97.6	100

**FDK-083G2149**  
**FDK-083G2151**  
**FDK-083G2152**  
**FDK-083G2153**  
**FDK-083G2154**  
**FDK-083G2155**

#### BS 4825-4

Adapter		Sensor	
DN (mm)	D <sub>o</sub> (mm)	D <sub>i</sub> (mm)	DN (mm)

25	37	22.6	25
38	51	35.6	40
51	64	48.6	50
63.5	78	60.3	65
76.1	91	72.9	80
101.6	126	97.6	100

**FDK-083G2149**  
**FDK-083G2151**  
**FDK-083G2152**  
**FDK-083G2153**  
**FDK-083G2154**  
**FDK-083G2145**

#### Accessories

Order No.<sup>F)</sup>

##### Threaded type connection fittings for MAG 1100 Food

##### Sanitary pipe fittings for Threaded types

Each of the following accessory order nos. comprises:

- 2 pcs. fittings
- 2 pcs. clamps (to join flow sensor and fitting)
- 2 pcs. EPDM gaskets

#### SMS 1145

Adapter		Sensor	
DN (mm)	D <sub>o</sub> (mm)	D <sub>i</sub> (mm)	DN (mm)

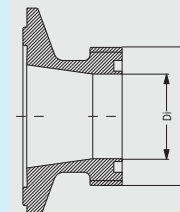

25	40	22.6	25
32	48	29.6	25
38	60	35.6	40
51	70	48.6	50
63.5	85	60.3	65
76	98	72	65

**FDK-083G2139**  
**FDK-083G2140**  
**FDK-083G2141**  
**FDK-083G2142**  
**FDK-083G2143**  
**FDK-083G2144**

D<sub>o</sub>: outer diameter  
D<sub>i</sub>: inner diameter

#### Spare parts for MAG 1100 Food

Order No.<sup>F)</sup>

##### Gaskets

(2 pcs., between flow sensor and adapter)

Rubber: EPDM (FDA)

- DN 10 ▶ **FDK-083G2206**
- DN 15 ▶ **FDK-083G2207**
- DN 25 ▶ **FDK-083G2209**
- DN 40 ▶ **FDK-083G2211**
- DN 50 ▶ **FDK-083G2212**
- DN 65 ▶ **FDK-083G2213**
- DN 80 ▶ **FDK-083G2214**
- DN 100 ▶ **FDK-083G2215**

Rubber: NBR

- DN 10 ▶ **FDK-083G2216**
- DN 15 ▶ **FDK-083G2217**
- DN 25 ▶ **FDK-083G2219**
- DN 40 ▶ **FDK-083G2221**
- DN 50 ▶ **FDK-083G2222**
- DN 65 ▶ **FDK-083G2223**
- DN 80 ▶ **FDK-083G2224**
- DN 100 ▶ **FDK-083G2225**

▶ Available ex stock.

## Dimensional drawings

Sensor MAG 1100 Food compact/remote

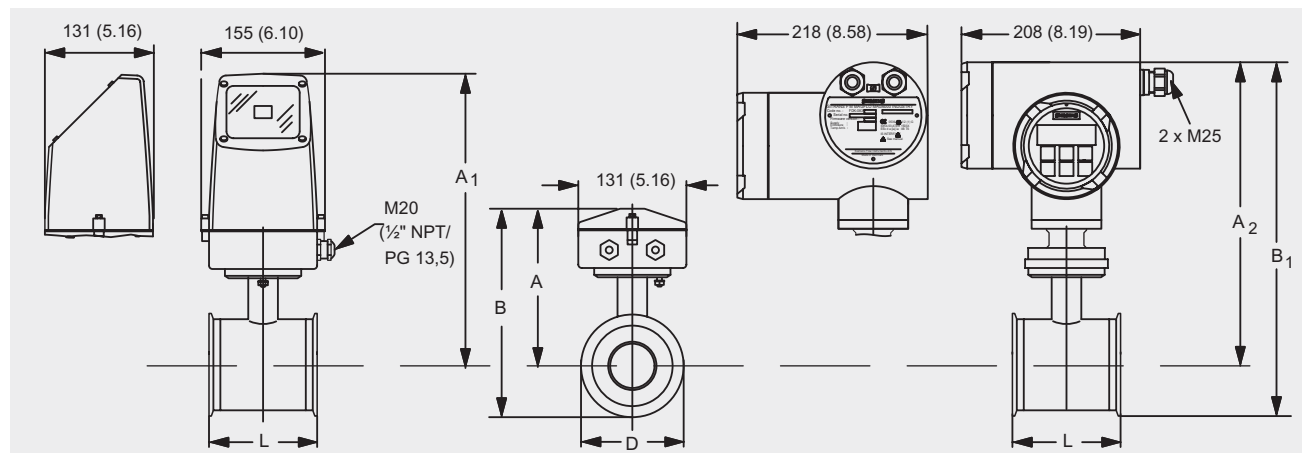

## Important note:

For compact installation with MAG 6000 I/Ex - transmitter to be supported to avoid tension on the sensor part.

Size	L	A	A <sub>1</sub>	B	B <sub>1</sub>	D	D <sub>i</sub> (Al <sub>2</sub> O <sub>3</sub> )	D <sub>i</sub> PFA	Weight <sup>1)</sup>
DN	[mm]	[mm]	[mm]	[mm]	[mm]	[mm]	[mm]	[mm]	[kg]
10	64	161	305	193.0	346.0	64.0	10	10	2.2
15	64	161	314	193.0	346.0	64.0	15	16	2.2
25	79	169	322	207.8	360.8	77.5	25	26	2.7
40	94	181	334	226.5	379.5	91.0	40	38	3.4
50	104	189	342	248.5	401.5	119.0	50	50	4.2
65	131	199	352	264.0	417.0	130.0	65	66	5.5
80	156	205	358	282.5	435.5	155.0	80	81	7.0
100	186	218	371	309.5	462.5	183.0	100	100	10.0

Size	L	A	A <sub>1</sub>	B	B <sub>1</sub>	D	D <sub>i</sub> (Al <sub>2</sub> O <sub>3</sub> )	D <sub>i</sub> PFA	Weight <sup>1)</sup>
[inch]	[inch]	[inch]	[inch]	[inch]	[inch]	[inch]	[inch]	[inch]	[lb]
3/8	2.52	6.34	11.96	7.60	13.63	2.52	0.39	0.39	4.8
1/2	2.52	6.34	11.96	7.60	13.63	2.52	0.59	0.63	4.8
1	3.11	6.66	12.29	8.18	14.21	3.05	0.98	1.02	4.9
1 1/2	3.70	7.13	12.83	8.92	14.94	3.58	1.57	1.50	7.5
2	4.09	7.44	12.97	9.79	15.81	4.68	1.97	1.97	9.2
2 1/2	5.16	7.84	13.48	10.40	16.42	5.12	2.56	2.60	12.0
3	6.14	8.07	13.50	11.13	17.15	6.10	3.15	3.19	15.0
4	7.32	8.59	13.97	12.19	18.21	7.20	3.94	3.94	22.0

<sup>1)</sup> With transmitter MAG 5000 or MAG 6000 compact, weight is increased by approximately 0.8 kg (1.8 lb)  
With MAG 6000 I weight is increased with 5.5 kg ( 12.1 lbs)

# SITRANS F flowmeters

## SITRANS F M

### MAGFLO MAG 1100 Food

Sensor MAG 1100 Food compact/separate – build-in length

4

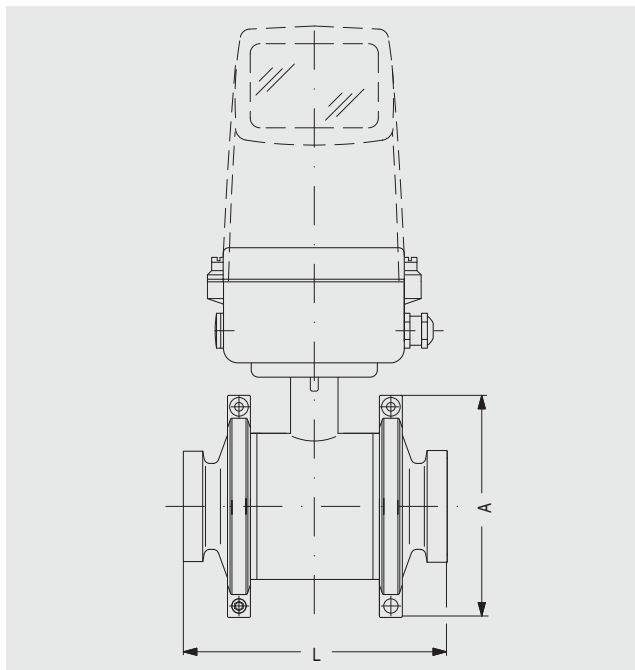

Size		A		L <sup>1)</sup>	
DN	Inch	[mm]	[inch]	[mm]	[inch]
10	3/8	99	3.90	146	5.75
15	1/2	99	3.90	146	5.75
25	1	113	4.45	161	6.34
40	1½	126	4.96	176	6.93
50	2	154	6.06	186	7.32
65	2½	165	6.50	223	8.78
80	3	200	7.87	258	10.16
100	4	225	8.86	288	11.34

<sup>1)</sup> The total build-in length "L" is independent of the adapter type selected.