

## SkillsUSA Carpentry Virtual Project

### Scope of the Contest

The contest will assess accuracy, workmanship, the ability to read and interpret blueprints, and the proper use of tools and equipment. Contestants may be required to frame walls using wood and/or steel studs; cut and install common, hip and jack rafters; and install drywall, siding, sheathing, baseboard moldings and window trim.

### Knowledge Performance

The contest will include a **Resume, Portfolio, and Video with Oral Presentation**. See SkillsUSA Virtual Technical Standards for competencies measured.

### Contest Information (All items must be received by due date)

- **PDF Resume**
  - Upload one file with all contestant's one-page resume's and include the digital link(s) to Written Submission and Zoom Recording
  - Click link below for Resume Rubric and scoring details  
<https://drive.google.com/file/d/1-9YpfjyKXVDSCVtVEJFMHeVnrQHxYd-O/view?usp=sharing>

### Portfolio/Written Submission

- Contestants are to submit a written summary of the steps they took to complete the project including planning, material management, and project evaluation.
- Upload written submission in a cloud-based storage platform and embed the link to written document into all contestant's resumes.

### Video of Demonstrated Procedures

- Utilizing Zoom or Teams, record the contestant completing 4-hour time limit.
- Ensure lighting, audio and video are high quality, and focus one camera at a distance to show the workspace the contestant is in to ensure they are not receiving any additional support. Position 1-2 additional cameras directly on the student to show their work. As tasks are completed, zoom in on key components for judging.

### Scoring Information

The following pre-submission items will be judged by industry professionals prior to virtual in-person Zoom session.

1. Resume with embedded links to written submission and video of STAR Interview
2. Written submission
3. Video presentation of contestant completing assigned project. Contestant should narrate what they are doing while doing it to ensure the judges can accurately score.

### Zoom Interview/Role Play

You will receive a specified date/time to participate in a virtual interview/role play via Zoom with industry professionals. You should be dressed in your SkillsUSA attire for this session. You will be asked questions about your resume and your completed project.

## **Contestant Tool and Materials List**

**Ensure all tools/materials are readily available prior to starting video recording.**

- 1 - (set) Sawhorses
- 1 - Cordless Drill
- 1 - Magnetic Bit Holder
- 1 - #2 Bits
- 1 - Cat's Paw
- 1 - Flat Bar
- 1 - Tin Snips (Straight)
- 1 - Hammer, framing
- 1 - Hammer, trim
- 1 - Coping Saw
- 1 - Hand Saw
- 1 - Drywall Saw
- 2 - (Pairs) of locking Clamps
- Squares (1 - Framing, 1 - Speed, 1 – (optional) Combination)
- 1 - Tape Measure
- 1 - Miter box (wood or plastic) and saw (**NO** Power Miter Saw)
- 1 - Utility knife
- 1 - Pencil
- 1 - Chalk box and line
- 1 – Nail set
- 1 - 24” and 48” Level
- 1 - Carpenter's Tool and Nail pouch with belt
- 1 - Power circular saw
- 1 - 50' Power Cord
- 1 – Each Safety (Gloves, Safety Glasses, Hard Hat, GFCI)
- 1 – Plumb Bob

## **Project Materials Required**

- 14 – 2 X 4 X 8' precut spruce (92 - 5/8")
- 3 – 2 X 4 X 8' spruce
- 2 – 2 X 4 X 12' spruce
- 1 – 3.5 X 8' steel track
- 2 – 3.5 X 8' steel studs
- 1 – box of 25 framing screws
- 1lb 1.25 course thread sheet rock screws
- 1 – ¼" X 11.25" X 4' whiteboard for step layout
- 10 lbs. # 12cc sinkers
- ½ lbs. #8cc sinkers
- 1 – ½" X 3.5" X 2' plywood for window header
- 1 black dry erase marker

CLIENT / PREPARER AGREEMENT

SIGNATURE: \_\_\_\_\_ DATE: \_\_\_\_\_

३०

DATE: \_\_\_\_\_

A diagram of a rectangular box with a diagonal beam and a weight. The box is labeled with dimensions: height is  $4' - 3\frac{1}{2}"$  and width is  $8' - 10"$ . A diagonal beam is shown inside the box, with a weight labeled "Weight" hanging from it. The beam is supported by a vertical post on the left side of the box.

DATE RECEIVED  
AS OF  
17305 1047 Terrace Line Co. 12008 PH. 306 842-2777, 306 330-4190

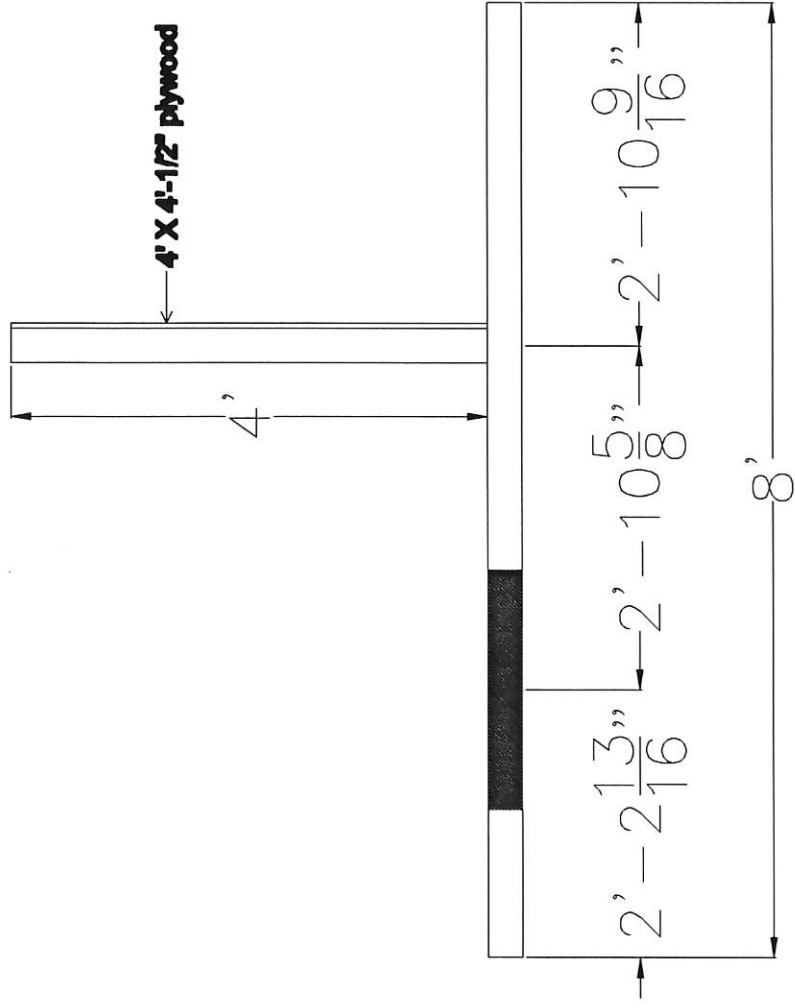

**Floor Plan**

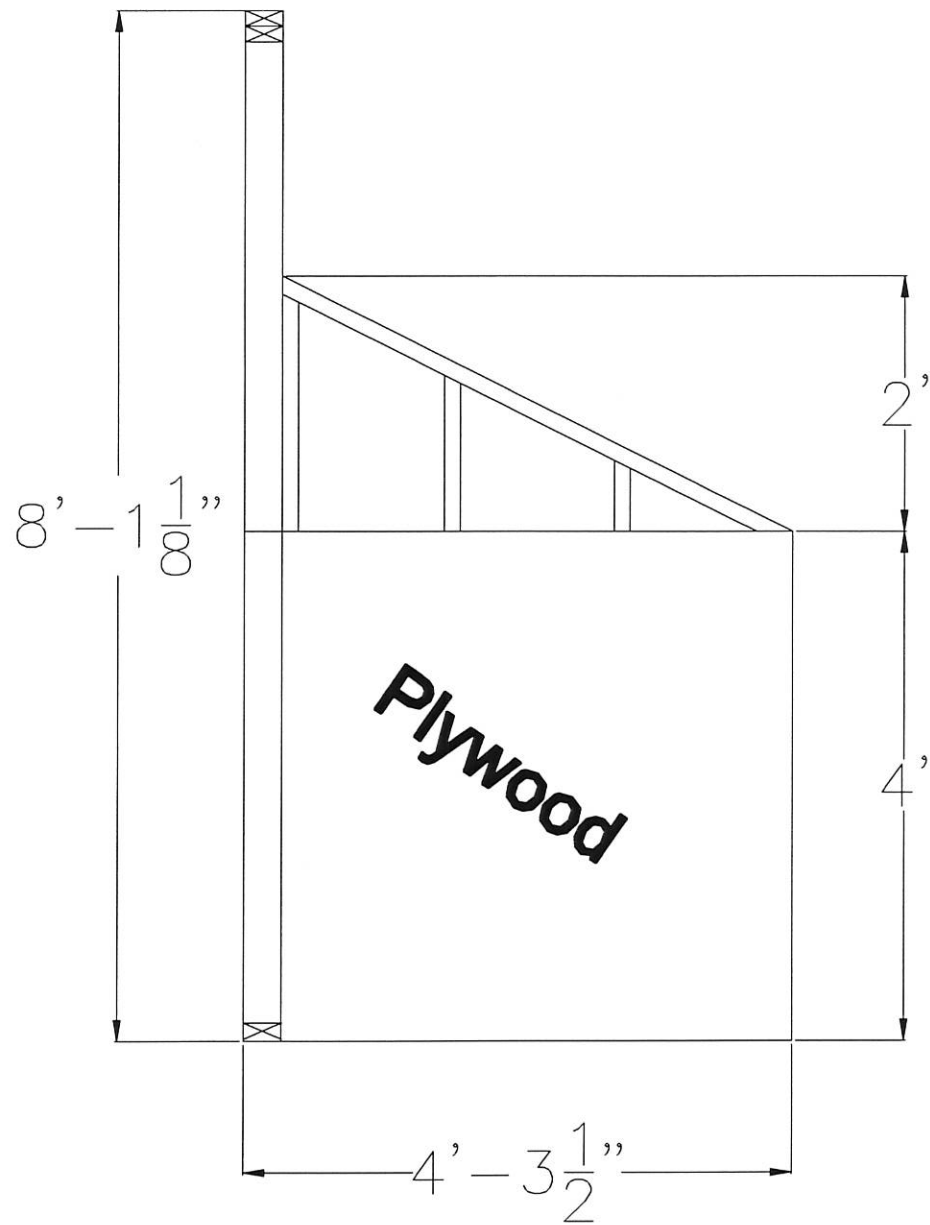

**Right Side View**

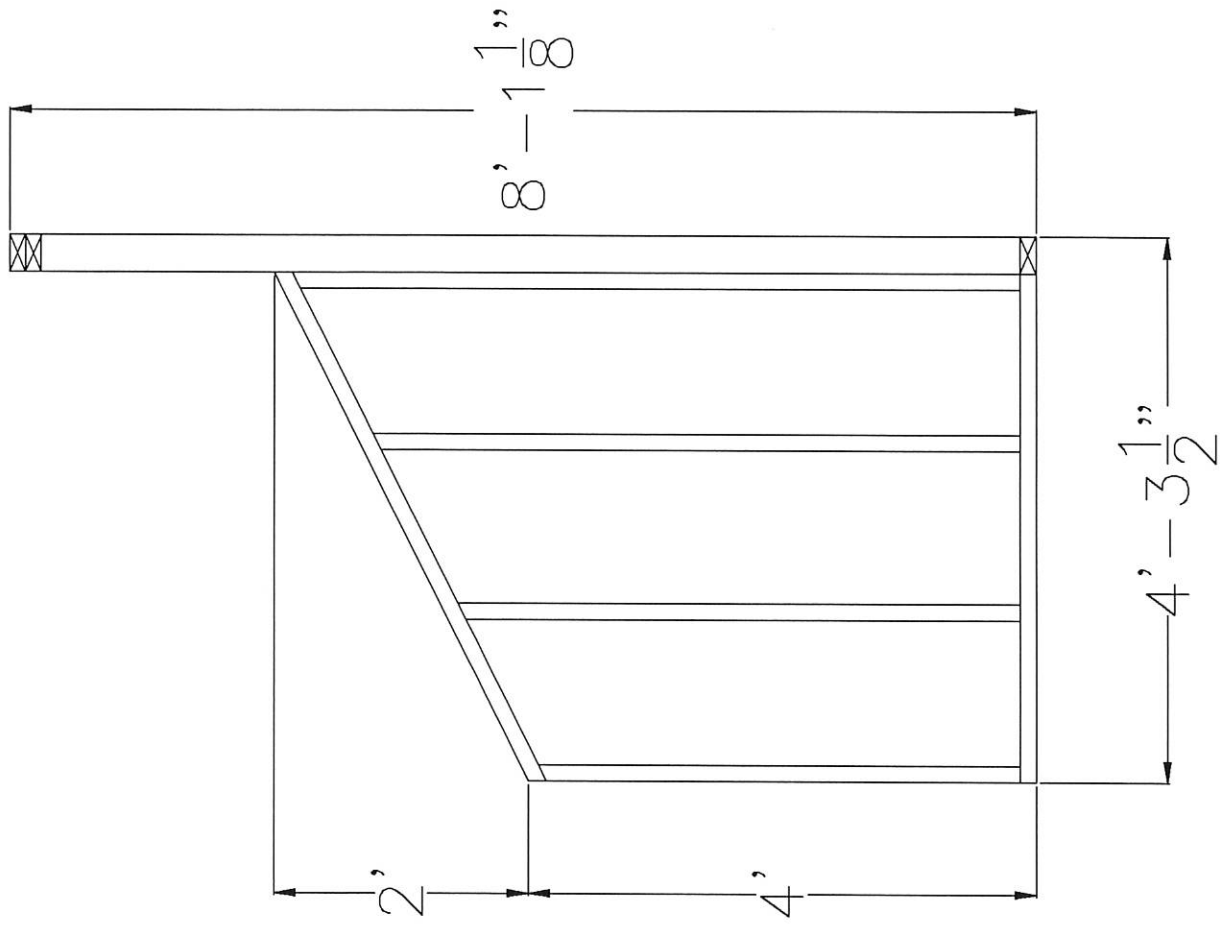

**Left Side View**

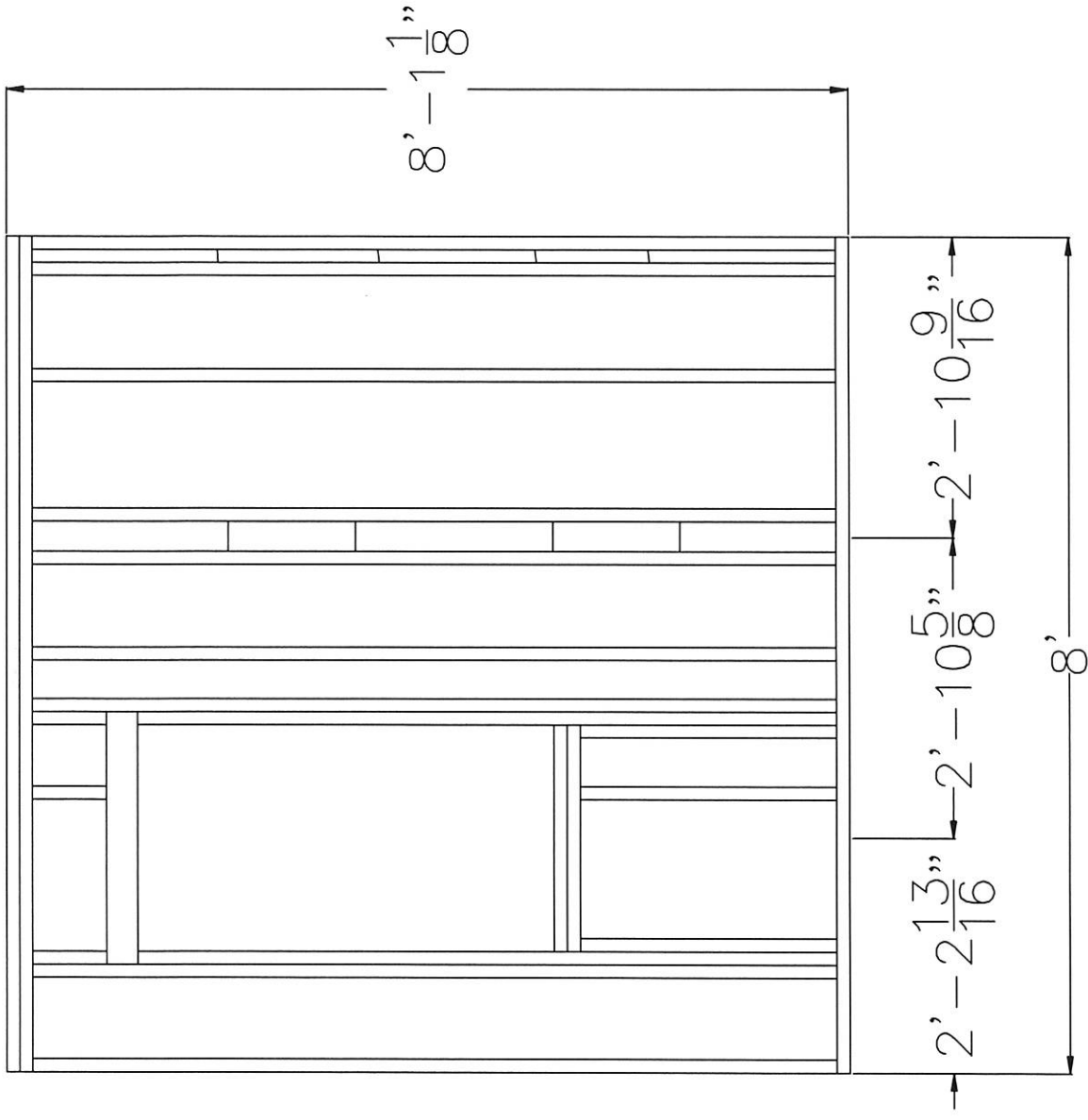

**Front View**

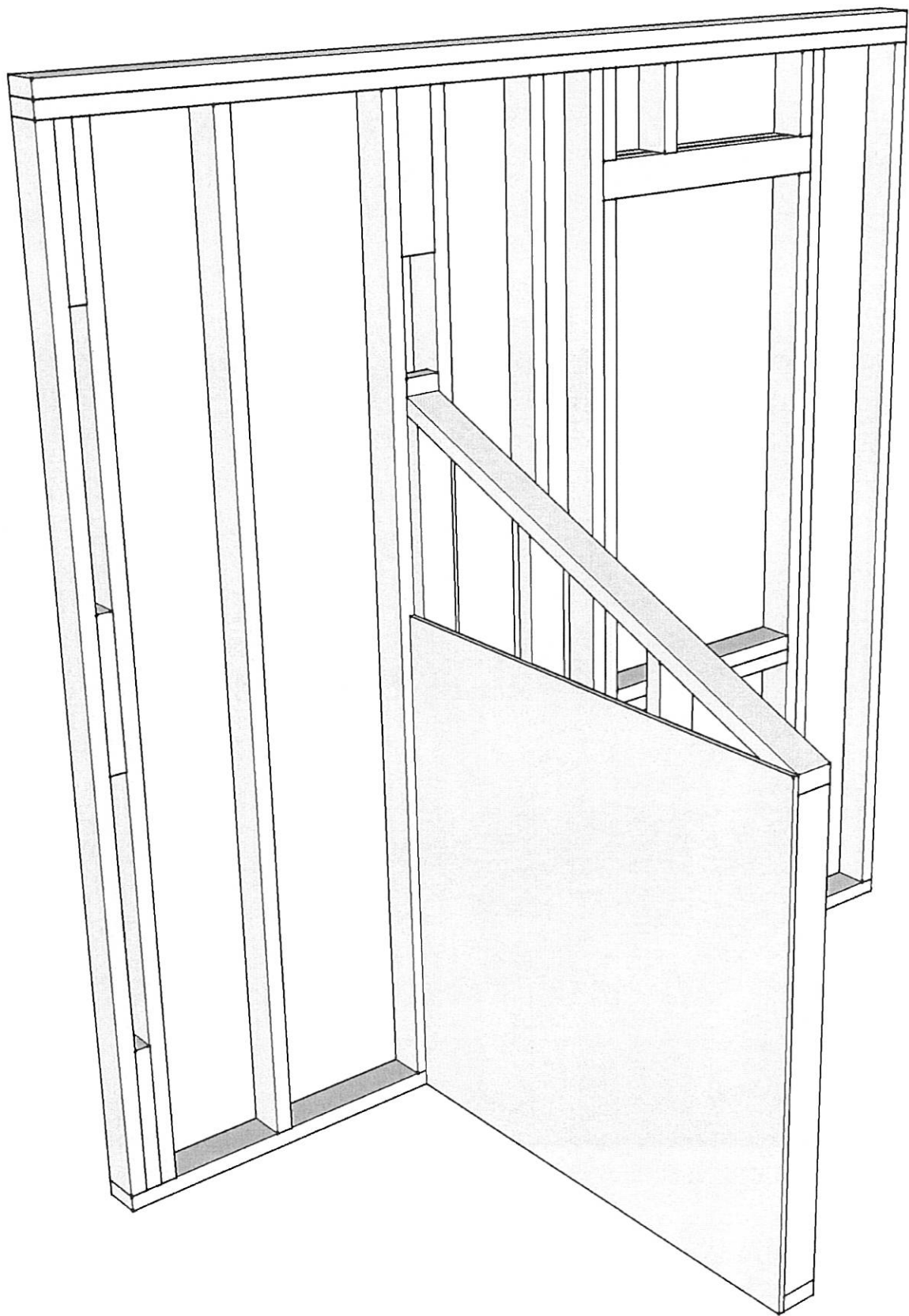



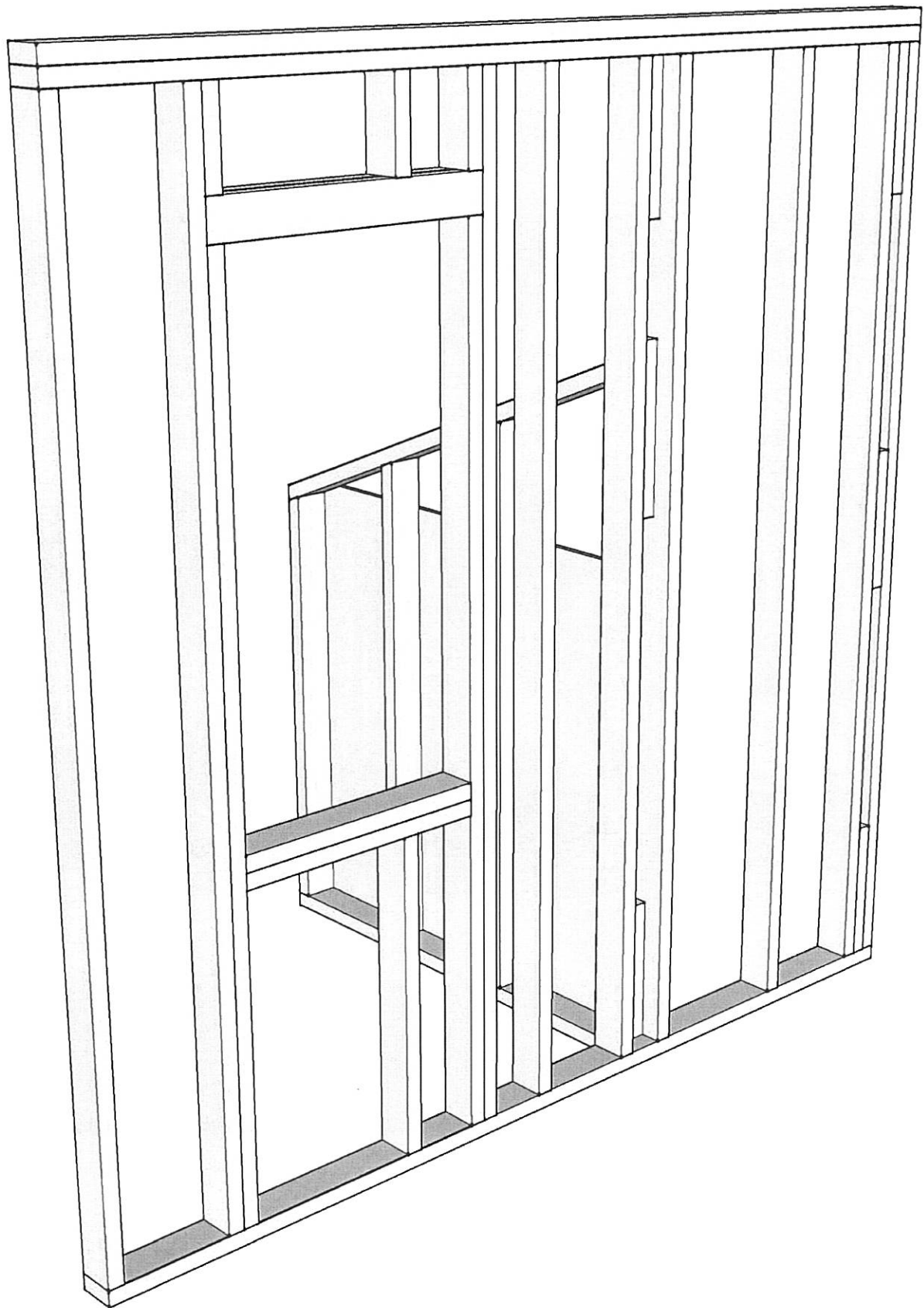

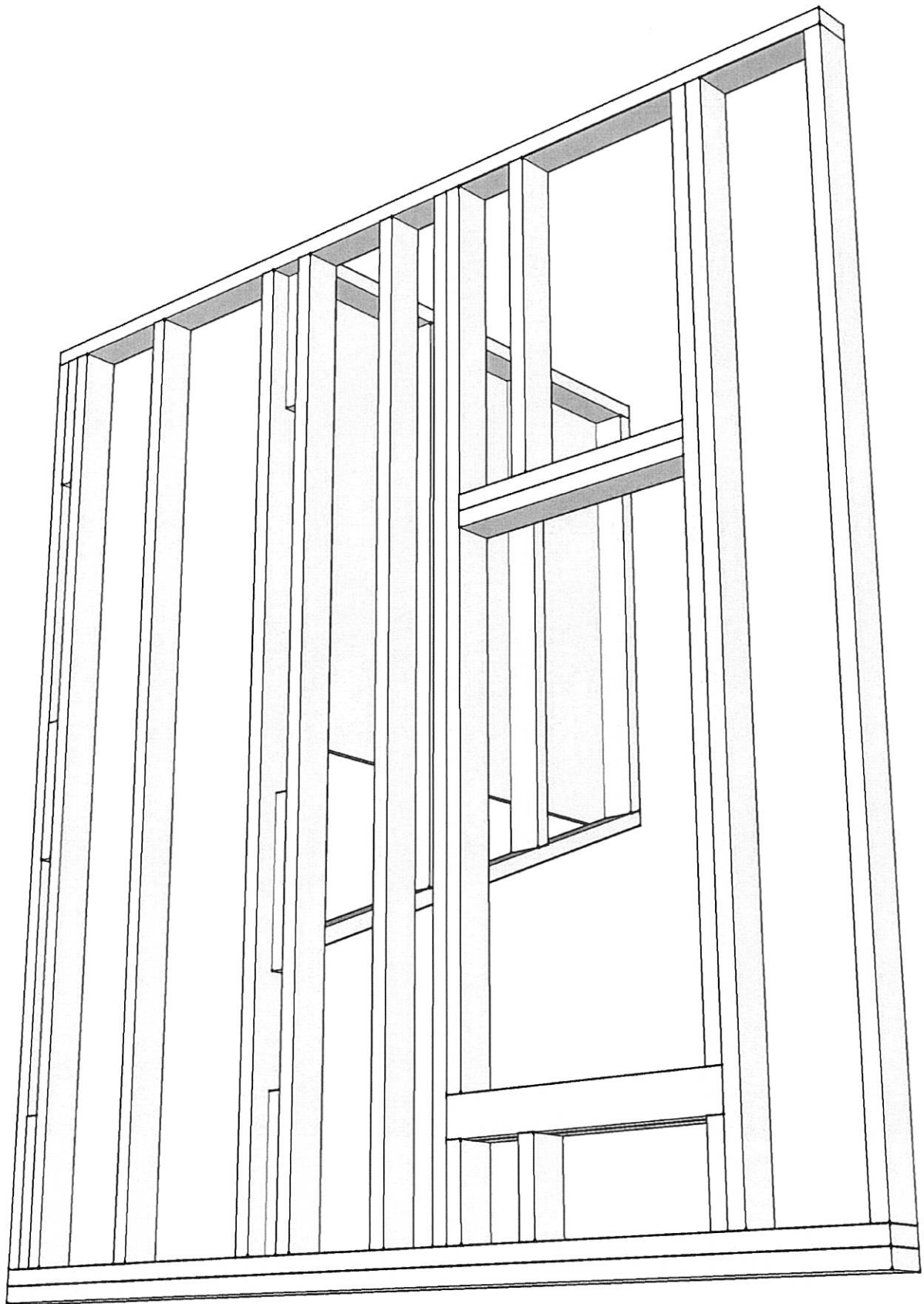

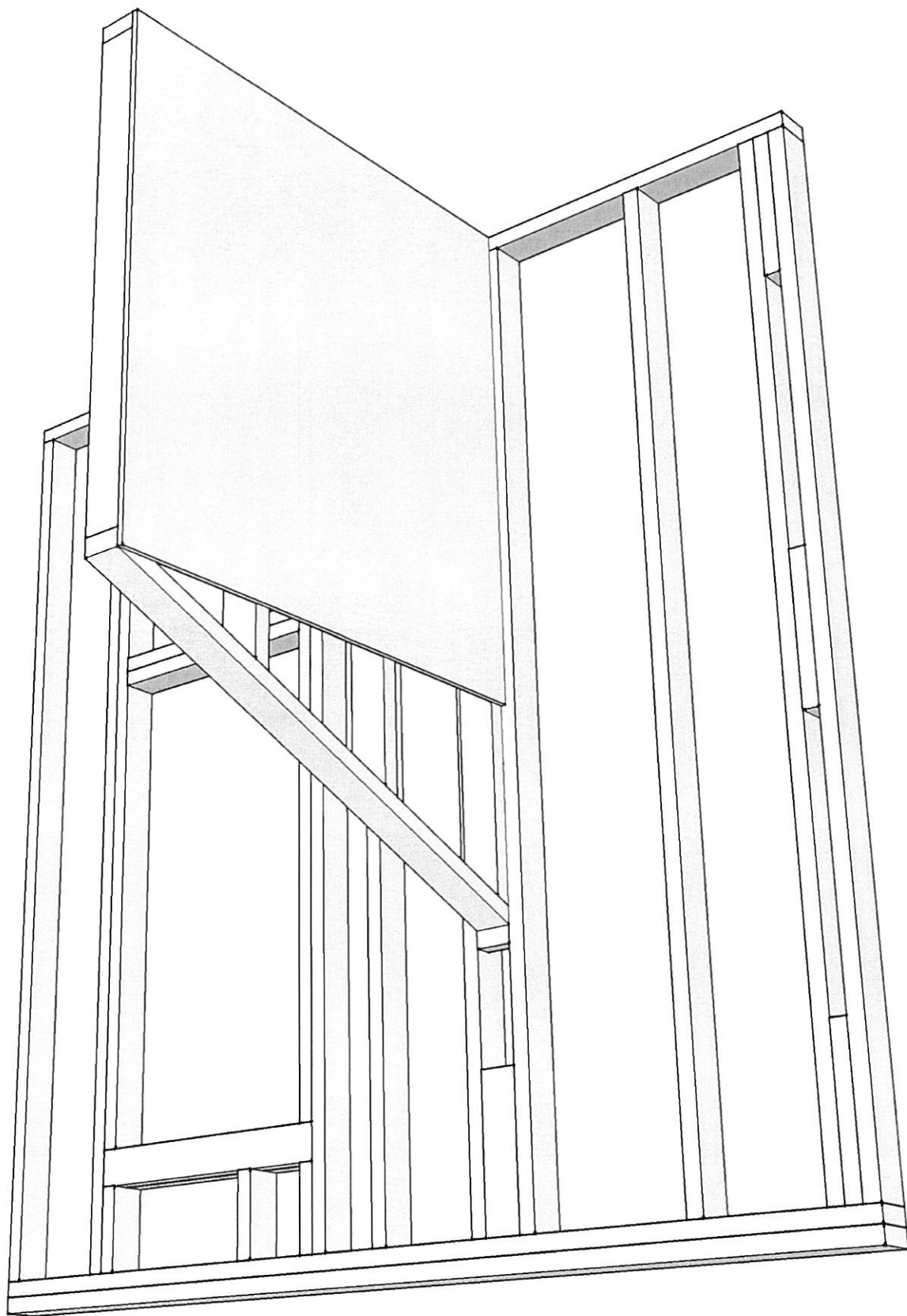

# CARPENTRY (VIRTUAL)



## PURPOSE

To evaluate each contestant's preparation for employment and to recognize outstanding students for excellence and professionalism in the field of residential and commercial carpentry.

First, download and review the General Regulations at: <http://updates.skillsusa.org>.

## ELIGIBILITY

Open to active SkillsUSA members enrolled in programs with carpentry as the occupational objective.

## CLOTHING REQUIREMENTS

### Class C: Contest Specific —

#### Manufacturing/Construction Khaki Attire

- Official SkillsUSA khaki short-sleeve work shirt and pants.
- Black, brown or tan leather work shoes.

### Contest Clothing Notes (Apply ONLY to Virtual Competitions):

- Official SkillsUSA Competition Clothing recommended but NOT required.
- Contestant clothing options include the following:
  - Official Competition Clothing.
  - Trade Appropriate Clothing.
  - Professional Dress.
  - Business Casual.
- Clothing must meet industry safety standards.
- No identification of the contestant, school or state is allowed on clothing.
- No offensive, vulgar or inappropriate images or text are allowed on contestants clothing.
- No shorts or sleeveless shirts are allowed.
- Skirts must be at least knee-length.
- Proper Personal Protective Equipment (PPE) must be worn by contestant to meet all state, local and school requirements due to COVID-19.

- Scoring deductions may only be given and/or disqualification of contestant if clothing safety standards are not met.

**Note:** Safety glasses must have side shields or goggles (prescription glasses may be used only if they are equipped with side shields. If not, they must be covered with goggles).

These regulations refer to clothing items that are pictured and described at:

[www.skillsusastore.org](http://www.skillsusastore.org). If you have questions about clothing or other logo items, call 1-888-501-2183.

## SAFETY REQUIREMENT

Both the instructor and the contestant certify by agreeing to enter this contest that the contestant has received instructions and has satisfactorily passed an examination on the safe use of a portable power saw. They also certify that the contestant's saw has been thoroughly inspected and is in safe working condition. Further, both the instructor and the contestant agree that SkillsUSA Inc., the SkillsUSA Championships technical committee and national judges are released from all responsibility and liability relating to personal injuries resulting from its use. Contestants will be removed from competition if proper training has not been provided and/or they are using the equipment in an unsafe manner.

## EQUIPMENT AND MATERIALS

Supplied by the contestant:

1. Computer with high-speed internet capability and camera to use applications such as Zoom, Teams, etc. The minimum recommended internet bandwidth speeds for joining Zoom meetings, accessing on-demand curriculum and other online operations is 2.0 Mbps up and down. You can test your current internet speeds by following this link: [www.speedtest.net](http://www.speedtest.net). Allow the page to load and click on GO.
2. A secondary camera(s) may be required to provide judges with the ability to view contestants from different angles. Additional camera requirements will be located on the SkillsUSA website at <http://updates.skillsusa.org>.
3. A contest Proctor will be required to be on site to assist judges. A local industry expert

is preferred to serve as the Proctor and shall not be an individual that has been involved with the training of the contestant(s). The Proctor will serve as the onsite “hands and eyes” for the judges. Proctor will follow instructions from the judges for safety and operations related to the competition. Proctor may be asked by judges to perform several tasks such as operating a portable camera to show specific components or steps, measure parts, or any task that will provide judges with information needed to assist in accurate scoring of the contestant’s work or presentation. However, the Proctor shall not serve as a judge nor have any influence on contestant scores.

4. The contestant’s instructor or advisor shall be on site to observe all competition activities to ensure a safe and healthy competition experience for all participants. That instructor or advisor will not be allowed to interact or interfere with the competitor unless a safety issue arises that requires interaction. Any other support or interaction between the contestant and the instructor/advisor will result in disqualification.
5. All competitors must create a one-page résumé and submit an electronic copy to the technical committee chair at least seven (7) days in advance of the competition. Failure to do so will result in a 10-point penalty. Instructions for submission of the electronic résumé copy will be provided on the SkillsUSA website at <http://updates.skillsusa.org>.
6. Prefabricated saw horses
7. All lumber and materials, as specified on the job sheet
8. Job sheets and blueprints for each contestant and judge
9. All necessary information and furnishings for judges and technical committee
10. Hard hat
11. Safety glasses
12. Cut-resistant Level 3 gloves
13. One 8 pt. crosscut saw (10 pt. or 12 pt. optional)
14. Claw hammer
15. One set chisels ( $\frac{1}{4}$ " to 1")
16. Framing square
17. 16' or longer steel tape measure
18. Utility knife with standard blades

19. Two pencils
20. One each — 1 and 2 pt. Phillips and 4" and 8" standard screwdrivers or one multi-tip with equivalent tip
21. Wrecking bar or gooseneck pinch bar
22. Coping saw and extra blade
23. Cat’s paw (nail puller)
24. Chalk box and line
25. One nail set
26. Straight aviation snip or any metal-cutting snips
27. 24" or 30" spirit level
28. Combination wood rasp and file (8")
29. Carpenter’s tool and nail pouch with belt and/or suspenders
30. Stair gauges
31. Combination square and/or speed square
32. 25' power cord (UL approved grounded)
33. Calculator
34. Power circular saw with new carbide-tipped blade
35. Drywall saw

**Note:** Your contest may also require a hard copy of your résumé as part of the actual contest. Check the Contest Guidelines and/or the updates page on the SkillsUSA website: <http://updates.skillsusa.org>.

## SCOPE OF THE CONTEST

### Knowledge Performance

The contest will include a written knowledge test that assesses knowledge of carpentry including, but not limited to, building materials, foundations and forms, rough framing, roof framing, exterior finish, interior finish, stairs, lumber and tools.

### Skill Performance

The contest will assess accuracy, workmanship, the ability to read and interpret blueprints, and the proper use of tools and equipment.

Contestants may be required to frame walls using wood and/or steel studs; cut and install common, hip and jack rafters; and install drywall, siding, sheathing, baseboard moldings and window trim.

## Contest Guidelines

1. Time limit: Contestants will be stopped when time limits, as specified on the contest job sheet, are up; however, contestants may stop whenever they have completed a particular phase of the contest.
2. The dismantling of the project will be considered the final sequence or task of this contest.

**Note:** If desired, a contestant may choose to use a standard hand saw without penalties.

## Standards and Competencies

**Note for Virtual Competitions:** Contestants may not be required to perform all the standards and competencies listed in this section. However, contestants should be prepared to perform components in all areas. Prior to the competition, the technical committee may determine which standards and competencies contestants will be perform for the virtual contests. The technical committee will determine if additional information is needed for contestants prior to the competition. These changes will be posted on the SkillsUSA Championships contest update website at: <http://updates.skillsusa.org>.

### C 1.0 — Read blueprints and specifications by interpreting dimensions and specifications, as well as door, window and finish schedules while understanding common blueprint abbreviations and symbols

- 1.1 Interpret and determine dimensions from multiple view drawings and build the project from plans, elevations, sections and details
- 1.2 Interpret specifications and drawing notes by verbally demonstrating how specifications are used
- 1.3 Identify plot plan information such as reference points and bench marks by locating the reference point; using Pythagorean theorem, a level and square, the participant can lay out building as drawn on the plot plan
- 1.4 Interpret oral and written changes, and incorporate modifications into existing plans
- 1.5 Understand common abbreviations and symbols, and verbally describe all

common blueprint abbreviations and symbols on competition blueprints

- 1.6 Interpret door, window and finish schedules by describing location, quantity and type of materials

### C 2.0 — Organize building site/materials in a safe and sequential manner while using builder's level and transit properly

- 2.1 Use builder's level and transit properly for layout and elevation
- 2.2 Identify, receive and inspect materials and ensure all required materials are in place prior to start of competition by using material lists supplied
- 2.3 Store lumber and other materials properly by type and use in a safe and sequential manner

### C 3.0 — Build foundations and forms including the construction and alignment of footing forms, wall and wall forms, and column and pier forms

- 3.1 Construct and align various footing forms to include keyways, bulkheads, dowels and anchorages, as per plans
- 3.2 Construct and align foundation wall and wall forms to include pilasters and beam pockets
- 3.3 Construct and align column and pier forms
- 3.4 Maintain form materials properly

### C 4.0 — Construct rough framing by identifying and selecting framing members, and installing frame components while meeting OSHA standards

- 4.1 Identify framing members and select materials for project
- 4.2 Frame and install sill plate, girders, floor joists and bridging
- 4.3 Frame floor
- 4.4 Install sub-floor
- 4.5 Build or erect safe scaffolding to meet OSHA standards
- 4.6 Frame and brace walls to include corners, openings, trimmers, cripples, partitions, plumbing partitions, fixture backing and sheathing
- 4.7 Frame stair stringer and other components

**C 5.0 — Construct roof framing by determining rafter lengths, making calculations, laying out a plan, framing and installing roof sheathing**

- 5.1 Identify types and components of roof construction and verbally describe all typical components of roof construction identified on the competition project blueprint
- 5.2 Determine rafter lengths from a rafter scale
- 5.3 Calculate and use the rise and run of a common roof
- 5.4 Lay out a common roof plan
- 5.5 Lay out, cut and install common rafters, ridge board, collar ties, gambrel rafters, valley rafters, valley jack rafters, tail rafters, hip rafters, hip jack rafters and cripple jack rafters
- 5.6 Frame roof openings, dormers and saddles
- 5.7 Lay out, cut and install roof trusses (purling)
- 5.8 Install roof sheathing

**C 6.0 — Construct exterior finish by installing frames, corner boards, moldings, cornices, siding and shingles as per industry standards**

- 6.1 Install window and doorframes as per competition project blueprint and manufacturer's standards
- 6.2 Measure, cut and install trim for window and door frames
- 6.3 Install corner boards, moldings or metal/vinyl corners within  $\frac{1}{8}$ "
- 6.4 Install wood, bevel, sheet and lap siding and aluminum or vinyl siding as per competition project blueprint and manufacturer's recommendations
- 6.5 Install wood shingles and miter corners as per industry standards
- 6.6 Install exterior finish rake, open cornice and box cornice as per competition project blueprint

**C 7.0 — Construct interior finish while measuring and cutting materials, fitting and hanging doors and trim, constructing closets and installing crown moldings**

- 7.1 Measure, cut and install gypsum board to meet blueprint specs and industry standards
- 7.2 Cut and install paneling while trimming to fit in prescribed locations

- 7.3 Fit and hang doors and trim to include swinging, sliding, folding and pocket doors to industry and manufacturers' standards
- 7.4 Construct closets and built-in units and install accessories as per competition blueprint specs and manufacturers' recommendations
- 7.5 Cut and install crown molding or other moldings within  $\frac{1}{16}$ "

**C 8.0 — Build stairs by laying out stringer and stringer sets, calculating rise, run and tread cutting and installing stair treads and stair skirts**

- 8.1 Lay out a straight run stringer and a two-flight stringer set with landing using a carpenter square
- 8.2 Calculate rise, run and tread width within  $\frac{1}{16}$ "
- 8.3 Cut and install stair treads and stair skirt within a  $\frac{1}{8}$ " variable

**C 9.0 — Identify lumber by writing a requisition for ordering lumber**

- 9.1 Match letters designating uses in plywood or composition board to their current application
- 9.2 Match at least two examples each of common hardwoods and softwoods to their uses
- 9.3 Identify types of trim and moldings, and describe use
- 9.4 Identify common defects in lumber
- 9.5 Write a requisition for ordering lumber based on a given material list
- 9.6 Calculate board feet using the standard formula (No. of pieces x thickness in inches x width in inches x length in feet  $\div 12$  = board feet)

**C 10.0 — Using and maintaining tools safely per manufacturers' recommendations**

- 10.1 Inspect and properly use hand tools as per manufacturers' recommendations. Hand tools from the following list: sliding T-bevel, tape measure, combination square/speed square coping saw, keyhole saw, folding rule, hammer, punch, hand saw, nail set, wood chisel, carpenter's level, and framing square
- 10.2 Inspect and properly operate power tools as per manufacturers' recommendations.

Power tools from the following list:  
reciprocating (jig saw), miter saw, hand  
drill, belt sander, circular saw, sabre saw,  
table saw, finish sander, and hand router

### Committee Identified Academic Skills

The technical committee has identified that the following academic skills are embedded in this contest.

#### Math Skills

- Use fractions to solve practical problems.
- Use proportions and ratios to solve practical problems.
- Measure angles.
- Find surface area and perimeter of two-dimensional objects.
- Apply transformations (rotate or turn, reflect or flip, translate or slide, and dilate or scale) to geometric figures.
- Construct three-dimensional models.
- Apply Pythagorean Theorem.
- Make comparisons, predictions and inferences using graphs and charts.
- Find slope of a line.
- Solve practical problems involving complementary, supplementary and congruent angles.
- Solve problems involving symmetry and transformation.

#### Science Skills

- Use knowledge of work, force, mechanical advantage, efficiency and power.
- Use knowledge of simple machines, compound machines, powered vehicles, rockets and restraining devices.

#### Language Arts Skills

- Provide information in conversations and in group discussions.
- Provide information in oral presentations.
- Demonstrate use of such nonverbal communication skills as eye contact, posture and gestures using interviewing techniques to gain information.
- Demonstrate comprehension of a variety of informational texts.
- Use text structures to aid comprehension.
- Identify words and phrases that signal an author's organizational pattern to aid comprehension.

- Understand source, viewpoint, and purpose of texts.

### Connections to National Standards

State-level academic curriculum specialists identified the following connections to national academic standards.

#### Math Standards

- Numbers and operations.
- Geometry.
- Measurement.
- Data analysis and probability.
- Problem solving.
- Communication.
- Connections.
- Representation.

**Source:** NCTM Principles and Standards for School Mathematics. For more information, visit: <http://www.nctm.org>.

#### Science Standards

- Understands the structure and function of cells and organisms.
- Understands relationships among organisms and their physical environment.
- Understands the sources and properties of energy.
- Understands forces and motion.
- Understands the nature of scientific inquiry.

**Source:** McREL compendium of national science standards. To view and search the compendium, visit: [www2.mcREL.org/compendium/browse.asp](http://www2.mcREL.org/compendium/browse.asp).

#### Language Arts Standards

- Students adjust their use of spoken, written, and visual language (e.g., conventions, style, vocabulary) to communicate effectively with a variety of audiences and for different purposes.
- Students use a variety of technological and information resources (e.g., libraries, databases, computer networks, video) to gather and synthesize information and to create and communicate knowledge.

**Source:** IRA/NCTE Standards for the English Language Arts. To view the standards, visit: [www.ncte.org/standards](http://www.ncte.org/standards).





# **CLOTHING CLASSIFICATIONS**

**With Photos**

## **Class A: SkillsUSA Attire:**

- Red SkillsUSA blazer, windbreaker or sweater, or black or red SkillsUSA jacket.
- Button-up, collared, white dress shirt (accompanied by a plain, solid black tie), white blouse (collarless or small-collared) or white turtleneck, with any collar not to extend into the lapel area or the blazer, sweater, windbreaker or jacket.
- Black dress slacks (accompanied by black dress socks or black or skin-tone seamless hose) or black dress skirt (knee-length, accompanied by black or skin-tone seamless hose).
- Black dress shoes.



## **Class B: Healthcare Attire**

- Official blue scrubs.
- Scrubs should fit appropriately for all health contests and should be properly hemmed and wrinkle free. Only plain, white, collarless T-shirts may be worn underneath the scrubs. Hair must be pinned up and off the collar.
- White socks or skin-tone seamless hose.
- Health-professionals white or black leather work shoes.
- Shoes must be all-white or black leather (no canvas), completely enclosed (no open-toe or open-heel). Athletic-style shoes that meet the criteria are acceptable.



## **Class C: Contest Specific — Manufacturing/Construction Khaki Attire**

- Official SkillsUSA khaki short-sleeve work shirt and pants.
- Black, brown or tan leather work shoes.

**Note:** Safety glasses must have side shields or goggles (prescription glasses may be used only if they are equipped with side shields. If not, they must be covered with goggles).



## **Class D: Contest Specific — Blue Attire**

- Official SkillsUSA light blue work shirt.
- Navy pants.
- Black, brown or tan leather work safety shoes (with protective toe cap).

**Note:** Safety glasses with side shields or goggles (prescription glasses may be used only if they are equipped with side shields. If not, they must be covered with goggles).



## **Class E: Contest specific — Business Casual**

- Official SkillsUSA white polo shirt.
- Black dress slacks (accompanied by black dress socks or black or skin-tone seamless hose) or black dress skirt (knee-length, accompanied by black or skin-tone seamless hose).
- Black leather closed-toe dress shoes.



## **Class F: Contest Specific — Cosmetology**

- Official SkillsUSA white dress shirt.
- Black dress slacks.
- Black socks or black or skin-tone seamless hose.
- Black leather work or dress shoes.

**Note:** The Official SkillsUSA white cosmetology smock or apron can be worn with the white dress shirt.





## **Class G: Culinary/Commercial Baking Attire**

- White or black work pants or black-and-white checkered chef's pants.\*
- White chef's jacket.
- White or black leather work shoes (non-slip).
- White apron.
- White neckerchief.
- Side-towels.
- Hairnet.

**Note:** Chef's hats (toques) will be supplied by the national technical committee, as well as food handlers' gloves.

**\* *Black-and-white checkered chef's pants not available through the SkillsUSA Store.***





## Class H: Contest Specific — Restaurant Service

- Official SkillsUSA white long-sleeved dress shirt, or long- sleeved plain white collared shirt.
- Black dress slacks (accompanied by black dress socks or black or skin-tone seamless hose) or black dress skirt (knee-length) (accompanied by black or skin-tone seamless hose).
- Plain black tie with no pattern or SkillsUSA black tie.
- Black socks.
- Shined black leather work shoes or black flat heels.

**Note:** Bistro aprons are the official apron for Restaurant Service and are required. Waiter's jackets, bow ties, vests, cummerbunds or half aprons are not permitted.



## **Class I: Contest Specific — Welding/Welding Fabrication**

- Official SkillsUSA khaki work shirt and pants (both the pants and shirt must be 100% cotton).
- Black, brown, or tan leather work shoes.

**Note:** Safety glasses with side shields or goggles (prescription glasses may be used only if they are equipped with side shields. If not, they must be covered with goggles).



## SkillsUSA Scoring Rubric

### Virtual Championships

Contestant #		
Skills	Possible Points	Points Earned
Resume	100	
Portfolio (Written Submission)	100	
Video (Skills Demonstration/Narration)	200	
Oral Interview/Role Play	100	
<b>Penalties</b>		
Clothing	-50	
Resume	-100	
Total Score		

**Judges Notes:**

## Resume Scoring Rubric

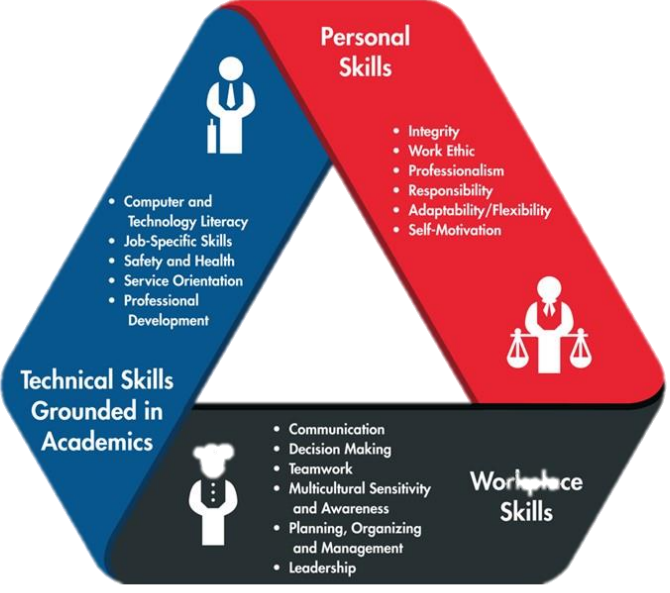
Category	Points	
<b>Personal Information:</b> Name, address, city, state, zip, phone & email	10	
<b>Skills:</b> Workplace, Technical, Personal *See Framework	20	
<b>Education:</b> High school, technical school, dual- enrollment	20	
<b>Employment:</b> And/or volunteer work or list NA	10	
<b>Activities, Awards and Honors:</b> Should include SkillsUSA membership/activities	20	
<b>References:</b> Or references available upon request	10	
<b>Spelling, Punctuation &amp; Grammar</b>	10	
<b>More than one page</b>	-10	

## NEW for 2021

You must include the link(s) to your digital documents and/or videos in your resume and save as a PDF.

### Directions:

**Step 1:** Record your video submission using a digital platform like Zoom

**Step 2:** Open Google Drive or One Drive and upload your Zoom file

**Step 3:** Right click on your Zoom file and select "get link". **Remove Restrictions** so anyone with the link can access your file

**Step 4:** Copy that link and paste it into the bottom of your resume

**Step 5:** If your contest requires a written submission, repeat the process of uploading your document to your Google Drive or One Drive, and then copy the link and paste into your resume

**Step 6:** Once your resume is complete, click File, Save As, and scroll down to select PDF, then Save

Click [Here](#) to view a sample resume with embedded links