



MAILING & OFFICE SOLUTIONS

Product Guide

OFFICE SOLUTIONS DESKTOP BINDERS SERVICE SUPPORT PAPER DRILLS & STAPLERS LARGE FORMAT LARGE FORMAT PRINTERS ADDRESS PRINTERS COMMERCIAL BINDERS PRINT FINISHING DESKTOP LAMINATORS SUPPLIES & CONSUMABLES FINANCE GUILLOTINES FOLDING MACHINES COLLATORS & BOOKLET MAKERS WIDE FORMAT LAMINATORS LARGE FORMAT FINISHING SLITTERS, CUTTERS, CREASERS MAILING SOLUTIONS CELLOGLAZERS SHIPPING SOLUTIONS FOLDER & INSERTERS PAYMENT SOLUTIONS DIGITAL

NEOPOST AROUND THE WORLD

Neopost is a global leader in tailor-made business solutions for the postal, parcel and related digital world of tomorrow. Whether you run a small company or employ thousands of people around the world, you need fast, fluid solutions that save time and money while helping you make the most of business opportunities.

Our solutions bring together our proven technologies with the latest high-tech and intuitive solutions, allowing you to stay agile and competitive. Neopost is aware of the need for constant innovation and is strongly committed to the ethics of sustainable development. For advice and support you can depend on our global commitment to supplying first-class service, whether on the phone, onsite or online.

With a direct presence in 31 countries and partners in more than 90 countries worldwide, Neopost's 6,200 employees are skilled professionals who support their customers locally at every stage of their project.

Find out more at www.neopost.com

NEOPOST AUSTRALIA

At a local level, Neopost Australia has been supporting Australian businesses for over 60 years. Our specialists span the country offering innovative market leading solutions. **Find out more at www.neopost.com.au**

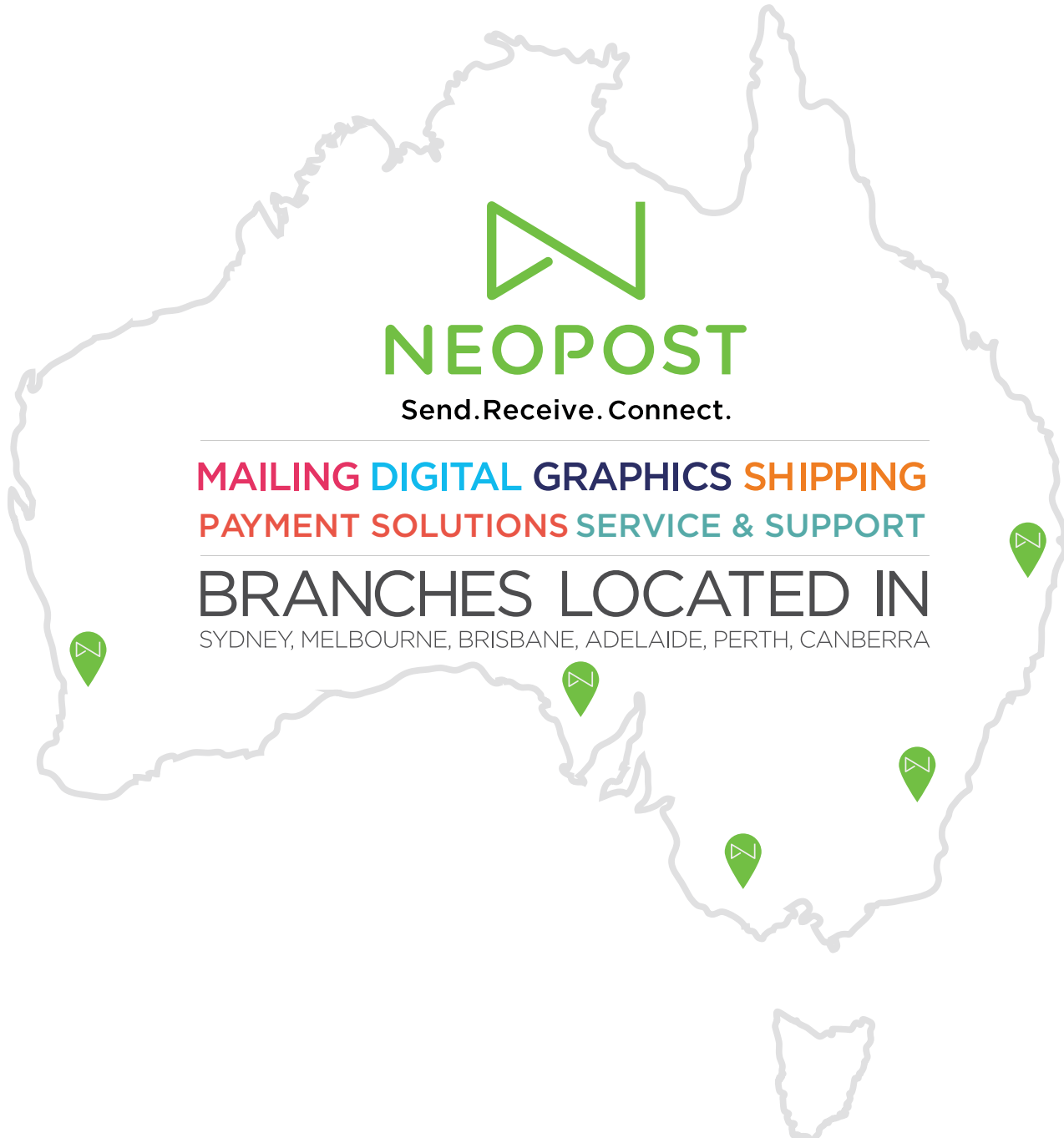

GROW YOUR BUSINESS USING NEOPOST SOLUTIONS



MAILING SOLUTIONS

Neopost provides state-of-the-art systems that efficiently streamline postage processes, accurately weigh mail pieces, quickly open envelopes and efficiently sort and archive business critical information.

Our Mailing Solutions are driven by proven technology, helping companies, as well as enterprises, increase productivity and customer satisfaction.



GRAPHICS SOLUTIONS

Offering an extensive range of global market brands in Print & Finishing Solutions, we have a product or solution to help you Print, Bind, Laminate, Fold, Trim, Cut, Shred and more.

We cater for all customers including individuals, schools, Government bodies, small-medium businesses, large corporations and production enterprises.



DIGITAL SOLUTIONS

Our document management software and data quality and analytics solutions ensure you deliver the right message to the right person through the right channel media.

You can also tailor content to your recipient's specific needs. This means you can control the communication process, cut costs and improve customer satisfaction.



SHIPPING SOLUTIONS

We help you streamline your shipping process and improve customer satisfaction. Our tracking solutions update you on delivery status, inventory and equipment, giving you total supply chain visibility.

POSTAGE METERS - FRANKING MACHINES



Neopost IS-280e Postage Meter

The Neopost IS-280e is the perfect postage meter for up and coming businesses, offering sophisticated features in a compact package. No more queuing at the Post Office. No more guessing the correct postage. No more running out of stamps. The Neopost IS-280e can be re-credited online with postage 24 hours a day, 365 days a year.

» Up to 18 letters /minute



Neopost iX-5 HF Postage Meter

Get the job done with accuracy and speed. The Neopost iX-5 HF is ideal for dynamic business environments, delivering fast and friendly operations, which are reliable and very easy to use. With state-of-the-art technology and online services under your control, you'll be sure to have the best-in-class solution to meet your requirements.

» Up to 70 letters /minute



Neopost iX-3 Postage Meter

Growing businesses count on smart productivity tools to keep their offices running smoothly. The Neopost iX-3 is a desktop powerhouse that makes it simple to weigh, rate, post and track your mail with accuracy. Easy to operate and convenient to use, the highly capable IS-350e with whisper-quiet operation is designed to intergrate smoothly into your office environment and process mail efficiently.

» Up to 45 letters /minute



Neopost IS-6000e Postage Meter

The Neopost IS-6000e has set a new standard for mailing system productivity, operability and efficiency. Neopost observed high volume mailing machine operators and listened to high volume mail customers to help it design the next generation mailing system. The IS-6000e delivers simple ergonomic operations, investment protection, cost savings, reliable production and maximum uptime. Coupled with the new internet connection and powerful integrated software solutions for postal management, the IS-6000e is the right choice if you are looking for a high volume mail postage meter.

» Up to 300 letters /minute



MyNeopost

MyNeopost is a unique online application that provides instant access to all of the services and supplies you need to realise the full potential of you Mailing System. MyNeopost is suited for any size mail room - from small offices to multi-site organisations.

MyNeopost delivers easy-to-use, cost effective iMeter™ Apps right from your browser, helping you manage your mailing operations with confidence. Manage, report, diagnose, control and purchase supplies through a single online tool - it's all right at your fingertips.

POSTAGE METERS - FRANKING MACHINES



Neopost iX-5 AF Postage Meter

Thriving businesses count on reliable processes that add value and streamline performance. The iX-5 delivers practical solutions that offer maximum versatility to give the results you need.

Easy to operate and convenient to use, the highly capable iX-5 with whisper-quiet operation is fast and efficient. You'll appreciate the sleek ergonomic design, saving you space and easily integrates into your business environment.

» Up to 110 letters /minute



Neopost iX-7 Postage Meter

Dynamic businesses count on smart productivity tools to do more than simply move the mail. The iX-7 takes mail processing to a new level of intelligence and delivers productivity at its smartest using advanced accounting options.

Built with a colour touch screen display for easy and intuitive navigation, the iX-7 can hold up to can hold up to 500 different accounts for departmental use.

» Up to 150 letters /minute

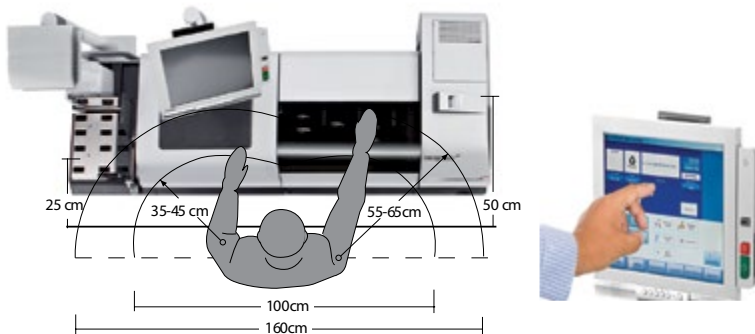

SIMPLE, ERGONOMIC OPERATIONS

The IS-6000 has been designed with the operator in mind. At first glance, you will notice all mailing operations are controlled from the same area, creating the ideal ergonomic workspace. This system's modular and flexible design allows operators to adjust and place components within arms reach, minimizing the range of motion, ensuring optimal workflow and comfort.



I-Weigh Dynamic Scale

The Neopost I-Weigh makes mail processing simple and accurate for every business, whether your volumes are 100 or 1,000 a day. Checks weight while in motion to calculate the correct postal rate. Simply drop in the mixed weight envelopes and press 'Start'. The scale can run up to 7,500 items per hour, making it one of the fastest in the market.



IBI Lite

Enhance the professional look of your organization. You can easily customise your mail message to include your company name, special greetings or marketing slogans to reinforce your communication to your customers. Your imprint will be sharp and fully postal compliant, printed in the latest technology, the smaller IBI Lite, 2-D barcode.

FOLDING & INSERTING MACHINES



Duplo DF-755 High Speed Paper Folder

For any organisation demanding a reliable, easy to use, high-speed paper folder, the Duplo DF-755 provides an ideal solution.

Manual-setting functionality gives user control of selecting fold types, adjustable knobs enable the user to make minor adjustments to fold increments to achieve the desired fold.

» Fold up to 120 sheets /minute



Duplo DF-777 High Speed Paper Folder

Duplo's DF-777 is the most reliable entry level folder in the market with a speed of 120 sheets per minute. It is specially designed to cater the low volume folding needs of the office type environment.

The DF-777 folds a variety of paper types and sizes in a quick and efficient manner.

» Fold up to 120 sheets /minute



Neopost DS-35

Folder & Inserter

Did you know it costs about 10¢ to fill an envelope by hand? This is costly, time consuming and negatively affects your company.

The DS-35 is handy and compact, which can suit any office environment to improve workplace efficiency, making it an invaluable solution to help manage your outgoing mail.

» Insert up to 1,350 envelopes /hr



Neopost DS-63

Folder & Inserter

The DS-63 saves you time and money by being able to quickly and automatically process all standard mail services, as well as, direct marketing applications.

Combined with our mail management software featuring grouping, sorting and splitting capabilities, the DS-63 will not only optimise your mail flow but also contribute to significant cost savings.

» Insert up to 2,200 envelopes /hr



Neopost DS-75i

Folder & Inserter

Productivity made easy. Are you working in an environment where mail matters and response time is key? With its compact footprint, large loading and unloading capabilities and many enhanced features, usually available only on larger systems, the DS-75i brings you the highest level of convenience, productivity and versatility.

» Insert up to 3,600 envelopes /hr



MPPC Mail Piece Production Control

Assurance that jobs are accurate and complete.

Are you sure that your printed jobs are actually being mailed? Due to the fact that your business depends on a secure mail process, Neopost has developed the perfect solution.

Mail Piece Production Control builds an audit trail for each production job. This provides you with real-time quality control and detailed line-item reports.



Neopost DS-85

Folder & Inserter

High productivity folding and inserting machine. The DS-85 is just right for your business. Whatever the application your business comes across, the DS-85 handles them all. From invoices and newsletters to mail outs and other promotional or marketing needs. The DS-85 is highly flexible and can accommodate up to six document feeders.

» Insert up to 4,000 envelopes /hr



Neopost DS-90i

Folder & Inserter

When it comes to meeting the demanding needs of your mail center operations, the DS-90i folder inserter offers versatility and the ability to process the widest range of business applications with ease. From traditional business correspondence to unique document combinations, the DS-90i includes features to ensure each recipient receives the correct document.

» Insert up to 4,300 envelopes /hr

Ask about OMS software!

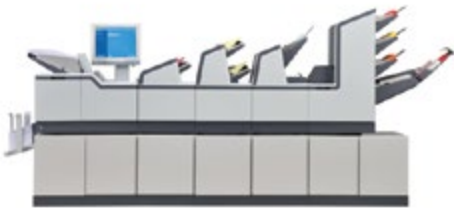

Neopost DS-180i

Folder & Inserter

The DS-180i is a high volume folder inserter enabling you to easily create professional, top-quality mail pieces. The system is modular and can be easily configured to adapt and suit your needs. Accommodates a wide range of envelope sizes. The ability to handle a superior document packet thickness (6mm), allows you to process a wide variety of mail items with ease.

» Up to 5,500 envelopes /hr (DS-180i)



Neopost DS-200i

Folder & Inserter

Versatile, modular, productive, easy to use. Introducing a new standard in production mail, the DLX to C4 capable DS-200i letter folder and inserter. It can handle a wide range of applications, designed to run a variety of jobs which can be configured with ease, the DS-200i fits perfectly into any mid-high level production environment.

» Insert up to 4,800 envelopes /hr



Neopost DS-600i

Folder & Inserter

The DS-600i has been designed to maximise ease of use, efficiency and accuracy in this ever changing world.

The modular design, High-Capacity feeders, intuitive Touch-Screen operation and output processing options mean there's a configuration to suit the needs of every organisation.

» Insert up to 6,000 envelopes /hr



Neopost DS-1200 Folder & Inserter

Intelligent, high-performance inserting system that streamlines your mail processing. The DS-1200 is designed to operate at the highest practical speed and efficiency - streamlining the entire mailing process, from input to throughput to output, even during peak or rush times. The high-capacity sheet feeder and vertical envelope reception stacker enables you to maintain the highest level of operational productivity even for your more demanding mail processing jobs.

» Insert up to 12,000 envelopes /hr

ADDRESSING SYSTEMS



Neopost AS-520C

Envelope & Address Printer

Entry level, full process colour address printer. The AS-520C is a user friendly system that prints full process photo quality colour, making it perfect for low volume mailing with high impact.

- » Print up to 4,000 DL envelopes /hour
- » Colour Printer



Neopost AS-710

Envelope & Address Printer

The versatile address, barcode & graphics printing solution. The AS-710 addressing system will make your mailings look more professional by giving you the ability to print addresses, logos, barcodes and graphics almost anywhere on the mail piece.

- » Print up to 14,000 DL envelopes /hour
- » Monochrome Printer

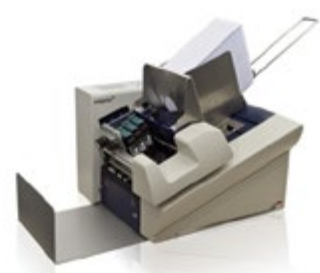

Neopost AS-930

Envelope & Address Printer

Project a professional appearance with all of your mailing. The fixed head AS-930 addressing system prints 600x600 dots per inch patented HP printing technology giving you sharp, crisp, more easily readable addresses.

- » Print up to 27,000 DL envelopes /hour
- » Monochrome Printer



Neopost AS-970C

Envelope & Address Printer

Featuring the newest digital printing technology available, the AS-970C is a full process colour printer that is powered by 1600 x 1600 dpi Memjet Technology and can print materials up to 240mm wide by 430mm long at high speed. This incredible technology can also print edge-to-edge on materials up to 215mm wide.

- » Print up to 7,500 DL envelopes /hour
- » Colour Printer



Neopost AS-3060

Envelope & Address Printer

A heavy-duty, high volume address printer with automatic head positioning, the AS-3060 works as either a standalone address printing solution or in-line with other mail processing equipment such as a folder inserter or a postage meter. With six print heads capable of high quality 600 dpi, this printer can easily meet your addressing needs.

- » Print up to 39,000 DL envelopes /hour
- » Monochrome Printer

SOFTWARE SOLUTIONS



FlexMail Address Management

FlexMail lets you connect to your data, design any mail piece, merge/purge and de-duplicate files, make changes to a mailing list, clean and validate the address and sort mailings to meet postal requirements.

Flexmail greatly enhances and streamlines your address printing process.



DMS POSTman Address Validation

Designed specifically with the needs of small businesses in mind, POSTman is an easy to use solution that saves valuable time spent sending and processing returned mail and ultimately reduces the cost of your postage. POSTman accurately validates records and appends Australia Post-approved barcodes from its built in database of over 12 million addresses.



Neopost IM-16 Letter Opener

The Neopost IM-16 letter opener can operate at speeds of up to 300 letters per minute, so opened mail is delivered faster. Easy to use and ultra reliable, it can handle mixed mail without pre-sorting, and opens a wide range of envelope sizes. Its efficiency gives your staff more time to concentrate on more productive work.

» Open up to 300 envelopes /min



OPEX-2112 Letter Opener

For medium-sized mail processing operations. The Model 2112 offers proven technology for both offices and small mail-opening centres. This tabletop unit provides mail room automation for low volumes of incoming mail, and it is equipped with the same milling cutter technology as the higher speed Model 306.

» Open up to 400 envelopes /min



OPEX Model 306 Letter Opener

Equipped with Opex's unique high-speed milling cutter technology, the model 306 offers durable performance for small mail-opening operations. Opex's unique milling cutter produces a soft, feathered edge, providing content security. The Model 306 is ideal for mixed sizes of mail including large letters, as well as, oversized and thicker than normal envelopes.

» Open up to 670 envelopes /min



OPEX Falcon™ Mail Document Scanner

The all-new Falcon™ combines Opex's innovative one step drop feed scanning with the performance of a high-capacity production scanner, providing the only universal document scanning workstation on the market. Regardless of your document scanning needs, the Falcon is designed to meet the most difficult and daunting workflow challenges.

» Scan up to 110 pages /minute



OPEX M-72 Rapid Extraction Desk

Offering speed, efficiency and automatic adjustments to handle a variety of intermixed mail. The advanced design of the Opex Model 72 provides high-precision control for semi-automatic mail extraction, including fine adjustment settings for accurate cutting. Advanced ergonomic features include workstation hydraulics to adjust the work surface height, convenient desktop, customized soft configurations and easy accessibility.

» Extract up to 60 mail pieces /min



OPEX FalconRED™ Mail Extraction & Scanner

The OPEX FalconRED™ can scan mail as soon as it is opened - in a single pass. Engineered as a high-speed colour scanner with a unique drop feeder integrated into an Opex Rapid Extraction Desk. By combining mail extraction with image capture it is no longer necessary to route paper outside of the mail room to be processed. In just one step the OPEX FalconRED™ operator can open, extract, identify, scan, orient, sort, print an audit trail and output mail contents.

» Open & Scan up to 110 pages /minute

OMS-200

BY NEOPOST

Neopost OMS-200

Output Management Software

Get the best from your Folder & Inserter with this flexible web-based solution. Neopost's OMS-200 Output Management Software simplifies and automates the document creation process. Barcodes or OMR marks are added easily to your documents through an intuitive interface to ensure your documents reach their intended recipients. The same technology directs the system to collate, fold, insert and seal your communications using Neopost's wide range Folding & Inserting machines.

OMS-500

BY NEOPOST

Neopost OMS-500

Multichannel Communications Software

Today, large organizations and small and medium-sized businesses operate under competitive and economic pressure to improve customer experience while cutting costs and increasing efficiency. Neopost's OMS-500 enables you to face these challenges.

Whether you have a centralized production center or many distribution facilities, the OMS-500 gives you complete control over your customer communications processes. Create enriched, personalized and secure documents and deliver them to the right person, at the right time, through their preferred channel.



PSI: CAPTURE

PSI: Capture Enterprise

Advanced Document Capture & Management Software

Document Capture and Scanning is a challenge in any organization. With an array of scanning devices, capture needs and backend content management systems, it is ineffective to settle for multiple applications to accomplish one goal.

PSI: Capture provides a single capture platform that can meet all the needs of an organization: document scanning and import, forms processing, data capture, OCR/ICR, data extraction and the ability to migrate the information into a document repository. PSICapture advanced capture system enhances the capabilities of any scanning device, providing a powerful onramp to any Enterprise Content Management (ECM) or Document Management Systems (DMS).

FileBound Workflow

Document & Workflow Automation Software

FileBound is a cloud-native, end-to-end application that manages workflow throughout enterprises of all sizes. By focusing on the needs of today's knowledge worker, FileBound delivers document and workflow automation that is easy to implement, configure, use and modify. FileBound's automation capabilities increase productivity, shorten cycle times, improve compliance and control critical corporate content.

FileBound's secure content repository centralises documents and metadata from nearly any source and has all the components necessary to build a complete automation solution at a single cost.





SHIPPING SOLUTIONS

From shipment booking to the retrieval of proof of delivery over the internet, through parcel tracking, management of returns, online archiving of shipping documents and transportation monitoring.

Our specialised Neopost ID teams located in Europe and in the USA design, project manage and implement for each customer a high-performance customised solution based on a range of state-of-the-art products and services.

Neopost ID offers a comprehensive range of shipping stations. Online or Offline adapted to the different goods transportation sectors - messenger services, express, single parcel, etc. Whether you are a carrier or a shipper, we offer the turnkey solution that fulfils your requirement and enables you to manage all of your shipments optimally, reliably, and professionally.

Automatic or **manual** shipment entry.

Generate parcel and shipment document labels in the size specified by the carrier. Manage electronic data exchanges between shippers and carriers, including payment processing. Archiving and reporting functionality, and direct access to tracing and proof of delivery, roll-out, installation, training, and hotline assistance, as well as onsite maintenance.



RFID SOLUTIONS

Neopost is a leader in RFID solutions, working with major carriers like DHL, Kuhne&Nagel and STG, we have provided integrated high performance RFID solutions in asset, stock and pallet, and parcel management.

Independent **RFID** expertise:

- Technology optimisation
- Systems definition, development and deployment
- Solutions implementation
- Service hosting and online solutions
- Risk management
- Responsive and flexible partner



POSTAGE METERS MAIL SOFTWARE BULK MAIL
BUSINESS MAIL WORKFLOW SOFTWARE OUTPUT MANAGEMENT **FOLDER INSERTER**
POSTAL SOLUTIONS DIGITAL MAIL MAILING SOLUTIONS **PAYMENT SOLUTIONS**
 CUSTOMER COMMUNICATION SOFTWARE **ENVELOPE PRINTER** **DOCUMENT SCANNING**
ADDRESS PRINTER **FOLDING MACHINE** ADDRESS VALIDATION MULTICHANNEL
SERVICE ARCHIVING MAIL EXTRACTION DELIVERY **WORKFLOW SCANNING**
SUPPORT **LETTER OPENERS** MULTI-CHANNEL MAILING SOLUTIONS **FINANCE**
 POSTAGE DISCOUNTS **FRANKING MACHINE**

Our Service Promise

At Neopost, we believe that our customers deserve more than just a great piece of equipment. That's why when you choose to work with Neopost you partner with a company that prides itself on customer service and attitude to customer support. No matter what solution you choose from Neopost, we guarantee that it will come with an exceptional level of service and support.

You see, we believe that if you are a happy customer, you're a loyal customer. We know that offering you the best service in the business is good for business. We know that our success depends on keeping you satisfied. That's why we're committed to providing you with an outstanding level of service each and every time.



This is how we guarantee to deliver on our promise to you:

Nationwide Account Managers

Wherever you are in Australia, we have an experienced, knowledgeable and professional account manager that will help you find the products and solutions that are perfect for your business.

Local Service Engineers

Partner with Neopost and get access to a team of expert service technicians located throughout Australia, with the skills, attitude and experience needed to ensure you get the most from your machine. When your service request requires more than a phone call, one of our expert technicians can be with you quickly to make sure your Neopost machine is running smoothly.

Regular Opening Hours

Our helpdesk is here when you need us. You can speak to a member of the team quickly, anytime from Monday to Friday, 8:00am - 5:30pm AEST.



Our Payment Solutions Offer

We arrange Payment Solutions for many private and public organisations that span SME to global enterprise, across a broad spectrum of industries. Our experience and capacity extends from solutions costing from as little as \$1,000 up to large intricate projects that involve Neopost's world class mailing, printing, presentation & software solutions.



The majority of Neopost customers choose Neopost Payment Solutions rather than purchasing equipment for many reasons:

Cash Flow

Neopost Payment Solutions allow you to invest in the latest technology with no cash outlay requirement.

Convenience & Speed

Minimal paperwork, simple processes and flexible repayment options. We tailor programs to suit our customers quickly and easily, and most of the time a program is approved and implemented the same day.

Full Service Solutions

When you use Neopost Payment Solutions all costs are included within the program. Service & maintenance, training, installation & delivery charges are all included in the standard program.

Tax & Accounting Benefits

Neopost Finance runs its programs on a rental (or operating lease) platform which ensures that all payments are 100% tax deductible providing the technology is used for business purposes. Payments are fixed and normally appear as an expense on the profit & loss statement only therefore no balance sheet depreciation of the equipment is required.

Equipment Life Cycle & Technology Management

All industries demand ongoing technology improvements. Neopost Payment Solutions are designed to allow for regular technology reviews in order to reduce obsolescence thus future proofing equipment investment in your business.



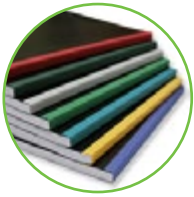

Fastback Innovative

Choose from three different strip widths to bind any document quickly and effectively. Strips are available in black, white, dark blue, purple, maroon, red and dark green; in narrow, medium and wide.

Capacity: 300+ sheets



CombBind Resilient & Affordable

Our most conventional and affordable binding option in a 20 and 21 ring format. The spine lets pages lie flat, and you can easily make edits. CombBind spines are available in black, white, clear, blue and red; in diameters from 6mm to 51mm.

Capacity: 400+ sheets



SpiralCoil Flexible & Stylish

For a professional appearance, this is your spine. SpiralCoil keeps its shape with bounce-back flexibility. The spine lets pages lie flat for 360° rotation. Coil spines are available in black, white, clear, navy and silver; in diameters from 6mm to 33mm.

Capacity: 275 sheets



WireBind Contemporary Look

This high-tech spine takes any presentation to the next level. It lets pages lie flat for 360° rotation. Wire bound spines are available in black, white, blue, red, bronze and silver; in diameters from 6.3mm to 32mm.

Capacity: 210 sheets

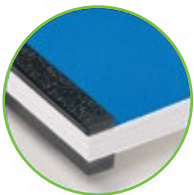

SureBind Sleek & Secure

Get a smooth, book-like finish with this binding option. Lock in place, and great for filing, stacking and mailing. SureBind spines are available in black, white, navy and burgundy; in diameters from 25mm to 75mm.

Capacity: 750 sheets



Opus Metal Channel Customised Presentation

An innovation in hard cover binding, Opus Metal Channel is a secure and fast binding solution. Suitable for a wide variety of applications, including increasingly popular photobooks. Hardcover books can be customised with hot foil stamping. Metal Channels are available in black, navy, blue and red; in portrait and landscape formats.

Capacity: 300 sheets

*Maximum sheet capacity based on 80gsm and largest binding diameter available.



Fastback 20 Multi-Purpose Thermal Binding

The Fastback 20 is the ideal binding machine for anyone needing a full-featured solution in medium to large quantities. This multi-purpose machine handles tape binding, perfect binding and hard cover book binding. Binds up to 350 sheets in less than 20 secs.



Fastback 9 Compact Thermal Binding

The versatile Fastback 9 is the most compact and affordable binding machine in its class. A powerful machine despite its size, producing finished documents from 10 to 250 sheets. User-friendly interface makes choosing the correct strip settings fast and easy.



CW-4500

Dual Comb & Wire Binder

A powerful, multi-functional dual electric punch and bind system for the complete solution of both plastic comb and twin loop wire. User-friendly edge guide for adjusting the paper format easily. Manual punch, CW-350 also available.



WR-2500

Dual 2:1 & 3:1 Wire Binder

Practical and user-friendly interface, with electrical power. Equipped with two blades for both 2:1 and 3:1 twin loop wire punching. Individual system for punch and bind allows operating separately. Manual punch, WR-200 also available.



Surebind System 1/2

Strip Binding

The ultimate desktop strip binding system, with the ability to bind documents up to 500 sheets. Available in System 1 and System 2 (pictured) models; to suit various requirements of volume and thickness. Edge guides ensure accurate paper alignment. Utilises patented binding strip technology for secure binding.



ATLAS 300

Metal Bind & Foil System

An innovation in hard cover binding and hot foil stamping, specifically designed for the creation of personalised photobooks. Unique Metalbind binding and Goldcover hot stamping system in one, for stylish presentation. Securely bind A5, A4 & A3 books up to 300 pages and foil stamp the book's hardcover.



Opus Easy 120 binder

Channel Binder

The Opus Easy 120 binder is fantastic compact metal binder suitable for small runs of binding documents with a number of Pages (up 120 sheet).

Using the Opus easy 120 Binder takes 10 seconds and can take a variety of binding types; Fully padded cover, Traditional binding (bottom cardboard, PVC top) etc.



Duplo UP-240

Desktop Banding Machine

Bundle finished pieces such as business cards, postcards, and brochures with the UP-240 Desktop Banding Machine. The UP-240 wraps a strip of craft paper or film around the bundle, providing the same security, but at a lower cost, than a box or bag. Capable of banding up to 24 bundles per minute. Max. banding size of 240mm x 180mm (WxH).

BINDING MACHINES



GBC Magnapunch 2.0 Heavy Duty Punch

The higher capacity Magnapunch 2.0 sets the standard in electric binding; featuring revolutionary edge detection technology, eliminating mis-punches. Interchangeable die sets for different punch patterns simply slide in and automatically lock into place.



GBC MP2500ix Interchangeable Die Punch

The GBC MP2500ix is designed for those needing high volume punching with ease of use. Never has there been a punch as versatile as the MP2500ix. Simply slide the die sets in place - no tools or locking levers are required.



GBC PB2600

Plastic Comb Closer

The PB2600 electric comb closer is easy to operate with either the dual foot pedal or table-top button to activate the binding process. User-friendly adjustable binding knob and LED display help to easily set-up your system for each binding job.



GBC TL2900

Twin-Loop Wire Closer

Twin-loop binding has never been easier. The TL2900 presents a revolutionary design, with hassle-free operation. Twin-loop wire bound documents lie completely flat when opened, and pages wrap all the way around for easy handling.



GBC CC2700

Spiral Coil Closer

Produce attractive spiral bound documents with this versatile production system. With its exclusive "Spine Former", adjustable roller knobs and all metal construction, the CC2700 ensures quick, easy and reliable binding.

Duplo



Duplo DBM-150

Perfect Binding Machine

The DBM-150 is the world's smallest fully automatic bookletmaker and trimmer. Equipped with Duplo's superior engineering within a compact footprint. It can produce finish documents either sheet by sheet or set by set. The DBM-150 is designed to meet the challenges of today's offset and digital printer. Duplo has bundled the features of the big bookletmakers into this uniquely compact system.

The DBM-150 can finish wide range of applications. It can handle sheet sizes from 120mm x 210mm to 320mm x 460mm and paper weights from 64gsm to 300gsm.



NeoLam 1500 Desktop Pouch Laminator

Sleek and modern, designed for reliability and ease of use. This hot & cold laminator is capable of laminating up to A3 sheet size and features a 4-roller system, which provides a consistent, even speed to ensure high quality lamination. Includes visual and audible indicators.



NeoLam 3256 Desktop Pouch Laminator

User-friendly and efficient A3 pouch laminator. This 6-roller machine can operate at a speed of up to 1,460mm/minute, and can handle pouch thickness of up to 350mic. Minimal footprint and efficient warm-up time of less than 5 minutes.



GBC Catena 35 Roll Laminator

The Catena 35 roll laminator has been designed to give you the flexibility to laminate, encapsulate and mount; using a variety of hot and pressure sensitive (cold) lamination film. Features pre-set laminating functions with manual override. The perfect finish for your full colour digital output. Maximum laminating width: 330mm.



GBC Docuseal 3100 Roll Laminator

Low cost, high performance hot shoe roll laminator up to 800mm wide. Ideal for laminating posters, drawings, charts, graphs, educational material, plans, pamphlets and signs. Simple to operate, featuring silicon rollers for easy clean up and durability. Easy replacement of film using pre-slotted film shaft.



GBC 3500/4500 Pro Desktop Pouch Laminator

Transform simple pieces into special presentations with the GBC 3500/4500 laminators. The GBC 3500 laminates up to A3, while the GBC 4500 will laminate documents up to A2 size. Features adjustable speed and temperature control for bubble-free lamination.

Laminating Film Supplies

Neopost supplies a variety of lamination films ranging from laminating pouches in various sizes up to A3, roll laminates, large format hot & cold laminating films, as well as, celloglazing films.

EBA



EBA 4300M Desktop Guillotine

Extremely safe, manual desktop office guillotine with 430mm cutting length and 20mm cutting height. Hinged, transparent safety guard on the front table. Fast flick action clamp provides optimal clamp pressure. Side lay, lockable back gauge and measuring scale (mm/inches).



EBA 4305M Manual Guillotine

Solid all-metal construction, blade from high quality steel. 430mm cutting length for formats up to A3, and 435mm insertion depth. Backgauge and side lays allow for precise alignment of the paper stack for exact cutting. Safety guard locks in position while cutting.



EBA 5255 Electric Guillotine

Convenient & powerful cutting with electro-mechanical blade and clamp drive. Designed with an emphasis on safety and ergonomic use for effortless and fatigue-free operation. Optical cutting line with bright and durable LEDs for accurate cuts.



PC-360
Manual Creaser

The PC-360 is easy to operate and maintain, making it an ideal component in the binding process. Features durable steel upper and lower creasing moulds, that do not require replacement as often as rubber moulds. Maximum creasing width of 360mm, and paper thickness of 450gsm.



Duplo DF-980
Desktop Paper Folder

The fastest and quietest table-top folding solution in the market today, with a top speed of 260 sheets per minute. User-friendliness is key with functions like automatic plate setting to ensure fast setup and consistent folding accuracy. The efficiency and productivity of the DF-980 results in huge time and cost savings.



Max EH-70F
Electronic Stapler

Heavy duty electronic stapler provides flat clinch stapling of 2 to 70 sheets without changing the staple. Features a super quiet motor and a high capacity staple cartridge allowing you to staple up to 5,000 times without reloading. Flat clinch stapling allows papers to stack neatly & evenly.

Duplo



Duplo DC-616
Multifinisher

The DC-616 provides the short-run on-demand digital printer, multi-function finishing in one compact, easy to use solution. It cuts, creases and perforates printed sheets, producing finished applications in a single pass.

The DC-616 has been designed for higher return on investment by saving the costs of additional machines by reducing production times.







-  Credit Cards
-  DVDs/CDs

E8280CC

Deskside, High Security Shredder

Compact auto feed document shredder for your office. Convenient, automatic shredding of up to 150 sheets. Separate cutting unit and bin for CDs/DVDs and plastic cards. Capable of shredding paper into 4x10mm particles.



-  Credit Cards
-  DVDs/CDs

Neoshred 8730HS

High Security, Combination Shredder

High performance, high security, NSA approved combination shredder. A perfect solution for the destruction of highly classified paper and optical media. Features all-metal cabinet, steel gearing, lifetime guaranteed waste bins and automatic oiling system.



Neoshred ET-10HS

High Security Shredder

Capable of shredding paper into particles 1x8mm in size. Also shreds CDs, credit cards and staples. Easily clear paper jams with Auto Reverse, Manual Forward and Turbo Boost functions. Quiet operation (55dB). SCEC approved, Class A. Built-in blue LED shred bin capacity indicator.



FORDIGRAPH 2326C

Exceptional Power & Speed

Innovative, centralised office shredder, suitable for continuous operation. Patented Electronic Capacity Control indicates used sheet capacity during shredding process. Sturdy steel cutting mechanism swallows paper clips. Convenient 260mm feed opening. 100 litre waste capacity.



FORDIGRAPH 5141C

High Performance & High Volume

Suitable for shredding of CDs and DVDs. Automatic oil injection system lubricates the cutting shafts when shredding and guarantees a consistently high shred performance. Large feed opening of 405mm for convenient feeding of large paper formats, with 165 litre shred bin.

FORDIGRAPH 5146C/6040C/7050-2C

High Capacity Shredders

5146C - Compact with total front access. Automatic reverse in case of paper jam. Automatic cut-off when waste cart is full, capacity of 230 litres. High quality cutting-mechanism made of high grade steel. Suitable for safe shredding of CDs.

6040C - Indestructible, all-steel construction. Clearly laid out operator panel with push buttons, pilot lights, mains switch, safety lock and emergency switch. Centralised oiling system for easy lubrication of the cutting head guarantees a consistently high sheet capacity. Material feed via conveyor belt. High shredded paper volume of 300 litres.

7050-2C (pictured) - Large feeding table with conveyor belt. Robust cutting mechanism made of high grade steel. "2-Speed", two automatic speed levels - automatic adaption of the shred speed to the paper quantity fed. Electronic control prevents overfeeding. 300 litre capacity.



Canon



Canon iPF680/685/780/785 24/36" Plotters

Built for speed, quality and ease of use, the 24" iPF680/685 and 36" iPF780/785 is an ideal large format printing solution for all size workgroups in production or office environments. Quickly and easily produce full-bleed posters, CAD/GIS renders and line drawings.



Canon iPF815/825 44" Plotters

Designed specifically for high volume technical document printing environments, iPF815/825 effortlessly produce detailed drawings, colour renderings and maps. iPF825 printer equipped with two media rolls that support multiple media types and long print runs.



HP Designjet T830

36" Wi-Fi MFP

Achieve sharp, true-color prints of your designs, maps, photos and presentations at resolutions of up to 2400 dpi. Wi-fi connectivity means you can place the printer where it's most convenient. Process complex files at high speeds; D/A1 print in 25 seconds. Ensure accuracy with true print previews, and monitor media rolls and printer status from the touchscreen. Load rolls quickly, even when seated.



HP Designjet T3500

36" Production eMFP

The most productive large format e-multifunction printer in the market. The Designjet T3500 eMFP offers low cost and high productivity for all large format printing and scanning needs. High-speed printing up to A1 size in just 21 seconds with vivid colours, rich blacks and neutral greys. Engineered for high print volumes, unattended printing, rigorous IT demands and top security operation.



Exhibition Display Banner



Double-Sided A-Frame



Double-Sided A1 Poster Stand

Realise the full potential of large format prints with our full range of indoor/outdoor display accessories.



The world's fastest large format printers

HP PageWide XL Series

HP PageWide XL8000

Monochrome and colour printer

The fastest large-format monochrome and colour printer ever, with a print speed of 30 A1/D pages per minute (1500 A1/D pages per hour). Setting new technical document standards with crisp lines, fine detail, and smooth grayscale that can not be beat by LED.

The PageWide XL8000 can print on a wide range of media up to 101.6 cm/40 inches—covering ISO/US technical and offset standards. working to make sure no matter the client you have the best quality prints.



HP PageWide XL 8000



HP PageWide XL 5000

HP PageWide XL5000

Multifunction printer

A powerful & efficient multifunction printer, the HP PageWide XL5000 deliveries up to 14 A1/D Pages per minute both in monochrome and colour prints.

Frees up the operation with optional high capacity stacker or online folding. Holding up to four rolls and dual ink supplies with an auto switch function for unattended printing.



HP PageWide XL 4000

HP PageWide XL4000

Monochrome and colour printer

HP PageWide XL4000 was designed with lower cost and increasing speed as a bench mark. Built to print 8 A1/D pages per minute with the first page printed within the first 30seconds.

The PageWide XL4000 is designed to do all your printing and scanning needs, with the printer able to be configured to hold up to 4 rolls and a 100-sheet integrated top stacker you can now focus more on your project than your printer.

AEC, CAD & GIS INDUSTRIES - Solutions for architecture, engineering and construction.

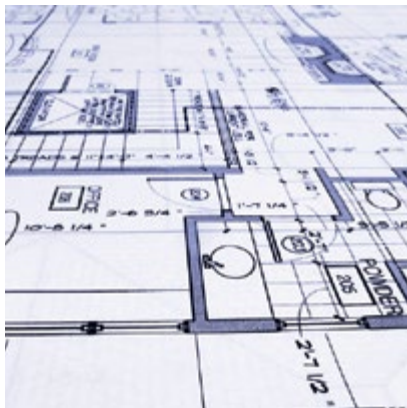

RISO ComColor Series

High Speed, Full Colour Inkjet Printers

The perfect answer to the high speed, high volume printing demands of busy offices. The RISO ComColor combines the world's fastest print speed with low running costs, increased productivity and reliability, for superior performance.

Specifically designed to give you the ultimate in ease of use, these advanced printers require virtually no operator training. At up to 160 pages per minute, ComColor sets a new standard in full colour print production.

The new RISO ComColor reduces power consumption to an all-time low with the introduction of automatic power shut-off. Truly eco-friendly, they consume a fraction of the electricity required by other production printers.



MODEL	MAX. SHEET SIZE	SPEED /MINUTE
GD7330	A3	130 Pages
GD9630	A3	160 Pages

Duplo Duprinters High Speed Duplicators

Duplo offer the most cost-effective print duplicating method available today. Combining the convenience and simplicity of a copier, with the economy and versatility of offset printing. Users benefit from the age old 'economies of scale' principle. Put simply, as the copy run increases, the cost-per-copy rapidly decreases. Featured ink saving mode allows a cartridge to last a great deal longer whilst maintaining high quality prints - further reducing cost-per-copy. Ideal solution offering economy, versatility and productivity to spot colour printing. Typical applications: business stationery, forms, flyers etc.



MODEL	MAX. SHEET SIZE	SPEED /MINUTE
DP-A100	A4	90 Pages
DP-J450	A3	120 Pages
DP-U850	A3	150 Pages
DP-U950	A3	150 Pages

(straight/offset stacker)

SUPPORT MAIL ROOM EQUIPMENT **OFFICE SOLUTIONS**
HELP DESK **LARGE FORMAT** MARKET LEADER
MAILING SOLUTIONS COMMUNICATION HIGH QUALITY **DIGITAL**
GRAPHICS **NEOPOST AUSTRALIA** TECHNOLOGY
SERVICE EQUIPMENT SUPPLIER BUSINESS LOCAL **FINANCE**
CONSUMABLES **SHIPPING SOLUTIONS** INTERNATIONAL
PRINT FINISHING WHOLESALER **PAYMENT SOLUTIONS**
 WAREHOUSE



Available in Full HD and Ultra HD 4K*

Touchscreen
Gesture Recognition



Mounting Option
Mobile electric stand
Adjustable height



NeoPanel Interactive LED Display Panel

Utilising the latest in display technology, our range of multi-touch interactive displays are ideal for both corporate office and classroom learning environments. The NeoPanel is plug-and-play and by simply attaching the USB to your computer, you now have a teaching tool to convey your lesson or conduct a presentation. Your fingertip acts as a stylus to touch the LED.

- Available in sizes 55" / 65" / 70" / 84"
- Fits anywhere in an office/classroom environment
- Control computer operation directly from the LED

*Only 65" & 84" models are available in Ultra HD 4K.



Neopost Interactive Touch Table Interactive Technology & Software Applications

An interactive class makes group learning fun, building creativity and communication skills for the students. Neopost Interactive Touch Table is a tool for learning through small group collaboration. The multi-touch ability supports up to four users simultaneous input. This 32" LCD touch-sensitive screen is ideal for kids to collaborate and play.

The Touch table features Multi-touch detection, no pressure required for touch, slim and robust design, Plug and Play function, Preloaded and ready to use applications, Built in 10W stereo speakers and wireless and cordless internet to make it easier for Kids to interact with the most up to date programs.



Interactive Whiteboards

Whiteboards & Projectors

Our whiteboards work in conjunction with your data projector and your computer to create a touch-based interactive whiteboard where you have full control of your PC from the whiteboard.

No longer do you have to be stuck behind your computer on a desk to teach a class. Take full control at the front of the classroom (or boardroom), allowing you to really engage with your students.

National Sales & Service

Monday - Friday
(8:00am to 5:30pm AEST)

Phone

1800 422 349

Fax

1800 819 985

Emails

ebusiness@neopost.com
service.au@neopost.com
accounts.au@neopost.com

Websites

www.neopost.com.au
www.neopostgraphics.com.au

Branches

NSW

Unit 1, Block Q
Regents Park Estate
Princes Road East
Regents Park, NSW 2143
P: (02) 9738 4000

VIC

91 Cook Street
Port Melbourne
VIC 3207
P: (03) 9674 2727

QLD

2/36 Turbo Drive
Coorparoo
QLD 4151
P: (07) 3004 6300

WA

9 Millrose Drive
Malaga
WA 6090
P: (08) 9272 1002

SA

24 Blenheim Street
Adelaide
SA 5000
P: (08) 8410 7500

ACT

Unit 7, 157 Gladstone Street
Fyshwick
ACT 2609
P: (02) 6280 8955



NEOPOST

Send.Receive.Connect.