



# **NILES BUILDING PRODUCTS CO.**

P.O. BOX 662 • 1600 HUNTER STREET • NILES, OH 44446

**330•544•0880**

**800•323•3329**

Fax: 330•544•8868

**[www.nilesbldg.com](http://www.nilesbldg.com)**

“Specialists in Expanded Metal Building Products”





## ***“Specialists in Expanded Metal Building Products”***

### **COMPANY OVERVIEW**

**Our Products** Niles Building Products is the industry leader in manufacturing expanded metal accessories for stucco, plaster, drywall and veneer plaster applications. Our products are used in Portland cement and stucco construction for wall-to-wall ceiling joints, frames, corners and Exterior Insulation Finishing Systems (E.I.F.S.). Their function is to control expansion and contraction while preserving the integrity of surfaces and their finished appearance.

Take a look at our products and their descriptions and let us know how we can assist with your needs.

**Our Superiority** Expanded metal building products are our specialty. This is where our skills, experience and manufacturing competence are concentrated; adding up to quality that you can depend on.

We work with a variety of gauges of hot-dipped galvanized steel and pure zinc alloy. Our expertise in expanded metal accessories, coupled with our commitment to producing world class quality has made us the market leader in our industry.

**Our Company** At Niles Building Products we are a service oriented company, high on quality and low in overhead. Our distinction and reputation in the wall and ceiling industry is defined by the personal attention we give every inquiry and order. Our customers need, want and deserve the best product of the highest quality, priced right and delivered on time. Make Niles Building Products your choice!





## Niles Drywall Corner Bead

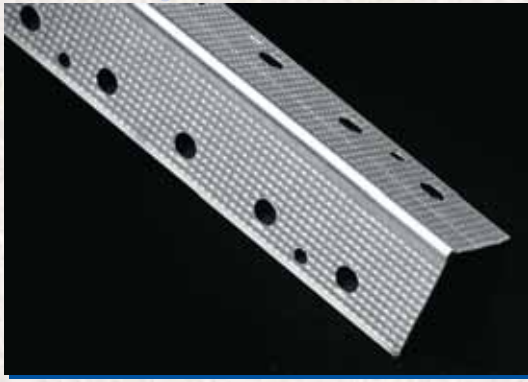

Wing size 1-1/4" x 1-1/4".  
Also available in Electro-Galvanized Steel.

## Resilient Channel



## Furring Channel

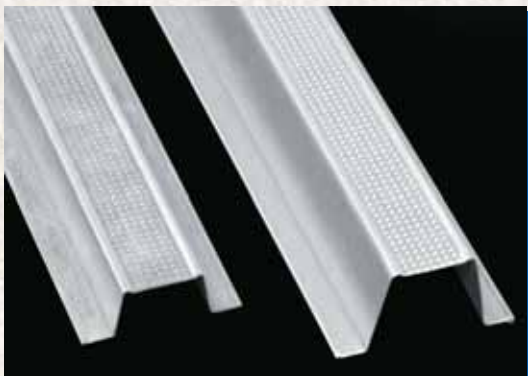

## Security Mesh



**\*\*PALLET WEIGHTS MAY VARY**

LENGTH	PIECES/ CTN	FEET/ CTN	CTNS. PALLET
8'	63	504	49
9'	56	504	49
10'	50	500	49
12'	42	504	49

NOMINAL WEIGHT/CARTON - 56 LBS.  
NOMINAL WEIGHT/PALLET - 2500 LBS.\*\*

Extremely durable, hot-dipped galvanized bead that provides superior corrosion protection. Flanges are deeply knurled for excellent joint compound adhesion. Easily installed by using drywall nails, staples, screws or clinching tool.

RESILIENT CHANNEL	SIZE	LENGTH	PIECES/ BUNDLE
RC1 - ONE LEG			
25 GAUGE	1/2" x 2"	12'	20
RC2 - TWO LEGS			
25 GAUGE	1/2" x 2-1/2"	12'	20

50 BUNDLES/PALLET  
OTHER LENGTHS AVAILABLE

The Niles Resilient Channel, available with one leg (RC1) or two legs (RC2), is used as a cross furring member for attachment of gypsum wallboard on ceilings & partitions. One of the most efficient, low-cost methods developed to reduce sound transmission through wall partitions and ceiling assemblies.

SIZE	GAUGE	LENGTH	PIECES/ BUNDLE
7/8" x 2-1/2"	25	12'	20
7/8" x 2-1/2"	20	12'	10
1-1/2" x 2-3/4"	25	12'	10
1-1/2" x 2-3/4"	20	12'	10

50 BUNDLES/PALLET  
OTHER LENGTHS AVAILABLE

Available in two sizes, the Niles Furring Channel is used as a cross furring member for attachment of gypsum wallboard or lath on ceiling or furred masonry walls.

SIZE	WEIGHT
3/4", 9 GAUGE	60 LBS/SHEET
1-1/2", 9 GAUGE	40 LBS/SHEET
1-1/2", 13 GAUGE	21 LBS/SHEET
1-1/2", 16 GAUGE	14.75 LBS/SHEET

SHEET SIZE 48"x96"  
AVAILABLE IN STANDARD & FLATTENED

Also Available: 1" Security Mesh  
Security Mesh Clips





# NILES MINI-BEAD & ZINC CONTROL JOINTS

## Niles "Mini-Bead" 800/900

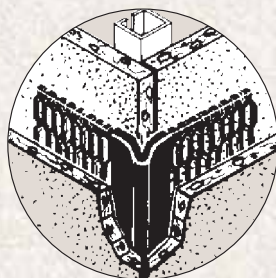
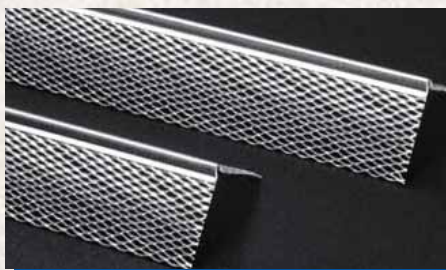

NILES MINI-BEAD	CTNS. PALLET	NOMINAL LBS/CTN	NOMINAL WT/PALLET**
Mini-Bead 8'	25	40	1000
Mini-Bead 10'	25	48	1200

8' CORNER BEAD - 60 PCS./CTN. - 480 FT. PER CTN.  
10' CORNER BEAD - 60 PCS./CTN. - 600 FT. PER CTN.

Wing size 1-1/4" x 1-1/4". Used to provide a straight and true reinforced corner for veneer plaster and drywall applications. Manufactured from hot-dipped galvanized steel, these beads can be nailed, stapled or clinched. The fine mini-mesh flanges allow for excellent bonding to veneer plaster or drywall finishing compound. Available in 8' & 10' lengths.

## Niles "L"-Trim & Niles "J"-Trim

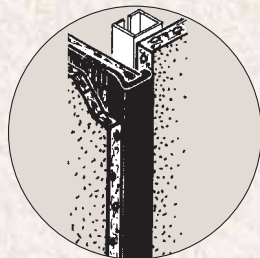
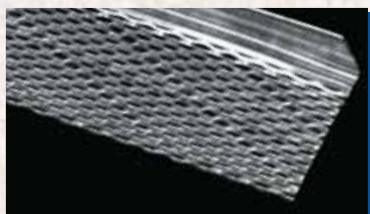

NILES L & J TRIM	CTNS. PALLET	NOMINAL LBS/CTN	NOMINAL WT/PALLET**
Niles L Trim 1/2" & 5/8"-10'	60	45	2700
Niles J Trim 1/2" & 5/8"-10'	63	45	2835

L & J TRIMS - 50 PCS./CTN. - 500 FT. PER CTN.

**Niles 'L'-Trim** — Used to provide a protective edge for either drywall or veneer gypsum board & plaster, or for gypsum finish edges. Provides a fine mini-mesh flange for bonding of veneer plaster or gypsum finishing compound.

**Niles 'J'-Trim** — Similar to our 'L'-Trim, but with a return lip to provide a complete protective edge around the gypsum board.

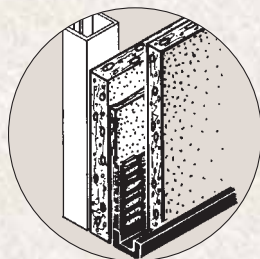
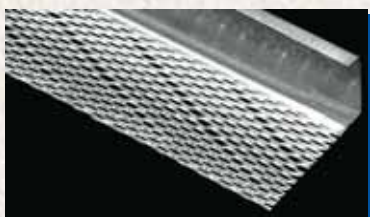

## Niles-093 Zinc Control Joint

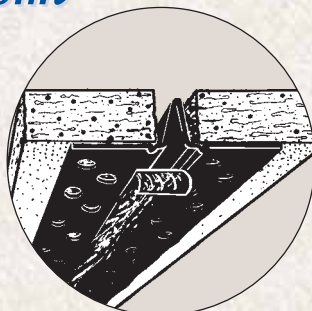
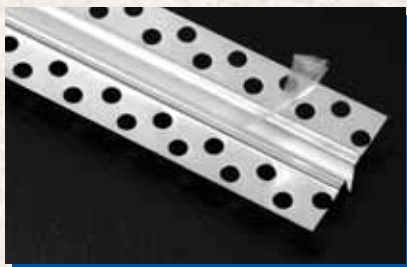

NILES-093 ZINC CONTROL JOINT	CTNS. PALLET	NOMINAL LBS/CTN	NOMINAL WT/PALLET**
Niles-093 Zinc Control Joint	20	27	540

25 PCS./CTN. - 250 FT. PER CTN.

Niles-093 zinc control joints for large expanses of ceiling and wall areas, both drywall and veneer. Excellent for long partitions and from door headers to ceilings. Tape protects 1/4" openings, 7/16" deep; 3/32" grounds. Note: A sure seal behind joints must be placed where fire ratings are observed and sound transmissions a factor.

## Niles Zinc Control Joint

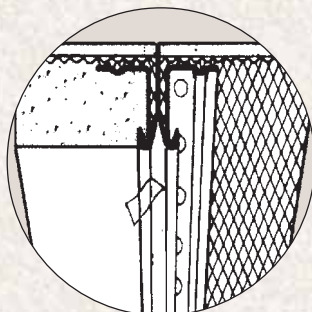

NILES "C" ZINC CONTROL JOINT	CTNS. PALLET	NOMINAL LBS/CTN	NOMINAL WT/PALLET**
C380 - 3/8"	20	55	1100
C500 - 1/2"	20	60	1200
C750 - 3/4"	20	66	1320

25 PCS./CTN. - 250 FT. PER CTN.

Used to provide a mechanism for movement to accommodate expansion & contraction caused by initial stucco shrinkage and minor thermal movement. The "J" shaped shoulder provides excellent stucco bonding. The Niles Zinc Control Joint has unexpanded flanges with large holes that aid in the bonding to adjoining metal lath. Comes pre-taped to ensure a clean finish.

\*\*PALLET WEIGHTS MAY VARY



**Niles Building Products** 330-544-0880 • 800-323-3329 • Fax 330-544-8868 • [www.nilesbldg.com](http://www.nilesbldg.com)  
NILES BUILDING PRODUCTS RECOMMENDS THE USE OF ZINC ACCESSORIES FOR ALL EXTERIOR APPLICATIONS



# NILES EXPANSION CONTROL JOINTS, PLASTER & STUCCO

## Niles Double "V" Expansion Control Joint

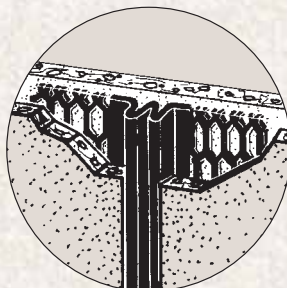
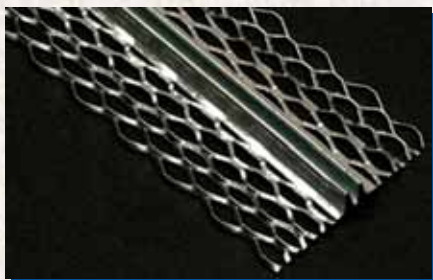

Used to provide a mechanism for movement to accommodate expansion & contraction caused by initial stucco shrinkage and minor thermal movement.

## Niles Double "V" Inside Corner Expansion Control Joint

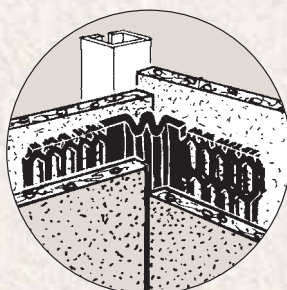
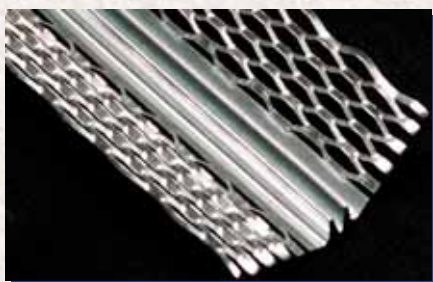

## Niles Double "J" Expansion Control Joint

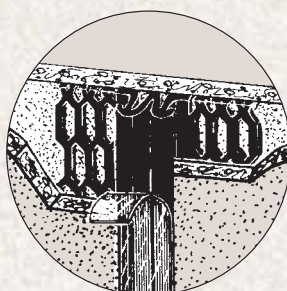
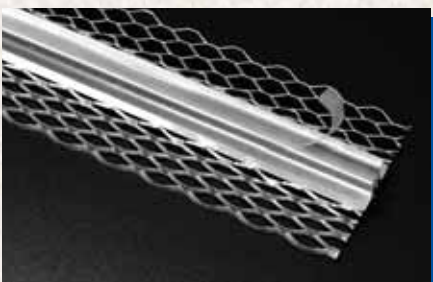

## Niles Two-Piece Tru-Joint

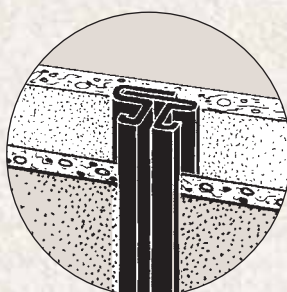

\*\*PALLET WEIGHTS MAY VARY

NILES DOUBLE "V" EXPANSION CONTROL JOINT	CTNS. PALLET	NOMINAL LBS/CTN	NOMINAL WT/PALLET**
1/4" gr. Galv.	42	45	1890
1/4" gr. Zinc	42	43	1806
3/8" gr. Galv.	42	48	2016
3/8" gr. Zinc	42	45	1890
1/2" gr. Galv.	40	66	2640
1/2" gr. Zinc	40	58	2320
5/8" gr. Galv.	40	70	2800
5/8" gr. Zinc	40	63	2520
3/4" gr. Galv.	40	74	2960
3/4" gr. Zinc	40	68	2720
7/8" gr. Galv.	40	83	3320
7/8" gr. Zinc	40	72	2880

24 PCS./CTN. - 240 FT. PER CTN.

NILES DOUBLE "V" EXPANSION CONTROL JOINT-INSIDE CORNER	CTNS. PALLET	NOMINAL LBS/CTN	NOMINAL WT/PALLET**
1/2" gr. Galv.	40	66	2640
1/2" gr. Zinc	40	58	2320
5/8" gr. Galv.	40	70	2800
5/8" gr. Zinc	40	63	2520
3/4" gr. Galv.	40	74	2960
3/4" gr. Zinc	40	68	2720
7/8" gr. Galv.	40	83	3320
7/8" gr. Zinc	40	72	2880

24 PCS./CTN. - 240 FT. PER CTN.

Similar to the standard Double "V", roll formed to fit inside corner locations.

NILES DOUBLE "J" EXPANSION CONTROL JOINT	CTNS. PALLET	NOMINAL LBS/CTN	NOMINAL WT/PALLET**
1/2" gr. Galv.	40	74	2960
1/2" gr. Zinc*	40	64	2560
3/4" gr. Galv.	40	80	3200
3/4" gr. Zinc*	40	74	2960
7/8" gr. Galv.	40	84	3360
7/8" gr. Zinc*	40	78	3120

24 PCS./CTN. - 240 FT. PER CTN.

**\*SPECIAL ORDER ONLY. MINIMUM QUANTITIES APPLY.**

Like the Double "V", the Double "J" is also used to provide a mechanism for movement to accommodate expansion and contraction caused by initial stucco shrinkage and minor thermal movement. The Double "J" shaped shoulders provide a more secure stucco bond. Comes pre-taped to ensure a clean finish.

NILES TRU-JOINT EXPANSION JOINT (2 Piece)	CTNS. PALLET	NOMINAL LBS/CTN	NOMINAL WT/PALLET**
1/2" gr. Galv.	25	61	1525
1/2" gr. Zinc	25	57	1425
3/4" gr. Galv.	25	65	1625
3/4" gr. Zinc	25	61	1525
7/8" gr. Galv.	25	67	1675
7/8" gr. Zinc	25	63	1575

15 PCS./CTN. - 150 FT. PER CTN.

The Niles Two-Piece Tru-Joint is used to relieve stress caused by expansion & contraction and initial stucco shrinkage. The opening adjusts from 1/4" to 5/8" and is ideally used where more movement is expected than would be normal with a one-piece expansion control joint.



**Niles Building Products 1600 Hunter Street • Niles, Ohio 44446 • [www.nilesbldg.com](http://www.nilesbldg.com)**

NILES BUILDING PRODUCTS RECOMMENDS THE USE OF ZINC ACCESSORIES FOR ALL EXTERIOR APPLICATIONS



# CORNER BEADS & CASING BEADS

## Niles 1-A Corner Bead

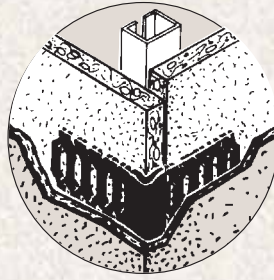
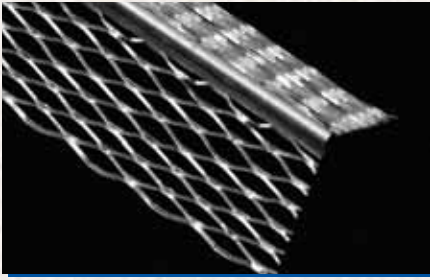

NILES NO. 1-A CORNER BEAD	FT/CTN	CTNS. PALLET	NOMINAL LBS/CTN	NOMINAL WT/PALLET**
8' Galv.	240	40	52	2080
10' Galv.	300	40	56	2240
10' Zinc	300	40	48	1920

30 PCS./CTN.

Wing size 2-5/8" x 2-5/8". Used to reinforce external corners on Portland cement stucco applications. The 2-5/8" expanded flanges allow for complete embedment of the entire bead, especially near the nose where strength is needed most. Available in hot-dipped galvanized and 99% pure zinc alloy.

## Niles 2-A Corner Bead

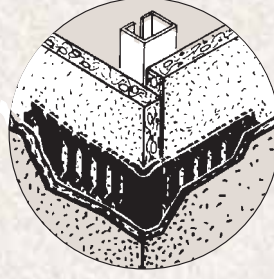
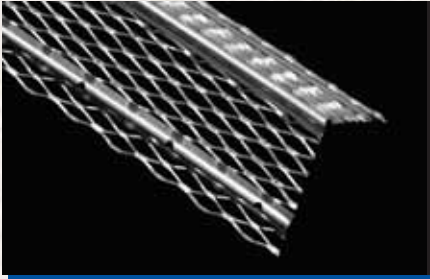

NILES NO. 2-A CORNER BEAD	FT/CTN	CTNS. PALLET	NOMINAL LBS/CTN	NOMINAL WT/PALLET**
10' Galv.	300	25	72	1800
10' Zinc	300	25	65	1625

30 PCS./CTN. - 300 FT. PER CTN.

Wider, reinforced flange provides additional rigidity & strength superior to the Niles 1-A thus allowing for easier installation.

## Niles No. 66-X Expanded Flange Casing Bead

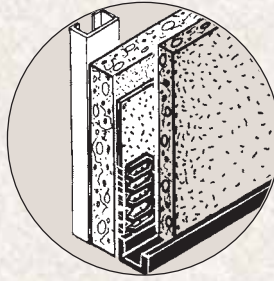
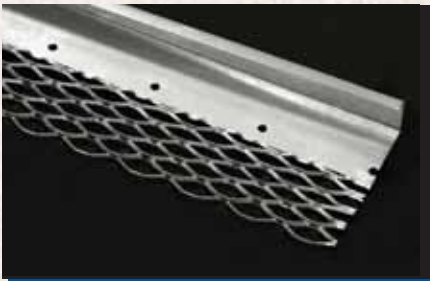

Used to effectively terminate plaster edge and/or to separate stucco from all other structural membranes at doors, windows, and other openings; also when plaster/stucco meets dissimilar material. Expanded flange provides excellent stucco embedment at the junctions of the bead and metal lath.

Also available with punched grounds upon request.

Caution: 66X Casing Beads w/punched grounds should not be used as a substitute for foundation weep screeds in a 3 coat stucco system.

NILES NO. 66-X EXPANDED FLANGE	CTNS. PALLET	NOMINAL LBS/CTN	NOMINAL WT/PALLET**
1/4" gr. Galv.	42	42	1764
1/4" gr. Zinc	42	39	1638
3/8" gr. Galv.	42	48	2016
3/8" gr. Zinc	42	45	1890
1/2" gr. Galv.	42	55	2310
1/2" gr. Zinc	42	51	2142
5/8" gr. Galv.	42	56	2352
5/8" gr. Zinc	42	53	2226
3/4" gr. Galv.	42	58	2436
3/4" gr. Zinc	42	55	2310
7/8" gr. Galv.	42	62	2604
7/8" gr. Zinc	42	59	2478
1" gr. Galv.	42	64	2688
1" gr. Zinc	42	60	2520
1-1/4" gr. Galv.	40	68	2720
1-1/4" gr. Zinc	40	64	2560
1-1/2" gr. Galv.	40	72	2880
1-1/2" gr. Zinc	40	68	2720

30 PCS./CTN. - 300 FT. PER CTN.

## Niles No. 66N, Long Flange (J-Weep)



3-1/2 Flange

Available in Zinc - Contact Plant for Details

NILES NO. 66N LONG FLANGE	PCS./CARTON	CTNS. PALLET
3/8"	30	42
1/2"	30	42
3/4"	30	42
7/8"	30	42
1"	30	42
1-3/8"	30	40
1-1/2"	30	40

300 FT. PER CTN.

\*\*PALLET WEIGHTS MAY VARY



**Niles Building Products** 330-544-0880 • 800-323-3329 • Fax 330-544-8868 • [www.nilesbldg.com](http://www.nilesbldg.com)

NILES BUILDING PRODUCTS RECOMMENDS THE USE OF ZINC ACCESSORIES FOR ALL EXTERIOR APPLICATIONS



## Niles No. 66-N, Short Flange

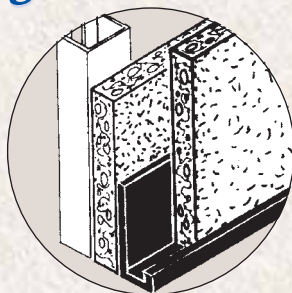
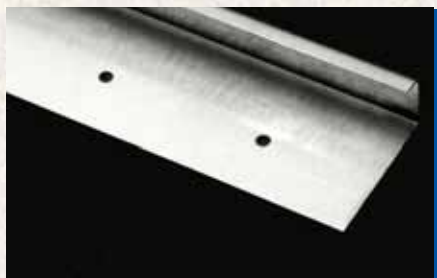

The choice where short, solid flanges are preferable. Also available with punched grounds.

NILES NO. 66-N SHORT FLANGE	CTNS. PALLET	NOMINAL LBS/CTN	NOMINAL WT/PALLET
3/8" gr. Galv.	42	38	1596
3/8" gr. Zinc*	42	36	1512
1/2" gr. Galv.	42	40	1680
1/2" gr. Zinc*	42	38	1596
3/4" gr. Galv.	42	44	1848
3/4" gr. Zinc*	42	41	1722
7/8" gr. Galv.	42	47	1974
7/8" gr. Zinc*	42	44	1848
1" gr. Galv.	42	48	2016
1" gr. Zinc*	42	45	1890
1-1/4" gr. Galv.	42	52	2184
1-1/4" gr. Zinc*	42	49	2058
1-1/2" gr. Galv.*	42	56	2352
1-1/2" gr. Zinc*	42	53	2226

30 PCS./CTN. - 300 FT. PER CTN.

**\*SPECIAL ORDER ONLY MINIMUM QUANTITIES APPLY**

## Niles Foundation Weep Screed (FHA #7)

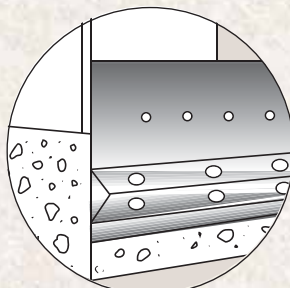

The #7 Foundation Weep Screed is used to provide a weep mechanism as part of the drainage system as required at the bottom of all framed walls; by all major building codes and the International Building Code in ASTM C1063. The larger holes in the ground flange are bonding holes as the entire surface of the sloped ground provides for drainage once the stucco has hydrated and shrinkage has occurred. The 3-1/2" nailing flange serves as a flashing when water resistant, breathable building paper or paper backed lath is installed over the flange.

NILES #7 FHA	CTNS. PALLET	NOMINAL LBS/CTN	NOMINAL WT/PALLET**
1/2" Galv.	25	77	1925
1/2" Zinc*	25	71	1775
5/8" Galv.	25	82	2050
5/8" Zinc*	25	75	1870
3/4" Galv.	25	86	2150
3/4" Zinc*	25	79	1960
7/8" Galv.	25	90	2250
7/8" Zinc*	25	82	2060
1" Galv.	25	95	2375
1" Zinc*	25	87	2175

25 PCS./CTN. - 250 FT. PER CTN.

**\*Consult with mill before ordering.**

**#36 Foundation Sill Screed Also Available - Special Order Only. Minimum Quantities Apply.**

## Niles Cornerite

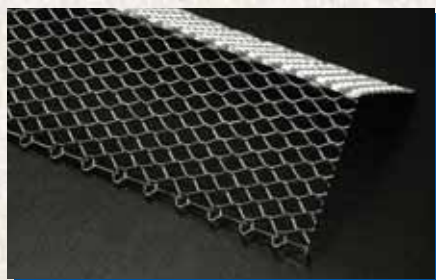

NILES CORNERITE	PCS/CTN	FT/CN	CTNS PALLET	NOMINAL LBS/CTN	NOMINAL WT/PALLET**
2" Galv. 4'	125	500'	20	50	1000
2" Galv. 8'	75	600'	18	63	1134
3" Galv. 8'	75	600'	18	84	1512

Used to reinforce and straighten inside metal lath installations to provide strength and smoothness to this critical area.

## Niles Strip Lath

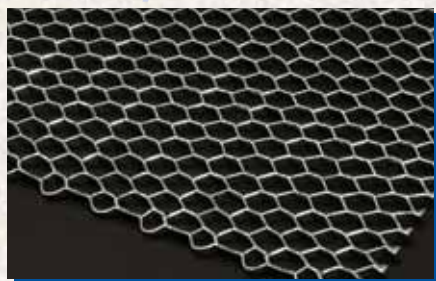

NILES STRIP LATH	PCS/CTN	FT/CN	CTNS PALLET	NOMINAL LBS/CTN	NOMINAL WT/PALLET**
4" Galv. 8'	75	600'	18	63	1134
5" Galv. 8'	75	600'	18	73	1314
6" Galv. 8'	75	600'	18	84	1512

Single strip of smooth lath. Used to fill in and/or reinforce some lath areas.

**\*\*PALLET WEIGHTS MAY VARY**



**Niles Building Products 1600 Hunter Street • Niles, Ohio 44446 • [www.nilesbldg.com](http://www.nilesbldg.com)**  
NILES BUILDING PRODUCTS RECOMMENDS THE USE OF ZINC ACCESSORIES FOR ALL EXTERIOR APPLICATIONS



# METAL LATH

## Diamond Mesh Lath



WT./ SQ.YD	SHEET SIZE	PCS BUNDLE	BUNDLES PALLET
1.75	27" x 96"	10	50
2.5	27" x 96"	10	50
3.4	27" x 96"	10	50

1000 SQ YARDS PER PALLET

Niles' Diamond Mesh Lath is a versatile metal lath ideal as a plaster base and reinforcement for all types of walls, ceilings and fireproofing of steel beams and columns.

## Self-Furred Diamond Mesh Lath

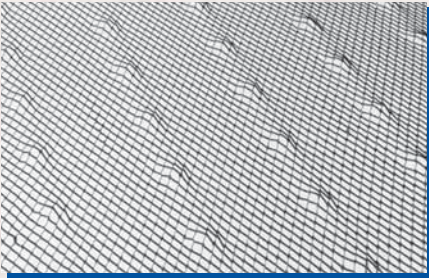

WT./ SQ.YD	SHEET SIZE	PCS BUNDLE	BUNDLES PALLET
1.75	27" x 96"	10	25
2.5	27" x 96"	10	25
3.4	27" x 96"	10	25

500 SQ YARDS PER PALLET

Niles' Self-Furred Diamond Mesh Lath provides a 1/4" indentation in the metal lath to hold away from the sheathing base and reinforcement (plaster embedment). Provides more ample keying for scratch coat application.

## Paper Back Lath

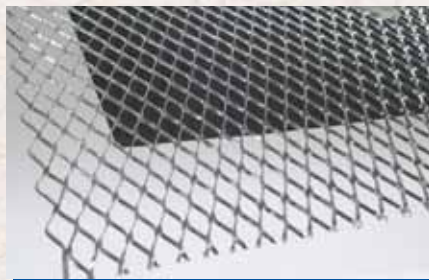

Available in Flat & Self-Furring

WT./ SQ.YD	SHEET SIZE	PCS BUNDLE	BUNDLES PALLET
1.75 *	27" x 96"	10	25
2.5 *	27" x 96"	10	25
3.4 *	27" x 96"	10	25

500 SQ YARDS PER PALLET

\*WEIGHT PER SQ.YARD DOES NOT INCLUDE PAPER

Niles' Paper-Back Lath is metal lath, fully backed with Type-1, Grade "D", Style-2 asphalt paper that meets or exceeds federal specifications NO. UU-B-790A. Paper is offset 1-1/2" on one end and side.

**NOTE:** Niles Building Products will not be responsible for pinholes/perforations caused by the dimples penetrating the paper.

# ZINC LATH

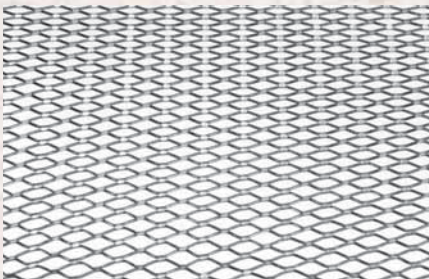

Available in Self-Furring and Paper Back.  
Call Plant for details.

WT./ SQ.YD	SHEET SIZE	PCS BUNDLE	BUNDLES PALLET
2.5	27" x 96"	10	25
3.4	27" x 96"	10	25

500 SQ YARDS PER PALLET

Manufactured from #190 special high grade zinc alloy, approximately 99% pure zinc. Provides the ultimate in corrosion resistance for both specialty and conventional stucco applications. Ideal for coastal applications where salt water and moisture are a concern.



**Niles Building Products** 330-544-0880 • 800-323-3329 • Fax 330-544-8868 • [www.nilesbldg.com](http://www.nilesbldg.com)

NILES BUILDING PRODUCTS RECOMMENDS THE USE OF ZINC ACCESSORIES FOR ALL EXTERIOR APPLICATIONS



## *Metal Lath & Accessories*

### **HOT DIPPED GALVANIZED:**

**ASTM C645** - Standard specification for non-structural steel framing members

**ASTM C653** - Standard specification for steel sheet zinc coated (galvanized) or zinc iron alloy coated (galvanized) by the hot-dip process

**ASTM C841** - Standard specification for installation of interior lath and furring

**ASTM C847** - Standard specification for metal lath (2.5 & 3.4 only)

**ASTM C1047** - Standard specification for gypsum wallboard and gypsum veneer base accessories

**ASTM C1063** - Standard specification for installation of lathing and furring for Portland cement based plaster

- All galvanized products produced from G-60 hot-dipped galvanized raw material to meet full compliancy for your application needs.
- Full line of G90 hot-dipped galvanized now available. This finish is intended for applications where superior corrosion resistance is required and cost is a consideration. Contact plant for details.

### **ZINC:**

**ASTM B69** - Standard specification for flat rolled zinc. Approximately 99% pure zinc.

**NILES BUILDING PRODUCTS RECOMMENDS THE USE OF ZINC ACCESSORIES FOR ALL EXTERIOR APPLICATIONS**

### **PAPER:**

Type 1, Grade "D", Style 2.

Meets or exceeds federal specifications No. 44-B-790A

### **STORAGE:**

Per ASTM C1063 - All metal lath and accessories must be protected from the elements during storage and at job sites





# GENERAL FACTS/RECOMMENDATIONS

## *Zinc Accessories*

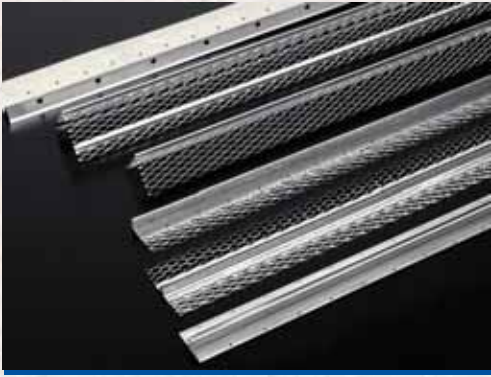

All Niles Building Products accessories are fabricated from galvanized steel or 99% pure zinc alloy.

Zinc accessories are ideal for locations where moisture & corrosion are a concern, however Niles Building Products recommends the use of zinc accessories for all exterior applications.

At the foundation plate line or where the bottom of the stucco wall terminates, a foundation weep screed is recommended.

## *Foundation Weep Screed*



## *Casing Beads, Expansion & Control Joints*



Casing beads, expansion & control joints are chosen to the specified ground of the stucco system based on the number of coats - scratch, brown, & finish.

66x casing bead is attached to assure straight lines & square angles and to separate structural from non-structural elements such as window & door openings.

**STORAGE** - Per ASTM C1063: All metal lath and accessories must be protected from the elements during storage and at job sites



*Niles Building Products* 330-544-0880 • 800-323-3329 • Fax 330-544-8868 • [www.nilesbldg.com](http://www.nilesbldg.com)  
NILES BUILDING PRODUCTS RECOMMENDS THE USE OF ZINC ACCESSORIES FOR ALL EXTERIOR APPLICATIONS



## Corner Beads



Corner beads are recommended for external corners. They provide a means of producing straight vertical or horizontal stucco surfaces that intersect as well as protection from impact damage. Also aid in establishing the thickness of the basecoat cement plaster.

## Control Joints

The installation of control joints is recommended for the purpose of controlling the location and amount of cracking that may occur. However, it is not an assurance that no cracking will occur in the stucco or an assurance that cracking will only occur at the control joint locations.

Control joints provide for better quality stucco work, however the type of building, design and system dictate whether control joints are necessary and the number involved.



## Inside Corner Accessories



Inside corner accessories are recommended if the structure of the intersecting wall construction is different, in which case one or both walls should terminate and the joint should have a sealant system or an inside corner expansion joint (Niles Double V Inside Corner).

**STORAGE** - Per ASTM C1063: All metal lath and accessories must be protected from the elements during storage and at job sites



**Niles Building Products** 1600 Hunter Street • Niles, Ohio 44446 • [www.nilesbldg.com](http://www.nilesbldg.com)  
NILES BUILDING PRODUCTS RECOMMENDS THE USE OF ZINC ACCESSORIES FOR ALL EXTERIOR APPLICATIONS





• **TEXAS DISTRIBUTION CENTER •**  
**609 AVENUE R**  
**GRAND PRAIRIE, TX 75050**



**NILES BUILDING PRODUCTS CO.**

P.O. BOX 662 • 1600 HUNTER STREET • NILES, OH 44446

330-544-0880 • 800-323-3329 • Fax: 330-544-8868

[www.nilesbldg.com](http://www.nilesbldg.com)

