

SRS Light "ON" - B0111/B0116 - Open Side Squib Circuit

Service Category Vehicle Interior

Section Supplemental Restraint Systems

Market USA

Toyota Supports
 ASE Certification 

Applicability

YEAR(S)	MODEL(S)	ADDITIONAL INFORMATION
2005 – 2009	Sienna	

Introduction

Some 2005 – 2009 model year Sienna vehicles may exhibit an SRS lamp "ON" condition with Diagnostic Trouble Code (DTC) B0111 and/or B0116. An updated repair procedure is available to address this condition. Follow the procedures in this bulletin to replace the floor wire harness and side squib.

TSB Overview

After confirming the vehicle condition matches this bulletin, this TSB will direct you to replace the floor wire harness and the side squib. In order to do this, it is necessary to first remove several major components, such as the upper instrument panel, front and rear seats, and seat belts. This bulletin provides detailed instructions on the removal and installation of these components.

Parts Information

SEAT TYPE	PREVIOUS PART NUMBER	CURRENT PART NUMBER	PART NAME	QTY
Driver Manual	73920-AE041	Same	Airbag Assembly, FR Seat, LH	1
Driver Power	73920-AE031	Same		1
Passenger Fold Flat	73910-AE031	Same	Airbag Assembly, FR Seat, RH	1
Passenger Manual	73910-AE041	Same		1
Passenger Power	73910-AE051	Same		1
All	90080-17200	Same	Nut	2
	90468-18008	Same	Clip (Hog Rings)	15
	82161-#####	Same	Floor Wire Harness, No. 1	1
	82162-#####	Same	Floor Wire Harness, No. 2	1

SRS Light "ON" - B0111/B0116 - Open Side Squib Circuit

Warranty Information

OP CODE	DESCRIPTION	TIME	OFF	T1	T2
EL7023	R & R Side Air Bag Assembly (Driver Manual)	1.8	73920-AE041	8B	71
EL7024	R & R Side Airbag Assembly (Driver Power)	1.8	73920-AE031		
EL7025	R & R Side Airbag Assembly (Passenger Manual)	1.8	73910-AE041		
EL7026	R & R Side Airbag Assembly (Passenger Fold Flat)	1.9	73910-AE031		
EL7027	R & R Side Airbag Assembly (Passenger Power)	1.8	73910-AE051		
EL7028	R & R Side Airbag Assembly (Driver Manual and Passenger Manual)	3.4	73920-AE041		
EL7029	R & R Side Airbag Assembly (Driver Manual and Passenger Fold Flat)	3.5			
EL7030	R & R Side Airbag Assembly (Driver Power and Passenger Manual)	3.4	73920-AE031		
EL7031	R & R Side Airbag Assembly (Driver Power and Passenger Power)	3.4			
EL9030	R & R Floor Wire Harness (Driver Side)	6.2	82161-08###		
EL9031	R & R Floor Wire Harness (Passenger Side)	5.4	82162-08###		
EL9032	R & R Floor Wire Harness (Both Sides)	7.4	82161-08###		
EL9033	R & R Side Air Bag Assembly (Power or Manual) and Floor Wire Harness (Driver Side)	8.0	82161-08###		
EL9034	R & R Side Air Bag Assembly (Power or Manual) and Floor Wire Harness (Passenger Side)	7.2	82162-08###		
EL9035	R & R Side Air Bag Assembly (Fold Flat) and Floor Wire Harness (Passenger Side)	7.3	82162-08###		
EL9036	R & R Side Airbag Assembly (Power or Manual) and Floor Wire Harness (BOTH sides)	10.8	82161-08###		
EL9037	R & R Side Airbag Assembly (Manual and Fold Flat) and Floor Wire Harness (BOTH sides)	10.9	82162-08###		

APPLICABLE WARRANTY

- This repair is covered under the Toyota Restraint System Warranty. This warranty is in effect for 60 months or 60,000 miles, whichever occurs first, from the vehicle's in-service date.
- Warranty application is limited to occurrence of the specified condition described in this bulletin.

SRS Light "ON" - B0111/B0116 - Open Side Squib Circuit

Required Tools & Equipment

SPECIAL SERVICE TOOLS (SST'S)	PART NUMBER	QTY
Plastic Pry Tool Set*	00002-06000-01	1
Occupant Classification Seat Weight Set	00002-09090-01	1

* Essential SST.

NOTE

Additional SSTs may be ordered by calling 1-800-933-8335.

REQUIRED EQUIPMENT	SUPPLIER	PART NUMBER	QTY
TIS Techstream*	ADE	TSPKG1	1
NOTE: Software version 5.01.001 or later is required.			

* Essential SST.

NOTE

Additional TIS Techstream units may be ordered by calling Approved Dealer Equipment (ADE) at 1-800-368-6787.

SRS Light "ON" - B0111/B0116 - Open Side Squib Circuit

Repair Procedure Overview

- **Section 1: Diagnostic Procedure**

This procedure, using Techstream and TIS will determine the correct repair method. Replacement of either the side airbag and/or the floor wire harness will be necessary.

- **Section 2: Side Airbag Assembly Replacement**

If the side airbag has not been previously replaced using T-SB-0252-08, this section instructs the reader to replace the side airbag. If it has been previously replaced, this section can be skipped.

- **Section 3: Floor Wire Harness Replacement**

The floor wire harness will need to be replaced on all vehicles applicable to this bulletin. This will require removal of several major components, such as the upper instrument panel, front and rear seats, and seat belts.

Diagnostic Procedure

1. Follow the diagnostic procedure in the Repair Manual.

Refer to the Technical Information System (TIS), applicable model year Sienna Repair Manual:

B0111:

- [2005](#) Sienna:
Vehicle Interior – Supplemental Restraint Systems – “Supplemental Restraint System: B0111/44 Open In Side Squib”
- [2006](#) / [2007](#) / [2008](#) / [2009](#) Sienna:
Vehicle Interior – Supplemental Restraint Systems – “Supplemental Restraint System: Airbag System: B0111/44: Open In Side Squib RH Circuit”

B0116:

- [2005](#) Sienna:
Vehicle Interior – Supplemental Restraint Systems – “Supplemental Restraint System: B0116/48 Open In Side Squib”
- [2006](#) / [2007](#) / [2008](#) / [2009](#) Sienna:
Vehicle Interior – Supplemental Restraint Systems – “Supplemental Restraint System: Airbag System: B0116/48: Open In Side Squib LH Circuit”

If NO concern is identified after inspecting the floor harness and the center airbag sensor assembly, go to the next step to determine the correct repair procedure.

2. Has the side airbag been replaced? (Refer to TSB [T-SB-0252-08](#), “Repair Manual Supplement: SRS Light 'ON' DTC B0111/B0116 – Open Side Squib Circuit”.)
 - **YES** — Replace the floor wire harness.
 - **NO / Not Sure** — Replace the side airbag assembly and floor wire harness.

SRS Light "ON" - B0111/B0116 - Open Side Squib Circuit

Repair Procedure: Side Airbag Assembly Replacement

Replace the side airbag assembly.

Refer to TIS, TSB [T-SB-0252-08](#), "Repair Manual Supplement: SRS Light 'ON' DTC B0111/B0116 – Open Side Squib Circuit".

Repair Procedure: Floor Wire Harness Removal

1. Remove the instrument panel.

Refer to TIS, applicable model year Sienna Repair Manual:

- [2005](#) Sienna:
Vehicle Interior – Interior Panels/Trim – "Instrument Panel Safety Pad Sub-Assy: Replacement"
- [2006](#) / [2007](#) / [2008](#) / [2009](#) Sienna:
Vehicle Interior – Interior Panels/Trim – "Instrument Panel: Instrument Panel Safety Pad: Removal"

2. Remove the front seat outer belt assembly.

Refer to TIS, applicable model year Sienna Repair Manual:

- [2005](#) Sienna:
Vehicle Interior – Seat Belt – "Front Seat Belt: Replacement"
- [2006](#) / [2007](#) / [2008](#) / [2009](#) Sienna:
Vehicle Interior – Seat Belt – "Seat Belt: Front Seat Outer Belt Assembly: Removal"

SRS Light "ON" - B0111/B0116 - Open Side Squib Circuit

Repair Procedure: Floor Wire Harness Removal (Continued)

LH Side Only (steps 3 – 12):

3. Remove the back door weatherstrip.
4. Remove the back door scuff plate.
 - A. Remove the 3 bolts.
 - B. Using a plastic pry tool, disengage the 6 clips and remove the scuff plate.

Figure 1.

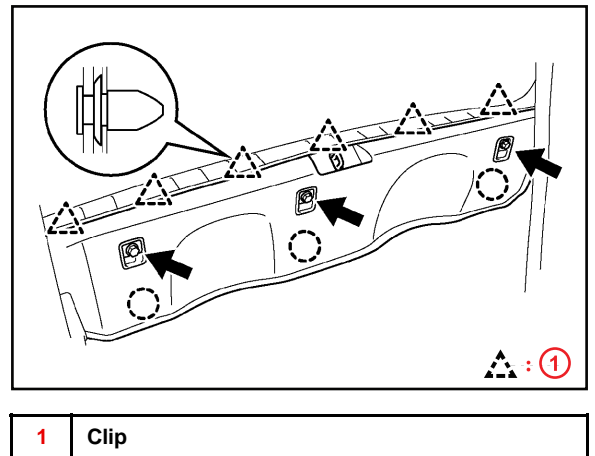

5. Remove the quarter trim front panel assembly LH.
 - A. Remove the floor anchor cover.
 - B. Remove the bolt and disconnect the rear No. 2 seat belt on the floor anchor side.

SRS Light "ON" - B0111/B0116 - Open Side Squib Circuit

Repair Procedure: Floor Wire Harness Removal (Continued)

C. Remove the 2 package holder net hooks.

Figure 2.

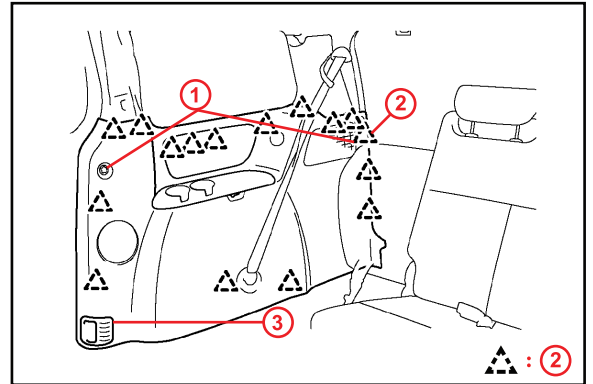

1	Hook
2	Clip
3	Courtesy Light

D. Using a plastic pry tool, disengage the claw and remove the courtesy light.

E. Disconnect the courtesy light connectors.

F. Using a plastic pry tool, disengage the 16 clips and remove the quarter trim panel assembly.

6. Remove the No. 2 speaker assembly with box by disconnecting the connector and removing the 5 bolts.

Figure 3.

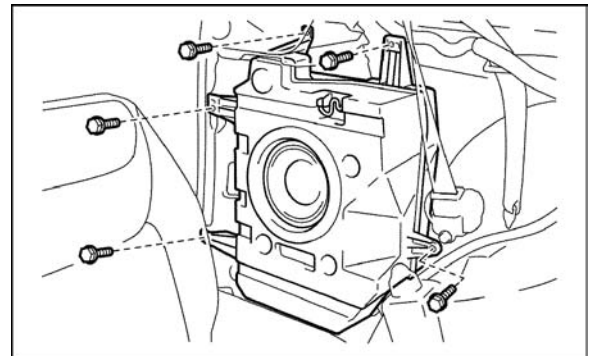

7. Remove the right rear window side garnish assembly No. 2 LH.

SRS Light "ON" - B0111/B0116 - Open Side Squib Circuit

Repair Procedure: Floor Wire Harness Removal (Continued)

8. Remove the power back door rod by removing the 2 clips.

Figure 4.

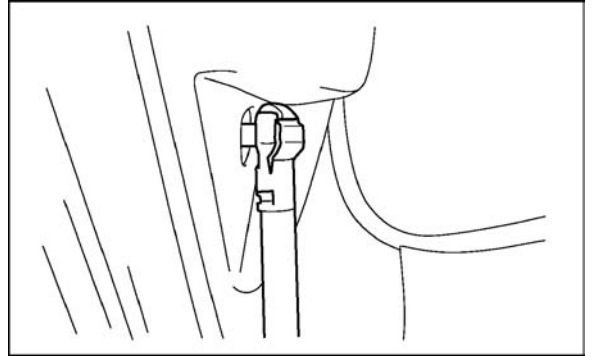

9. Remove the power back door drive unit by removing the 3 bolts.

Figure 5.

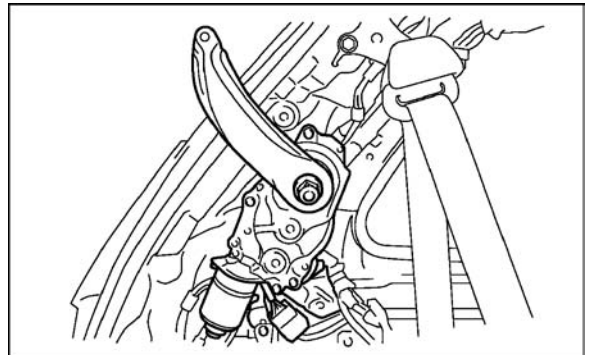

10. Remove the rear speaker assembly by disconnecting the connector and removing the 3 screws.

Figure 6.

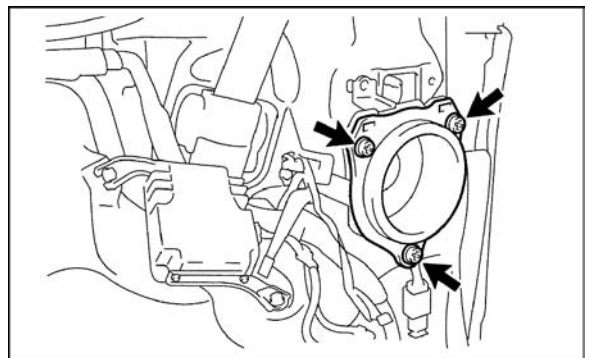

SRS Light "ON" - B0111/B0116 - Open Side Squib Circuit

Repair Procedure: Floor Wire Harness Removal (Continued)

11. Remove the parking brake control pedal assembly. **Figure 7.**

- A. Remove the 4 nuts and separate the instrument panel junction block assembly w/ wiring harness connector from the body.
- B. Disconnect the parking brake switch connector.
- C. Remove the bolt, 2 nuts, and parking brake control pedal assembly.

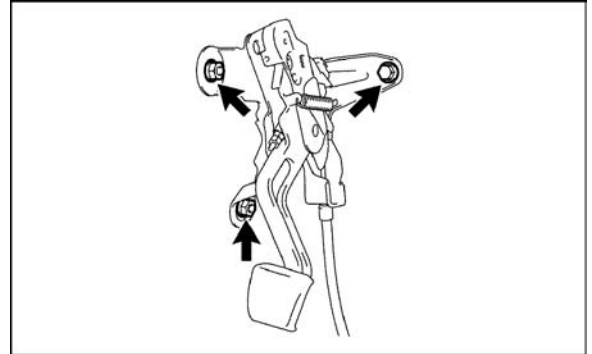

12. Remove the floor wire harness.

RH Side Only (steps 13 – 23):

13. Remove the back door scuff plate.

- A. Remove the 3 bolts.
- B. Using a plastic pry tool, disengage the 6 clips and remove the scuff plate.

Figure 8.

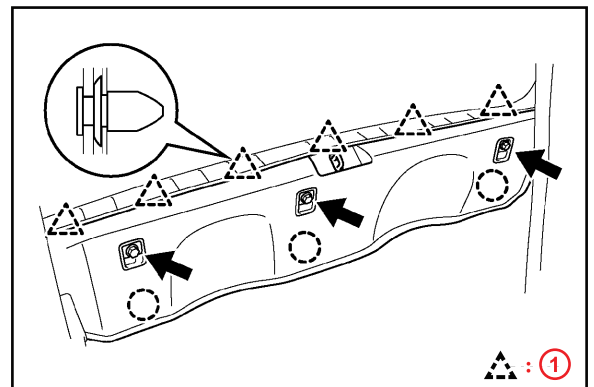

1	Clip
----------	-------------

14. Remove the quarter trim front panel assembly LH.

- A. Remove the floor anchor cover.
- B. Remove the bolt and disconnect the rear No. 2 seat belt on the floor anchor side.

SRS Light "ON" - B0111/B0116 - Open Side Squib Circuit

Repair Procedure: Floor Wire Harness Removal (Continued)

C. Remove the 2 package holder net hooks.

Figure 9.

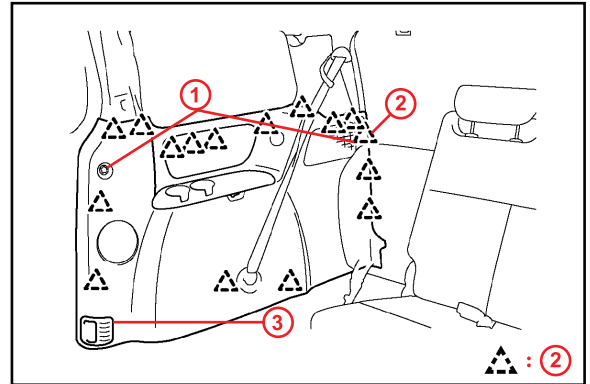

1	Hook
2	Clip
3	Courtesy Light

D. Using a plastic pry tool, disengage the claw and remove the courtesy light.

E. Disconnect the courtesy light connectors.

F. Using a plastic pry tool, disengage the 16 clips and remove the quarter trim panel assembly.

15. Remove the roof headlining garnish rear by disengaging the 6 clips with a plastic pry tool.

Figure 10.

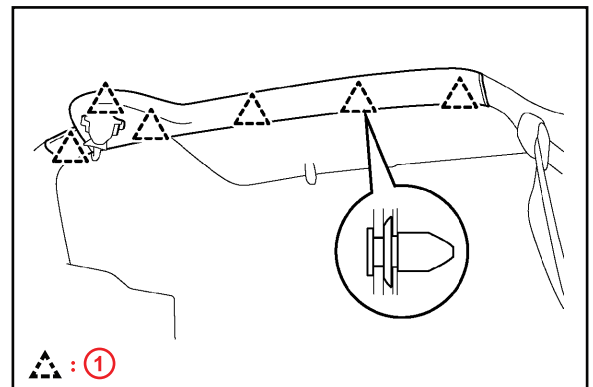

1	Clip
----------	------

SRS Light "ON" - B0111/B0116 - Open Side Squib Circuit

Repair Procedure: Floor Wire Harness Removal (Continued)

16. Remove the right rear window side garnish assembly No. 2 RH.

- A. Using a plastic pry tool, disengage the 2 claws and remove the cover of the rear No. 2 seat belt on the shoulder anchor side.

Figure 11.

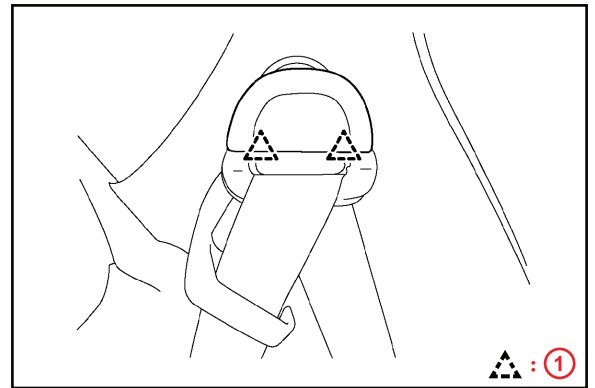

1	Claw
----------	-------------

- B. Remove the bolt and disconnect the rear No. 2 seat belt assembly on the shoulder anchor side.
- C. Using a plastic pry tool, disengage the 5 clips and remove the side garnish.

Figure 12.

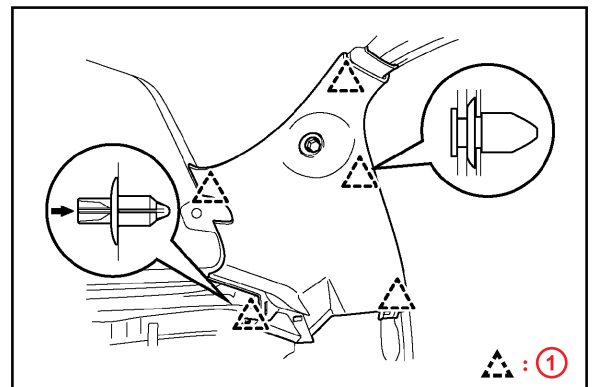

1	Clip
----------	-------------

SRS Light "ON" - B0111/B0116 - Open Side Squib Circuit

Repair Procedure: Floor Wire Harness Removal (Continued)

17. Remove the air duct assemblies.

A. Remove the 2 clips and the air duct assembly from the air conditioning blower assembly.

Figure 13.

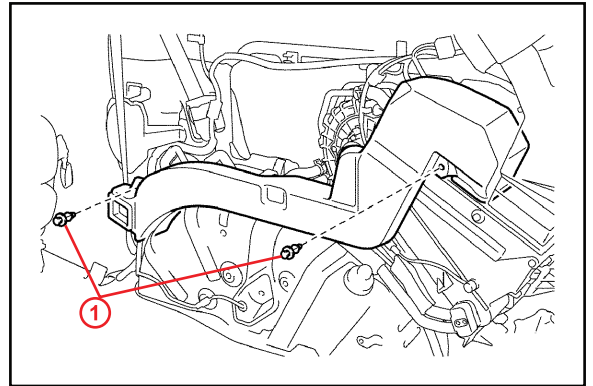

1	Clip
----------	-------------

B. Remove the cover sub-assembly by disengaging the 2 claw fittings.

Figure 14.

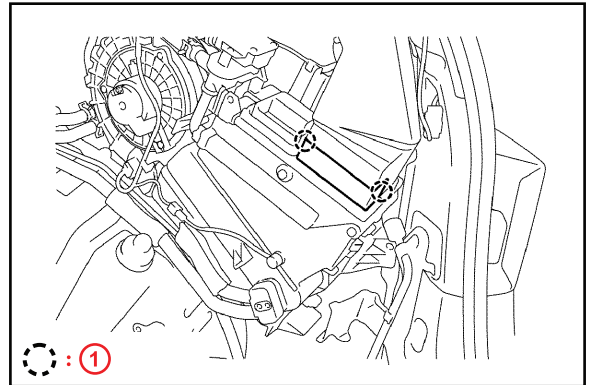

1	Claw
----------	-------------

SRS Light "ON" - B0111/B0116 - Open Side Squib Circuit

Repair Procedure: Floor Wire Harness Removal (Continued)

C. Remove the air duct assembly.

Figure 15.

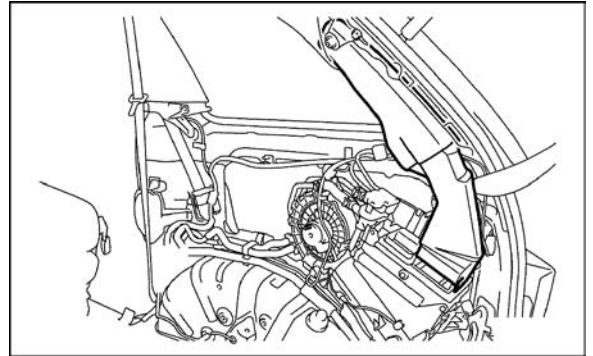

18. Remove the rear door scuff plate by disengaging the 8 clips with a plastic pry tool.

Figure 16.

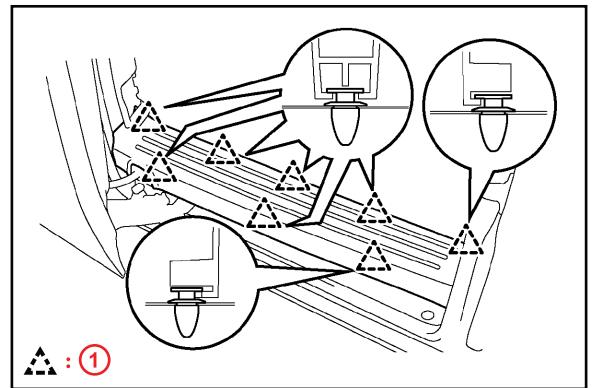

1	Clip
----------	-------------

19. Remove the rear door weatherstrip RH.

HINT

When reinstalling the weatherstrip, completely remove the sealer adhering to the opening flange on the body side beforehand.

20. Remove the back door weatherstrip.

21. Remove the quarter trim front panel assembly RH.

A. Remove the floor anchor cover.

B. Remove the bolt and disconnect the rear No. 2 seat belt on the floor anchor side.

SRS Light "ON" - B0111/B0116 - Open Side Squib Circuit

Repair Procedure: Floor Wire Harness Removal (Continued)

C. Remove the 2 package holder net hooks.

Figure 17.

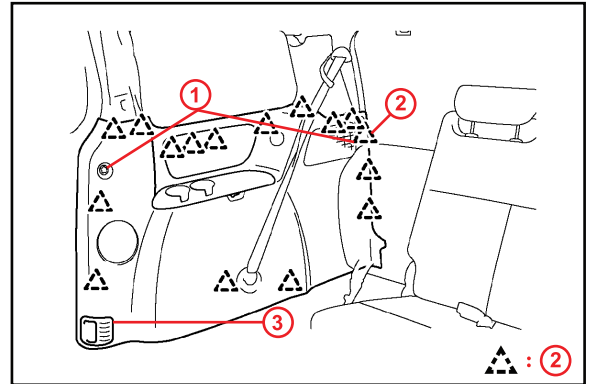

1	Hook
2	Clip
3	Courtesy Light

D. Using a plastic pry tool, disengage the claw and remove the courtesy light.

E. Disconnect the courtesy light connectors.

F. Using a plastic pry tool, disengage the 16 clips and remove the quarter trim panel assembly.

22. Remove the rear speaker assembly by disconnecting the connector and removing the 3 screws.

Figure 18.

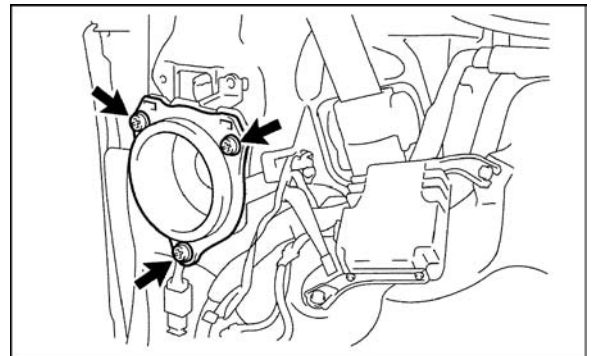

23. Remove the floor wire harness.

SRS Light "ON" - B0111/B0116 - Open Side Squib Circuit

Repair Procedure: Floor Wire Harness Installation

NOTE

Installation is in the reverse order of removal. Only key installation points are noted below.

1. Install the NEW floor wire harness.
2. Install the parking brake control pedal assembly **(LH only)**.

- A. Install the parking brake control pedal assembly with a bolt and the 2 nuts.

Torque: 39 N*m (398 kgf*cm, 29 ft*lbf)

- B. Connect the parking brake switch connector.

- C. Connect the instrument panel junction block assembly with the 4 nuts.

Torque: 7.3 N*m (74 kgf*cm, 65 in*lbf)

3. Install the power back door drive unit **(LH only)**.

- A. Install the drive unit with the 3 bolts.

Torque: 12.5 N*m (112 kgf*cm, 9 ft*lbf)

- B. Reset the drive unit.

Figure 19.

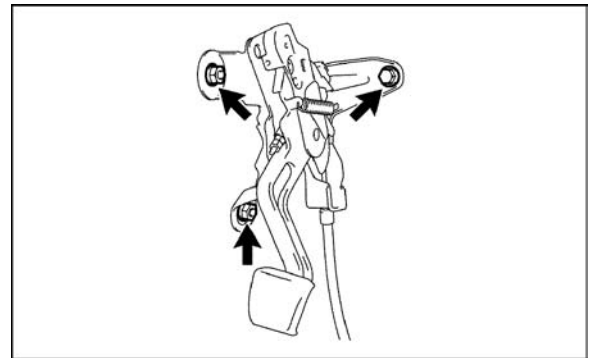
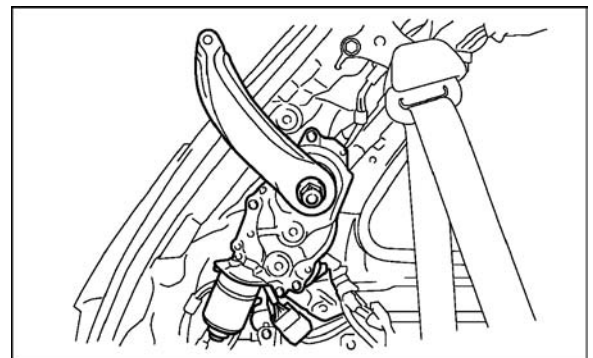

Figure 20.



4. Install the front shoulder belt anchor adjuster assembly with the bolt.

Torque: 42 N*m (430 kgf*cm, 31 ft*lbf)

5. Install the center pillar upper garnish.

SRS Light "ON" - B0111/B0116 - Open Side Squib Circuit

Repair Procedure: Floor Wire Harness Installation (Continued)

6. Install the front seat outer belt assembly.

NOTICE

Do NOT disassemble the retractor.

- A. Install the retractor with the 2 bolts.
Torque: 42 N*m (430 kgf*cm, 31 ft*lbf)
- B. Install the shoulder anchor with the nut.
Torque: 42 N*m (430 kgf*cm, 31 ft*lbf)
- C. Install the floor anchor with the bolt.
Torque: 42 N*m (430 kgf*cm, 31 ft*lbf)
- D. Install the floor anchor cover.
- E. Check the ELR lock.

NOTICE

The check should be performed with the assembly installed.

Check that the belt locks when pulling out the belt quickly when the belt is installed.

If operation is NOT as specified, replace the front seat outer belt assembly.

- F. Check the fastening function of the lock mode for the child restraint systems.

NOTICE

The check should be performed with the assembly installed.

- (1) Check that the belt cannot be pulled out any more but can be rewound after the belt is fully pulled out.
- (2) Check that the belt can be pulled out and rewound after the belt is fully rewound.

If operation is NOT as specified, replace the front seat outer belt assembly.

7. Install the center pillar lower garnish.
8. Install the front door weatherstrip.
9. Install the rear door weatherstrip.
10. Install the front door scuff plate.
11. Install the rear door scuff plate.

SRS Light "ON" - B0111/B0116 - Open Side Squib Circuit

Repair Procedure: Floor Wire Harness Installation (Continued)

12. Install the front seat assembly.

HINT

Refer to the Repair Manual instructions for each type of seat assembly.

Refer to TIS, applicable model year Sienna Repair Manual:

- **2005 Sienna:**
Vehicle Interior – Seat – “Front Seat Assembly ([Fold Flat Type](#)) / ([Manual Seat Type](#)) / ([Power Seat Type](#)): Overhaul”
- **2006 Sienna:**
Vehicle Interior – Seat – “Seat: Front Seat Assembly ([for Flat Type](#)) / ([for Manual Seat](#)) / ([for Power Seat](#)): Installation”
- **2007 Sienna:**
Vehicle Interior – Seat – “Seat: Front Seat Assembly ([for Flat Type](#)) / ([for Manual Seat](#)) / ([for Power Seat](#)): Installation”
- **2008 Sienna:**
Vehicle Interior – Seat – “Seat: Front Seat Assembly ([for Flat Type](#)) / ([for Manual Seat](#)) / ([for Power Seat](#)): Installation”
- **2009 Sienna:**
Vehicle Interior – Seat – “Seat: Front Seat Assembly ([for Flat Type](#)) / ([for Manual Seat](#)) / ([for Power Seat](#)): Installation”

13. Re-install the instrument panel.

Refer to TIS, applicable model year Sienna Repair Manual:

- [2005](#) Sienna:
Vehicle Interior – Interior Panels/Trim – “Instrument Panel Safety Pad Sub-Assy: Replacement”
- [2006](#) / [2007](#) / [2008](#) / [2009](#) Sienna:
Vehicle Interior – Interior Panels/Trim – “Instrument Panel: Instrument Panel Safety Pad: Installation”

14. Initialize the front passenger Occupant Classification System (OCS).

Refer to TIS, applicable model year Sienna Repair Manual:

- [2005](#) Sienna:
Vehicle Interior – Supplemental Restraint Systems – “Supplemental Restraint System: Initialization”
- [2006](#) / [2007](#) / [2008](#) / [2009](#) Sienna:
Vehicle Interior – Supplemental Restraint Systems – “Supplemental Restraint System: Occupant Classification System: Initialization”

SRS Light "ON" - B0111/B0116 - Open Side Squib Circuit

Repair Procedure: Floor Wire Harness Installation (Continued)

15. Initialize power systems (windows, moon roof, etc.). Refer to the appropriate Service Bulletin on TIS.