

SMITH-COOPER®

I N T E R N A T I O N A L

CORPORATE OFFICE TEL (800) 766-0076 LOCAL (323) 890-4455 FAX (323) 890-4456
WWW.SMITHCOOPER.COM



Stainless Steel Butt Weld Fittings

SMITH-COOPER®

INTERNATIONAL



Stainless Weld Fittings

Specifications

- Stainless Weld Fittings conform to ASTM A403, ASTM A960, MSS SP-43;
- Stainless Weld Fitting Dimensions conform to ASTM B16.9 (except Wall) and MSS SP-43
- Manufacturing Facility is ISO 9001-2000
- Independent lab verification that fittings meet applicable chemical & physical properties

SCI Quality Plus

- Quality control inspections both at the overseas factory and our US warehouses
- Company engineer available at your request
- \$10,000,000 product liability insurance
- SCI 5/50 guarantee
- Pro Pak System makes products easier to handle and warehouse
- Orders shipped within 24 hours
- Fax confirmation of every order
- Knowledgeable customer service personnel

Warranty and Limitations of Liability

SMITH-COOPER INTERNATIONAL (SCI) warrants to its initial purchaser only, that its products which are delivered to this initial purchaser will be of the kind described in the order or price list and will be free of defects in workmanship or material for a period of five years from the date of delivery to our initial purchaser.

Should any failure to conform to this warranty appear within five years after the date of the initial delivery to our initial purchaser, SCI will, upon written notification thereof and substantiation that the goods have been stored, installed, maintained and operated in accordance with recognized engineering and piping practices and industry standards, correct such defects by suitable repair or replacement (which alternative shall be at the discretion of SCI) of product at SCI's own expense upon return of the defective part to SCI.

In the event that SCI elects to replace the defective product, SCI shall pay up to \$50 per defective product for total cost of replacement. In the event of multiple claims, such payment shall be no greater than \$1,000 for each installation project.

This warranty applies only during normal use that meets the above referenced conditions of installation and operation and is absolutely void if the product has been damaged after purchase or if it has been misused, repaired, altered or modified in any manner whatsoever. SCI shall not warranty any of its products if any portion of the product including without limitation, any component, gasket, housing or bolt has been modified, altered, remanufactured or replaced in any manner by any customer, user of the product or third party.

Correction of non-conformities, in the manner and for the period of time provided above, shall constitute fulfillment of all liabilities of SCI to our initial purchaser, with respect to the goods, whether based on contract, negligence, strict tort, or otherwise. It is the intention of SCI that no warranty of any kind, whether expressed or implied shall pass through our initial purchaser to any other person or corporation.

No returns will be allowed unless prior written permission of SCI is first obtained. Buyers shall be responsible for all costs of transportation as well as a restocking charge.

This warranty is exclusively for the benefit of the initial purchaser of this product from SCI and, except to the extent prohibited by applicable law, the foregoing warranty is in lieu of all other warranties, express or implied, including but not limited to warranties of fitness or merchantability.

LIMITATIONS OF LIABILITY: SCI shall not under any circumstances be liable for special or consequential damages such as, but not limited to damage to loss of other property or equipment, loss of profits or revenue, cost of capital, cost of purchased or replacement goods, claims of customers of our initial purchaser, any labor cost for repair or replacement of the product or damage caused by the product.

The remedies of our initial purchaser, and all others, set forth herein are exclusive, and the liability of SCI with respect to same shall not, except as expressly provided herein, exceed the price of the SCI products on which such liability is based.



Stainless Weld Fittings Dimensions

90° Elbow Long Radius

Size	Dimensions (in)		Weight (lb)	
	OD	A	Sch 10	Sch 40
1/2	0.840	1.50	0.100	0.130
3/4	1.050	1.12	0.100	0.130
1	1.315	1.50	0.180	0.290
1-1/4	1.660	1.88	0.250	0.470
1-1/2	1.90	2.25	0.360	0.640
2	2.375	3.00	0.620	1.090
2-1/2	2.875	3.75	1.210	1.820
3	3.50	4.50	1.740	2.680
3-1/2	4.00	5.25	2.330	3.590
4	4.50	6.00	3.010	4.620
5	5.563	7.50	6.100	8.000
6	6.625	9.00	8.950	11.50
8	8.625	12.00	15.40	22.00
10	10.75	15.00	29.20	38.60
12	12.75	16.00	52.00	59.50

90° Elbow Short Radius

Size	Dimensions (in)		Weight (lb)	
	OD	A	Sch 10	Sch 40
1/2	-	-	-	-
3/4	-	-	-	-
1	1.315	1.00	0.160	0.180
1-1/4	1.660	1.25	0.220	0.300
1-1/2	1.90	1.50	0.300	0.420
2	2.375	2.00	0.460	0.700
2-1/2	2.875	2.50	0.930	1.200
3	3.50	3.00	1.220	1.700
3-1/2	4.00	3.50	1.620	2.300
4	4.50	4.00	2.100	3.000
5	5.563	5.00	4.200	5.200
6	6.625	6.00	6.300	8.200
8	8.625	8.00	10.50	14.20
10	10.75	10.00	20.00	25.00
12	12.75	12.00	34.00	39.00

45° Elbow

Size	Dimensions (in)		Weight (lb)	
	OD	A	Sch 10	Sch 40
1/2	0.840	0.62	0.070	0.090
3/4	1.050	0.44	0.070	0.090
1	1.315	0.86	0.140	0.170
1-1/4	1.660	1.00	0.230	0.290
1-1/2	1.90	1.12	0.320	0.420
2	2.375	1.36	0.540	0.750
2-1/2	2.875	1.75	0.910	1.490
3	3.50	2.00	1.340	2.340
3-1/2	4.00	2.25	1.790	3.280
4	4.50	2.50	2.310	4.450
5	5.563	3.12	4.000	7.550
6	6.625	3.75	5.750	11.80
8	8.625	5.00	11.10	23.50
10	10.75	6.25	19.30	41.80
12	12.75	7.50	29.80	61.50

Tee

Size	Dimensions (in)		Weight (lb)	
	OD	A	Sch 10	Sch 40
1/2	0.840	1.00	0.230	0.300
3/4	1.050	1.125	0.300	0.470
1	1.315	1.50	0.550	0.600
1-1/4	1.660	1.68	1.150	1.100
1-1/2	1.90	2.25	1.610	1.610
2	2.375	2.50	1.720	4.160
2-1/2	2.875	3.00	2.870	6.350
3	3.50	3.38	3.820	8.410
3-1/2	4.00	3.75	4.800	11.40
4	4.50	4.12	5.800	13.20
5	5.563	4.88	10.30	21.90
6	6.625	5.520	14.60	34.60
8	8.625	7.00	24.00	61.00
10	10.75	8.6	40.00	89.00
12	12.75	10.00	56.00	145.0

Cross

Size	Dimensions (in)		Weight (lb)	
	OD	A	Sch 10	Sch 40
1/2	0.840	1.00	0.378	0.336
3/4	1.050	1.125	0.540	0.480
1	1.315	1.50	0.720	0.650
1-1/4	1.660	1.68	1.260	1.320
1-1/2	1.90	2.25	1.720	1.910
2	2.375	2.50	2.150	2.860
2-1/2	2.875	3.00	3.560	4.900
3	3.50	3.38	4.480	7.370
3-1/2	4.00	3.75	6.760	9.090
4	4.50	4.12	8.770	11.74
5	5.563	4.88	15.46	20.95
6	6.625	5.520	20.47	24.49
8	8.625	7.00	39.67	46.56
10	10.75	8.6	67.85	78.78
12	12.75	10.00	100.0	138.0

Cap

Size	Dimensions (in)		Weight (lb)	
	OD	A	Sch 10	Sch 40
1/2	0.840	1.00	0.070	0.070
3/4	1.050	1.00	0.120	0.130
1	1.315	1.50	0.160	0.220
1-1/4	1.660	1.50	0.220	0.310
1-1/2	1.90	1.50	0.280	0.370
2	2.375	15.0	0.410	0.510
2-1/2	2.875	1.50	0.530	0.810
3	3.50	2.00	0.830	1.420
3-1/2	4.00	2.50	1.010	2.140
4	4.50	2.50	1.260	2.540
5	5.563	3.00	2.430	4.190
6	6.625	3.50	3.110	6.440
8	8.625	4.00	5.460	11.20
10	10.75	5.00	9.950	20.00
12	12.75	6.00	14.72	35.40

Weld Fittings conform to ASTM A403, ASTM A960, MSS-SP-43, ASTM B16.9, A774 where applicable



Stainless Weld Fittings - Weights

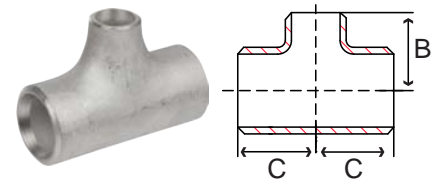
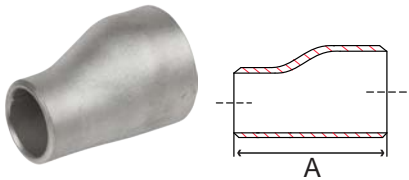
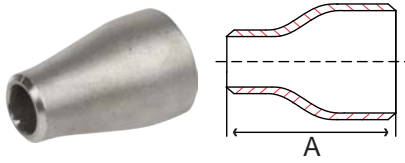

Dimensions

Nominal Size	Reducers		Reducing Tee	
	Concentric	Eccentric		
	Dimensions (in)			
	A	B	C	
3/4 x 1/2	1-1/2	1-1/8	1-1/8	
1 x 1/2	2	1-1/2	1-1/2	
1 x 3/4	2	1-1/2	1-1/2	
1-1/4 x 1/2	2	1-7/8	1-7/8	
1-1/4 x 3/4	2	1-7/8	1-7/8	
1-1/4 x 1	2	1-7/8	1-7/8	
1-1/2 x 1/2	2-1/2	2-1/4	2-1/4	
1-1/2 x 3/4	2-1/2	2-1/4	2-1/4	
1-1/2 x 1	2-1/2	2-1/4	2-1/4	
1-1/2 x 1-1/4	2-1/2	2-1/4	2-1/4	
2 x 3/4	3	2-1/2	1-3/4	
2 x 1	3	2-1/2	2	
2 x 1-1/4	3	2-1/2	2-1/4	
2 x 1-1/2	3	2-1/2	2-3/8	
2-1/2 x 1	3-1/2	3	2-1/4	
2-1/2 x 1-1/4	3-1/2	3	2-1/2	
2-1/2 x 1-1/2	3-1/2	3	2-5/8	
2-1/2 x 2	3-1/2	3	2-3/4	
3 x 1	3-1/2	3-3/8		
3 x 1-1/4	3-1/2	3-3/8	2-3/4	
3 x 1-1/2	3-1/2	3-3/8	2-7/8	
3 x 2	3-1/2	3-3/8	3	
3 x 2-1/2	3-1/2	3-3/8	3-1/4	
3-1/2 x 1-1/2	4	3-3/4	3-1/8	
3-1/2 x 2	4	3-3/4	3-1/4	
3-1/2 x 2-1/2	4	3-3/4	3-1/2	
3-1/2 x 3	4	3-3/4	3-5/8	
4 x 1-1/2	4	4-1/8	3-3/8	
4 x 2	4	4-1/8	3-1/2	
4 x 2-1/2	4	4-1/8	3-3/4	
4 x 3	4	4-1/8	3-7/8	
4 x 3-1/2	4	4-1/8	4	
5 x 2	5	4-7/8	4-1/8	
5 x 2-1/2	5	4-7/8	4-1/4	
5 x 3	5	4-7/8	4-3/8	
5 x 3-1/2	5	4-7/8	4-1/2	

Dimensions, cont.

Nominal Size	Reducers		Reducing Tee	
	Concentric	Eccentric		
	Dimensions (in)			
	A	B	C	
5 x 4	5	4-7/8	5	
6 x 2-1/2	5-1/2	5-5/8	4-3/4	
6 x 3	5-1/2	5-5/8	4-7/8	
6 x 3-1/2	5-1/2	5-5/8	5	
6 x 4	5-1/2	5-5/8	5-1/8	
6 x 5	5-1/2	5-5/8	5-3/8	
8 x 3	6	7		
8 x 3-1/2	6	7	6	
8 x 4	6	7	6-1/8	
8 x 5	6	7	6-3/8	
8 x 6	6	7	6-5/8	
10 x 4	7	8-1/2	7-1/4	
10 x 5	7	8-1/2	7-1/2	
10 x 6	7	8-1/2	7-5/8	
10 x 8	7	8-1/2	8	
12 x 5	8	10	8-1/2	
12 x 6	8	10	8-5/8	
12 x 8	8	10	9	
12 x 10	8	10	9-1/2	

Weights

Nominal Size	Reducers		Reducing Tee	
	Concentric	Eccentric		
	Weight (lb)			
	Sch 10	Sch 40	Sch 10	Sch 40
3/4	0.140	0.210	0.300	0.470
1	0.150	0.250	0.550	0.600
1-1/4	0.200	0.340	1.150	1.100
1-1/2	0.230	0.380	1.610	1.610
2	0.340	0.580	1.720	4.160
2-1/2	0.600	0.860	2.870	6.350
3	0.740	1.080	3.820	8.410
3-1/2	1.000	1.430	4.800	11.40
4	1.110	1.610	5.800	13.20
5	2.340	2.850	10.30	21.90
6	3.170	3.910	14.60	34.60
8	4.550	6.180	24.00	61.00
10	8.160	10.05	40.00	89.00
12	14.15	15.38	56.00	145.0

Weld Fittings conform to ASTM A403, ASTM A960, MSS-SP-43, ASTM B16.9, A774 where applicable

SMITH-COOPER INTERNATIONAL® • TOLL FREE 1-800-766-0076 • FAX (323) 890-4456 • www.smithcooper.com



Stainless Stub Ends

MSS Type A Stub End

Nominal Size	Outside Diameter (OD)	A	B	R	Weight (lb)	
					Sch 10	Sch 40
1/2	0.840	1.38	2.00	0.125	0.170	0.250
3/4	1.050	1.69	2.00	0.125	0.190	0.340
1	1.315	2.00	2.00	0.125	0.310	0.410
1-1/4	1.660	2.50	2.00	0.187	0.460	0.580
1-1/2	1.90	2.88	2.00	0.250	0.550	0.830
2	2.375	3.62	2.50	0.313	0.830	1.190
2-1/2	2.875	4.12	2.50	0.313	1.040	1.760
3	3.50	5.00	2.50	0.375	1.410	2.500
3-1/2	4.00	5.50	3.00	0.375	1.840	3.250
4	4.50	6.19	3.00	0.436	2.160	4.000
5	5.563	7.31	3.00	0.436	2.730	5.600
6	6.625	8.50	3.50	0.500	4.300	8.200
8	8.625	10.625	4.00	0.500	6.850	13.00
10	10.75	12.75	5.0	0.500	10.73	23.00
12	12.75	15.00	6.0	0.500	12.69	33.00

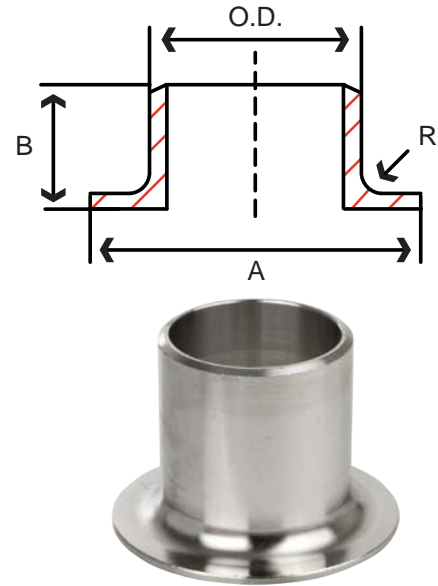

MSS Type C Stub End

Nominal Size	Outside Diameter (OD)	A	B	R	Weight (lb)	
					Sch 10	Sch 40
1/2	0.840	1.38	2.00	0.031	0.170	0.250
3/4	1.050	1.69	2.00	0.031	0.190	0.340
1	1.315	2.00	2.00	0.031	0.310	0.410
1-1/4	1.660	2.50	2.00	0.031	0.460	0.580
1-1/2	1.90	2.88	2.00	0.031	0.550	0.830
2	2.375	3.62	2.50	0.031	0.830	1.190
2-1/2	2.875	4.12	2.50	0.031	1.040	1.760
3	3.50	5.00	2.50	0.031	1.410	2.500
3-1/2	4.00	5.50	3.00	0.031	1.840	3.250
4	4.50	6.19	3.00	0.063	2.160	4.000
5	5.563	7.31	3.00	0.063	2.730	5.600
6	6.625	8.50	3.50	0.063	4.300	8.200
8	8.625	10.625	4.00	0.063	6.850	13.00
10	10.75	12.75	5.0	0.063	10.73	23.00
12	12.75	15.00	6.0	0.063	12.69	33.00

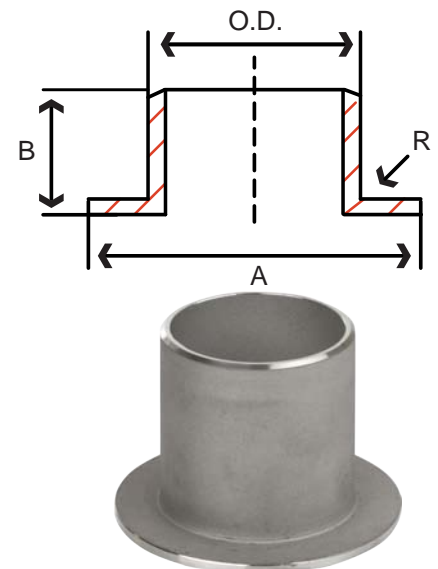



Stainless Weld Fittings - Part Number

S20 1 4 C 004

Product Line	
S20	S10/40 Butt Weld Fittings
S22	Stub Ends
S23	Domestic Butt Weld Fittings

Schedule	
1	Schedule 10
4	Schedule 40
8	Schedule 80

Alloy	
4	304/304L
6	316/316L

Item Code	
C	Cap
CR	Concentric Reducer
X	Cross
ER	Eccentric Reducer
LE	90° Elbow
F	45° Elbow
RT	Reducing Tee
E	Short Radius 90's
T	Tee
MA	Type A Stub End
MC	Type C Stub End

Size	
004	1/2"
006	3/4"
010	1"
012	1-1/4"
014	1-1/2"
020	2"
024	2-1/2"
030	3"
034	3-1/2"
040	4"
050	5"
060	6"
080	8"
100	10"
120	12"



150# Fittings

304 & 316
1/8" - 4"



Weld Fittings

304L & 316L Sch 10, 40 & 80
1/2" - 12"



Nipples

304L & 316L
SCH 40 WELDED & SCH 80 SEAMLESS
1/8" - 4" DIAMETER • CLOSE - ANY LENGTH



Pipe & Sanitary Tubing

Pipe, 304/304L & 316/316L
Sch 10, 40 & 80
Welded & Seamless 1/8" - 8"
Sanitary Tubing 1" - 4"



Flanges

304/304L & 316/316L
150# & 300# • 1/2" - 12"



3000# Forged Fittings

304L & 316L
THREADED & SOCKET WELD
1/8" - 4"



Belled-End Fittings

304L & 316L
1/2" - 2"



Valves

316/316L CAST AND FORGED
150#, 200#, 300#, 600#, 800#
BALL, GATE, GLOBE, & CHECK • 1/4" - 12"



Grooved Fittings

304L & 316L
Sch 10 & Sch 40
1-1/2" - 12"



Compression Fittings

316 STAINLESS
DOUBLE FERRULE

Instrumentation Tubing

304/304L & 316/316L
WELDED & SEAMLESS • 1/16" - 1"



Fabrication & Machining

FLANGED FITTINGS MADE TO ORDER
CUSTOM MACHINING OF FLANGES



Specialty Fittings

316 KING COMBO NIPPLES
WELD SPUDS
HEX NIPPLES

SMITH-COOPER®
INTERNATIONAL