

**STAGE  
LINE**®



# SL 100

HYDRAULIC **MOBILE STAGE**





**STAGELINE HAS EARNED ITS REPUTATION AS THE LEADING DESIGNER AND MANUFACTURER OF MOBILE STAGES THAT INSPIRE UNMATCHED LEVELS OF CONFIDENCE.**

**ALL OUR IDEAS, CONCEPTS AND DEVELOPMENTS ARE USER ORIENTED. DECADES OF EXPERIENCE WITH OUTDOOR EVENTS ARE EMBODIED IN EVERY SINGLE ONE OF OUR MOBILE STAGES.**

**STAGELINE MOBILE STAGES, SERVICES AND SOLUTIONS ENABLE TECHNICIANS, CREATIVE DESIGNERS, ARTISTS AND EVENT ORGANISERS TO CARRY OUT THEIR WORK WITH PEACE OF MIND AND COMPLETE SATISFACTION.**



**STRONG  
RIGID & LIGHT**

WEIGHT SAVING BENEFITS MAKE ALUMINUM THE BEST CHOICE FOR A STAGE OF THIS SIZE. EXTRUSIONS, RIVETING, AND EXPERT WELDING ARE ALL COMBINED TO BUILD A STATE OF THE ART STAGELINE MOBILE STAGE.



# MOBILITY ROAD PERFORMANCE



EASILY TOWED WITH A STANDARD PICK UP TRUCK



## ON AND OFF ROAD WITH TRUE TRACK ENGINEERING

Stageline mobile stages are complex to build since they perform as road legal trailers and as outdoor stages.

TRUE TRACK ENGINEERING combines a custom Stageline chassis with multiple hinged panels and telescoping structures that will not alter in performance from mileage and bad roads. True Track results in excellent road handling and safety year after year.

### HAULING OPTIONS



Drawbar for  
pintle hook

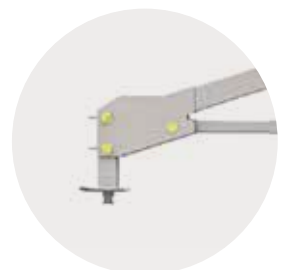

King pin for  
fifth wheel

*Other coupler options available.*

# STAGELINE SL100

A STAGE ABOVE ANY OTHER CATEGORY  
WITH A FULLY HYRAULIC SET UP



1



Level the unit & hydraulically position the deck and roof panels.

2



Hang sound, lighting, banners and sets at ground and deck level.

3



Suspend loads of up to 3,800 lbs (1,725 kg) from the roof before raising it.

FLOOR	SET-UP	WIND RESISTANCE	RIGGING
24' X 20' (7 M X 6 M)	2* 0H30	80 MPH (129 KM/H)	6,500 LB (2,948 KG)

## FAST & EASY

\* Stageline promotes safe working habits by having a minimum of two workers on every job site.

# ALL AROUND SAFETY & RELIABILITY THROUGH INNOVATION



## TOTAL CONTROL INSTALLATION

Pre-assembled rigid structural panels unfold hydraulically and sequentially. Locking devices and pins are incorporated into every step of the set up ensuring total control of the installation in complete safety. Totally self standing, the stage does not need to be secured with ballast and cables to maintain its stability and structural integrity.



## RAISE AND LOWER THE ROOF SECURELY WITH DOUBLE MASTS WITH LIFTING MECHANISM

A set of sturdy masts lifts and lowers the roof and show support equipment. They function with balanced or unbalanced loads even in difficult weather conditions.





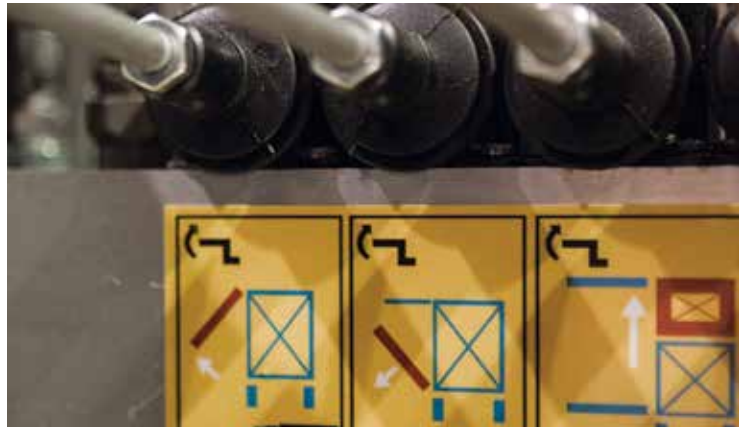

## RIGGING SHOW SUPPORT EQUIPMENT MADE EASY AT GROUND AND DECK LEVEL

Industry standard rigging points, trusses and beams facilitate the installation of equipment. Cuts down on climbing and set up time.



## CUSTOMIZED HYDRAULICS WITH BACK UP

Calibrated power from precision designed cylinders and components yield a perfect flow with safe, well-timed speed of operation. Comes with safety valves that block the liquid flow and undue movements when needed. Easy and safe throughout with minimum effort and operation. Very low maintenance.



## FIBER LOCK PANELS

In closed position the roof panels of the stage become the side panels of a hard shell trailer. Fiber Lock is a process where fiberglass is wrapped around the aluminum frame. This method has multiple functions to address esthetics and durability. Both structural and weather protective, this layering process compensates for movement and structural deflection of the panels when they are hydraulically deployed. The process eliminates damage from road vibrations and extreme weather conditions. The fiberglass panels never need replacement and they remain safe and great looking year in and year out.



# SAFETY AND RELIABILITY UNDER ALL SKIES, IN ALL CONDITIONS

The SL100 is specifically designed and engineered to be safely transported, safely deployed and safely used outdoors. Designed to make production logistics easy, it sets up rapidly as all the work is done at deck and ground level reducing the risk for potential human error and accidents.

## MOTHER NATURE WILL NOT STEAL THE SHOW

The SL100 is a tough machine that withstands today's changing climatic conditions.

The SL100 offers superior protection through the use of the highest standards and the most innovative built in features. It demonstrates unique capacities to resist high winds, to protect gear, talent and crew even under the most demanding outdoor situations.

## SUPERIOR DESIGN FOR LOADS & RIGGING

The SL100 is built and tested with the highest load and rigging design criteria in the industry – up to 2 times the permitted load.

Engineering calculations are based on the IBC (International Building Codes) and NBC (Canadian Building Codes).

## HIGHEST WIND RESISTANCE IN THE INDUSTRY

80 mph (129 km/h) without wind walls and 60 mph (97 km/h) with wind walls.



# SHOW YOUR COLORS



THE SL 100 IS A MOVING BILLBOARD.

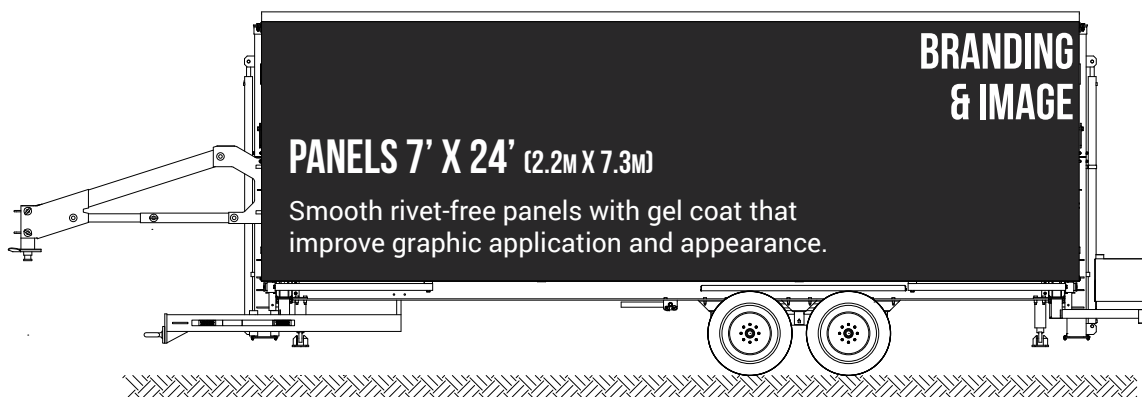

SL100 MIX



# MAXIMUM VISIBILITY



- 1 Optional equipment to easily install lateral, roof top and backdrop banners.
- 2 Printed wind walls and skirts are available.
- 3 The SL100 offers maximum banner space to showcase your event.
- 4 The hardware is designed to provide a nice fit and resist gust winds.





## STAGELINE SL 100 OPTION - MIX POSITION / FOH



This is a technician's FOH dream. Two Stageline equipment in one - when not being used as a stage, it is transformed into a mixing position.

For sound, light, mix, delay towers, broadcasting & event coverage, indoor or out. A spacious multi-level and weather protected FOH unit ready in 1½ hours.

### STANDARD EQUIPMENT

Central roof made of FRP bonded to 2" (50 mm) aluminium tubing

Guardrails on central roof

Technician ladder to access central roof

Low and adjustable floor: 22' x 6'-10" (6.7 m x 2.1 m)

Removable staircase

### OPTIONAL

Tailored windwalls, mesh or PVC / fire retardant & retractable

Covered upper level

Scrim windows

Shade canopy with hardware 6' (1.8m)

Additional worklights (2): 500 w each

Crowd blinder support: 2" (50 mm) aluminium tubing

Lower deck extension kit: 96 ft² (8.9 m²)

**“ THE SL 100 MIX IS A VERY VALUABLE ASSET IN ANY FESTIVAL APPLICATION. WITH IT'S 18" HIGH AUDIO DECK AND REAR LEVEL AT ABOUT 2' HIGHER, LX, VIDEO OR SFX OPERATORS ALL HAVE A CLEAR VIEW. THE COVERED ROOF DECK IS GREAT FOR 4 FOLLOWSPOTS AND THE AUDIO DELAY POINTS USL & USR ARE AN ADDED BONUS. ”**

**Scott Pollard**  
Palmer Audio Inc.



# SL100 MIX FEATURES

## FOLLOW-SPOT TOWER

- Upper level with roof.
- Work area of 24' (7,3 m) wide x 6' (1,8 m) deep.
- Fits 4 follow-spots and operators.

## SOUND RIGGING

- Two SL100 standard 800 lb (363 kg) rigging beams. Can be used as delay towers.

## WEATHER PROTECTION

- Custom SL100 Mix windwall to fully enclose the unit and protect sound and lighting boards.

## ROOF

- Same lifting and rigging capacity as the standard SL100.
- Custom central roof made of FRP.
- Follow-spots can be positioned at lower roof height and raised with hydraulics.

## RETRACTABLE WALLS

- Front and rear windwalls open and close to optimize sightlines and weather protection.

## MIXING POSITION FLOOR

- The upstage deck of the SL100 can be installed as low as 1' (.3 m) from the ground and up to the same height as the main deck in increments of 2" (50 mm).
- Optional lower deck extension.

## ENCLOSED MIX POSITION

- Fully enclosed for overnight protection.
- Optional scrim window.





# WHY THE INDUSTRY CHOOSES STAGELINE



## Most widely used

Used in over 15,000 events per year in more than 45 countries.

## Craftsmanship and expertise

Every stage benefits from serious engineering and craftsmanship, with experience gathered from decades of use in outdoor events.

## Most reliable

Rain or shine, sand or snow, Stageline mobile stages can be used even under demanding touring situations and weather conditions.

## Quality control and delivery

Each mobile stage goes through a 600 point inspection including in-house manufacturing, road and load tests and complete installation of the unit prior to delivery.

## Provider of safe staging environments for 25 years

Highest wind resistance, 80mph (129 km/h) without wind walls and 60 mph (97 km/h) with wind walls.

No incident causing an injury due to a breakdown of equipment.

## Exceptional durability

Built to last 20 years and more with proper care and maintenance.

## Best outstanding value

Low operation and maintenance cost. High resale value even after 10 years.

## Certification

Every stage complies with road regulations. For all countries, Stageline provides complete engineering certification for both structural design and rigging capacity. In Canada and the US, we can provide certified documents for each state and province.

## An environmentally responsible product

Greenhouse gas emissions are reduced to a minimum compared to ground support stages. Stageline operates from one of the most energy efficient LEED certified industrial buildings constructed to date. Products are 80% recyclable.



## WHAT OUR CLIENTS SAY

*"The SL100 is a truly marvelous machine! We have found no glitches, nothing less than impeccable workmanship, the highest quality of materials, and exact adherence to the special order tolerances we requested. Everything is functioning perfectly."*

**Frank "BirdDawg" Jones**  
Architectural Stage Designer,  
R&R Staging, Inc., Houston, Texas

*"We at the City of North Las Vegas could not be happier with our SL 100. Its beauty is in its simplicity and versatility. We have utilized the stage in several set-up options and every time, has performed flawlessly. The 24' x 20' dimension allows for dynamic stage presentations and flexibility not found in many mobile stage units, and can be set-up in many situations in less than an hour. Thanks Stageline for making our job so much easier!"*

**Patrick Genovese**  
Special Events - City of North Las Vegas, NV

# GROWING & BUILDING TOGETHER

## Customer Support

We provide a complete 24 / 7 after sales support.

## Parts & Accessories

The best way to ensure that your Stageline mobile stage retains its original condition is to purchase your parts and accessories directly from Stageline.

## Inspection & Maintenance

Like any sophisticated piece of equipment, a Stageline mobile stage requires basic maintenance throughout the year. This maintenance must be performed according to specific guidelines.

With this in mind, Stageline's engineers and experienced technicians have developed a unique inspection program. This program will give you a complete analysis of your equipment's condition including a list of immediate repairs & recommendations.

## Training

Driven by the need to ensure technical efficiency, Stageline developed a training and certification program which meets and even exceeds its clients' and users' requirements. Operation of a Stageline mobile stage by qualified personnel is directly linked with the enforceability of the warranty and is required to benefit from the technical support offered on all Stageline products.

With its training program, Stageline helps its users and clients increase profitability on their investment through an efficient utilization of the products.

Our main objective is to develop the aptitudes and technical knowledge of the technicians in order to preserve the products' integrity and guarantee durability and maximum safety levels.

## \* Stage Care

Some limitations apply: details available on request.

**WE ARE SO CONFIDENT IN  
THE QUALITY, RELIABILITY  
AND DURABILITY OF OUR  
STAGES THAT WE SUPPORT  
EVERY MODEL WITH THE  
BEST WARRANTY IN  
THE BUSINESS**

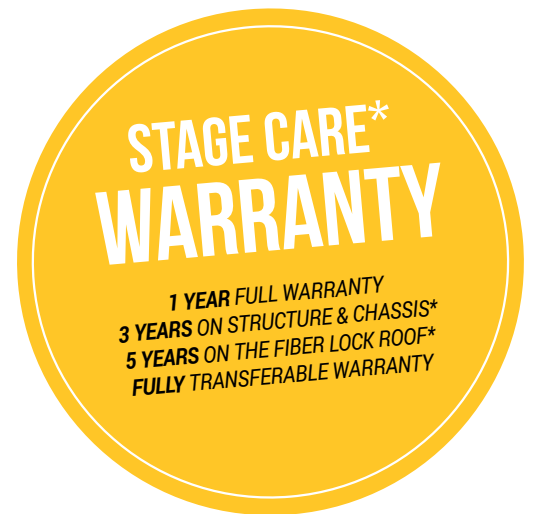

*"Stageline mobile stages were definitely a dominant asset in making this tour a hit... 38 weeks... thousands of miles and hundreds of events. Thanks to hydraulics and a skilled operator, setting the stage up and taking it down every day went smoothly and effortlessly."*

## Patricia Gonzales

Production Manager,  
Coca-Cola Mexico

*"The Indianapolis Colts promotions department used the Stage Line SL 100 at seven Fan Fest tour stops around the states of Indiana and Kentucky. It was an amazing asset for the club to use at events marketing the team to our fans. The modern engineering of the stage made it very convenient for us to transport the stage from location to location."*

## Matt Gonso

Promotion Manager  
Indianapolis Colts

*"We appreciated the exceptional way in which your company has received us. Your hospitality, sincerity, and remarkable client relations overwhelmed us at times. The unselfish way in which you have deposited knowledge and experience in our business and personal lives, left us in awe."*

## Chris Serfontein

Owner / Anointed M.  
South Africa

# TECHNICAL SPECIFICATIONS

## TRAILER

Length	31' 4" - 34' 9"	9.6 - 10.6 m
Width	8'	2.4 m
Height	11' 2"	3.5 m
Storage Space	23' 6" x 5' 9" x 5' 8"	7.2 x 1.8 x 1.7 m
Storage Compartment	17" x 17" x 36"	0.43 x 0.43 x 0.91 m
Storage Capacity	5000 lb	2270 kg
Weight	9990 lb	4531 kg

## STAGE FLOOR

Length and Depth	24' x 20'	7.3 x 6.1 m
Length and Depth with Extension Platforms	40' x 24'	12.2 x 7.3 m
Height	3' 6" to 4' 3"	1.1 to 1.3 m
Design Live Load	100 lb/ft <sup>2</sup>	490 kg/m <sup>2</sup>
Type of Surface	Plywood on aluminium	

## ROOF

Length and Depth	24' 11" x 23' 9"	7.6 x 7.2 m
Clearance (Inclined roof)	14' 7" to 13' 9"	4.6 to 3.9 m
Maximum Height with Banner *	23' 11"	7.3 m
Type of Surface	Fiberglass bonded on aluminium	
Roof Lifting Capacity	3800 lb	1725 kg
Roof Load Bearing Capacity	6500 lb	2948 kg
4 Built in Rigging Points	350 lb each	160 kg each
2 Trusses - Upstage and Downstage (T2)	500 lb	227 kg
2 Trusses - Central Roof (T1)	700 lb each	320 kg each
2 Front Overhang Extensions* - 9'4" (2.9 m)	125 lb at 34" each	57 kg at 0.8 m each
2 Side Overhang Rigging Bars	800 lb at 36" each	363 kg at 0.9 m each

## PRACTICAL ASPECTS

Personnel Required	1 Certified technician and 1 stagehand
Site Preparation	None
Heavy Machinery Required	None
Mode of Transportation	1 Pick-up truck or fifth-wheel tractor
Gust Wind Resistance	60 mph (97 km/h) with windwalls 80 mph (129 km/h) without windwalls
Rigging Bars - Standard 2" (50 mm) Tubing	Provides higher overhead clearance
Windwalls*	Weatherproof - fire retardant vinyl or scrim
Vertical and Horizontal Banner Supports*	Installed at ground level

### TOTAL ROOF LOAD BEARING CAPACITY

**6,500 LBS**  
**2,948 KG**

\* Optional.

Contact us for detailed SL100 Mix specifications

Due to Stagline's product improvement policy, technical specifications may change without notice.





# FLOOR CONFIGURATIONS TO SUIT YOUR NEEDS

1



Standard 24'x20'

2

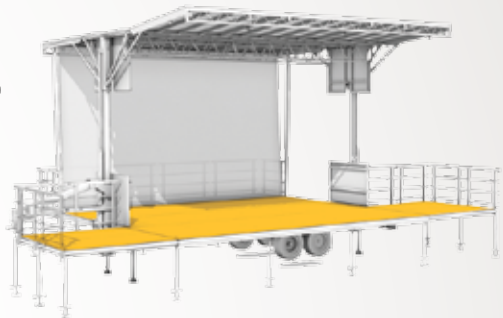

Standard 24'x20' with  
8'x8' sound wings

3

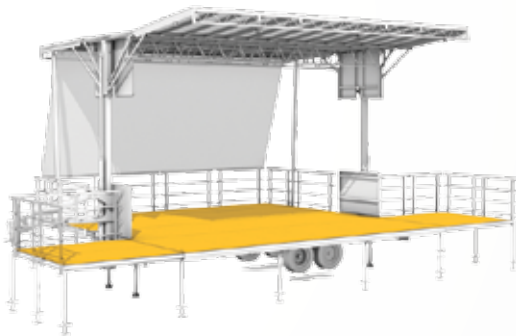

Back Extended 4'x24' with  
8'x8' sound wings

4

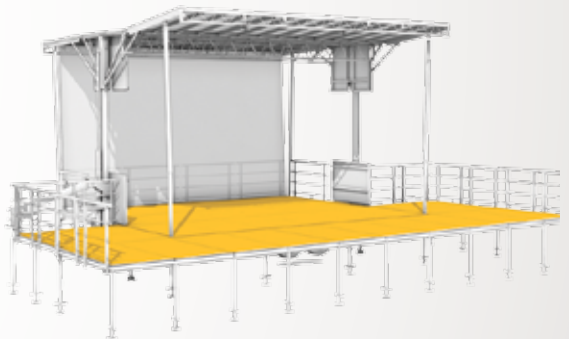

Standard 24'x20' with 8'x8' sound wings  
and 8'x40' at the front

5

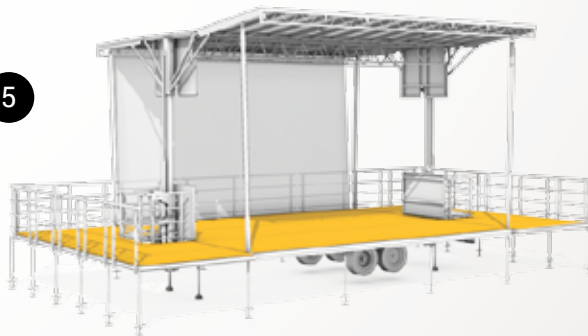

Standard 24'x20' with 12'x20' sound wings



## INNOVATIVE MOBILE STAGING

827 L'Ange-Gardien Blvd., L'Assomption  
Quebec, Canada J5W 1T3

T 1 450.589.1063  
F 1 450.589.1711  
North America 1 800.267.8243  
[stageline.com](http://stageline.com)