



December 18, 2015

VIA EMAIL: Ernest.Sandland@whrsd.k12.ma.us

Mr. Ernest Sandland
Facilities Department
Whitman Hanson Regional School District
600 Franklin Street
Whitman, MA 02382

AEC Project No. 421902

**Subject: AHERA 3-Year Re-inspection Report
Conley Elementary School
100 Forest Street
Whitman, Massachusetts**

Dear Mr. Sandland:

Please find enclosed the three-year re inspection report for the Conley Elementary School. If you require any further assistance please feel free to contact me at (781) 337-0016.

Thank you for allowing American Environmental Consulting, Inc (AEC) to assist you with this project.

Sincerely,
American Environmental Consulting, Inc

Gregory Hatch
Partner
MA Certified Asbestos Inspector (AI061535)
MA Certified Management Planner (AP061534)

The asbestos, lead, mold and hazardous material professionals

814 Broad St. ▪ Weymouth, MA 02189 ▪ 781-337-0016 ▪ Fax: 781-337-0986



**AHERA
3-YEAR REINSPECTION REPORT
CONLEY ELEMENTARY SCHOOL**

SUBMITTED TO:

**WHITMAN HANSON REGIONAL SCHOOL DISTRICT
600 Franklin Street
Whitman, MA 02382**

SUBMITTED BY:

**AMERICAN ENVIRONMENTAL CONSULTANTS, INC.
814 Broad Street
Weymouth, Massachusetts 02189**

PROJECT NO. 421902

December 18, 2015



**AHERA
3-YEAR REINSPECTION REPORT
CONLEY ELEMENTARY SCHOOL
100 FOREST STREET
WHITMAN, MASSACHUSETTS**

Submitted To:

Mr. Ernest Sandland
Facilities Department/LEA
Whitman Hanson Regional School District
600 Franklin Street
Whitman, MA 02382

Inspector:

Gregory Hatch

Partner
American Environmental Consultants, Inc
Massachusetts Inspector # AI061535

December 18, 2015



TABLE OF CONTENTS

SECTION	PAGE
1.0 INTRODUCTION	1
2.0 DISCUSSION	2
3.0 REINSPECTION EPA ASSESSMENT SUMMARY	4
4.0 CONCLUSIONS	5

APPENDICES

SCHOOL KEY PLAN	APPENDIX A
ACBM MATERIALS REMAINING	APPENDIX B
HOMOGENOUS MATERIAL IDENTIFICATION	APPENDIX C
EPA AHERA SELF AUDIT CHECKLIST	APPENDIX D
MANAGEMENT PLANNER TRAINING INFORMATION	APPENDIX E
BULK SAMPLE RESULTS.....	APPENDIX F
AHERA MEMO TO PARENTS	APPENDIX G
EMPLOYEE TRAINING DOCUMENTATION	APPENDIX H

1.0 INTRODUCTION

American Environmental Consultants, Inc (AEC) was retained by the Whitman Hanson Regional School District (WHRSD) to perform a three-year reinspection at the Conley Elementary School located at 100 Forest Street in Whitman, Massachusetts.

The inspection was performed on November 20, 2015 by AEC's Industrial Hygienist, Gregory Hatch, with Massachusetts State Accreditation # AI061535.

The purpose of this inspection is to visually reinspect and reassess all friable and non-friable known or assumed asbestos-containing building material (ACBM) within the school facility in compliance with the United States Environmental Protection Agency's (USEPA) Asbestos Hazard Emergency Response Act (AHERA) (40 CFR Part 763.85 [b]).

The reinspection was conducted in two phases.

PHASE I

- Review the existing management plan and discuss with the designated person response actions completed.
- Review abatement/remedial activities, work orders and training records since management plan implementation, if applicable.
- Obtain 8 1/2" x 11" drawings from the Local Education Agency (LEA).

PHASE II

- Visually re-inspect and reassess the condition of all friable known or assumed ACBM.
- Visually inspect material that was previously identified as non-friable ACBM and touch the material to determine whether it has become friable since the last inspection or reinspection.
- Identify homogeneous areas with materials that have become friable since the last inspection or reinspection.
- Assess the condition of any newly friable materials.
- Submit to the designated person any assessments or reassessments made of friable known or assumed ACBM as identified in the original inspection report.
- Submit a report detailing the results of the reinspection for inclusion into the LEA's management plans.

2.0 DISCUSSION

The management plan on file at the office of the LEA was reviewed and the following summarizes this review.

2.1 Designated Person

Mr. Ernest Sandland
Facilities Department
Whitman Hanson Regional School District
600 Franklin Street
Whitman, MA 02382

The AHERA regulation 763.84[g](1) states that "the general LEA shall designate a person to ensure that requirements under this section are properly implemented". Section 763.84[g](2) further states that "the LEA shall ensure that the designated person receives adequate training to perform duties assigned under this section".

2.2 Yearly Building Occupant Notification

"The designated person must ensure that workers and building occupants, or their legal guardians, are informed at least once each school year about inspections, response actions, and post-response action activities, including periodic re-inspection and surveillance activities that are planned or in progress", as per the AHERA regulation section 763.84(c).

The records for previous years have been incorporated into the management plan for the school and a copy is also attached in Appendix G. AEC recommends that copies of the records be incorporated into the management plans to satisfy the requirement to maintain and update the plan.

2.3 Custodial/Maintenance Personnel Training

Custodial and maintenance personnel hired are required to receive a minimum of 2 hours "asbestos awareness training". Training should be provided within 60 days of employment. The LEA documentation of Training is provided for in the Letter to Parent in Appendix G.

Documentation of the 2 hour Asbestos Awareness training for maintenance staff working currently in the building was available during the inspection and is attached in Appendix H. Documentation of training is included in the Management Plan. If any staff remains untrained, training should be provided and documented in the Management Plan.

2.4 Periodic Surveillance

The LEA shall conduct six-month periodic surveillance of all known ACBM present in each school in accordance with the AHERA Regulation. A 2 hour trained staff member may conduct the six-month inspection. The inspection is performed to document any changes in condition in the ACBMs.

Records were available documenting the six-month periodic surveillance inspections. AEC recommends documenting these periodic inspections and, that copies of these records be entered into the management plan to satisfy the requirement to maintain and update the plan. The records should be maintained in a central location. The attached Appendix B can be copied and used as a basis for the re-inspection.

2.5 Warning Labels

As per the AHERA regulation section 763.95[a], "the LEA shall attach a warning label immediately adjacent to any friable and non-friable ACBM and suspected ACBM assumed to be asbestos-containing material (ACM) located in routine maintenance areas (such as boiler rooms) at each school building".

No suspect friable materials were observed in routine maintenance areas.

2.6 Summary of Response Actions

According to the LEA, there has not been any work in the school in the last three years therefore, no records of response actions were found in the management plan since the last AHERA 3-year inspection performed in January 2012.

3.0 REINSPECTION EPA ASSESSMENT SUMMARY

3.1 ACBM Remaining

Asbestos-containing and assumed asbestos containing building materials remaining in the building includes:

Surfacing Materials

The suspect accessible surfacing material was identified in acoustic ceiling located in classrooms was sampled and determined to be non-ACM.

Thermal System Insulation

Most of the thermal system insulation observed was non-ACM. Suspect boiler breeching insulation was observed in the Boiler room and found to be in good condition. The breeching was sampled and determined to be non-ACM.

Miscellaneous Materials

Miscellaneous materials are located in areas throughout the school building. Detailed locations, amounts and condition information can be found in Appendix B and C.

3.2 Additional ACBM Identified

No additional ACBM was identified during the reinspection.

3.3 Results and Recommendations

The identified ACBM remaining in the Conley Elementary School was inspected and found to be in generally good condition.

The materials should continue to be maintained in place under the O & M plan until removal is made necessary by renovations or demolition.

4.0 CONCLUSIONS

The AHERA three year reinspection at the Duval Elementary School was performed on November 20, 2015 in accordance with the AHERA regulations. A management plan audit was performed with additional results and recommendations for correction and updating the management plan listed in Section 2 of this report.

The ACM/PACM was found to be in good condition with a low potential for damage.

Recommendations/schedule/Cost:

- a. There will be a cost for response actions between this re-inspection and the next. This is dependant on renovation and operation/maintenance activities. There will be a cost related to consulting services and abatement contractor services.
- b. There will be time associated with each six month periodic inspection. It is anticipated that this activity would require a full 8 hour shift.

APPENDIX A
FLOOR PLANS

**Louise A Conley Elementary School
100 Forest Street, Whitman MA**

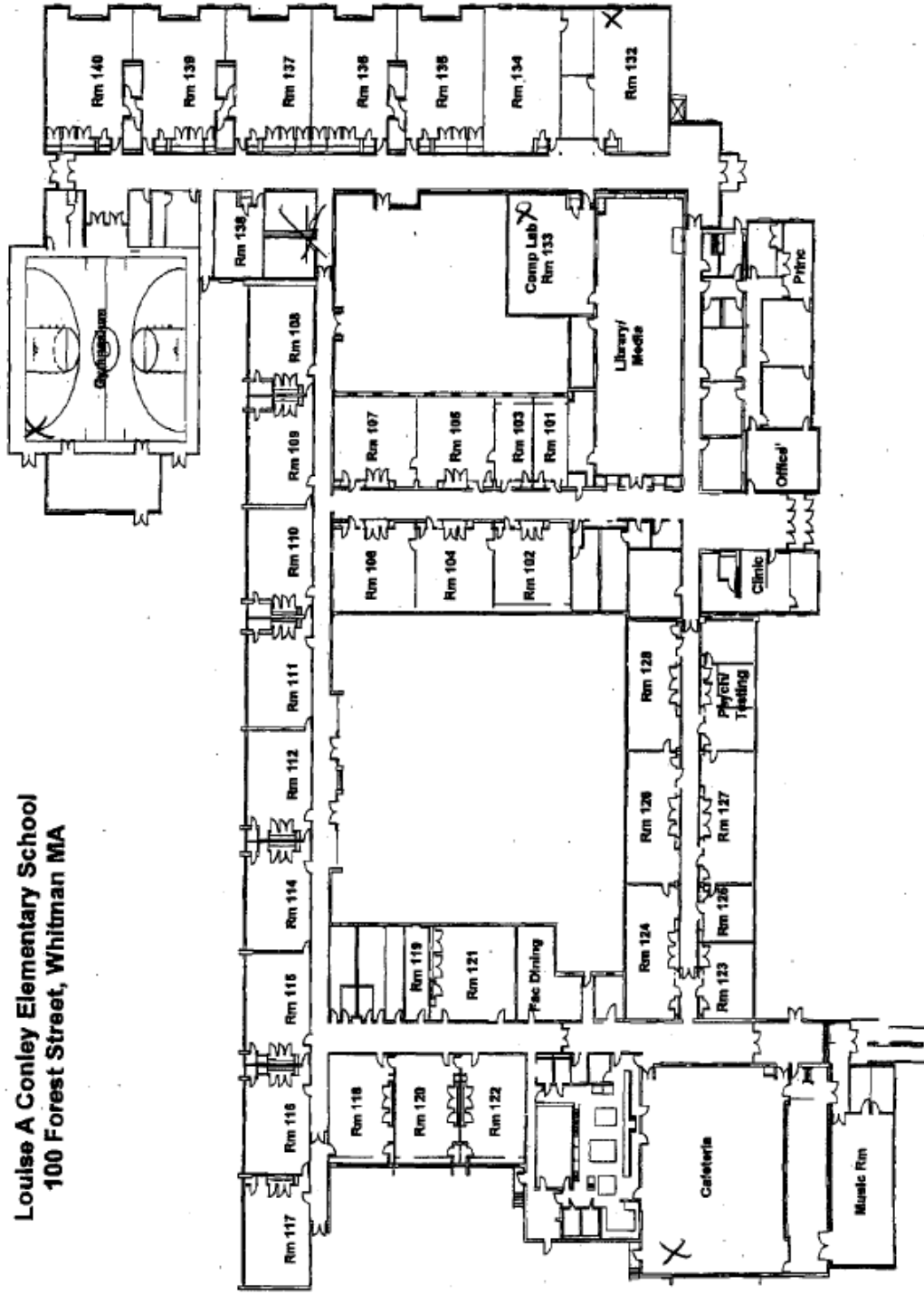

APPENDIX B
ACBM REMAINING

ACBM REMAINING

The following abbreviations were used in the Reinspection Assessment Table that follows:

SF = Square Feet; LF = Linear Feet; EA = Each

The assessment is divided into two categories. The physical assessment and the hazard potential assessment as follows:

PHYSICAL ASSESSMENT:

The physical assessment is divided into the following seven categories and describes the material condition at the time of the inspection:

- Physical Condition #1 - Damaged or significantly damaged thermal insulation.
- Physical Condition #2 Damaged friable surfacing ACM.
- Physical Condition #3 Significantly damaged friable surfacing ACM.
- Physical Condition #4 Damaged or significantly damaged friable miscellaneous ACM.
- Physical Condition #5 ACBM with potential for damage.
- Physical Condition #6 ACBM with potential for significant damage.
- Physical Condition #7 Any remaining friable ACBM or friable suspected ACBM.

HAZARD ASSESSMENT:

The hazard assessment is a combination of the physical assessment combined with the potential for disturbance (i.e. physical contact, vibration air movement) as follows:

- Hazard rank #1 – Good condition/Low potential for disturbance
- Hazard rank #2 – Good condition/ Moderate potential for disturbance
- Hazard rank #3 – Good condition/ High potential for disturbance
- Hazard rank #4 – Fair condition/Low potential for disturbance
- Hazard rank #5 – Fair condition/Moderate potential for disturbance
- Hazard rank #6 – Fair condition/ High potential for disturbance
- Hazard rank #7 – Poor condition (significant damage)

**Conley Elementary School
3-YEAR REINSPECTION
ASSESSMENT TABLE**

December 18, 2015

Project No. 421902

Location: Building- Floor/Room or Area	Type of Material	Quantity	Homogenous Area Number	Physical/ Hazard Assessment	Condition	Friable/Non -Friable (F/NF)
1-2 each classroom/ Office	Black sink undercoat	50 EA	HA-1	5/1	Good	NF
Lower level	Brown Fire Stop	50 SF	HA-3	5/1	Good	NF
Hallways (accent tile)	12" x 12" Yellow floor tile	300 SF	HA-4	5/1	Good	NF
Hallways (accent tile) and Nurse Office	12" x 12" Orange VFT	2,000 SF	HA-5	5/1	Good	NF
Nurse Office	Orange Cove Base	200 LF	HA-6	5/1	Good	NF
Nurse Office	Cove base mastic	200 LF	HA-7	5/1	Good	NF
Music room, Room 138 (38), Room 133 (33), Offices, Stage in Library, Guidance	Carpet mastic	5,100 SF	HA-8	5/1	Good	NF
Classroom entry	Wood Door Core	170 EA	HA-9	5/1	Good	F
In classrooms and Office areas	White Board/Chalkboard adhesive	210 EA	HA-10	5/1	Good	NF
Bathrooms	4" white ceramic tile grout	2,500 SF	HA-11	5/1	Good	NF
Bathrooms	4" white ceramic tile adhesive	2,500 SF	HA-12	5/1	Good	NF
Bathrooms	2" blue ceramic tile grout	1,800 SF	HA-13	5/1	Good	NF

**Conley Elementary School
3-YEAR REINSPECTION
ASSESSMENT TABLE**

December 18, 2015

Project No. 421902

Location: Building- Floor/Room or Area	Type of Material	Quantity	Homogenous Area Number	Physical/ Hazard Assessment	Condition	Friable/Non -Friable (F/NF)
Bathrooms	4" blue ceramic tile grout	1,800 SF	HA-14	5/1	Good	NF
Kitchen	PVC wall adhesive	2,100 SF	HA-15	5/1	Good	NF
Gym	Heavy duty cove base	260 LF	HA-16	5/1	Good	NF
Gym	Cove base adhesive	260 LF	HA-17	5/1	Good	NF
Gym	Gray HVAC duct seam sealant	200 SF	HA-18	5/1	Good	NF
Upper Wall Hallways	Glue Daubs	6,000 SF	HA-19	5/2	Good	F

6- Month Periodic Re-inspection:

Date Re-inspected: _____

Re-inspection done by: _____

Changes in Condition: _____

APPENDIX C
HOMOGENOUS AREA SAMPLING GUIDE

HOMOGENOUS AREA SAMPLING GUIDE

Note: Where mastic is listed, it is associated with the material above. (i.e. Floor tile is followed by mastic and cove base is followed by mastic etc).

Conley Elementary School 3-YEAR REINSPECTION HOMOGENOUS MATERIAL TABLE							
December 18, 2015				Project No. 421902			
Homogenous Material Number	Material	Sampled (Yes/No)	ACM (yes/no)	Date Sampled	How Many Samples	Lab Doing Analysis	Lab Project Number
HA-1	Black sink undercoat	No	N/A	N/A	N/A	N/A	N/A
HA-2	Boiler Breeching	Yes	No	12/9/15	9	SanAir	15038960
HA-3	Brown Fire Stop	No	N/A	N/A	N/A	N/A	N/A
HA-4	12" x 12" Yellow floor tile	No	N/A	N/A	N/A	N/A	N/A
HA-5	12" x 12" Orange VFT	No	N/A	N/A	N/A	N/A	N/A
HA-6	Orange Cove Base	No	N/A	N/A	N/A	N/A	N/A
HA-7	Cove base mastic	No	N/A	N/A	N/A	N/A	N/A
HA-8	Carpet mastic	No	N/A	N/A	N/A	N/A	N/A
HA-9	Wood Door Core	No	N/A	N/A	N/A	N/A	N/A
HA-10	White Board/ Chalkboard adhesive	No	N/A	N/A	N/A	N/A	N/A
HA-11	4" white ceramic tile grout	No	N/A	N/A	N/A	N/A	N/A
HA-12	4" white ceramic tile adhesive	No	N/A	N/A	N/A	N/A	N/A

**Conley Elementary School
3-YEAR REINSPECTION
HOMOGENOUS MATERIAL TABLE**

December 18, 2015

Project No. 421902

Homogenous Material Number	Material	Sampled (Yes/No)	ACM (yes/no)	Date Sampled	How Many Samples	Lab Doing Analysis	Lab Project Number
HA-13	2" blue ceramic tile grout	No	N/A	N/A	N/A	N/A	N/A
HA-14	4" blue ceramic tile grout	No	N/A	N/A	N/A	N/A	N/A
HA-15	PVC wall adhesive	No	N/A	N/A	N/A	N/A	N/A
HA-16	Heavy duty cove base	No	N/A	N/A	N/A	N/A	N/A
HA-17	Cove base adhesive	No	N/A	N/A	N/A	N/A	N/A
HA-18	Gray HVAC duct seam sealant	No	N/A	N/A	N/A	N/A	N/A
HA-19	Glue Daubs	Yes	Yes	11/20/15	3	San Air	15037165
HA-20	Blue cove base	Yes	No	11/20/15	3	San Air	15037165
HA-21	Associated Mastic	Yes	No	11/20/15	3	San Air	15037165
HA-22	Sheetrock	Yes	No	11/20/15	4	San Air	15037165
HA-23	Joint Compound	Yes	No	11/20/15	4	San Air	15037165
HA-24	2'x4' faux ceiling tile	Yes	No	11/20/15	2	San Air	15037165
HA-25	12" x 12" white with blue VFT	Yes	No	11/20/15	2	San Air	15037165
HA-26	Associated mastic	Yes	No	11/20/15	2	San Air	15037165
HA-27	2' x 4' Ceiling tile	Yes	No	11/20/15	2	San Air	15037165
HA-28	1' x 1' spline ceiling tile	Yes	No	11/20/15	2	San Air	15037165
HA-29	Acoustic ceiling plaster	Yes	No	11/20/15	7	San Air	15037165

**Conley Elementary School
3-YEAR REINSPECTION
HOMOGENOUS MATERIAL TABLE**

December 18, 2015

Project No. 421902

Homogenous Material Number	Material	Sampled (Yes/No)	ACM (yes/no)	Date Sampled	How Many Samples	Lab Doing Analysis	Lab Project Number
HA-30	12" x 12" blue with blue chip VFT	Yes	No	11/20/15	2	San Air	15037165
HA-31	Associated mastic	Yes	No	11/20/15	2	San Air	15037165

N/A – Not applicable as the material has not been sampled.

APPENDIX D

EPA AHERA SELF AUDIT CHECKLIST

**AHERA Asbestos Management Plan
Self-Audit Checklist for Designated Persons***

School:		Phone:	
Address:			
County:			
Local Education Agency:		Phone:	
Address:			
Designated Person:		Phone:	
Address:			
Date Checklist Completed by Designated Person:			
Designated Person's Signature:			
Yes	No	N/A	School:
N/A - Not Applicable			
General Information			
<input type="checkbox"/>	<input type="checkbox"/>	<input type="checkbox"/>	1. Has an Asbestos Management Plan been developed for your school? <div align="right"><small>(40 CFR § 763.93)</small></div>
<input type="checkbox"/>	<input type="checkbox"/>	<input type="checkbox"/>	2. Does the Local Education Agency (LEA) have a complete and up-to-date copy of the school's management plan in both the LEA's administrative office and the school's administrative office? <div align="right"><small>(40 CFR § 763.93(g)(2)-(3))</small></div>
<input type="checkbox"/>	<input type="checkbox"/>	<input type="checkbox"/>	3. Was the management plan developed by an accredited management planner? <div style="border: 1px solid black; padding: 5px; width: fit-content; margin-left: auto; margin-right: auto;">Did you know? Your LEA <i>may</i> require each management plan to contain a statement signed by an accredited management plan developer that he/she has prepared or assisted in the preparation of the plan or has reviewed the plan and that the plan is in compliance with 40 CFR 763, Subpart E. The management plan developer that signs the statement may not also implement the plan (40 CFR § 763.93(f)).</div> <div align="right"><small>(40 CFR § 763.93(e))</small></div>

*References to Model Asbestos Management Plan (AMP) forms are to the forms contained in EPA Region 2's guidance manual, published March 2004, entitled: "Model AHERA Asbestos Management Plan for Local Education Agencies." The Model AMP forms and this Self-Audit Checklist are not a substitute for the applicable legal requirements, are not regulations themselves, and are not required to be used/completed under AHERA. Rather, they are provided by EPA Region 2 as guidance to enhance schools' compliance with EPA AHERA regulations regarding the required documentation that must be included in the AMP. These documents do not impose legally binding requirements on any party, including EPA, states, or the regulated community, and are not intended and cannot be relied upon to create any rights, substantive or procedural, enforceable by any party in litigation with the United States. Please contact your state asbestos coordinator for any applicable state regulations/AMP Forms.



Yes No N/A <small>N/A - Not Applicable</small>	School:
<input type="checkbox"/> <input type="checkbox"/> <input type="checkbox"/>	<p>4. For each consultant who contributed to the management plan, does the plan include the following:</p> <ul style="list-style-type: none"> • consultant's name? • a statement that he/she is accredited under the state accreditation program or another state's accreditation program or an EPA-approved course? <p style="text-align: right;">(40 CFR § 763.93 (e)(12)(i)-(ii))</p> <p>Note: Although not required, EPA suggests including in the AMP the name of the training agency, the course name and date, and a copy of the accreditation certificate for each consultant.</p> <p>*Tip: See suggested Model AMP Form 1 - Contact Information</p>
<input type="checkbox"/> <input type="checkbox"/> <input type="checkbox"/>	<p>5. Does the management plan include a list of the name and address of each building used as a school building and identify whether the school building has:</p> <ul style="list-style-type: none"> • friable ACBM (asbestos-containing building material)? • non-friable ACBM? • friable and non-friable suspected ACBM assumed to be ACM (asbestos-containing material)? <p style="text-align: right;">(40 CFR §§ 763.93(a)(1)-(2) and 763.93(e)(1))</p> <p>*Tip: See Model AMP Form 2 - School Building List</p>
<input type="checkbox"/> <input type="checkbox"/> <input type="checkbox"/>	<p>6. If a new school building was constructed after October 12, 1988 and is asbestos-free, does the management plan include the following and has a copy of same been provided by the LEA to the EPA Regional Office:</p> <ul style="list-style-type: none"> • a statement signed by an architect or project engineer responsible for the construction of the building, or by an accredited inspector, indicating that no ACBM was specified as a building material in any construction document for the building, or, to the best of his or her knowledge, no ACBM was used as a building material in the building? <p style="text-align: right;">(40 CFR § 763.99(a)(7))</p> <p>*Tip: See Model AMP Form 2 - School Building List</p>
<input type="checkbox"/> <input type="checkbox"/> <input type="checkbox"/>	<p>7. Does the management plan include a copy of any of the statements required under 40 CFR § 763.99(a)(1)-(7) to support an exclusion from inspection that the school may qualify for under 40 CFR § 763.99 and has a copy of any such statement been provided by the LEA to the Regional Office?</p> <p style="text-align: right;">(40 CFR § 763.99)</p> <p>Note: The exclusion under 40 CFR § 763.99(a)(7) is also covered under Checklist question number 6.</p>



Yes No N/A N/A - Not Applicable	School:	
<input type="checkbox"/> <input type="checkbox"/> <input type="checkbox"/>	<p>8. Does the management plan include the following information about the LEA Designated Person (DP):</p> <ul style="list-style-type: none"> • Name, address, and telephone number of the DP? • Course name, dates, and hours of training that the DP attended to carry out his or her AHERA duties? • Signed statement by the DP that the LEA's general responsibilities under 40 CFR § 763.84 have been or will be met? 	<p style="text-align: right;">(40 CFR § 763.93(e)(4) and (i))</p> <p>Note: Although not required, EPA suggests including in the AMP the name of the training agency and a copy of the DP's training certificates.</p> <p>*Tip: See Model AMP Form 1 - Contact Information and Form 3 - Designated Person Assurances</p>
<input type="checkbox"/> <input type="checkbox"/> <input type="checkbox"/>	<p>9. Does the management plan include the following recommendations:</p> <ul style="list-style-type: none"> • A plan for reinspection required under 40 CFR § 763.85? • A plan for operations and maintenance activities (including initial cleaning) required under 40 CFR § 763.91? • A plan for periodic surveillance required under 40 CFR § 763.92? • A description of the management planner's recommendation for additional cleaning under 40 CFR § 763.91(c)(2), as part of an operations and maintenance program, and the response of the LEA to that recommendation? 	<p style="text-align: right;">(40 CFR § 763.93(e)(9))</p> <p>*Tip: See Model AMP Form 10 - Plan for Reinspection, Form 14 - Plan for Operations and Maintenance Activities, Form 18 - Periodic Surveillance Plan/Report, and Form 16 Cleaning Record</p>
<input type="checkbox"/> <input type="checkbox"/> <input type="checkbox"/>	<p>10. Does the management plan include an evaluation of resources needed to carry out response actions, reinspections, operations and maintenance, and periodic surveillance and training?</p>	<p style="text-align: right;">(40 CFR § 763.93(e)(11))</p> <p>*Tip: See suggested Model AMP Form 4 - Evaluation of Resources</p>
<input type="checkbox"/> <input type="checkbox"/> <input type="checkbox"/>	<p>11. Does the management plan include a record of the minimum 2 hours of awareness training required under 40 CFR § 763.92(a)(1) for all maintenance and custodial staff who may work in a building that contains ACBM, whether or not they are required to work with ACBM, and does the record include the following information:</p> <ul style="list-style-type: none"> • person's name and job title? • date training was completed? • location of training? • number of hours completed? 	<div style="border: 1px solid black; padding: 5px; margin-bottom: 10px;"> <p>Did you know? New custodial and maintenance employees must be trained within 60 days after starting work (40 CFR §763.92(a)(1)).</p> </div> <p style="text-align: right;">(40 CFR §§ 763.93(h) and 763.94(c))</p> <p>Note: Although not required, EPA suggests including in the AMP the name of the training agency, the course name, and a copy of the accreditation certificate for each staff person.</p> <p>*Tip: See Model AMP Form 5 - Training Record for Maintenance and Custodial Staff</p>



Yes No N/A N/A - Not Applicable	School:
<input type="checkbox"/> <input type="checkbox"/> <input type="checkbox"/>	<p>12. Does the management plan include a record of the additional 14 hours of training required under 40 CFR § 763.92(a)(2) for maintenance and custodial staff who conduct any activities that will result in the disturbance of ACBM and does the record include the following information:</p> <ul style="list-style-type: none"> • person's name and job title? • date training was completed? • location of training? • number of hours completed? <p style="text-align: right;">(40 CFR §§ 763.93(h) and 763.94(c))</p> <p>Note: Although not required, EPA suggests including in the AMP the name of the training agency, the course name, and a copy of the accreditation certificate for each staff person.</p> <p>*Tip: See Model AMP Form 5 - Training Record for Maintenance and Custodial Staff</p>
Inspections and Reinspections	
<input type="checkbox"/> <input type="checkbox"/> <input type="checkbox"/>	<p>13. For inspections conducted before 12/14/87 (i.e., the effective date of the 10/30/87 EPA Asbestos-Containing Materials in Schools rule), does the management plan include the following information:</p> <ul style="list-style-type: none"> • date of inspection? • blueprint, diagram or written description of each school building that identifies clearly each location and approximate square or linear footage of homogenous /sampling area sampled for ACM? • if possible, the exact locations where the bulk samples were collected and the dates of collection? • a copy of the analyses of any bulk samples, dates of analyses, and a copy of any other laboratory reports pertaining to the analyses. • description of response actions or preventive measures taken, including, if possible, the names and addresses of all contractors, start and completion dates and air clearance sample results? • description of assessments of material identified prior to 12/14/87 as friable ACBM or friable suspected ACBM assumed to be ACM, and the name, signature, state of accreditation and if applicable, the accreditation number of the person making the assessments (i.e., inspector)? <p style="text-align: right;">(40 CFR § 763.93(e)(2)(i)-(v))</p> <p>*Tip: See Model AMP Form 6 - Inspection Cover Sheet, Form 8 - Homogeneous Area/Bulk Sample Summary, Form 9 - Homogeneous Area/Bulk Sample Diagram, Form 12 - Implementation of Response Actions, and Form 7 - Room/Functional Space Assessment</p>
<input type="checkbox"/> <input type="checkbox"/> <input type="checkbox"/>	<p>14. Does the management plan include for each inspection and reinspection conducted under 40 CFR § 763.85 the following information:</p> <ul style="list-style-type: none"> • date of the inspection or reinspection? • name, signature, state of accreditation, and, if applicable, the accreditation number for each accredited inspector performing the inspection or reinspection? <p style="text-align: right;">(40 CFR § 763.93(e)(3)(i))</p> <p>Note: Although not required, EPA suggests including in the AMP the name of the training agency, the course name and date, and a copy of the accreditation certificate for each inspector.</p> <p>*Tip: See Model AMP Form 6 - Inspection Cover Sheet</p>



Yes No N/A N/A - Not Applicable	School:
<input type="checkbox"/> <input type="checkbox"/> <input type="checkbox"/>	<p>15. Does the management plan include for each inspection and reinspection conducted under 40 CFR § 763.85 the following sampling information:</p> <ul style="list-style-type: none"> • Blueprint, diagram, or written description of each school building that identifies clearly each location and approximate square or linear footage of homogeneous areas where material was sampled for ACM? • Exact location where each bulk sample was collected and the date of collection of each bulk sample? • Homogeneous areas where friable suspected ACBM is assumed to be ACM? • Homogeneous areas where nonfriable suspected ACBM is assumed to be ACM? • Description of the manner used to determine sampling locations? • The name, signature, state of accreditation, and, if applicable, the accreditation number for each accredited inspector that collected samples? <p style="text-align: right;">(40 CFR § 763.93(e)(3)(ii)-(iii))</p> <p>Note: For details on how to collect bulk samples, see 40 CFR § 763.86. Although not required, EPA suggests including in the AMP the name of the training agency, the course name and date, and a copy of the accreditation certificate for each inspector that collected the samples.</p> <p>*Tip: See Model AMP Form 6 - Inspection Cover Sheet, Form 8 - Homogeneous Area/Bulk Sample Summary, and Form 9 - Homogeneous Area/Bulk Sample Diagram</p>
<input type="checkbox"/> <input type="checkbox"/> <input type="checkbox"/>	<p>16. Does the management plan include for each inspection and reinspection conducted under 40 CFR § 763.85 the following information on the analysis of the bulk samples and has it been submitted to the DP for inclusion in the plan within 30 days of the analysis:</p> <ul style="list-style-type: none"> • Copy of the analysis of any bulk samples collected and analyzed? • Name and address of any laboratory that analyzed bulk samples? • A statement that any laboratory used meets the applicable laboratory accreditation requirements of 40 CFR § 763.87(a)? • Dates of any analyses performed? • Name and signature of the person performing each analysis? <p style="text-align: right;">(40 CFR §§ 763.87(d) and 763.93(e)(3)(iv))</p> <p>Note: For details on how to submit bulk samples for analysis, see 40 CFR § 763.87.</p>
<input type="checkbox"/> <input type="checkbox"/> <input type="checkbox"/>	<p>17. Does the management plan include for each inspection and reinspection conducted under 40 CFR § 763.85 the following assessment information and has it been submitted to the DP for inclusion in the plan within 30 days of the assessment:</p> <ul style="list-style-type: none"> • Written assessments (signed and dated) required to be made under 40 CFR § 763.88 of all ACBM and suspected ACBM assumed to be ACBM? • Name, signature, state of accreditation, and, if applicable, the accreditation number of each accredited person making the assessment (i.e., inspector(s)) <p style="text-align: right;">(40 CFR §§ 763.88(a)(2) and 763.93(c)(3)(v))</p> <p>Note: Although not required, EPA suggests including in the AMP the name of the training agency, the course name and date, and a copy of the accreditation certificate for each inspector making the assessment.</p> <p>*Tip: See Model AMP Form 6 - Inspection Cover Sheet and Form 7 - Room/Functional Space Assessment</p>



Yes No N/A N/A - Not Applicable	School:
<input type="checkbox"/> <input type="checkbox"/> <input type="checkbox"/>	<p>18. Has the following information about the inspection been recorded and submitted to the DP for inclusion in the management plan within 30 days of the inspection:</p> <ul style="list-style-type: none"> • Inspection report with the date of inspection signed by each accredited inspector making the inspection, the state of accreditation, and if applicable, his/her accreditation number? • Inventory of the locations of the homogeneous areas where samples are collected, exact location where each bulk sample is collected, dates that samples are collected, homogeneous areas where friable suspected ACBM is assumed to be ACM and homogeneous areas where nonfriable suspected ACBM is assumed to be ACM? • Description of the manner used to determine sampling locations, the name and signature of each accredited inspector who collected the samples, state of accreditation, and, if applicable, his or her accreditation number? • List of whether the homogeneous areas identified under 40 CFR § 763.85(a)(4)(vi)(B) of this section, are surfacing material, thermal system insulation, or miscellaneous material? • Assessments of friable material (signed and dated), the name and signature of each accredited inspector making the assessment, state of accreditation, and if applicable, his or her accreditation number? <p style="text-align: right;">(40 CFR §§ 763.85(a)(4)(vi)(A)-(E) and 763.88(a)(2))</p> <p>Note: For further details on activities conducted during an inspection (e.g., visually inspect/touch material), see 40 CFR § 763.85(a)(4)(i)-(v)</p> <p>*Tip: See Model AMP Form 6 - Inspection Cover Sheet, Form 7 - Room/Functional Space Assessment, Form 8 - Homogeneous Area/Bulk Sample Summary and Form 9 - Homogeneous Area /Bulk Sample Diagram</p>
<input type="checkbox"/> <input type="checkbox"/> <input type="checkbox"/>	<p>19. Has the following information about the reinspection been recorded and submitted to the DP for inclusion in the management plan within 30 days of the reinspection:</p> <ul style="list-style-type: none"> • Date of reinspection, name and signature of the person making the reinspection, state of accreditation, and if applicable, his or her accreditation number, and any changes in the condition of known or assumed ACBM? • Exact location where samples were collected during the reinspection, a description of the manner used to determine sampling locations, the name and signature of each accredited inspector who collected the samples, state of accreditation, and, if applicable, his or her accreditation number? • Any assessments or reassessments of friable material, date of the assessment or reassessment, the name and the signature of the accredited inspector making the assessments, state of accreditation, and if applicable, his or her accreditation number? <p style="text-align: right;">(40 CFR §§ 763.85(b)(3)(vii)(A) - (C) and 763.88(a)(2))</p> <p>Note: At least once every 3 years after a management plan has been in effect, a reinspection must be conducted by an accredited inspector of all friable and nonfriable known or assumed ACBM in each school building that the LEA leases, owns, or otherwise uses as a school building (40 CFR § 763.85(b)(1)-(2)). For further details on activities conducted during a reinspection (e.g., visually reinspect/touch material), see 40 CFR § 763.85(b)(3)(i)-(vi).</p> <p>*Tip: See Model AMP Form 6 - Inspection Cover Sheet, Form 7 - Room/Functional Space Assessment, Form 8 - Homogeneous Area/Bulk Sample Summary, Form 9 - Homogeneous Area /Bulk Sample Diagram</p>



Yes No N/A N/A - Not Applicable	School:	
Response Actions		
<input type="checkbox"/> <input type="checkbox"/> <input type="checkbox"/>	<p>20. Does the management plan include the recommendations made to the LEA regarding response actions under 40 CFR § 763.88(d) and the following information about the accredited management planner:</p> <ul style="list-style-type: none"> • name, signature, state of accreditation, and, if applicable, the accreditation number for each accredited management planner making the recommendations? <p style="text-align: right;">(40 CFR §§ 763.88(d) and 763.93(e)(5))</p> <p>Note: Although not required, EPA suggests including in the AMP the name of the training agency, the course name and date, and a copy of the accreditation certificate for each accredited person making the recommendations.</p> <p>*Tip: See Model AMP Form 11 - Recommended Response Actions</p>	
<input type="checkbox"/> <input type="checkbox"/> <input type="checkbox"/>	<p>21. Does the management plan include a detailed description of preventive measures and response actions to be taken, including the following:</p> <ul style="list-style-type: none"> • Methods to be used for any friable ACM? • Locations where such measures and actions will be taken? • Reasons for selecting the response action or preventive measure? • Schedule for beginning and completing each preventive measure or response action? <p style="text-align: right;">(40 CFR § 763.93(e)(6))</p> <p>Note: For further details on how to conduct response actions, see 40 CFR § 763.90</p> <p>*Tip: See Model AMP Form 11 - Recommended Response Actions</p>	<p>Did you know? The LEA may select, from the response actions which protect human health and the environment, the least burdensome action (40 CFR § 763.90(a)).</p>
<input type="checkbox"/> <input type="checkbox"/> <input type="checkbox"/>	<p>22. Does the management plan include one of the following statements for the person or persons who inspected for ACM and who will design or carry out response actions, except for operations and maintenance, with respect to the ACM:</p> <ul style="list-style-type: none"> • statement that he/she is accredited under the state accreditation program, or that the LEA has used (or will use) persons accredited under another state's accreditation program or an EPA-approved course? <p style="text-align: right;">(40 CFR § 763.93(e)(7))</p> <p>*Tip: See note on Model AMP Form 3 - Designated Persons Assurances</p>	



Yes No N/A N/A - Not Applicable	School:
<input type="checkbox"/> <input type="checkbox"/> <input type="checkbox"/>	<p>23. Does the management plan include a detailed written description of each preventive measure and response action taken for friable and nonfriable ACBM and friable and nonfriable suspected ACBM assumed to be ACM, including the following:</p> <ul style="list-style-type: none"> • Methods used? • Location where the measure or action was taken? • Reasons for selecting the measure or action? • Start and completion dates of the work? • Names and addresses of all contractors involved and, if applicable, their state of accreditation and accreditation numbers? • If ACBM is removed, the name and location of storage or disposal site of the ACM? <p style="text-align: right;">(40 CFR § 763.94(b)(1))</p> <p>Note: Although not required, EPA suggests including in the AMP a copy of the accreditation.</p> <p>*Tip: See Model AMP Form 12 - Implementation of Response Actions</p>
<input type="checkbox"/> <input type="checkbox"/> <input type="checkbox"/>	<p>24. Does the management plan include the following sampling information required to be collected at the completion of certain response actions specified by 40 CFR § 763.90(i):</p> <ul style="list-style-type: none"> • Name and signature of any person collecting any air sample required to be collected? • Locations where samples were collected? • Date of collection? • Name and address of the laboratory analyzing the samples? • Date of analysis? • Results of analysis? • Method of analysis? • Name and signature of the person performing the analysis? • Statement that the laboratory meets the applicable laboratory accreditation requirements of 40 CFR § 763.90(i)(2)(ii)? <p style="text-align: right;">(40 CFR § 763.94(b)(2))</p> <p>*Tip: See Model AMP Form 12 - Implementation of Response Actions</p>
<input type="checkbox"/> <input type="checkbox"/> <input type="checkbox"/>	<p>25. Does the management plan include a detailed description in the form of a blueprint, diagram, or written description, of any ACBM or suspected ACBM assumed to be ACM that remains in the school once response actions are undertaken under 40 CFR § 763.90 and is the description updated as response actions are completed?</p> <p style="text-align: right;">(40 CFR § 763.93(e)(8))</p>
<input type="checkbox"/> <input type="checkbox"/> <input type="checkbox"/>	<p>26. For each homogeneous area where all ACBM has been removed, have records been retained in the management plan for at least 3 years after the next reinspection required under 40 CFR § 763.85(b)(1), or for an equivalent period?</p> <div style="border: 1px solid black; padding: 5px; margin-top: 10px;"> <p>Did you know? Significantly damaged friable surfacing ACM or significantly damaged friable miscellaneous ACM must be immediately isolated and access must be restricted unless isolation is not necessary to protect human health and the environment. Then, this material must be removed, or depending upon whether enclosure or encapsulation would be sufficient to protect human health and the environment, enclosed or encapsulated (40 CFR § 763.90(d)(1) - (2)).</p> </div> <p style="text-align: right;">(40 CFR §§ 763.93(h) and 763.94(a))</p>



Yes No N/A N/A - Not Applicable	School:
Operations and Maintenance	
<input type="checkbox"/> <input type="checkbox"/> <input type="checkbox"/>	<p>27. Does the management plan include a record of each cleaning conducted under 40 CFR § 763.91(c), including the following:</p> <ul style="list-style-type: none"> • Name of each person performing the cleaning? • Date of the cleaning? • Locations cleaned? • Methods used to perform the cleaning? <p style="text-align: right;">(40 CFR §§ 763.93(h) and 763.94(e))</p> <p>Note: For details on initial cleaning after an inspection and before the initiation of any response action, other than O&M activities or repair, see 40 CFR § 763.91(c)(1) and for details on any additional cleaning recommended by the management planner and approved by the LEA, see 40 CFR § 763.91(c)(2).</p> <p>*Tip: See Model AMP Form 16 - Cleaning Record</p>
<input type="checkbox"/> <input type="checkbox"/> <input type="checkbox"/>	<p>28. Does the management plan include a record of each O&M activity and major asbestos activity, with the following information:</p> <ul style="list-style-type: none"> • Name of each person performing the activity? • For a major asbestos activity, the name, signature, state of accreditation and, if applicable, the accreditation number of each person performing the activity? • Start and completion date of each activity? • Location of the activity? • Description of the activity including preventative measures used? • If ACBM is removed, the name and location of the storage and disposal site for the ACM? <p style="text-align: right;">(40 CFR §§ 763.93(h) and 763.94(f) and(g))</p> <p>Note: The response actions for any maintenance activities disturbing friable ACBM, other than small-scale, short-duration maintenance activities, must be designed by persons accredited to design response actions and conducted by persons accredited to conduct response actions (40 CFR § 763.91(e)). Although not required, EPA suggests including in the AMP a copy of the accreditation.</p> <p>*Tip: See Model AMP Form 15 - Operations and Maintenance Activities</p>
<input type="checkbox"/> <input type="checkbox"/> <input type="checkbox"/>	<p>29. Does the management plan include a record of each fiber release episode, whether major or minor, with the following information:</p> <ul style="list-style-type: none"> • Date and location of the episode? • Method of repair? • Preventive measure or response action taken? • Name of each person performing the work? • If ACBM is removed, the name and location of the storage and disposal site of the ACM? <p style="text-align: right;">(40 CFR §§ 763.93(h) and 763.94(h))</p> <p>Note: A major fiber release episode is the falling or dislodging of more than 3 square or linear feet of friable ACBM (40 CFR § 763.91(f)(2)). A minor fiber release episode is the falling or dislodging of 3 square or linear feet or less of friable ACBM (40 CFR § 763.91(f)(1)).</p> <p>*Tip: See Model AMP Form 17 - Major/Minor Fiber Release Episode Log</p>



Yes No N/A N/A - Not Applicable	School:
Periodic Surveillance	
<input type="checkbox"/> <input type="checkbox"/> <input type="checkbox"/>	<p>30. Does the management plan include a record of each periodic surveillance performed under 40 CFR § 763.92(b), with the following information:</p> <ul style="list-style-type: none"> • Name of person performing the surveillance? • Date of the surveillance? • Any changes in the condition of the material? <p style="text-align: right;">(40 CFR §§ 763.92(b)(2)(ii)-(iii), 763.93(h) and 763.94(d))</p> <p>Note: A periodic surveillance of each school building must be conducted at least once every 6 months after a management plan has been in effect (40 CFR § 763.92(b)).</p> <p>*Tip: See Model AMP Form 18 - Periodic Surveillance Plan/Report</p>
Notification	
<input type="checkbox"/> <input type="checkbox"/> <input type="checkbox"/>	<p>31. Does the management plan include the following notification information:</p> <ul style="list-style-type: none"> • Description of the steps taken to notify, in writing, at least once a year, parent, teacher and employee organizations of the availability of the management plan for review? • Dated copies of all such management plan availability notifications (e.g., letter, newsletter)? • Description of the steps taken to inform workers and building occupants, or their legal guardians, about inspections, reinspections, response actions, and post-response action activities, including periodic reinspection and surveillance activities that are planned or in progress? (Under 40 CFR § 763.84(c), the LEA must inform them about these activities at least once each school year.) <p style="text-align: right;">(40 CFR §§ 763.93(e)(10) and 763.93(g)(4))</p> <p>*Tip: See Model AMP Form 19 - Plan to Inform</p>



Appendix A - Glossary

Unless otherwise noted with an asterisk (*), the following definitions contained in this Glossary can be found under 40 CFR § 763.83:

Act means the Toxic Substances Control Act (TSCA), 15 U.S.C. 2601, et seq.

Accessible when referring to asbestos-containing material means that the material is subject to disturbance by school building occupants or custodial or maintenance personnel in the course of their normal activities.

Accredited or *accreditation* when referring to a person or laboratory means that such person or laboratory is accredited in accordance with section 206 of Title II of the Act.

Air erosion means the passage of air over friable asbestos-containing building material (ACBM) which may result in the release of asbestos fibers.

Asbestos means the asbestiform varieties of: Chrysotile (serpentine); crocidolite (riebeckite); amosite (cummingtonite/grunerite); anthophyllite; tremolite; and actinolite.

Asbestos-containing material (ACM) when referring to school buildings means any material or product which contains more than 1 percent asbestos.

Asbestos-containing building material (ACBM) means surfacing ACM, thermal system insulation ACM, or miscellaneous ACM that is found in or on interior structural members or other parts of a school building.

Asbestos debris means pieces of ACBM that can be identified by color, texture, or composition, or means dust, if the dust is determined by an accredited inspector to be ACM.

Damaged friable miscellaneous ACM means friable miscellaneous ACM which has deteriorated or sustained physical injury such that the internal structure (cohesion) of the material is inadequate or, if applicable, which has delaminated such that its bond to the substrate (adhesion) is inadequate or which for any other reason lacks fiber cohesion or adhesion qualities. Such damage or deterioration may be illustrated by the separation of ACM into layers; separation of ACM from the substrate; flaking, blistering, or crumbling of the ACM surface; water damage; significant or repeated water stains, scrapes, gouges, mars or other signs of physical injury on the ACM. Asbestos debris originating from the ACBM in question may also indicate damage.

Damaged friable surfacing ACM means friable surfacing ACM which has deteriorated or sustained physical injury such that the internal structure (cohesion) of the material is inadequate or which has delaminated such that its bond to the substrate (adhesion) is inadequate, or which, for any other reason, lacks fiber cohesion or adhesion qualities. Such damage or deterioration may be illustrated by the separation of ACM into layers; separation of ACM from the substrate; flaking, blistering, or crumbling of the ACM surface; water damage; significant or repeated water stains, scrapes, gouges, mars or other signs of physical injury on the ACM. Asbestos debris originating from the ACBM in question may also indicate damage.

Damaged or significantly damaged thermal system insulation ACM means thermal system insulation ACM on pipes, boilers, tanks, ducts, and other thermal system insulation equipment where the insulation has lost its



structural integrity, or its covering, in whole or in part, is crushed, water-stained, gouged, punctured, missing, or not intact such that it is not able to contain fibers. Damage may be further illustrated by occasional punctures, gouges or other signs of physical injury to ACM; occasional water damage on the protective coverings/jackets; or exposed ACM ends or joints. Asbestos debris originating from the ACBM in question may also indicate damage.

Designated Person means a person appointed by the Local Education Agency (LEA), under 40 CFR § 763.84 (g), who is trained to ensure the proper implementation of AHERA in school buildings. *

Encapsulation means the treatment of ACBM with a material that surrounds or embeds asbestos fibers in an adhesive matrix to prevent the release of fibers, as the encapsulant creates a membrane over the surface (bridging encapsulant) or penetrates the material and binds its components together (penetrating encapsulant).

Enclosure means an airtight, impermeable, permanent barrier around ACBM to prevent the release of asbestos fibers into the air.

Fiber release episode means any uncontrolled or unintentional disturbance of ACBM resulting in visible emission.

Friable when referring to material in a school building means that the material, when dry, may be crumbled, pulverized, or reduced to powder by hand pressure, and includes previously nonfriable material after such previously nonfriable material becomes damaged to the extent that when dry it may be crumbled, pulverized, or reduced to powder by hand pressure.

Functional space means a room, group of rooms, or homogeneous area (including crawl spaces or the space between a dropped ceiling and the floor or roof deck above), such as classroom(s), a cafeteria, gymnasium, hallway(s), designated by a person accredited to prepare management plans, design abatement projects, or conduct response actions.

High-efficiency particulate air (HEPA) refers to a filtering system capable of trapping and retaining at least 99.97 percent of all monodispersed particles 0.3 μm in diameter or larger.

Homogeneous area means an area of surfacing material, thermal system insulation material, or miscellaneous material that is uniform in color and texture.

Local education agency (LEA) means: (1) Any local educational agency as defined in section 198 of the Elementary and Secondary Education Act of 1965 (20 U.S.C. 3381). (2) The owner of any nonpublic, nonprofit elementary, or secondary school building. (3) The governing authority of any school operated under the defense dependent's education system provided for under the Defense Dependents' Education Act of 1978 (20 U.S.C. 921, et seq.).

Miscellaneous ACM means miscellaneous material that is ACM in a school building.

Miscellaneous material means interior building material on structural components, structural members or fixtures, such as floor and ceiling tiles, and does not include surfacing material or thermal system insulation.



Nonfriable means material in a school building which when dry may not be crumbled, pulverized, or reduced to powder by hand pressure.

Operations and maintenance program means a program of work practices to maintain friable ACBM in good condition, ensure clean up of asbestos fibers previously released, and prevent further release by minimizing and controlling friable ACBM disturbance or damage.

Phase contrast microscopy (PCM) refers to the procedure outlined in NIOSH Method 7400 for the evaluation of fibers in air samples.*

Polarized light microscopy (PLM) refers to the method outlined in 40 CFR § 763, Appendix E to Subpart E, for the identification of asbestos in bulk samples.*

Potential damage means circumstances in which: (1) Friable ACBM is in an area regularly used by building occupants, including maintenance personnel, in the course of their normal activities. (2) There are indications that there is a reasonable likelihood that the material or its covering will become damaged, deteriorated, or delaminated due to factors such as changes in building use, changes in operations and maintenance practices, changes in occupancy, or recurrent damage.

Potential significant damage means circumstances in which: (1) Friable ACBM is in an area regularly used by building occupants, including maintenance personnel, in the course of their normal activities. (2) There are indications that there is a reasonable likelihood that the material or its covering will become significantly damaged, deteriorated, or delaminated due to factors such as changes in building use, changes in operations and maintenance practices, changes in occupancy, or recurrent damage. (3) The material is subject to major or continuing disturbance, due to factors including, but not limited to, accessibility or, under certain circumstances, vibration or air erosion.

Preventive measures means actions taken to reduce disturbance of ACBM or otherwise eliminate the reasonable likelihood of the material's becoming damaged or significantly damaged.

Removal means the taking out or the stripping of substantially all ACBM from a damaged area, a functional space, or a homogeneous area in a school building.

Repair means returning damaged ACBM to an undamaged condition or to an intact state so as to prevent fiber release.

Response action means a method, including removal, encapsulation, enclosure, repair, operations and maintenance, that protects human health and the environment from friable ACBM.

Routine maintenance area means an area, such as a boiler room or mechanical room, that is not normally frequented by students and in which maintenance employees or contract workers regularly conduct maintenance activities.

School means any elementary or secondary school as defined in section 198 of the Elementary and Secondary Education Act of 1965 (20 U.S.C. 2854).



School building means: (1) Any structure suitable for use as a classroom, including a school facility such as a laboratory, library, school eating facility, or facility used for the preparation of food. (2) Any gymnasium or other facility which is specially designed for athletic or recreational activities for an academic course in physical education. (3) Any other facility used for the instruction or housing of students or for the administration of educational or research programs. (4) Any maintenance, storage, or utility facility, including any hallway, essential to the operation of any facility described in this definition of "school building" under paragraphs (1), (2), or (3). (5) Any portico or covered exterior hallway or walkway. (6) Any exterior portion of a mechanical system used to condition interior space.

Significantly damaged friable miscellaneous ACM means damaged friable miscellaneous ACM where the damage is extensive and severe.

Significantly damaged friable surfacing ACM means damaged friable surfacing ACM in a functional space where the damage is extensive and severe.

State means a State, the District of Columbia, the Commonwealth of Puerto Rico, Guam, American Samoa, the Northern Marianas, the Trust Territory of the Pacific Islands, and the Virgin Islands.

Surfacing ACM means surfacing material that is ACM.

Surfacing material means material in a school building that is sprayed-on, troweled-on, or otherwise applied to surfaces, such as acoustical plaster on ceilings and fireproofing materials on structural members, or other materials on surfaces for acoustical, fireproofing, or other purposes.

Thermal system insulation (TSI) means material in a school building applied to pipes, fittings, boilers, breeching, tanks, ducts, or other interior structural components to prevent heat loss or gain, or water condensation, or for other purposes.

Thermal system insulation ACM means thermal system insulation that is ACM.

Transmission electron microscopy (TEM) refers to the method outlined in 40 CFR § 763, Appendix A to Subpart E, for the identification of asbestos in air samples.*

Vibration means the periodic motion of friable ACBM which may result in the release of asbestos fibers.



Appendix B - Acronyms

ACM - Asbestos-containing material

ACBM - Asbestos-containing building material

AHERA - Asbestos Hazard Emergency Response Act

DOT - Department of Transportation

DP - AHERA Designated Person

EPA - U.S. Environmental Protection Agency

HEPA - High-efficiency particulate air

LEA - Local Education Agency

NIOSH - National Institute for Occupational Safety and Health

NIST - National Institute of Standards and Technology

NVLAP - National Voluntary Laboratory Accreditation Program

O&M - Operations and maintenance

OSHA - Occupational Safety and Health Administration

PCM - Phase contrast microscopy

PLM - Polarized light microscopy

TEM - Transmission electron microscopy

TSI - Thermal system insulation



APPENDIX E

MANAGEMENT PLANNER TRAINING INFORMATION

MANAGEMENT PLANNER INFORMATION

MANAGEMENT PLANNER: Gregory Hatch

COMPANY: American Environmental Consulting, Inc.
814 Broad Street
Weymouth, MA 02189
(781) 337-0016

SIGNATURE  DATE September 23, 2014

Accredited Course: Asbestos Management
Planner Training

State of
Accreditation: Massachusetts

Training
Provided By: Kaselaan & D'Angelo

Refresher Course
Training Provided
By: RI Analytical 11/13/2012

Refresher Course
Certificate #: RI132245

State Certification #: AP 061534

Date of Certification: 1/28/14

APPENDIX F

SAMPLE ANALYSIS RESULTS

SanAir Technologies Laboratory

Analysis Report

prepared for

**Whitman-Hanson Regional
School District**

Report Date: 12/3/2015
Project Name: Conley School
AHERA
SanAir ID#: 15037165



NVLAP LAB CODE 200870-0



Certification # 652931



License # LAB0166



804.897.1177

www.sanair.com



SanAir Technologies Laboratory, Inc.

1551 Oakbridge Drive, Suite B, Powhatan, VA 23139
804.897.1177 Toll Free: 888.895.1177 Fax: 804.897.0070
Web: <http://www.sanair.com> E-mail: iaq@sanair.com

Whitman-Hanson Regional School District
610 Franklin Street
Whitman, MA 02382

December 3, 2015

SanAir ID # 15037165
Project Name: Conley School AHERA
Project Number:

Dear G. H.,

We at SanAir would like to thank you for the work you recently submitted. The 41 sample(s) were received on Tuesday, November 24, 2015 via FedEx. The final report(s) is enclosed for the following sample(s): 112015-01A, 112015-01B, 112015-01C, 112015-02A, 112015-02B, 112015-02C, 112015-03A, 112015-03B, 112015-03C, 112015-03D, 112015-04A, 112015-04B, 112015-04C, 112015-04D, 112015-05A, 112015-05B, 112015-06A, 112015-06B, 112015-07A, 112015-07B, 112015-08A, 112015-08B, 112015-09A, 112015-09B, 112015-10A, 112015-10B, 112015-11A, 112015-11B, 112015-12A, 112015-12B, 112015-13A, 112015-13B, 112015-13C, 112015-13D, 112015-13E, 112015-13F, 112015-13G, 112015-14A, 112015-14B, 112015-15A, 112015-15B.

These results only pertain to this job and should not be used in the interpretation of any other job. This report is only complete in its entirety. Refer to the listing below of the pages included in a complete final report.

Sincerely,

Sandra Sobrino
Asbestos & Materials Laboratory Manager
SanAir Technologies Laboratory

Final Report Includes:
- Cover Letter
- Analysis Pages
- Disclaimers and Additional Information

sample conditions:
41 sample(s) in Good condition



SanAir Technologies Laboratory, Inc.

1551 Oakbridge Drive, Suite B, Powhatan, VA 23139
804.897.1177 Toll Free: 888.895.1177 Fax: 804.897.0070
Web: <http://www.sanair.com> E-mail: iaq@sanair.com

SanAir ID Number

15037165

FINAL REPORT

Name: Whitman-Hanson Regional School District
Address: 610 Franklin Street
Whitman, MA 02382

Project Number:
P.O. Number:
Project Name: Conley School AHERA

Collected Date: 11/23/2015
Received Date: 11/24/2015 2:35:00 PM
Report Date: 12/3/2015 6:12:09 PM
Analyst: Robertson, Erin

Asbestos Bulk PLM EPA 600/R-93/116

SanAir ID / Description	Stereoscopic Appearance	Components		Asbestos Fibers
		% Fibrous	% Non-Fibrous	
112015-01A / 15037165-001 Teacher Dining Rm Cove Base	Blue Non-Fibrous Homogeneous		100% Other	None Detected

SanAir ID / Description	Stereoscopic Appearance	Components		Asbestos Fibers
		% Fibrous	% Non-Fibrous	
112015-01B / 15037165-002 Room 8 Cove Base	Blue Non-Fibrous Homogeneous		100% Other	None Detected

SanAir ID / Description	Stereoscopic Appearance	Components		Asbestos Fibers
		% Fibrous	% Non-Fibrous	
112015-01C / 15037165-003 Room 1 Cove Base	Blue Non-Fibrous Homogeneous		100% Other	None Detected

SanAir ID / Description	Stereoscopic Appearance	Components		Asbestos Fibers
		% Fibrous	% Non-Fibrous	
112015-02A / 15037165-004 Teacher Dining Rm Mastic	Yellow Non-Fibrous Homogeneous		100% Other	None Detected

SanAir ID / Description	Stereoscopic Appearance	Components		Asbestos Fibers
		% Fibrous	% Non-Fibrous	
112015-02B / 15037165-005 Room 8 Mastic	Yellow Non-Fibrous Homogeneous		100% Other	None Detected

SanAir ID / Description	Stereoscopic Appearance	Components		Asbestos Fibers
		% Fibrous	% Non-Fibrous	
112015-02C / 15037165-006 Room 1 Mastic	Yellow Non-Fibrous Homogeneous		100% Other	None Detected

SanAir ID / Description	Stereoscopic Appearance	Components		Asbestos Fibers
		% Fibrous	% Non-Fibrous	
112015-03A / 15037165-007 Teacher Dining Rm Sheetrock	White Non-Fibrous Homogeneous	5% Cellulose 2% Glass	93% Other	None Detected

Certification

Analyst: *Erin Robertson*

Approved Signatory:

Analysis Date: 12/3/2015

Date: 12/3/2015

Page 1 of 6



SanAir Technologies Laboratory, Inc.

1551 Oakbridge Drive, Suite B, Powhatan, VA 23139
804.897.1177 Toll Free: 888.895.1177 Fax: 804.897.0070
Web: <http://www.sanair.com> E-mail: iaq@sanair.com

SanAir ID Number

15037165

FINAL REPORT

Name: Whitman-Hanson Regional School District
Address: 610 Franklin Street
Whitman, MA 02382

Project Number:
P.O. Number:
Project Name: Conley School AHERA

Collected Date: 11/23/2015
Received Date: 11/24/2015 2:35:00 PM
Report Date: 12/3/2015 6:12:09 PM
Analyst: Robertson, Erin

Asbestos Bulk PLM EPA 600/R-93/116

SanAir ID / Description	Stereoscopic Appearance	Components		Asbestos Fibers
		% Fibrous	% Non-Fibrous	
112015-03B / 15037165-008 Room 8 Sheetrock	White Non-Fibrous Homogeneous	5% Cellulose 2% Glass	93% Other	None Detected

SanAir ID / Description	Stereoscopic Appearance	Components		Asbestos Fibers
		% Fibrous	% Non-Fibrous	
112015-03C / 15037165-009 Room 27 Sheetrock	White Non-Fibrous Homogeneous	5% Cellulose 2% Glass	93% Other	None Detected

SanAir ID / Description	Stereoscopic Appearance	Components		Asbestos Fibers
		% Fibrous	% Non-Fibrous	
112015-03D / 15037165-010 Room 32 Sheetrock	White Non-Fibrous Homogeneous	5% Cellulose 2% Glass	93% Other	None Detected

SanAir ID / Description	Stereoscopic Appearance	Components		Asbestos Fibers
		% Fibrous	% Non-Fibrous	
112015-04A / 15037165-011 Teacher Dining Rm Joint Compound	White Non-Fibrous Homogeneous		100% Other	None Detected

SanAir ID / Description	Stereoscopic Appearance	Components		Asbestos Fibers
		% Fibrous	% Non-Fibrous	
112015-04B / 15037165-012 Room 8 Joint Compound	White Non-Fibrous Homogeneous		100% Other	None Detected

SanAir ID / Description	Stereoscopic Appearance	Components		Asbestos Fibers
		% Fibrous	% Non-Fibrous	
112015-04C / 15037165-013 Room 27 Joint Compound	White Non-Fibrous Homogeneous		100% Other	None Detected

SanAir ID / Description	Stereoscopic Appearance	Components		Asbestos Fibers
		% Fibrous	% Non-Fibrous	
112015-04D / 15037165-014 Room 32 Joint Compound	White Non-Fibrous Homogeneous		100% Other	None Detected

Certification

Analyst: *Erin Robertson*

Approved Signatory: *[Signature]*

Analysis Date: 12/3/2015

Date: 12/3/2015

Page 2 of 6



SanAir Technologies Laboratory, Inc.

1551 Oakbridge Drive, Suite B, Powhatan, VA 23139
804.897.1177 Toll Free: 888.895.1177 Fax: 804.897.0070
Web: <http://www.sanair.com> E-mail: iaq@sanair.com

SanAir ID Number

15037165

FINAL REPORT

Name: Whitman-Hanson Regional School District
Address: 610 Franklin Street
Whitman, MA 02382

Project Number:
P.O. Number:
Project Name: Conley School AHERA

Collected Date: 11/23/2015
Received Date: 11/24/2015 2:35:00 PM
Report Date: 12/3/2015 6:12:09 PM
Analyst: Robertson, Erin

Asbestos Bulk PLM EPA 600/R-93/116

SanAir ID / Description	Stereoscopic Appearance	Components		Asbestos Fibers
		% Fibrous	% Non-Fibrous	
112015-05A / 15037165-015 Teacher Dining Rm 2x4 Faux 2x4 Ceiling Tile	White Fibrous Homogeneous	50% Cellulose 40% Min. Wool	10% Other	None Detected

SanAir ID / Description	Stereoscopic Appearance	Components		Asbestos Fibers
		% Fibrous	% Non-Fibrous	
112015-05B / 15037165-016 Guidance 2x4 Faux 2x2 Ceiling Tile	White Fibrous Homogeneous	50% Cellulose 40% Min. Wool	10% Other	None Detected

SanAir ID / Description	Stereoscopic Appearance	Components		Asbestos Fibers
		% Fibrous	% Non-Fibrous	
112015-06A / 15037165-017 Teacher Dining Rm 12x12	White Non-Fibrous Homogeneous		100% Other	None Detected

SanAir ID / Description	Stereoscopic Appearance	Components		Asbestos Fibers
		% Fibrous	% Non-Fibrous	
112015-06B / 15037165-018 Room 1 12x12	Yellow Non-Fibrous Homogeneous		100% Other	None Detected

SanAir ID / Description	Stereoscopic Appearance	Components		Asbestos Fibers
		% Fibrous	% Non-Fibrous	
112015-07A / 15037165-019 Teacher Dining Rm Mastic	Yellow Non-Fibrous Homogeneous		100% Other	None Detected

SanAir ID / Description	Stereoscopic Appearance	Components		Asbestos Fibers
		% Fibrous	% Non-Fibrous	
112015-07B / 15037165-020 Room 1 Mastic	Yellow Non-Fibrous Homogeneous		100% Other	None Detected

SanAir ID / Description	Stereoscopic Appearance	Components		Asbestos Fibers
		% Fibrous	% Non-Fibrous	
112015-08A / 15037165-021 Room 6 2'x4' Ceiling Tile	White Fibrous Homogeneous	50% Cellulose 40% Min. Wool	10% Other	None Detected

Certification

Analyst: *Erin Robertson*

Approved Signatory: *[Signature]*

Analysis Date: 12/3/2015

Date: 12/3/2015

Page 3 of 6



SanAir Technologies Laboratory, Inc.

1551 Oakbridge Drive, Suite B, Powhatan, VA 23139
804.897.1177 Toll Free: 888.895.1177 Fax: 804.897.0070
Web: <http://www.sanair.com> E-mail: iaq@sanair.com

SanAir ID Number

15037165

FINAL REPORT

Name: Whitman-Hanson Regional School District
Address: 610 Franklin Street
Whitman, MA 02382

Project Number:
P.O. Number:
Project Name: Conley School AHERA

Collected Date: 11/23/2015
Received Date: 11/24/2015 2:35:00 PM
Report Date: 12/3/2015 6:12:09 PM
Analyst: Robertson, Erin

Asbestos Bulk PLM EPA 600/R-93/116

SanAir ID / Description	Stereoscopic Appearance	Components		Asbestos Fibers
		% Fibrous	% Non-Fibrous	
112015-08B / 15037165-022 Room 1 2'x4' Ceiling Tile	White Fibrous Homogeneous	50% Cellulose 40% Min. Wool	10% Other	None Detected

SanAir ID / Description	Stereoscopic Appearance	Components		Asbestos Fibers
		% Fibrous	% Non-Fibrous	
112015-09A / 15037165-023 Hall At Room 16 Glue Daub	Brown Non-Fibrous Homogeneous		98% Other	2% Anthophyllite

SanAir ID / Description	Stereoscopic Appearance	Components		Asbestos Fibers
		% Fibrous	% Non-Fibrous	
112015-09B / 15037165-024 Hall At Room 10 Glue Daub				Not Analyzed

SanAir ID / Description	Stereoscopic Appearance	Components		Asbestos Fibers
		% Fibrous	% Non-Fibrous	
112015-10A / 15037165-025 Hall At Room 16 1'x2' Ceiling Tile	White Fibrous Homogeneous	70% Min. Wool 20% Cellulose	10% Other	None Detected

SanAir ID / Description	Stereoscopic Appearance	Components		Asbestos Fibers
		% Fibrous	% Non-Fibrous	
112015-10B / 15037165-026 Hall At Room 10 1'x1' Ceiling Tile	White Fibrous Homogeneous	70% Min. Wool 20% Cellulose	10% Other	None Detected

SanAir ID / Description	Stereoscopic Appearance	Components		Asbestos Fibers
		% Fibrous	% Non-Fibrous	
112015-11A / 15037165-027 Kitchen 2'x4' Ceiling Tile	White Fibrous Homogeneous	60% Min. Wool 30% Cellulose	10% Other	None Detected

SanAir ID / Description	Stereoscopic Appearance	Components		Asbestos Fibers
		% Fibrous	% Non-Fibrous	
112015-11B / 15037165-028 Kitchen 2'x4' Ceiling Tile	White Fibrous Homogeneous	60% Min. Wool 30% Cellulose	10% Other	None Detected

Certification

Analyst: *Erin Robertson*

Approved Signatory: *[Signature]*

Analysis Date: 12/3/2015

Date: 12/3/2015

Page 4 of 6



SanAir Technologies Laboratory, Inc.

1551 Oakbridge Drive, Suite B, Powhatan, VA 23139
804.897.1177 Toll Free: 888.895.1177 Fax: 804.897.0070
Web: <http://www.sanair.com> E-mail: iaq@sanair.com

SanAir ID Number

15037165

FINAL REPORT

Name: Whitman-Hanson Regional School District
Address: 610 Franklin Street
Whitman, MA 02382

Project Number:
P.O. Number:
Project Name: Conley School AHERA

Collected Date: 11/23/2015
Received Date: 11/24/2015 2:35:00 PM
Report Date: 12/3/2015 6:12:09 PM
Analyst: Robertson, Erin

Asbestos Bulk PLM EPA 600/R-93/116

SanAir ID / Description	Stereoscopic Appearance	Components		Asbestos Fibers
		% Fibrous	% Non-Fibrous	
112015-12A / 15037165-029 Room 10 1'x1' Ceiling Tile	White Fibrous Homogeneous	60% Min. Wool 30% Cellulose	10% Other	None Detected

SanAir ID / Description	Stereoscopic Appearance	Components		Asbestos Fibers
		% Fibrous	% Non-Fibrous	
112015-12B / 15037165-030 Room 8 1'x1' Ceiling Tile	White Fibrous Homogeneous	60% Min. Wool 30% Cellulose	10% Other	None Detected

SanAir ID / Description	Stereoscopic Appearance	Components		Asbestos Fibers
		% Fibrous	% Non-Fibrous	
112015-13A / 15037165-031 Room 8 Acoustic Ceiling Plaster	White Non-Fibrous Homogeneous		100% Other	None Detected

SanAir ID / Description	Stereoscopic Appearance	Components		Asbestos Fibers
		% Fibrous	% Non-Fibrous	
112015-13B / 15037165-032 Room 9 Acoustic Ceiling Plaster	White Non-Fibrous Homogeneous		100% Other	None Detected

SanAir ID / Description	Stereoscopic Appearance	Components		Asbestos Fibers
		% Fibrous	% Non-Fibrous	
112015-13C / 15037165-033 Room 10 Acoustic Ceiling Plaster	White Non-Fibrous Homogeneous		100% Other	None Detected

SanAir ID / Description	Stereoscopic Appearance	Components		Asbestos Fibers
		% Fibrous	% Non-Fibrous	
112015-13D / 15037165-034 Room 11 Acoustic Ceiling Plaster	White Non-Fibrous Homogeneous		100% Other	None Detected

SanAir ID / Description	Stereoscopic Appearance	Components		Asbestos Fibers
		% Fibrous	% Non-Fibrous	
112015-13E / 15037165-035 Room 12 Acoustic Ceiling Plaster	White Non-Fibrous Homogeneous		100% Other	None Detected

Certification

Analyst: *Erin Robertson*

Approved Signatory: *[Signature]*

Analysis Date: 12/3/2015

Date: 12/3/2015

Page 5 of 6



SanAir Technologies Laboratory, Inc.

1551 Oakbridge Drive, Suite B, Powhatan, VA 23139
804.897.1177 Toll Free: 888.895.1177 Fax: 804.897.0070
Web: <http://www.sanair.com> E-mail: iaq@sanair.com

SanAir ID Number

15037165

FINAL REPORT

Name: Whitman-Hanson Regional School District
Address: 610 Franklin Street
Whitman, MA 02382

Project Number:
P.O. Number:
Project Name: Conley School AHERA

Collected Date: 11/23/2015
Received Date: 11/24/2015 2:35:00 PM
Report Date: 12/3/2015 6:12:09 PM
Analyst: Robertson, Erin

Asbestos Bulk PLM EPA 600/R-93/116

SanAir ID / Description	Stereoscopic Appearance	Components		Asbestos Fibers
		% Fibrous	% Non-Fibrous	
112015-13F / 15037165-036 Room 15 Acoustic Ceiling Plaster	White Non-Fibrous Homogeneous		100% Other	None Detected

SanAir ID / Description	Stereoscopic Appearance	Components		Asbestos Fibers
		% Fibrous	% Non-Fibrous	
112015-13G / 15037165-037 Room 16 Acoustic Ceiling Plaster	White Non-Fibrous Homogeneous		100% Other	None Detected

SanAir ID / Description	Stereoscopic Appearance	Components		Asbestos Fibers
		% Fibrous	% Non-Fibrous	
112015-14A / 15037165-038 Hall At Bathroom (Rm 18) 12x12 VFT	Blue Non-Fibrous Homogeneous		100% Other	None Detected

SanAir ID / Description	Stereoscopic Appearance	Components		Asbestos Fibers
		% Fibrous	% Non-Fibrous	
112015-14B / 15037165-039 Hall At Main Entry Foyer 12x12 VFT	Blue Non-Fibrous Homogeneous		100% Other	None Detected

SanAir ID / Description	Stereoscopic Appearance	Components		Asbestos Fibers
		% Fibrous	% Non-Fibrous	
112015-15A / 15037165-040 Hall At Bathrom (Rm 18) Mastic	Yellow Non-Fibrous Homogeneous		100% Other	None Detected

SanAir ID / Description	Stereoscopic Appearance	Components		Asbestos Fibers
		% Fibrous	% Non-Fibrous	
112015-15B / 15037165-041 Hall At Main Entry Foyer Mastic	Yellow Non-Fibrous Homogeneous		100% Other	None Detected

Certification

Analyst: *Erin Robertson*

Approved Signatory: *[Signature]*

Analysis Date: 12/3/2015

Date: 12/3/2015

Page 6 of 6

Disclaimer

The final report cannot be reproduced, except in full, without written authorization from SanAir. Fibers smaller than 5 microns cannot be seen with this method due to scope limitations. The accuracy of the results is dependent upon the client's sampling procedure and information provided to the laboratory by the client. SanAir assumes no responsibility for the sampling procedure and will provide evaluation reports based solely on the sample and information provided by the client. This report may not be used by the client to claim product endorsement by NVLAP or any other agency of the U.S. government.

For NY state samples, method EPA 600/M4-82-020 is performed.

Polarized- light microscopy is not consistently reliable in detecting asbestos in floor covering and similar non-friable organically bound materials. Quantitative transmission electron microscopy is currently the only method that can be used to determine if this material can be considered or treated as non-asbestos containing.

NY ELAP lab ID 11983

15037165

Relinquished by: C. Hatch Date/Time: 11/23/15
 Received by: Justin Proulx Date/Time: 11-23-15 2:30pm
 Relinquished by: Justin Proulx Date/Time: 11-23-15 2:30pm
 Received by: Justin Proulx Date/Time: 11-23-15 2:30pm

Client Name: American Environmental Consultants - 814 Broad St Weymouth, MA 02189
 Project # 15037165
 American Client: Whitman Hanson PSD
 Project: Conley Street
 Proj. Address: 60 Forest St Weymouth State (Required): 1028

AEC Laboratories, LLC
 814 Broad Street
 Weymouth, MA 02189
 Phone: 781-337-0567
 Fax: 781-337-0986
 labreports@americanenviro.com

BULK SAMPLE CHAIN OF CUSTODY
 Page 1 of 3

Analysis: PLM Positive Stop Qualitative Point Count NOB Prep TEM Chat Lead PCB

AEC Laboratories ID: 15135
 Special Instructions: James Bill - Whitman Hanson

Turnaround Time: RUSH 24 Hour 48 Hour 3 Day 5 Day

Verbal Results: Y/N
 Cell #: 609.511.1111
 Name: James Bill - Whitman Hanson

Sampled By: C. Hatch Date: 11/23/15
 Results to (PM): C. Hatch

LAB ID	FIELD ID	LOCATION	SAMPLE DESCRIPTION	Homogen-ous Area	Material Type
	15015-01A	Teacher Dining Rm	blue cover base		
	-01B	Room 8			
	-01C	Room 1			
	-02A	same as 01A			
	-02B	" " 01B			
	-02C	" " 01C			
	-03A	Teacher Dining Rm	Shed CR		
	-03B	Room 8			
	-03C	Room 27			
	-03D	Room 32			
	-04A	same as 03A	Joint Compound		
	-04B	" " 03B			
	-04C	" " 03C			
	-04D	" " 03D			
	-05A	Teacher Dining Rm	2x4 faux 2x2 ceiling tile		
	-05B	Teacher Dining Rm			
	-06A	Teacher Dining Rm	12x12 white w/ blue		
	-06B	Room 1			
	-07A	same as 06A			
	-07B	" " 06B			

3

NOV 24 2015

10:35

11037165

Relinquished by: G. Hatcher Date/Time: 11/23/15
 Received by: Austin Leave Date/Time: 11-23-15 2:30pm
 Relinquished by: Austin Leave Date/Time: 11-23-15 2:30pm
 Received by: _____ Date/Time: _____

Client Name: American Environmental Consultants - 814 Broad St Weymouth, MA 02189
 Project # _____
 American Client: Whitman Hanson RSD
 Project: Conley School AHERA
 Proj. Address: 814 Broad St Weymouth State (Required): MA

AEC Laboratories, LLC
 814 Broad Street
 Weymouth, MA 02189
 Phone: 781-337-0567
 Fax: 781-337-0986
 labreports@americanenviro.com
 Page 7 of 7
BULK SAMPLE CHAIN OF CUSTODY

Analysis: PLM Positive Stop Qualitative Point Count NOB Prep TEM Chat Lead PCB

Turnaround Time: RUSH 24 Hour 48 Hour 3 Day 5 Day

Sampled By: G. Hatcher Verbal Results: Y/N

Date: 11/20/15 Cell #: 05011

Results to (PM): G. Hatcher Name: _____

AEC Laboratories ID: 15135
 Special Instructions: Invoices Whitman Hanson Ernie Sandhand

LAB ID	FIELD ID	LOCATION	SAMPLE DESCRIPTION	Homogen- ous Area	Material Type
11505-684		Room 6	3'x4' ceiling tile		
088		Room 1			
094		Hall at room 12			
098		" "			
104		Hall at Room 16	3'x4' square ceiling tiles		
108		" "			
114		Kitchen	3'x4' solid ceiling tile		
118		" "			
124		Room 10	1'x1' perforated square ceiling tile		
128		Room 8			
134		Room 8	Acoustics ceiling plaster		
138		Room 9			
142		Room 10			
146		Room 11			
150		Room 12			
154		Room 13			
158		Room 14			
162		Room 15			
166		Room 16			
170		Hall at Cafeteria (Room 18)	3'x4' square of blue chip vinyl		
174		Hall at room 16/17 foyer			
178		same as 174			
182		same as 174			
186		same as 174			

NOV 24 2015 10:35

SanAir Technologies Laboratory

Analysis Report

prepared for

AEC Laboratories, LLC

Report Date: 12/17/2015
Project Name: Conley School
AHERA
Project #: 421902
SanAir ID#: 15038960



NVLAP LAB CODE 200870-0



Certification # 652931



License # LAB0166



804.897.1177

www.sanair.com



SanAir Technologies Laboratory, Inc.

1551 Oakbridge Drive, Suite B, Powhatan, VA 23139
804.897.1177 Toll Free: 888.895.1177 Fax: 804.897.0070
Web: <http://www.sanair.com> E-mail: iaq@sanair.com

AEC Laboratories, LLC
814 Broad Street
Weymouth, MA 02189

December 17, 2015

SanAir ID # 15038960
Project Name: Conley School AHERA
Project Number: 421902

Dear G. Hatch,

We at SanAir would like to thank you for the work you recently submitted. The 9 sample(s) were received on Thursday, December 10, 2015 via FedEx. The final report(s) is enclosed for the following sample(s): 120915-01A, 120915-01B, 120915-01C, 120915-02A, 120915-02B, 120915-02C, 120915-03A, 120915-03B, 120915-03C.

These results only pertain to this job and should not be used in the interpretation of any other job. This report is only complete in its entirety. Refer to the listing below of the pages included in a complete final report.

Sincerely,

Sandra Sobrino
Asbestos & Materials Laboratory Manager
SanAir Technologies Laboratory

Final Report Includes:

- Cover Letter
- Analysis Pages
- Disclaimers and Additional Information

sample conditions:

9 sample(s) in Good condition



SanAir Technologies Laboratory, Inc.

1551 Oakbridge Drive, Suite B, Powhatan, VA 23139
804.897.1177 Toll Free: 888.895.1177 Fax: 804.897.0070
Web: <http://www.sanair.com> E-mail: iaq@sanair.com

SanAir ID Number

15038960

FINAL REPORT

Name: AEC Laboratories, LLC
Address: 814 Broad Street
Weymouth, MA 02189

Project Number: 421902
P.O. Number: 15261
Project Name: Conley School AHERA

Collected Date: 12/9/2015
Received Date: 12/10/2015 10:50:00 AM
Report Date: 12/17/2015 5:29:48 PM
Analyst: Vaughan, Nathaniel

Asbestos Bulk PLM EPA 600/R-93/116

SanAir ID / Description	Stereoscopic Appearance	Components		Asbestos Fibers
		% Fibrous	% Non-Fibrous	
120915-01A / 15038960-001 Boiler Room Boiler Breech Skim	Off-White Non-Fibrous Heterogeneous		100% Other	None Detected

SanAir ID / Description	Stereoscopic Appearance	Components		Asbestos Fibers
		% Fibrous	% Non-Fibrous	
120915-01B / 15038960-002 Boiler Room Boiler Breech Skim	Off-White Non-Fibrous Heterogeneous		100% Other	None Detected

SanAir ID / Description	Stereoscopic Appearance	Components		Asbestos Fibers
		% Fibrous	% Non-Fibrous	
120915-01C / 15038960-003 Boiler Room Boiler Breech Skim	Off-White Non-Fibrous Heterogeneous		100% Other	None Detected

SanAir ID / Description	Stereoscopic Appearance	Components		Asbestos Fibers
		% Fibrous	% Non-Fibrous	
120915-02A / 15038960-004 Boiler Room Boiler Breech Insulation Board	Beige Fibrous Heterogeneous	85% Cellulose	15% Other	None Detected

SanAir ID / Description	Stereoscopic Appearance	Components		Asbestos Fibers
		% Fibrous	% Non-Fibrous	
120915-02B / 15038960-005 Boiler Room Boiler Breech Insulation Board	Beige Fibrous Heterogeneous	85% Cellulose	15% Other	None Detected

SanAir ID / Description	Stereoscopic Appearance	Components		Asbestos Fibers
		% Fibrous	% Non-Fibrous	
120915-02C / 15038960-006 Boiler Room Boiler Breech Insulation Board	Beige Fibrous Heterogeneous	85% Cellulose	15% Other	None Detected

SanAir ID / Description	Stereoscopic Appearance	Components		Asbestos Fibers
		% Fibrous	% Non-Fibrous	
120915-03A / 15038960-007 Boiler Room Boiler Breech	Off-White Non-Fibrous Heterogeneous	40% Cellulose	60% Other	None Detected

Certification

Analyst: 

Analysis Date: 12/17/2015

Approved Signatory: 

Date: 12/17/2015

Page 1 of 2



SanAir Technologies Laboratory, Inc.

1551 Oakbridge Drive, Suite B, Powhatan, VA 23139
804.897.1177 Toll Free: 888.895.1177 Fax: 804.897.0070
Web: <http://www.sanair.com> E-mail: iaq@sanair.com

SanAir ID Number

15038960

FINAL REPORT

Name: AEC Laboratories, LLC
Address: 814 Broad Street
Weymouth, MA 02189

Project Number: 421902
P.O. Number: 15261
Project Name: Conley School AHERA

Collected Date: 12/9/2015
Received Date: 12/10/2015 10:50:00 AM
Report Date: 12/17/2015 5:29:48 PM
Analyst: Vaughan, Nathaniel

Asbestos Bulk PLM EPA 600/R-93/116

SanAir ID / Description	Stereoscopic Appearance	Components		Asbestos Fibers
		% Fibrous	% Non-Fibrous	
120915-03B / 15038960-008 Boiler Room Boiler Breech	Off-White Non-Fibrous Heterogeneous	40% Cellulose	60% Other	None Detected

SanAir ID / Description	Stereoscopic Appearance	Components		Asbestos Fibers
		% Fibrous	% Non-Fibrous	
120915-03C / 15038960-009 Boiler Room Boiler Breech	Off-White Non-Fibrous Heterogeneous	40% Cellulose	60% Other	None Detected

Certification

Analyst: *Nathaniel Vaughan*
Analysis Date: 12/17/2015

Approved Signatory: *Sandra Sobierko*
Date: 12/17/2015

Disclaimer

The final report cannot be reproduced, except in full, without written authorization from SanAir. Fibers smaller than 5 microns cannot be seen with this method due to scope limitations. The accuracy of the results is dependent upon the client's sampling procedure and information provided to the laboratory by the client. SanAir assumes no responsibility for the sampling procedure and will provide evaluation reports based solely on the sample and information provided by the client. This report may not be used by the client to claim product endorsement by NVLAP or any other agency of the U.S. government.

For NY state samples, method EPA 600/M4-82-020 is performed.

Polarized- light microscopy is not consistently reliable in detecting asbestos in floor covering and similar non-friable organically bound materials. Quantitative transmission electron microscopy is currently the only method that can be used to determine if this material can be considered or treated as non-asbestos containing.

NY ELAP lab ID 11983

15036960

Relinquished by: S. Patch Date/Time: 12/9/15
 Received by: Antonia Date/Time: 12/9/15 10:00
 Relinquished by: Antonia Date/Time: 12/9/15 EDR
 Received by: _____ Date/Time: _____

Client Name: American Environmental Consultants - 814 Broad St Weymouth, MA 02189

Project # 421952

Americ an Client: WHPSP
 Project: Conley School AHERA
 Proj. Address: 100 Forest St State (Required): Whitman, MA

AEC Laboratories, LLC
 814 Broad Street
 Weymouth, MA 02189
 Phone: 781-337-0567
 Fax: 781-337-0986
 labreports@americanenviro.com

Page 1 of 1

BULK SAMPLE CHAIN OF CUSTODY

Analysis: PLM Positive Stop Qualitative Point Count NOB Prep TEM Chat Lead PCB

Turnaround Time: RUSH 24 Hour 48 Hour 3 Day 5 Day

AEC Laboratories ID: 15261

Sampled By: S. Patch
 Date: 12/9/15
 Results to (PM): S. Patch

Verbal Results: _____
 Cell #: email
 Name: _____
 Special Instructions: BITTS- ERIC SANDLAND
WHITMAN SCHOOLS

LAB ID	FIELD ID	LOCATION	SAMPLE DESCRIPTION	Homogen- ous Area	Material Type
	150915-01A	Boiler Room	Boiler breach round gray skin		
	-01B				
	-01C				
	-01H		Boiler breach round insulating board		
	-02B				
	-02C				
	-03K		Boiler breach square		
	-03R				
	-03Z				

APPENDIX G

MEMO TO PARENTS

**Whitman-Hanson Regional School District
Facilities Management Department**

**ANNUAL ASBESTOS NOTIFICATION LETTER
For School Year 2015-2016**

September 17, 2015

Re: Annual Notification of AHERA Management Plan

Dear Parents, Teachers, Employee Organizations, Building Occupants and Legal Guardians of Children:

In accordance with the Asbestos Hazard Emergency Response Act (AHERA) regulations concerning notification of plan availability, please be advised that copies of our District's Asbestos Management Plans are available online at www.whrsd.org under District Departments -> Facilities Services and then selecting Facilities Documents. Plans are also available in our District Central Office during normal operating hours.

The management plans are site-specific guidance documents that the District must follow in managing the asbestos-containing building materials (ACBM) present in some of the schools. The plan is updated to keep it current with on-going operations and maintenance, periodic inspections and response action activities. Our plan is undergoing a regulated review this school year.

Any inquiries regarding the management of asbestos containing materials in our schools should be directed to our district's AHERA Designated Person, Ernest Sandland, Facilities Manager, who can be reached at Whitman Hanson Regional High School; by e-mail at ernest.sandland@whrsd.org and via telephone at 781-618-7435.

Ernest Sandland
Facilities Manager

APPENDIX H
EMPLOYEE TRAINING DOCUMENTATION

SAFETY TRAINING SIGN-IN SHEET

 Topic: 2 hour Asbestos Awareness Training per AHERA regulation 40 CFR 763

 Client: Whitman Hanson Schools Trainer: Paul Matuszko, CIH Date: 4/25/14

 Time: _____ Location: Whitman Hanson High School

 Department: Facilities Services Training Materials/Methods: _____

 Power point presentation, labels, quiz, etc.

Name (Print)	Name (sign)	Title	Dept.
1. Paul Matuszko	<i>Paul Matuszko</i>	TRAINER	FLI ENV
2. John F. Kemmett	<i>John F. Kemmett</i>	HVAC	MAINTENANCE
3. Kevin Leadbetter	<i>Kevin Leadbetter</i>		MAINTENANCE
4. James Bettere	<i>James Bettere</i>		" "
5. MATT CREW	<i>Matthew J. Crew</i>	MAINTENANCE	-
6. RICHARD FINCH	<i>Richard Finch</i>	MAINTENANCE	
7.			
8.			
9.			
10.			
11.			
12.			
13.			
14.			
15.			



Paul Matuszko
Environmental Consulting

Two-Hour
ASBESTOS AWARENESS TRAINING
Review Quiz

Name: Richard FINCH Date: 4/25/14

Department: Maintenance Title/Job: MAINTANCE

Circle True (T) or False (F) which best answers each question:

- | | True | False |
|---|------------------------------------|------------------------------------|
| 1. Asbestos-containing material (ACM) is defined as a material containing any percentage of asbestos. | T | <input checked="" type="radio"/> F |
| 2. Agencies that regulate asbestos include; the Federal EPA and OSHA and the Massachusetts DEP and DLS. | <input checked="" type="radio"/> T | F |
| 3. Asbestos exposure and smoking increases a person's risk for developing lung cancer. | <input checked="" type="radio"/> T | F |
| 4. As long as you don't smoke, your body's defense mechanisms will always protect you from asbestos exposure. | T | <input checked="" type="radio"/> F |
| 5. A paper dust mask is sufficient to protect you from asbestos fibers inhalation. | T | <input checked="" type="radio"/> F |
| 6. The three classes of ACMs are <u>surfacing material</u> , <u>flooring materials</u> and <u>thermal system insulation</u> . | T | <input checked="" type="radio"/> F |
| 7. Asbestos is used in building materials due to its excellent insulating properties, chemical resistance, tensile strength and easy manufacturing production properties. | <input checked="" type="radio"/> T | F |
| 8. Products containing asbestos can still be commercially purchased in the USA. | <input checked="" type="radio"/> T | F |
| 9. The condition and friability of an ACM will determine its potential exposure hazard rating. | <input checked="" type="radio"/> T | F |
| 10. An Asbestos Management Plan is only concerned with exposed asbestos pipe insulation and surfacing material in public areas. | T | <input checked="" type="radio"/> F |
| 11. Anyone can legally remove asbestos in quantities less than 3 square or linear feet. | T | <input checked="" type="radio"/> F |
| 12. Amosite and crocidolite are the most commonly found asbestos types, while chrysotile is rare. | T | <input checked="" type="radio"/> F |
| 13. Building owners/managers are required to post labels and warning signs only in the main boiler room of a building. | T | <input checked="" type="radio"/> F |
| 14. The health effects of asbestos are acute and can be reversed over time. | T | <input checked="" type="radio"/> F |
| 15. In general, buildings constructed from 1945 to 1972 will contain the most ACMs. | <input checked="" type="radio"/> T | F |



Paul Matuszko
Environmental Consulting

**Two-Hour
ASBESTOS AWARENESS TRAINING
Review Quiz**

Name: John F Kemmick
(print)

Date: 4/25/14

Department: HVAC

Title/Job: Maintenance

Circle True (T) or False (F) which best answers each question:

- | | True | False |
|---|------------------------------------|------------------------------------|
| 1. Asbestos-containing material (ACM) is defined as a material containing any percentage of asbestos. | T | <input checked="" type="radio"/> F |
| 2. Agencies that regulate asbestos include; the Federal EPA and OSHA and the Massachusetts DEP and DLS. | <input checked="" type="radio"/> T | F |
| 3. Asbestos exposure and smoking increases a person's risk for developing lung cancer. | <input checked="" type="radio"/> T | F |
| 4. As long as you don't smoke, your body's defense mechanisms will always protect you from asbestos exposure. | T | <input checked="" type="radio"/> F |
| 5. A paper dust mask is sufficient to protect you from asbestos fibers inhalation. | T | <input checked="" type="radio"/> F |
| 6. The three classes of ACMs are <u>surfacing material</u> , <u>flooring materials</u> and <u>thermal system insulation</u> . | T | <input checked="" type="radio"/> F |
| 7. Asbestos is used in building materials due to its excellent insulating properties, chemical resistance, tensile strength and easy manufacturing production properties. | <input checked="" type="radio"/> T | F |
| 8. Products containing asbestos can still be commercially purchased in the USA. | <input checked="" type="radio"/> T | F |
| 9. The condition and friability of an ACM will determine its potential exposure hazard rating. | <input checked="" type="radio"/> T | F |
| 10. An Asbestos Management Plan is only concerned with exposed asbestos pipe insulation and surfacing material in public areas. | T | <input checked="" type="radio"/> F |
| 11. Anyone can legally remove asbestos in quantities less than 3 square or linear feet. | T | <input checked="" type="radio"/> F |
| 12. Amosite and crocidolite are the most commonly found asbestos types, while chrysotile is rare. | T | <input checked="" type="radio"/> F |
| 13. Building owners/managers are required to post labels and warning signs only in the main boiler room of a building. | T | <input checked="" type="radio"/> F |
| 14. The health effects of asbestos are acute and can be reversed over time. | T | <input checked="" type="radio"/> F |
| 15. In general, buildings constructed from 1945 to 1972 will contain the most ACMs. | <input checked="" type="radio"/> T | F |

Periodic Surveillance

School Name & Address

Date:

Performed by _____ (signature of person performing surveillance)

Location	Description	Amount (LF/SF)	Change in Condition	Comments
Boiler Room	Tank Insulation	200sf	Yes	Minor contact damage
	Fittings	15 ea	No	
Room B-1	9x9 mint green floor tiles	600sf	Yes	Cracks by univent
Library	9x9 brown floor tiles	1200 sf	No	
1 st floor hallway	12x12 white floor tiles	3200sf	No	Cracks by gym door still present



Paul Matuszko
Environmental Consulting

**Two-Hour
ASBESTOS AWARENESS TRAINING
Review Quiz**

Name: JAMES BETTERS Date: 4/25/14
(print)

Department: Main Title/Job: Main

Circle True (T) or False (F) which best answers each question:

- | | True | False |
|---|--------------|--------------|
| 1. Asbestos-containing material (ACM) is defined as a material containing any percentage of asbestos. | T | F |
| 2. Agencies that regulate asbestos include; the Federal EPA and OSHA and the Massachusetts DEP and DLS. | T | F |
| 3. Asbestos exposure and smoking increases a person's risk for developing lung cancer. | T | F |
| 4. As long as you don't smoke, your body's defense mechanisms will always protect you from asbestos exposure. | T | F |
| 5. A paper dust mask is sufficient to protect you from asbestos fibers inhalation. | T | F |
| 6. The three classes of ACMs are <u>surfacing material</u> , <u>flooring materials</u> and <u>thermal system insulation</u> . | T | F |
| 7. Asbestos is used in building materials due to its excellent insulating properties, chemical resistance, tensile strength and easy manufacturing production properties. | T | F |
| 8. Products containing asbestos can still be commercially purchased in the USA. | T | F |
| 9. The condition and friability of an ACM will determine its potential exposure hazard rating. | T | F |
| 10. An Asbestos Management Plan is only concerned with exposed asbestos pipe insulation and surfacing material in public areas. | T | F |
| 11. Anyone can legally remove asbestos in quantities less than 3 square or linear feet. | T | F |
| 12. Amosite and crocidolite are the most commonly found asbestos types, while chrysotile is rare. | T | F |
| 13. Building owners/managers are required to post labels and warning signs only in the main boiler room of a building. | T | F |
| 14. The health effects of asbestos are acute and can be reversed over time. | T | F |
| 15. In general, buildings constructed from 1945 to 1972 will contain the most ACMs. | T | F |



Paul Matuszko
Environmental Consulting

**Two-Hour
ASBESTOS AWARENESS TRAINING
Review Quiz**

Name: MATTHEW T. CAREW Date: 4/25/14
(print)

Department: MAINTENANCE / GROUNDS Title/Job: HEAD GROUNDS KEEPER

Circle True (T) or False (F) which best answers each question:

- | | True | False |
|---|------------------------------------|------------------------------------|
| 1. Asbestos-containing material (ACM) is defined as a material containing any percentage of asbestos. | T | <input checked="" type="radio"/> F |
| 2. Agencies that regulate asbestos include; the Federal EPA and OSHA and the Massachusetts DEP and DLS. | <input checked="" type="radio"/> T | F |
| 3. Asbestos exposure and smoking increases a person's risk for developing lung cancer. | <input checked="" type="radio"/> T | F |
| 4. As long as you don't smoke, your body's defense mechanisms will always protect you from asbestos exposure. | T | <input checked="" type="radio"/> F |
| 5. A paper dust mask is sufficient to protect you from asbestos fibers inhalation. | T | <input checked="" type="radio"/> F |
| 6. The three classes of ACMs are <u>surfacing material</u> , <u>flooring materials</u> and <u>thermal system insulation</u> . | <input checked="" type="radio"/> T | <input checked="" type="radio"/> F |
| 7. Asbestos is used in building materials due to its excellent insulating properties, chemical resistance, tensile strength and easy manufacturing production properties. | <input checked="" type="radio"/> T | F |
| 8. Products containing asbestos can still be commercially purchased in the USA. | <input checked="" type="radio"/> T | F |
| 9. The condition and friability of an ACM will determine its potential exposure hazard rating. | <input checked="" type="radio"/> T | F |
| 10. An Asbestos Management Plan is only concerned with exposed asbestos pipe insulation and surfacing material in public areas. | T | <input checked="" type="radio"/> F |
| 11. Anyone can legally remove asbestos in quantities less than 3 square or linear feet. | T | <input checked="" type="radio"/> F |
| 12. Amosite and crocidolite are the most commonly found asbestos types, while chrysotile is rare. | <input checked="" type="radio"/> T | <input checked="" type="radio"/> F |
| 13. Building owners/managers are required to post labels and warning signs only in the main boiler room of a building. | <input checked="" type="radio"/> T | F |
| 14. The health effects of asbestos are acute and can be reversed over time. | T | <input checked="" type="radio"/> F |
| 15. In general, buildings constructed from 1945 to 1972 will contain the most ACMs. | <input checked="" type="radio"/> T | F |



Paul Matuszko
Environmental Consulting

**Two-Hour
ASBESTOS AWARENESS TRAINING
Review Quiz**

Name: Kevin Leadbetter (print) Date: 4-25-14

Department: Maintenance Title/Job: _____

Circle True (T) or False (F) which best answers each question:

- | | True | False |
|---|----------------------------------|----------------------------------|
| 1. Asbestos-containing material (ACM) is defined as a material containing any percentage of asbestos. | T | <input checked="" type="radio"/> |
| 2. Agencies that regulate asbestos include; the Federal EPA and OSHA and the Massachusetts DEP and DLS. | <input checked="" type="radio"/> | F |
| 3. Asbestos exposure and smoking increases a person's risk for developing lung cancer. | <input checked="" type="radio"/> | F |
| 4. As long as you don't smoke, your body's defense mechanisms will always protect you from asbestos exposure. | T | <input checked="" type="radio"/> |
| 5. A paper dust mask is sufficient to protect you from asbestos fibers inhalation. | T | <input checked="" type="radio"/> |
| 6. The three classes of ACMs are <u>surfacing material</u> , <u>flooring materials</u> and <u>thermal system insulation</u> . | T | <input checked="" type="radio"/> |
| 7. Asbestos is used in building materials due to its excellent insulating properties, chemical resistance, tensile strength and easy manufacturing production properties. | <input checked="" type="radio"/> | F |
| 8. Products containing asbestos can still be commercially purchased in the USA. | <input checked="" type="radio"/> | F |
| 9. The condition and friability of an ACM will determine its potential exposure hazard rating. | <input checked="" type="radio"/> | F |
| 10. An Asbestos Management Plan is only concerned with exposed asbestos pipe insulation and surfacing material in public areas. | T | <input checked="" type="radio"/> |
| 11. Anyone can legally remove asbestos in quantities less than 3 square or linear feet. | T | <input checked="" type="radio"/> |
| 12. Amosite and crocidolite are the most commonly found asbestos types, while chrysotile is rare. | T | <input checked="" type="radio"/> |
| 13. Building owners/managers are required to post labels and warning signs only in the main boiler room of a building. | T | <input checked="" type="radio"/> |
| 14. The health effects of asbestos are acute and can be reversed over time. | T | <input checked="" type="radio"/> |
| 15. In general, buildings constructed from 1945 to 1972 will contain the most ACMs. | <input checked="" type="radio"/> | F |