

TECHNICAL INSTRUCTIONS

FOR

Safety (Non Compliance) Recall 21TA02

NHTSA Recall No. 21V-554

**PASSENGER SEATBELT AUTOMATIC LOCKING RETRATOR FUNCTION –
MAY NOT ACTIVATE**

CERTAIN 2021 SUPRA VEHICLES

The repair quality of covered vehicles is extremely important to Toyota. All dealership technicians performing this repair are required to successfully complete the most current version of the E-Learning course “Safety Recall and Service Campaign Essentials”. To ensure that all vehicles have the repair performed correctly; technicians performing this recall repair are required to currently have completed all of the following courses:

- **TIN519B – GR Supra New Model Technical Introduction**

It is the dealership’s responsibility to select technicians with the above certification level or greater to perform this recall repair. Carefully review your resources, the technician skill level, and ability before assigning technicians to this repair. It is important to consider technician days off and vacation schedules to ensure there are properly trained technicians available to perform this repair at all times.

I. OPERATION FLOW CHART

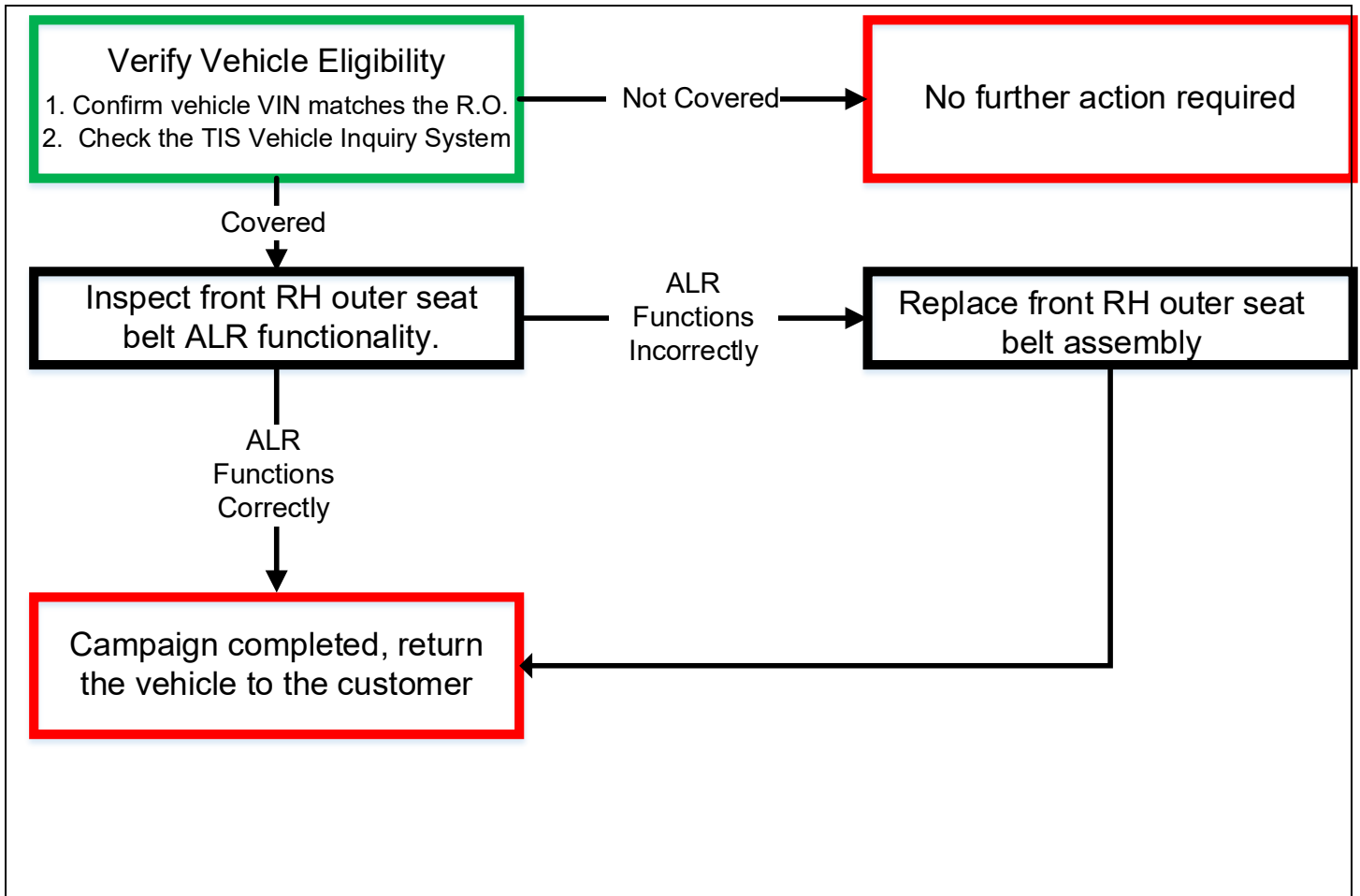

II. IDENTIFICATION OF AFFECTED VEHICLES

1. CHECK VEHICLE FOR CAMPAIGN ELIGIBILITY

- Compare the vehicle's VIN to the VIN listed on the Repair Order to ensure they match.
- Check the TIS Vehicle Inquiry System to confirm the VIN is involved in this Campaign, and that it has not already been completed.

Note: TMNA warranty will not reimburse dealers for repairs completed on vehicles that are not affected or were previously completed, even by another dealer.

III. BACKGROUND

According to BMW and Autoliv (the part supplier), the Automatic Locking Retractor (ALR) function in the passenger seat belt in the subject vehicles may prematurely cease activation when attempting to install and secure a Child Restraint System (CRS) by a vehicle user. In this condition, the passenger side seat belt may not meet certain U.S. safety requirements.

IV. PREPARATION

1. PARTS

***Note: Parts are ONLY REQUIRED if the inspection process determines that the Front RH Outer Seat Belt Assembly needs to be replaced. The inspection process does not require any parts.**

2. TOOLS & EQUIPMENT

***Note: Tools and equipment are NOT required for inspection. All tools and equipment listed are required for outer seat belt assembly replacement, if necessary.**

- Standard Hand Tools
- Torque Wrench
- “Torx” Socket Wrench T-Type T50
- Protective Gloves
- TOYOTA-ISTA
- DCA Battery Charger
- Molding Remover A
- Protective Tape
- ISTA Cable
- “Torx” Socket Wrench T-Type T20
- Molding Remover B

V. RH OUTER SEAT BELT - ALR FUNCTION - INSPECTION

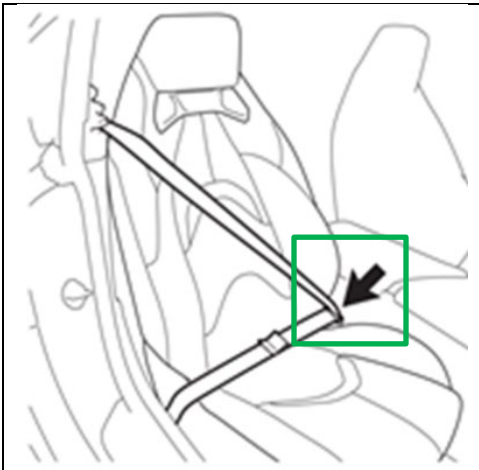

1. RH Outer Seat Belt ALR Function Inspection - Process
 - a. Fasten RH outer seat belt to RH inner seat belt using buckle assembly.

Note: Ensure there is no seat belt extender on the seat belt when performing inspection.



Ensure RH seat is in the most rearward position.



- b. Fully extend RH outer seat belt assembly to enable ALR function.



Remove Seatbelt webbing slowly. If seatbelt webbing is pulled to quickly, ELR may activate and the inspection process will need to be restarted.

NOTE: Once the RH outer seat belt has been fully extended, it will not be possible to pull the belt out any further.



- c. With the seatbelt buckled, slowly allow RH outer seat belt webbing to fully retract.

NOTE: If ALR has been correctly enabled, an audible clicking noise will be heard as the seat belt is being retracted.

- d. Confirm ALR locks by slowly pulling seatbelt out.



Do NOT pull seatbelt webbing quickly, ELR function will activate.

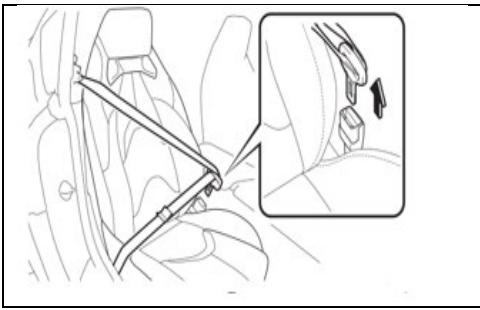

e. Un-buckle seatbelt and allow seatbelt to full retract.

RH Outer Seat Belt – ALR Inspection Video



The inspection **MUST** be performed **6** times total.

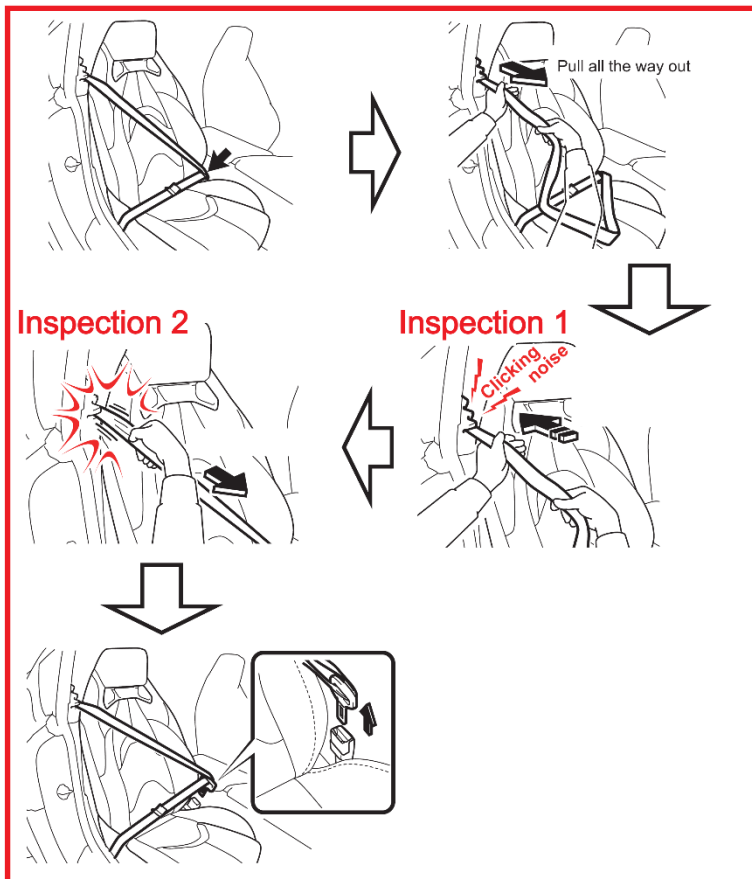

Perform inspection additionally

× **5**
SETS
(perform 6 sets in total)

R210810001F

f. Repeat Steps 1a-1e a total of 5 additional times, or 6 times total.

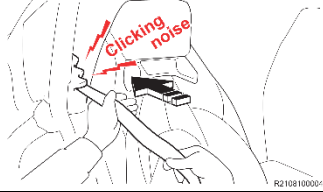
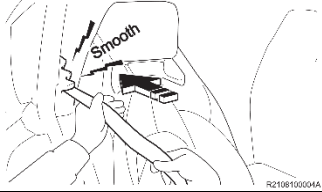
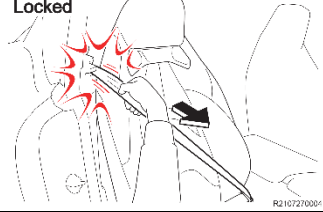
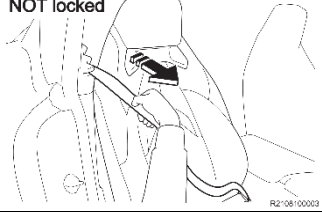
Inspection Step	Ok Functioning ALR	Incorrectly Functioning ALR
ALR Clicking Noise	<p>Clicking noise heard</p> 	<p>NO clicking noise</p> 
Seat Belt Locking Function	<p>Locked</p> 	<p>NOT locked</p> 

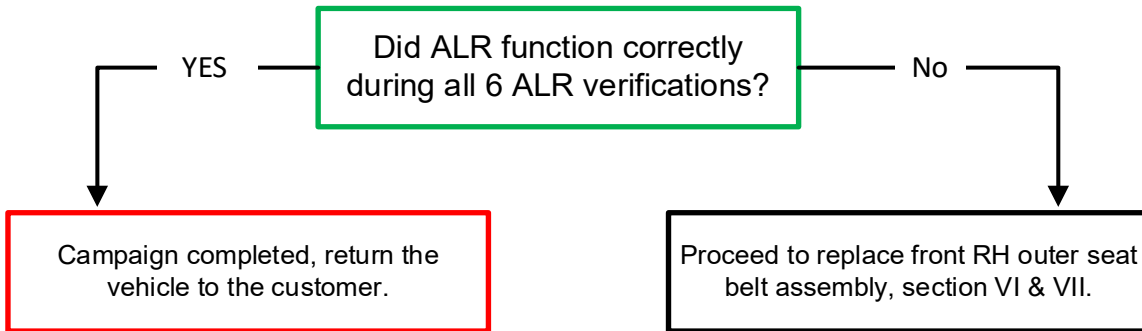

◀ VERIFY REPAIR QUALITY ▶

Confirm that inspection process steps 1a-1e were completed a total of 6 times and ALR functioned correctly each time.

VI. COMPONENTS

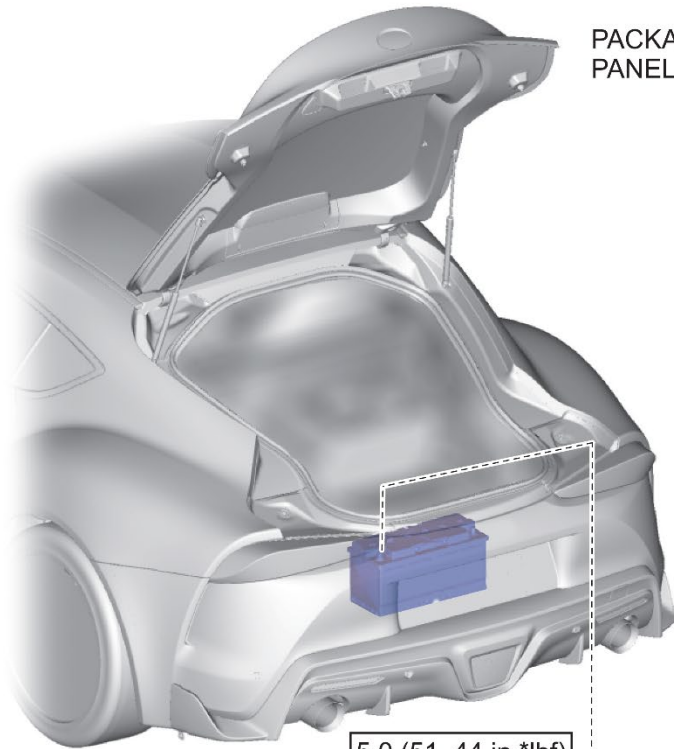

PACKAGE TRAY TRIM
PANEL ASSEMBLY

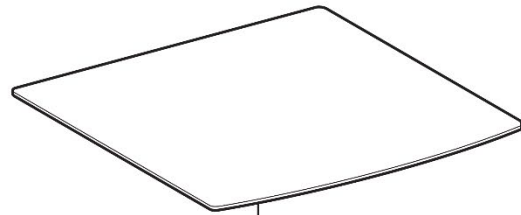
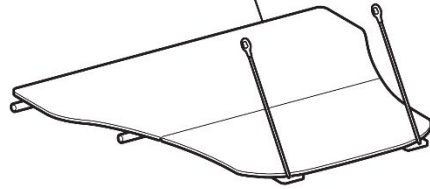

DECK BOARD ASSEMBLY

5.0 (51, 44 in.*lbf)

NO .3 EARTH WIRE

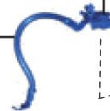

N*m (kgf*cm, ft.*lbf) : Specified torque

R2102100026A

for B46 BATTERY:

COWL VENT COVER RH



19 (194, 14)

No.2 EARTH WIRE

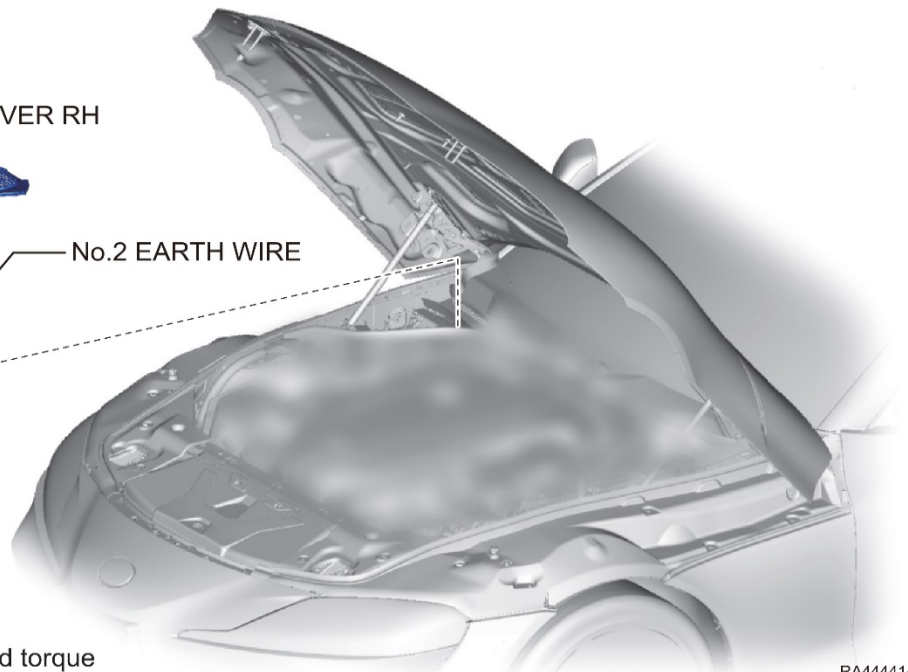

N*m (kgf*cm, ft.*lbf) : Specified torque

RA444414

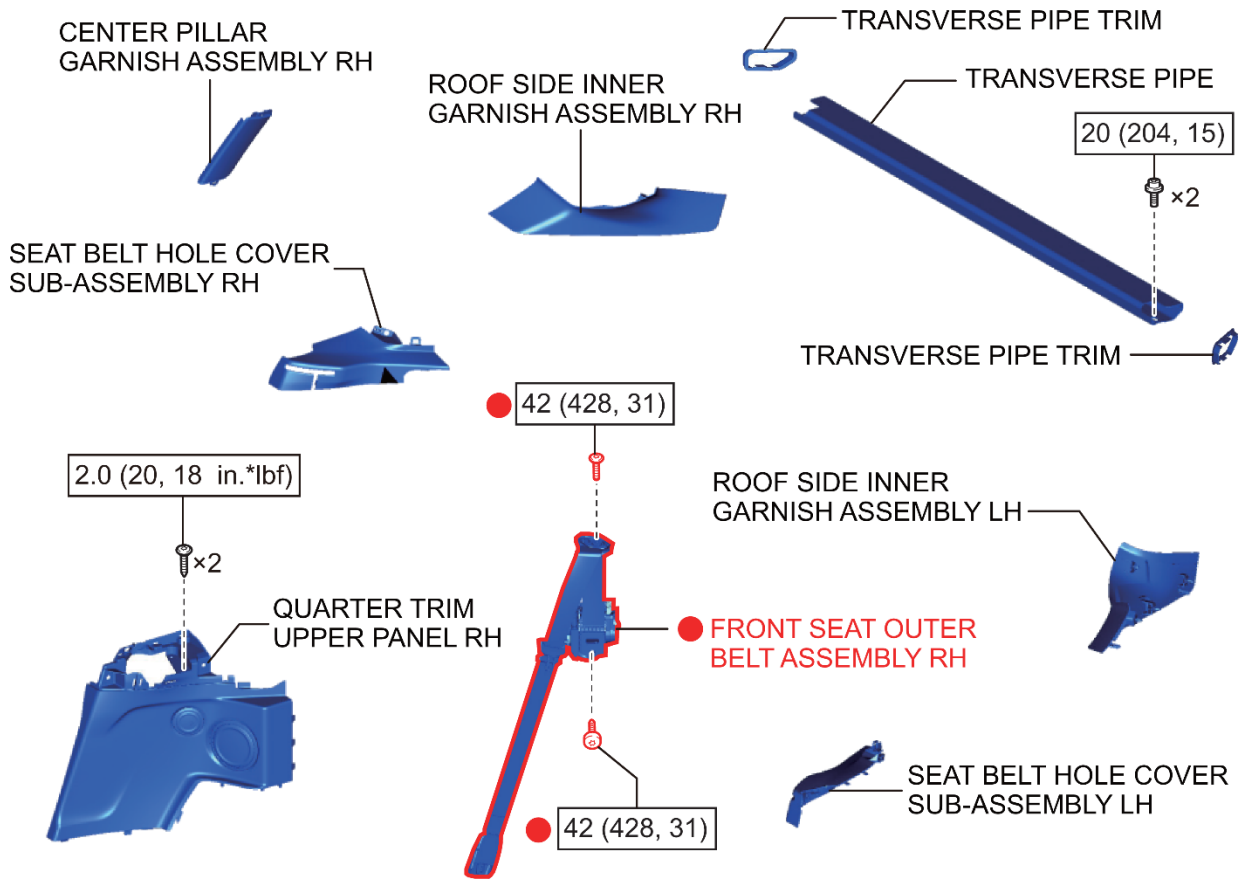

DO NOT REMOVE THE FOLLOWING COMPONENTS

w/ Courtesy Light:

 ROPE HOOK
 x2
 x2

DECK TRIM SIDE BOARD AND DECK SIDE TRIM COVER RH



DECK TRIM REAR COVER

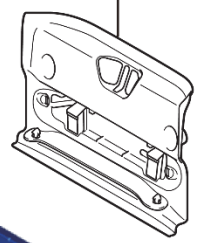

for 10 Speakers:

 REAR No.2 SPEAKER ASSEMBLY

for 12 Speakers:

 REAR No.3 SPEAKER ASSEMBLY

No.1 LUGGAGE COMPARTMENT LIGHT ASSEMBLY

TRIANGLE REFLECTOR SET

● : Replacement part
 N*m (kgf*cm, ft.*lbf) : Specified torque

R2107270007

VII. RH OUTER SEAT BELT ASSEMBLY – REPLACEMENT



Prior to replacing the RH Outer Seat Belt Assembly, a video showing the incorrectly functioning ALR feature **MUST** be emailed to quality_compliance@toyota.com.

**** You will receive an email response with directions after the video is viewed. Video submission with replacement direction will be REQUIRED for warranty submission and part release. ****



- **DO NOT touch the area around the retractor, even when a front seat outer belt assembly or rear seat outer belt assembly is temporarily removed during service.** If the pretensioner unexpectedly deploys and the front seat outer belt assembly or rear seat outer belt assembly is retracted during an operation, it could cause a serious accident.
- **When storing a pretensioner, DO NOT place objects on top of it or place it in a pile.**

Do NOT touch the area around the retractor.

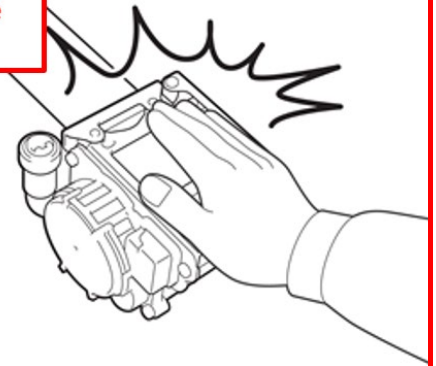

The following steps of the TIS repair manual process need to be skipped. The parts are illustrated in VI. COMPONENTS.

- **NO. 1 LUGGAGE COMPARTMENT LIGHT ASSEMBLY (w/ Front Center Speaker)**
- **TRIANGLE REFLECTOR SET (w/ Front Center Speaker)**
- **DECK TRIM REAR COVER (w/ Front Center Speaker)**
- **ROPE HOOK (w/ Front Center Speaker)**
- **DECK TRIM SIDE BOARD AND DECK SIDE TRIM COVER RH (w/ Front Center Speaker)**
- **REAR NO. 3 SPEAKER ASSEMBLY (w/ Front Center Speaker)**
- **REAR NO. 2 SPEAKER ASSEMBLY (w/ Front Center Speaker)**

- 1. RECORD THE SETTINGS OF THE AUDIO, AIR CONDITIONING AND COMBINATION METER.**
 - a) For devices such as the audio system, air conditioner, record current settings before the negative (-) battery terminal is disconnected.
- 2. RECORD THE POSITIONS OF THE FRONT SEATS**
 - a) Record the positions of the front seats.
 - b) Slide the front seats to the frontmost position.
- 3. CHECK FOR DTCs**
- 4. REMOVE THE FRONT SEAT OUTER BELT ASSEMBLY RH**
FRONT SEAT OUTER BELT ASSEMBLY / REMOVAL

Wear protective gloves

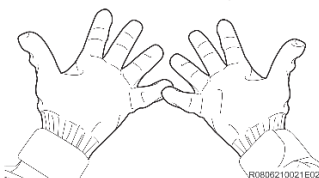

NOTE:

For vehicles with front center speaker, follow the steps a), b) and c) below to remove the front seat outer belt assembly RH in order to avoid interference with surrounding components.

- a) Wear protective gloves.

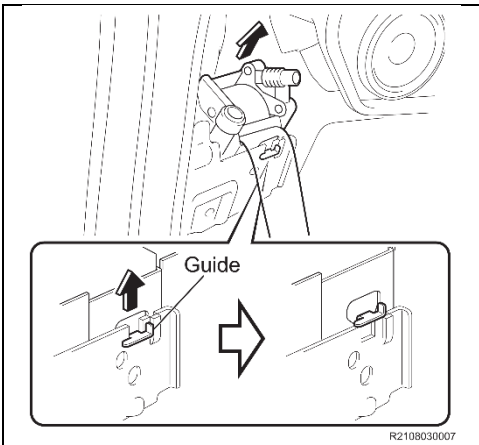

b. Raise the front seat outer belt assembly until the guide is disengaged.

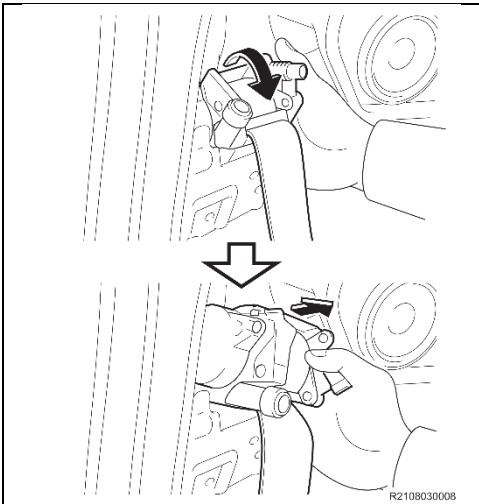

c. Turn the front seat outer belt assembly as shown in the illustration and then remove.

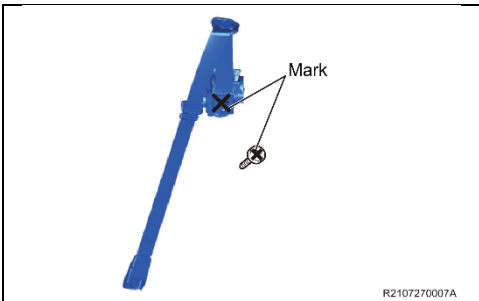

d. Mark and store the removed bolt and seat outer belt assembly in a separate container.

5. INSTALL THE **NEW** FRONT SEAT OUTER BELT ASSEMBLY RH FRONT SEAT OUTER BELT ASSEMBLY / INSTALLATION



a) Wear protective gloves.

6. RETURN THE POSITIONS OF THE SEAT
7. RESTORE AUDIO, AIR CONDITIONING AND COMBINATIONMETER SETTINGS
8. CHECK FOR DTCs

◀ VERIFY REPAIR QUALITY ▶

- Confirm all Seatbelt mounting bolts were torqued to specification.
- Confirm No DTCs are present.
- Confirm No air bag warning lights are present.

VIII. APPENDIX

A. CAMPAIGN DESIGNATION/PHASE DECODER

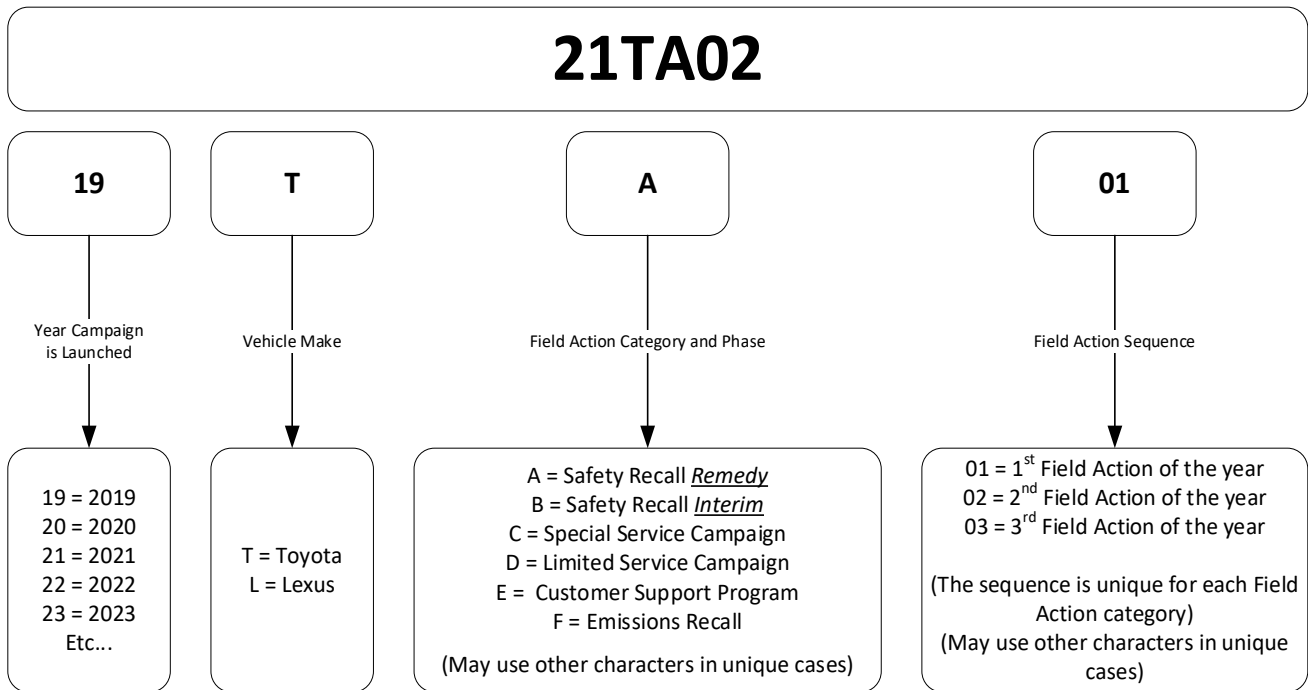

Examples:

19TA01 = Launched in 2019, Toyota, Safety Recall Remedy Phase, 1st Safety Recall Launched in 2019
 20TC02 = Launched in 2020, Special Service Campaign, 2nd Special Service Campaign Launched in 2020
 21TE05 = Launched in 2021, Customer Support Program, 5th Customer Support Program Launched in 2021

B. RECALL PARTS DISPOSAL

As required by Federal Regulations, please make sure all recalled parts (original parts) removed from the vehicle are disposed of in a manner in which they will not be reused, **unless requested for parts recovery return.**