

# Technical Support Manual

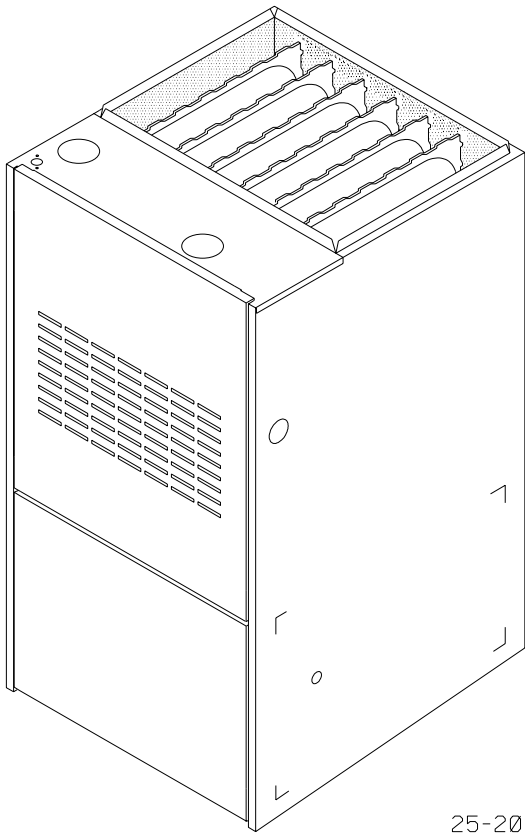

25-20-66

## Models

NTGM050EFA3  
NTGM075EGA3  
NTGM100EHA3  
NTGM125EKA3

GNK050N12A3  
GNK075N14A3  
GNK100N16A3  
GNK125N20A3

Manufactured by:  
*International Comfort Products Corporation (USA)*  
Lewisburg, TN USA 37091

# Condensing Gas Furnaces

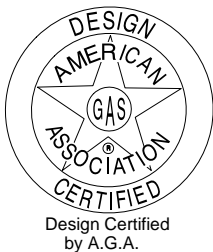

**Save This Manual For Future Reference**

THIS DATA IS SUBJECT TO CHANGE WITHOUT NOTICE

Manufacturers Number (Mfr No -See Rating Plate)				NTGM050EF/GNK050N12A																																																																																			
Specifications				Circulation Air Blower Data																																																																																			
GENERAL	Gas Type	Nat	LP	Type & Size	10-8	Filter Type	Washable																																																																																
	Input (Btuh) Std/Alt.	50,000	50,000		Motor Amps/RPM	4.6/1050	Filter Size (")	16x25x1																																																																															
	Output (Btuh) Std/Alt.	45,500	45,500		Motor Type/ H.P.	PSC/1/3	Min. Cool																																																																																
	Temp. Rise (°F)	40-70	40-70	Cap. MFD/Volts	5/370	Cap. (Tons)	1.5																																																																																
	Electrical (Volts/Hz/FLA)	115/60/5.3	115/60/5.3			Max. Cool																																																																																	
	Transformer Size (VA)	40	40			Cap. (Tons)	3																																																																																
	T'stat Heat Anticipator	.30	.30	<b>Air Delivery in Cubic Feet per Minute (C.F.M.)</b> (Furnace Rated @0.5" WC ESP) <table border="1"> <thead> <tr> <th>TAP</th> <th>LOW</th> <th>MED L</th> <th>MED H</th> <th>HIGH</th> </tr> </thead> <tbody> <tr><td>.10</td><td>718</td><td>840</td><td>1109</td><td>1473</td></tr> <tr><td>.20</td><td>719</td><td>838</td><td>1094</td><td>1431</td></tr> <tr><td>.30</td><td>714</td><td>837</td><td>1086</td><td>1396</td></tr> <tr><td>.40</td><td>692</td><td>819</td><td>1063</td><td>1349</td></tr> <tr><td>.50</td><td>660</td><td>791</td><td>1027</td><td>1291</td></tr> <tr><td>.60</td><td>615</td><td>752</td><td>986</td><td>1222</td></tr> <tr><td>.70</td><td>563</td><td>683</td><td>934</td><td>1141</td></tr> </tbody> </table> <b>Air Delivery in Liters Per Second (L/S)</b> (Furnace Rated @0.5" WC ESP) <table border="1"> <thead> <tr> <th>TAP</th> <th>LOW</th> <th>MED L</th> <th>MED H</th> <th>HIGH</th> </tr> </thead> <tbody> <tr><td>.10</td><td>339</td><td>396</td><td>523</td><td>695</td></tr> <tr><td>.20</td><td>339</td><td>395</td><td>516</td><td>675</td></tr> <tr><td>.30</td><td>337</td><td>395</td><td>513</td><td>659</td></tr> <tr><td>.40</td><td>327</td><td>387</td><td>502</td><td>637</td></tr> <tr><td>.50</td><td>311</td><td>373</td><td>485</td><td>609</td></tr> <tr><td>.60</td><td>290</td><td>355</td><td>465</td><td>577</td></tr> <tr><td>.70</td><td>266</td><td>322</td><td>441</td><td>538</td></tr> </tbody> </table>				TAP	LOW	MED L	MED H	HIGH	.10	718	840	1109	1473	.20	719	838	1094	1431	.30	714	837	1086	1396	.40	692	819	1063	1349	.50	660	791	1027	1291	.60	615	752	986	1222	.70	563	683	934	1141	TAP	LOW	MED L	MED H	HIGH	.10	339	396	523	695	.20	339	395	516	675	.30	337	395	513	659	.40	327	387	502	637	.50	311	373	485	609	.60	290	355	465	577	.70	266	322	441	538
TAP	LOW	MED L	MED H					HIGH																																																																															
.10	718	840	1109					1473																																																																															
.20	719	838	1094					1431																																																																															
.30	714	837	1086					1396																																																																															
.40	692	819	1063					1349																																																																															
.50	660	791	1027					1291																																																																															
.60	615	752	986					1222																																																																															
.70	563	683	934					1141																																																																															
TAP	LOW	MED L	MED H					HIGH																																																																															
.10	339	396	523	695																																																																																			
.20	339	395	516	675																																																																																			
.30	337	395	513	659																																																																																			
.40	327	387	502	637																																																																																			
.50	311	373	485	609																																																																																			
.60	290	355	465	577																																																																																			
.70	266	322	441	538																																																																																			
GAS & IGNITION	Gas Valve	HW SV9500	HW SV9500	External Static Pressure Inches of W.C.																																																																																			
	Regulation Type	SNAP	SNAP																																																																																				
	Manifold Press. (Inch's WC)	3.5	10.0																																																																																				
	Std. Main Orifices (No/Size)	2/#42	2/#54																																																																																				
	Pilot Orifice Size	.018	.011																																																																																				
	Ignition Type/Series	HW HSP	HW HSP																																																																																				
	Lock-Out Time	---	---																																																																																				
COMBUSTION	Flue Outlet Size (Inches)	2	2																																																																																				
	Std. Outlet Temp (°F)	<140	<140																																																																																				
	Comb. Blower (MFD/Volts)	4/250	4/250																																																																																				
	Std. Pressures (Inch's of WC)	@Blower	@Burner Box	Differential																																																																																			
	5' No Elbows	-2.30	-.10	-2.4																																																																																			
	40' +5-90° DWV Elbows	-2.20	-.20	-2.0																																																																																			
LIMITS & CONTROLS	Rollout Switch	250	250																																																																																				
	Limit Control Setting (°F)	160	160																																																																																				
	Auxiliary Limit (°F)	130	130																																																																																				
	Fan Control (Type)	HW ST9120	HW ST9120																																																																																				
	Fan Control	On	60	60																																																																																			
	(Timed-Secs)	Off	60,90,120,150	60,90,120,150																																																																																			
	Std. Pressure Sw. (Part No)	1010895	1010895																																																																																				
	Press Differential (Close)	1.62	1.62																																																																																				
	Press Differential (Open)	1.38	1.38																																																																																				
	High Alt. Press. Sw (Part No)	1008817	1008817																																																																																				
Press Differential (Close)	1.40	1.40																																																																																					
Press Differential (Open)	1.18	1.18																																																																																					

THIS DATA IS SUBJECT TO CHANGE WITHOUT NOTICE

Manufacturers Number (Mfr No -See Rating Plate)				NTGM075EG/GNK075N14A																																																																																			
Specifications				Circulation Air Blower Data																																																																																			
GENERAL	Gas Type	Nat	LP	Type & Size	10-8	Filter Type	Washable																																																																																
	Input (Btuh) Std/Alt.	75,000	75,000		Motor Amps/RPM	6.8/1050	Filter Size (")	16x25x1																																																																															
	Output (Btuh) Std/Alt.	67,500	67,500		Motor Type/ H.P.	PSC/1/2	Min. Cool																																																																																
	Temp. Rise (°F)	40-70	40-70	Cap. MFD/Volts	7.5/370	Cap. (Tons)	2																																																																																
	Electrical (Volts/Hz/FLA)	115/60/7.5	115/60/7.5			Max. Cool																																																																																	
	Transformer Size (VA)	40	40			Cap. (Tons)	3.5																																																																																
	T'stat Heat Anticipator	.30	.30	<b>Air Delivery in Cubic Feet per Minute (C.F.M.)</b> (Furnace Rated @0.5" WC ESP) <table border="1"> <thead> <tr> <th>TAP</th> <th>LOW</th> <th>MED L</th> <th>MED H</th> <th>HIGH</th> </tr> </thead> <tbody> <tr><td>.10</td><td>778</td><td>984</td><td>1263</td><td>1576</td></tr> <tr><td>.20</td><td>786</td><td>1003</td><td>1249</td><td>1532</td></tr> <tr><td>.30</td><td>790</td><td>1003</td><td>1244</td><td>1489</td></tr> <tr><td>.40</td><td>788</td><td>1001</td><td>1215</td><td>1432</td></tr> <tr><td>.50</td><td>781</td><td>982</td><td>1186</td><td>1371</td></tr> <tr><td>.60</td><td>765</td><td>962</td><td>1146</td><td>1308</td></tr> <tr><td>.70</td><td>743</td><td>923</td><td>1094</td><td>1229</td></tr> </tbody> </table> <b>Air Delivery in Liters Per Second (L/S)</b> (Furnace Rated @0.5" WC ESP) <table border="1"> <thead> <tr> <th>TAP</th> <th>LOW</th> <th>MED L</th> <th>MED H</th> <th>HIGH</th> </tr> </thead> <tbody> <tr><td>.10</td><td>367</td><td>464</td><td>596</td><td>744</td></tr> <tr><td>.20</td><td>371</td><td>473</td><td>589</td><td>723</td></tr> <tr><td>.30</td><td>373</td><td>473</td><td>587</td><td>703</td></tr> <tr><td>.40</td><td>372</td><td>472</td><td>573</td><td>676</td></tr> <tr><td>.50</td><td>369</td><td>463</td><td>560</td><td>647</td></tr> <tr><td>.60</td><td>361</td><td>454</td><td>541</td><td>617</td></tr> <tr><td>.70</td><td>351</td><td>436</td><td>516</td><td>580</td></tr> </tbody> </table>				TAP	LOW	MED L	MED H	HIGH	.10	778	984	1263	1576	.20	786	1003	1249	1532	.30	790	1003	1244	1489	.40	788	1001	1215	1432	.50	781	982	1186	1371	.60	765	962	1146	1308	.70	743	923	1094	1229	TAP	LOW	MED L	MED H	HIGH	.10	367	464	596	744	.20	371	473	589	723	.30	373	473	587	703	.40	372	472	573	676	.50	369	463	560	647	.60	361	454	541	617	.70	351	436	516	580
TAP	LOW	MED L	MED H					HIGH																																																																															
.10	778	984	1263					1576																																																																															
.20	786	1003	1249					1532																																																																															
.30	790	1003	1244					1489																																																																															
.40	788	1001	1215					1432																																																																															
.50	781	982	1186					1371																																																																															
.60	765	962	1146					1308																																																																															
.70	743	923	1094					1229																																																																															
TAP	LOW	MED L	MED H					HIGH																																																																															
.10	367	464	596	744																																																																																			
.20	371	473	589	723																																																																																			
.30	373	473	587	703																																																																																			
.40	372	472	573	676																																																																																			
.50	369	463	560	647																																																																																			
.60	361	454	541	617																																																																																			
.70	351	436	516	580																																																																																			
GAS & IGNITION	Gas Valve	HW SV9500	HW SV9500	External Static Pressure Inches of W.C.																																																																																			
	Regulation Type	SNAP	SNAP																																																																																				
	Manifold Press. (Inch's WC)	3.5	10.0																																																																																				
	Std. Main Orifices (No/Size)	3/#42	3/#54																																																																																				
	Pilot Orifice Size	.018	.011																																																																																				
	Ignition Type/Series	HW HSP	HW HSP																																																																																				
	Lock-Out Time	---	---																																																																																				
COMBUSTION	Flue Outlet Size (Inches)	2,2 <sup>1</sup> / <sub>2</sub> ,3	2,2 <sup>1</sup> / <sub>2</sub> ,3																																																																																				
	Std. Outlet Temp (°F)	<140	<140																																																																																				
	Comb. Blower (MFD/Volts)	4/250	4/250																																																																																				
	Std. Pressures (Inch's of WC)	@Blower	@Burner Box	Differential																																																																																			
	5' No Elbows	-2.30	-.10	-2.2																																																																																			
	40' +5-90° DWV Elbows	-2.05	-.15	-1.9																																																																																			
LIMITS & CONTROLS	Rollout Switch	200	200																																																																																				
	Limit Control Setting (°F)	190	190																																																																																				
	Auxiliary Limit (°F)	130	130																																																																																				
	Fan Control (Type)	HW ST9120	HW ST9120																																																																																				
	Fan Control	On	60	60																																																																																			
	(Timed-Secs)	Off	60,90,120,150	60,90,120,150																																																																																			
	Std. Pressure Sw. (Part No)	1010895	1010895																																																																																				
	Press Differential (Close)	1.62	1.62																																																																																				
	Press Differential (Open)	1.38	1.38																																																																																				
	High Alt. Press. Sw (Part No)	1008817	1008817																																																																																				
Press Differential (Close)	1.40	1.40																																																																																					
Press Differential (Open)	1.18	1.18																																																																																					

THIS DATA IS SUBJECT TO CHANGE WITHOUT NOTICE

Manufacturers Number (Mfr No -See Rating Plate)				NTGM100EH/GNK100N16A						
Specifications				Circulation Air Blower Data						
GENERAL	Gas Type	Nat	LP	Type & Size	10-10	Filt Type	Washable			
	Input (Btuh) Std/Alt.	100,000	100,000		Motor Amps/RPM			8.5/1050	Filt Size (")	16x25x1
	Output (Btuh) Std/Alt.	90,000	90,000		Motor Type/ H.P.			PSC/1/2	Min. Cool	
	Temp. Rise (°F)	40-70	40-70	Cap. MFD/Volts	10/370	Cap. (Tons)	2			
	Electrical (Volts/Hz/FLA)	115/60/9.2	115/60/9.2			Max. Cool				
	Transformer Size (VA)	40	40			Cap. (Tons)	4			
	T'stat Heat Anticipator	.30	.30	<b>Air Delivery in Cubic Feet per Minute (C.F.M.)</b>						
GAS & IGNITION	Gas Valve	HW SV9500	HW SV9500	(Furnace Rated @0.5" WC ESP)						
	Regulation Type	SNAP	SNAP	External Static Pressure Inches of W.C.	TAP	LOW	MED L	MED H	HIGH	
	Manifold Press. (Inch's WC)	3.5	10.0		.10	954	1312	1698	1925	
	Std. Main Orifices (No/Size)	4/#42	4/#54		.20	950	1292	1645	1853	
Pilot Orifice Size	.018	.011	.30		946	1265	1596	1780		
Ignition Type/Series	HW HSP	HW HSP	.40		915	1231	1530	1708		
	Lock-Out Time	---	---	.50	878	1175	1455	1638		
COMBUSTION	Flue Outlet Size (Inches)	2,2 <sup>1</sup> / <sub>2</sub> ,3	2,2 <sup>1</sup> / <sub>2</sub> ,3	.60	830	1118	1362	1546		
	Std. Outlet Temp (°F)	<140	<140	.70	778	1020	1241	1435		
	Comb. Blower (MFD/Volts)	4/250	4/250	<b>Air Delivery in Liters Per Second (L/S)</b>						
	Std. Pressures (Inch's of WC)	@Blower	@Burner Box	(Furnace Rated @0.5" WC ESP)						
	5' No Elbows	-2.40	-.10	External Static Pressure Inches of W.C.	TAP	LOW	MED L	MED H	HIGH	
	40' +5-90° DWV Elbows	-1.98	-20		.10	450	619	801	908	
					.20	448	610	776	874	
					.30	446	597	753	840	
					.40	432	581	722	806	
LIMITS & CONTROLS	Rollout Switch	200	200	.50	414	555	687	773		
	Limit Control Setting (°F)	180	180	.60	392	528	643	730		
	Auxiliary Limit (°F)	130	130	.70	367	481	586	677		
	Fan Control (Type)	HW ST9120	HW ST9120							
	Fan Control On	60	60							
	(Timed-Secs) Off	60,90,120,150	60,90,120,150							
	Std. Pressure Sw. (Part No)	1010895	1010895							
	Press Differential (Close)	1.62	1.62							
Press Differential (Open)	1.38	1.38								
High Alt. Press. Sw (Part No)	1008817	1008817								
Press Differential (Close)	1.40	1.40								
Press Differential (Open)	1.18	1.18								

THIS DATA IS SUBJECT TO CHANGE WITHOUT NOTICE

Manufacturers Number (Mfr No -See Rating Plate)				NTGM125EK/GNK125N20A						
Specifications				Circulation Air Blower Data						
GENERAL	Gas Type	Nat	LP	Type & Size	11.8-10.6	Filt Type	Washable			
	Input (Btuh) Std/Alt.	125,000	125,000		Motor Amps/RPM			9.8/900	Filt Size (")	(2)16x25
	Output (Btuh) Std/Alt.	113,125	113,125		Motor Type/ H.P.			PSC/3/4	Min. Cool	
	Temp. Rise (°F)	45-75	45-75	Cap. MFD/Volts	10/370	Cap. (Tons)	3.5			
	Electrical (Volts/Hz/FLA)	115/60/10.5	115/60/12.0			Max. Cool				
	Transformer Size (VA)	40	40			Cap. (Tons)	5			
	T'stat Heat Anticipator	.30	.30	<b>Air Delivery in Cubic Feet per Minute (C.F.M.)</b>						
GAS & IGNITION	Gas Valve	HW SV9500	HW SV9500	(Furnace Rated @0.5" WC ESP)						
	Regulation Type	SNAP	SNAP	External Static Pressure Inches of W.C.	TAP	LOW	MED L	MED H	HIGH	
	Manifold Press. (Inch's WC)	3.5	10.0		.10	1463	1650	1879	2214	
	Std. Main Orifices (No/Size)	5/#42	5/#54		.20	1429	1635	1859	2154	
Pilot Orifice Size	.018	.011	.30		1417	1614	1838	2152		
Ignition Type/Series	HSP	HSP	.40		1389	1579	1806	2106		
	Lock-Out Time	---	---	.50	1364	1556	1773	2049		
COMBUSTION	Flue Outlet Size (Inches)	3	3	.60	1339	1513	1725	1981		
	Std. Outlet Temp (°F)	<140	<140	.70	1299	1470	1668	1903		
	Comb. Blower (MFD/Volts)	4/250	4/250	<b>Air Delivery in Liters Per Second (L/S)</b>						
	Std. Pressures (Inch's of WC)	@Blower	@Burner Box	(Furnace Rated @0.5" WC ESP)						
	5' No Elbows	-2.40	-.17	External Static Pressure Inches of W.C.	TAP	LOW	MED L	MED H	HIGH	
	40' +5-90° DWV Elbows	-2.16	-.20		.10	690	779	887	1045	
					.20	674	772	877	1017	
					.30	669	762	867	1016	
					.40	656	745	852	994	
LIMITS & CONTROLS	Rollout Switch	200	200	.50	644	734	837	967		
	Limit Control Setting (°F)	190	190	.60	632	714	814	935		
	Auxiliary Limit (°F)	130	130	.70	613	694	787	898		
	Fan Control (Type)	HW ST9120	HW ST9120							
	Fan Control On	60	60							
	(Timed-Secs) Off	60,90,120,150	60,90,120,150							
	Std. Pressure Sw. (Part No)	1010895	1010895							
	Press Differential (Close)	1.62	1.62							
Press Differential (Open)	1.38	1.38								
High Alt. Press. Sw (Part No)	1008817	1008817								
Press Differential (Close)	1.40	1.40								
Press Differential (Open)	1.18	1.18								



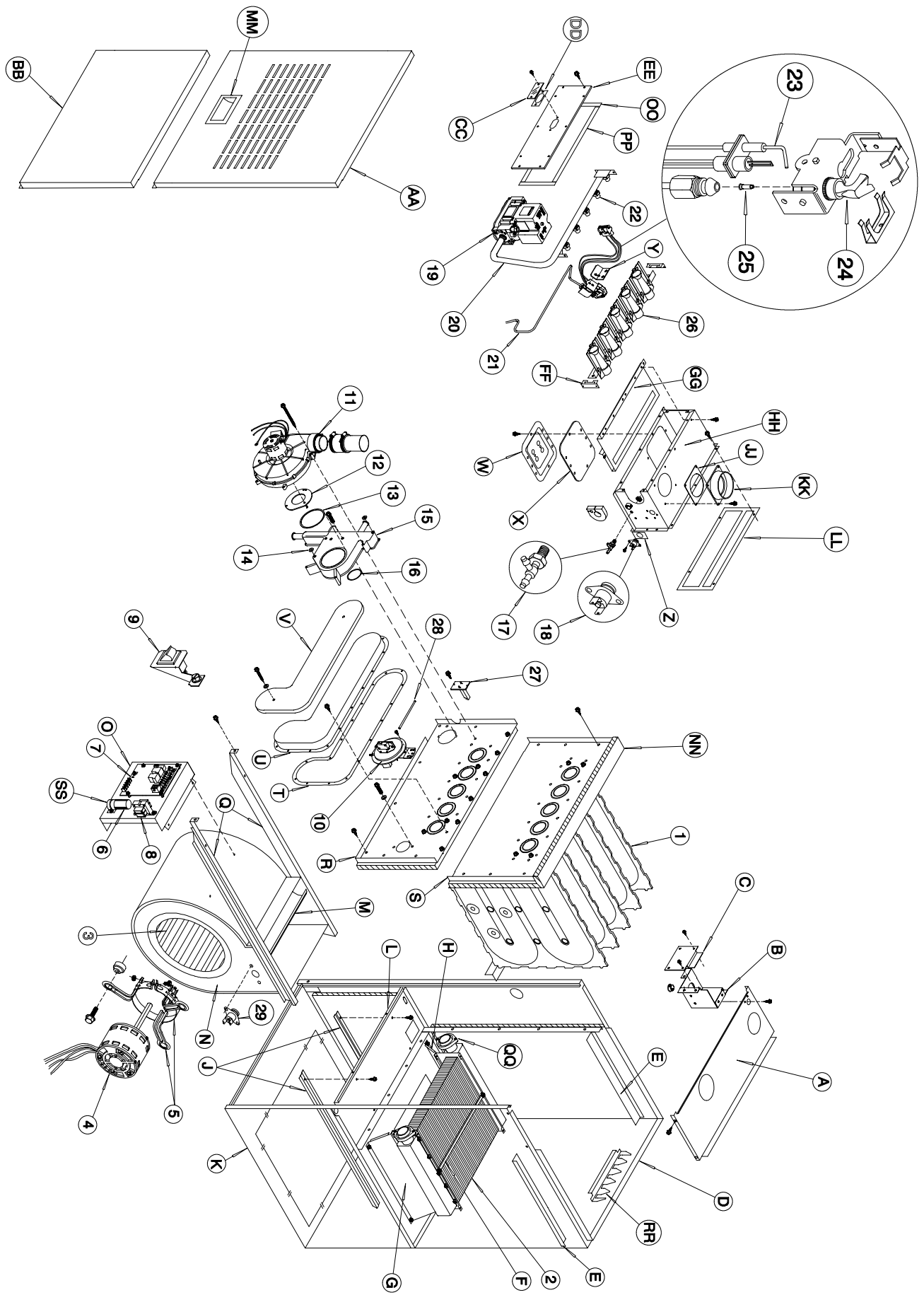

25-22-57

# Replacement Parts - NTGM/GNK

**Models** - NTGM050EFA3, NTGM075EGA3, NTGM100EHA3, NTGM125EKA3 (Natural Gas)  
 GNK050N12A3, GNK075N14A3, GNK100N16A3, GNK125N20A3 (Natural Gas)

**Replacement part supplied will be current active part. For parts not listed, consult place of purchase.**

Key No.	Description Functional	Part Number	050	075	100	125
1	Heat Exchanger	1008876	1	-	-	-
		1008877	-	1	-	-
		1008878	-	-	1	-
		1008879	-	-	-	1
2	Coil Condenser	1010495	1	1	-	-
		1010496	-	-	1	-
		1010497	-	-	-	1
3	Wheel Blower	600587	1	1	-	-
		601210	-	-	1	-
		1011420	-	-	-	1
4	Motor Blower	1009054	1	-	-	-
		1009053	-	1	-	-
		1009052	-	-	1	-
		1011404	-	-	-	1
5	Mount Motor Kit	609227	1	1	1	-
		522020024	-	-	-	1
6	Capacitor 5/370V 10/370V 7.5/370V	1094954	1	-	-	-
		1094956	-	-	1	1
		1094239	-	1	-	-
7	Control, Fan Timer	1009838	1	1	1	1
8	Transformer	1011626	1	1	1	1
9	Switch Door Interlock	1010886	1	1	1	1
10	Switch Pressure	1010895	1	1	1	1
11	Blower Exhaust	1011412	1	1	1	1
12	Restrictor Exh Blwr	1008696	1	1	-	-
		1009386	-	-	1	-
		1008699	-	-	-	1
13	O Ring (Exh Blwr)	1009035	1	1	1	1
14	Washer Exh Blwr	1009037	2	2	2	2
15	Transition Asy	1010537	1	1	1	1
16	O Ring (Header Box)	1009036	1	1	1	1
17	Pressure Tap	1005606	1	1	1	1
18	Switch Limit Rollout	1005548	1	-	-	-
		1010575	-	1	1	1
19	Valve Gas Nat & LP	1011024	1	1	1	1
20	Manifold Gas	1011645	1	-	-	-
		1011646	-	1	-	-
		1011647	-	-	1	-
		1011648	-	-	-	1
21	Tube Pilot	64930	1	1	1	1
22	Orifice Burner Nat #42 LP #54 High Altitude Orifice Nat #44 LP #55 LP #56	1011351	2	3	4	5
		*1011376	2	3	4	5
		1011352	2	3	4	5
		*1011354	2	3	4	5
		*1011355	2	3	4	5
23	Igniter/Sensor with Clip	1009524	1	1	1	1
24	Pilot Burner Assembly Nat & LP	1149856	1	1	1	1
25	Orifice Pilot Nat .020 LP .011	1160403	1	1	1	1
		1009136	-	-	-	-
26	Burner Asy	1008723	1	-	-	-
		1008724	-	1	-	-
		1008725	-	-	1	-
		1008726	-	-	-	1
27	Switch Limit (Main)	1010647	1	-	-	-
		34332903	-	1	-	1
		1320547	-	-	1	-
28	Tube Sensor	1006298	1	1	1	1
29	Switch, Limit (Aux.)	1000735	1	1	1	1
30	Filter 16" x 25" x 1/2"	1010365	1	1	1	2

Key No.	Description Non-Functional	Part Number	050	075	100	125
A	Panel Top	1010607	1	1	-	-
		1010608	-	-	1	-
		1010609	-	-	-	1
B	Box Field Connect	1010359	1	1	1	1
C	Cover Field Connect	1010360	1	1	1	1
D	Casing	1011649	1	1	-	-
		1011650	-	-	1	-
		1011651	-	-	-	1
E	Baffle Circ Air	707010031	2	2	2	2
F	Bracket Coil	1008743	1	1	-	-
		1008745	-	-	1	-
		1008747	-	-	-	1
G	Bracket Mount Coil(RH)	1011446	1	1	1	1
H	Bracket Mount Coil(LH)	1011445	1	1	1	1
J	Rail Blower Slide	57059	2	2	2	2
K	Casing Base	1010113	1	1	-	-
L	Blower Partition	1010114	-	-	1	-
		1010115	-	-	-	1
		1010815	1	1	-	-
M	Panel Cutoff Blwr	1010816	-	-	1	-
		1010817	-	-	-	1
		721020013	1	1	-	-
N	Housing Blower	721020008	-	-	1	1
		1011680	1	1	-	-
O	Bracket Ctrl Board	1011681	-	-	1	-
		1010481	-	-	-	1
		1011178	1	1	1	1
Q	Hanger Blower	1010690	2	2	2	2
R	Partition Frit Bot	1009489	1	-	-	-
		1009490	-	1	-	-
		1009491	-	-	1	-
		1009492	-	-	-	1
S	Partition Frit Top	1009485	1	-	-	-
		1009486	-	1	-	-
		1009487	-	-	1	-
		1009488	-	-	-	1
T	Gasket Collector Box	1008676	1	1	-	-
		1008677	-	-	1	-
		1008678	-	-	-	1
U	Collector Box	1008670	1	1	-	-
		1008671	-	-	1	-
		1008672	-	-	-	1
		1008682	1	1	-	-
V	Board Insul Coll Box	1008683	-	-	1	-
		1008684	-	-	-	1
		1068036	1	1	1	1
W	Cover Diaphragm	1068036	1	1	1	1
X	Diaphragm Silicone	1008763	1	1	1	1
Y	Bracket Pilot	1010901	1	1	1	1
Z	Gasket Limit Switch	1008778	1	1	1	1
AA	Door Louvered (NTGM ONLY)	1010184	1	1	-	-
		1010185	-	-	1	-
		1010186	-	-	-	1
		1010168	1	1	-	-
BB	Door Louvered (GNK ONLY)	1010169	-	-	1	-
		1010170	-	-	-	1
CC	Door Blower	1010190	1	1	-	-
		1010192	-	-	1	-
		1010257	-	-	-	1
DD	Viewport Cover Lexan	2480678	1	1	1	1
	Gasket Viewport	1093666	1	1	1	1

\* Only used when furnace has been converted to LP Gas

# Replacement Parts - NTGM

**Models** - NTGM050EFA3, NTGM075EGA3, NTGM100EHA3, NTGM125EKA3 (Natural Gas)  
 GNK050N12A3, GNK075N14A3, GNK100N16A3, GNK125N20A3 (Natural Gas)

**Replacement part supplied will be current active part. For parts not listed, consult place of purchase.**

Key No.	Description Non-Functional	Part Number	050	075	100	125
EE	Cover Burner Box	1008748	1	1	-	-
		1008749	-	-	1	-
		1008750	-	-	-	1
FF	Bracket Burner Box	1008722	2	2	2	2
GG	Baffle Burner Box	1008709	1	1	-	-
		1008710	-	-	1	-
		1008711	-	-	-	1
HH	Burner Box Asy	1010381	1	1	-	-
		1010382	-	-	1	-
		1010383	-	-	-	1
JJ	Gasket Air Intake	1008746	1	1	1	1
KK	Coupling Air Intake	1008744	1	1	1	1
LL	Gasket Burner Box	1008759	1	1	-	-
		1008760	-	-	1	-
		1008761	-	-	-	1
MM	Door Handle	1010073	1	1	1	1
NN	Gasket, Heat Exchanger	2480904	2	-	-	-
		2480905	-	2	-	-
		2480906	-	-	2	-
		2480907	-	-	-	2
OO	Seal, Burner Box Sides	1008755	2	2	2	2
PP	Seal, Burner Box	1008762	2	2	-	-
		1009243	-	-	2	-
		1009244	-	-	-	2
QQ	Gasket, Header Box	1010510	1	1	1	1
RR	Support, Heat Exchanger	1010092	1	-	-	-
		1010093	-	1	-	-
		1010098	-	-	1	-
		1010099	-	-	-	1
SS	Clamp, Capacitor	1095020	1	1	1	1
TT	Wrapper Filter Rack	741010039	1	1	1	2
UU	Front Filter Rack	741020001	1	1	1	2
VV	Cover Filter Plastic	2791043	1	1	1	2
WW	Clip Filter	1008482	3	3	3	3
{	<b>PART NOT ILLUSTRATED</b>					
{	Wire Harness	1011068	1	1	1	1
{	Pin Plastic Clip	2344276	3	3	3	3
{	Flexible Neoprene Coupling	1002522	2	2	2	2
{	Clamp Hose	1002793	4	4	4	4
{	Screen 2"	1007339	2	2	2	2
{	Screen 3"	1007340	2	2	2	2
{	Elbow Union	2971503	1	1	1	1
{	Manual Tech	440 03 1003 00	1	1	1	1
{	Manual Install	440 01 1001 03	1	1	1	1
{	Manual Homeowners	441 02 1001 02	1	1	1	1
{	Flue Pipe, ABS 2" x 22"	1009566	1	1	1	1
{	Grommet, Vinyl	1009535	1	1	1	1
{	Bushing, Strn Rlf	1945287	1	1	1	1

### Gas Conversion Kits - All models

Nat to LP            NAHF002LP \*1009509  
 LP to Nat            \*1009510

\*Must be ordered from Service Parts