

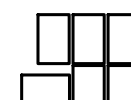

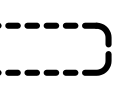

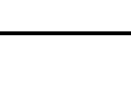

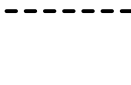



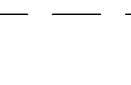

**SITE LEGEND**

-  (N) POWERPACK AND POWERPACK INVERTERS
-  AREAS OF INTEREST
-  (N) CONDUIT FOR POWER
-  (N) CONDUIT FOR COMMUNICATIONS
-  (N) UNDERGROUND CONDUIT FOR POWER
-  (N) UNDERGROUND CONDUIT FOR COMMUNICATIONS
-  (N) FENCE
-  (E) UNDERGROUND ELECTRICAL LINE
-  (E) UNDERGROUND SEWER LINE
-  (E) UNDERGROUND WATER LINE
-  (E) UNDERGROUND GAS LINE
-  (E) OVERHEAD ELECTRICAL LINE
-  (E) FIRE HYDRANT

**EQUIPMENT LEGEND**

- SWITCHBOARD SB-#
- POWERPACK INVERTER PP-#
- METER MTR-#
- SMARTLOGGER SML-#
- TESLA SITE CONTROLLER TSC
- GENERATOR DISCONNECT SWITCH SW-1
- FIRE CONTROL PANEL FCP-PNL

REFERENCE PAGE 4367-0006-005 FOR EQUIPMENT SCHEDULES

NYSEG- WASTE WATER TREATMENT PLAN  
525 THIRD ST.  
ITHACA, NY 14853, US

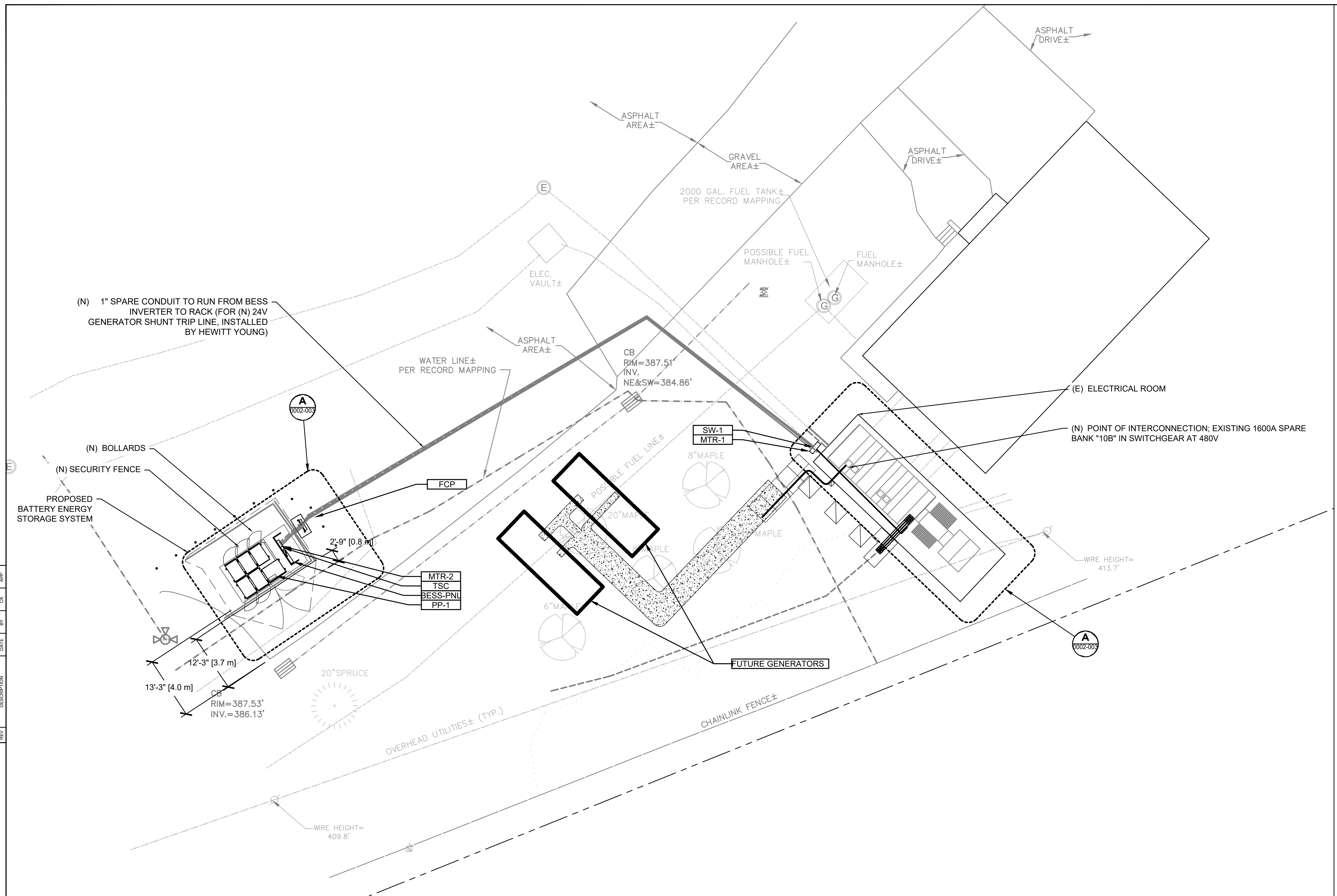

REV	DESCRIPTION	DATE	BY	CK	APP

INFO

**SITE PLAN**

1" = 10'

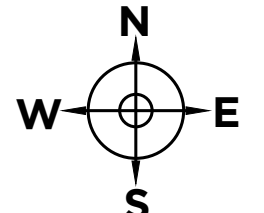
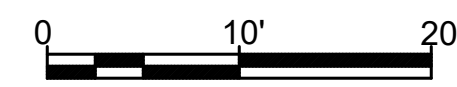

3500 DEER CREEK RD.  
PALO ALTO, CA 94304  
(650) 681-5000

PE Stamp

AVANGRID ENGINEERING  
CONFIDENTIAL, PROPRIETARY and  
TRADE SECRET INFORMATION  
Property of AVANGRID, Inc.



**ELECTRICAL SITE PLAN  
SITE PLANS  
SHEET 4 OF 15**

REV	DESCRIPTION	DATE	BY	CK	APP	SCALE: N/A	FILE: 4367-0003-001 SH 01.DWG	NO.	REV
A	PAD RELOCATION	11/27/2019	-	-	-	-	-	-	-

4367-0003-001 A

ANSI D

**EQUIPMENT LEGEND**

- BESS PANEL BOARD BESS-PNL
- POWERPACK INVERTER PP-#
- METER MTR-#
- TESLA SITE CONTROLLER TSC
- STEP-DOWN TRANSFORMER XFMR
- GENERATOR DISCONNECT SWITCH SW-1
- XXX-## COMMUNICATION CIRCUIT TAG
- XX-## POWER CIRCUIT TAG
- XX-## EQUIPMENT TAG

**CONDUIT LEGEND**

- ABOVE GROUND COMMS
- UNDERGROUND COMMS
- ABOVE GROUND POWER
- UNDERGROUND POWER

REFERENCE PAGE 0002-006 FOR EQUIPMENT SCHEDULES AND FOR CIRCUIT SCHEDULES

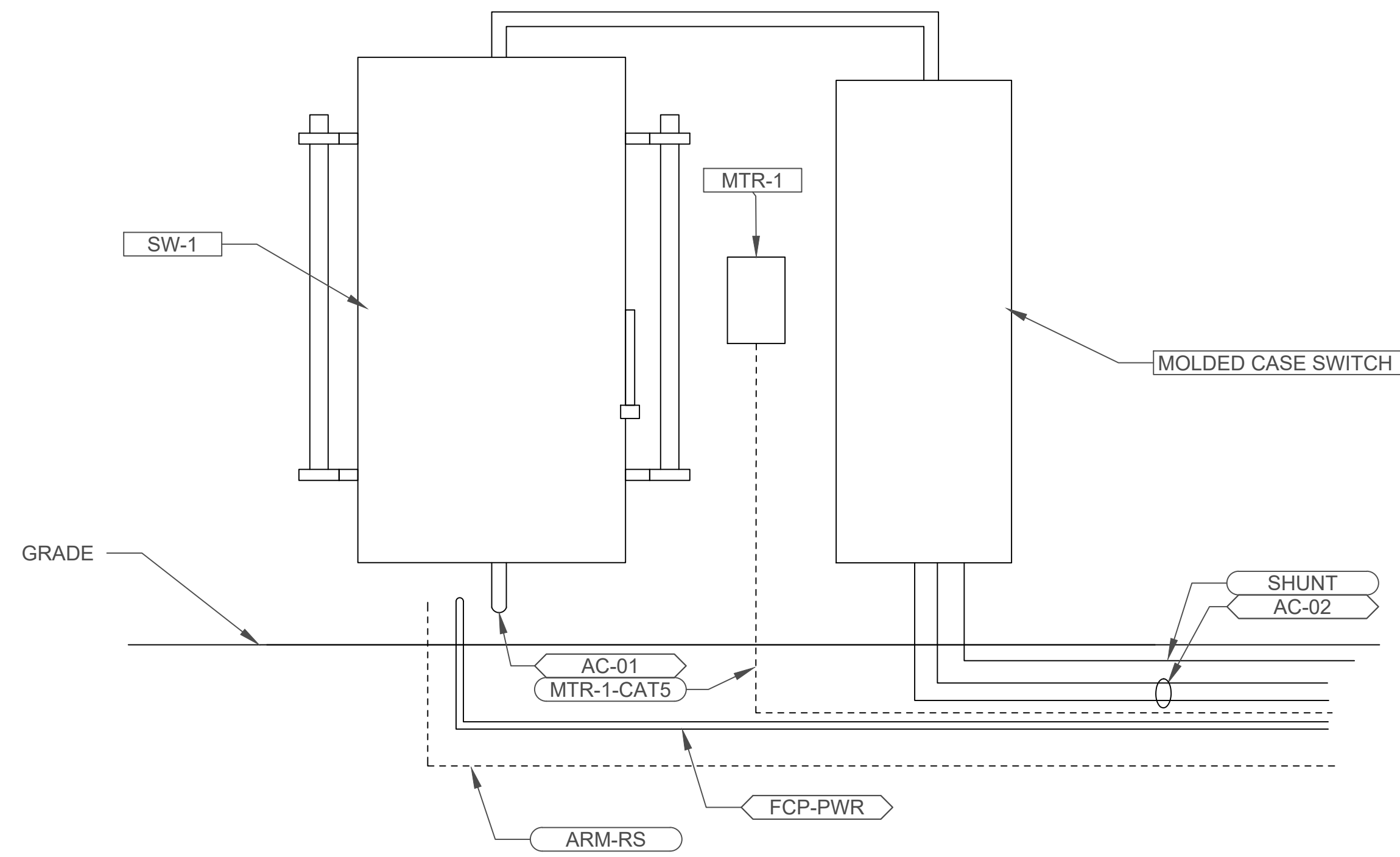

**C ELECTRICAL ROOM - ELEVATION VIEW**  
1/4" = 1'-0"

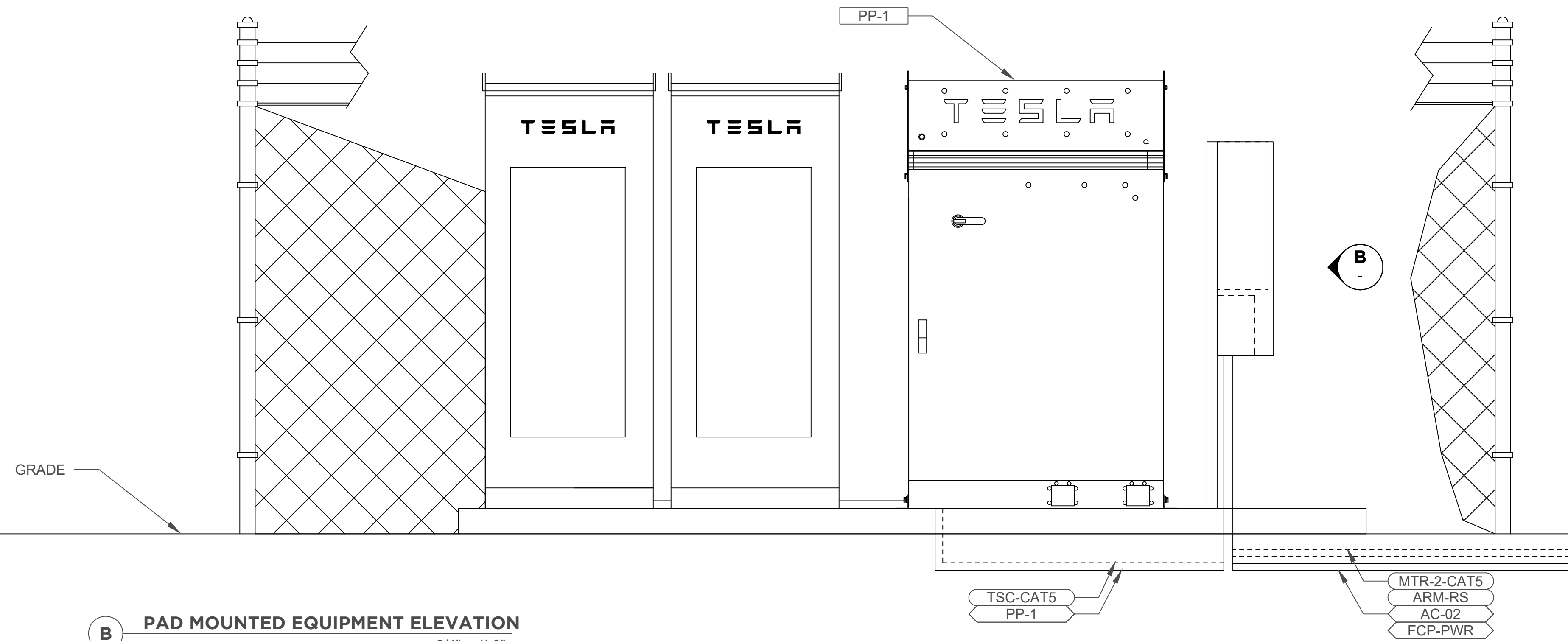

**B PAD MOUNTED EQUIPMENT ELEVATION**  
3/4" = 1'-0"

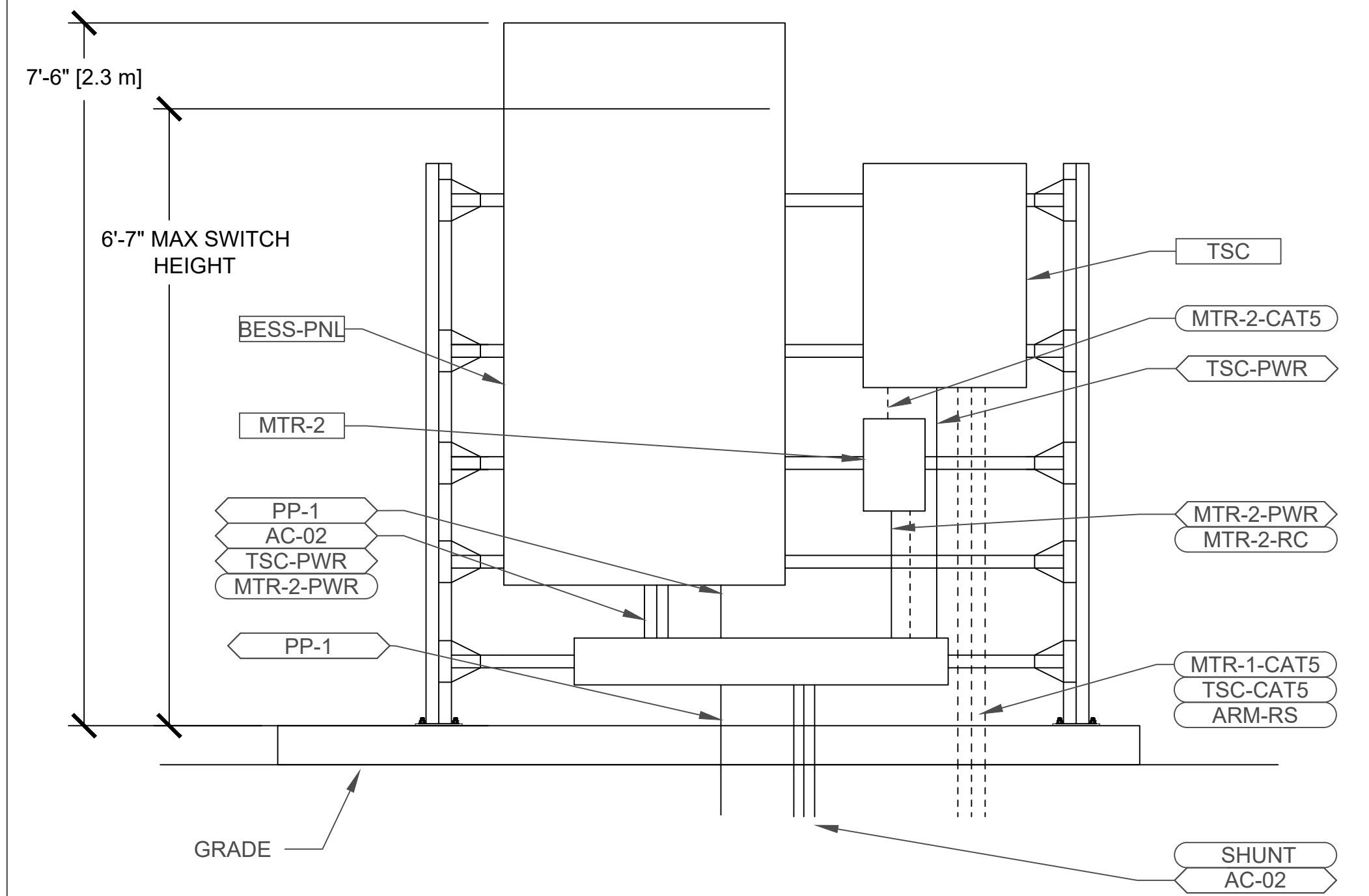

**A PAD MOUNTED EQUIPMENT ELEVATION**  
1/4" = 1'-0"

NYSEG- WASTE WATER TREATMENT PLAN  
525 THIRD ST.  
ITHACA, NY 14853, US

REV	DESCRIPTION	DATE	BY	CK	APP

ANSI D



3500 DEER CREEK RD.  
PALO ALTO, CA 94304  
(650) 681-5000

PE Stamp

AVANGRID ENGINEERING  
CONFIDENTIAL, PROPRIETARY and  
TRADE SECRET INFORMATION  
Property of AVANGRID, Inc.







**DETAILED CONDUIT PLAN  
CONDUIT PLAN**  
SHEET 12 OF 17 OF ELECTRICAL SET

REV	DESCRIPTION	DATE	BY	CK	APP	SCALE	NO.	FILE	DATE
0	ISSUE FOR CONSTRUCTION	07/XX/2019	-	-	-	1"=30'-0"	NO.	FILE 4367-0002-002 SH 01.DWG	07/XX/2019



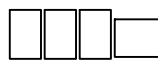
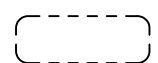
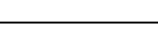
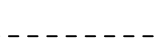

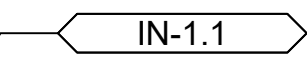
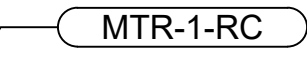

4367-0006-004 0



**SITE PLAN LEGEND**

-  (N) POWERPACK AND POWERPACK INVERTERS
-  AREAS OF INTEREST
-  (N) CONDUIT FOR POWER
-  (N) CONDUIT FOR COMMUNICATIONS
-  (N) UNDERGROUND CONDUIT FOR POWER
-  (N) UNDERGROUND CONDUIT FOR COMMUNICATIONS
-  (N) FENCE
-  IN-1.1 CONDUIT TAG FOR POWER
-  MTR-1-RC CONDUIT TAG FOR COMMUNICATIONS

**EQUIPMENT LEGEND**

- BESS PANEL  BESS-PNL
- PV INVERTER  IN-#.#
- POWERPACK INVERTER  PP-#
- METER  MTR-#
- TESLA SITE CONTROLLER GENERATOR DISCONNECT SWITCH  TSC
-  SW-1
- MOLDED CASE SHUNT TRIP  SHUNT

**CONDUIT LEGEND**

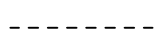
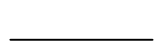
-  UNDERGROUND/ INSIDE ENCLOSURE
-  ABOVE GROUND

REFERENCE PAGE 0002-006 FOR EQUIPMENT SCHEDULES AND FOR CIRCUIT SCHEDULES

NYSEG- WASTE WATER TREATMENT PLAN  
525 THIRD ST.  
ITHACA, NY 14853, US

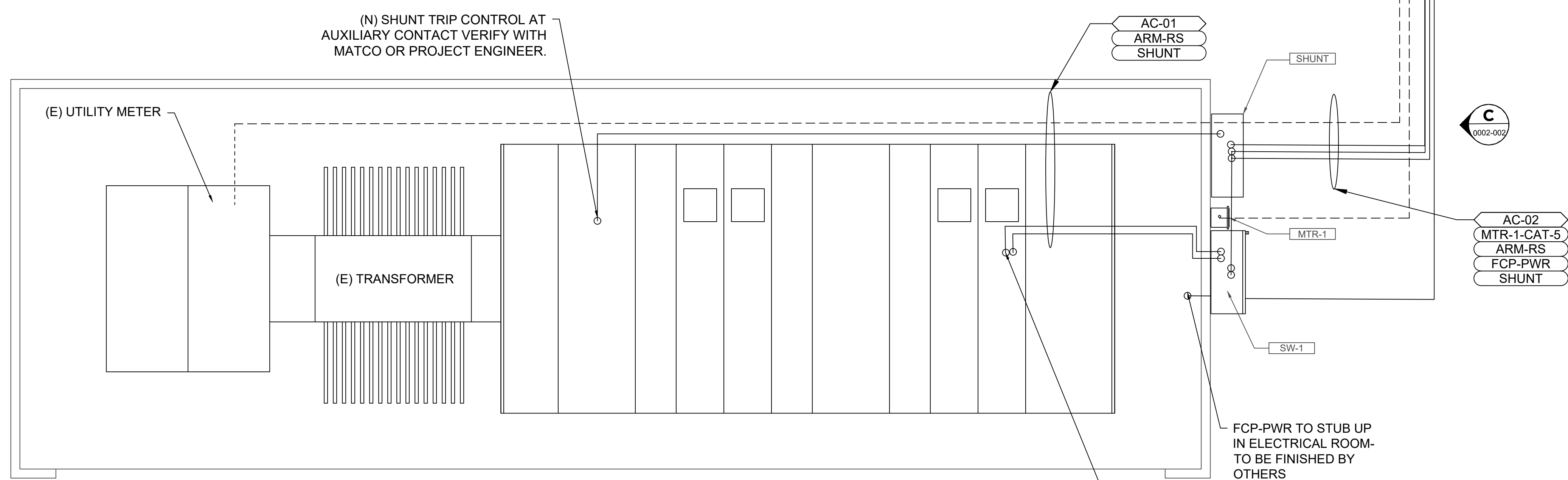

**B ELECTRICAL ROOM - PLAN VIEW**  
1/4" = 1'-0"

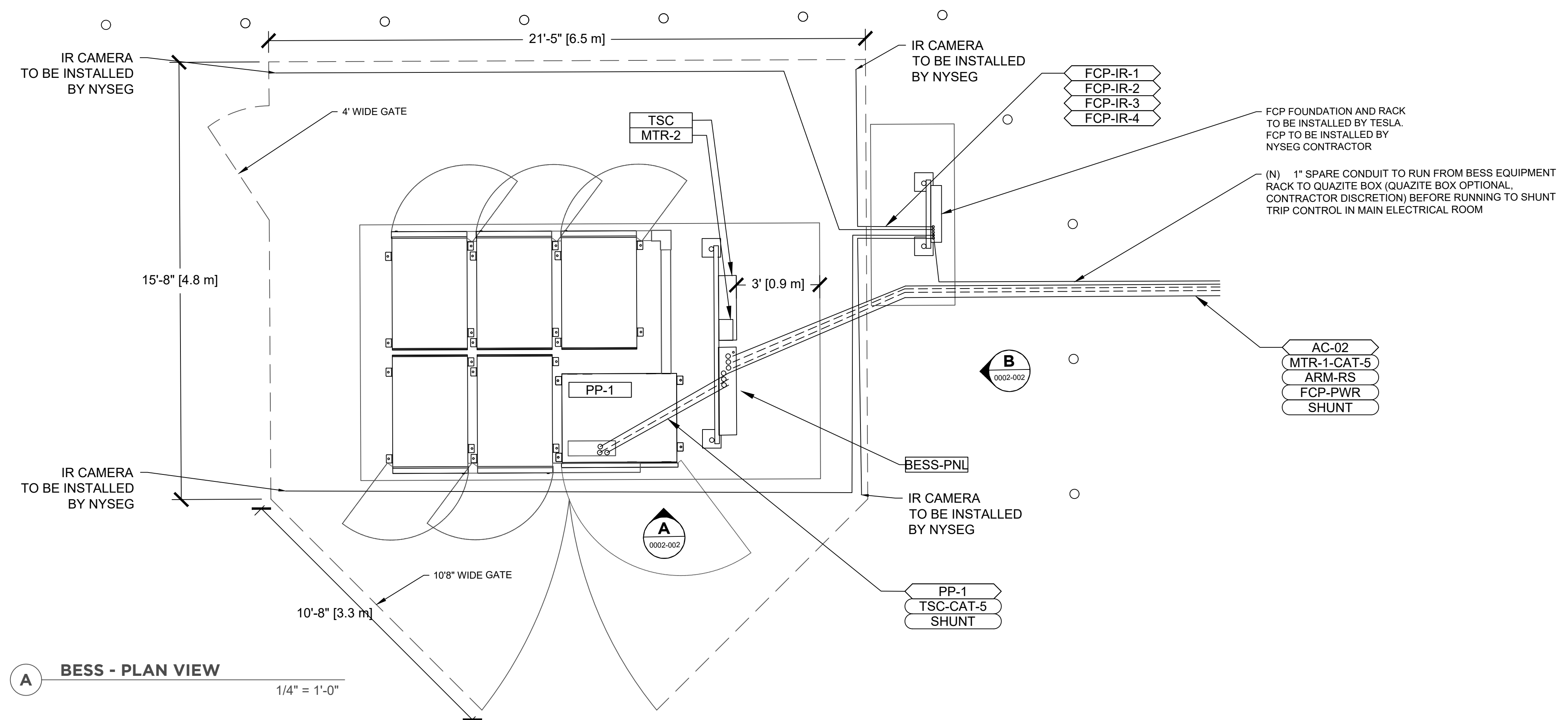

**A BESS - PLAN VIEW**  
1/4" = 1'-0"

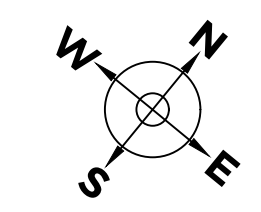
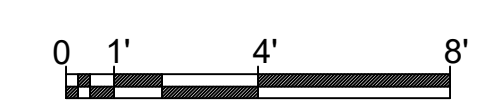

REV	DESCRIPTION	DATE	BY	CK	APP

ANSI D  
LOGO



3500 DEER CREEK RD.  
PALO ALTO, CA 94304  
(650) 681-5000

PE Stamp

AVANGRID ENGINEERING  
CONFIDENTIAL, PROPRIETARY and  
TRADE SECRET INFORMATION  
Property of AVANGRID, Inc.



**DETAILED CONDUIT PLAN**  
CONDUIT PLAN  
SHEET 11 OF 17 OF ELECTRICAL SET

REV	DESCRIPTION	DATE	BY	CK	APP	SCALE	NO.	FILE	REV
0	ISSUE FOR CONSTRUCTION	07/XX/2019	-	-	-	1"=30'-0"	NO.	FILE 4367-0002-002 SH 01.DWG	-

4367-0006-004 0



FIRE CONTROL PANEL TO BE POWERED IN MAIN ELECTRICAL ROOM AS OPPOSED TO (N) BESS PANEL. IN THE EVENT OF A POWER OUTAGE THE PROPOSED GENERATOR SYSTEM WILL SUPPLY POWER TO THE MAIN ELECTRICAL ROOM WHILE THE BATTERY SYSTEM DISCONNECTS.

(E) MAIN SWITCH GEAR  
480VAC, 3Φ 4W  
4000A

**BREAKER CONNECTION COMPARTMENT 10B**  
1600A BREAKER TO BE DIALED DOWN TO 0.5 BY TESLA

(E) TIE BREAKER

CONTROL AT AUXILIARY CONTACT VERIFY WITH MATCO OR PROJECT ENGINEER.

(E) BUSS SECTION TO BE REMOVED UNDER FUTURE CONTRACT

(N) ROGOWSKI COIL BY TESLA

19.1

7  
(E) UTILITY TRANSFORMER  
2500 KVA  
8.3KVΔ-480/277Y

IN UNIT SUBSTATION WALK IN ENCLOSURE LOCATED OUTSIDE

GENERATOR GENERAC  
(E) GENERATOR TO BE REMOVED BY OTHERS.

3  
(N) FUSIBLE DISCONNECT "SW-1"  
600A, 450A FUSES BY TESLA

9  
(N) MOLDED CASE SWITCH TO ISOLATE PP-1 FROM MAIN SWITCH GEAR BY TESLA (SAFE OPEN)

10  
(N) BESS-PNL  
480VAC, 3Φ 4W 600A BY TESLA

"MTR-2-RC" 0001-004 BY TESLA

19.2  
(N) ROGOWSKI COIL

15  
(N) POWERPACK INVERTER, PP-1 BY TESLA 280kVA

20  
(N) POWERPACK HVDC CABLE BY TESLA

17  
(N) POWERPACK BY TESLA 1140kWh

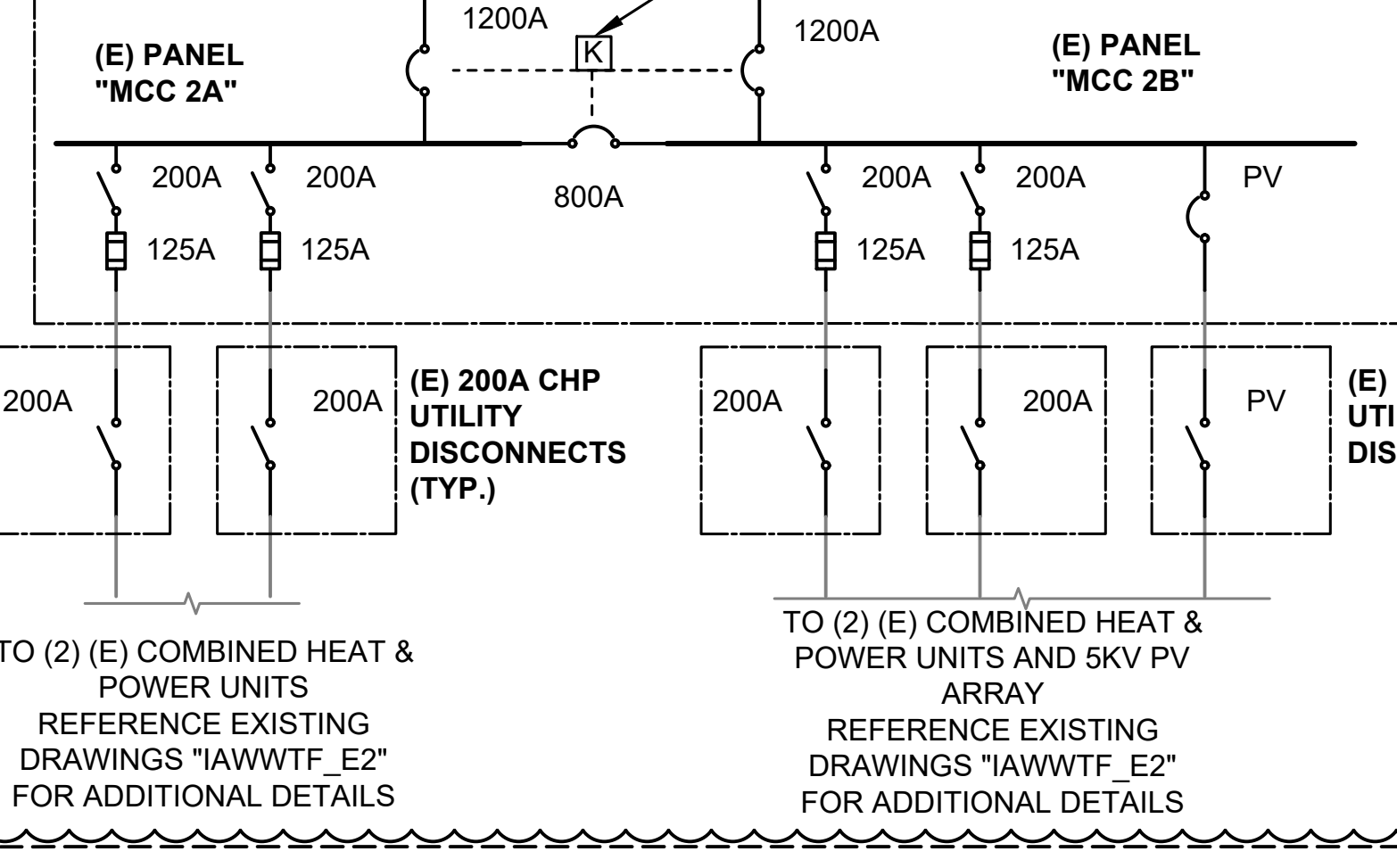

(N) POINT OF INTERCONNECTION

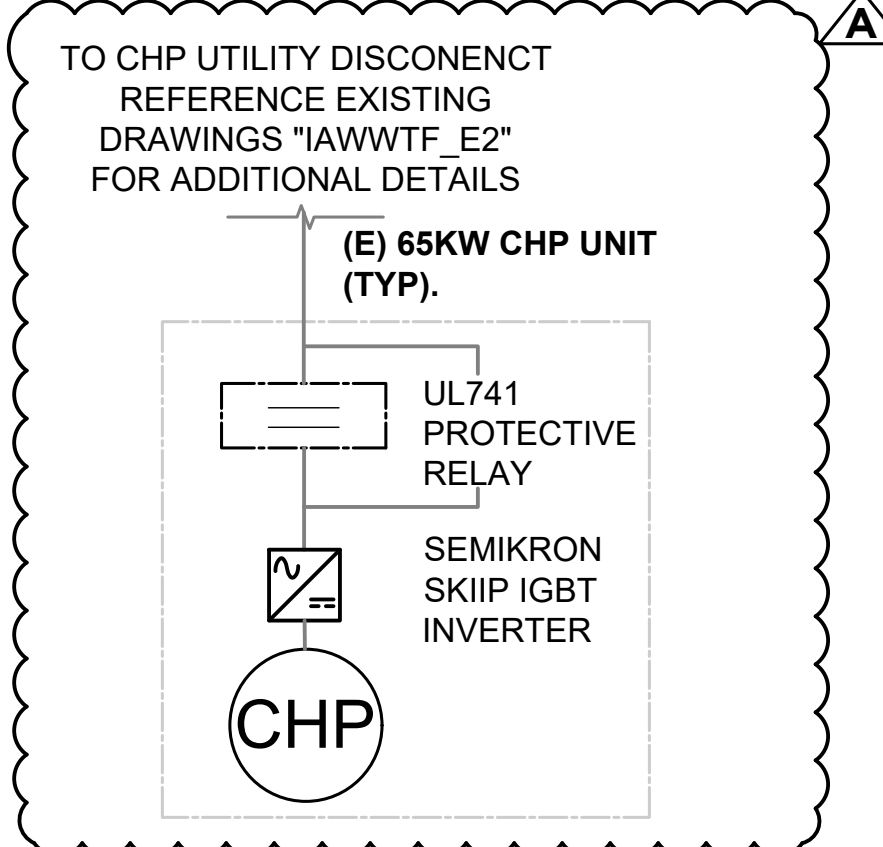

4  
(N) SITE METER "MTR-1" BY TESLA

6  
(N) TESLA SITE CONTROLLER "TSC" BY TESLA

(N) RTU BY TESLA

5  
(N) BATTERY METER "MTR-2" BY TESLA

PROPOSED (N) GENERATOR BACK UP BY OTHERS UNDER FUTURE CONTRACT FINAL SITE LOCATION TBD

# EQUIPMENT NOTES

1	(E) MAIN DISTRIBUTION EQUIPMENT • 600VAC, 4000A RATED • 4000A MAIN BREAKER • REFERENCE A/E-231 FOR GROUNDING
2	(E) UTILITY METER • METER # 4370121 TO BE RETROFITTED BY UTILITY
3	(N) PV UTILITY DISCONNECT (SW-1) • 600A, 600VAC RATED • (3) 450A FUSES • 24/7 UTILITY ACCESSIBLE • LOCKABLE, NEMA 3R • REFERENCE D-0006-003 FOR GROUNDING
4	(N) SITE METER • (ACCUENERGY # ACUVIM-IR METER) • CUSTOMER OWNED BATTERY PRODUCTION METER • REFERENCE THE TESLA "COMMUNICATION INTERFACE MANUAL" FOR SPECIFIED METER MODELS
5	(N) BATTERY METER • (ACCUENERGY # ACUVIM-IR METER) • CUSTOMER OWNED BATTERY PRODUCTION METER • REFERENCE THE TESLA "COMMUNICATION INTERFACE MANUAL" FOR SPECIFIED METER MODELS
6	(N) TESLA SITE CONTROLLER • TESLA-MANUFACTURED CONTROLLER • TESLA OPTICASTER SOFTWARE CONFIGURED TO ON-GRID DEMAND PEAK SHAVING (NON-EXPORT) FUNCTIONALITY • PRIVATE TCP NETWORK COMMUNICATION TO POWERPACK INVERTERS • COMMUNICATION WITH TESLA SERVERS VIA WIRELESS CELLULAR GSM • 480VAC INPUT ENCLOSURE POWER • NEMA 3R RATED • REFERENCE D/E-231 FOR GROUNDING
7	(E) UTILITY TRANSFORMER 2500 KVA 8.3KVΔ-480/277 WYE
8	NOT USED
9	(N) BATTERY PANELBOARD • 480VAC PANELBOARD, 3-PH, 4-W • 600A RATED, MN • NEMA 3R • REFERENCE D/F-0006-003 FOR GROUNDING
10	NOT USED
11	NOT USED
12	NOT USED
13	NOT USED
14	NOT USED
15	(N) POWERPACK INVERTER • (4) POWER STAGE(S), 70KVA EACH, 280 KVA TOTAL • TESLA PART # 1134768-41 • 480VAC 3-PH, 4-W, 900VDC RATED • BI-DIRECTIONAL, INTEGRATED ISOLATION TRANSFORMER • NEMA 3R RATED, UL 1741 LISTED • REFERENCE F-0006-003 FOR GROUNDING
16	NOT USED
17	(N) POWERPACK ENERGY STORAGE • TESLA POWERPACK 2.5, 4 HR INDUSTRIAL BATTERY SYSTEM • (5) POWERPACKS, 57KW EACH, 285 KWH TOTAL • 228KWH EACH, 1140KWH TOTAL • UL 1973 LISTED, INCLUSIVE OF CABLE HARNESS AND DC COMBINER PANEL
18	NOT USED
19.1	NOT USED
19.2	(N) ACCUENERGY ROGOWSKI COILS • RCT24-1000 • 7.01" Window 5A-50kA RANGE
19.3	(N) ACCUENERGY ROGOWSKI COILS • RCT36-5000 • 10.67" Window 5A-50kA RANGE
20	(N) POWERPACK HVDC CABLE • TESLA PROVIDED DC BATTERY HARNESS • EGC INSTALLED BY CONTRACTOR • 5 BATTERIES MAX PER EGC PER INSTALLATION MANUALS, AHJ, AND NEC REQUIREMENTS

NOTE: SEE E-011 AND E-021 FOR CIRCUIT AND EQUIPMENT SCHEDULES

NYSEG- WASTE WATER TREATMENT PLAN 525 THIRD ST. ITHACA, NY 14853, US

REV	DESCRIPTION	DATE	BY	CK	APP

ANSI D  
LOGO

**TESLA**

3500 DEER CREEK RD.  
PALO ALTO, CA 94304  
(650) 681-5000

PE Stamp

AVANGRID ENGINEERING  
CONFIDENTIAL PROPRIETARY AND  
TRADE SECRET INFORMATION  
Property of AVANGRID, Inc.

**NYSEG**  
AVANGRID

**SINGLE LINE DIAGRAM**  
ONE LINE DIAGRAM  
SHEET 5 OF 15 OF ELECTRICAL SET

REV	DESCRIPTION	DATE	BY	CK	APP	SCALE: N/A	FILE: 4367-0001-001 SH 01.DWG

4367-0001-001 0