



7th ANNUAL UKC GATEWAY NATIONALS

Friday, October 28 - Sunday, October 30, 2016

Hosted by United Kennel Club

- 6 UKC Licensed Multi-Breed Conformation Shows (Intact and Altered) (2 Friday, 2 Saturday, 2 Sunday)
 - 6 Agility Trials (2 Friday, 2 Saturday, 2 Sunday)
 - 3 Obedience Trials (1 Friday, 1 Saturday, 1 Sunday)
 - 3 Rally Obedience Trials (1 Friday, 1 Saturday, 1 Sunday)
 - 6 Drag Races (2 Friday, 2 Saturday, 2 Sunday, 2nd race Sunday Aptitude only)
 - 6 Nosework Trials (2 Friday – 1st Trial PT & Container N-E, 2nd Trial Containers N-E, 2 Saturday – 1st Trial PT & Exterior N-E, 2nd Trial Exterior N-E, 2 Sunday – Both Trials Vehicle N-A)
 - Lure Coursing Meets Hosted by United Greyhound Club
- Dock Jumping Not Offered*

All Events held at Purina Events Center, 200 Checkerboard Dr, Gray Summit, Missouri 63039

Temporary Listing Numbers will be available at these events.
Conformation, Agility, Rally Obedience & Obedience events, crating & grooming area will be indoors.
Lure Coursing, Drag Racing & Nosework will be outdoors.

Building will be open to exhibitors at 7 a.m. and close each evening at 9 p.m.
Overnight security is not provided • No dogs may be left in the building overnight.

Saturday has been designated as "Wear Pink" Day in support of Breast Cancer Awareness. We encourage you to show your support by wearing pink and help us in honoring those who are currently battling breast cancer, those who have lost the battle, and those in remission.



SHOW INFORMATION • All times are Central Time

Day of show entries will be taken

Friday, October 28, 2016 Show/Trial #1 and #27:00-8:00 a.m.
Drag Racing Entries will be accepted until 12 noon. (Applies to Drag Racing only, No Exceptions. Entries will be taken at the track.) Agility, Conformation, Drag Racing, Nosework and Lure Coursing will accept DOS for Friday, October 28, 2016, if limits are not reached

Saturday, October 29, 2016 Show/Trial #1 and #27:00-8:00 a.m.
Drag Racing Entries will be accepted until 12 noon. (Applies to Drag Racing only, No Exceptions. Entries will be taken at the track.) Agility, Conformation, Drag Racing, Nosework and Lure Coursing will accept DOS for Saturday, October 29, 2016, if limits are not reached.

Sunday, October 30, 2016 Show/Trial #1 and #27:00-8:00 a.m.
Drag Racing Entries will be accepted until 12 noon. (Applies to Drag Racing only, No Exceptions.) Agility, Conformation, Drag Racing, Nosework, Obedience and Lure Coursing will accept DOS for Sunday, October 30, 2016, if limits are not reached.

Event Start Times

FRIDAY

1. Conformation.

- Junior Showmanship. Show 1: 8:30 a.m., immediately followed by Junior Showmanship Show 2.
- Breed Judging. Shows 1 & 2 to follow the judging of Junior Showmanship, or 9 a.m. whichever comes first or at the discretion of the Event Committee.
- Group Judging. Group judging to commence immediately following all breeds in that group, or at the discretion of the Event Committee.

2. Agility. Trial 1: 8 a.m. Trial 2 to follow Trial 1; however, the order of classes and trials are to be judged in this order: AG1 T1, AG1 T2, AG3 T1, AG3 T2, AG2 T1, AG2 T2.

3. Rally Obedience Trial: 8 a.m.

4. Obedience Trial immediately to follow the conclusion of Rally Obedience.

5. Drag Racing. Aptitude 8:00 a.m.-3:00 p.m. Race 1 will begin at 1 p.m. immediately followed by Race 2.

6. Lure Coursing. See United Greyhound Club event listing.

7. Nosework. Pretrial: 8 a.m. See page 7.

SATURDAY

1. Conformation.

- Junior Showmanship. Show 1: 8:30 a.m., immediately followed by Junior Showmanship Show 2.
- Breed Judging. Show 1 & 2 to follow the judging of Junior Showmanship, or 9 a.m. whichever comes first, or at the discretion of the Event Committee.
- Group Judging. Group judging to commence immediately following all breeds in that group, or at the discretion of the Event Committee.

2. Agility. Trial 1: 8 a.m. Trial 2 to follow Trial 1; however, the order of classes and trials are to be judged in this order: AG1 T1, AG1 T2, AG3 T1, AG3 T2, AG2 T1, AG2 T2.

3. Rally Obedience. Trial: Immediately to follow the conclusion of Obedience.

4. Obedience. Trial: 8 a.m.

5. Drag Racing. Aptitude 8:00 a.m.-3:00 p.m. Race 1 will begin at 1 p.m. immediately followed by Race 2.

6. Lure Coursing. See United Greyhound Club event listing.

7. Nosework. Pretrial: 8 a.m. See page 7.

SUNDAY

1. Conformation.

- Junior Showmanship. Show 1: 8:30 a.m., immediately followed by Junior Showmanship Show 2.
- Breed Judging. Show 1 & 2 to follow the judging of Junior Showmanship, or 9 a.m. whichever comes first, or at the discretion of the Event Committee.
- Group Judging. Group judging to commence immediately following all breeds in that group, or at the discretion of the Event Committee.

2. Agility. Trial 1: 8 a.m. Trial 2 to follow Trial 1; however, the order of classes and trials are to be judged in this order: AG1 T1, AG1 T2, AG3 T1, AG3 T2, AG2 T1, AG2 T2.

3. Rally Obedience. Trial: 8 a.m.

4. Obedience. Trial immediately to follow the conclusion of Rally Obedience.

5. Drag Racing. Aptitude 8:00 a.m.-3:00 p.m. Race 1 will begin at 1 p.m. immediately followed by Race 2.

6. Lure Coursing. See United Greyhound Club event listing.

7. Nosework. Pretrial: 8 a.m. See page 7.

Building Availability & Restrictions

1. Building will be open to exhibitors at 7 a.m. and stay open until 9 p.m. on Thursday, October 27, 2016.

2. On Friday, Saturday and Sunday, the building will open at 7 a.m. and will close at 9 p.m. each night. Overnight security is not provided and no dog(s) may be left in the building overnight.

3. Please follow the directions of the parking attendants to facilitate an orderly traffic flow through the unloading areas and in the parking areas. Vehicles are allowed a 15 minute unloading time-frame. Violators will be towed.

4. Empty grooming space may not be saved. Grooming space is on a first come, first served basis.

5. No rugs or ground cover mats are allowed on the grooming room floor. No tents or non-grooming tables are allowed in the grooming area.

6. There will be absolutely NO SMOKING in any buildings. Smoking is only permitted in designated areas.

7. NO powdering or other grooming products used to alter or enhance a dog's coat or color are allowed.

Armbands — One armband will be assigned to each dog for all shows/trials in which the dog is entered for the weekend. Armbands will be available for pick up at the event site from the superintendents table. Entry confirmation information will be printed on the back of the armband. Please verify the classes/events your dog is entered into upon picking your armband up. Should there be any errors please see the superintendent at the event immediately. All entry errors must be corrected prior to the start of judging.

Class Change/Correction of Entry — Owners are responsible for the accuracy of information and any errors on the entry forms. There will be no refunds for invalid entries. Dogs that, according to their owners' records, have completed the requirements for a title after the closing of entries, may be moved-up from the entered class to another class for which the dog is now eligible. Requests for a move-up must be made in writing to UKC no later than one-half hour prior to the start of any regular judging at the show. All other corrections to entries must be made in writing to the Event Secretary no later than one-half hour prior to the start of any regular judging at the show.

Directions To The Show — Purina Event Center is located 45 miles southwest of St. Louis in Gray Summit, MO.

- From St. Louis or Springfield, Missouri. Purina Farms is handy to reach from Interstate 44. Simply turn north at the Gray Summit exit (Exit 253) on Interstate 44, and travel two blocks on Missouri Highway 100. Go left on County Road MM, and the entrance to Purina Farms is one mile on the left.
- From Kansas City. Take I-70 east to the Warrenton exit at Hwy. 47. Go south on Hwy. 47 for approximately 25 miles until you reach Hwy. 100 in Washington. Turn left onto Hwy. 100 and continue to I-44 (approximately 10 miles). Go east on I-44. Follow the directions above from Springfield.

Useful Phone Numbers & E-mail addresses

Event Superintendent: United Kennel Club, Show Operations Department (269) 343-9020, gateway@ukcdogs.com

Event Chairperson(s): Sydney Suwannarat, sydney@sukcdogs.com. Tony Vacha, tvacha@ukcdogs.com

Event Coordinator: Sara Herbert, sherbert@ukcdogs.com

2 UKC GATEWAY NATIONALS 2016

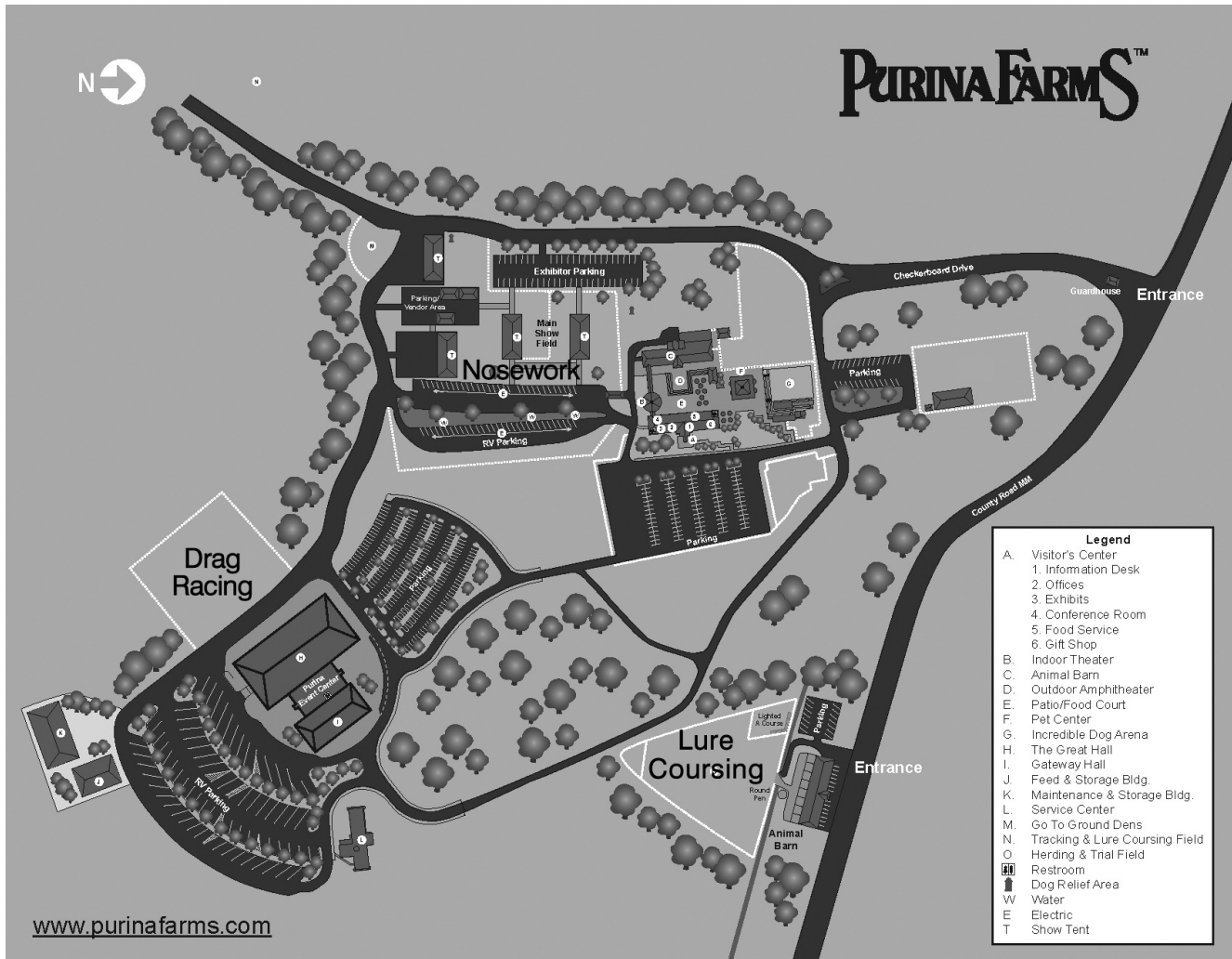

www.purinafarms.com

Vendor Location

1. Whitman's - 30 x 10
2. Safety Pups - 20 x 10
3. Natural Performance Dogs - 20 x 10
4. Independent Scentsy - 10 x 10
5. Fuzzywumpets - 20 x 10
6. Puppy Warmer - 15 x 10
7. K9 Coal Care - 15 x 10
8. Precious Pats - 20 x 10
9. Midwest Pet Supply - 40 x 10
10. Anderson's Pet Supply - 15 x 10
11. The Copper Mare Collection - 15 x 10
12. Doggie Pro - 10 x 10
13. Thomas Photography
14. Midwest Embroidery - 30 x 10

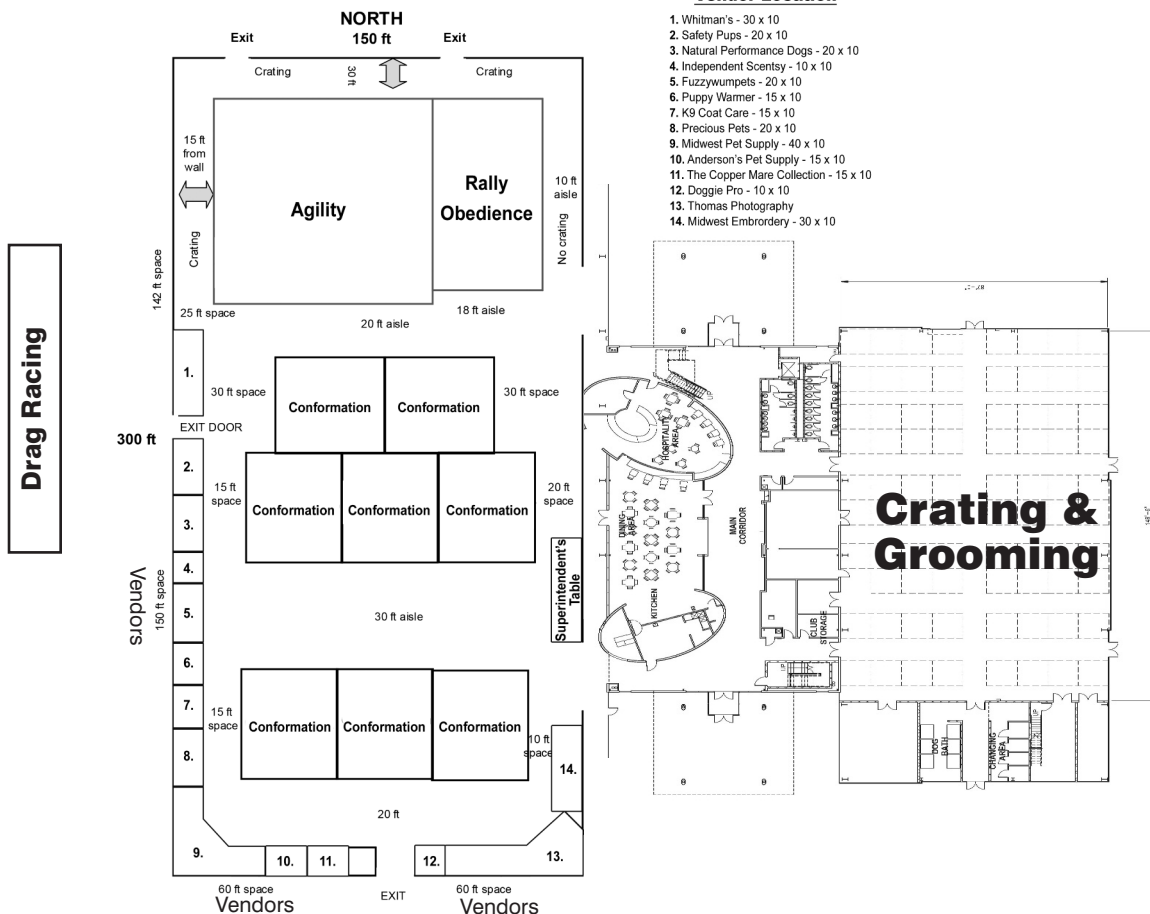

GATEWAY NATIONALS INDEX OF PRE-ENTRIES

For your convenience, the following division of entries has been carefully tabulated; however, the United Kennel Club does not assume responsibility for complete accuracy.

This index has been prepared to enable exhibitors to know the number of dogs pre-entered. All dogs pre-entered may not be present on the show day and day of show entries may change the final entry numbers.

The breakdown is noted by the number of class males-class females-Champions-Grand Champions. For breeds with varieties the variety is noted before the tabulation of Champion and Grand Champions.

BREED	Friday October 28, 2016 Show 1	Friday October 28, 2016 Show 2	Saturday October 29, 2016 Show 1	Saturday October 29, 2016 Show 2	Sunday October 30, 2016 Show 1	Sunday October 30, 2016 Show 2
AFGHAN HOUND	0-0-0-1	0-0-0-1	0-0-0-1	0-0-0-1	0-0-0-1	0-0-0-1
AKITA	0-1-1-0	0-1-1-0	0-1-1-0	0-1-1-0	0-1-1-0	0-1-1-0
ALASKAN KLEE KAI	M 0-1 S 1-0 CH-2 GRCH-3	M 0-1 S 1-0 CH-2 GRCH-3	M 0-1 S 1-0 CH-2 GRCH-3	M 0-1 S 1-0 CH-2 GRCH-3	M 0-1 S 1-0 CH-2 GRCH-3	M 0-1 S 1-0 CH-2 GRCH-3
ALASKAN KLEE KAI ALT	CH-0 GRCH-1	CH-0 GRCH-1	CH-0 GRCH-1	CH-0 GRCH-1	CH-0 GRCH-1	CH-0 GRCH-1
AMERICAN B & T COONHOUND	3-0-1-0	3-0-1-0	3-0-1-0	3-0-1-0	2-0-1-0	2-0-1-0
AMERICAN ESKIMO	M 3-3 S 1-0 CH-5 GRCH-3	M 3-3 S 1-0 CH-5 GRCH-3	M 3-3 S 1-0 CH-5 GRCH-3	M 3-3 S 1-0 CH-4 GRCH-3	M 3-3 S 1-0 CH-4 GRCH-3	M 3-3 S 1-0 CH-4 GRCH-3
AMERICAN HAIRLESS TERRIER	CH-0 GRCH-1			H 1-0 CH-0 GRCH-0	H 1-0 CH-0 GRCH-0	
AMERICAN PIT BULL TERRIER	0-0-0-3	0-0-0-3	0-0-0-3	0-0-0-3	0-0-0-2	0-0-0-2
AUSTRALIAN CATTLE DOG	0-0-1-1	0-0-1-1	0-0-2-1	0-0-2-1	0-0-2-1	0-0-2-1
AUSTRALIAN CATTLE DOG ALT	1-0-0-0	1-0-0-0	1-0-0-0	1-0-0-0	1-0-0-0	1-0-0-0
AUSTRALIAN SHEPHERD	1-4-6-2	1-4-6-2	1-4-6-1	1-4-5-1	1-4-4-1	1-4-4-1
AUSTRALIAN SHEPHERD ALT	1-1-2-1	1-1-2-1	0-1-2-1	0-1-2-1	0-1-2-1	0-1-2-1
BASSET HOUND	0-0-4-0	0-0-4-0	0-0-4-0	0-0-4-0	0-0-4-0	0-0-4-0
BEAGLE	0-0-1-0	0-0-1-0	1-0-1-0	1-0-1-0	1-0-1-0	1-0-1-0
BERNESE MOUNTAIN DOG	0-1-0-0	0-1-0-0	0-1-0-0			
BERNESE MOUNTAIN DOG ALT	0-1-0-0	0-1-0-0	0-1-0-0			
BIEWER TERRIER	1-0-0-0	1-0-0-0	1-0-0-0	1-0-0-0	1-0-0-0	1-0-0-0
BLACK RUSSIAN TERRIER	0-1-1-0	0-1-1-0				
BLUETICK COONHOUND	1-2-3-0	1-2-3-0	1-2-3-0	1-2-3-0	1-2-3-0	1-2-3-0
BORDER COLLIE ALT	1-0-1-0	0-0-1-0				
BORZOI	1-0-0-0	1-0-0-0	1-0-1-0	1-0-1-0	1-0-1-0	1-0-1-0
BOSTON TERRIER	0-0-1-0	0-0-1-0	0-0-1-0	0-0-1-0	0-0-1-0	0-0-1-0
BOUVIER DES FLANDRES	0-1-0-0	0-1-0-0	0-1-0-0	0-1-0-0	0-1-0-0	0-1-0-0
BRUSSELS GRIFFON	0-0-1-0	0-0-1-0	0-0-1-0	0-0-1-0	0-0-1-0	0-0-1-0
CARDIGAN WELSH CORGI	0-1-1-0	0-1-1-0	0-1-1-0	0-1-1-0	0-1-1-0	0-1-1-0
CAROLINA DOG	0-0-3-1	0-0-3-1	0-0-3-1	0-0-3-1	0-0-3-1	0-0-3-1
CHESAPEAKE BAY RETRIEVER	0-0-1-0	0-0-1-0	0-0-1-0	0-0-1-0		
CHINESE CRESTED	1-0-1-0	1-0-1-0	1-0-1-0	1-0-1-0	1-0-1-0	1-0-1-0
CHINESE SHAR-PEI	0-2-1-0	0-2-1-0	0-2-1-0	0-2-1-0	0-2-1-0	0-2-1-0
CHOW CHOW ALT			1-0-0-0	1-0-0-0	1-0-0-0	1-0-0-0
DALMATIAN	0-2-0-0	0-2-0-0	0-2-0-0	0-2-0-0	0-2-0-0	0-2-0-0
DOBERMAN PINSCHER	1-2-2-0	1-2-2-0	1-2-2-0	1-2-2-0	1-2-2-0	1-2-2-0
DUTCH SHEPHERD	1-0-4-0	1-0-4-0	1-0-4-0	1-0-4-0	1-0-4-0	1-0-4-0
DUTCH SHEPHERD ALT	0-0-1-0	0-0-1-0				
ENGLISH COCKER SPANIEL ALT	0-0-1-0	0-0-1-0	0-0-1-0	0-0-1-0	0-0-1-0	0-0-1-0
ENGLISH COONHOUND	0-0-1-0	0-0-1-0	0-0-1-0	0-0-1-0	0-0-1-0	0-0-1-0
ENGLISH POINTER	0-1-0-0	0-0-0-2	0-0-0-2	0-0-0-2	0-0-0-2	0-0-0-2
ENGLISH SETTER			0-0-1-0	0-0-1-0	0-0-1-0	0-0-1-0
FLAT-COATED RETRIEVER	0-1-2-1	0-1-2-1	0-2-2-1	0-2-2-1	0-2-2-1	0-2-2-1
FRENCH BULLDOG	0-1-1-0	0-1-1-0	0-1-1-0	0-1-1-0	0-1-1-0	0-1-1-0
GERMAN SHEPHERD DOG	0-0-0-1	0-0-0-1	0-0-0-1	0-0-0-1	0-0-0-1	0-0-0-1
GERMAN SHEPHERD DOG ALT	1-0-1-0	1-0-1-0	1-0-1-0	1-0-1-0	1-0-1-0	1-0-1-0
GERMAN SHORTHAIRED PNTR	0-0-1-2	0-0-1-2	0-0-1-2	0-0-1-2	0-0-1-2	0-0-1-2
GERMAN SPITZ	CH-1 GRCH-0	CH-1 GRCH-0	CH-1 GRCH-0	CH-1 GRCH-0	CH-1 GRCH-0	CH-1 GRCH-0
GIANT SCHNAUZER	0-2-0-0	0-2-0-0	0-2-1-0	0-2-1-0	0-2-0-0	0-2-0-0
GOLDEN RETRIEVER	2-0-3-2	2-0-3-2	2-0-3-2	2-0-3-2	2-0-2-2	2-0-2-2
GOLDEN RETRIEVER ALT	0-0-1-0	0-0-1-0	0-0-1-0	0-0-1-0	0-0-1-0	0-0-1-0
GREAT DANE	0-1-0-0	0-1-0-0	0-1-0-0	0-1-0-0	0-1-0-0	0-1-0-0
GREAT PYRENEES	0-0-1-0	0-0-1-0	0-0-1-0	0-0-1-0	0-0-1-0	0-0-1-0
GREAT PYRENEES ALT	1-0-0-0	1-0-0-0	1-0-0-0			
GREYHOUND	1-3-2-0	1-3-1-0	1-3-2-0	1-3-1-0	1-3-2-0	1-3-1-0
HUNGARIAN WH VIZSLA	1-2-0-0	1-2-0-0	1-2-0-0	1-2-0-0	1-2-0-0	1-2-0-0
IRISH SETTER	1-0-0-0	1-0-0-0	1-0-0-0	1-0-0-0	1-0-0-0	1-0-0-0
IRISH WOLFHOUND	0-2-2-0	0-2-2-0	0-2-2-0	0-2-2-0	0-2-2-0	0-2-2-0
JACK RUSSELL TERRIER	0-0-1-0	0-0-1-0	0-0-1-0	0-0-1-0	0-0-1-0	0-0-1-0
KEESHOND	0-1-0-0	0-1-0-0	0-1-0-0	0-1-0-0	0-1-0-0	0-1-0-0
KERRY BLUE TERRIER	0-1-1-0	0-1-1-0	0-1-1-0	0-1-1-0	0-1-1-0	0-1-1-0
LA CATAHOULA LEOPARD DOG	0-0-1-3	0-0-1-2	1-0-0-3	1-0-0-2	1-0-0-2	1-0-0-2
LABRADOR RETRIEVER	3-3-1-1	3-3-1-1	3-3-3-1	3-3-3-1	3-3-3-1	3-3-3-1
LUNDEHUND	0-0-1-0	0-0-1-0	0-0-1-0	0-0-1-0	0-0-1-0	0-0-1-0
MASTIFF	0-1-1-0	0-1-1-0	0-1-1-0	0-1-1-0	0-1-1-0	0-1-1-0
MIN AMERICAN SHEPHERD	1-0-0-0	1-0-0-0	1-0-0-0	1-0-0-0	1-0-0-0	1-0-0-0
MINIATURE BULL TERRIER	1-0-0-0	1-0-0-0	1-0-0-0	1-0-0-0	1-0-0-0	1-0-0-0
MINIATURE SCHNAUZER	1-0-0-0	1-0-0-0	1-0-0-0	1-0-0-0	1-0-0-0	1-0-0-0
NS DUCK TOLLING RETRIEVER	1-0-0-0	1-0-0-0	1-0-0-0	1-0-0-0	1-0-0-0	1-0-0-0
NS DUCK TOLLING RETRIEVER ALT	0-0-1-0	0-0-1-0				
PAPILLON	3-1-1-0	3-1-1-1	3-1-1-0	3-1-1-0	3-1-1-0	3-1-1-0
PAPILLON ALT	1-0-0-1	0-0-0-1				
PARSON RUSSELL TERRIER	CH-2 GRCH-0	CH-2 GRCH-0	CH-2 GRCH-0	CH-2 GRCH-0	CH-2 GRCH-0	CH-2 GRCH-0
PEMBROKE WELSH CORGI	1-0-1-0	1-0-1-0	1-0-1-0	1-0-1-0	1-0-1-0	1-0-1-0
PERRO DE PRESA CANARIO	0-2-4-0	0-2-4-0	0-2-4-0	0-2-4-0	0-2-4-0	0-2-4-0
PLOTT HOUND	1-1-0-0	1-1-0-0	1-1-0-0	1-1-0-0	1-1-0-0	1-1-0-0

	CH-2 GRCH-1 1-0-0-0 S 0-1 CH-0 GRCH-0 CH-1 GRCH-0	CH-2 GRCH-1 1-0-0-0 S 0-1 CH-0 GRCH-0 CH-1 GRCH-0	M 0-2 CH-2 GRCH-1 1-0-0-0 S 0-1 CH-0 GRCH-0 CH-1 GRCH-0	M 0-2 CH-2 GRCH-1 1-0-0-0 S 0-1 CH-0 GRCH-0 CH-1 GRCH-0	M 0-2 CH-2 GRCH-1 1-0-0-0 S 0-1 CH-0 GRCH-0 CH-1 GRCH-0	M 0-2 CH-2 GRCH-1 1-0-0-0 S 0-1 CH-0 GRCH-0 CH-1 GRCH-0
	Friday 10/28/16 Trial 1	Friday 10/28/16 Trial 2	Saturday 10/29/16 Trial 1	Saturday 10/29/16 Trial 2	Sunday 10/30/16 Trial 1	Sunday 10/30/16 Trial 2
POODLE						
PUG						
RAT TERRIER						
RAT TERRIER ALT						
REDBONE COONHOUND	1-2-3-0	1-2-3-0	1-1-3-0	1-1-3-0	1-1-3-0	1-1-3-0
ROTTWEILER	0-1-0-0	0-1-0-0	0-1-0-0	0-1-0-0	0-1-0-0	0-1-0-0
SAMOYED	1-0-1-0	1-0-1-0	1-0-1-0	0-0-1-0	0-0-1-0	0-0-1-0
SCHIPPERKE	0-0-2-0	0-0-2-0	0-0-2-0	0-0-2-0	0-0-2-0	0-0-2-0
SHETLAND SHEEPDOG	0-3-0-2	0-2-0-1	0-3-0-2	0-3-0-2	0-2-0-1	0-2-0-1
SHETLAND SHEEPDOG ALT	0-0-1-0	0-0-1-0	0-0-1-0	0-0-1-0	0-0-1-0	0-0-1-0
SILKEN WINDHOUND	5-1-4-2	5-1-4-2	5-1-4-2	5-1-4-2	5-1-4-2	5-1-4-2
SILKEN WINDHOUND ALT	1-0-0-0	1-0-0-0	1-0-0-0	1-0-0-0	1-0-0-0	1-0-0-0
STAFFORDSHIRE BULLTERRIER	1-1-0-1	1-1-0-1	1-1-0-1	1-1-0-1	1-1-0-1	1-1-0-1
STANDARD POODLE	0-4-2-1	0-4-2-1	0-4-3-1	0-4-3-1	0-4-3-1	0-4-3-1
STANDARD POODLE ALT			0-1-0-0	0-1-0-0	0-1-0-0	0-1-0-0
STANDARD POODLE MC	2-2-4-4	2-2-4-4	2-2-4-4	2-2-4-4	2-2-4-4	2-2-4-4
STANDARD POODLE MC ALT	0-0-0-1	0-0-0-1	0-0-0-1	0-0-0-1	0-0-0-1	0-0-0-1
STANDARD SCHNAUZER	1-0-0-0	1-0-0-0	1-0-0-0	1-0-0-0	1-0-0-0	1-0-0-0
STANDARD SCHNAUZER ALT	0-0-0-1	0-0-0-1	0-0-0-1	0-0-0-1	0-0-0-1	0-0-0-1
TIBETAN SPANIEL	0-1-2-0	0-1-2-0	0-1-2-0	0-1-2-0	0-1-2-0	0-1-2-0
TOY FOX TERRIER	2-1-3-2	2-1-3-2	2-1-3-1	2-1-3-2	2-1-3-1	2-1-3-2
TOY FOX TERRIER ALT	0-0-0-1	0-0-0-1	0-0-0-1	0-0-0-1	0-0-0-1	0-0-0-1
TREEING WALKER COONHOUND	0-0-2-1	0-0-2-1	0-0-2-1	0-0-2-1	0-0-2-1	0-0-2-1
VIZSLA	0-1-0-0	0-1-0-0	0-1-0-0	0-1-0-0	0-1-0-0	0-1-0-0
WHITE SHEPHERD	1-1-2-2	1-1-3-2	1-1-2-2	1-1-2-2	1-1-2-2	1-1-2-2
AGILITY TRIAL						
Agiility I	29	29	30	24	19	19
Agiility II	22	22	23	22	17	17
Agiility III	13	12	15	14	11	12
TOTAL	64	63	68	60	47	48
OBEDIENCE TRIAL						
Novice	20	<i>Not Offered</i>	18	<i>Not Offered</i>	17	<i>Not Offered</i>
Open	5	<i>Not Offered</i>	7	<i>Not Offered</i>	4	<i>Not Offered</i>
Utility	3	<i>Not Offered</i>	3	<i>Not Offered</i>	3	<i>Not Offered</i>
TOTAL	28		28		24	
RALLY OBEDIENCE TRIAL						
RO 1	38	<i>Not Offered</i>	35	<i>Not Offered</i>	31	<i>Not Offered</i>
RO 2	14	<i>Not Offered</i>	16	<i>Not Offered</i>	19	<i>Not Offered</i>
RO 3	12	<i>Not Offered</i>	13	<i>Not Offered</i>	13	<i>Not Offered</i>
TOTAL	64		64		63	
DRAG RACES						
Aptitude Flat	4	4	7	6	6	6
Aptitude Steeple	7	7	10	7	7	6
Regular Flat	12	11	12	11	10	<i>Not Offered</i>
Regular Steeple	11	11	11	11	9	<i>Not Offered</i>
Champion (Flat & Steeple)	1	1	1	1	1	<i>Not Offered</i>
Grand Champion(Flat & Steeple)	0	0	0	0	0	<i>Not Offered</i>
TOTAL	35	34	41	36	33	12
NOSEWORK						
PRE TRIAL						
NOVICE	5	<i>Not Offered</i>	3	<i>Not Offered</i>	<i>Not Offered</i>	<i>Not Offered</i>
ADVANCED	2	<i>Not Offered</i>	1	<i>Not Offered</i>	<i>Not Offered</i>	<i>Not Offered</i>
SUPERIOR	1	<i>Not Offered</i>	1	<i>Not Offered</i>	<i>Not Offered</i>	<i>Not Offered</i>
MASTER	0	<i>Not Offered</i>	0	<i>Not Offered</i>	<i>Not Offered</i>	<i>Not Offered</i>
ELITE	0	<i>Not Offered</i>	0	<i>Not Offered</i>	<i>Not Offered</i>	<i>Not Offered</i>
TOTAL	8		5			
INDIVIDUAL ELEMENTS						
	CONTAINER	CONTAINER	EXTERIOR	EXTERIOR	VEHICLE	VEHICLE
NOVICE	7	9	9	11	10	10
ADVANCED	4	4	5	4	8	8
SUPERIOR	3	2	4	5	<i>Not Offered</i>	<i>Not Offered</i>
MASTER	1	1	0	0	<i>Not Offered</i>	<i>Not Offered</i>
ELITE	1	2	0	0	<i>Not Offered</i>	<i>Not Offered</i>
Total	16	18	18	20	18	18
JUNIOR SHOWMANSHIP						
Sub-Junior	0	0	0	0	0	0
Pre - Junior	0	0	0	0	0	0
Novice Junior	1	1	1	1	1	1
Novice Senior	1	1	1	1	1	1
Open Junior	0	0	0	0	0	0
Open Senior	7	6	8	8	7	7
TOTAL	9	8	10	10	9	9

2016 Gateway Nationals Judging Schedule*

Location: Purina Farms-Purina Event Center, Gray Summit MO
Please Note: All times are Central Daylight Savings Time*

Legend: S1=Show 1; S2=Show 2

Please note order of Judging: When feasible, judging of breeds will be alphabetical from A to Z within each group, except as indicated below. Group judging to commence immediately following all breed judging in that group, or at the discretion of the Event Committee.

Group and Best In Multi-Breed Show Judges will be made public immediately prior to the start of judging for these classes.

Subject to change at the discretion of the Event Committee

FRIDAY October 28, 2016

Judges may take a 30-minute lunch break at their discretion.

RING 1

JUDGE: Lori Sargent
Starts: 8:30 AM

Immediately following JS S1 first class
Junior Showmanship S2
Herding Dogs S1
Scenthounds S2

RING 2

JUDGE: Patricia Till
Starts: 9:00 AM

Gun Dogs S1
Guardians S2

RING 3

JUDGE: Karen Cattin
Starts: 9:00 AM

Terrier S1
Companion Dogs S2

RING 4

JUDGE: Tracy Doty
Starts: 9:00 AM

Sighthound & Pariah Dogs S1
Terriers S2

RING 5

JUDGE: John F Booth
Starts: 9:00 AM

Guardian Dogs S1
Herding Dogs S2

RING 6

JUDGE: Antonio Raposo
Starts: 9:00 AM

Northern Breeds S1
Gun Dogs S2

RING 7

JUDGE: Julie Hatlas-Pepper
Starts: 9:00 AM

Companion Dogs S1
Northern Breeds S2

RING 8

JUDGE: Diana Allen
Starts: 8:30 AM

Junior Showmanship S1
Scenthound S1
Sighthound & Pariah Dog S2

Best in Show S1

Best in Show S2

RING 9

Agility
Starts: 8:00 AM

Judge Trial 1: Beverly Benjes
Judge Trial 2: Richard Benjes

Class Order:
AGI A Trial 1 Div Toy
AGI B Trial 1 Div Toy
AGI A Trial 1 Div 1
AGI B Trial 1 Div 1
AGI A Trial 1 Div 2
AGI B Trial 1 Div 2
AGI A Trial 1 Div 3
AGI B Trial 1 Div 3

AGI A Trial 2 Div 3
AGI B Trial 2 Div 3
AGI A Trial 2 Div 2
AGI B Trial 2 Div 2
AGI A Trial 2 Div 1
AGI B Trial 2 Div 1
AGI A Trial 2 Div Toy
AGI B Trial 2 Div Toy

AGIII Trial 1 Div Toy
AGIII Trial 1 Div 1
AGIII Trial 1 Div 2
AGIII Trial 1 Div 3

AGIII Trial 2 Div 3
AGIII Trial 2 Div 2
AGIII Trial 2 Div 1
AGIII Trial 2 Div Toy

AGII A Trial 1 Div Toy
AGII B Trial 1 Div Toy
AGII A Trial 1 Div 1
AGII B Trial 1 Div 1
AGII A Trial 1 Div 2
AGII B Trial 1 Div 2

AGII B Trial 1 Div 2
AGII A Trial 1 Div 3
AGII B Trial 1 Div 3

AGII A Trial 2 Div 3
AGII B Trial 2 Div 3
AGII A Trial 2 Div 2
AGII B Trial 2 Div 2
AGII A Trial 2 Div 1
AGII B Trial 2 Div 1
AGII A Trial 2 Div Toy
AGII B Trial 2 Div Toy

RING 10

RALLY OBEDIENCE
Time: 8:00 AM

Judge: Dovie Ryan

Class Order:
RO 3 A Div 1
RO 3 B Div 1
RO 3 A Div 2
RO 3 B Div 2
RO 3 A Div 3
RO 3 B Div 3
RO 2 A
RO 2 B
RO 1 A
RO 1 B

OBEDIENCE

Time: To follow conclusion of Rally Obedience Trial

Judge: Sarah Schroeder

Class Order:
Utility B
Utility A
Open B
Open A
Novice C
Novice B
Novice A

DRAG RACE

Time: Aptitude classes will be run from 8:00 AM to 3:00 PM. Entries will be taken at the track. Regular classes for Flat and Steeple will begin at 1:00 PM for Race 1. Race 2 to follow. Race times may be altered at the Event Committee's discretion.
Judge: Karyn Pingel

Race 1 - 1:00 PM or at the Event Committee's discretion
Flat Racing
Steeplechase Racing

Race 2

Time: to follow conclusion of Race 1
Steeplechase Racing
Flat Racing

NOSEWORK

Time: Pre-Trials will begin at 8 AM immediately followed by Trial 1 and Trial 2 Container classes.

Judge Trial 1: Nancy Anderson

Judge Trial 2: Karen Shivers

Class Order
Pre-Trail Novice
Pre-Trail Advanced
Pre-Trail Superior
Pre-Trail Master
Pre-Trail Elite

Novice Container A Trial 1
Novice Container B Trial 1
Novice Container A Trial 2
Novice Container B Trial 2

Advanced Container A Trial 1
Advanced Container B Trial 1
Advanced Container A Trial 2
Advanced Container B Trial 2

Superior Container A Trail 1
Superior Container B Trial 1
Superior Container A Trail 2
Superior Container B Trial 2

Master Container A Trial 1
Master Container B Trial 1
Master Container A Trial 2
Master Container B Trial 2

Elite Container A Trial 1
Elite Container B Trial 1
Elite Container A Trial 2
Elite Container B Trial 2

Attention All Ghouls and Goblins! You are invited to take part in the Halloween festivities at the Gateway Nationals!

SPECIAL COSTUME CONTEST

to be held **Friday, October 28** at the conclusion of judging

Feel free to dress up early! No entry fee. Just show up at the designated ring (to be announced).

Categories:

Scariest! • Funniest! • Goriest! • People's Choice! • Junior's Contest!

Breed Related, for example Staffordshire Bull "Terror", "Hogwart Hound" (Hovawart), Czechoslovakian "Were" Wolf) • Performance Event Related

Trick or Treating is encouraged in the crating area throughout the weekend!

SATURDAY October 29, 2016

Judges may take a 30-minute lunch break at their discretion.

RING 1

JUDGE: Lori Sargent
Starts: 8:30 AM

Gun Dogs S1
Guardian Dogs S2

RING 2

JUDGE: Patricia Till
Starts: 8:00 AM

Junior Showmanship S1
Scenthounds S1
Companion Dogs S2

RING 3

JUDGE: Karen Cattin
Starts: 8:30 AM

Northern Breeds S1
Sighthounds & Pariah Dogs S2

RING 4

JUDGE: Tracy Doty
Starts: 8:30 AM

Companion Dogs S1
Herding Dogs S2

RING 5

JUDGE: John F Booth
Starts: 8:30 AM

Sighthounds & Pariah Dogs S1
Gun Dogs S2

RING 6

JUDGE: Antonia Raposo
Starts: 8:30 AM

Herding Dogs S1
Terrier S2

RING 7

JUDGE: Julie Hatlas-Pepper
Starts: 8:00 AM

Immediately following JS S1 first class
Junior Showmanship S2
Guardian Dogs S1
Scenthounds S2

RING 8
JUDGE: Diana Allen
Starts: 8:30 AM
Terriers S1
Northern Breeds S2

Best In Show 1
Best In Show 2

Total Junior Parade & Announcement of qualifiers.

Total Dog Groups and Total Dog Best In Show Competition. Total Dog Ribbons can be collected from the Secretary's table.
See page 8 for additional instructions.

JUDGES: TBA

RING 9
Agility
Starts: 8:00 AM
Judge Trial 1: Beverly Benjes
Judge Trial 2: Richard Benjes

Class Order:
AGI A Trial 1 Div Toy
AGI B Trial 1 Div Toy
AGI A Trial 1 Div 1
AGI B Trial 1 Div 1
AGI A Trial 1 Div 2
AGI B Trial 1 Div 2
AGI A Trial 1 Div 3
AGI B Trial 1 Div 3

AGI A Trial 2 Div 3
AGI B Trial 2 Div 3
AGI A Trial 2 Div 2
AGI B Trial 2 Div 2

AGI A Trial 2 Div 1
AGI B Trial 2 Div 1
AGI A Trial 2 Div Toy
AGI B Trial 2 Div Toy

AGIII Trial 1 Div Toy
AGIII Trial 1 Div 1
AGIII Trial 1 Div 2
AGIII Trial 1 Div 3

AGIII Trial 2 Div 3
AGIII Trial 2 Div 2
AGIII Trial 2 Div 1
AGIII Trial 2 Div Toy

AGII A Trial 1 Div Toy
AGII B Trial 1 Div Toy
AGII A Trial 1 Div 1
AGII B Trial 1 Div 1
AGII A Trial 1 Div 2
AGII B Trial 1 Div 2
AGII A Trial 1 Div 3
AGII B Trial 1 Div 3

AGII A Trial 2 Div 3
AGII B Trial 2 Div 3
AGII A Trial 2 Div 2
AGII B Trial 2 Div 2
AGII A Trial 2 Div 1
AGII B Trial 2 Div 1
AGII A Trial 2 Div Toy
AGII B Trial 2 Div Toy

RING 10
OBEDIENCE
Time: 8:00 AM
Judge: Dovie Ryan
Class Order:
Utility B

Utility A
Open B
Open A
Novice C
Novice B
Novice A

RALLY OBEDIENCE
Time: To follow conclusion of Obedience
Judge: Sarah Schroeder

Class Order:
RO 3 A Div 1
RO 3 B Div 1
RO 3 A Div 2
RO 3 B Div 2
RO 3 A Div 3
RO 3 B Div 3
RO 2 A
RO 2 B
RO 1 A
RO 1 B

DRAG RACE
Time: Aptitude classes will be run from 8:00am to 3:00pm. Entries will be taken at the track. Regular classes for Flat and Steeple will begin at 1:00pm for Race 1. Race 2 to follow. Race times may be altered at the Event Committee's discretion.
Judge: Karyn Pingel

Race 1 - 1:00pm or at the Event Committee's discretion
Flat Racing
Steeplechase Racing

Race 2 - Following Race 1
Time: to follow conclusion of Race 1
Steeplechase Racing

Flat Racing
NOSEWORK
Time: Pre-Trials will begin at 8 AM immediately followed by Trial 1 and Trial 2 Exterior classes.
Judge Trial 1: Nancy Anderson
Judge Trial 2: Karen Shivers
Class Order
Pre-Trail Novice
Pre-Trail Advanced
Pre-Trail Superior
Pre-Trail Master
Pre-Trail Elite

Novice Exterior A Trial 1
Novice Exterior B Trial 1
Novice Exterior A Trial 2
Novice Exterior B Trial 2

Advanced Exterior A Trial 1
Advanced Exterior B Trial 1
Advanced Exterior A Trial 2
Advanced Exterior Trial 2

Superior Exterior A Trial 1
Superior Exterior B Trial 1
Superior Exterior A Trial 2
Superior Exterior B Trial 2

Master Exterior A Trial 1
Master Exterior B Trial 1
Master Exterior A Trial 2
Master Exterior B Trial 2

Elite Exterior A Trial 1
Elite Exterior B Trial 1
Elite Exterior A Trial 2
Elite Exterior B Trial 2

Sunday October 30, 2016

Judges may take a 30-minute lunch break at their discretion.

RING 1
JUDGE: Lori Sargent
Starts: 8:30 AM
Northern Breeds S1
Terriers S2

RING 2
JUDGE: Patricia Till
Starts: 8:30 AM
Herding Dogs S1
Sighthounds & Pariah Dogs S2

RING 3
JUDGE: Karen Cattin
Starts: 8:00 AM
Junior Showmanship S1
Scenthounds S1
Guardian Dogs S2

RING 4
JUDGE: Tracy Dotty
Starts: 8:30 AM
Gun Dogs S1
Northern Breeds S2

RING 5
JUDGE: John F Booth
Starts: 8:00 AM
Immediately following JS S1 first class
Junior Showmanship S2
Companion Dogs S1
Scenthounds S2

RING 6
JUDGE: Antonio Raposo
Starts: 8:30 AM
Sighthounds & Pariah Dogs S1
Companion Dogs S2

RING 7
JUDGE: Julie Hatlas-Pepper
Starts: 8:30 AM
Terriers S1
Herding Dogs S2

RING 8
JUDGE: Diana Allen
Starts: 8:30 AM
Guardian Dogs S1
Gun Dogs S2

Best in Show S1
Best in Show S2

RING 9
Agility
Starts: 8:00 AM
Judge Trial 1: Beverly Benjes
Judge Trial 2: Richard Benjes

Class Order:
AGI A Trial 1 Div Toy
AGI B Trial 1 Div Toy
AGI A Trial 1 Div 1
AGI B Trial 1 Div 1
AGI A Trial 1 Div 2
AGI B Trial 1 Div 2
AGI A Trial 1 Div 3
AGI B Trial 1 Div 3

AGI A Trial 2 Div 3
AGI B Trial 2 Div 3
AGI A Trial 2 Div 2
AGI B Trial 2 Div 2
AGI A Trial 2 Div 1
AGI B Trial 2 Div 1
AGI A Trial 2 Div Toy
AGI B Trial 2 Div Toy

AGIII Trial 1 Div Toy
AGIII Trial 1 Div 1
AGIII Trial 1 Div 2
AGIII Trial 1 Div 3

AGIII Trial 2 Div 3
AGIII Trial 2 Div 2
AGIII Trial 2 Div 1
AGIII Trial 2 Div Toy

AGII A Trial 1 Div Toy
AGII B Trial 1 Div Toy
AGII A Trial 1 Div 1
AGII B Trial 1 Div 1
AGII A Trial 1 Div 2
AGII B Trial 1 Div 2
AGII A Trial 1 Div 3
AGII B Trial 1 Div 3

AGII A Trial 2 Div 3
AGII B Trial 2 Div 3
AGII A Trial 2 Div 2
AGII B Trial 2 Div 2
AGII A Trial 2 Div 1
AGII B Trial 2 Div 1
AGII A Trial 2 Div Toy
AGII B Trial 2 Div Toy

RING 10
RALLY OBEDIENCE
Time: 8:00 AM
Judge: Dovie Ryan

Class Order:
RO 3 A Div 1
RO 3 B Div 1
RO 3 A Div 2
RO 3 B Div 2
RO 3 A Div 3
RO 3 B Div 3
RO 2 A
RO 2 B
RO 1 A
RO 1 B

OBEDIENCE
Time: To follow conclusion of Rally Obedience
Judge: Sarah Schroeder
Class Order:

Utility B
Utility A
Open B
Open A
Novice C
Novice B
Novice A

DRAG RACE
Time: Aptitude classes will be run from 8:00 AM to 3:00 PM. Entries will be taken at the track. Regular classes for Flat and Steeple will begin at 1:00 PM. Race time may be altered at the Event Committee's discretion.
Judge: Karyn Pingel
Race 1 - 1:00pm or at the Event Committee's discretion
Flat Racing
Steeplechase Racing

Race 2 - Following Race 1
Time: to follow conclusion of Race 1
Aptitude Only

NOSEWORK
Time: Pre-Trials will begin at 8 AM immediately followed by Trial 1 and Trial 2 Vehicle classes.
Judge Trial 1: Nancy Anderson
Judge Trial 2: Karen Shivers
Class Order
Novice Vehicle A Trial 1
Novice Vehicle B Trial 1
Novice Vehicle A Trial 2
Novice Vehicle B Trial 2

Advanced Vehicle A Trial 1
Advanced Vehicle B Trial 1
Advanced Vehicle A Trial 2
Advanced Vehicle Trial 2

• CLASS CHANGE/CORRECTION OF ENTRY

Owners are responsible for the accuracy of information and any errors on the entry forms. There will be no refunds for invalid entries. Dogs that, according to their owners' records, have completed the requirements for a title after the closing of entries, may be moved-up from the entered class to another class for which the dog is now eligible. Requests for a move-up must be made in writing to UKC no later than one-half hour prior to the start of any regular judging at the show. All other corrections to entries must be made in writing to the Event Secretary no later than one-half hour prior to the start of any regular judging at the show.

• SUBSTITUTIONS

Dogs entered into Agility, Drag Racing, Nosework, Obedience or Rally Obedience may be substituted if the entered dog is unable to remain entered. Substitutions will only be made for the same event type and class(es) in which the original dog was entered. The substituted dog does not have to be entered into all of the classes as the original dog, however no refund will be given for classes not being substituted. (For example if the original dog was entered into AGI A for all 6 agility trials, the substituted dog may only be entered into the AGI A class for up to all six agility trials.) All substitutions must be submitted in writing with an entry change form and newly completed entry form prior to the close of Day of Show entries on the day in which the substitution will be taking effect.

• ENTRY CANCELLATION AND REFUNDS

1. Entry cancellations MUST be received in writing prior to the closing of Pre-Entries or, in the case of performance events, prior to the numerical limit for the event has been reached, and MUST include the dog's UKC number, breed and name. No cancellations will be accepted over the phone.

2. No refunds will be given for invalid entries and dogs found to have been entered in the incorrect class after the class has been judged.

3. No refund of entry fees will be made for entries cancelled after the Pre-Entry deadline, except in the cases of bitches that come into season and are entered in Agility, Obedience, Rally Obedience and/or Drag Race events or, in the case of performance events, after the numerical limit for the event has been reached. In those cases, refunds may be obtained by providing the superintendent with a veterinarian's certificate verifying that the bitch came into season after the closing date. The certificate may be mailed, provided the postmark is no later than the date prior to the day of the trial, or delivered by hand to the UKC Superintendent personnel before the start of the trial(s).

4. Cancelled entries submitted before the close of entries will be charged a \$12 processing fee for each entry/class being cancelled. No entries will be refunded after the closing date and time or after entry limits have been reached.

5. Entry fees shall not be refunded in the event that a dog is absent, disqualified, excused by Veterinarian or Judge, or barred from competition by action of the Event Committee.

6. Every effort will be made to find all duplicate entries before processing. If a duplicate entry is processed, however, no refund will be given.

7. Entry overpayments will not be refunded.

8. If, because of riots, civil disturbances, or other acts beyond the control of the host organization it is impossible to open or to complete a show or trial, no refund of entry fee will be made.

9. If, in the opinion of the host club, the well-being of dogs, exhibitors or spectators is at risk due to extreme weather conditions, such as, but not limited to rain/thunderstorms, tornados, snow storms, hurricanes, lightning, or extreme heat, the host club may cancel or stop a show or trial before completion. No refunds will be made in such cases.

• SCHEDULING CONFLICTS FOR DOGS COMPETING IN MULTIPLE EVENTS

1. Exhibitors are responsible for being available for judging at the scheduled time.

2. Every possible effort will be made to accommodate exhibitors who have dogs entered in multiple events, but judges are not required to wait for dogs. Exhibitors are advised to notify stewards in all rings affected by the conflict so that judges may more easily work around any conflicts.

3. If a performance exhibitor misses a scheduled judging time, the judge has the discretion to allow that exhibitor to run at the end of the class when possible or mark the dog absent. The Judge's decision is final.

TOTAL DOG AWARD

To be eligible for a "Total Dog" award a dog must: On Friday, October 28, 2016, win in conformation with competition and on the same day earn a qualifying score in a qualifying performance event.

Total Dog Hunting Title Bye-In!

Dogs that have earned a hunting title in any hunting event recognized by UKC on or before September 28, 2016, can enter the UKC Gateway Nationals as eligible for Total Dog. All dogs must be designated as entering Total Dog upon submission of entry into the conformation class in which the dog is eligible for on Friday, October 28, 2016.

Altered Total Dog Award!

Altered dogs are eligible to compete for an Altered Total Dog Award AT THIS EVENT ONLY! The requirements are identical to the regular Total Dog requirements except that the conformation qualifier must come from the altered conformation classes. CAOM and GAOM will be counted if applicable. All dogs must be designated as entering the Altered Total Dog competition upon submission of entry into the altered conformation class in which the dog is eligible for on Friday, October 28, 2016.



Conformation requirements

Win one of the following classes: Best Male/Female of Variety, Best Male/Female, Best of Winners, Champion, Grand Champion, Best of Breed, Group 1 through 4 (Note: Group 4 win only counts if there are five or more breeds in the Group class.), Best In Show, Best In Multi-Breed Show, Reserve Best In Show, or Reserve Best In Multi-Breed Show; with special permission from the United Kennel Club the following addition to the existing Total Dog Rules regarding conformation competition requirements for the Champion and Grand Champion classes shall apply solely on Friday, October 28, 2016.

a. Champion Classes. The following will be granted a competition win:

1. Champion Competition win with 2 or more dogs in competition.

2. Reserve Champion win with 3 or more dogs in competition.

3. Champion Award of Merit (CAOM) shall count toward competition win when computing a total dog qualifier. The number of Champion Awards of Merit to be awarded shall be calculated as follows:

- 5-9 dogs in competition – 1 CAOM
- 10-14 dogs in competition – 2 CAOM
- 15-19 dogs in competition – 3 CAOM
- 20-24 dogs in competition – 4 CAOM
- 25-29 dogs in competition – 5 CAOM
- 30-34 dogs in competition – 6 CAOM
- 35-40 dogs in competition – 7 CAOM

b. Grand Champion Classes. Grand Award of Merits (GAOM) shall count towards competition when computing a total dog qualifier. The number of Grand Awards of Merit to be awarded shall be calculated as follows:

- 3-4 dogs in competition – 1 GAOM
- 5-9 dogs in competition – 2 GAOM
- 10-14 dogs in competition – 3 GAOM
- 15-19 dogs in competition – 4 GAOM
- 20-24 dogs in competition – 5 GAOM
- 25-29 dogs in competition – 6 GAOM
- 30-34 dogs in competition – 7 GAOM
- 35-40 dogs in competition – 8 GAOM

Qualifying Performance Event Requirements: A qualifying score must be earned in any of the following; agility trial, obedience trial, rally obedience trial, drag race (Aptitude class not eligible for Total Dog), nosework (pre-trial not eligible for Total Dog) lure coursing (regular stakes only) on Friday, October 28, 2016. *Those participating in the regular stakes in lure coursing must use the appropriate Total Dog form provided by UKC. Dogs who meet the above requirements will automatically receive a special "Total Dog" award.

Total Dog Qualifiers Parade (including Altered), Total Junior Participants Parade and Announcement of Qualifiers, Total Dog Groups, Total Dog Best In Multi-Breed Show Competition and the Altered Total Dog Best In Multi-Breed Show Competition.

On Saturday, October 29, 2016, just after Saturday's Gateway National Best In Multi-Breed Show competition, the following will take place (consult the Judging Program for changes in procedure, time or location):

1. A parade of "Total Junior" participants and qualifiers (dog and handler teams) report for the parade of Total Juniors and the announcement of Total Junior Qualifiers.

2. A parade of all "Total Dog" qualifiers (including Altered) for special recognition of competition. All Total Dog Qualifiers (dog AND handlers teams) report for the parade of Total Dog Qualifiers.

3. Next, all Total Dog qualifiers will immediately compete in Total Dog Groups. The Total Dog Groups are the standard eight group designations. Each dog that qualifies will compete in the group that its breed belongs to. There will be NO ALTERED TOTAL DOG GROUP COMPETITION.

4. Then, the Total Dog Group One winners will proceed to the judging of the Gateway Nationals Total Dog Best In Multi-Breed Show competition. A 2016 Gateway Nationals Total Dog Best In Multi-Breed Show and 2016 Gateway Nationals Total Dog Reserve Best In Multi-Breed Show winners will be selected.

5. Lastly, the competition of Altered Total Dog qualifiers will compete for a 2016 Gateway Nationals Altered Total Dog Best In Multi-Breed Show and 2016 Gateway Nationals Altered Total Dog Reserve Best in Multi-Breed Show.

• TOTAL JUNIOR AWARD - CONFORMATION & PERFORMANCE

To be eligible for a "Total Junior" award a junior must:

1. Compete in a UKC Junior Showmanship Licensed class and earn a 1st-4th placement with competition, or an Award of Merit. Licensed classes include Novice Junior, Novice Senior, Open Junior and Open Senior.

2. Award of Merit for UKC Junior Showmanship classes will be calculated as follows:

*Award of Merit will only be given if the individual class meets these requirements.

- 6 Junior Handlers in competition 1 AOM
- 9 Junior Handlers in competition 2 AOM
- 12 Junior Handlers in competition 3 AOM
- 15 Junior Handlers in competition 4 AOM
- 18 Junior Handlers in competition 5 AOM
- 21 Junior Handlers in competition 6 AOM
- 24 Junior Handlers in competition 7 AOM
- 27 Junior Handlers in competition 8 AOM
- 30 Junior Handlers in competition 9 AOM
- 33 Junior Handlers in competition 10 AOM

3. The Junior must also earn a qualifying score in any one performance event on the

INDEPENDENT BREED SPECIALTIES AND PERFORMANCE EVENTS HELD IN CONJUNCTION WITH UKC GATEWAY NATIONAL

All Specialty Events and Agility Trials will be held on October 27, 2016

TEMPORARY LISTINGS WILL BE AVAILABLE (through UKC)

SPECIAL EVENTS & SPECIALTIES HELD IN CONJUNCTION WITH UKC GATEWAY NATIONAL; The following is a listing of the UKC Gateway National event and the scheduled Breed Specialty, Performance, Companion and special events that will be held in conjunction with the UKC Gateway National.

ALASKAN KLEE KAI ASSOCIATION OF AMERICA

Northern Group Specialty – ALT offered
Oct 27; Gary Richards
NLC: Novice Puppy, Veteran, Brace
Entries: 12 noon-1 pm
Show: to follow the Companion Group Specialty
DOS \$25; NLC \$5; PE \$20; Multiple Dog Entry discount \$15/dog if 6 or more dogs entered at same time received by October 20, 2016
Make fees payable to the Alaskan Klee Kai Association of America
Chairperson: Susan Cain (412) 720-9332
skylineakks@aol.com
Event Secretary: Sheila Sweet, PO box 66, Haworth OK 74740 (580) 612-5061
shyyfox84@gmail.com

MID-LAKES AUSTRALIAN SHEPHERD CLUB - INSIDE

National Australian Shepherd Specialty – ALT offered
Oct 27; S1 Tina Lass
Junior Showmanship (Junior Handlers are limited to showing ONLY Australian Shepherds)
NLC: Novice Puppy, Veteran
Entries: 12 noon-1 pm
Show: 1:30 pm
DOS \$25; JS & NLC \$8; PE \$20 received by October 17, 2016
Make fees payable to the Mid-Lakes Australian Shepherd Club
Find us on Facebook – Mid Lakes Australian Shepherd Club
Chairperson: Gary Oliver
Event Secretary: Jeanne Heger, 518 Rt 31 #101, McHenry IL 60050 (847) 638-6716
nationalasc@aol.com
PE fee adjustment posted 7/25/16

MID-LAKES AUSTRALIAN SHEPHERD CLUB - INSIDE

Herding Group Specialty – ALT offered
Oct 27; S2 Karen Cattin
NLC: Novice Puppy, Veteran
Entries: 12 noon-1 pm
Show: to follow the Australian Shepherd National event

DOS \$25; NLC \$8; PE \$20 received by October 17, 2016
Make fees payable to the Mid-Lakes Australian Shepherd Club
Find us on Facebook – Mid Lakes Australian Shepherd Club
Chairperson: Gary Oliver
Event Secretary: Jeanne Heger, 518 Rt 31 #101, McHenry IL 60050 (847) 638-6716
nationalasc@aol.com

NATIONAL TOY FOX TERRIER ASSOCIATION - INSIDE

National Toy Fox Terrier Specialty– ALT offered
Oct 27; Carlos Rodriguez
NLC: Novice Puppy, Stud Dog, Brood Bitch, Veteran, Brace, Special Exhibition (Parade of Champions)
Entries: 12 noon-1 pm
Show: 1:30 pm
DOS \$25; NLC \$8; PE \$20 received by October 20, 2016
Make fees payable to the National Toy Fox Terrier Association
www.nationaltoyfoxterrier.org
Chairperson: Kelley Maldon (770) 479-6053
maldonfox@windstream.net
Event Secretary: Lila Fast (replacing Kim Egan), PO Box 433, Knoxville IA 50138-3206 (641) 842-4842 or (641) 891-4083
lilafast@yahoo.com
ES change posted 7/15/16

UNITED BERGER PICARD ALLIANCE - INSIDE

Berger Picard Specialty – ALT offered
Oct 27; Tina Camp
NLC: Novice Puppy, Stud Dog, Brood Bitch, Veteran
Entries: 12 noon-1 pm
Show: 1:30 pm
DOS \$25; NLC \$5; PE \$20 received by October 17, 2016
Make fees payable to the United Berger Picard Alliance
www.unitedbergerpicardalliance.com
Chairperson: Sloan Cannon info@ideasofmarchpicards.com
Event Secretary: Jennifer Cannon, 7789 Rinehart Lane, Clemmons NC 27012 (336) 618-1261
jcannon@ideasofmarchpicards.com

UNITED GERMAN SHORHAIRD POINTER CLUB - INSIDE

Gun Dog Group Specialty - ALT offered
Oct 27; William Hossler
NLC: Novice Puppy, Veteran

Entries: 12 noon-1 pm
Show: 1:30 pm
DOS \$25; NLC \$10; PE \$20 received by October 21, 2016
Chairperson: Beverly Quarles (512) 695-1699
gsptx@sbcglobal.net
Event Secretary: Christie Ogdome-Dalman, 1407 N Mars ST, Wichita KS 67212 (913) 210-9138
spiritwhsper@gmail.com

UNITED GREYHOUND CLUB - INSIDE

Sighthound & Pariah Dog Group with Italian Greyhound / Greyhound Specialty)
See Lure Coursing below
Oct 27; S1 TBA SIGHT IG
NLC: Novice Puppy, Veteran, Special Exhibition (Coursing CH earned through UKC, AKC, ASFA or ISWS FCH)
Oct 27; S2 TBA GH
NLC: Novice Puppy, Stud Dog, Brood Bitch, Veteran, Brace, Special Exhibition (Coursing CH earned through UKC, AKC, ASFA or ISWS FCH)
Entries: 12 noon-1 pm
Show 1: 1:30 pm
Show 2: to follow S1
DOS \$25; NLC \$10; PE \$20 received by Oct 19, 2016
Chairperson: Dave McMahan (519) 458-8181
sirius-supply@sympatico.ca
Event Secretary: Leslie Reeve, 8402 Washington Blvd, Indianapolis IN 46240 (317) 253-2163
leslie.reeve@att.net

UNITED LCLD CLUB - INSIDE

Louisiana Catahoula Leopard Dog Specialty – ALT offered
SPOT TESTING OFFERED
Oct 27; Diana Allen
NLC: Novice Puppy, Veteran, Special Exhibition (OFA Certified)
Entries: 12 noon-1 pm
Show: 1:30 pm
DOS \$25; NLC \$10; PE \$18, ULCLDC Members \$15 received by October 21, 2016
Make fees payable to the United LCLD Club
Chairperson: Lavonne Mullens Thoming (530) 742-7944
Event Secretary: Casey Hogestyn, 1635 E Lisbon, Kendallville IN 46755 (260) 318-5123
crfick03@hotmail.com

UNITED POMERANIAN ASSOCIATION - INSIDE

Companion Group Specialty – ALT offered
Oct 27; Gary Richards
NLC: Novice Puppy, Veteran
Entries: 12 noon-1 pm

Show: 2 pm
DOS \$25; NLC \$8; PE \$20 received by October 17, 2016
Make fees payable to the United Pomeranian Association
Chairperson: Gary Oliver
Event Secretary: Jeanne Heger, 518 Rt 31 #101, McHenry IL 60050 (847) 638-6716

PERFORMANCE EVENTS HELD IN CONJUNCTION WITH GATEWAY NATIONAL EVENT

AGILITY ABILITY OF GREATER KANSAS - INSIDE

Agility Trials
Oct 27; T1 Beverly Benjes
Oct 27; T2 Beverly Benjes
Entries: 10-12 noon
Trials start at 1 pm
DOS \$20, \$15 additional runs same dog/same trial; Junior Handler \$10; PE \$18, \$13 additional runs same dog/same trial received by October 19, 2016
Chairperson: Debi McCarty (816) 678-2836
keeshondagility@sbcglobal.net
Event Secretary: Ann Adams, 2035 S. 34th St, Kansas City KS 66106 (913) 530-9954
annadams29@gmail.com

UNITED GREYHOUND CLUB

Lure Coursing Meet
See Conformation event above
Oct 28; T1 Heather Minnich CA Entries 9-10 am Meet 10 am; Lee Warden (Heather Minnich backup) CT RS Entries 9-10 am Meet 10 am
Oct 28; T2 Heather Minnich CA Entries 9-10 am Meet 10 am
Oct 29; T1 Lee Warden CA Entries 9-10 am Meet 10 am; Heather Minnich (Lee Warden backup) CT RS Entries 9-10 am Meet 10 am
Oct 29; T2 Lee Warden CA Entries 9-10 am Meet 10 am
Oct 30; T1 Heather Minnich CA Entries 9-10 am Meet 10 am; Lee Warden (Heather Minnich backup) CT RS Entries 9-10 am Meet 10 am
Oct 30; T2 Heather Minnich CA Entries 9-10 am Meet 10 am
DOS \$25; PE \$20 received by October 19, 2016
Chairperson: Dave McMahan (519) 458-8181
sirius-supply@sympatico.ca
Event Secretary: Leslie Reeve, 8402 Washington Blvd, Indianapolis IN 46240 (317) 253-2163
leslie.reeve@att.net

SPECIALTY SCHEDULE Thursday, October 27, 2016

RING 1
SHOW TIME 1:30 P.M.
Mid-Lakes Australian Shepherd Club
Australian Shepherd National Specialty
Judge: Tina Lass

Mid-Lakes Australian Shepherd Club
Herding Group Specialty
Judge: Karen Cattin

RING 2
SHOW TIME 1:30 P.M.
National Toy Fox Terrier Association
Toy Fox Terrier Specialty
Judge: Carlos Rodriguez

RING 3
SHOW TIME 2 P.M.
United Pomeranian Association
Companion Group Specialty
Judge: Gary Richards

Alaskan Klee Kia Association of America
Northern Breeds Group Specialty
Judge: Gary Richards

RING 4
SHOW TIME 1:30 P.M.
United Berger Picard Alliance
Berger Picard Specialty
Judge: Tina Camp

RING 6
SHOW TIME 1:30 P.M.
United LCLD Club
Louisiana Catahoula Leopard Dog Specialty
Judge: Diana Allen

RING 7
SHOW TIME 1:30 P.M.
United German Shorthaired Pointer Club
Gun Dog Group Specialty
Judge: William Hossler

United Greyhound Club
Sighthound & Pariah Dog Group & Italian Greyhound Specialty and Greyhound Specialty
Ring Assignment and Times to be determined
Judges to be announced

List of PRIZES from Purina In addition to UKC trophies and rosettes

May be subject to change at the discretion of Purina

NUTRITION THAT PERFORMS™

Friday, October 28, 2016

Best in Multi-Breed Show

Two (2) large bags of any Purina dog food offered by Purina

Reserve Best in Multi-Breed Show

Purina Pro Plan Garment Bag offered by Purina

Group First Winners

Purina Pro Plan Barrel Bag offered by Purina

Altered Best In Multi-Breed Show

Purina Pro Plan Duffle Bag offered by Purina

Altered Reserve Best In Multi-Breed Show

Purina Pro Plan Garment Bag offered by Purina

Altered Group First Winner

Purina Pro Plan Barrel Bag offered by Purina

Best of Breed Winners

Purina Pro Plan Towel offered by Purina

Altered Best of Breed Winners

Purina Pro Plan Towel offered by Purina

High in Trial – Agility, Obedience, Rally Obedience, Nosework

Purina Pro Plan Trunk Organizer offered by Purina

Best Junior Handler – Agility, Conformation, Obedience, Rally Obedience, Nosework

Purina Pro Plan Grooming Apron offered by Purina

Each Junior Entry

Purina Pro Plan Slip Lead offered by Purina

Drag Racing

Under 10"

Purina Pro Plan Small Towel offered by Purina

Over 10" to 12 ½"

Purina Pro Plan Small Towel offered by Purina

Over 12 ½" to 15"

Purina Pro Plan Small Towel offered by Purina

Over 15"-18"

Purina Pro Plan Small Towel offered by Purina

Steeplechase Racing, Fastest Under 10"

Purina Pro Plan Small Towel offered by Purina

Steeplechase Racing, Fastest Over 10" to 12 ½ "

Purina Pro Plan Small Towel offered by Purina

Steeplechase Racing, Fastest Over 12 ½" to 15"

Purina Pro Plan Small Towel offered by Purina

Steeplechase Racing, Fastest Over 15"-18"

Purina Pro Plan Small Towel offered by Purina

Saturday, October 29, 2016

Best in Multi-Breed Show

Two (2) large bags of any Purina dog food offered by Purina

Reserve Best in Multi-Breed Show

One (1) large bag of any Purina dog food offered by Purina

Group First Winners

Purina Pro Plan Blanket offered by Purina

Altered Best In Multi-Breed Show

Purina Pro Plan Duffle Bag offered by Purina

Altered Reserve Best In Multi-Breed Show

Purina Pro Plan Umbrella offered by Purina

Altered Group First Winner

Purina Pro Plan Blanket offered by Purina

Total Dog Best In Show

Two (2) large bags of any Purina dog food offered by Purina

Altered Total Dog Best In Show

Purina Pro Plan Duffle Bag offered by Purina

Best Male/Best Female Class Winners

Purina Pro Plan Spray bottle offered by Purina

Altered Best Male/Best Female Class Winners

Purina Pro Plan Spray bottle offered by Purina

High in Trial – Agility, Obedience, Rally Obedience, Nosework

Purina Pro Plan Large Thermal Tote offered by Purina

Best Junior Handler – Agility, Conformation, Obedience, Rally Obedience, Nosework

Purina Pro Plan Grooming Towel offered by Purina

Total Junior Qualifier

Purina Pro Plan Duffle Bag offered by Purina

Each Junior Entry

Purina Pro Plan Slip Lead offered by Purina

Drag Racing

Under 10"

Purina Pro Plan Small Towel offered by Purina

Over 10" to 12 ½"

Purina Pro Plan Small Towel offered by Purina

Over 12 ½" to 15"

Purina Pro Plan Small Towel offered by Purina

Over 15"-18"

Purina Pro Plan Small Towel offered by Purina

Steeplechase Racing, Fastest Under 10"

Purina Pro Plan Small Towel offered by Purina

Steeplechase Racing, Fastest Over 10" to 12 ½ "

Purina Pro Plan Small Towel offered by Purina

Steeplechase Racing, Fastest Over 12 ½" to 15"

Purina Pro Plan Small Towel offered by Purina

Steeplechase Racing, Fastest Over 15"-18"

Purina Pro Plan Small Towel offered by Purina

Sunday, October 30, 2016

Best in Multi-Breed Show

Purina Pro Plan Best In Show Grooming Bag offered by Purina

Reserve Best in Multi-Breed Show

Purina Pro Plan Duffle Bag offered by Purina

Group First Winners

Purina Pro Plan Trunk Organizer offered by Purina

Altered Best in Multi-Breed Show

Purina Pro Plan Duffle Bag offered by Purina

Altered Reserve Multi-Breed Best in Show

Purina Pro Plan Garment Bag offered by Purina

Altered Group First Winners

Purina Pro Plan Trunk Organizer offered by Purina

Champion and Grand Champion Class Winners

Purina Pro Plan Small Thermal Sack offered by Purina

Altered Champion and Grand Champion Class Winners

Purina Pro Plan Small Thermal Sack offered by Purina

High in Trial – Agility, Obedience, Rally Obedience, Nosework

Purina Pro Plan Barrel Bag offered by Purina

Best Junior Handler – Agility, Conformation, Obedience, Rally Obedience, Nosework

Purina Pro Plan Grooming Apron offered by Purina

Each Junior Entry

Purina Pro Plan Slip Lead offered by Purina

Drag Racing

Under 10"

Purina Pro Plan Small Towel offered by Purina

Over 10" to 12 ½"

Purina Pro Plan Small Towel offered by Purina

Over 12 ½" to 15"

Purina Pro Plan Small Towel offered by Purina

Over 15"-18"

Purina Pro Plan Small Towel offered by Purina

Steeplechase Racing, Fastest Under 10"

Purina Pro Plan Small Towel offered by Purina

Steeplechase Racing, Fastest Over 10" to 12 ½ "

Purina Pro Plan Small Towel offered by Purina

Steeplechase Racing, Fastest Over 12 ½" to 15"

Purina Pro Plan Small Towel offered by Purina

Steeplechase Racing, Fastest Over 15"-18"

Purina Pro Plan Small Towel offered by Purina

All awards, if not presented in the ring, must be picked up during the event at the Pro Plan booth. Presentation of the winning ribbon is required. Pro Plan reserves the right to make award substitutions of equal or greater value if listed award is not available.



Feed *your* breed.

Feeding Purina® supports the
future of your breed.

*F*eeding high-quality nutrition every day can help support a strong, healthy future not only for your dogs, but for your entire breed. As a Purina® Pro Club® member, each time you send in weight circles for participating Purina brand dog foods, Purina will donate 10% of the

value to help the future of your breed. Since 2002, the Purina Parent Club Partnership program has raised more than \$5 million to support canine health research, education and rescue efforts.

Learn more at purinaproclub.com/ppcp



 **PURINA®**
Parent Club
PARTNERSHIP