

2014 Donors

Thank you to our donors!
Complete list inside.



Newsletter



Building Tomorrow:
fundraising for the future.

Bethany Life Foundation

Making History in a Historic Time



2014 was a remarkable year for Bethany Life and our Foundation. We celebrated our centennial through honoring our traditions and heritage. We invested significant

resources in strengthening our ministry for those we serve today. We took bold moves to prepare for the future. The friends of our organization partnered with us in 2014 through their gifts to the Bethany Life Foundation and they did it in a big way.

The Bethany Life Foundation made history in 2014 by receiving the largest amount of annual funding since its inception. The funds received in 2014

totaled \$744,546.68. These funds came from individuals, businesses, churches, estates, grants, sales at Affordables, volunteers, civic groups and more. This funding supported everything from our Chaplaincy services to our Building Tomorrow Campaign, to scholarships and appreciation events for our staff, to medical equipment and to the support of our pets.

This newsletter recognizes those who supported our Foundation in making history in a historic time. We cannot say thank you enough. We are so grateful and honored to know that we are a ministry that is worthy of your support.

Larry Elphic

VP Resource Development



Foundation Friend of the Year
Carl Hermanson 2014.



Olive Sampson and family celebrate the dedication of Sampson Court with a ribbon cutting.



Bethany Manor North Wing was renamed Christy Place in honor of Dorothy Christy and the late Jim Christy.

Inside the Foundation

Foundation Board Members

Bonnie Hunziker, President Ames
Pr. Jim Norem Randall
Al Holm Story City
Sally Greenfield Kamrar

Claudia Pauk, Vice President Story City
Dave Quam Story City
Scott Saienga Ames
Jane Jackson Story City

Our Mission

Bethany Life's mission is to help elders thrive in their life journey, living in a Christian environment of hope and compassion.

Our Vision

Bethany Life will become a regionally recognized resource for comprehensive and innovative aging services.

Our Values

Benevolence, Stewardship, Personal Growth, Innovation, Teamwork, & Relationships.



Bethany Life
Helping older adults thrive

Thanks to our Donors

Humanitarian

\$5000+

Robert & Carolyn Ahlstrom
David & Susan Amensen
BLF AFFORDABLES
Harold Bolstad Estate
Carl E. Hermanson
Eudene & Nancy Lund
Sharron Martin
Douglas & Mary
Mechaelen
Roger & Lois Oakland
Christine Sampson Estate
Corwin & Kay Stephan
Rozella Tressler
Tom & Stevie Walsh

Benefactor

\$2500 - \$4999

Bethany Life
Bethany Life Volunteers
Raymond & Lois Danielson
Alan & Karen Hermanson
Immanuel Lutheran Church
Delores Larson
Northeastern Iowa Synod-
ECLA
Peterson's Paint & Floors,
Inc.
Jay & Betsy Warburton

Leadership

\$1000 - \$2499

Anonymous
Paul & Ann Barkema
Bergen Lutheran Church
Keith & Elaine Christian
Dorothy Christy
Elim Lutheran Church
Glen Eglund
Larry & Kathaleen Elphic
Gilbert Lutheran Church
Haila Architecture
Structure Planning
Michael & Kimberly
Hermanson
Peter & Janet Hermanson
Gary & Judy Hested
Allen & Wanda Holm
Roy & Patricia Hougen
Pr. Tom & Sandy Hunt
Jon & Bonnie Hunziker
Kari & Mike Matheason
Silvera Meimann
Paul & Claudia Pauk
Carmen Peter
Dave & Kathy Quam

Scott & Vicki Saienga
William & Susan Sandve
Eunice Sansgaard
Beth Shields
St. Petri Lutheran Church
Robert & Rosemary Taylor
Ann Thompson
Clarion & Doradene
Thompson
Elsa Thompson
Thrivent Financial for
Lutherans
Trinity Lutheran Church

Stewardship

\$500 - \$999

Ackley State Bank
American Packaging Flexo
Division
MB Enterprises of Ames
Brian & Elaine Anderson
Pr. Stephen & Ch. Sandra
Anenson
Exchange State Bank
Reliance State Bank
Bethany Lutheran Church,
Kelley
Bethesda Lutheran Church,
Ames
Bethlehem Lutheran
Church
Austin & Tarra Carlson
Anna Christensen
Danfoss
DDM Electric
David & Doris Fausch
Fjeldberg Lutheran Church
Health Care Services
Group, Inc
Robert & Maripat Higgins
James Lewis & Buel Hogan-
Lewis
IBM International
Foundation
IMT Insurance Company
Pr. Glenn & Mary
Kappelmann
Howard & Barb Larson
Lee Agency, Inc.
Trinity Women of the
NALC
David Nerdig
Larry & Carole Otteman
Jerry & Ann Pearson
PDG Printing
Frankie Romsey
Jeffrey Russel

Ryun, Givens & Co., P.L.C.
Mary Ann Sandvold
Milton & Gloria Severson
Beth Shields
Soderstrum Funeral Homes
St. Andrew's Lutheran
Church
Shirley Stakey
Story Construction
Company
Connie & Tom Sweeney
David & Donna Teigland
Jim & Amy Twetten
Paul Vandenbosch

Friend of Bethany

\$100 - \$499

ACT Insurance Agency
James & Cathryn
Ahrenholz
Andrew & Barbara Alfseike
Dennis & Anne Alvestad
Ralph & Irene Alvestad
American Business Phones
Dianne Amme
Carroll & Laurine
Anderson
Gary & Dee Anderson
Bill & Dorothy Appelgate
Rick Arnold
Cheryl Baker
William Bathie
Greg A. & Rosemary L.
Bennett
Pr. Donald & Barbara Berg
Bergen Lutheran Church-
WELCA
Bethany Lutheran Church
Bethel Lutheran Church
Bethesda Lutheran Church,
Jewell
Michelle & Nathan Bilyeu
JoAnn Boehmer & April
Katz
Mary & Kenneth Brown
Fred & Barbara Brown
Thompson Auto Care Inc.
Gary Carpenter
Linda Christensen
Kenwood & Teresa
Christian
Jon A. & Janeen M. Christy
Gary & Diane Clark
Jim & Janine Clark
Gary & Sue Clem
Garold & Shirley Colston
Combustion Control Co.

Royce & Mimi Cornwell
Megan E. Couch
Zada Danielson
M.H. Eby Inc.
Dorothy & Donald Ehm
Van Wall Equipment
M June Anderson Estate
JRK Investments, LLC
Pat Fawcett
Dwayne & DeEtta Fiilhr
Flora Freeland Trust
Esther Frandsen
Eugene & Florence Furman
Ruth Gabrielson
Gary Thompson Oil
Company
Gookin Ford
Henry & Janet Gray
Great Western Bank
Mark & Pam Greiner
Gene & Jill Grimsley
Hammer Incorporated
Theodore & Terri Hammes
Lavina Hanson
Todd Hanson
Jan & Sharon Haugen
Mark & Karen Haugland
Mike & Ann Healy
Neva Henderson
Colleen Henryson
Stephen & Becky
Hermanson
Janice Hetland
Burnell Hill
Phyllis Hill
Nancy & Gary Holcomb
Holmes Murphy &
Associates Inc
Joel & Lisa Hovick
Mary & Arthur Hovick
Scott & Judith Huebsch
Ideacom Mid America
Indoshell Precision
Technologies, LLC
Beth Isvik
Jane L. Jackson
Lorraine Jacobson
Karel S. Johnson
Joanne Johnson
Thomas Johnson
Aaron & Kathy Keller
Thomas & Adel Kessler
Kiwanis Club of Roland
Barbara Klein
Gerald & Eileen Klonglan
Joyce Knutson
Esther Kuhn

Warren B. Kuhn
Ronald Kurtz
Continental Wholesale,
LLC
Golden Valley Hardscapes
LLC
Timothy Labella
Ilene Lage
Steve & Deb Lage
Jeanette Larson
Margaret Larson
Ona Mae Lettow
Theo & Christine Leverenz
Randel & Elizabeth Lewis
Jerry & Janice Lewis
Brad Liggett
Peter & Mary Limas
Robert C. & Kathleen M.
Maegerlein
Manatts, Inc.
Doris Mathre
Margie & Mike McCoy
Judy McDonald
Tom & Judy McDonald
Dr. Carol Meldman
Meredith Corporation
Foundation
Kermit Miskell
Robert J. Moratz DPM, PC
Elaine Munson
David & Candy Nelsen
Paul Nelsen
Suzanne K. Nelson
Margaret Nordmann
Pr. Jim & Linda Norem
Norsemen Realty
David & Deborah O'Neill
Oakland Corporation
Merlyn Okland
Mildred Olson
Peter Orazem
Curtiss Ostrem
Brekken, Wynia, & Hyland
Palestine Lutheran Church
Donald & Janet Payer
Lisa Pechan
Jerome & Ruth Peltier
Pete Tekippe Photography
Charles J Petersen
Michael & Marianne
Petersen
NuCara Pharmacy
Gregory J & Caroline
Phillips
Elizabeth & Roger Porter
David & Donna Pribyl
J.C. Purdy

Record Printing Co.
Don Rhead
Russell & Idella Richardson
Harold & Julia Ridpath
Don & Cathy Rimathe
Gerald & Gladys Risdal
Donald & Roxana
Robertson
Bryan Rohs
Pr. Conrad & Mary Rolland
Motor Roost
Scott & Carrie Russel
Ryan Funeral Home
Salem Lutheran Church
Everett & Patricia Sather
Patricia Schaefer
Candy L. Schainker
Lynn & Janice Schulte
Sandy Searl
Evvie Severeide
Laura Severson
Tamra Shadlow
R.E. & C. A. Shafer
Emmy Shakeshaft
A. James & Jo M. Shold
Tim & Linda Shuck
Greg & Patricia Sindt
Roger & Marilyn Skromme
June Sondall
Stan & Jane Sondoll
James & Lisa Sorenson
Donna Starck
Martha Stebelton
Gail Steffen
W. Robert Stephenson
Bradley & Leslie Stewart
Story City Building
Products, Co.
Marie Stupp
Neal Sturtz
Sinold Swenson
Junior Thrasher
LaVon Titus
Arlotte Tjernagel
Marilyn Hanson & Ted
Tostlebe
True Value Hardware
Jerry & Barbara Twedt
Paul & Sharon Twedt
Harris "Pete" & Viola
Twedt, Jr.
James & Susan Twedt
Jo & Al Twedt
Stephen & Naomi Tweet
Gail Vasily
Fred & Linda Vogtlin
Mike Wahlin

Bradley & Karen Waline
Christina Walsh
Webster City RV Inc. &
Story City RV
Duane & Shirley Wheeler
Robert & Sherilyn Witowski
Zion Lutheran Church

Supporter

\$1-\$99

Gary & Kathryn Aitchison
Craig & Barbara Alcott
Greg & Laura Allen
Terence and Susan Amann
Carroll Anderson
Darrell & Deb Anderson
Amy & Brian Argo
Roger & Charlotte Auestad
Dennis & Kimberly Auld
Joan Baird
Lorraine Bakke
Dr. Louis & Pat Banitt
Glen & Ila Barrington
David & Natalie Bass
Bernice Becker
Alan & Patsy Beese
Sharman Beeson
James & Helen Bergeson
Marianne Berhow
Mary Lou Berhow
David & Margaret Berve
Robert & Kathleen Best
Michael & Kay Billings
Cindy Blomberg
Shirley Bolton
Deloris Bozoian
Donnie & Cathy Braathun
Ethyleen Braathun
Marvin & Sue Braland
Kurt & Diane Brattain
Larry & Jean Bremer
Elaine Brown
Ruby Costello Buck
J. Ben & Sarah Buck
William & Donna Busch
Neil & Suzanne Calhoun
Barb Campbell
William & Winnie Carson
Ronald Chelsvig
David Christen
Jean M. Christen
Sally Christenson
Mardell Christian
Nancy Clark
Richard Clinard
John W. & Nancy E. Clough
Don Cochran

Steve Cochran
Eugene & Joan Colhoun
Susan Collison
R & C Colwell
Ralph & Diana Cox
Jim Cue
James & Marjorie Dale
Joel & Mary Danielson
Shannon Danner
Robert & Joyce Davis
Steven & Linda Disbrowe
William Dodds
Mark Donhowe
Betty Donnelly
Cheryl Eddy
Orlene & Judy Egeland
Ken & Gloria Egertson
Joan Eglund
Jean Ellingson
Phillip & Carolyn Ellingson
Larry & Jean Engelson
George & Mary Engstrom
Susanne & Daniel Erdahl
Arlen & Eloise Ericson
Alison Eschen
Mary Cristine Eyanson
Alyce & Glenn Fanslow
Myrtle Fauerby
Emily & Charles Feldmann
Robert & Barbara
Folkmann
Karen Forsling
Mary Etta Fothergill
Jack & Lavonne Frandsen
Mrs. Harold (Leah)
Frandsen
Charles & Patricia Frandsen
Dennis & Janice Freeman
Jim Freerks
Monica Friedman
Steven & DeAnn Frisk
Verlyn & Barb Frohling
Devin & Kristine Fuhrman
Norma Gandrup
Ron & Helen Gates
Garry & Brandi Gerjets
Robert & Marlene Gernes
Wendell & Linda Graber
Gary & Olivia Griggs
Linda Grimm
Ruth Grimsley
Renaissance Insurance
Group
Teresa Haaland
John & Nancy Halleland
David & Joyce Hansen
Orlin & Marilyn Hanson

Steve & Mary Hanson
Myrtle Harper
Henry & Dorothy Hayes
Merlyn & Carol Hegland
Phil & Jane Heinlen
Tom & Barbara Helgeson
Jeffrey & Kristine Helms
Dallas & Donna Henderson
Rosemary Hennessy
Mark & Cathy Hermanson
Hilda Perez & Carolyn
Lincoln
Charlotte Hill
Glenn & Dr. Arnhild
Hillesland
William & Jane Hobbs
Geneva H. Hodnefield
Jim Hoekstra
Mary Honsinger
Hook & Eye Questers
Susan Hoshor
Gary & Roxie Hove
Andy & Kris Hunter
Joseph & Becky Iman
Mary Imsland
GLT Investments
Floyd & Shirley Isebrands
Brad & Karin Jacobson
Greg & Sandra Jacobson
Kirk & Judy Jacobson
Mervin & Ilene Jennings
Jewell United Church
of Christ- Women's
Fellowship
Virgetta Johnson
Ardis & Helen Johnson
Curtis & Twila Johnson
Marlys J. Johnson
Loren & Joyce Jondall
Roger & Linda Jurney
Norman & Dorene
Kammin
Christopher & Lisa Kayser
Carole Davis Kazmierski
Rupert & Carmen Kenyon
Danny & Susan Kepley
Harvey & Shirley Kimble
Joann Kinyon
Richard & Nancy Klodt
Sterling & Garnet Knutson
Raymond & Georgiann
Koeder
Joel & Cindy Kruckenberg
Judith Kuhn
Rick & Nancy Landt
J.A. & Debra Landuyt
John & Laurie Larsen

Fred Larson
Sharon Lawrence
Christopher & Carol
LeForge
Idalice J. Lee
Virginia Lee
Marilyn Lekwa
Tony & Janet Lindseth
Laura Lovan
Ronald & Ann Lovig
Sigfrid Lybeck
George & Delores Mackey
Stephen & Mary Mahoney
Thomas & Susan Major
Cheryl & David Martin
Charles & Ruby Matheason
Barbara Mathias
Dennis & Karen Mathiason
Gordon & Marilyn
McConnell
Gary & Ruth McCoy
Walter & Christine
McDonald
Chris & Lisa McIlrath
Craig & Cathy Meimann
Patricia A. Melchert
Lynne Melssen
Leonard & Jo Ann Michel
Patricia Miller
Rachel Thorson Mithelman
Roger & Debra Moore
Sharon Jo Morrival
Wendell & Marilyn
Mortvedt
Donald & Eleanor Munsen
Richard & Katherine
Munsen
Mary Lou Murray
John & Patti Nervig
Alma O'Donnell
Don & Zola Obe
Melvin Oberhokamp
Robert & Mary Olthoff
Michael & Kathleen Ose
Mark Osheim
Marcie Osmundson
Sondra Oswald
Allan L. & Patricia A.
Pearson
Keith T. & Miriam R.
Pedersen
Melvin & Dorothy Peter

Jerold & Joyce Peterson
Matthew Peterson
John Pfeffer
Mary Phillips
Mary Phillips
Nancy Pilcher
Rod & Ingrid Place
Ruth Seiser Poland
Dennis & Colleen Posegate
Birdelle Post
Marvin & Myrtle Post
Pr. Tom & Sharon
Prochnow
Darlene Quam
Ron & Glenda Rahfeldt
Rex & Janet Ramsay
Howard & Naomi Reisetter
Larry & Denice Reisetter
Linn Reisetter
Daniel & Janet Richardson
Ronald & Sandra Risdal
Suzanne Rock
Juanita Rogers
David Rolf
Irving & Mary Rosheim
Phil & Carolyn Ross
Sharon Rowe
James & Katny Rudin
Dale & Cynthia Ruigh
Opal & Robert Saddoris
Alan & Paula Sampson
Elizabeth Sampson
Owen & Gloria Sampson
Ernest Sansgaard
Donald & Diane Schaffer
Matthew & Carol Scheiber
Phil & Barbara Schendel
Bernard & Ingeborg Schey
Bob & Dorothy Schumer
Julie Schwery
Regina & Patrick Scott
Arlene Sealine
David & Lisa Seufferer
Laverne & Mary Severseike
Karen Seymour
Myrle Shaw
Bill & Linda Shickell
Steven & Mary Ann
Simpson
Vicki V. Sivesind
Kent & Mary Beth Sneller
Betty Snider
Steven & Peggy Sorensen

G.Ruth Springer
St. Paul Lutheran Church,
Jewell
Dr. Arthur and Jayne
Staniforth
Dennis & Roxanne Steding
Ronald (Red) & Marilyn
Stenberg
Ruth & Dale Stevens
Duane & Marty Swanson
Mark D. & Janelle Swenson
Stanley & JoAnn Swenson
Sandra R. Sydnes
Larry & Barb Taylor
Frank & Joanne Tedesco
Beverly Thompson
Ken & Gwen Thompson
Eloise Thorson
Doris Tjernagel
William & Helen Tjernagel
Mary Tomlinson
Karene Topp
Mary Treimer
Janet Tunesvick
Alice R. Twedt
Arlen & Asta Twedt
Loren & Solvey Twedt
Gene & Betty Upstill
Paul & Vera Anne Valde
Ruth D. Valen
Larry Varland
Lois Varland
Gregory Viers
Thomas & Gayle Vogel
Adeline Vogtline
Bernice Voldness
Mr. & Mrs. Robert Wailes
Dennis & Lois Warme
Steve Waugh
Ernest & Cheryl
Weatherington
Paul & Anna Weber
Ruth Weber
Deborah Wegener
Tom & Norma Wessling
Gary & Gail Wierson
Paul Wierson
Wallace Wierson
Neil & Brenda Wilkinson
Lee & Laura Wille
Red's World
Terry & Dianne Wycoff
Lowell & M. Louise Yager

Thank you for your never ending support!

Building Tomorrow Campaign

The **Building Tomorrow** Campaign goal has been increased from \$750,000 to \$1M and our Foundation is excited to meet this new challenge. With the initial goal of \$750,000 soon to be realized; it became apparent that we can do more! These additional funds will allow for the creation of two new terrace areas which were in the original design, but were put on hold due to fiscal restraints. We now have the opportunity to make these outdoor spaces a reality! Over 60 residents will soon have easy access to the great outdoors to enjoy! The generosity of our friends has made this opportunity a reality. **What a blessing!**

\$1,000,000

\$651,500

as of December 31, 2014

In 2014 our Foundation received designated gifts to the **Building Tomorrow** Campaign which have ranged from \$10 to \$50,000. The Foundation has granted \$500,000 to date for this initiative. We have received gifts from all over the country; from grateful family members, churches, employees, board members, businesses, estate gifts and our thrift store - Affordables. **Every gift has made a difference.**

2015 will be a critical time in meeting the **Building Tomorrow** challenge. We must be assured that the additional funds can be raised in order to move forward with this additional construction. Please make a pledge to the **Building Tomorrow** Campaign that you can fulfill in 2015. The impact of your gift is immeasurable.

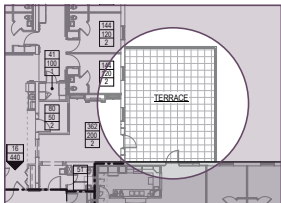

Let's give those we serve at Bethany Manor beautiful outdoor spaces to call their own. We all need one.



The Building Tomorrow campaign received a generous gift at the Visionary Level, from the Christine Sampson (pictured left) Estate.



The Sterling and Arleen Lund Memorial Library will be dedicated at the completion of the **Building Tomorrow** Campaign in recognition of a generous gift received by their family. Pictured: Nancy Lund, Eudene Lund, Douglas Mechaelson, Betsy Warburton (CEO), Melissa Hall, Mary Mechaelson.



Dignitaries breaking ground for **Building Tomorrow** Campaign.

Celebrating our Past, Believing in our Future

Building TOMORROW

Campaign Gifting Levels

- | | |
|-----------------------|---------------------|
| Visionary — \$100,000 | Journeyman — \$2500 |
| Designer — \$25,000 | Artisan — \$1000 |
| Contractor — \$10,000 | Apprentice — \$500 |
| Foreman — \$5000 | Worker — \$100 |

We will contact you to discuss recognition opportunities!

Donor(s) _____

Address _____

Phone _____

Please make my gift in honor/memory of: _____

Pledge amount: \$ _____ over two years.

Immediate gift: \$ _____

Use your credit card by going to bethanylife.org/give

Bethany Manor
212 Lafayette Avenue
Story City, Iowa 50248
515.733.4325
Fax: 515.733.5293



Cedar Place
812 Cedar Street
Story City, Iowa 50248
515.733.2904
Fax: 515.733.6111

Timberland Village
725 Timberland Drive
Story City, Iowa 50248
515.733.6500
Fax: 515.733.9376

Bethany Life Foundation
212 Lafayette Avenue
Story City, Iowa 50248
515.733.4325
Fax: 515.733.5293

Affordables Thrift Store
630 Pennsylvania Avenue
Story City, Iowa 50248
515.733.5304

Website: www.bethanylife.org

Bethany Life's Chaplaincy Endowment Fund



*Chaplain
Sandy
Anenson*

As we plan for the future of Bethany Life through the *Building Tomorrow* Campaign, we are also working hard to preserve the Christian legacy of our mission. The *Chaplaincy Endowment Fund* was created in 2006 to establish a fund which lives in perpetuity and which supports the day to day work of our Chaplain. The goal of this fund is \$1.2 million. When the fund's goal is reached, the earnings from the investment of these funds will be granted to Bethany Life, specifically designated to our Chaplaincy program. The principle of this fund will never be spent.

As of today, the *Chaplaincy Endowment Fund* has received approximately \$750,000 in immediate and planned gifts. Please consider a gift from your estate to support this ministry of hope. The gift of our Chaplain is immeasurable. Your gift could create a legacy that your family and your community will cherish.

The Bethany Life Foundation has partnered with Endow Iowa which allows donations to the *Chaplaincy Endowment Fund* to receive a 25% Iowa tax credit. Please contact Larry Elphic at the Foundation office at 515-509-3299 to discuss how you can make an immediate or planned gift to this very important fund.

If you do not want to receive future publications or fundraising requests supporting Bethany Life you may call 515-733-3040 and request to be removed from our mailing list.
Thank you.

Non-Profit
Postage
PAID
Permit No. 84
Story City, IA

Bethany Life
212 Lafayette Avenue
Story City, Iowa 50248
Return Service Requested

