

# Comfort *stat*™



The **simple** thermostat



# istat wireless

large thermostat

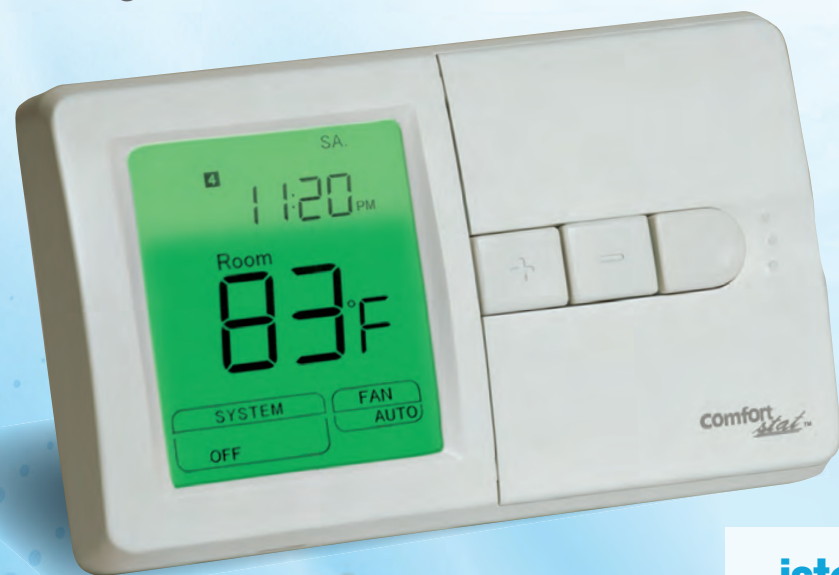

## istat

### Standard Features:

- Universal 7 day programmable or non-programmable
- Up to 3 heat/2 cool heat pump system or up to 2 heat/2 cool conventional system
- Clean filter reminder
- Low battery reminder
- Temporary override or permanent override
- Vacation leave setting
- Pre-programmed with energy star guidelines
- 4 minute delay compressor protection
- Key pad lock
- Emergency heat for heat pump system
- Self-diagnostic
- Overheat protection
- Anti-freezing protection
- 10 communication channels can be selected for better performance

### Applications:

- Heat pump with aux. and emergency heat
- Gas, oil or electrical gas furnace
- Millivolt systems
- 2-wire hydronic systems



Controller

Stop walking back and forth to adjust your temperature.

Install the controller in your AC equipment room and your iStat wireless thermostat will control the temperature from anywhere in your home or office.

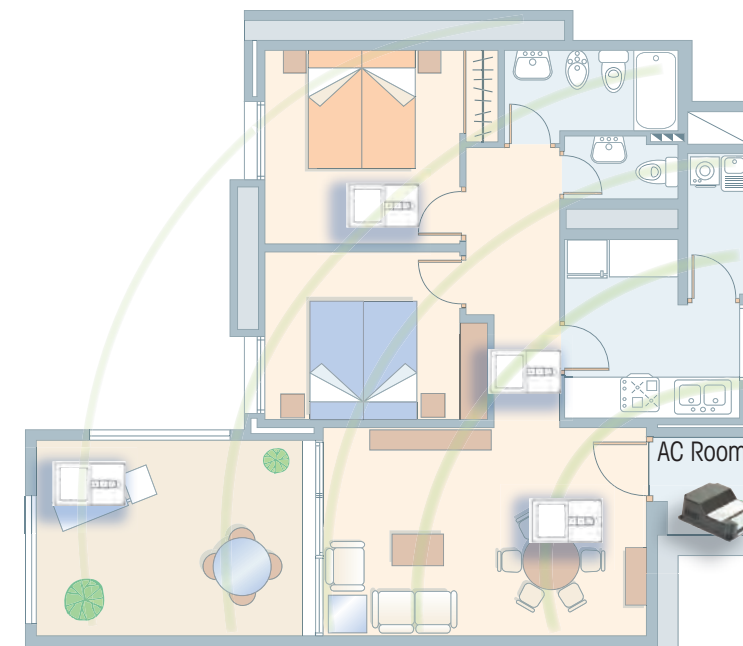

Wireless Communication Range up to 300'



### Specifications:

- Wireless Communication Range: -up to 300' in an open area -100' in a building
- Battery powered without hard wire connecting
- Setting temperature range 45°F to 95°F
- Display temperature range 30°F to 99°F
- Working temperature range 32°F to 120°F
- Fire retardant ABS case
- 24ACV 50/60Hz, less than 3A for each terminal
- Communication Frequency of 433MHz
- Dimensions: (W x H x D)  
Master Thermostat: 5 7/16" x 3 3/8" x 1 1/16"  
Controller: 3 7/8" x 4 1/2" x 1 7/8"

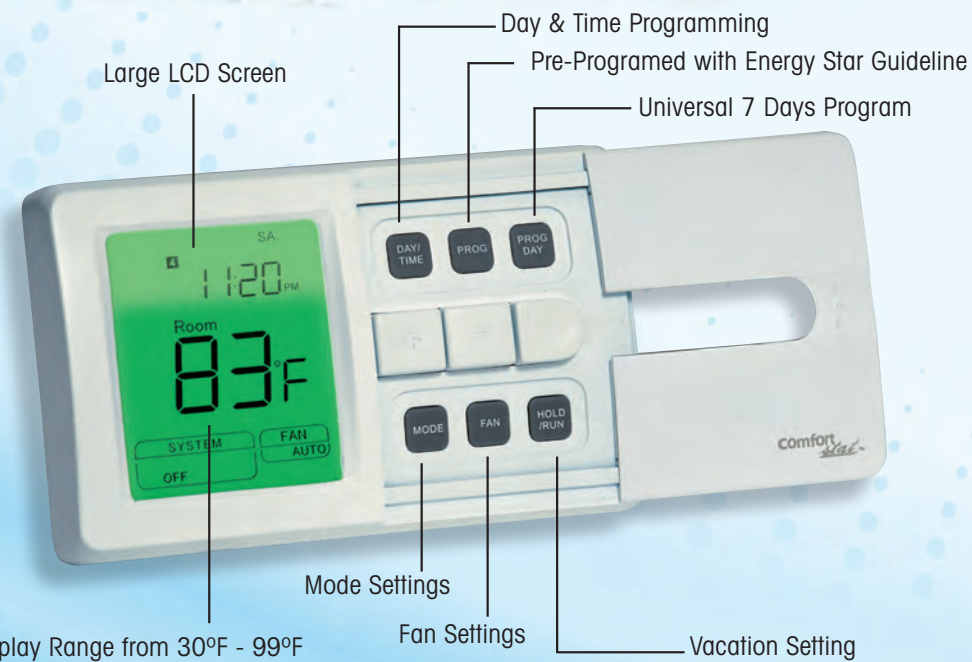



# large touch screen

display with green backlight / digital thermostat



touch screen



touch screen

THE **BIG GREEN SCREEN™**



## ACCESSORIES



Part # IRS-1  
10' Indoor Remote Sensor



Part # ORS-1  
10' Outdoor Remote Sensor

## CDT900 & CDT901

- Large touch screen display with green backlight
- Easy-to-follow menu-driven programming
- Armchair programming allows you to remove the thermostat from the wall for programming
- Change/check reminders let you know when to service or replace filters or batteries
- Real time clock keeps time during power failures and updates automatically to Daylight Savings Time
- Holds options allowing you to override the program schedule as desired
- Gas, oil, electric and heat pump systems; up to 3 heat/2 cool
- Manual or Auto changeover
- **Indoor humidity reading and display (CDT901 ONLY)**
- Outdoor temperature reading and display
- Dehumidification control
- Programmable fan
- Universal programming for seven-day programmable to non-programmable
- Temperature setting range: heat 40-90F, cool 50-99F
- Battery or hard wire power



# introducing our NEW large touch screen

display with green backlight / digital thermostat

## TOUCH ME-1

- 11 Sq. Inch Screen
- True touch screen operation
- Supply power—hardwire and/or battery backup
- Cooling—2 stages
- Heating—3 stages
- Applications: gas, oil, electric, heat pump or millivolt
- Fan modes: auto/on/circ
- Programmable fan capacity
- Compressor delay protection
- Auto changeover
- Auto recovery
- Temperature set point limit
- UV light indicator
- Low battery indicator
- Adjustable back light
- Keypad lockout
- Calibrated reading
- Fahrenheit/Celsius scale selector
- Filter reminder
- Remote indoor sensor (option)



THE **BIG GREEN SCREEN™**



# single stage

24v only digital vertical thermostat

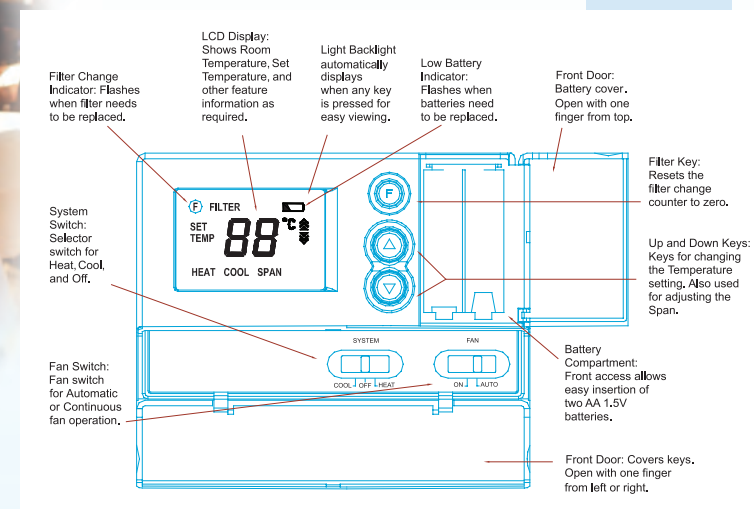

### Compatible With:

- 1 stage heat / 1 stage cool: gas, oil, electric, or single stage heat pump systems
- 2 wire heat only hydronic systems



### CVT88

- 1 heat / 1 cool or single stage heat pump
- System powered only
- Large illuminated digital display
- Attractive slim design
- Soft touch buttons
- Fahrenheit/Celsius display
- Adjustable temperature stops
- 4-Minute compressor protection
- Temperature control range 45°F to 95°F
- Accuracy: +/-1°F
- Vertical installation
- 24v hardwire power
- Dimensions: 3 3/8" x 4 3/4" x 1"
- 2 year warranty

### Not Compatible With:

- Multi-stage heat pumps
- 3 wire hydronic systems
- Line voltage systems (120 / 240 VAC)
- Millivolt systems

# single stage

non-programmable digital thermostats



### CP1717

- Digital non-programmable thermostat
- Battery powered, 2 AA batteries included
- Single stage, 1 stage heat / 1 stage cool
- Compatible with gas, oil, electric & heat pump systems
- Horizontal installation
- Dimensions: 5 1/2" x 3 3/4" x 1"

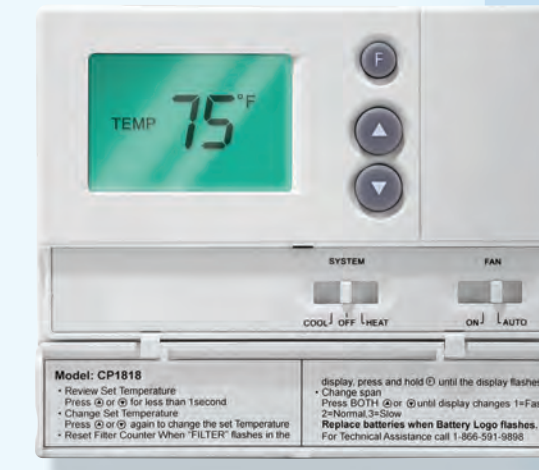

### CP1818

- Digital non-programmable thermostat
- 24v powered with battery backup, 2 AA batteries included
- Single stage, 1 stage heat / 1 stage cool
- Compatible with gas, oil, electric & heat pump systems
- Horizontal installation
- Dimensions: 5 1/2" x 3 3/4" x 1"





# single stage

5+2 programmable digital thermostat

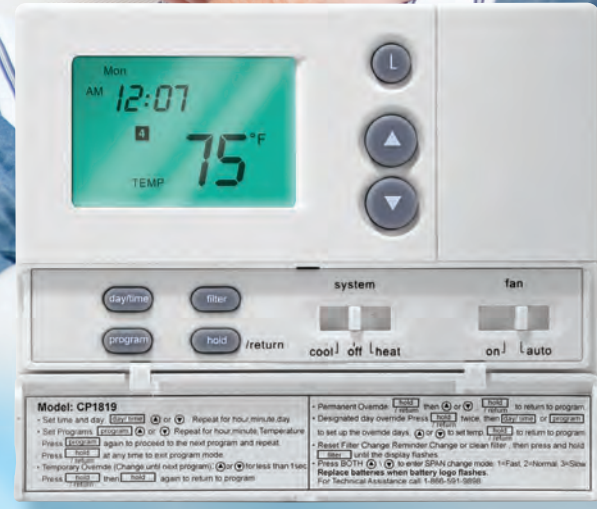
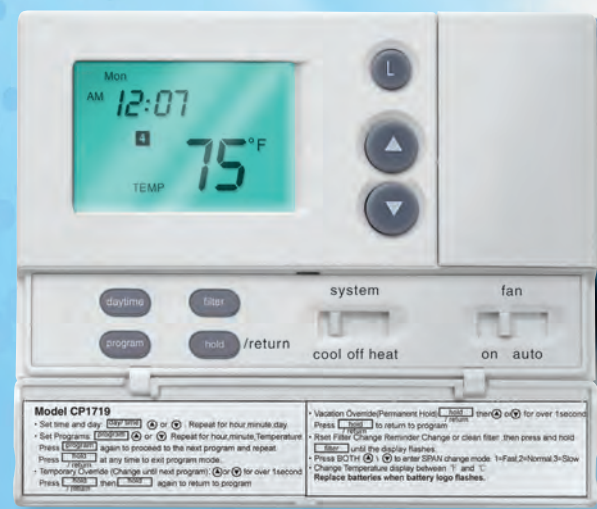
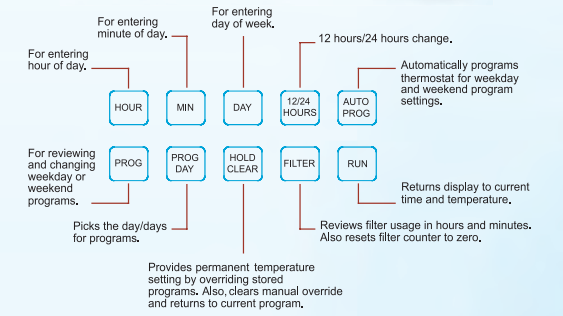
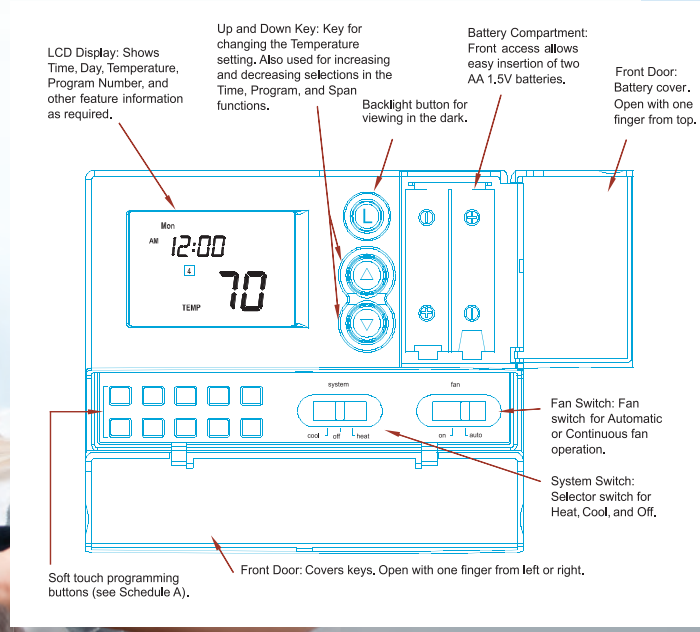
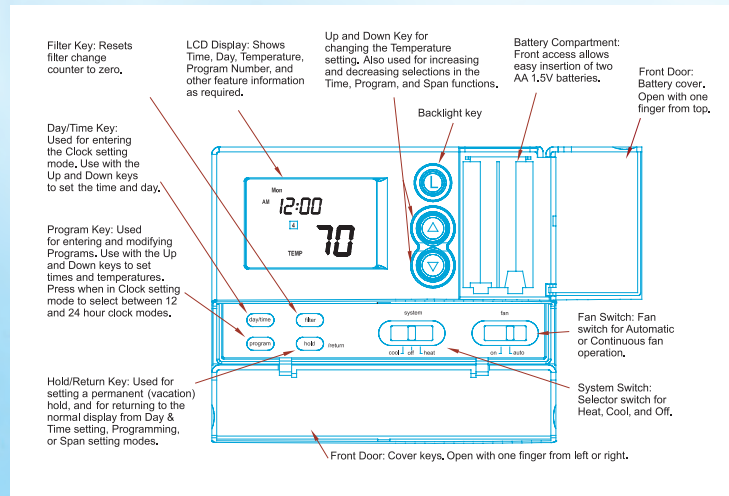

# single stage

7 day programmable digital thermostat

## CP1719

- Digital 5+2 days programmable thermostat
- **Battery powered, 2 AA batteries included**
- Single stage, 1 stage heat / 1 stage cool
- Compatible with gas, oil, electric & heat pump systems
- Horizontal installation

## CP1819

- Digital 5+2 days programmable thermostat
- **AC powered with battery backup, 2 AA batteries included**
- Single stage, 1 stage heat / 1 stage cool
- Compatible with gas, oil, electric & heat pump systems
- Horizontal installation

## CP1919

- Digital 7 days programmable thermostat
- **Battery powered, 2 AA batteries included**
- Single stage, 1 stage heat / 1 stage cool
- Compatible with gas, oil & electric systems
- Horizontal installation

## CP1820

- Digital 7 days programmable thermostat
- **AC powered with battery backup, 2 AA batteries included**
- Single stage, 1 stage heat / 1 stage cool
- Compatible with gas, oil & electric systems
- Horizontal installation





# single stage

7 day programmable digital thermostat / auto changeover

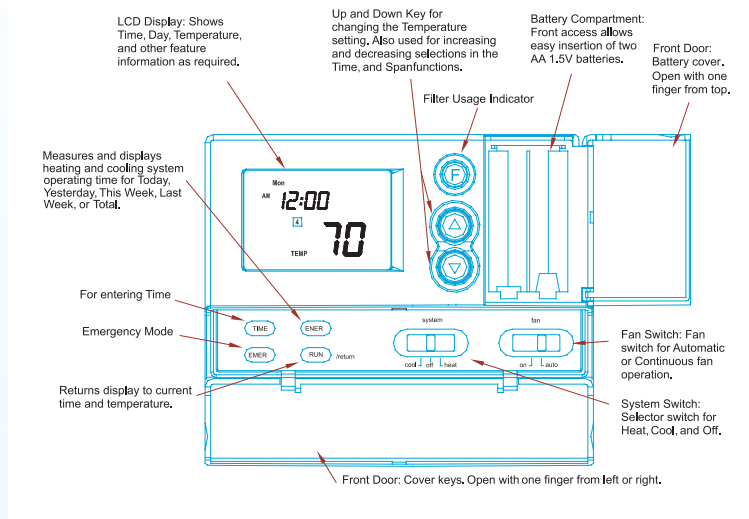
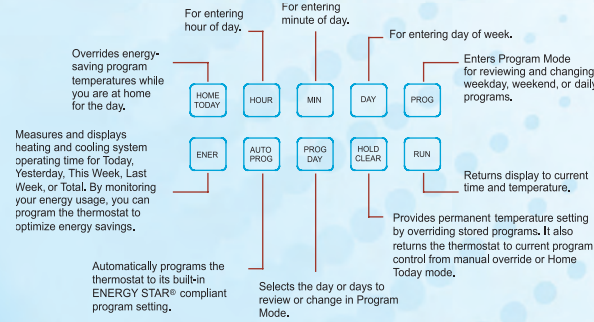
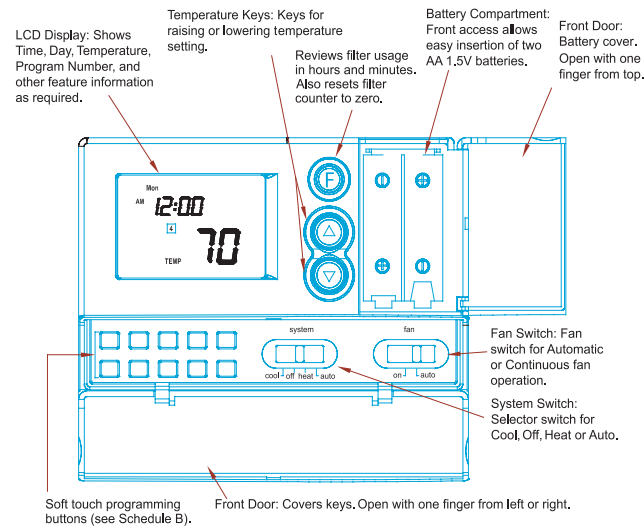

# multi stage

non-programmable digital thermostat

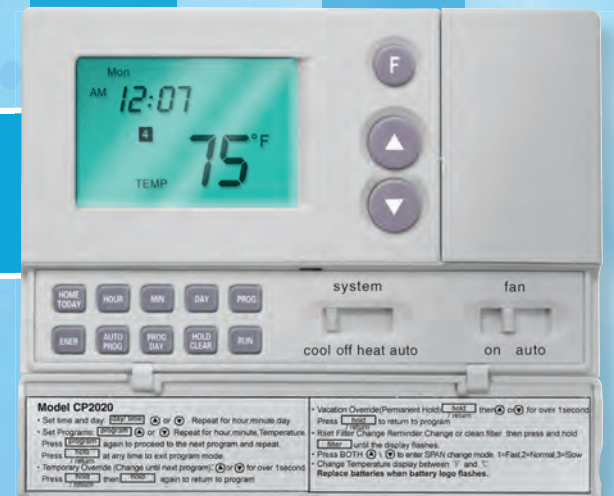

## CP2020

- Digital 7 days programmable thermostat, auto changeover
- **Battery powered, 2 AA batteries included**
- Single stage, 1 stage heat / 1 stage cool
- Compatible with gas, oil, electric & heat pump systems
- Horizontal installation

## CP2006

- Digital 7 days programmable thermostat, auto changeover
- **AC powered with battery backup, 2 AA batteries included**
- Single stage, 1 stage heat / 1 stage cool
- Compatible with gas, oil, electric & heat pump systems
- Horizontal installation



## CP2801

- Digital non-programmable thermostat
- **AC powered with battery backup, 2 AA batteries included**
- Multi-stage 2 stage heat / 1 stage cool
- Compatible with gas, oil, electric & heat pump systems
- Horizontal installation

## CP2802

- Digital non-programmable thermostat
- **AC powered with battery backup, 2 AA batteries included**
- Multi-stage 2 stage heat / 2 stage cool
- Compatible with gas, oil, electric & heat pump systems
- Horizontal installation.



# multi-stage

programmable digital thermostat

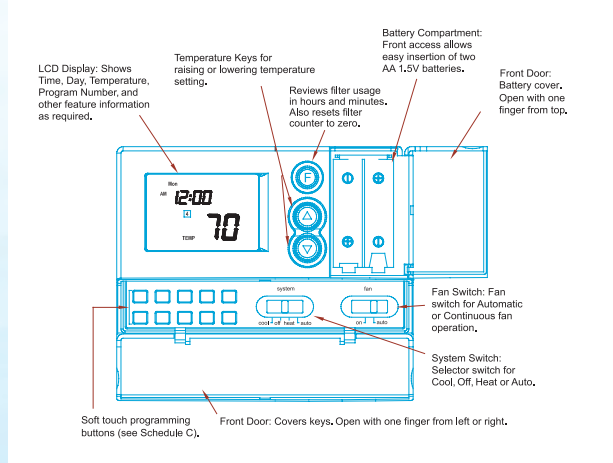
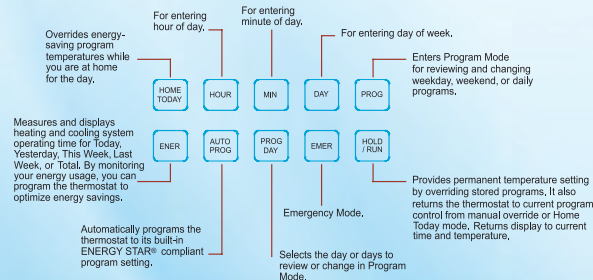

# thermostat guards



- STM11**
- Beige metal steel
  - Solid steel construction
  - Solid base included
  - T/Stat clearance area: 5 1/2" x 3 1/2" x 2 3/4"



- STG12**
- Clear plastic
  - Ring base/solid base
  - General application, larger than STG1 & STG2
  - T/Stat clearance area: 8 1/4" x 4 1/2" x 3 1/4"



- STM1**
- Beige metal steel
  - Solid steel construction
  - T/Stat clearance area: 6" x 4" x 3"



- STG1**
- Clear plastic
  - Standard size wall thermostats
  - Ring base/solid base
  - T/Stat clearance area: 5 3/4" x 3 1/2" x 2 3/4"



- STG2**
- Clear plastic
  - Medium size
  - Ring base/solid base
  - T/Stat clearance area: 4 3/4" x 4 1/4" x 2 3/4"



- STL10**
- Clear plastic
  - Low profile design
  - Ring/solid base included
  - T/Stat clearance area: 6 1/4" x 3 3/4" x 1 3/4"



- CP2810**
- Digital 7 days programmable thermostat, auto changeover
  - **AC powered with battery back up, 2 AA batteries included**
  - Multi-stage 2 stage heat / 1 stage cool
  - Compatible with gas, oil, electric & heat pump systems
  - Horizontal installation



- CP2811**
- Digital 7 days programmable thermostat, auto changeover
  - **AC powered with battery backup, 2 AA batteries included**
  - Multi-Stage 2 stage heat / 2 stage cool
  - Compatible with gas, oil, electric & heat pump systems
  - Horizontal installation



- CP2815**
- Digital 7 days programmable thermostat, remote sensor, auto changeover
  - **AC powered with battery backup, 2 AA batteries included**
  - Multi-Stage 2 stage heat / 2 stage cool
  - Compatible with gas, oil, electric & heat pump systems
  - Horizontal installation





# cross reference

and product features

Features	ComfortStat Istat	Honeywell TH6320R1004	White Rodgers 1F85-RF-275	Pro IAQ T955W	Controlled Air T50
Program Options (Universal 7 days)	•	•	•	•	—
Temporary & Permanent Override	•	•	•	•	—
Multi-Stage (3 heat/2 cool)	•	•	•	•	—
Gas, Oil, Electric System	•	•	•	•	—
Heat Pump System	•	•	•	•	—
Zone Valve	•	•	•	—	—
Millivolt System	•	—	•	—	—
Hardwire with Freeze Protection	•	•	•	•	•
Real-Time Clock	•	•	•	•	•
Auto Changeover	•	—	—	•	•
Auto Recovery	•	•	•	•	•
Low Battery Reminder	•	•	•	—	—
Programming Fan—Vacation Leave Setting	•	•	•	—	•
Heat Pump Emergency Heat	•	•	•	—	—
Keypad Lockout	•	•	•	•	—
Clean Filter Reminder	•	•	•	•	—
Overheat Protection	•	•	—	•	—
10 Communications Channels	•	•	•	—	—
F/C Temperature Read Out	•	•	•	•	•
Change/Check Reminder	•	•	•	•	•
Temporary or Permanent Override	•	•	•	—	—
Compressor Short-Cycle Protection	•	•	•	•	•
Backlight	•	•	•	•	•

Features	ComfortStat Touch Me-1	Lux PSP711TS	Pro IAQ T925	Controlled Air T61
Program Options (Universal 7 days)	•	7 day	•	•
Temporary & Permanent Override	•	•	•	•
Multi-stage (3 heat/2 cool)	•	—	•	•
Gas, Oil, Electric System	•	•	—	•
Heat Pump System	•	—	•	•
Zone Valve	•	•	—	—
Millivolt System	•	•	—	—
Hardwire with Battery Backup	•	•	•	•
Real-Time Clock	•	•	•	—
Auto Changeover	•	—	•	•
Auto Recovery	•	•	—	—
Programming Fan	•	—	—	—
Keypad Lockout	•	•	•	limited
UV Light Indicator	•	—	—	•
F/C Temperature Read Out	•	•	•	•
Filter Reminder	•	•	•	•
Compressor Short-Cycle Protection	•	•	•	•
Backlight	•	•	•	•
Low Battery Indicator	•	•	•	—
Indoor Remote Sensor (Option)	•	—	—	—
Temperature Set Point Limit	•	—	•	•

Features	ComfortStat CDT900	Honeywell TH8320	White Rodgers 1F95-1277	Lux N/A	Climatouch CT03TS32
Program Options (Universal 7 days)	•	•	•	—	•
Temporary & Permanent Override	•	•	•	—	•
Multi-stage (3 heat/2 cool)	•	•	•	—	•
Gas, Oil, Electric System	•	•	•	—	•
Heat Pump System	•	•	•	—	•
Zone Valve	•	•	•	—	•
Millivolt System	•	•	•	—	•
Hardwire with Battery Backup	•	•	•	—	•
Real-Time Clock	•	•	•	—	•
Auto Changeover	•	•	•	—	•
Auto Recovery	•	•	•	—	•
Auto Programming	•	•	•	—	•
Programming Fan	•	•	•	—	•
Heat Pump Compressor Lockout	•	•	•	—	•
Keypad Lockout	•	•	•	—	•
Dehumidification Control	—	—	—	—	—
Indoor Humidity Sensor	—	—	—	—	—
Outdoor or Indoor Remote Sensor	•	•	•	—	•
F/C temperature Read Out	•	•	•	—	•
Change/Check Reminder	•	•	•	—	•
Adjustable Cycle Rate	•	•	•	—	•
Compressor Short-Cycle Protection	•	•	•	—	•
Backlight	•	•	•	—	•

Features	ComfortStat CDT901	Honeywell TH8321	White Rodgers N/A	Lux N/A	Climatouch CT03TS32H
Program Options (Universal 7 days)	•	•	—	—	•
Temporary & Permanent Override	•	•	—	—	•
Multi-stage (3 heat/2 cool)	•	•	—	—	•
Gas, Oil, Electric System	•	•	—	—	•
Heat Pump System	•	•	—	—	•
Zone Valve	•	•	—	—	•
Millivolt System	•	•	—	—	•
Hardwire with Battery Backup	•	•	—	—	•
Real-Time Clock	•	•	—	—	•
Auto Changeover	•	•	—	—	•
Auto Recovery	•	•	—	—	•
Auto Programming	•	•	—	—	•
Programming Fan	•	•	—	—	•
Heat Pump Compressor Lockout	•	•	—	—	•
Keypad Lockout	•	•	—	—	•
Dehumidification Control	•	•	—	—	•
Indoor Humidity Sensor	•	•	—	—	•
Outdoor or Indoor Remote Sensor	•	•	—	—	•
F/C Temperature Read Out	•	•	—	—	•
Change/Check Reminder	•	•	—	—	•
Adjustable Cycle Rate	•	•	—	—	•
Compressor Short-Cycle Protection	•	•	—	—	•
Backlight	•	•	—	—	•



# cross reference

and product features

Features	ComfortStat CP1717	CTC 43054	Honeywell TH3110	White Rodgers 1F86-244	RobertShaw 9400	Braeburn 1000	LUX PSD011B	Controlled Air T20A3B11	ICM SC2000
Backlight	•	•	•	•	•	•	•	•	—
Front Battery Door	•	•	—	—	•	•	—	—	—
Quick-Connect Wiring Terminal	•	•	•	•	•	•	•	•	•
Static Protection	•	•	•	•	•	•	•	•	•
F/C Temperature Read Out	•	•	•	•	•	•	•	•	•
High/Low Temperature Protection	•	•	•	•	•	•	•	•	•
Compressor Short-Cycle Protection	•	•	•	•	•	•	•	•	•
Energy Usage Counter	—	—	—	—	—	—	—	—	—
1st Stage Temp. Differential Rating	•	•	•	•	•	•	•	•	•
Separate O & B Terminal	•	•	•	•	•	•	•	•	•
Gas, Oil, Electric System	•	•	•	•	•	•	•	•	•
Heat Pump System	•	•	•	•	•	•	•	•	•
Millivolt System	•	•	•	•	—	•	•	—	•
Battery Operation	•	•	•	•	•	•	•	•	•
Non-Volatile Memory	—	—	•	—	—	—	—	•	—
Hardwire	—	—	•	—	—	—	—	•	—
2nd Stage Temp. Differential Setting	—	—	—	—	—	—	—	•	—
Keypad Lockout	—	—	—	—	—	—	—	—	—

Features	ComfortStat CP1818	Honeywell TH3110	White Rodgers 1F86-241	RobertShaw 9401	Braeburn 1010	LUX PSD111	Pro IAQ T701	Controlled Air T20B3B11	ICM 2001
Backlight	•	•	•	•	•	•	•	•	•
Front Battery Door	•	—	—	•	•	—	—	—	—
Quick-Connect Wiring Terminal	•	•	•	•	•	•	•	•	•
Static Protection	•	•	•	•	•	•	•	•	•
F/C Temperature Read Out	•	•	•	•	•	•	•	—	•
High/Low Temperature Protection	•	•	•	•	•	•	•	•	•
Compressor Short-Cycle Protection	•	•	•	•	•	•	•	•	•
Energy Usage Counter	—	—	—	—	—	—	—	—	—
1st Stage Temp. Differential Rating	•	•	•	•	•	•	•	•	•
Separate O & B Terminal	•	•	•	•	•	•	•	•	•
Gas, Oil, Electric System	•	•	•	•	•	•	•	•	•
Heat Pump System	•	•	•	•	•	•	•	•	•
Millivolt System	•	•	•	•	•	•	•	—	•
Battery Operation	•	•	•	•	•	•	•	•	—
Non-Volatile Memory	—	•	—	—	—	—	•	•	—
Hardwire	•	•	•	•	•	•	•	•	•
2nd Stage Temp. Differential Setting	—	—	—	—	—	—	—	•	—
Keypad Lockout	—	—	—	—	—	—	—	—	—

Features	ComfortStat CP1719	CTC 43154	Honeywell TH4110	White Rodgers 1F78-151	RobertShaw 9600	Braeburn 2000	LUX PSP511	Controlled Air T21A3311
Backlight	•	•	•	•	—	•	•	•
Front Battery Door	•	•	•	—	—	•	—	—
Quick-Connect Wiring Terminal	•	•	•	•	•	•	•	•
Static Protection	•	•	•	•	•	•	•	•
F/C Temperature Read Out	•	•	•	•	•	•	•	—
High/Low Temperature Protection	•	•	•	•	•	•	•	•
Compressor Short-Cycle Protection	•	•	•	•	•	•	•	•
Auto Recovery	•	•	•	•	•	•	•	•
Filter Check Monitor	•	•	•	•	•	•	•	•
4 Periods Temp. Adjustment	•	•	•	•	•	•	•	•
Pre-Programming Set Point	•	•	•	•	•	•	•	•
Hold & Override	•	•	•	•	•	•	•	•
Energy Usage Counter	—	—	—	—	—	•	—	—
5 + 2 Programming	•	•	•	•	•	•	•	•
Universal Days or 5 + 2 Prog.	—	—	—	—	—	—	—	—
1st Stage Temp. Differential Rating	•	•	•	•	•	•	•	•
Separate O & B Terminal	•	•	•	•	•	•	•	•
Gas, Oil, Electric System	•	•	•	•	•	•	•	•
Heat Pump System	•	•	•	•	—	•	•	•
Millivolt System	•	•	•	•	—	•	•	—
Battery Operation	•	•	•	•	•	•	•	•
Non-Volatile Memory	—	—	•	—	—	—	•	•
Hardwire	—	—	•	—	—	—	•	•
2nd Stage Temp. Differential Setting	—	—	—	—	—	—	—	—
Keypad Lockout	—	—	—	—	—	—	•	—
Remote Sensor	—	—	—	—	—	—	—	—

Features	ComfortStat CP1819	Pro IAQ T765	Honeywell TH4110	White Rodgers 1F78H-151	RobertShaw 300-224	Braeburn 2010	LUX PSP511	Controlled Air T2/B3811
Backlight	•	•	•	•	—	•	•	•
Front Battery Door	•	—	—	—	•	•	—	—
Quick-Connect Wiring Terminal	•	•	•	•	•	•	•	•
Static Protection	•	•	•	•	•	•	•	•
F/C Temperature Read Out	•	•	•	•	•	•	•	—
High/Low Temperature Protection	•	•	•	•	•	•	•	•
Compressor Short-Cycle Protection	•	•	•	•	•	•	•	•
Auto Recovery	•	•	•	•	•	•	•	•
Filter Check Monitor	•	•	•	•	•	•	•	•
4 Periods Temp. Adjustment	•	•	•	•	•	•	•	•
Pre-Programmed Set Point	•	•	•	•	•	•	•	•
Hold & Override	•	•	•	•	•	•	•	•
Energy Usage Counter	—	—	—	—	—	—	—	—
5 + 2 Programming	•	•	•	•	•	•	•	•
Universal Days or 5 + 2 Prog.	—	—	—	—	—	—	—	—
1st Stage Temp. Differential Rating	•	•	•	•	•	•	•	•
Separate O & B Terminal	•	•	•	•	•	•	•	•
Gas, Oil, Electric System	•	•	•	•	•	•	•	•
Heat Pump System	•	•	•	•	•	•	•	•
Millivolt System	•	•	•	•	—	—	•	—
Battery Operation	•	•	•	•	•	•	•	—
Non-Volatile Memory	—	•	•	—	—	—	•	•
Hardwire	•	•	•	•	•	•	•	•
2nd Stage Temp. Differential Setting	—	—	—	—	—	—	—	—
Keypad Lockout	—	—	—	—	—	—	•	—
Remote Sensor	—	—	—	—	—	—	—	—



# cross reference

and product features

Features	ComfortStat CP1919	CTC 43323	Honeywell N/A	White Rodgers 1F80-240	RobertShaw N/A	Braeburn N/A	LUX N/A
Backlight	•	•	-	•	-	-	-
Front Battery Door	•	•	-	—	-	-	-
Quick-Connect Wiring Terminal	•	•	-	•	-	-	-
Static Protection	•	•	-	•	-	-	-
F/C Temperature Read Out	•	•	-	•	-	-	-
High/Low Temperature Protection	•	•	-	•	-	-	-
Compressor Short-Cycle Protection	•	•	-	•	-	-	-
Auto Recovery	•	•	-	•	-	-	-
Filter Check Monitor	•	•	-	•	-	-	-
4 Periods Temp. Adjustment	•	•	-	•	-	-	-
Pre-Programmed Set Point	•	•	-	•	-	-	-
Hold & Override	•	•	-	•	-	-	-
Energy Usage Counter	—	—	-	—	-	-	-
5 + 2 Programming	•	•	-	•	-	-	-
Universal Days or 5 + 2 Programming	•	•	-	•	-	-	-
1st Stage Temp. Differential Rating	•	•	-	•	-	-	-
Separate O & B Terminal	—	—	-	—	-	-	-
Gas, Oil, Electric System	•	•	-	•	-	-	-
Heat Pump System	—	—	-	—	-	-	-
Millivolt System	•	•	-	•	-	-	-
Battery Operation	•	•	-	•	-	-	-
Non-Volatile Memory	—	—	-	—	-	-	-
Hardwire	—	—	-	—	-	-	-
2nd Stage Temp. Differential Setting	—	—	-	—	-	-	-
Keypad Lockout	—	—	-	—	-	-	-
Remote Sensor	—	—	-	—	-	-	-

Features	ComfortStat CP1820	CTC N/A	Honeywell N/A	White Rodgers N/A	RoberShaw N/A	Braeburn N/A	LUX N/A
Backlight	•	-	-	-	-	-	-
Front Battery Door	•	-	-	-	-	-	-
Quick-Connect Wiring Terminal	•	-	-	-	-	-	-
Static Protection	•	-	-	-	-	-	-
F/C Temperature Read Out	•	-	-	-	-	-	-
High/Low Temperature Protection	•	-	-	-	-	-	-
Compressor Short-Cycle Protection	•	-	-	-	-	-	-
Auto Recovery	•	-	-	-	-	-	-
Filter Check Monitor	•	-	-	-	-	-	-
4 Periods Temp. Adjustment	•	-	-	-	-	-	-
Pre-Programmed Set Point	•	-	-	-	-	-	-
Hold & Override	•	-	-	-	-	-	-
Energy Usage Counter	—	-	-	-	-	-	-
5 + 2 Programming	•	-	-	-	-	-	-
Universal Days or 5 + 2 Programming	•	-	-	-	-	-	-
1st Stage Temp. Differential Rating	•	-	-	-	-	-	-
Separate O & B Terminal	—	-	-	-	-	-	-
Gas, Oil, Electric System	•	-	-	-	-	-	-
Heat Pump System	—	-	-	-	-	-	-
Millivolt System	•	-	-	-	-	-	-
Battery Operation	•	-	-	-	-	-	-
Non-Volatile Memory	—	-	-	-	-	-	-
Hardwire	•	-	-	-	-	-	-
2nd Stage Temp. Differential Setting	—	-	-	-	-	-	-
Keypad Lockout	—	-	-	-	-	-	-
Remote Sensor	—	-	-	-	-	-	-

Features	ComfortStat CP2020	CTC 43503	Honeywell TH6110	White Rodgers 1F87-251	RobertShaw N/A	Braeburn 2000	LUX PSPA711	ICM SC30006
Backlight	•	•	•	•	-	•	•	•
Front Battery Door	•	•	•	—	-	•	—	—
Quick-Connect Wiring Terminal	•	•	•	•	-	•	•	•
Static Protection	•	•	•	•	-	•	•	•
F/C Temperature Read Out	•	•	•	•	-	•	•	•
High/Low Temperature Protection	•	•	•	•	-	•	•	•
Compressor Short-Cycle Protection	•	•	•	•	-	•	•	•
Auto Recovery	•	•	•	•	-	•	•	—
Filter Check Monitor	•	•	•	•	-	•	•	—
4 Periods Temp. Adjustment	•	•	•	•	-	•	•	•
Pre-Programmed Set Point	•	•	•	•	-	•	•	•
Hold & Override	•	•	•	•	-	•	•	•
Energy Usage Counter	•	•	•	•	-	•	•	—
5 + 2 Programming	•	•	•	•	-	•	•	•
Universal Days or 5 + 2 Prog.	•	•	•	•	-	—	•	•
1st Stage Temp. Differential Rating	•	•	•	•	-	•	•	•
Separate O & B Terminal	•	•	•	•	-	•	•	•
Gas, Oil, Electric System	•	•	•	•	-	•	•	•
Heat Pump System	•	•	•	•	-	•	•	•
Millivolt System	•	•	•	•	-	•	•	•
Battery Operation	•	•	•	•	-	•	•	•
Non-Volatile Memory	—	—	•	—	-	—	•	—
Hardwire	—	—	•	—	-	—	•	—
2nd Stage Temp. Differential Setting	—	—	—	—	-	—	—	—
Keypad Lockout	•	—	•	—	-	—	•	—
Remote Sensor	—	—	—	—	-	—	—	—

Features	ComfortStat CP2006	ICM SC3010L	Honeywell TH6110	White Rodgers 1F80-261	RobertShaw 300-225	Braeburn 2010	LUX PSPA711
Backlight	•	•	•	•	—	•	•
Front Battery Door	•	—	—	—	•	•	—
Quick-Connect Wiring Terminal	•	•	•	•	•	•	•
Static Protection	•	•	•	•	•	•	•
F/C Temperature Read Out	•	•	•	•	•	•	•
High/Low Temperature Protection	•	•	•	•	•	•	•
Compressor Short-Cycle Protection	•	•	•	•	•	•	•
Auto Recovery	•	•	•	•	•	•	•
Filter Check Monitor	•	—	•	•	•	•	•
4 Periods Temp. Adjustment	•	•	•	•	•	•	•
Pre-Programmed Set Point	•	•	•	•	•	•	•
Hold & Override	•	•	•	•	•	•	•
Energy Usage Counter	•	—	•	•	•	•	•
5 + 2 Programming	•	•	•	•	•	•	•
Universal Days or 5 + 2 Programming	•	•	•	•	•	—	•
1st Stage Temp. Differential Rating	•	•	•	•	•	•	•
Separate O & B Terminal	•	•	•	•	•	•	•
Gas, Oil, Electric System	•	•	•	•	•	•	•
Heat Pump System	•	•	•	•	•	•	•
Millivolt System	•	—	•	•	—	—	•
Battery Operation	•	•	•	•	•	•	•
Non-Volatile Memory	—	•	•	—	—	—	•
Hardwire	•	•	•	•	•	•	•
2nd Stage Temp. Differential Setting	—	•	—	—	—	—	—
Keypad Lockout	•	—	•	—	—	—	•
Remote Sensor	—	—	—	—	—	—	—



# cross reference

and product features

Features	ComfortStat CP2801	ICM 2201L	Honeywell TH3210	White Rodgers 1F89-211	RobertShaw 300-208	Braeburn 1100/1200	LUX PSH121B
Backlight	•	•	•	•	•	•	•
Front Battery Door	•	—	—	—	•	•	—
Quick-Connect Wiring Terminal	•	•	•	•	•	•	•
Static Protection	•	•	•	•	•	•	•
F/C Temperature Read Out	•	—	•	•	•	•	•
High/Low Temperature Protection	•	—	•	•	•	•	•
Compressor Short-Cycle Protection	•	•	•	•	•	•	•
Energy Usage Counter	•	—	•	•	•	•	—
1st Stage Temp. Differential Rating	•	•	•	•	•	•	•
Separate O & B Terminal	•	•	•	•	•	•	•
Gas, Oil, Electric System	•	—	•	—	•	•	—
Heat Pump System	•	•	•	•	•	•	•
Millivolt System	•	—	•	—	—	•	—
Battery Operation	•	—	•	•	•	•	•
Non-Volatile Memory	•	—	•	•	•	•	—
Hardwire	•	•	•	•	•	•	•
2nd Stage Temp. Differential Setting	•	•	•	•	•	•	•
Keypad Lockout	•	—	—	—	•	•	—

Features	ComfortStat CP2810	CTC N/A	Honeywell TH4210	White Rodgers 1F82-261	RobertShaw 300-226	Braeburn 2100/2200	LUX PSPH521L	Pro IAQ T925
Backlight	•	-	•	•	—	•	•	•
Front Battery Door	•	-	—	—	•	•	—	—
Quick-Connect Wiring Terminal	•	-	•	•	•	•	•	•
Static Protection	•	-	•	•	•	•	•	•
F/C Temperature Read Out	•	-	•	•	•	•	•	•
High/Low Temperature Protection	•	-	•	•	•	•	•	•
Compressor Short-Cycle Protection	•	-	•	•	•	•	•	•
Auto Recovery	•	-	•	•	•	•	•	•
Filter Check Monitor	•	-	•	•	•	•	•	•
4 Periods Temp. Adjustment	•	-	•	•	•	•	•	•
Pre-Programmed Set Point	•	-	•	•	•	•	•	•
Hold & Override	•	-	•	•	•	•	•	•
Energy Usage Counter	•	-	•	•	•	•	•	•
5 + 2 Programming	•	-	•	•	•	•	•	•
Universal Days or 5 + 2 Prog.	•	-	•	•	•	•	—	—
1st Stage Temp. Differential Rating	•	-	•	•	•	•	•	•
Separate O & B Terminal	•	-	•	•	•	•	•	•
Gas, Oil, Electric System	•	-	•	•	•	•	—	—
Heat Pump System	•	-	•	—	•	•	•	•
Millivolt System	•	-	•	—	—	—	—	—
Battery Operation	•	-	•	•	•	•	•	•
Non-Volatile Memory	•	-	•	•	•	•	—	•
Hardwire	•	-	•	•	•	•	•	•
2nd Stage Temp. Differential Setting	•	-	•	•	•	•	•	•
Keypad Lockout	•	-	•	—	•	—	•	—
Remote Sensor	—	-	—	—	—	—	—	—

Features	ComfortStat CP2802	CTC 43058	Honeywell TH5220	White Rodgers 1F83-277	RobertShaw 9515	Braeburn 3100/3200	ICM SC4811
Backlight	•	•	•	•	—	•	•
Front Battery Door	•	—	—	—	—	•	—
Quick-Connect Wiring Terminal	•	•	•	•	•	•	•
Static Protection	•	•	•	•	•	•	•
F/C Temperature Read Out	•	•	•	•	•	•	•
High/Low Temperature Protection	•	•	•	•	•	•	•
Compressor Short-Cycle Protection	•	•	•	•	•	•	•
Energy Usage Counter	•	•	•	•	•	•	—
1st Stage Temp. Differential Rating	•	•	•	•	•	•	•
Separate O & B Terminal	•	•	•	•	•	•	•
Gas, Oil, Electric System	•	•	•	•	•	•	•
Heat Pump System	•	•	•	•	—	•	•
Millivolt System	•	•	•	•	—	—	—
Battery Operation	•	•	•	•	•	•	—
Non-Volatile Memory	•	•	•	•	•	•	•
Hardwire	•	•	•	•	•	•	•
2nd Stage Temp. Differential Setting	•	•	•	•	•	•	•
Keypad Lockout	•	—	•	•	—	•	—

Features	ComfortStat CP2811	CTC 43558	Honeywell TH6220	White Rodgers 1F85-277	RobertShaw 9615	Braeburn 5100/5200	LUX PSPA722	ICM SC5811	Controlled Air T30B3B11	Pro IAQ T755
Backlight	•	•	•	•	—	•	•	•	•	•
Front Battery Door	•	—	—	—	—	•	—	—	—	—
Quick-Connect Wiring Terminal	•	•	•	•	•	•	•	•	•	•
Static Protection	•	•	•	•	•	•	•	•	•	•
F/C Temperature Read Out	•	•	•	•	•	•	•	•	—	•
High/Low Temperature Protection	•	•	•	•	•	•	•	•	•	•
Compressor Short-Cycle Protection	•	•	•	•	•	•	•	•	•	•
Auto Recovery	•	•	•	•	•	•	•	•	•	•
Filter Check Monitor	•	•	•	•	•	•	•	•	—	•
4 Periods Temp. Adjustment	•	•	•	•	•	•	•	•	•	•
Pre-Programmed Set Point	•	•	•	•	•	•	•	•	•	•
Hold & Override	•	•	•	•	•	•	•	•	•	•
Energy Usage Counter	•	•	•	•	•	•	•	—	—	•
5 + 2 Programming	•	•	•	•	•	•	•	•	•	•
Universal Days or 5 + 2 Programming	•	•	•	•	•	•	•	•	—	—
1st Stage Temp. Differential Rating	•	•	•	•	•	•	•	•	•	•
Separate O & B Terminal	•	•	•	•	•	•	•	•	•	•
Gas, Oil, Electric System	•	•	•	•	•	•	•	•	•	•
Heat Pump System	•	•	•	•	—	•	•	•	•	•
Millivolt System	•	•	•	•	—	•	•	—	—	•
Battery Operation	•	•	•	•	•	•	•	—	—	•
Non-Volatile Memory	•	•	•	•	•	•	•	•	—	•
Hardwire	•	•	•	•	•	•	•	•	•	•
2nd Stage Temp. Differential Setting	•	•	•	•	•	•	•	•	•	•
Keypad Lockout	•	—	•	—	•	•	•	—	—	—
Remote Sensor	—	—	—	—	—	—	—	•	—	—



# cross reference

Features	ComfortStat CP2815	CTC 43558	Honeywell TH6220	White Rodgers 1F85-277	RobertShaw 9715i	Braeburn 5100/5200	LUX PSPA722
Backlight	*	*	*	*	*	*	*
Front Battery Door	*	—	*	—	—	*	—
Quick-Connect Wiring Terminal	*	*	*	*	*	*	*
Static Protection	*	*	*	*	*	*	*
F/C Temperature Read Out	*	*	*	*	*	*	*
High/Low Temperature Protection	*	*	*	*	*	*	*
Compressor Short-Cycle Protection	*	*	*	*	*	*	*
Auto Recovery	*	*	*	*	*	*	*
Filter Check Monitor	*	*	*	*	*	*	*
4 Periods Temp. Adjustment	*	*	*	*	*	*	*
Pre-Programmed Set Point	*	*	*	*	*	*	*
Hold & Override	*	*	*	*	*	*	*
Energy Usage Counter	*	*	*	*	*	*	*
5 + 2 Programming	*	*	*	*	*	*	*
Universal Days or 5 + 2 Programming	*	*	*	*	*	*	*
1st Stage Temp. Differential Rating	*	*	*	*	*	*	*
Separate O & B Terminal	*	*	*	*	*	*	*
Gas, Oil, Electric System	*	*	*	*	*	*	*
Heat Pump System	*	*	*	*	—	*	*
Millivolt System	*	*	*	*	—	*	*
Battery Operation	*	*	*	*	*	*	*
Non-Volatile Memory	*	*	*	*	*	*	*
Hardwire	*	*	*	*	*	*	*
2nd Stage Temp. Differential Setting	*	*	*	*	*	*	*
Keypad Lockout	*	—	*	*	*	*	*
Remote Sensor	*	—	—	—	*	—	—

Features	ComfortStat CVT88	CTC 43054	Honeywell TH1110	White Rodgers 1F78-144	RobertShaw 8401	Braeburn 1010	LUX PSD011W	ICM SC2001VL	Pro IAQ	Controlled Air N/A
Backlight	*	*	*	*	*	*	*	*	*	-
Front Battery Door	*	*	—	—	*	*	—	—	—	-
Quick-Connect Wiring Terminal	*	*	*	*	*	*	*	*	*	-
Static Protection	*	*	*	*	*	*	*	*	*	-
F/C Temperature Read Out	*	*	*	*	*	*	*	—	*	-
High/Low Temperature Protection	*	*	*	*	*	*	*	*	*	-
Compressor Short-Cycle Protection	*	*	*	*	*	*	*	*	*	-
Energy Usage Counter	—	—	—	—	—	—	—	—	—	-
1st Stage Temp. Differential Rating	*	*	*	*	*	*	*	*	*	-
Separate O & B Terminal	*	*	*	*	*	*	*	*	*	-
Gas, Oil, Electric System	*	*	*	*	*	*	*	*	*	-
Heat Pump System	*	*	*	*	*	*	*	*	*	-
Millivolt System	*	*	*	*	—	*	*	—	*	-
Battery Operation	*	*	*	*	*	*	*	—	*	-
Non-Volatile Memory	—	—	*	—	—	—	—	—	*	-
Hardwire	—	—	*	—	—	—	—	*	*	-
2nd Stage Temp. Differential Setting	—	—	—	—	—	—	—	—	—	-
Keypad Lockout	—	—	—	—	—	—	—	—	—	-

# product features

PRODUCT FEATURES	Touch Me-1	900	901	CVT88	CP1717 Single Stage	CP1818 Single Stage	CP2801 2 Heat/1 Cool	CP2802 2 Heat/2 Cool
Program Options	*	*	*	—	—	—	—	—
Temporary & Permanent Override	*	*	*	—	—	—	—	—
Multi-Stage	*	*	*	—	—	—	*	*
Gas, Oil, Electric System	*	*	*	*	*	*	*	*
Heat Pump System	*	*	*	*	*	*	*	*
Zone Valve	*	*	*	—	—	—	—	—
Millivolt System	*	*	*	—	*	*	*	*
Hardwire with Battery Backup	*	*	*	—	—	*	*	*
Hardwire	*	*	*	*	—	—	*	*
Real-Time Clock	*	*	*	—	—	—	—	—
Auto Changeover	*	*	*	—	—	—	—	—
Auto Recovery	*	*	*	—	—	—	—	—
Auto Programming	*	*	*	—	—	—	—	—
Programming Fan	—	*	*	—	—	—	—	—
Heat Pump Compressor Lockout	—	*	*	—	—	—	*	*
Keypad Lockout	*	*	*	—	—	—	*	*
Dehumidification Control	—	—	*	—	—	—	—	—
Indoor Humidity Sensor	—	—	*	—	—	—	—	—
Outdoor or Indoor Remote Sensor	indoor	*	*	—	—	—	—	—
F/C Temperature Read Out	*	*	*	*	*	*	*	*
Change/Check Reminder	*	*	*	—	*	*	*	*
Adjustable Cycle Rate	—	*	*	—	*	*	*	*
Compressor Short-Cycle Protection	*	*	*	*	*	*	*	*
Backlight	*	*	*	*	*	*	*	*
Front Battery Door	—	—	—	—	*	*	*	*
Quick-Connect Wiring Terminal	*	*	*	*	*	*	*	*
Static Protection	*	*	*	*	*	*	*	*
High/Low Temperature Protection	*	*	*	*	*	*	*	*
Energy Usage Counter	—	—	—	—	—	—	*	*
1st Stage Temp. Differential Rating	*	*	*	—	*	*	*	*
Separate O & B Terminal	—	—	—	—	*	*	*	*
Battery Operation	*	*	*	—	*	*	*	*
Non-Volatile Memory	*	*	*	—	—	—	*	*
2nd Stage Temp. Differential Setting	*	*	*	—	—	—	*	*

PRODUCT FEATURES	CP1719 Single Stage 5+2 days	CP1819 Single Stage 5+2 days	CP1919 Single Stage 7 days	CP1820 Single Stage 7 days	CP2020 Single Stage 7 days	CP2006 Single Stage 7 days	CP2810 2 Heat/1 Cool 7 days	CP2811 2 Heat/2 Cool 7 days	CP2815 2 Heat/2 Cool 7 days
Backlight	*	*	*	*	*	*	*	*	*
Front Battery Door	*	*	*	*	*	*	*	*	*
Quick-Connect Wiring Terminal	*	*	*	*	*	*	*	*	*
Static Protection	*	*	*	*	*	*	*	*	*
F/C Temperature Read Out	*	*	*	*	*	*	*	*	*
High/Low Temperature Protection	*	*	*	*	*	*	*	*	*
Compressor Short-Cycle Protection	*	*	*	*	*	*	*	*	*
Auto Recovery	*	*	*	*	*	*	*	*	*
Filter Check Monitor	*	*	*	*	*	*	*	*	*
4 Periods Temperature Adjustment	*	*	*	*	*	*	*	*	*
Pre-Programmed Set Point	*	*	*	*	*	*	*	*	*
Hold & Override	*	*	*	*	*	*	*	*	*
Energy Usage Counter	—	—	—	—	*	*	*	*	*
5 + 2 Programming	*	*	*	*	*	*	*	*	*
Universal Days or 5 + 2 programming	—	—	*	*	*	*	*	*	*
1st Stage Temp. Differential Rating	*	*	*	*	*	*	*	*	*
Separate O & B Terminal	*	*	—	—	*	*	*	*	*
Gas, Oil, Electric System	*	*	*	*	*	*	*	*	*
Heat Pump System	*	*	—	—	*	*	*	*	*
Millivolt System	*	*	*	*	*	*	*	*	*
Battery Operation	*	*	*	*	*	*	*	*	*
Non-Volatile Memory	—	—	—	—	—	—	*	*	*
Hardwire	—	*	—	—	—	—	*	*	*
2nd Stage Temp. Differential Setting	—	—	—	—	—	—	*	*	*
Keypad Lockout	—	—	—	—	*	*	*	*	*
Remote Sensor	—	—	—	—	—	—	—	—	*
Auto Changeover	—	—	—	—	*	*	*	*	*



# Comfort *stat*™



manufacturer of  
thermostats for residential,  
light commercial &  
commercial applications



## Comfortstat

phone: 866-594-9898 • fax: 305-500-9896

web: [www.comfortstatusa.com](http://www.comfortstatusa.com)

email: [info@comfortstatusa.com](mailto:info@comfortstatusa.com)

We are Proud Sponsors of

Casa  Amor

*Mending Hearts, One Child at a Time*

[www.casaamorvillages.org](http://www.casaamorvillages.org)

## The simple thermostat