

In the Heartland of BioHealth Innovation

Digital Health

Health Research Institutes

Medical Device & Diagnostics

Integrated Health Solutions

Biotech & BioPharma

The CTSI of
Southeast Wisconsin welcomes you
to the 19th Annual Health & Human Services

SBIR/STTR CONFERENCE

November 7 – November 9, 2017

MILWAUKEE, WISCONSIN

HOSTED BY

CTSI | Clinical and Translational Science Institute of Southeast Wisconsin

HHS | Department of Health & Human Services • USA

MCW | Medical College of Wisconsin



HHS



knowledge changing life



New Knowledge Can Change Everything

A single life. An entire community. The future as we know it. That knowledge starts here, at the Medical College of Wisconsin (MCW), where a diverse group of scientists, physicians, students and community partners are working together to rewrite the stories of people everywhere. Through ground breaking discoveries and innovation, we are pioneering pathways to a healthier world.

At MCW, we believe the only way to build a healthier world is to build it together.

Knowledgechanginglife.com

knowledge changing life



WELCOME



SCOTT WALKER
OFFICE OF THE GOVERNOR
STATE OF WISCONSIN

P.O. BOX 7863
MADISON, WI 53707



Scott Walker

Greetings,

As the Governor of Wisconsin, it is my distinct pleasure to welcome each of you to the State of Wisconsin and the City of Milwaukee for the 19th Annual HHS SBIR/STTR Conference hosted by the Clinical and Translational Science Institute of Southeast Wisconsin (CTSI).

Headquartered at the Medical College of Wisconsin, the CTSI is a unique consortium of eight organizations which also includes the Blood Center of WI, Children’s Hospital of WI, Froedtert Hospital, Marquette University, Milwaukee School of Engineering, UW-Milwaukee and the Zablocki VA Medical Center. The CTSI’s mission is to advance the health of our community through research and discovery. The work done by the CTSI institutions profoundly touches many lives by training the next generation of clinical and translational researchers and by providing groundbreaking services to accelerate the translation of discoveries into better health for our citizens.

The State of Wisconsin boasts world class academic and research institutions that attract nearly \$1B in BioHealth research & development funding, offers high quality talent, is ranked 8th best in quality of life by Forbes, is rated a top-ten state for business by Chief Executive magazine and is proud of our robust entrepreneurial spirit, work ethic and natural resources. More than 1,600 Wisconsin BioHealth companies, including medical diagnostics, devices, digital health, healthcare IT, biotechnology and biopharmaceutical companies - are actively moving the State’s economy and innovative healthcare solutions Forward. In 2016, Wisconsin earned a total of \$422M in NIH funding, and our BioHealth businesses attracted \$14M in valuable SBIR/STTR funding. We are working and winning for Wisconsin, the Heartland and the Nation.

We are delighted that you are our guests. I send my best wishes to all of you for a fruitful conference and hope that you enjoy the marvelous experiences that can only be found in the Heartland of BioHealth Innovation and the great State of Wisconsin.

Sincerely,

Scott Walker, Governor

OFFICE OF THE GOVERNOR
P.O. BOX 7863
MADISON, WI 53707
608-266-1212

TABLE OF CONTENTS

INTRODUCTIONS

Welcome Letters.....	3-5
Conference Hosts	6
CTSI	7

CONFERENCE INFORMATION

Logistical Information	8-9
------------------------------	-----

ONE ON ONES

10-11

KEYNOTE SPEAKERS

Dr. Walter Koroshetz	12
----------------------------	----

CONFERENCE SCHEDULES

Conference at a Glance	13
Tuesday.....	14-15
Wednesday	16-17
Thursday.....	18
Maps	19
Sponsors	20

WELCOME REMARKS



John R. Raymond, Sr., MD President and CEO Medical College of Wisconsin

John R. Raymond, Sr., MD, the Medical College of Wisconsin's (MCW) President and CEO assumed his new position as MCW's sixth President on July 1, 2010. He was previously Vice President for Academic Affairs and Provost at the Medical University of South Carolina (MUSC). Dr. Raymond leads Wisconsin's only private medical school with an operating budget of approximately \$1.1 billion. More than one out of every three Wisconsin physicians is an alumnus of MCW. With approximately 5,650 faculty and staff members, MCW is the eighth largest private employer in Metro Milwaukee.

Under Dr. Raymond's leadership, MCW is addressing Wisconsin's pending physician shortage through the establishment of regional medical school campuses, and training pharmacists with a new School of Pharmacy.

A practicing nephrologist who plays active roles in clinical care, teaching and faculty mentorship, Dr. Raymond is a peer-designated Best Doctor,[®] he has published more than 140 full-length manuscripts and earned nearly \$40 million of grant funding over his career. He received his undergraduate and medical degrees with honors from the Ohio State University, and performed his internship, residency, chief residency and nephrology fellowship training at Duke University Medical Center where he rose through the ranks to attain tenure. Dr. Raymond serves on the Boards of the United Way of Greater Milwaukee and Waukesha County and the BloodCenter of Wisconsin's Blood Research Institute. He is Past President of the Board of the American Heart Association of Metro Milwaukee and has served on the editorial boards of prestigious journals. Dr. Raymond has received many awards for excellence in leadership, research, mentorship, service, diversity, teaching and clinical care.



Mayor Tom Barrett

Tom Barrett was elected Milwaukee's 40th Mayor on April 6, 2004, and has been reelected with over 70% of the vote in 2008, 2012 and 2016. As Milwaukee's Chief Executive, Tom Barrett is making neighborhoods safer by strengthening public safety services, targeting gangs and illegal guns and forging partnerships with neighborhood organizations. He is a founding member of Mayors Against Illegal Guns.

Mayor Barrett continues to strengthen the City's economy by creating family-supporting jobs and provide assistance to entrepreneurs. He is creating hope in the lives of young people throughout the city with a number of workforce initiatives, including his Earn & Learn initiative which has placed nearly 20,000 students in summer jobs.

Mayor Barrett has enacted his vision for a more sustainable Milwaukee by establishing the Office of Environmental Sustainability, which promotes cost-effective sustainability practices that meet Milwaukee's environmental, economic and social needs while enhancing economic growth. He is also one of the region's greatest champions for the Great Lakes and is the past Chair of the Great Lakes St. Lawrence Cities Initiative, a binational organization comprised of local officials actively working to protect and restore the Great Lakes and the St. Lawrence River. The Mayor is recognized as a national leader on stormwater mitigation, sustainable manufacturing and urban agriculture.

Tom Barrett grew up on Milwaukee's West side, graduated college and law school from the University of Wisconsin-Madison, was a member of both the Wisconsin State Assembly and Senate and served five terms in the U.S. Congress.



County Executive Chris Abele

Chris Abele is bringing a new form of leadership to Milwaukee County and Wisconsin, redefining what government can be. He was first elected Milwaukee County Executive on April 4, 2011 and most recently re-elected on April 5, 2016. By combining social responsibility and fiscal discipline, County Executive Abele has lowered the County's deficit by more than \$70 million while strengthening critical safety net services like public transportation, child support and mental health care.

For more than two decades, Abele has been a highly successful business owner. He currently runs a growing real estate company, CSA Commercial, and venture fund, CSA Partners. Chris is a dedicated philanthropist focused on empowering others. For nearly 20 years, his volunteer work has included serving on and leading numerous local, national and international nonprofit boards, including Boys & Girls Clubs of America, Schools that Can-Milwaukee, and the Carr Center for Human Rights Policy at Harvard University. County Executive Abele is proud to live in Milwaukee and has three young daughters.

WELCOME FROM THE NIH

National Institutes of Health

Welcome to the 19th Annual HHS Small Business Innovation Research (SBIR) and Small Business Technology Transfer (STTR) Conference! We are pleased to be in Milwaukee and have nearly 100 federal staff available to learn about your innovative ideas.

The agenda is packed with information about the SBIR/STTR programs, recent policies, strategies for developing a successful Phase I and Phase II application, the suite of programs available to you beyond the SBIR/STTR awards, and tips from successful entrepreneurs.

We strongly encourage you to set up a one-on-one meeting with us! Representatives from the National Institutes of Health (NIH), Centers for Disease Control and Prevention (CDC), Food and Drug Administration (FDA), Administration for Community Living (ACL), and HHS Office of the Inspector General (OIG) will be available to provide guidance about your proposal and answer specific questions. We are also pleased to welcome our program manager colleagues from the National Aeronautics and Space Administration (NASA) SBIR/STTR programs.

Please don't be shy! Maximize your opportunity and ask us lots of questions.

Thank you for attending, and we look forward to a productive and informative conference.

Sincerely,
Matthew E. Portnoy, PhD
Director, Division of Special Programs
NIH SBIR/STTR Program Coordinator
Office of Extramural Research
National Institutes of Health



Host Planning Committees

Kalpa Vithalani, Host, Conference Chair, MCW
Pam Jung, Host, Conference Project Manager, MCW
Zeeshan Afsal, MCW
Kurstin Bauer, MCW
Rachel Best, Wisconsin Economic Development Corporation
Holly Botsford, MCW
Jenny Broecker, UW Extension
Emily Connors, MCW
Pat Dillon, MN-SBIR, Minnesota High Tech Association
Katherine Durben, Marquette University
Orsolya Garrison, MCW
Michael Harrison, BioForward
Kathy Heady, Wisconsin Economic Development Corporation
John Imig, MCW
Michelle Johnson, UW-Milwaukee
Katherine July, MCW
Ashley Kleibor, Smith & Gesteland
Kelly Lietz, Wisconsin Economic Development Corporation
Lisa Liljigram, Concordia University
David Linz, Center for Technology Commercialization
Mark Maley, Wisconsin Economic Development Corporation
Joseph Miotke, DeWitt Ross & Stevens
Jeanan Yasisri Moe, Wisconsin Alumni Research Foundation
Margaret Ramey, Center for Technology Commercialization
Kate Rodgers, BioForward
Carmel Ruffolo, Marquette University
Jennifer Russell, Marquette University
Audrey Salazar, UW-Milwaukee Research Foundation
Laura Savatski, BloodCenter of Wisconsin
Brittney Schultz, Wisconsin Economic Development Corporation
Daniel Sem, Concordia University
Jessica Silvaggi, UW-Milwaukee Research Foundation
Fay Spano, BloodCenter of Wisconsin
Todd Strother, Center for Technology Commercialization
Ranjit Verma, MCW
David Volz, Wisconsin Economic Development Corporation
Doriel Ward, MCW
Amanda Wegner, Wisconsin Economic Development Corporation
Jeri Lynn Wehner, MCW
Wujie Zhang, Milwaukee School of Engineering

2017 NIH SBIR/STTR Conference Planning Committees

NIH Planning Committee Robert Vinson,
Chairperson Office of Extramural Research

Patricia Swayne
Office of Extramural Research

Mindy Bixby
National Institute of Child Health and Human Development

Kristopher Bough
National Institute on Drug Abuse

Pam Clark
National Institute of Environmental Health Sciences

Cathleen Cooper
Center for Scientific Review

Augie Diana
National Institute of Nursing Research

Stephanie Fertig
National Institute of Neurological Disorders and Stroke

Joseph Gindhart
National Institute of General Medical Sciences

J.P. Kim
Office of Extramural Research

Phyllis Mitchell
National Heart, Lung, and Blood Institute

Matthew Portnoy
Office of Extramural Research

Jacquelyn Saval
National Cancer Institute

Vincent Thomas
National Institute on Minority Health and Health Disparities



Reza Shaker, MD

*Senior Associate Dean & Director
Clinical & Translational Science Institute
Joseph E. Geenen Professor & Chief,
Division of Gastroenterology & Hepatology
Medical College of Wisconsin*



Kalpa Vithalani, PhD

*Licensing Manager
Office of Technology Development
Medical College of Wisconsin
Host, Conference Chair*



knowledge changing life

Welcome Message from Conference Hosts: Dr. Reza Shaker and Dr. Kalpa Vithalani

On behalf of the Clinical & Translational Science Institute of Southeast Wisconsin (CTSI) and the Medical College of Wisconsin (MCW), we welcome each of you to the 19th Annual HHS Small Business Innovation Research (SBIR) and Small Business Technology Transfer (STTR) Conference. The CTSI and its partner institutions; the Medical College of Wisconsin, Marquette University, University of Wisconsin- Milwaukee, Milwaukee School of Engineering, Blood Center of Wisconsin, Froedert Health, Children's Hospital of Wisconsin and the Milwaukee Veteran's Medical Center and the State of Wisconsin are proud and pleased to be a destination for innovators.

This is an extraordinary opportunity for innovators across the Heartland and the nation to meet one-on-one with nearly 100 Program Managers from most of NIH's Institutes and Centers, get specific questions answered, meet like-minded investigators, entrepreneurs, investors, and business partners, and learn how to submit successful SBIR/STTR grant applications.

The goal of the SBIR/STTR program synergizes well with the CTSI's mission. We will advance the health of our communities through research and discovery as we increase private-sector commercialization of innovations derived from federal funding. Non-dilutive SBIR/STTR seeds funds will enable innovators and small businesses to move efficiently from ideation to commercialization.

We are excited to showcase our strengths and opportunities, hear the ideas of other innovators and spark productive collaborations. Together, let us connect the translational research engine with the commercialization locomotive, tap into America's Largest Seed Fund and accelerate the translation of discoveries into cutting-edge healthcare solutions.

We wish to thank each of our sponsors, Conference committee members, guests, esteemed speakers, volunteers, as well as the Department of Health and Human Services. We personally invite you, and hope you will take the opportunity to visit our website at ctsi.mcw.edu to sign up to become a CTSI Community Partner.

Sincerely,

Reza Shaker, MD
Kalpa Vithalani, PhD



CLINICAL AND TRANSITIONAL SCIENCE INSTITUTE *of Southeast Wisconsin*

Who We Are...

The Clinical & Translational Science Institute (CTSI) of Southeast Wisconsin represents a unique and transformative collaboration between the Medical College of Wisconsin (MCW), Froedtert Hospital, Children's Hospital of Wisconsin, BloodCenter of Wisconsin, Zablocki VA Medical Center, Marquette University, University of Wisconsin-Milwaukee, and the Milwaukee School of Engineering (MSOE). Headquartered at MCW, the composition of the CTSI is unique nationally because of the engagement of diverse academic SE Wisconsin institutions. Our eight-member consortium creates a borderless, synergistic biomedical research enterprise, works collaboratively across all institutions and translates research discoveries into new diagnostics, treatments, therapeutic interventions and outcomes that are better, faster, and more economical. The CTSI is one of sixty-two recipients of the National Institutes of Health (NIH) Clinical & Translational Science Award (CTSA), and is functionally integrated into the regional and national CTSA network.

Our Mission...

The mission of the CTSI is advancing the health of our community through research and discovery.

What We Do...

The CTSI is dedicated to transforming the biomedical research enterprise throughout southeast Wisconsin by advancing patient care and education through the facilitation of translational research, i.e. from the laboratory bench to the patient bedside, and into the community. The CTSI offers expertise in medicine, nursing, dentistry, engineering, social sciences, pharmacology, and allied health for both research and educational/career development. Additionally, the CTSI provides opportunities for trainees and faculty at all levels to evolve into active investigators through participation in inter-institutional and inter-disciplinary team research.

Our Principles...

Collaboration – Leverage resources to enhance inter-disciplinary clinical and translational research

Transformation – Foster innovation among institutions & contributions to clinical and translational science

Facilitation – Provide resources to develop, implement & disseminate clinical and translation.

Education – Train clinicians and basic scientists in the discipline of clinical and translational science.



For additional information please contact:
Clinical & Translational Science Institute (CTSI)
8701 Watertown Plank Road
Milwaukee, WI 53226
(415) 955-8200 | ctsi.mcw.edu

CONFERENCE INFORMATION

REGISTRATION DESK

The registration desk is located on the 4th Floor, between the grand staircase and the elevators. The registration desk will be open at the following times:
Tuesday..... 7:00 a.m. - 5:00 p.m.
Wednesday..... 7:30 a.m. - 4:30 p.m.
Thursday 7:30 a.m. - 4:00 p.m.

NAME BADGES

For security purposes, delegates, speakers, and exhibitors are asked to wear their name badges to the sessions, meals, and reception. Entrance into sessions is restricted to registered delegates only.

WIRELESS INTERNET ACCESS

Complimentary WiFi is available. Please select WiFi Connection **HHonorsConference**. No password is required.

EXHIBITORS

Exhibit tables will be located on the 4th floor outside of the Wright Ballroom, and on the 5th floor outside of the Crystal Ballroom.

SPEAKERS

Please ensure you are available in your presentation room at least 15 minutes prior to the start of the session.

CATERING

A continental breakfast and lunch will be served daily in the Crystal Ballroom. Afternoon refreshments will also be served by the registration table.

NETWORKING RECEPTION

The networking reception will take place on Tuesday, November 7th from 5:00 - 7:00 p.m. in the Crystal Ballroom, 5th floor. Enjoy Milwaukee's own Charles Walker Band.

SOCIAL MEDIA

The conference hashtag is **#SBIRMKE**

CONFERENCE APP

Download the EventMobi-2017 HHS SBIR/STTR Conference APP which is available for iOS and Android devices on the APP store. Enter Code: **NIH-SBIR-MKE**

[See Speaker Bios](#)

[See Descriptions of Conference Sessions](#)

[Create Personal Schedule](#)

[Get Social & Network](#)

<https://eventmobi.com/nih-sbir-mke/>



**POSSIBILITIES
BECOME REALITIES**
THINK·MAKE·HAPPEN IN WISCONSIN



In Wisconsin, you're free to **think** bigger, encouraged to **make** your mark, and poised for great things to **happen**. Our culture and traditions fuel discovery and create opportunities for personal and professional fulfillment.

Follow Think-Make-Happen In Wisconsin on:     

PARKING

The Hilton Milwaukee City Center offers guests and visitors convenient, covered parking attached to the hotel. Daily self-parking is \$25/day. Guests that have reserved a hotel room under the conference room block will be charged \$15/day for parking. Please enter the parking structure using the entrance on N. 5th Street and Michigan.

PHOTOGRAPHY: During this event, we may capture photos that will solely be used for the aims of the Clinical and Translational Science Institute and Community Engagement.

VIDEOTAPING: During this event, we may capture video of the presentation and a selection of interactions between the audience and speaker. The video may be posted on various web resources, in presentations, or other educational opportunities that will solely be used for the aims of the Clinical and Translational Science Institute and Community Engagement.

BROADCASTING: During this event, we may stream the presentation and interactions between the audience and speaker. Only those in attendance (speaker and audience) will be able to view the interactions.

By attending this event, your consent for photos, videos, or broadcasting is implied. If you do not wish to be in photos, videos, or broadcasting please inform a staff or faculty member when checking in at the registration table.

PUBLICATION OR WHITE PAPER:

The themes that come from this event could be used in possible future publications or white papers. No direct quotations or identifiable information will be used for publication.

This event has not been funded in whole or in part with Federal funds from the Department of Health and Human Services and/or the National Institutes of Health.



business planning & accounting

YOU DO THE TECHNOLOGY. WE'LL DO THE REST.

Are you looking for advisors that can help with tax, accounting and consulting services unique to early stage technology companies? We are the local experts that can help manage your business so you can focus on technology.

S&G Smith & Gesteland^{LLP}
accountants & consultants
FOCUS ON WHAT MATTERS

MADISON, WISCONSIN
www.sgcpa.com

WANDA BIRD
608.828.3120
wanda.bird@sgcpa.com

ASHLEY KLEIBOR, CPA
608.828.3130
ashley.kleibor@sgcpa.com

ONE-ON-ONES

SBIR Program Managers from the National Institutes of Health will be present to meet with attendees and discuss federal resources, biotech research and development, and details of NIH the SBIR/STTR program. Registered attendees will be able to sign up for sessions in advance of the conference online and on-site for no more than 5 slots across all agencies, institutes, and centers. Appointments are first-come, first-served.

One-on-Ones will be held during the following times:

Tuesday, November 7th 1:00 p.m. - 4:50 p.m.	4th Floor Conference Rooms
Wednesday, November 8th 8:00 a.m. - 4:50 p.m.	4th Floor Conference Rooms
Thursday, November 9th 8:00 a.m. - 4:50 p.m.	4th Floor Conference Rooms

NIH Institutes/Centers Participating in One-on-One Sessions

All conference rooms are located on the 4th floor

MACARTHUR CONFERENCE ROOM

National Institute on Aging
National Institute on Alcohol Abuse and Alcoholism
National Institute of Allergy and Infectious Diseases
National Institute of Arthritis and Musculoskeletal and Skin Diseases

MITCHELL CONFERENCE ROOM

National Institute of Biomedical Imaging and Bioengineering
National Cancer Institute
National Institute of Child Health and Human Development
National Institute on Drug Abuse
National Institute of Dental and Craniofacial Research

WALKER CONFERENCE ROOM

National Institute of Diabetes and Digestive and Kidney Diseases
National Institute of Environmental Health Sciences
National Eye Institute
National Institute of General Medical Sciences
National Heart, Lung, and Blood Institute
National Institute of Mental Health
National Institute on Minority Health and Health Disparities
National Institute of Neurological Disorders and Stroke
National Institute of Nursing Research

PABST CONFERENCE ROOM

National Center for Advancing Translational Sciences
National Center for Complementary and Integrative Health
Division of Program Coordination, Planning and Strategic Initiatives, Office of Research Infrastructure Programs (ORIP)

MILLER CONFERENCE ROOM

Centers for Disease Control and Prevention (CDC)
Food and Drug Administration (FDA)
Center for Scientific Review (CSR)
Office of Laboratory Animal Welfare (OLAW)

SCHLITZ CONFERENCE ROOM

Office of the National Coordinator for Health Information Technology (ONC)
Research Involving Human Subjects
Indirect Cost Branch
Intellectual Property and Requirements iEdison Invention Report

USINGER CONFERENCE ROOM

The National Aeronautics and Space Administration (NASA)
Research Portfolio Online Reporting Tools (RePORT)
Research Integrity
Clinical Trials

INNOVATION MEANS BUSINESS

From Feasibility to Funding

The Center for Technology Commercialization works with innovators throughout Wisconsin.

Our programs include:

- » SBIR Ready — Quick course
- » SBIR Advance — Matching grants
- » IDeaFund — UW System Seed Fund
- » Microgrants — Early funding

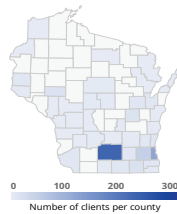

Boosting Wisconsin in...



wisconsinctc.org



Part of the UW-Extension Division for Business & Entrepreneurship

Our **Biorepository and Specimen Resource Center** collects, processes, stores and distributes biospecimens from consenting research participants, allowing investigators to advance innovative research to improve outcomes in cancer, heart disease, neurological disorders and other ailments more quickly and easily.

TO REQUEST BIOSPECIMENS:

- Email bsrc@aurora.org
- Call 414-646-0677

aurora.org/research





KEYNOTE SPEAKERS



Dr. Walter Koroshetz

DR. WALTER KOROSHETZ

Walter J. Koroshetz, M.D. was selected Director of the National Institute of Neurological Disorders and Stroke (NINDS) in 2015. Dr. Koroshetz joined NINDS in 2007 as Deputy Director, and he served as Acting Director from October 2014 through June 2015. He has held leadership roles in a number of NIH and NINDS programs including the NIH's BRAIN Initiative, the Traumatic Brain Injury Center collaborative effort between the NIH intramural program and the Uniformed Health Services University, and the multi-year work to develop and establish the NIH Office of Emergency Care Research to coordinate NIH emergency care research and research training.

Before joining NINDS, Dr. Koroshetz served as Vice Chair of the neurology service and Director of stroke and neurointensive care services at Massachusetts General Hospital (MGH). He was a professor of Neurology at Harvard Medical School (HMS) and led neurology resident training at MGH between 1990 and 2007. Over that same period, he co-directed the HMS Neurobiology of Disease Course with Drs. Edward Kravitz and Robert H Brown.

A native of Brooklyn, New York, Dr. Koroshetz graduated from Georgetown University and received his medical degree from the University of Chicago. He trained in internal medicine at the University of Chicago and Massachusetts General Hospital. Dr. Koroshetz trained in neurology at MGH and later at the Harvard neurobiology department. A major focus of his clinical research career was to develop measures in patients that reflect the underlying biology of their conditions.



Tommy G. Thompson

TOMMY G. THOMPSON

Tommy G. Thompson currently is the Chairman and Chief Executive Officer of Thompson Holdings, and former United States Health and Human Services (HHS) Secretary and four-term Governor of Wisconsin. Following his term in public office, he built, and continues to build with his work at Thompson Holdings, on his efforts as HHS Secretary and Governor to develop innovative solutions to the health care challenges facing American families, businesses, communities, states and the nation as a whole. These efforts focus on improving the use of information technology in hospitals, clinics and doctors' offices; promoting healthier lifestyles; strengthening and modernizing Medicare and Medicaid; and expanding the use of medical diplomacy around the world.

From 2005 until 2009, Governor Thompson served as a senior advisor at the consulting firm Deloitte LLP and was the founding independent chairman of the Deloitte Center for Health Solutions, which researches and develops solutions to some of our nation's most pressing health care and public health related challenges. From 2005 to early 2012, Governor Thompson served as a senior partner at the law firm of Akin, Gump, Strauss, Hauer, & Feld LLP. Governor Thompson served as Chairman of the Board of Directors of Logistics Health, Inc. from January 2011 to May 2011, and served as President from February 2005 to January 2011.

He currently serves on the Board of Directors of the following public companies: Physicians Realty Trust and TherapeuticsMD, Inc, as Chairman of the Board of Directors, Centene Corporation, C.R. Bard, Inc., and United Therapeutics Corporation.

In the Heartland of BioHealth Innovation



Program Sessions: Empire - Lobby Level, Wright - 4th Floor, Regency - 5th Floor
 One-on-Ones: 4th Floor break out rooms - please see signage

TUESDAY, NOVEMBER 7

7:00 – 8:00 am	Continental Breakfast, and Networking	Crystal Ballroom - 5th Floor
8:00 – 9:25 am	Welcome and Keynote Speaker Dr. Walter Koroshetz	Crystal Ballroom - 5th Floor
9:30 – 10:15 am	HHS Overview and Update	Crystal Ballroom - 5th Floor
10:20 – 11:25 am	Plenary Sessions	Crystal Ballroom - 5th Floor
11:30 – 12:50 pm	Lunch & Plenary Session	Crystal Ballroom - 5th Floor
1:00 – 4:50 pm	Breakout Sessions	
5:00 – 7:00 pm	Networking Reception	Crystal Ballroom - 5th Floor

WEDNESDAY, NOVEMBER 8

7:00 – 8:00 am	Continental Breakfast & Plenary Session	Crystal Ballroom - 5th Floor
8:00 – 11:50 am	Breakout Sessions	
12:00 – 12:50 pm	Lunch & Plenary Session	Crystal Ballroom - 5th Floor
1:00 – 4:50 pm	Breakout Sessions	
5:00 – 9:00 pm	Healthcare Innovation Pitch Event	Crystal Ballroom - 5th Floor

THURSDAY, NOVEMBER 9

7:00 – 8:00 am	Continental Breakfast & Plenary Session	Crystal Ballroom - 5th Floor
8:00 – 11:50 am	Breakout Sessions	
12:00 – 1:50 pm	Lunch & Plenary Session	Crystal Ballroom - 5th Floor
2:00 – 4:50 pm	Breakout Sessions	

Conference Gold Sponsors



AGENDA | TUESDAY, NOVEMBER 7

7:00 am	REGISTRATION OPENS			
7:00 – 8:00 am	CONTINENTAL BREAKFAST AND NETWORKING			
8:00 – 8:30 am	Welcome Remarks <i>Dr. Kalpa Vithalani, Dr. John Raymond, Sr., President & CEO, MCW. Dr. Reza Shaker, Director, CTSI, Tom Barrett, Milwaukee Mayor, Chris Abele, Milwaukee County Executive</i>			
8:35 – 9:25 am	KEYNOTE SPEAKER <i>Dr. Walter Koroshetz, Director, National Institute of Neurological Disorders and Stroke (NINDS)</i>			<i>Keynote</i> 
9:30 – 10:15 am	“HHS Overview and Update” <i>Matthew Portnoy, SBIR/STTR Program Coordinator, Director of the Division of Special Prog, Office of Extramural Research(OER)</i>			
10:20 – 11:25 am	“Getting from Submission to Review” <i>Cathleen Cooper, Director, Division of Receipt & Referral (DRR), NIH Center for Scientific Review (CSR)</i>			
	“The Review Process” <i>Gagan Pandya, Scientific Review Officer, NIH Center for Scientific Review (CSR)</i>			
11:30 – 12:50 pm	LUNCH – “Reducing Anxiety: Getting to Know the OIG” <i>Les Hollie, Assistant Inspector General for Investigations within HHS, Office of Inspector General (OIG)</i>			
BALLROOMS:	WRIGHT	EMPIRE	REGENCY	ONE-ON-ONES
1:00 – 1:50 pm	Advice to Applicants from Program Staff: Making the Most of the Conference <i>Stephanie Fertig, Patricia Weber, Lili Portilla, Miguel Contreras</i>	Protecting Your Intellectual Property* <i>Scott Cooper</i>	Compliance and Stewardship of Federal Funds* <i>Kathy Hancock</i>	<i>Federal Staff</i>
2:00 – 2:50 pm	Resources for Women and Minority Owned Businesses <i>Stephanie Fertig, Sandra Jones</i>	FDA Regulatory Basics for Small Businesses* <i>Chris Sasiela</i>	NIH Resources for Small Business Success <i>Phyllis Mitchell, Lili Portilla, Gary Robinson & Athan Kuliopulos</i>	<i>Federal Staff</i>
3:00 – 3:50 pm	Lessons Learned from Successful Companies: Navigating Application & Commercialization <i>Stephanie Fertig, Laverne Carter, Dianne Goodwin, Lisa McKerracher</i>	Successfully Submitting a Small Business Grant Application Using ASSIST* <i>Sheri Cummins</i>		<i>Federal Staff</i>
4:00 – 4:50 pm	Research Involving Animals* <i>Eileen Morgan</i>	Using NIH’s RePORT to Your Advantage <i>Sheri Cummins</i>	Ins and Outs of Incubators and Accelerators <i>Jessica Silvaggi, Arun Bhatia, Tom Denison, Mark Liber, Abby Taubner</i>	<i>Federal Staff</i>
5:00 – 7:00 pm	NETWORKING RECEPTION – Milwaukee’s Own Charles Walker Band			

* Repeat Sessions / Agendas are subject to change. Please use conference app for up-to-date information.



Creating an efficient, effective and easy to use health experience.



A proud supporter of the 19th Annual HHS SBIR/STTR Conference. www.dohmen.com



Creating
technology that
transforms health



HORIZON

Learn more www.redarrowlabs.com



We are a proud sponsor of the
**19th Annual Department of
Health and Human Services
SBIR/STTR Conference**

**YOUR GO-TO
INTELLECTUAL
PROPERTY
FIRM.**

Boston, MA | New York, NY

Follow Us: [in](#) [t](#)

www.wolfgreenfield.com

AGENDA | WEDNESDAY, NOVEMBER 8

7:00 – 8:00 am	CONTINENTAL BREAKFAST – “Dynamic Women Leaders” <i>Kathleen Gallagher, Exec. Dir, Milwaukee Institute; Lisa Johnson, CEO, BioForward; Kathy Koshgarian, CPO, Dohmen Life Science Services; Dr. Zhu Li, GM CT Engineering GEHC; Dr. Kelly Piacsek, Aurora VP of Patient-Centered Research</i>			
BALLROOMS:	WRIGHT	EMPIRE	REGENCY	ONE-ON-ONES
8:00 – 8:50 am	Indirect Cost Rates and Accounting System Workshop <i>Hruta Virkar, Dan Milstead & Kyle Kroneberger</i>	FDA Regulatory Basics for Small Businesses* <i>Chris Sasiela</i>	Research Integrity and the NIH* <i>Patricia Valdez</i>	<i>Federal Staff</i>
9:00 – 9:50 am		Planning for Phase III: Networking <i>Kristopher Bough, Augie Diana, JoAnne Robbins & Eric Horler</i>	Follow Just-in-Time Procedures to Get Your Award Faster* <i>Mindy Bixby</i>	<i>Federal Staff</i>
10:00 – 10:50 am	Commercialization Assistance Programs: I-Corps, Niche, and CAP <i>Lili Portilla, Rob Vinson, J.P. Kim, & Maureen Mulvihill</i>		Building an Effective Team <i>Todd Strother, Sandra Cochrane, Tom Mozer, Loren Peterson, Kurt Waldhuetter</i>	<i>Federal Staff</i>
11:00 – 11:50 am		NIH Clinical Trials Update: “Putting it All Together” <i>Sherry Mills</i>	Centers for Disease Control and Prevention – SBIR Program <i>Sean David Griffiths</i>	<i>Federal Staff</i>
12:00 – 12:50 pm	LUNCH – Wisconsin SBIR Success Story, Dr. Lynn Allen-Hoffmann <i>Former Wisconsin Governor & 19th HHS Secretary, Tommy Thompson</i>			<i>Keynote</i> 
1:00 – 1:50 pm	Phase I Proposal Development <i>Lisa Kurek</i>	Writing Your Phase II Commercialization Plan* <i>Gary Robinson</i>	Compliance and Stewardship of Federal Funds* <i>Kathy Hancock</i>	<i>Federal Staff</i>
2:00 – 2:50 pm		Opportunities for Eliminating Health Disparities <i>Xinzhi Zhang</i>	Digital Health: From Passion to Profit <i>Rohit Shukla, Bobby Peterson, Bill Tan, Maureen Mulvihill & Vince Thomas</i>	<i>Federal Staff</i>
3:00 – 3:50 pm	FDA – Center for Drug Evaluation & Research Small Business & Industry Assistance <i>Renu Lal</i>	Downstream Funding Opportunities <i>David Linz, David Klick, Mike Krenzke, Fred Kron, Ray Takigiku</i>	Digital Health: The Building Blocks for Success <i>Rohit Shukla, Bobby Peterson, Bill Tan, Maureen Mulvihill & Vince Thomas</i>	<i>Federal Staff</i>
4:00 – 4:50 pm	FDA – Regulatory Requirements: Devices* <i>William Heetderks</i>	NASA Space Technology Directorate <i>Joseph Grant</i>	Prepare for VC Questions <i>Dan Sem, Giovanni Ferrara, Allen Hakimi, John Torinus & Paul Weiss</i>	<i>Federal Staff</i>
5:00 – 9:00 pm	NETWORKING RECEPTION – Healthcare Innovation Pitch Event			

* Repeat Sessions / Agendas are subject to change. Please use conference app for up-to-date information.



**UNIVERSITY
RESEARCH PARK**
UNIVERSITY OF WISCONSIN-MADISON

Where Wisconsin IDEAS Flourish

University Research Park is a neighborhood of ideas, entrepreneurship, and opportunity, positively impacting Wisconsin and beyond.



info@urp.wisc.edu • (608) 441-8000

www.universityresearchpark.org



Image © Board of Regents of the University of Wisconsin System

Helping UW-Madison *improve* the World

Since 1925, WARF has been investing in research at the University of Wisconsin-Madison, partnering with companies all over the world to help the landmark discoveries of the university improve the lives of millions.

From new ways of combatting bacteria to technologies that lead to faster, greener and more powerful computers, from long-lasting, reliable batteries to improved tools for scientists and physicians, WARF helps innovations from across campus benefit the world.



INVESTING IN RESEARCH, MAKING A DIFFERENCE.



Stay Curious

Innovation is on the next horizon.
Thank you for supporting the
curiosity that will take us there.



Outside In. Inside Out.

Whether fighting a business dispute or negotiating a deal, our deep industry focus has a direct bearing on the ultimate outcome. It also, in turn, gives us the perspective to see your industry through your eyes from the inside out.

Austin, TX	Manitowoc, WI	Raleigh, NC
Chicago, IL	Midvale, UT	Salt Lake City, UT
Denver, CO	Milwaukee, WI	Washington, D.C.
Madison, WI	Missoula, MT	Waukesha, WI

michaelbest.com
Michael Best & Friedrich LLP

AGENDA | THURSDAY, NOVEMBER 9

7:00 – 8:00 am

CONTINENTAL BREAKFAST – “What Technology Means to the Healthcare Industry in Wisconsin & Beyond” *Dr. Johnathan Truwit, Enterprise CMO, Froedtert & MCW; Michael Barbouche, CEO Forward Health Group; Eric Haberichter, CEO Access Health;*

BALLROOMS:

WRIGHT

EMPIRE

REGENCY

ONE-ON-ONES

8:00 – 8:50 am

Phase II Proposal Development
Lisa Kurek

Finding and Understanding Funding Opportunity Announcements
Michelle Timmerman

Lessons Learned by Wisconsin Companies
Pat Dillon, Brian Armstrong, Ray Harter, Brian Volkman

Federal Staff

9:00 – 9:50 am

FDA – Regulatory Requirements: Devices*
Anita Nosratieh

Planning for Phase III: Strategic Partnering
Augie Diana, Kristopher Bough, JoAnne Robbins & Eric Horler

Ins and Outs of SBIR Contracts and Grants
Xing-Jian Lou & Andre Walker

Federal Staff

10:00 – 10:50 am

Research Integrity and the NIH*
Patricia Valdez

Managing Your SBIR/STTR Costs
Ashley Kleibor, Wanda Bird & Cheryl Vickroy

Human Research Protections in NIH SBIR/STTR Applications
Petrice Brown-Longenecker

Federal Staff

11:00 – 11:50 am

12:00 – 1:50pm

LUNCH – “Mock Peer Review Study Section”

Kristopher Bough, Cathleen Cooper, Augie Diana, Stephanie Fertig, Gagan Pandya, Joe Gindhart, Xinzhi Zhang

2:00 – 2:50 pm

Research Involving Animals*
Eileen Morgan

Innovative Practices for Institutional Review Boards
David Clark, AnnMarie Eve & Ryan Spellecy

Partnering with the NIH: Technology Transfer
Jennifer Wong & Chang Hee Kim

Federal Staff

3:00 – 3:50 pm

Writing Your Phase II Commercialization Plan*
Gary Robinson

Protecting Your Intellectual Property*
Scott Cooper

Follow Just-in-Time Procedures to Get Your Award Faster*
Mindy Bixby

Federal Staff

4:00 – 4:50 pm

Successfully Submitting a Small Business Grant using ASSIST*
Sheri Cummins

Actually, You Do Need Lawyers So Pick the Right Ones
Mark Ehrmann, Paul Jones, Janice Vatland

Office of the National Coordinator for Health Information Technology
Stephen Konya

Federal Staff

* Repeat Sessions
10/27/17

Conference Silver Sponsors



FLOOR PLANS

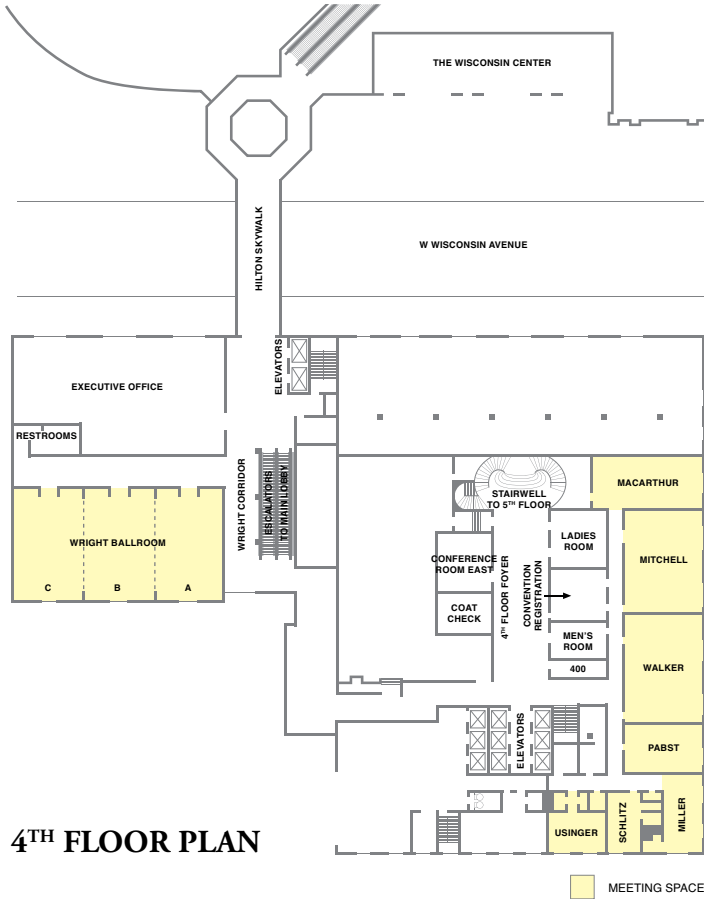

4TH FLOOR PLAN

5TH FLOOR PLAN

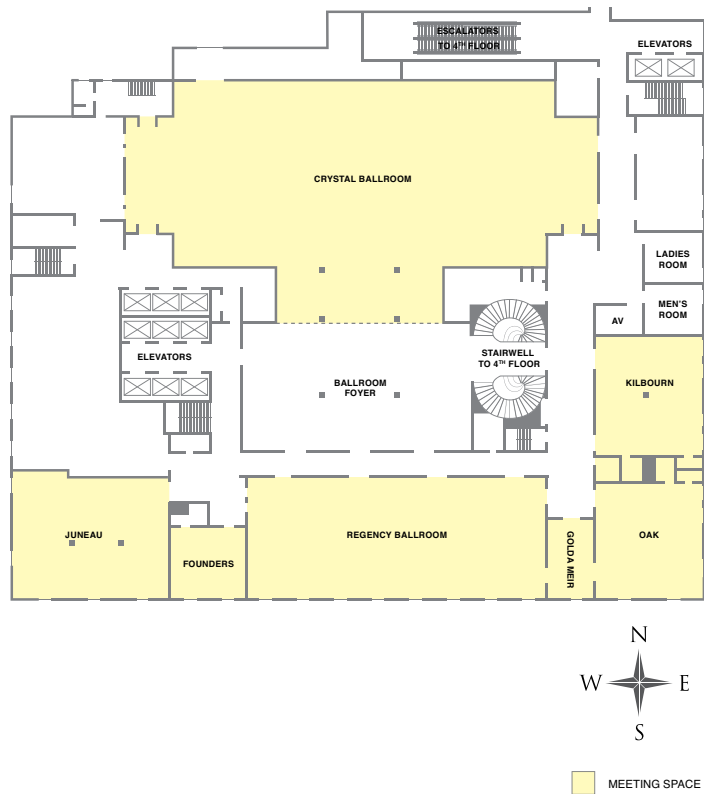

To learn more about what the law firm of Quarles & Brady can do for you, contact **Mark T. Ehrmann, Partner** at **608.283.2479** or **mark.ehrmann@quarles.com**.



**WE WISH TO
THANK ALL
OUR SPONSORS FOR
2017 HHS SBIR/STTR
CONFERENCE**

GOLD SPONSORS



knowledge changing life

SILVER SPONSORS



BRONZE SPONSORS



WISCONSIN:

Better BioHealth Businesses are Built Here

