

North American English

PARTS INCLUDED

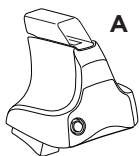

A

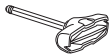

B



C



D



E

part	description	part number	480 qty.	4802 qty.
A	Rapid Traverse foot	7522249001	4	2
B	AcuTight tool	7522352002	2	1
C	tensioning bolt plug	8526446001	2	1
D	tape measure	—	1	1
E	endcap	8533593	4	2

WARNINGS / LIMITATIONS:

- The load you are carrying plus the weight of the roof rack must not exceed the maximum roof weight specified by the vehicle's manufacturer.
- Long loads such as, but not limited to, paddleboards, kayaks, surfboards, canoes, lumber, mattresses, and construction materials must be securely tied down at minimum to the roof rack and to the front of the vehicle.



Overloading the vehicle roof and/or failing to secure the load properly may result in loss of the load or the rack system, damage to the vehicle, and/or damage to other persons or property.

PARTS NOT INCLUDED

SQUARE LOAD BARS

x2

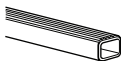

LB50, LB58, LB65, LB78

PARTS NOT INCLUDED

FIT KIT



THULE ONE KEY SYSTEM

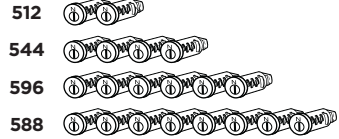

Complete your Load Carrier with the recommended Fit Kit and Load Bar for your vehicle.

1

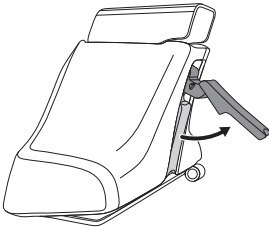

- Open One-Touch levers on inside of all Traverse feet.

2

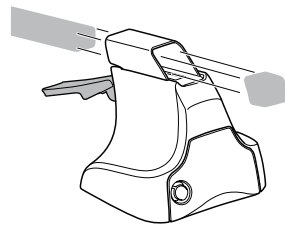

- Slide Traverse feet onto bars.

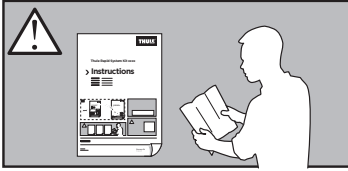
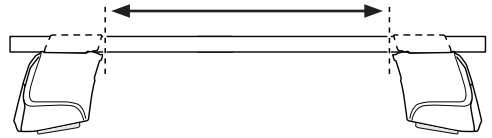
3**A****B**

X/Y inch/mm

- A. Open Fit Kit box and see Kit instruction #1.
- B. Measure inside to inside of feet using X/Y "mm" or "inch" dimensions listed for your vehicle to set foot position.

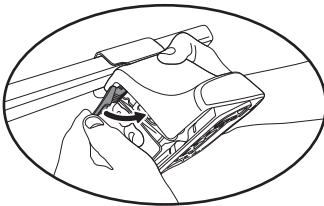
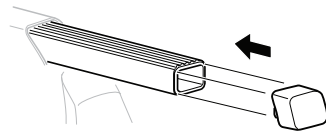
4**A****B**

- A. Lock feet into place by closing One-Touch levers.
- B. Press endcaps into ends of bars.

5

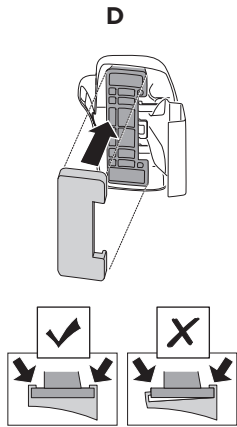
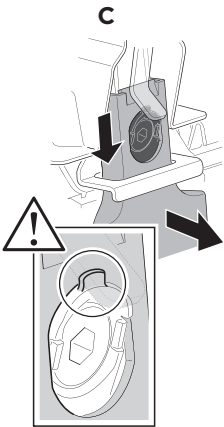
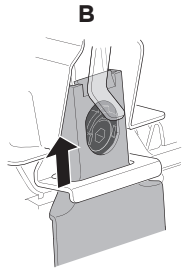
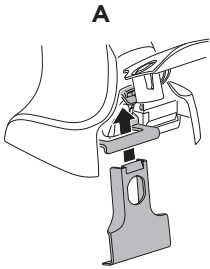
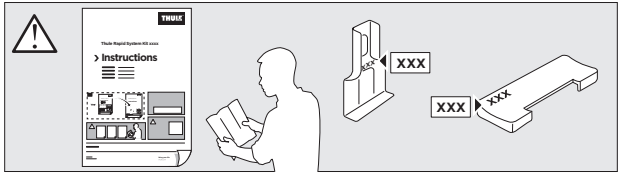

- See Fit Kit Instructions #2. Install brackets and pads onto Traverse feet in the indicated positions as follows.

6

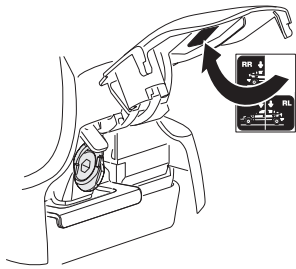

- Apply foot position stickers from Fit Kit to feet. This will make it easier to re-install the rack later.

7

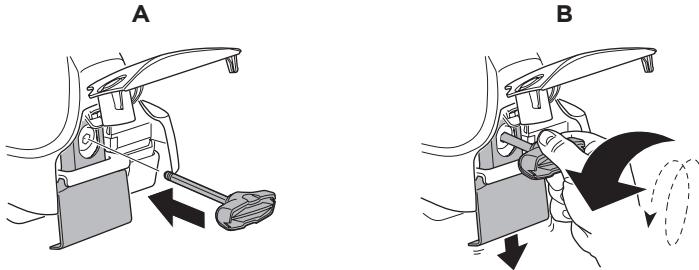

- Insert AcuTight tool into tensioning bolt on each foot and loosen completely. Bolt will stop when completely loose.

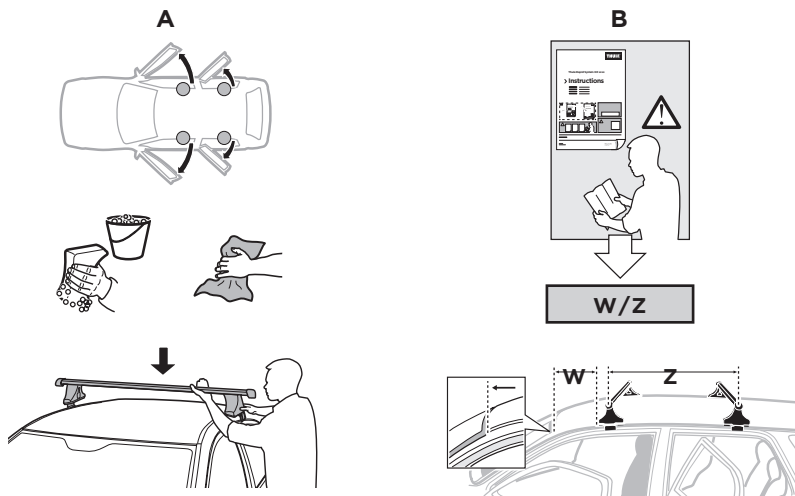
8

A. Clean and dry vehicle roof.

B. See Fit Kit instructions step #3. Position bars on vehicle per W and Z dimensions. Foot brackets should hang down into door frame. Measure, position and tighten front bar first, then proceed to rear bar. See next page, step #10 for foot tightening procedure.

CAUTION: Read Fit Kit step #3 completely before proceeding. Fit Kit instructions may contain additional vehicle-specific detail not shown here.

9

A

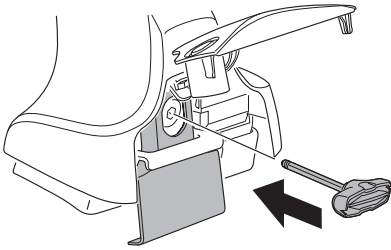

A. For each bar, tighten feet alternately. Just a few turns on each side until tight.

B. Hold Fit Kit bracket firmly against vehicle while tightening.

C. Foot is tight when green arrow and grey notches line up.

B

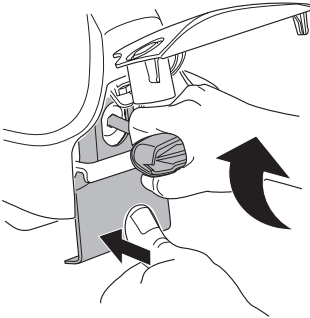

C

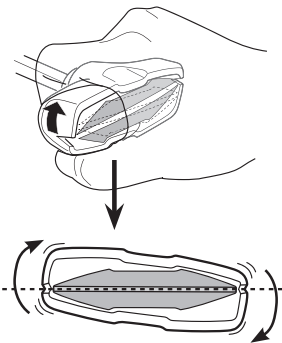

9

D

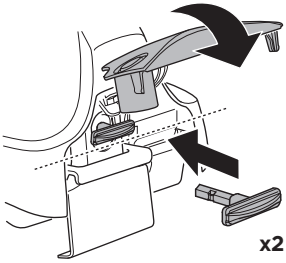

D&E. NOTE: Leave AcuTight tools installed in two feet. Install tensioning bolt plugs in remaining two feet.

F. Push and pull on installed rack and Fit Kit brackets. Check foot tightness and/or review rack install steps if any movement is detected.

E

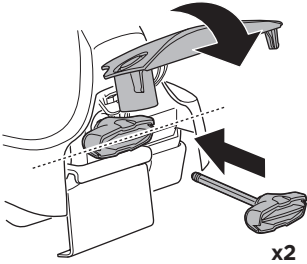

F

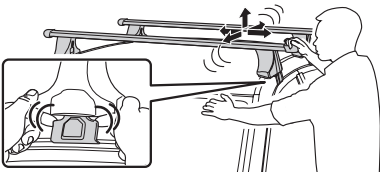

i

A

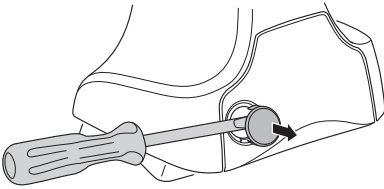

INSTALLING LOCK CORES IF PURCHASED:

A. Remove lock plugs from foot covers.

B. Insert square install key into lock cylinder.

Slide cylinder fully into foot cover. Remove square key.

C. Use N-series key to lock / unlock foot cover.

B

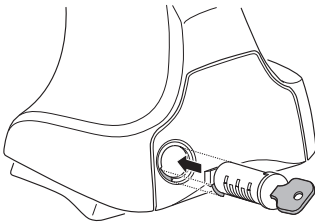

C

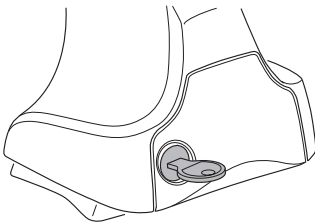

i

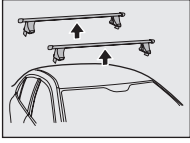

A

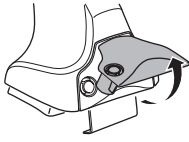

B

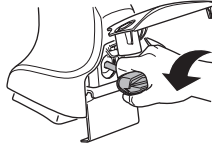

C

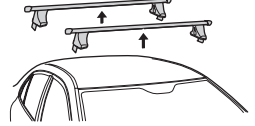

REMOVING ROOF RACK

i

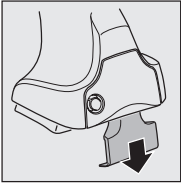

A

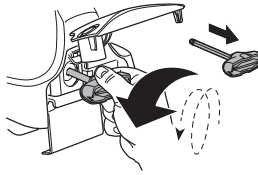

B

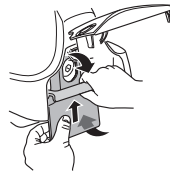

C

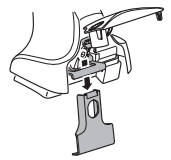

REMOVING FIT KIT BRACKETS