

**LONGBRIDGE MOTOR SPARES LTD**



**TRIUMPH 2000 2500 P I  
MK1 & MK2 CATALOGUE**

**NOVEMBER 2020**

Telephone: 07495 443 549  
longbridgeld@btinternet.com  
[www.longbridgemotorsparses.co.uk](http://www.longbridgemotorsparses.co.uk)

## HOW TO FIND A PART:

Firstly, select the category required, which, are alphabetically listed (i.e. part required. "L-H Front Wing" - Section for "Wing" then "Front", then "L-H". It's that simple!

## INDEX:

	Page		Page
Badges	6	Exhaust Fittings	14
Body fittings	6	Fuel system	15
Body panels	7	Gearbox	16
Brakes	8	Gearbox/Auto	16
Bumpers	9	Ignition	17
Clutch	9	Int Trim	17
Cooling system	10	Lamps	17
Driveshaft	11	Nuts & Bolts	18
Electrics	11	Speedo	18
Engine	12	Steering	18
Exhaust	13	Suspension	19
		Wheels	20
		Windscreen	20

## SURCHARGE:

We would ask for your co-operation on the return of exchange units, as we are only able to provide this service whilst we continue to receive a supply of reconditionable units. When the returned units stop, this service will no longer be able to operate. Please respond promptly. Your old unit, once reconditioned, could help a fellow ENTHUSIAST owner. It is up to you to help us to continue to provide this service!

ITEMS marked EXCH or EX, are exchange items and as such incur a surcharge. This is fully refundable upon the return of your own unit, which must be in an undamaged, serviceable condition to qualify. The old unit must also be returned within a 90 DAY period. Please return your old units promptly, taking care not to damage them on removal.

## KEY TO ABBREVIATIONS:

20/1 = Triumph 2000      MK1 1964-69      25TC/2 = Triumph 2500TCMK2 1974-77  
20/2 = Triumph 2000      MK2 1969-71      25S/2 = Triumph 2500S      MK2 1974-77  
20/2 = Triumph 2000      MK2 1971-75      2.5Pi/1 = Triumph 2.5Pi      MK1 1968-69  
20/2 = Triumph 2000TC      MK2 1975-77      2.5Pi/2 = Triumph 2.5Pi      MK2 1969-75

(SAL) = Saloon (EST) = Estate (L-H) = Left Hand (R-H) = Right Hand (S/H) = Second Hand  
(RECON) = Reconditioned (PRESS) = Pressed (REMAN) = Remanufactured (REP) = Repair  
(WH) = Wheel (CEN) = Centre (EXCH) = Exchange (PNL) = Panel (SB) = Stromberg  
(Man) = Manual (AUTO) = Automatic (QTR) = Quarter (PAS) = Power Assisted Steering  
(O/D, O/DR & O/drive) = Overdrive (P.O.A) = Price on application

# BODY PANELS

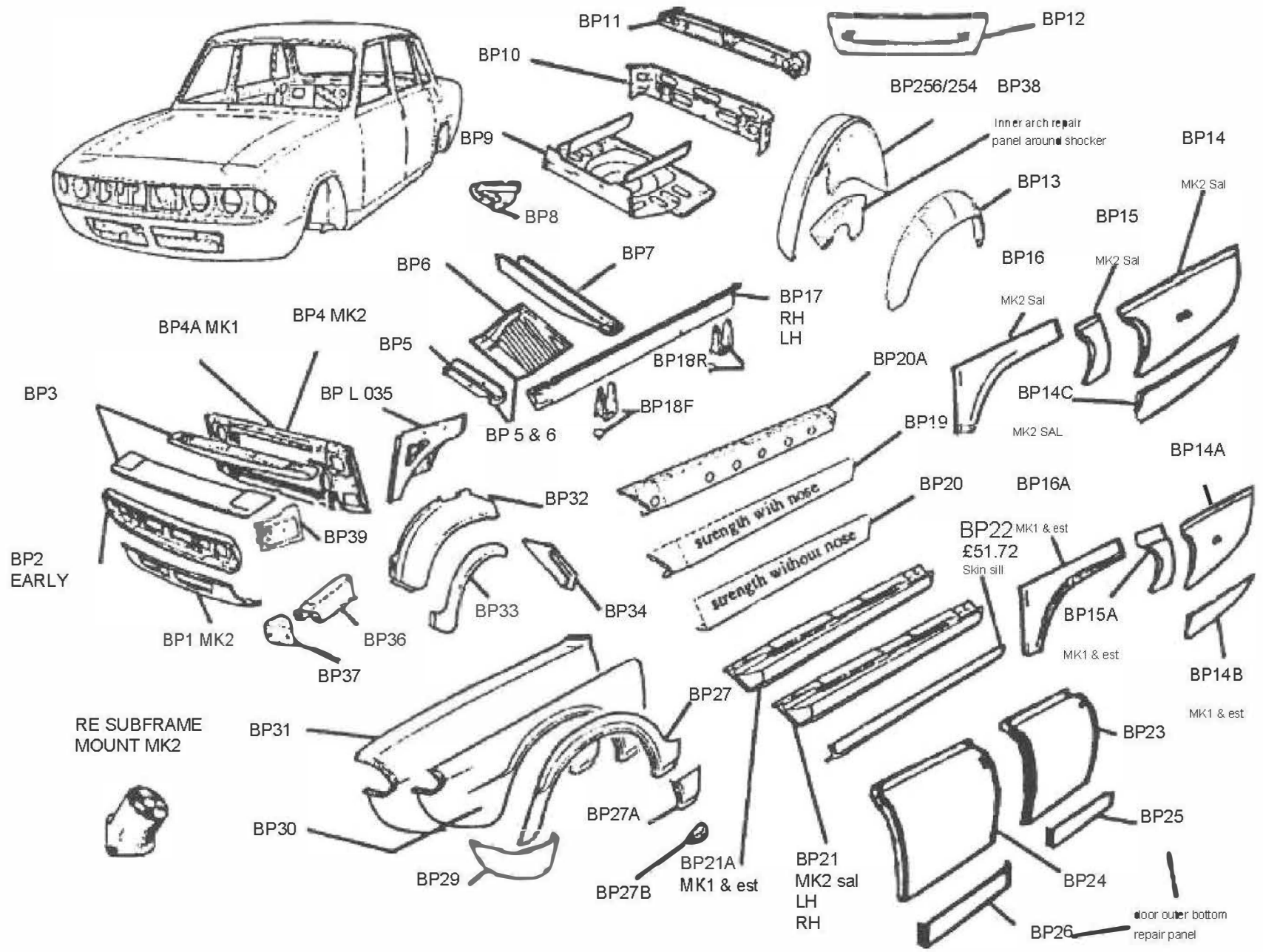

**LONGBRIDGE MOTOR SPARES LTD**

STRUT GAITER

COIL SPRING SEAT RUBBERS

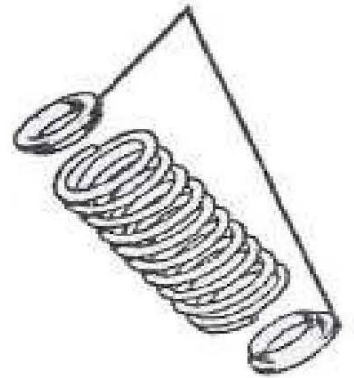
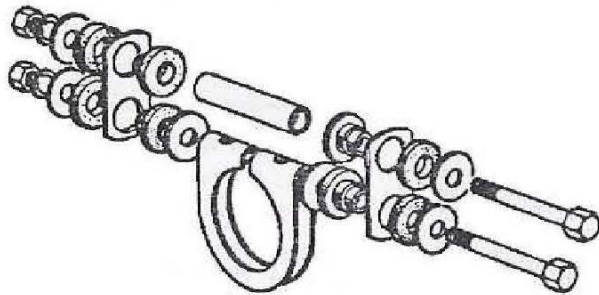
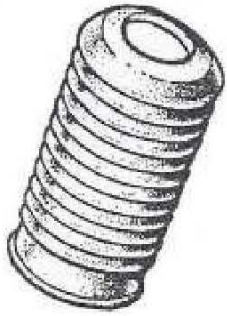

REAR SUBFRAME EXHAUST MOUNTING (COMPLETE) MK 2

PEDAL RUBBER ACCELERATOR  
PEDAL RUBBER MANUAL BRAKE & CLUTCH  
PEDAL RUBBER AUTO BRAKE

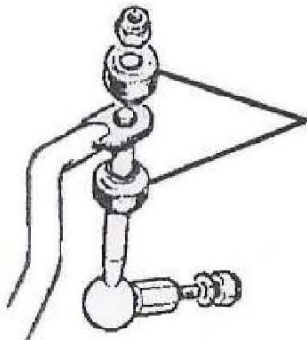

ANTI ROLL BAR LINK BUSHES RUBBER

RACK MOUNTING RUBBER MANUAL

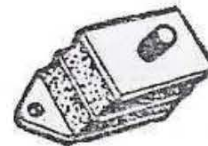

ENGINE MOUNTING



HOSE SU HS6 PUMP TO INLET REINFORCED

GEARBOX MOUNTING

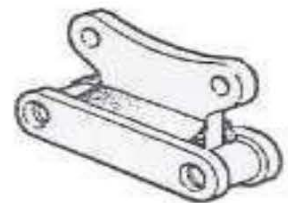

RE SUBFRAME MOUNT MK2

Category		Prodco	20/1	2.5PI/1	20/2	20TC/2	25TC/2	25S/2	2.5PI/2	Price
<b>Badges</b>										
BADGES	badge letter set, T R I U M P H, fr nose cone MK1	BAG 076	*	*						£35.11
BADGES	badge, for wheel trim word TRIUMPH	BAG 032			*	*	*	*	*	£16.97
BADGES	badge, front wing (LEYLAND)	BAG 003			*	*	*	*	*	£16.97
BADGES	badge, grille (alloy) 2500 MK 2 preface lift	BAG 030				*	*			£16.97
BADGES	badge, grille (plastic) 2000 MK 2 face lift	BAG 028				*	*			£16.97
BADGES	badge, grille (plastic) 2000TC MK 2 face lift	BAG 035				*	*			£16.97
BADGES	badge, grille (plastic) 2500 MK 2 face lift	BAG 020					*			£16.97
BADGES	badge, grille (plastic) 2500 MK 2 injection	BAG 016						*		£21.23
BADGES	badge, grille (plastic) 2500TC MK 2 face lift	BAG 015				*	*			£20.94
BADGES	badge, pillar rear S MK 2	BAG 019					*			£19.11
BADGES	badge, upper front panel MK 2 (TRIUMPH)	BAG 001			*	*	*	*	*	£31.91
BADGES	badge, valance rear or tailgate 2000 MK2	BAG 022			*	*				£21.23
BADGES	badge, valance rear or tailgate 2000 TC	BAG 077				*	*			£36.18
BADGES	badge, valance rear or tailgate 2500 MK 2	BAG 024				*	*			£31.08
BADGES	badge, valance rear or tailgate INJECTION	BAG 013					*			£23.54
BADGES	badge, valance rear or tailgate TRIUMPH MK 2	BAG 028			*	*	*	*	*	£36.57
BADGES	badge, wheel centre (alloy wheel)	BAG 033					*			£21.23
BADGES	clip, retainer plastic for badges	BAG 002	*	*	*	*	*	*	*	£0.64
<b>Body care</b>										
BODY CARE	dinitrol 3125 body & cavity wax for rusty areas 1LT	BC 0002	*	*	*	*	*	*	*	£25.70
BODY CARE	dinitrol 3054 cavity wax for clean & new areas 1LT	BC 0003	*	*	*	*	*	*	*	£21.87
BODY CARE	dinitrol 4041 black heavy body wax exposed areas 1LT	BC 0004	*	*	*	*	*	*	*	£21.87
BODY CARE	dinitrol gun application of wax needs air pressure	BC 0005	*	*	*	*	*	*	*	£33.86
BODY CARE	dinitrol RC000 rust converter for rusted areas 1LT	BC 0001	*	*	*	*	*	*	*	£50.15
BODY CARE	gun, for stone clip	BC 0010	*	*	*	*	*	*	*	£50.15
BODY CARE	pad, sound deadening pad 10" x 8" (price per pad)	BC 0007	*	*	*	*	*	*	*	£2.34
BODY CARE	pad, sound deadening pad 20" x 8" (price per pad)	BC 0006	*	*	*	*	*	*	*	£3.41
BODY CARE	spot weld drill, for removing spot welds	BC 0008	*	*	*	*	*	*	*	£14.84
BODY CARE	stone clip, for under body areas 1 Litre	BC 0009	*	*	*	*	*	*	*	£0.64
<b>Body Fittings</b>										
BODY FTNGS	bezel, headlamp, L-H, Tri MK1	BF 0291	*	*						£48.50
BODY FTNGS	bezel, headlamp, R-H, Tri MK1	BF 0292	*	*						£48.50
BODY FTNGS	buffer, rubber bonnet QTY 2 per car	BF 0098	*	*	*	*	*	*	*	£5.45
BODY FTNGS	cabie, bonnet	BF 0097	*	*	*	*	*	*	*	£12.77
BODY FTNGS	catch, assy bonnet	BF 0101	*	*	*	*	*	*	*	£14.84
BODY FTNGS	channel kit, drop glass front door (3 channels)	BF 0110	*	*	*	*	*	*	*	£19.11
BODY FTNGS	channel kit, drop glass rear door (3 channels)	BF 0108	*	*	*	*	*	*	*	£18.67
BODY FTNGS	clip, & pop rivet for waistband midg r/wing EST (7 per side)	BF 0105	*	*	*	*	*	*	*	£0.84
BODY FTNGS	clip, & pop rivet sill moulding MK 1, 10 per side	BF 0039	*	*						£2.03
BODY FTNGS	clip, & pop rivet sill moulding MK 2, 10 per side	BF 0038	*	*	*	*	*	*	*	£2.03
BODY FTNGS	clip, boot lid or rear screen moulding sal/est	BF 0042	*	*	*	*	*	*	*	£1.38
BODY FTNGS	clip, buffer rubber bonnet QTY 2 per car	BF 0099	*	*	*	*	*	*	*	£0.84
BODY FTNGS	clip, for grille mouldings upper & lower MK 2	BF 0029			*	*	*	*	*	£0.53
BODY FTNGS	clip, fr horse shoe or re wing moulding MK 2	BF 0035			*	*	*	*	*	£0.38
BODY FTNGS	clip, rear pnl, faci pnl black MK 2 sal QTY 6 REO	BF 0048			*	*	*	*	*	£2.03
BODY FTNGS	clip, rear wing moulding all estate & MK 1 saloon	BF 0051	*	*	*	*	*	*	*	£0.53
BODY FTNGS	clip, seal felt inner MK2 QTY REO 4 fr door, 5 rear	BF 0086			*	*	*	*	*	£1.25
BODY FTNGS	clip, seal felt inner MK1 QTY REO 4 fr door, 5 rear	BF 0085	*	*						£1.25
BODY FTNGS	clip, sunvisor retainer clip, Tri MK2 only, 2 per car	BF 0316			*	*	*	*	*	£10.57
BODY FTNGS	clip, top of door frame & D window moulding clip	BF 0049	*	*	*	*	*	*	*	£2.03
BODY FTNGS	clip, waist band moulding	BF 0050	*	*	*	*	*	*	*	£1.18
BODY FTNGS	clip, weather seal QTY REO 4 fr door, 6 re doors	BF 0076	*	*	*	*	*	*	*	£0.38
BODY FTNGS	facia panel, black, rear panel MK 2 saloon	BF 0047								£41.37
BODY FTNGS	filler, black vent QTR light front L-H	BF 0062	*	*	*	*	*	*	*	£27.65
BODY FTNGS	filler, black vent QTR light front R-H	BF 0061	*	*	*	*	*	*	*	£27.65
BODY FTNGS	gasket, handle set (for 4 door handles frt & rear)	BF 0174	*	*	*	*	*	*	*	£19.53
BODY FTNGS	gasket, handle, large front door	BF 0080	*	*	*	*	*	*	*	£2.45
BODY FTNGS	gasket, handle, large rear door	BF 0081	*	*	*	*	*	*	*	£1.49
BODY FTNGS	gasket, handle, small front & rear doors	BF 0082	*	*	*	*	*	*	*	£0.74
BODY FTNGS	grill, section inner (small) s/hand L-H MK2 facelift	BF 0281			*	*	*	*	*	£8.43
BODY FTNGS	grill, section inner (small) s/hand R-H MK2 facelift	BF 0282			*	*	*	*	*	£8.43
BODY FTNGS	grill, section outer (small) s/hand L-H MK2 facelift	BF 0280			*	*	*	*	*	£8.43
BODY FTNGS	grill, section outer (small) s/hand R-H MK2 facelift	BF 0279			*	*	*	*	*	£8.43
BODY FTNGS	grille, Tri MK2 facelift, centre section (s/hand)	BF 0235			*	*	*	*	*	£31.91
BODY FTNGS	handle, front L-H door MK 1	BF 0068	*	*						£55.00
BODY FTNGS	handle, front L-H door MK 2	BF 0070	*	*	*	*	*	*	*	£55.00
BODY FTNGS	handle, front R-H door MK 1	BF 0067	*	*						£55.00
BODY FTNGS	handle, front R-H door MK 2	BF 0069	*	*	*	*	*	*	*	£55.00
BODY FTNGS	handle, rear L-H door MK 1 & 2	BF 0072	*	*	*	*	*	*	*	£34.04
BODY FTNGS	handle, rear R-H door MK 1 & 2	BF 0071	*	*	*	*	*	*	*	£34.04
BODY FTNGS	handle, window winder s/hand MK 2	BF 0087			*	*	*	*	*	£8.43
BODY FTNGS	hinge, front door bottom L-H	BF 0053	*	*	*	*	*	*	*	£62.11
BODY FTNGS	hinge, front door bottom R-H	BF 0052	*	*	*	*	*	*	*	£62.11
BODY FTNGS	hinge, front door top R-H & L-H	BF 0025	*	*	*	*	*	*	*	£55.00
BODY FTNGS	knob, door lock inner front or rear	BF 0231	*	*	*	*	*	*	*	£5.73
BODY FTNGS	lock, tailgate, est MK1 & 2	BF 0317	*	*	*	*	*	*	*	£49.67
BODY FTNGS	mirror head, flat glass use with BF 0113 see fr pg	BF 0114	*	*	*	*	*	*	*	£23.01
BODY FTNGS	mirror stem, wing mirror use with BF 0114	BF 0113	*	*	*	*	*	*	*	£31.91
BODY FTNGS	mirror, 2 BF 0114 mirror stems & 2 heads BF 0113	BF 0324	*	*	*	*	*	*	*	£78.00
BODY FTNGS	mirror, door L-H flat glass anti-glazz pol-stain/s	BF 0111	*	*	*	*	*	*	*	£38.31
BODY FTNGS	mirror, door R-H flat glass anti-glazz pol-stain/s	BF 0112	*	*	*	*	*	*	*	£38.31
BODY FTNGS	moulding, boot lid MK 1 saloon & MK 1 & 2 est	BF 0041	*	*	*	*	*	*	*	£43.56
BODY FTNGS	moulding, boot lid MK 2 saloon	BF 0040			*	*	*	*	*	£62.11
BODY FTNGS	moulding, foot rear screen surround L-H	BF 0044	*	*	*	*	*	*	*	£31.91
BODY FTNGS	moulding, foot rear screen surround R-H	BF 0043	*	*	*	*	*	*	*	£31.91
BODY FTNGS	moulding, fr wing horse shoe L-H MK 2 (chrome)	BF 0034			*	*	*	*	*	£103.59
BODY FTNGS	moulding, fr wing horse shoe R-H MK 2 (chrome)	BF 0033			*	*	*	*	*	£82.85
BODY FTNGS	moulding, rear wing L-H MK 2 saloon	BF 0046			*	*	*	*	*	£41.37
BODY FTNGS	moulding, rear wing R-H MK 2 saloon	BF 0045			*	*	*	*	*	£41.37
BODY FTNGS	mouldings, grill s/hand upper/lower MK2 1 pair	BF 0031			*	*	*	*	*	£49.67
BODY FTNGS	nut, retainer fixing flasher side lamp fr MK 1	BF 0323	*	*						£2.11
BODY FTNGS	pin, hinge front or rear door	BF 0054	*	*	*	*	*	*	*	£3.39

BODY FITINGS	pin, hinges front or rear door, SPECIAL PRICE FOR 2	BF 00	*	*	*	*	*	*	*	*	£6.38
BODY FITINGS	plate, tread, rear	BF 0117	*	*	*	*	*	*	*	*	£17.00
BODY FITINGS	regulator, fr R-H for drop glass (window winder)	BF 0118	*	*	*	*	*	*	*	*	£21.23
BODY FITINGS	seal, bonnet to bulkhead	BF 0100	*	*	*	*	*	*	*	*	£32.91
BODY FITINGS	seal, boot lid MK 1	BF 0091	*	*	*	*	*	*	*	*	£25.58
BODY FITINGS	seal, boot lid MK 2, fits to boot aperture	BF 0093	*	*	*	*	*	*	*	*	£23.38
BODY FITINGS	seal, boot lid MK 2, fits to boot lid	BF 0092	*	*	*	*	*	*	*	*	£23.38
BODY FITINGS	seal, felt inner front door, glass to frame	BF 0083	*	*	*	*	*	*	*	*	£7.92
BODY FITINGS	seal, felt inner rear door, glass to frame	BF 0084	*	*	*	*	*	*	*	*	£11.14
BODY FITINGS	seal, felt inner rear door, glass to frame, SPECIAL PRICE FOR 4 DOOR FELT SEALS	BF 00	*	*	*	*	*	*	*	*	£29.66
BODY FITINGS	seal, front or rear doors fits to door rubber reman	BF 0094	*	*	*	*	*	*	*	*	£23.38
BODY FITINGS	seal, front or rear doors fits to door rubber reman, SPECIAL PRICE FOR 4 DOOR SEALS	BF 00	*	*	*	*	*	*	*	*	£77.06
BODY FITINGS	seal, rubber, D window rear (side window) L-H saloon Orig	BF 0064	*	*	*	*	*	*	*	*	£37.93
BODY FITINGS	seal, rubber, D window rear (side window) R-H saloon Reman	BF 0063	*	*	*	*	*	*	*	*	£53.48
BODY FITINGS	seal, rubber, D window rear (side window) 1 PAIR	BF 0063SP	*	*	*	*	*	*	*	*	£82.26
BODY FITINGS	seal, tail gate door rubber	BF 0096	*	*	*	*	*	*	*	*	POA
BODY FITINGS	seal, vent, QTR light rubber front L-H	BF 0060	*	*	*	*	*	*	*	*	£42.58
BODY FITINGS	seal, vent, QTR light rubber front R-H	BF 0059	*	*	*	*	*	*	*	*	£66.71
BODY FITINGS	seal, vent, QTR light rubber front 1 PAIR,	BF 00	*	*	*	*	*	*	*	*	£74.12
BODY FITINGS	seal, vent, QTR light rubber rear L-H est	BF 0066	*	*	*	*	*	*	*	*	POA
BODY FITINGS	seal, vent, QTR light rubber rear R-H est	BF 0065	*	*	*	*	*	*	*	*	POA
BODY FITINGS	seal, weather seal fr L-H door, door to glass	BF 0074	*	*	*	*	*	*	*	*	£20.38
BODY FITINGS	seal, weather seal fr R-H door, door to glass	BF 0073	*	*	*	*	*	*	*	*	£20.38
BODY FITINGS	seal, weather seal re door, dr to glass(substitute) R-H or L-H	BF 0075	*	*	*	*	*	*	*	*	£11.54
BODY FITINGS	seal, weather seal kit, 2 front door weather seals & 2 rears, door to glass(substitute) & 20 clips	BF 00	*	*	*	*	*	*	*	*	£29.45
BODY FITINGS	strap, check front door s/hand MK 1	BF 0088	*	*	*	*	*	*	*	*	£12.70
BODY FITINGS	strap, check front doors MK 2	BF 0077	*	*	*	*	*	*	*	*	£25.50
BODY FITINGS	strap, check L-H rear door s/hand MK 1	BF 0090	*	*	*	*	*	*	*	*	£16.97
BODY FITINGS	strap, check R-H rear door s/hand MK 1	BF 0089	*	*	*	*	*	*	*	*	£16.97
BODY FITINGS	strap, check s/hand rear L-H doors MK 2	BF 0079	*	*	*	*	*	*	*	*	£16.97
BODY FITINGS	strap, check s/hand rear R-H doors MK 2	BF 0078	*	*	*	*	*	*	*	*	£16.97
BODY FITINGS	striker, pin assy s/hand (bonnet)	BF 0102	*	*	*	*	*	*	*	*	£8.43
BODY FITINGS	vent, QTR light front L-H	BF 0056	*	*	*	*	*	*	*	*	POA
BODY FITINGS	vent, QTR light front R-H	BF 0055	*	*	*	*	*	*	*	*	POA
BODY FITINGS	vent, QTR light rear L-H EST	BF 0054	*	*	*	*	*	*	*	*	POA
BODY FITINGS	vent, QTR light rear R-H EST	BF 0057	*	*	*	*	*	*	*	*	POA
<b>Body Panels</b>											
BODY PANELS	B post assy, R-H (centre pillar)	BP 0230	*	*	*	*	*	*	*	*	£33.72
BODY PANELS	bonnet, MK 2 B.L.	BP 0230	*	*	*	*	*	*	*	*	£184.89
BODY PANELS	chassis ext, fr chassis MK 2 (No 36)	BP 0036	*	*	*	*	*	*	*	*	£16.13
BODY PANELS	chassis leg bracket, fr ext, fr chassis (No 37)	BP 0037	*	*	*	*	*	*	*	*	£11.49
BODY PANELS	door, fr door skin L-H reman (No 24)	BP L024	*	*	*	*	*	*	*	*	£152.20
BODY PANELS	door, fr door skin R-H reman (No 24)	BP R024	*	*	*	*	*	*	*	*	£152.20
BODY PANELS	door, fr MK 1 L-H shell	BP 0189	*	*	*	*	*	*	*	*	£311.16
BODY PANELS	door, fr MK 2 L-H shell s/hand rust free	BP 0203	*	*	*	*	*	*	*	*	£180.93
BODY PANELS	door, fr MK 2 R-H shell s/hand rust free	BP 0202	*	*	*	*	*	*	*	*	£202.93
BODY PANELS	door, fr outer bottom repair panel L-H (No 26)	BP L026	*	*	*	*	*	*	*	*	£37.01
BODY PANELS	door, fr outer bottom repair panel R-H (No 26)	BP R026	*	*	*	*	*	*	*	*	£37.01
BODY PANELS	door, re door skin L-H B.L. (No 23)	BP L023	*	*	*	*	*	*	*	*	£71.12
BODY PANELS	door, re door skin R-H reman (No 23)	BP R023	*	*	*	*	*	*	*	*	£152.20
BODY PANELS	door, re MK 1 L-H shell est	BP 0182	*	*	*	*	*	*	*	*	£288.57
BODY PANELS	door, re MK 1 L-H shell saloon	BP 0181	*	*	*	*	*	*	*	*	£288.57
BODY PANELS	door, re MK 1 R-H shell est	BP 0184	*	*	*	*	*	*	*	*	£288.57
BODY PANELS	door, re MK 1 R-H shell saloon	BP 0183	*	*	*	*	*	*	*	*	£288.57
BODY PANELS	door, re MK 2 L-H shell est	BP 0200	*	*	*	*	*	*	*	*	£288.57
BODY PANELS	door, re MK 2 L-H shell sal s/hand rust free	BP 0201	*	*	*	*	*	*	*	*	£157.72
BODY PANELS	door, re MK 2 R-H shell est	BP 0205	*	*	*	*	*	*	*	*	£288.57
BODY PANELS	door, re MK 2 R-H shell sal s/hand rust free	BP 0226	*	*	*	*	*	*	*	*	£157.72
BODY PANELS	door, re outer bottom repair panel L-H (No 25)	BP L025	*	*	*	*	*	*	*	*	£37.01
BODY PANELS	door, re outer bottom repair panel R-H (No 25)	BP R025	*	*	*	*	*	*	*	*	£37.01
BODY PANELS	floor, fr pan & outrigger R-H SP/PRICE (No 6 & 5)	BP 0218	*	*	*	*	*	*	*	*	£89.27
BODY PANELS	floor, front floor pan R-H (No 6)	BP R006	*	*	*	*	*	*	*	*	£72.59
BODY PANELS	floor, panel boot MK1 sal/est, whl well repair pnl	BP 0009A	*	*	*	*	*	*	*	*	£198.31
BODY PANELS	floor, panel boot MK2 saloon (No 9)	BP 0009	*	*	*	*	*	*	*	*	£399.56
BODY PANELS	headlamp, panel L-H MK 1	BP 0234	*	*	*	*	*	*	*	*	£87.31
BODY PANELS	headlamp, panel R-H MK 1	BP 0232	*	*	*	*	*	*	*	*	£87.31
BODY PANELS	headlamp, pnl MK 2 B.L. pre face lift (No 2)	BP 0002	*	*	*	*	*	*	*	*	£109.98
BODY PANELS	headlamp, pnl MK 2 face lift use pre flit (No 2)	BP 0002A	*	*	*	*	*	*	*	*	£198.42
BODY PANELS	jacking, point rear & stud pressed R-H or L-H No 18	BP 0018R	*	*	*	*	*	*	*	*	£34.52
BODY PANELS	jacking, point, front & stud pressed R-H or L-H No 18	BP 0018	*	*	*	*	*	*	*	*	£34.52
BODY PANELS	lid, boot MK 2 single lamp s/hand rust free	BP 0211	*	*	*	*	*	*	*	*	£112.63
BODY PANELS	lid, boot MK 2 twin lamp s/hand rust free	BP 0208	*	*	*	*	*	*	*	*	£112.63
BODY PANELS	light panel, rear upper MK 2 saloon (No 11)	BP 0011	*	*	*	*	*	*	*	*	£241.52
BODY PANELS	nose cone, fr panel bare MK 1	BP 0247	*	*	*	*	*	*	*	*	£173.52
BODY PANELS	outrigger, centre L-H 16G press (No 7)	BP 0007L	*	*	*	*	*	*	*	*	£41.06
BODY PANELS	outrigger, centre R-H 16G press (No 7)	BP 0007R	*	*	*	*	*	*	*	*	£41.06
BODY PANELS	outrigger, fr L-H 16G press (No 5)	BP 0005L	*	*	*	*	*	*	*	*	£35.46
BODY PANELS	outrigger, fr R-H 16G press (No 5)	BP 0005R	*	*	*	*	*	*	*	*	£35.46
BODY PANELS	platform, rear spring (RP) L-H 16G (top hat)(No 8)	BP L008	*	*	*	*	*	*	*	*	£52.77
BODY PANELS	radiator, mounting panel B.L. MK 1 (No 4)	BP 0004A	*	*	*	*	*	*	*	*	£67.64
BODY PANELS	radiator, mounting panel B.L. MK 2 (No 4)	BP 0004	*	*	*	*	*	*	*	*	£148.70
BODY PANELS	reinforcement, panel, headlamp to rad pnl, MK2 L-H	BP L039	*	*	*	*	*	*	*	*	£23.09
BODY PANELS	reinforcement, panel, headlamp to rad pnl, MK2 R-H	BP R039	*	*	*	*	*	*	*	*	£23.09
BODY PANELS	sill, inner L-H inside car (No 17)	BP L017	*	*	*	*	*	*	*	*	£177.84
BODY PANELS	sill, inner R-H inside car (No 17)	BP R017	*	*	*	*	*	*	*	*	£166.55
BODY PANELS	sill, inner strengthener pressed L-H No 20A (as OE.)	BP 0258	*	*	*	*	*	*	*	*	£222.95
BODY PANELS	sill, inner strengthener pressed R-H No 20A (as OE.)	BP 0259	*	*	*	*	*	*	*	*	£222.95
BODY PANELS	sill, inner strength rep pnl no nose L-H (No 20)	BP L020	*	*	*	*	*	*	*	*	£44.54
BODY PANELS	sill, inner strength rep pnl no nose R-H (No 20)	BP R020	*	*	*	*	*	*	*	*	£44.54
BODY PANELS	sill, inner strength rep pnl with nose L-H (No 19)	BP L019	*	*	*	*	*	*	*	*	£101.48
BODY PANELS	sill, inner strength rep pnl with nose R-H (No 19)	BP R019	*	*	*	*	*	*	*	*	£101.48
BODY PANELS	sill, outer full MK1 L-H sal, all est pressed (No 21A)	BP L021A	*	*	*	*	*	*	*	*	£244.38
BODY PANELS	sill, outer full MK1 R-H sal, all est pressed (No 21A)	BP R021A	*	*	*	*	*	*	*	*	£244.38
BODY PANELS	sill, outer full MK2 L-H saloon B.L. (No 21)	BP L021	*	*	*	*	*	*	*	*	£255.44
BODY PANELS	sill, outer full MK2 R-H saloon pressed (No 21)	BP R021	*	*	*	*	*	*	*	*	£244.38
BODY PANELS	upper, fr panel MK 2 (grille to bonnet) (No 3)	BP 0003	*	*	*	*	*	*	*	*	£343.20
BODY PANELS	valance, fr lower MK 1	BP 0050	*	*	*	*	*	*	*	*	£439.70
BODY PANELS	valance, fr lower MK 2 B.L. (No 1)	BP 0001	*	*	*	*	*	*	*	*	£64.34
BODY PANELS	valance, re inner MK 1 & 2 estate	BP 0220	*	*	*	*	*	*	*	*	£191.67

BODY PANELS	valance, re inner MK 1 saloon	BP 0206	*	*	*	*	*	*	*	*	£191.67
BODY PANELS	valance, re inner MK 2 saloon (No 10)	BP 0010	*	*	*	*	*	*	*	*	£91.48
BODY PANELS	valance, re lower MK 1 & 2 estate	BP 0219	*	*	*	*	*	*	*	*	£260.84
BODY PANELS	valance, re lower MK 1 saloon	BP 0221	*	*	*	*	*	*	*	*	£376.77
BODY PANELS	valance, re lower MK 2 saloon (No 12)	BP 0012	*	*	*	*	*	*	*	*	£416.82
BODY PANELS	wh, arch fr inner bowl repair MK1 L-H (No 33)	BP L033A	*	*	*	*	*	*	*	*	£95.01
BODY PANELS	wh, arch fr inner bowl repair MK1 R-H (No 33)	BP R033A	*	*	*	*	*	*	*	*	£95.01
BODY PANELS	wh, arch fr inner bowl repair MK2 L-H (No 33)	BP L033	*	*	*	*	*	*	*	*	£95.01
BODY PANELS	wh, arch fr inner bowl repair MK2 R-H (No 33)	BP R033	*	*	*	*	*	*	*	*	£95.01
BODY PANELS	wh, arch fr inner to bulkhead L-H repair panel (No 34)	BP L034	*	*	*	*	*	*	*	*	£67.55
BODY PANELS	wh, arch fr inner to bulkhead R-H repair panel (No 34)	BP R034	*	*	*	*	*	*	*	*	£67.55
BODY PANELS	wh, arch fr repair MK 1 R-H repressed	BP R028	*	*	*	*	*	*	*	*	£90.00
BODY PANELS	wh, arch fr repair MK 2 L-H repressed (No 27)	BP L027	*	*	*	*	*	*	*	*	£191.67
BODY PANELS	wh, arch fr repair MK 2 R-H repressed (No 27)	BP R027	*	*	*	*	*	*	*	*	£191.67
BODY PANELS	wh, arch re back portion MK 1 L-H sal/est (No 15)	BP L015A	*	*	*	*	*	*	*	*	£47.05
BODY PANELS	wh, arch re back portion MK 1 R-H sal/est (No 15)	BP R015A	*	*	*	*	*	*	*	*	£47.05
BODY PANELS	wh, arch re back portion MK 2 L-H sal (No 15)	BP L015	*	*	*	*	*	*	*	*	£47.05
BODY PANELS	wh, arch re back portion MK 2 R-H sal (No 15)	BP R015	*	*	*	*	*	*	*	*	£47.05
BODY PANELS	wh, arch re inner half L-H all models (Reman)	BP 0256	*	*	*	*	*	*	*	*	£338.23
BODY PANELS	wh, arch re inner half R-H all models (Reman)	BP 0254	*	*	*	*	*	*	*	*	£338.23
BODY PANELS	wh, arch re inner half top repair panel L-H (shocker)	BP L038	*	*	*	*	*	*	*	*	£123.91
BODY PANELS	wh, arch re inner half top repair panel R-H (shocker)	BP R038	*	*	*	*	*	*	*	*	£123.91
BODY PANELS	wh, arch re inner outer half (RP) MK2 L-H SAL (No 13)	BP L013	*	*	*	*	*	*	*	*	£315.67
BODY PANELS	wh, arch re inner outer half (RP) MK2 R-H SAL (No 13)	BP R013	*	*	*	*	*	*	*	*	£315.67
BODY PANELS	wh, arch re inner outer half (RP) MK1 L-H sal & EST No 13	BP L013A	*	*	*	*	*	*	*	*	£315.67
BODY PANELS	wh, arch re inner outer half (RP) MK1 R-H sal & EST No 13	BP R013A	*	*	*	*	*	*	*	*	£315.67
BODY PANELS	wh, arch re repair fr (RP) MK1 R-H sal/est (No 16)	BP R016A	*	*	*	*	*	*	*	*	£58.53
BODY PANELS	wh, arch re repair fr (RP) MK1 L-H sal/est (No 16)	BP L016A	*	*	*	*	*	*	*	*	£58.53
BODY PANELS	wh, arch re repair fr (RP) MK2 L-H sal (No 16)	BP L016	*	*	*	*	*	*	*	*	£58.53
BODY PANELS	wh, arch re repair fr (RP) MK2 R-H sal (No 16)	BP R016	*	*	*	*	*	*	*	*	£58.53
BODY PANELS	wing, fr fr lower corner repair L-H MK 2 (No 29)	BP L029	*	*	*	*	*	*	*	*	£92.33
BODY PANELS	wing, fr fr lower corner repair R-H MK 2 (No 29)	BP R029	*	*	*	*	*	*	*	*	£92.33
BODY PANELS	wing, fr inner filler panel L-H (No 35)	BP L035	*	*	*	*	*	*	*	*	£64.38
BODY PANELS	wing, fr MK 1 L-H BL	BP 0246	*	*	*	*	*	*	*	*	£338.23
BODY PANELS	wing, fr MK 1 R-H BL	BP 0235	*	*	*	*	*	*	*	*	£338.23
BODY PANELS	wing, fr MK 2 L-H repressed (No 31)	BP L031	*	*	*	*	*	*	*	*	£743.97
BODY PANELS	wing, fr MK 2 R-H repressed (No 31)	BP R031	*	*	*	*	*	*	*	*	£743.97
BODY PANELS	wing, fr MK 2 half L-H repressed (No 30)	BP L030	*	*	*	*	*	*	*	*	£371.94
BODY PANELS	wing, fr MK 2 half R-H repressed (No 30)	BP R030	*	*	*	*	*	*	*	*	£371.94
BODY PANELS	wing, fr re lower corner bracket to sill (No 27B)	BP 0027b	*	*	*	*	*	*	*	*	£7.54
BODY PANELS	wing, fr re lower corner repair L-H MK 2 (No 27A)	BP L027A	*	*	*	*	*	*	*	*	£42.74
BODY PANELS	wing, fr re lower corner repair R-H MK 2 (No 27A)	BP R027A	*	*	*	*	*	*	*	*	£42.74
BODY PANELS	wing, re lower TR repair MK1 L-H sal/est (No 14)	BP L014A	*	*	*	*	*	*	*	*	£202.99
BODY PANELS	wing, re lower TR repair MK1 R-H sal/est (No 14)	BP R014A	*	*	*	*	*	*	*	*	£202.99
BODY PANELS	wing, re lower TR repair MK2 L-H sal (No 14)	BP L014	*	*	*	*	*	*	*	*	£202.99
BODY PANELS	wing, re lower TR repair MK2 R-H sal (No 14)	BP R014	*	*	*	*	*	*	*	*	£202.99
BODY PANELS	wing, re lower repair panel MK1 L-H sal/est (14B)	BP L014B	*	*	*	*	*	*	*	*	£80.84
BODY PANELS	wing, re lower repair panel MK1 R-H sal/est (14B)	BP R014B	*	*	*	*	*	*	*	*	£80.84
BODY PANELS	wing, re lower repair panel MK2 L-H sal/est (14C)	BP L014C	*	*	*	*	*	*	*	*	£80.84
BODY PANELS	wing, re lower repair panel MK2 R-H sal/est (14C)	BP R014C	*	*	*	*	*	*	*	*	£80.84
BODY PANELS	wing, re outer MK 1 & 2 L-H est	BP 0187	*	*	*	*	*	*	*	*	£358.64
BODY PANELS	wing, re outer MK 1 & 2 R-H est	BP 0185	*	*	*	*	*	*	*	*	£360.66
BODY PANELS	wing, re outer MK 1 L-H saloon	BP 0216	*	*	*	*	*	*	*	*	£543.21
BODY PANELS	wing, re outer MK 1 R-H saloon	BP 0188	*	*	*	*	*	*	*	*	£543.21
BODY PANELS	wing, re outer MK 2 L-H saloon	BP 0242	*	*	*	*	*	*	*	*	£620.08
BODY PANELS	wing, re outer MK 2 R-H saloon	BP 0233	*	*	*	*	*	*	*	*	£326.96
<b>Brakes - Clips</b>											
BRAKES CLIPS	clip, single plus for brake pipe QTY 7 sal, 5 est	BRC 002	*	*	*	*	*	*	*	*	£1.54
BRAKES CLIPS	clip, twin plus for brake pipe QTY 2 sal, 2 est	BRC 001	*	*	*	*	*	*	*	*	£1.07
<b>Brakes front</b>											
BRAKES FRONT	belt, hub to brake disc MK2	BRF 058	*	*	*	*	*	*	*	*	£2.67
BRAKES FRONT	belt, lower, (short) QTY 1 per caliper, MK2	BRF 058	*	*	*	*	*	*	*	*	£2.64
BRAKES FRONT	belt, upper, (long) QTY 2 per caliper, MK2	BRF 059	*	*	*	*	*	*	*	*	£4.18
BRAKES FRONT	bush, pedal shaft, QTY RE 4	BRF 100	*	*	*	*	*	*	*	*	£6.30
BRAKES FRONT	caliper, repair kit, 1 kit per caliper, all models	BRF 013	*	*	*	*	*	*	*	*	£8.89
BRAKES FRONT	caliper, Trn MK 1 L-H, recon, exch	BRF 009	*	*	*	*	*	*	*	*	£82.96
BRAKES FRONT	caliper, Trn MK 1 R-H, recon, exch	BRF 008	*	*	*	*	*	*	*	*	£82.96
BRAKES FRONT	caliper, Trn MK 2 L-H, recon, exch	BRF 010	*	*	*	*	*	*	*	*	£82.96
BRAKES FRONT	caliper, Trn MK 2 R-H, recon, exch	BRF 011	*	*	*	*	*	*	*	*	£82.96
BRAKES FRONT	caliper, Trn MK 1 & 2 surcharge	BRF 184	*	*	*	*	*	*	*	*	£51.86
BRAKES FRONT	cyl, master repair kit single syst Trn MK1 2064-69	BRF 085	*	*	*	*	*	*	*	*	£13.60
BRAKES FRONT	cyl, master repair kit single syst Trn MK2 1969-77	BRF 018	*	*	*	*	*	*	*	*	£12.08
BRAKES FRONT	cyl, master repair kit tandem system Trn MK 2 ONLY	BRF 001	*	*	*	*	*	*	*	*	£30.41
BRAKES FRONT	cyl, master Trn MK 1 2.5 Pi (girling type)	BRF 016	*	*	*	*	*	*	*	*	£145.07
BRAKES FRONT	cyl, master Trn MK 1 2000 (lockhead)	BRF 015	*	*	*	*	*	*	*	*	£186.55
BRAKES FRONT	cyl, master Trn MK 2 2000/2500, 2.5Pi surcharge	BRF 185	*	*	*	*	*	*	*	*	£37.33
BRAKES FRONT	cyl, master Trn MK 2 2000/2500, 2.5Pi recon exch	BRF 017	*	*	*	*	*	*	*	*	£165.81
BRAKES FRONT	disc KIT, MK 2 SPECIAL PRICE FOR 2 discs & pads	BRF 007	*	*	*	*	*	*	*	*	£194.20
BRAKES FRONT	disc, 350' wide Trn MK 1	BRF 005	*	*	*	*	*	*	*	*	£103.59
BRAKES FRONT	disc, 500' wide Trn MK 2	BRF 006	*	*	*	*	*	*	*	*	£95.14
BRAKES FRONT	disc, pads (set of 4) Trn MK 1	BRF 003	*	*	*	*	*	*	*	*	£44.78
BRAKES FRONT	disc, pads (set of 4) Trn MK 2	BRF 004	*	*	*	*	*	*	*	*	£43.37
BRAKES FRONT	fluid, brake & clutch (DOT4) (0.5 Litre)	BRF 087	*	*	*	*	*	*	*	*	£7.22
BRAKES FRONT	fluid, brake & clutch (DOT4) (1 Litre)	BRF 086	*	*	*	*	*	*	*	*	£10.20
BRAKES FRONT	hose, fr, flexible, R-H & L-H	BRF 014	*	*	*	*	*	*	*	*	£14.69
BRAKES FRONT	hose kit, SPECIAL PRICE FOR 2 front brake hoses	BRF 014	*	*	*	*	*	*	*	*	£19.89
BRAKES FRONT	hose kit, SPECIAL PRICE FOR 2 front brake hoses & 2 rear brake hoses	BRF 0	*	*	*	*	*	*	*	*	£44.14
BRAKES FRONT	hose, servo hose 1/2' (price per 1/2' metre)	BRF 186	*	*	*	*	*	*	*	*	£6.30
BRAKES FRONT	hose, servo hose, (per one metre 1/2' core)	BRF 183	*	*	*	*	*	*	*	*	£11.73
BRAKES FRONT	nut, for brake hose, (thin)	BRF 250	*	*	*	*	*	*	*	*	£1.38
BRAKES FRONT	pedal, rubber brake automatic, Trn 2000/2500	BRF 020	*	*	*	*	*	*	*	*	£10.92
BRAKES FRONT	pedal, rubber brake kit automatic, Trn 2000/2500 (brake & accelerator)	BRF 0	*	*	*	*	*	*	*	*	£14.00
BRAKES FRONT	pedal, rubber brake, manual also clutch pedal rubber	BRF 002	*	*	*	*	*	*	*	*	£8.70
BRAKES FRONT	pedal, rubber brake kit, manual (brake, clutch, accelerator pedal rubber)	BRF 0	*	*	*	*	*	*	*	*	£19.86
BRAKES FRONT	pin kit, pins & hold down springs, (brake pads) MK 1	BRF 088	*	*	*	*	*	*	*	*	£12.70
BRAKES FRONT	pin kit, pins & hold down springs, (brake pads) MK 2	BRF 089	*	*	*	*	*	*	*	*	£12.70
BRAKES FRONT	pipe kit, copper brake pipe/brass unions 1963-68	BRF 024	*	*	*	*	*	*	*	*	£51.07
BRAKES FRONT	pipe kit, copper brake pipe/brass unions 1968-77	BRF 023	*	*	*	*	*	*	*	*	£51.07

BRAKES FRONT	piston, caliper fr, Tri MK1 & 2	BRF 004	*	*	*	*	*	*	*	£12.58
BRAKES FRONT	piston, caliper fr, Tri MK1 & 2, SPECIAL PRICE FOR 4 PISTONS, 2 CALIPER REPAIR KITS	BRF 0	*	*	*	*	*	*	*	£49.88
BRAKES FRONT	servo, Tri MK1, recon, exch	BRF 005	*	*	*	*	*	*	*	£311.00
BRAKES FRONT	servo, Tri MK2, recon exch	BRF 006	*	*	*	*	*	*	*	£537.33
BRAKES FRONT	servo, Tri MK2 repair kit	BRF 182	*	*	*	*	*	*	*	£488.06
BRAKES FRONT	servo, Tri MK2 surcharge	BRF 007	*	*	*	*	*	*	*	£84.84
BRAKES FRONT	shield, for caliper Tri MK 2 L-H	BRF 022	*	*	*	*	*	*	*	£21.23
BRAKES FRONT	shield, for caliper Tri MK 2 R-H	BRF 021	*	*	*	*	*	*	*	£21.23
BRAKES FRONT	spring, pedal return spring, brake & clutch, Tri	BRF 012	*	*	*	*	*	*	*	£4.60
BRAKES FRONT	switch, brake light, Tri MK 2	BRF 019	*	*	*	*	*	*	*	£5.49
BRAKES FRONT	valve, non return valve, servo	BRF 169	*	*	*	*	*	*	*	£34.04
BRAKES FRONT	washer, copper, hose to cylinder	BRF 253	*	*	*	*	*	*	*	£0.53
BRAKES FRONT	washer, locking, for brake hose, (use with nut)	BRF 252	*	*	*	*	*	*	*	£0.33
BRAKES FRONT	washer-spring, pedal shaft, ●TR RE● 2	BRF 101	*	*	*	*	*	*	*	£2.03
<b>Brakes rear</b>										
BRAKES REAR	adjuster, manual rear TRI MK 1	BRR 006	*	*	*	*	*	*	*	£27.70
BRAKES REAR	cable, handbrake front TRI all models	BRR 022	*	*	*	*	*	*	*	£12.40
BRAKES REAR	cable, handbrake rear axle TRI MK 1	BRR 024	*	*	*	*	*	*	*	£12.05
BRAKES REAR	cable, handbrake rear axle TRI MK 2	BRR 023	*	*	*	*	*	*	*	£10.83
BRAKES REAR	clip, for retaining rear wheel cylinder	BRR 031	*	*	*	*	*	*	*	£2.03
BRAKES REAR	cyl, whl, re, MK 1,	BRR 001	*	*	*	*	*	*	*	£73.13
BRAKES REAR	cyl, whl, re, MK 2,	BRR 002	*	*	*	*	*	*	*	£16.61
BRAKES REAR	cyl, whl, re, MK 2, SPECIAL PRICE FOR 2 MK 2, REAR WHEEL CYLINDERS	BRR 00	*	*	*	*	*	*	*	£24.58
BRAKES REAR	cyl, whl, re, repair kit, 1 kit per cyl	BRR 004	*	*	*	*	*	*	*	£8.26
BRAKES REAR	drum, rear MK 1	BRR 019	*	*	*	*	*	*	*	£86.11
BRAKES REAR	drum, rear MK 2	BRR 020	*	*	*	*	*	*	*	£83.65
BRAKES REAR	drum, rear SHAND MK 2	BRR 021	*	*	*	*	*	*	*	£17.60
BRAKES REAR	dust cover, handbrake lever, Tri 2000/2.5	BRR 003	*	*	*	*	*	*	*	£4.79
BRAKES REAR	dust cover, handbrake lever, special price for 2, Tri 2000/2.5	BRR 0	*	*	*	*	*	*	*	£8.59
BRAKES REAR	fork, for rear handbrake cable, MK 1, RE● 1	BRR 129	*	*	*	*	*	*	*	£12.70
BRAKES REAR	fork, for rear handbrake cable, MK 2, RE● 1	BRR 032	*	*	*	*	*	*	*	£12.70
BRAKES REAR	gaiter, handbrake, exterior cable side (rubber)	BRR 034	*	*	*	*	*	*	*	£17.35
BRAKES REAR	hold down kit, for shoes MK1 (4 pins, springs, clips)	BRR 036	*	*	*	*	*	*	*	£12.70
BRAKES REAR	hold down kit, for shoes MK2 (4 pins, springs, clips)	BRR 037	*	*	*	*	*	*	*	£12.70
BRAKES REAR	hose, re, flexible, L-H	BRR 009	*	*	*	*	*	*	*	£13.79
BRAKES REAR	hose, re, flexible, R-H	BRR 008	*	*	*	*	*	*	*	£13.79
BRAKES REAR	lever, hand brake operations shoes L-H MK 2	BRR 018	*	*	*	*	*	*	*	£14.91
BRAKES REAR	pin, clevis, handbrake cable to handbrake lever	BRR 035	*	*	*	*	*	*	*	£2.03
BRAKES REAR	screw, bleed screw 3/8"UNF fr ●TY RE● 2, re ●TY RE● 2	BRR 026	*	*	*	*	*	*	*	£2.03
BRAKES REAR	screw, brake drum ●TY RE● 2 per drum	BRR 025	*	*	*	*	*	*	*	£2.03
BRAKES REAR	shoe, spring bottom R-H or L-H	BRR 015	*	*	*	*	*	*	*	£6.92
BRAKES REAR	shoe, spring middle L-H	BRR 014	*	*	*	*	*	*	*	£9.12
BRAKES REAR	shoe, spring middle R-H	BRR 013	*	*	*	*	*	*	*	£9.12
BRAKES REAR	shoe, spring top L-H	BRR 012	*	*	*	*	*	*	*	£4.16
BRAKES REAR	shoe, spring top R-H	BRR 011	*	*	*	*	*	*	*	£4.16
BRAKES REAR	shoes, set of 4 rear MK 1, no exchange	BRR 005	*	*	*	*	*	*	*	£16.70
BRAKES REAR	shoes, set of 4 rear MK 2, exchange	BRR 007	*	*	*	*	*	*	*	£44.27
BRAKES REAR	shoes, set of 4 rear MK 2, exchange, with adjusters	BRR 106	*	*	*	*	*	*	*	£56.15
BRAKES REAR	shoes, set of 4 rear MK 2, surcharge	BRR 071	*	*	*	*	*	*	*	£25.61
<b>Bumpers</b>										
BUMPERS	bolt & nut, for bumper pad MK 2	BM 020	*	*	*	*	*	*	*	£3.85
BUMPERS	bolt, chromed fr/re bumper long type farina, Tri MK1	BM 0061	*	*	*	*	*	*	*	£2.94
BUMPERS	bolt, re centre MK 2 bumper to rear panel	BM 023	*	*	*	*	*	*	*	£3.89
BUMPERS	bolt, re ●TR bumper MK 2 side to rear wing	BM 022	*	*	*	*	*	*	*	£2.58
BUMPERS	bracket, front bumper MK 2 (centre) ●TY RE● 2	BM 013	*	*	*	*	*	*	*	£18.67
BUMPERS	bracket, front bumper MK 2 (side) ●TY RE● 2	BM 014	*	*	*	*	*	*	*	£10.57
BUMPERS	bumper, fr plain MK 1 rechromed exch	BM 0040	*	*	*	*	*	*	*	£387.83
BUMPERS	bumper, fr plain MK 1 surcharge	BM 0041	*	*	*	*	*	*	*	£103.70
BUMPERS	bumper, fr plain MK 2	BM 0001	*	*	*	*	*	*	*	£435.52
BUMPERS	bumper, re centre MK 2 plain estate	BM 0003	*	*	*	*	*	*	*	£302.69
BUMPERS	bumper, re centre MK 2 plain saloon	BM 0044	*	*	*	*	*	*	*	£302.69
BUMPERS	bumper, re centre MK 2 with 7 holes est	BM 0016	*	*	*	*	*	*	*	£302.69
BUMPERS	bumper, re centre MK 2 with 8 holes saloon	BM 0008	*	*	*	*	*	*	*	£302.69
BUMPERS	bumper, re centre MK1 facelift refurbished	BM 0094	*	*	*	*	*	*	*	£362.94
BUMPERS	bumper, re centre MK1 pre facelift refurbished	BM 0090	*	*	*	*	*	*	*	£226.07
BUMPERS	bumper, re centre MK1 surcharge	BM 0089	*	*	*	*	*	*	*	£93.34
BUMPERS	bumper, re ●TR L-H MK 2 plain estate	BM 0005	*	*	*	*	*	*	*	£124.33
BUMPERS	bumper, re ●TR L-H MK 2 plain saloon	BM 0042	*	*	*	*	*	*	*	£139.98
BUMPERS	bumper, re ●TR L-H MK 2 with 4 holes est	BM 0018	*	*	*	*	*	*	*	£93.34
BUMPERS	bumper, re ●TR L-H MK 2 with 4 holes saloon	BM 0010	*	*	*	*	*	*	*	£93.34
BUMPERS	bumper, re ●TR R-H MK 2 plain estate	BM 0004	*	*	*	*	*	*	*	£124.33
BUMPERS	bumper, re ●TR R-H MK 2 plain saloon	BM 0043	*	*	*	*	*	*	*	£139.98
BUMPERS	bumper, re ●TR R-H MK 2 with 4 holes est	BM 0017	*	*	*	*	*	*	*	£93.34
BUMPERS	bumper, re ●TR R-H MK 2 with 4 holes saloon	BM 0011	*	*	*	*	*	*	*	£93.34
BUMPERS	bumper, re ●TR Tri MK1 L-H, refurbished	BM 0092	*	*	*	*	*	*	*	£145.07
BUMPERS	bumper, re ●TR Tri MK1 R-H refurbished	BM 0093	*	*	*	*	*	*	*	£145.07
BUMPERS	bumper, re ●TR Tri MK1 surcharge	BM 0091	*	*	*	*	*	*	*	£62.20
BUMPERS	fixing plate, 3 bolt re bumper to ●TR bumper MK2	BM 0021	*	*	*	*	*	*	*	£14.84
BUMPERS	joint, between re centre/●TR bumper MK1 only	BM 0097	*	*	*	*	*	*	*	£8.43
BUMPERS	joint, between re centre/●TR bumper pad type MK2	BM 0012	*	*	*	*	*	*	*	£6.36
BUMPERS	joint, between re centre/●TR bumper pad type MK2, SPECIAL PRICE FOR 2	BM 00	*	*	*	*	*	*	*	£10.33
BUMPERS	joint, between re centre/●TR bumper plain type MK 2	BM 0006	*	*	*	*	*	*	*	£8.43
BUMPERS	over-rider, fr & re Tri MK1 pre (plain) refurbished	BM 0083	*	*	*	*	*	*	*	£102.65
BUMPERS	over-rider, fr & re Tri MK1 surcharge	BM 0088	*	*	*	*	*	*	*	£51.86
BUMPERS	pad, re centre bumper MK 2 est (●TY RE● 7 dips)	BM 0019	*	*	*	*	*	*	*	£43.56
BUMPERS	pad, re ●TR bumper MK 2 sal & est (●TY 4 dips)	BM 0015	*	*	*	*	*	*	*	£36.29
BUMPERS	pad, rear bumper MK 2 saloon (●TY RE● 7 dips)	BM 0009	*	*	*	*	*	*	*	£43.56
BUMPERS	strip seating, front or rear over riders (per metre)	BM 0034	*	*	*	*	*	*	*	£8.43
BUMPERS	washer, rubber re ●TR & centre bumper to panel	BM 0024	*	*	*	*	*	*	*	£1.31
<b>Clutch</b>										
CLUTCH	bearing, release (borg/beck & laycock)	CL 0030	*	*	*	*	*	*	*	£10.57
CLUTCH	bush, clutch cross shaft/bell housing extra wide	CL 0036	*	*	*	*	*	*	*	£4.16
CLUTCH	cap, master cylinder	CL 0043	*	*	*	*	*	*	*	£4.16
CLUTCH	carriage, release bearing	CL 0031	*	*	*	*	*	*	*	£62.11
CLUTCH	carriage, release bearing fork square late	CL 0033	*	*	*	*	*	*	*	£2.23
CLUTCH	clutch kit, borg/beck recon cover, plate & new bearing	CL 0028	*	*	*	*	*	*	*	£173.40
CLUTCH	clutch kit, laycock / borg & beck, surcharge	CL 0024	*	*	*	*	*	*	*	£67.87



CLUTCH	clutch kit, laycock recon, cover, plate & new bearing	CL 0023	*	*	*	*	*	*	*	*	*	£151.14
CLUTCH	cover, clutch berg & beck recon	CL 0028	*	*	*	*	*	*	*	*	*	£102.53
CLUTCH	cover, clutch laycock recon	CL 0026	*	*	*	*	*	*	*	*	*	£102.53
CLUTCH	cover, clutch laycock surcharge	CL 0027	*	*	*	*	*	*	*	*	*	£36.29
CLUTCH	cyl, master repair kit, TRI MK 1 & 2, Dia 5/8" (all models)	CL 0041	*	*	*	*	*	*	*	*	*	£9.36
CLUTCH	cyl, master, TRI MK 1, 2000, 1964-69, with reservoir	CL 0100	*	*	*	*	*	*	*	*	*	£145.07
CLUTCH	cyl, master, TRI MK 2, NEW but exch, with out re	CL 0040	*	*	*	*	*	*	*	*	*	£176.29
CLUTCH	cyl, master, TRI MK1 late & MK2, stainless steel sleeve, recon, exch	CL 0044	*	*	*	*	*	*	*	*	*	£145.07
CLUTCH	cyl, master, TRI MK 2, surcharge	CL 0046	*	*	*	*	*	*	*	*	*	£51.86
CLUTCH	cyl, slave, 1" (use with Laycock clutch)	CL 0050	*	*	*	*	*	*	*	*	*	£22.14
CLUTCH	cyl, slave, 7/8" (use with Berg & Beck clutch)	CL 0047	*	*	*	*	*	*	*	*	*	£47.60
CLUTCH	cyl, slave, repair kit, 1" (seals only)	CL 0115	*	*	*	*	*	*	*	*	*	£10.64
CLUTCH	cyl, slave, repair kit, 1" (with piston & seals)	CL 0049	*	*	*	*	*	*	*	*	*	£31.91
CLUTCH	cyl, slave, repair kit, 7/8" (seals only)	CL 0114	*	*	*	*	*	*	*	*	*	£10.64
CLUTCH	cyl, slave, repair kit, 7/8" (with piston & seals)	CL 0048	*	*	*	*	*	*	*	*	*	£31.91
CLUTCH	fork, for cross shaft clutch	CL 0035	*	*	*	*	*	*	*	*	*	£75.39
CLUTCH	hose, clutch, nylon, master cly to slave cyl MK1	CL 0170	*	*	*	*	*	*	*	*	*	£27.65
CLUTCH	hose, rubber master cylinder to reservoir MK 2	CL 0045	*	*	*	*	*	*	*	*	*	£5.24
CLUTCH	pin, clevis, clutch cross shaft to push rod	CL 0037	*	*	*	*	*	*	*	*	*	£2.22
CLUTCH	pin, for carriage release bearing	CL 0032	*	*	*	*	*	*	*	*	*	£0.53
CLUTCH	pin, for clutch fork carriage QTY REQ 2	CL 0039	*	*	*	*	*	*	*	*	*	£4.16
CLUTCH	pin, tapered for clutch fork STD	CL 0034	*	*	*	*	*	*	*	*	*	£11.73
CLUTCH	pipe, copper, MK1, master cyl to slave, nylon pipe	CL 0175	*	*	*	*	*	*	*	*	*	£21.23
CLUTCH	pipe, nylon, MK2, master cyl to slave cyl	CL 0176	*	*	*	*	*	*	*	*	*	£35.11
CLUTCH	plate, clutch recon	CL 0062	*	*	*	*	*	*	*	*	*	£42.64
CLUTCH	plate, clutch surcharge	CL 0025	*	*	*	*	*	*	*	*	*	£21.34
CLUTCH	push rod, cylinder slave	CL 0051	*	*	*	*	*	*	*	*	*	£27.65
CLUTCH	shaft, clutch cross shaft fits in bell housing	CL 0038	*	*	*	*	*	*	*	*	*	£56.92
CLUTCH	spring & adapter, master cylinder	CL 0042	*	*	*	*	*	*	*	*	*	£18.54
CLUTCH	spring, pedal return spring, clutch & brake, Tr	CL 0169	*	*	*	*	*	*	*	*	*	£4.60
<b>Cooling system</b>												
COOLING SYST	adapter, for pulley wheel, for viscous hub PAS	COS 032	*	*	*	*	*	*	*	*	*	£12.70
COOLING SYST	adapter, wtr pump housing to inlet manifold MK1&2	COS 200	*	*	*	*	*	*	*	*	*	£16.97
COOLING SYST	banjo bolt, rear of manifold MK1&2	COS	*	*	*	*	*	*	*	*	*	£48.68
COOLING SYST	belt, dynamo type Tr MK 1 & 2	COS 042	*	*	*	*	*	*	*	*	*	£12.70
COOLING SYST	belt, fan alternator type Tri MK 2	COS 041	*	*	*	*	*	*	*	*	*	£12.70
COOLING SYST	belt, for viscous hub	COS 034	*	*	*	*	*	*	*	*	*	£3.52
COOLING SYST	bush, rubber for fan blade mounting MK1&2(QTY REQ 3)	COS 040	*	*	*	*	*	*	*	*	*	£2.45
COOLING SYST	cap, radiator Tr MK 1	COS 043	*	*	*	*	*	*	*	*	*	£10.46
COOLING SYST	cap, radiator Tri MK 2	COS 044	*	*	*	*	*	*	*	*	*	£10.46
COOLING SYST	clip, hose, top & bottom radiator hoses all models	COS 132	*	*	*	*	*	*	*	*	*	£1.07
COOLING SYST	clip, hoses heater & wtr pump to inlet manifold hose	COS 131	*	*	*	*	*	*	*	*	*	£1.29
COOLING SYST	dowel, adapter to pulley wheel PAS, viscous hub	COS 033	*	*	*	*	*	*	*	*	*	£8.96
COOLING SYST	elbow, housing thermostat	COS 051	*	*	*	*	*	*	*	*	*	£55.18
COOLING SYST	fan, fixed type (13 blades) s/h (blue in colour) TRI	COS 036	*	*	*	*	*	*	*	*	*	£38.43
COOLING SYST	fan, fixed type TRI MK 2 (8 blades) s/hand	COS 079	*	*	*	*	*	*	*	*	*	£25.50
COOLING SYST	fan, viscous type TRI MK 2 (13 blades) s/hand	COS 076	*	*	*	*	*	*	*	*	*	£25.50
COOLING SYST	gasket, pump water	COS 038	*	*	*	*	*	*	*	*	*	£2.11
COOLING SYST	gasket, thermostat proper shape A99, TRI 2000/2500 etc	COS 024	*	*	*	*	*	*	*	*	*	£2.11
COOLING SYST	gasket, water pump to cylinder head all models	COS 111	*	*	*	*	*	*	*	*	*	£2.34
COOLING SYST	heater assy, good s/hand, Tr MK2	COS 130	*	*	*	*	*	*	*	*	*	£74.56
COOLING SYST	hose, below rear of manifold 1975 on (REINFORCED)	COS 060	*	*	*	*	*	*	*	*	*	£5.04
COOLING SYST	hose, heater bulkhead twirl shape S/B & SUHS4 MK2	COS 056	*	*	*	*	*	*	*	*	*	£5.04
COOLING SYST	hose, heater bulkhead U shape large all models MK2	COS 057	*	*	*	*	*	*	*	*	*	£10.07
COOLING SYST	hose, heater bulkhead U shape small MK2 SU HS6 & P	COS 058	*	*	*	*	*	*	*	*	*	£8.52
COOLING SYST	hose, rad, bottom lower P.A.S. pipe to rad bitm 45%	COS 048	*	*	*	*	*	*	*	*	*	£6.20
COOLING SYST	hose, rad, bottom non P.A.S	COS 046	*	*	*	*	*	*	*	*	*	£11.24
COOLING SYST	hose, rad, bottom upper P.A.S. thermostat to pipe 90%	COS 047	*	*	*	*	*	*	*	*	*	£5.04
COOLING SYST	hose, rad, top all 2000TC 2500TC & S models or HS6	COS 106	*	*	*	*	*	*	*	*	*	£7.67
COOLING SYST	hose, rad, top MK 1 & MK 2 2000 & P	COS 045	*	*	*	*	*	*	*	*	*	£7.98
COOLING SYST	hose, short link under banjo to pipe SB & SUHS4	COS 055	*	*	*	*	*	*	*	*	*	£1.55
COOLING SYST	hose, water pump to manifold (REINFORCED) HS6 75 on	COS 073	*	*	*	*	*	*	*	*	*	£8.97
COOLING SYST	hose, water, heater to cyl head, Tri MK1	COS 206	*	*	*	*	*	*	*	*	*	£9.06
COOLING SYST	hose, water, heater to manifold, Tri MK1	COS 202	*	*	*	*	*	*	*	*	*	£9.06
COOLING SYST	hose, wtr pump to manifold (REINFORCED) HS4&S/B to 75	COS 054	*	*	*	*	*	*	*	*	*	£6.88
COOLING SYST	hose kit, 2000 MK1, top & bottom hoses, heater, manifold hose, all hoses		*	*	*	*	*	*	*	*	*	£40.11
COOLING SYST	hose kit, 2000 2500 MK2 HS4 & SB, manual steering, top & bottom, heater hoses		*	*	*	*	*	*	*	*	*	£38.48
COOLING SYST	manifold hoses, all hoses		*	*	*	*	*	*	*	*	*	
COOLING SYST	hose kit, 2000 2500 MK2 HS4&SB, PAS steering, top & btm, heater, manifold hose, all hoses		*	*	*	*	*	*	*	*	*	£38.36
COOLING SYST	manifold hoses, all hoses		*	*	*	*	*	*	*	*	*	
COOLING SYST	hose kit, 2000TC 2500TC 2500S MK2 HS6, manual steering, top & bottom,		*	*	*	*	*	*	*	*	*	£44.56
COOLING SYST	heater hoses, manifold hoses, all hoses		*	*	*	*	*	*	*	*	*	
COOLING SYST	hose kit, 2000TC 2500TC 2500S MK2 HS6, PAS steering, top & btm, heater hoses		*	*	*	*	*	*	*	*	*	£44.56
COOLING SYST	heater hoses, manifold hoses, all hoses		*	*	*	*	*	*	*	*	*	
COOLING SYST	hub, viscous fan (NEW) Tr MK2	COS 039	*	*	*	*	*	*	*	*	*	£139.46
COOLING SYST	hub, viscous fan, s/hand TRI MK 2	COS 129	*	*	*	*	*	*	*	*	*	£51.75
COOLING SYST	locking tab, fan blade	COS 209	*	*	*	*	*	*	*	*	*	£2.72
COOLING SYST	nut, return pipe behind exhst manifold s/s all mals	COS 137	*	*	*	*	*	*	*	*	*	£7.65
COOLING SYST	o ring, seal for (heater) valve (farina & Tri MK1)	COS 032	*	*	*	*	*	*	*	*	*	£2.11
COOLING SYST	pipe, return behind exhst manifold s/s MK1 2000	COS 133	*	*	*	*	*	*	*	*	*	£36.82
COOLING SYST	pipe, return behind exhst manifold s/s MK1/2, 2.5 P	COS 135	*	*	*	*	*	*	*	*	*	£48.97
COOLING SYST	pipe, return behind exhst manifold s/s MK2 HS6 75 on	COS 136	*	*	*	*	*	*	*	*	*	£45.26
COOLING SYST	pipe, return behind exhst manifold s/s MK2 S/B & HS4	COS 134	*	*	*	*	*	*	*	*	*	£41.37
COOLING SYST	pipe, steel for P.A.S. bottom hose (rad) reman	COS 049	*	*	*	*	*	*	*	*	*	£13.09
COOLING SYST	pulley wheel, for viscous hub PAS s/hand TRI MK 2	COS 031	*	*	*	*	*	*	*	*	*	£25.61
COOLING SYST	pump, water, Tr 2000/2500	COS 037	*	*	*	*	*	*	*	*	*	£43.20
COOLING SYST	radiator, recondition exchange (3 core row) STD	COS 074	*	*	*	*	*	*	*	*	*	£293.23
COOLING SYST	radiator, recondition exchange (4 core row)	COS 110	*	*	*	*	*	*	*	*	*	£441.94
COOLING SYST	radiator, surcharge	COS 075	*	*	*	*	*	*	*	*	*	£82.19
COOLING SYST	thermostat, 74c (cooler running) all mals, except 4LR	COS 126	*	*	*	*	*	*	*	*	*	£9.75
COOLING SYST	thermostat, 82c (normal) all models, except 4LR	COS 053	*	*	*	*	*	*	*	*	*	£9.75
COOLING SYST	thermostat, 88c (winter) all models, except 4LR	COS 116	*	*	*	*	*	*	*	*	*	£9.75
COOLING SYST	transmitter, thermal MK 1 & 2 1967-77	COS 072	*	*	*	*	*	*	*	*	*	£8.37





ENGINE	piston set, MK2 2000 to 50000 1965-70 +0.030'	EG 0156	*	*	*	*	*	*	*	£404.42
ENGINE	piston set, MK2 2000 to 50000 1965-70 STD flat top	EG 0152	*	*	*	*	*	*	*	£404.42
ENGINE	piston set, MK2 2000 from 50001 1970-75 +0.020'	EG 0154	*	*	*	*	*	*	*	£383.68
ENGINE	piston set, MK2 2000 from 50001 1970-75 +0.030'	EG 0155	*	*	*	*	*	*	*	£383.68
ENGINE	piston set, MK2 2000 from 50001 1970-75 +0.040'	EG 0161	*	*	*	*	*	*	*	£383.68
ENGINE	piston set, MK2 2000 from 50001 1970-75 STD dommed	EG 0153	*	*	*	*	*	*	*	£383.68
ENGINE	piston set, MK2 2500/2.5 STD	EG 0157	*	*	*	*	*	*	*	£300.73
ENGINE	piston set, MK2 2500/2.5 +0.020'	EG 0158	*	*	*	*	*	*	*	£300.73
ENGINE	piston set, MK2 2500/2.5 +0.030'	EG 0159	*	*	*	*	*	*	*	£300.73
ENGINE	piston set, MK2 2500/2.5 +0.040'	EG 0160	*	*	*	*	*	*	*	£300.73
ENGINE	plug, sump plug, Tri MK1 & 2, std	EG 0411	*	*	*	*	*	*	*	£31.31
ENGINE	plug, sump plug, Tri MK1 & 2, magnetic	EG 0518	*	*	*	*	*	*	*	£16.97
ENGINE	plug, sump plug, Tri MK1 & 2, magnetic	EG 0518	*	*	*	*	*	*	*	£16.97
ENGINE	pump, oil assy	EG 0120	*	*	*	*	*	*	*	£101.08
ENGINE	pump, oil pump, rotor and spindle (alloy pump)	EG 0331	*	*	*	*	*	*	*	£45.52
ENGINE	pump, oil pump, rotor and spindle (cast iron pump)	EG 0329	*	*	*	*	*	*	*	£45.52
ENGINE	push rod, 2000 MK 1 from eng No MB 13751E	EG 0099	*	*	*	*	*	*	*	£14.84
ENGINE	push rod, MK 2 2000/2.5 Pi domed piston 4-1/8" long	EG 0590	*	*	*	*	*	*	*	£6.30
ENGINE	push rod, MK2 2.5TC & S, 8-5/16" long	EG 0631	*	*	*	*	*	*	*	£6.30
ENGINE	push rod, MK2 2000 flat top piston 8" long	EG 0632	*	*	*	*	*	*	*	£6.30
ENGINE	ring gear, for fly wheel	EG 0074	*	*	*	*	*	*	*	£23.37
ENGINE	ring set, MK 1/2 2000 to eng 50001 1964-71 STD	EG 0138	*	*	*	*	*	*	*	£103.59
ENGINE	ring set, MK 1/2 2000 to eng 50001 1964-71 +0.020'	EG 0140	*	*	*	*	*	*	*	£103.59
ENGINE	ring set, MK 1/2 2000 to eng 50001 1964-71 +0.030'	EG 0142	*	*	*	*	*	*	*	£103.59
ENGINE	ring set, MK 1/2 2000 to eng 50001 1964-71 +0.040'	EG 0144	*	*	*	*	*	*	*	£103.59
ENGINE	ring set, MK 1/2 2000 to eng 50001 1964-71 +0.060'	EG 0141	*	*	*	*	*	*	*	£103.59
ENGINE	ring set, MK 1/2 2500/2.5 1968-71 STD	EG 0146	*	*	*	*	*	*	*	£103.59
ENGINE	ring set, MK 1/2 2500/2.5 1968-71 +0.020'	EG 0136	*	*	*	*	*	*	*	£103.59
ENGINE	ring set, MK 1/2 2500/2.5 1968-71 +0.030'	EG 0145	*	*	*	*	*	*	*	£103.59
ENGINE	ring set, MK 1/2 2500/2.5 1968-71 +0.040'	EG 0147	*	*	*	*	*	*	*	£103.59
ENGINE	ring set, MK 1/2 2500/2.5 1968-71 +0.060'	EG 0148	*	*	*	*	*	*	*	£103.59
ENGINE	rocker arm, front for rocker shaft, rocker No2	EG 0081	*	*	*	*	*	*	*	£28.95
ENGINE	rocker arm, rear for rocker shaft, rocker No 1	EG 0082	*	*	*	*	*	*	*	£19.50
ENGINE	rocker shaft assy, Tri MK2, recon ex shaft&arms etc	EG 0577	*	*	*	*	*	*	*	£175.23
ENGINE	rocker shaft assy, Tri MK2, surcharge	EG 0578	*	*	*	*	*	*	*	£51.86
ENGINE	rod, connecting MK 2 all models	EG 0100	*	*	*	*	*	*	*	£48.73
ENGINE	seal, dip stick	EG 0092	*	*	*	*	*	*	*	£2.45
ENGINE	seal, oil rear crankshaft	EG 0073	*	*	*	*	*	*	*	£9.06
ENGINE	seal, oil timing cover, double lipped	EG 0055	*	*	*	*	*	*	*	£6.83
ENGINE	seal, valve stem seal, inlet ONLY	EG 0638	*	*	*	*	*	*	*	£2.03
ENGINE	service kit, 1 oil filter 2 air filters, 6 spark plugs, HT lead set, condenser, contact set, rotor arm		*	*	*	*	*	*	*	£75.88
ENGINE	distributor cap, D LUX TRI 2000 MK1, 2									
ENGINE	service kit, 1 oil filter 2 air filters, 6 spark plugs, condenser, contact set, rotor arm		*	*	*	*	*	*	*	£53.82
ENGINE	TRI 2000 MK1, 2, STANDARD									
ENGINE	shaft, rocker MK 1 & 2 2500 & 2.5 Pi	EG 0080	*	*	*	*	*	*	*	£66.26
ENGINE	shaft, rocker MK 1 2000 ONLY	EG 0079	*	*	*	*	*	*	*	£82.85
ENGINE	sleeve, crankshaft front / use with oil seal	EG 0094	*	*	*	*	*	*	*	£28.70
ENGINE	spring, for valve EXTRA STRONG MK 2 EXCEPT Pi	EG 0165	*	*	*	*	*	*	*	£2.34
ENGINE	spring, for valve inlet & exhaust MK 1	EG 0168	*	*	*	*	*	*	*	£3.05
ENGINE	spring, for valve inner & outer Pi from MG 50001	EG 0163	*	*	*	*	*	*	*	£4.25
ENGINE	spring, for valve inner & outer Pi up to MG 50000	EG 0164	*	*	*	*	*	*	*	£4.25
ENGINE	spring, for valve single STD MK 2 EXCEPT Pi	EG 0166	*	*	*	*	*	*	*	£2.78
ENGINE	sprocket, camshaft 2.5 (timing chain duplex)	EG 0069	*	*	*	*	*	*	*	£55.00
ENGINE	sprocket, camshaft 2000 (timing chain single)	EG 0070	*	*	*	*	*	*	*	£54.96
ENGINE	sprocket, crankshaft 2.5 (timing chain duplex)	EG 0072	*	*	*	*	*	*	*	£48.77
ENGINE	sprocket, crankshaft 2000 (timing chain single)	EG 0071	*	*	*	*	*	*	*	£51.03
ENGINE	stud, cylinder head 2000 QTY RE 14	EG 0115	*	*	*	*	*	*	*	£6.19
ENGINE	stud, manifold stud, TRI MK2 (QTY RE 2) 1-3/8x3/8	EG 0537	*	*	*	*	*	*	*	£2.03
ENGINE	stud, manifold stud, TRI MK2 (QTY RE 3) 1-1/2x5/16	EG 0680	*	*	*	*	*	*	*	£1.93
ENGINE	stud, manifold stud, TRI MK2 (QTY RE 6) 1-7/8x3/8	EG 0678	*	*	*	*	*	*	*	£2.23
ENGINE	switch, oil pressure light MK 1 & 2 1967-77	EG 0113	*	*	*	*	*	*	*	£6.61
ENGINE	switch, oil pressure light MK 1 ONLY 1964-66	EG 0112	*	*	*	*	*	*	*	£16.75
ENGINE	tensioner, timing chain 2000	EG 0052	*	*	*	*	*	*	*	£6.30
ENGINE	tensioner, timing chain 2500/2.5	EG 0053	*	*	*	*	*	*	*	£6.38
ENGINE	valve, exhaust MK 1 2000 for lead free	EG 0084	*	*	*	*	*	*	*	£13.62
ENGINE	valve, exhaust MK 2 2.5 Pi from MG #2077	EG 0087	*	*	*	*	*	*	*	£11.06
ENGINE	valve, exhaust MK 2 2.5 Pi up to MG #2076	EG 0167	*	*	*	*	*	*	*	£12.91
ENGINE	valve, exhaust MK 2 2000 from ME 50001E 1973-77	EG 0086	*	*	*	*	*	*	*	£12.91
ENGINE	valve, exhaust MK 2 2000 up to ME 50000E 1969-73	EG 0162	*	*	*	*	*	*	*	£12.91
ENGINE	valve, exhaust MK 2 2500S & TC 1974-77	EG 0175	*	*	*	*	*	*	*	£11.63
ENGINE	valve, inlet MK 1 2000 for lead free	EG 0083	*	*	*	*	*	*	*	£10.41
ENGINE	valve, inlet MK 2 2000, 2500 & 2.5	EG 0085	*	*	*	*	*	*	*	£9.28
ENGINE	valve, relief oil press	EG 0101	*	*	*	*	*	*	*	£10.57
ENGINE	valve, relief spring oil press	EG 0102	*	*	*	*	*	*	*	£2.58
ENGINE	washer tab, sprocket camshaft (locking washer)	EG 0118	*	*	*	*	*	*	*	£2.11
ENGINE	washer, crankshaft front for use with timing gear	EG 0093	*	*	*	*	*	*	*	£16.86
ENGINE	washer, for cly head stud TRI MK 2	EG 0679	*	*	*	*	*	*	*	£9.56
ENGINE	washers, thrust 1 pair MK 2 STD	EG 0132	*	*	*	*	*	*	*	£8.43
ENGINE	washers, thrust 1 pair MK 2 +0.05'	EG 0133	*	*	*	*	*	*	*	£8.43
ENGINE	washers, thrust 1 pair MK 2 +0.15'	EG 0135	*	*	*	*	*	*	*	£8.43
ENGINE	washers, thrust 1 pair MK 2 +0.30'	EG 0134	*	*	*	*	*	*	*	£8.43
ENGINE	washers, thrust 1 pair MK1 2000 STD to MB70000E	EG 0415	*	*	*	*	*	*	*	£19.11
ENGINE	washers, thrust 1 pair MK1 2000 +0.05' to MB70000E	EG 0420	*	*	*	*	*	*	*	£19.11
ENGINE	X member, engine, (anti roll bar) engine offset, HS6, NEW	EG 0525	*	*	*	*	*	*	*	£118.98
ENGINE	X member, engine, (anti roll bar) HS4&S/B, NEW	EG 0390	*	*	*	*	*	*	*	£118.98
ENGINE	X member, engine, (non anti roll) engine offset, HS6, NEW	EG 0526	*	*	*	*	*	*	*	£118.98
ENGINE	X member, engine, (non anti roll) recon, ex, HS4&S/B	EG 0109	*	*	*	*	*	*	*	£54.82
<b>Exhaust fitting kit</b>										
EXH, FIT KIT	20 MK1 1963-69 inc all fittings excludes EF 27	EFK 001	*	*	*	*	*	*	*	£38.87
EXH, FIT KIT	20 MK2 1969-71 inc all fittings exclude EF 27/21	EFK 002	*	*	*	*	*	*	*	£55.83
EXH, FIT KIT	20 MK2 1971-75 inc all fittings excludes EF 27/21	EFK 003	*	*	*	*	*	*	*	£55.83
EXH, FIT KIT	20/2.5 MK2 1974-77 inc all fittings exc EF 27/21	EFK 004	*	*	*	*	*	*	*	£55.83
<b>Exhausts Mild Steel</b>										
EXHAUSTS	B1 fr pipe, 2000 MK1 man o/air com MB 12187 1964-69	EX 0022	*	*	*	*	*	*	*	£63.03
EXHAUSTS	B2 cen sect, 2000 MK1 man o/air com MB 12187 1964-69	EX 0023	*	*	*	*	*	*	*	£189.57



EXHST F'INGS	mounting, male re ex clamp MK 1	TY 2, MK2	TY 4	EF 0016	*	*	*	*	*	*	*	*	£5.45
EXHST F'INGS	mounting, re pig nose sal	MK 2	1971-77	EF 0010	*	*	*	*	*	*	*	*	£11.77
EXHST F'INGS	mounting, re subframe & clamp	MK 1		EF 0100	*	*	*	*	*	*	*	*	£34.99
EXHST F'INGS	mounting, re subframe & clamp	MK 2		EF 0014	*	*	*	*	*	*	*	*	£39.18
EXHST F'INGS	nut, brass for front pipe	MK 1	TY RE 3 (5/16UNF)	EF 0025	*	*	*	*	*	*	*	*	£1.93
EXHST F'INGS	nut, brass for front pipe	MK 2	TY 3 (3/8UNC)	EF 0026	*	*	*	*	*	*	*	*	£1.93
EXHST F'INGS	plate, mounting rear subframe	TY RE 2 (stainless)		EF 0027	*	*	*	*	*	*	*	*	£3.79
EXHST F'INGS	strap, tailpipe	MK 1	2000 (saloon & estate)	EF 0020	*	*	*	*	*	*	*	*	£3.88
EXHST F'INGS	strap, tailpipe	MK 2	all EXCEPT saloon 1971-75	EF 0011	*	*	*	*	*	*	*	*	£3.88
EXHST F'INGS	stud, manifold to front pipe	MK 1	TY RE 3	EF 0003	*	*	*	*	*	*	*	*	£5.57
EXHST F'INGS	stud, manifold to front pipe	MK 2	TY RE 3	EF 0004	*	*	*	*	*	*	*	*	£5.57
EXHST F'INGS	tube, spacer re subframe exhaust mount	MK 2	TY 1	EF 0021	*	*	*	*	*	*	*	*	£3.07
EXHST F'INGS	washer, MK 1	TY RE 3	MK 2	TY RE 10 (1'X5/16ID)	EF 0012	*	*	*	*	*	*	*	£0.36
<b>Exhaust manifold</b>													
EXHST MANFD	manifold, s/hand	MK 1	cast iron	EM 0001	*	*	*	*	*	*	*	*	£254.49
EXHST MANFD	manifold, s/hand	MK 2	cast iron	EM 0002	*	*	*	*	*	*	*	*	£181.73
<b>Fuel system</b>													
FUEL SYST	bearing, accelerator shaft, Tri	MK1		FS 0255	*	*	*	*	*	*	*	*	£6.30
FUEL SYST	cable, choke	MK 2	2000 from 1974 prefacelift	FS 0052	*	*	*	*	*	*	*	*	POA
FUEL SYST	cable, choke	MK 2	2000 to 1974 prefacelift	FS 0051	*	*	*	*	*	*	*	*	POA
FUEL SYST	cable, choke	MK 2	2000TC 2500TC & S facelift	FS 0053	*	*	*	*	*	*	*	*	£34.04
FUEL SYST	cable, throttle	MK1/2	2000(fmME50001) S/B&HS4 R-H Dr	FS 0030	*	*	*	*	*	*	*	*	£19.11
FUEL SYST	cable, throttle	MK2	2000, 2500 L-Drive	FS 0108	*	*	*	*	*	*	*	*	£19.11
FUEL SYST	cable, throttle	MK2	2000/2500TC/S 74-77, HS6 R-Drive	FS 0033	*	*	*	*	*	*	*	*	£19.11
FUEL SYST	cap, locking, petrol cap & keys (fuel tank)	all models		FS 0109	*	*	*	*	*	*	*	*	£31.91
FUEL SYST	cap, petrol cap (fuel tank)	all models		FS 0066	*	*	*	*	*	*	*	*	£23.38
FUEL SYST	clip, plas twin, fuel pipe	TY 10	sal Pi, est Pi 14	FS 0060	*	*	*	*	*	*	*	*	£1.54
FUEL SYST	clip, single metal for fuel pipe	TY 1	sal only	FS 0050	*	*	*	*	*	*	*	*	£1.54
FUEL SYST	clip, single plas, for fuel pipe	TY 1	sal only	FS 0062	*	*	*	*	*	*	*	*	£1.54
FUEL SYST	clip, single plastic fuel pipe	TY 11	est 15	FS 0057	*	*	*	*	*	*	*	*	£1.54
FUEL SYST	clip, twin plas fuel pipe	TY 3	sal, est Pi ONLY 1	FS 0058	*	*	*	*	*	*	*	*	£1.31
FUEL SYST	clip, twin plas twin fuel pipe	TY 1	sal Pi	FS 0061	*	*	*	*	*	*	*	*	£1.54
FUEL SYST	diaphragm, (emission control valve)			FS 0056	*	*	*	*	*	*	*	*	£8.51
FUEL SYST	diaphragm, Stromberg	150	MK1 CD, MK2 CD3, CDS, CDSE	FS 0091	*	*	*	*	*	*	*	*	£9.50
FUEL SYST	filter air, 2000	MK1&2	1965-77 with Strombergs (TY RE 2)	FS 0006	*	*	*	*	*	*	*	*	£17.94
FUEL SYST	filter air, 2000	MK2	with SU's (TY RE 2)	FS 0007	*	*	*	*	*	*	*	*	£19.11
FUEL SYST	filter air, 2000TC	MK2	(TY RE 1)	FS 0069	*	*	*	*	*	*	*	*	£14.84
FUEL SYST	filter air, 2500	MK2	(TY RE 1) 1968-74	FS 0009	*	*	*	*	*	*	*	*	£14.84
FUEL SYST	filter air, 2500TC & S	MK2	(TY RE 1) 1975 onwards	FS 0034	*	*	*	*	*	*	*	*	£14.84
FUEL SYST	filter air, 2500TC & S	MK2	(TY RE 2) 1974-75	FS 0068	*	*	*	*	*	*	*	*	£20.13
FUEL SYST	filter, fuel filter (inline, fits in fuel hose)			FS 0136	*	*	*	*	*	*	*	*	£7.05
FUEL SYST	float, SU carb	HS4 & HS6		FS 0019	*	*	*	*	*	*	*	*	£23.56
FUEL SYST	float, Strombergs carb			FS	*	*	*	*	*	*	*	*	£18.22
FUEL SYST	gasket set, HS4, SU carb (1 gasket set per carb)			FS 0002	*	*	*	*	*	*	*	*	£8.12
FUEL SYST	gasket set, HS6, SU carb (1 gasket set per carb)			FS 0055	*	*	*	*	*	*	*	*	£8.12
FUEL SYST	gasket set, Strombergs (TY RE 2)	Tri 2000	MK1	FS 0236	*	*	*	*	*	*	*	*	£12.77
FUEL SYST	gasket, float chamber	SU carb	HS4 & HS6	FS 0017	*	*	*	*	*	*	*	*	£1.38
FUEL SYST	gasket, fuel pump	all models		FS 0107	*	*	*	*	*	*	*	*	£1.54
FUEL SYST	glass, pump petrol			FS 0067	*	*	*	*	*	*	*	*	£14.84
FUEL SYST	heat shield, SU, HS4, carb (1 per carb)			FS 0136	*	*	*	*	*	*	*	*	£14.84
FUEL SYST	heat shield, SU, HS6, carb (1 per carb)			FS 0137	*	*	*	*	*	*	*	*	£14.84
FUEL SYST	hose, breather	SB, L shape, emission to rockerbox		FS 0037	*	*	*	*	*	*	*	*	£12.15
FUEL SYST	hose, breather	SB, S shape manifold-emiss	REINFORCED	FS 0036	*	*	*	*	*	*	*	*	£9.06
FUEL SYST	hose, breather	SU, front carb to T piece		FS 0040	*	*	*	*	*	*	*	*	£13.73
FUEL SYST	hose, breather	SU, rear carb to T piece		FS 0039	*	*	*	*	*	*	*	*	£13.73
FUEL SYST	hose, breather	SU, T piece (short hose)		FS 0041	*	*	*	*	*	*	*	*	£6.38
FUEL SYST	hose, fuel from SU carb	fork to main fuel pipe		FS 0043	*	*	*	*	*	*	*	*	£1.82
FUEL SYST	hose, fuel hose, Tri	MK1 & 2 fr carb or re carb	S/B	FS 0254	*	*	*	*	*	*	*	*	£4.80
FUEL SYST	hose, fuel hose, Tri	MK1 & 2 fuel pipe to carb	S/B	FS 0253	*	*	*	*	*	*	*	*	£4.16
FUEL SYST	hose, fuel pipe to carb	SU		FS 0042	*	*	*	*	*	*	*	*	£4.80
FUEL SYST	hose, fuel pipe to fuel tank			FS 0044	*	*	*	*	*	*	*	*	£4.80
FUEL SYST	jet conversion kit, R/H	HS6 waxstat to non waxstat	jet	FS 0175	*	*	*	*	*	*	*	*	£18.89
FUEL SYST	jet conversion kit, R/L	HS6 waxstat to non waxstat	jet	FS 0176	*	*	*	*	*	*	*	*	£18.89
FUEL SYST	jet, HS4, front, SU carb	No AUD 604F/AUD 678F & 607R		FS 0013	*	*	*	*	*	*	*	*	£28.77
FUEL SYST	jet, HS4, rear, SU carb	No AUD 604R/AUD 678R & 607R		FS 0012	*	*	*	*	*	*	*	*	£28.77
FUEL SYST	jet, HS6, front, SU carb	No AUD 676F/AUD 678F		FS 0021	*	*	*	*	*	*	*	*	£28.77
FUEL SYST	jet, HS6, front, SU carb	No AUD 1264F/FZX 1263F		FS 0028	*	*	*	*	*	*	*	*	POA
FUEL SYST	jet, HS6, rear, SU carb	No AUD 676R/AUD 678R		FS 0022	*	*	*	*	*	*	*	*	£18.56
FUEL SYST	jet, HS6, rear, SU carb	No AUD 1264R/FZX 1263R		FS 0029	*	*	*	*	*	*	*	*	POA
FUEL SYST	link, throttle link, HS6	carbs Tri 2000TC/2500TC		FS 0235	*	*	*	*	*	*	*	*	£31.91
FUEL SYST	needle & seat, SU carb	HS4 & HS6		FS 0014	*	*	*	*	*	*	*	*	£23.38
FUEL SYST	needle, HS4, AB/L, SU carb	No AUD 604F/R 2000 1974-5		FS 0018	*	*	*	*	*	*	*	*	£19.40
FUEL SYST	needle, HS4, AB/U, SU carb	No AUD 678 & 607F/R 2.5 74-5		FS 0011	*	*	*	*	*	*	*	*	£18.02
FUEL SYST	needle, HS6, B/C/Y, SU carb	No AUD 676 & 1264 2000		FS 0003	*	*	*	*	*	*	*	*	£19.40
FUEL SYST	needle, HS6, B/D/S, SU carb	No AUD 678 & FZX1263 2.5		FS 0001	*	*	*	*	*	*	*	*	£19.40
FUEL SYST	needle, SB, all, Tri	MK1, carb No C1854, needle No 7A (1964-65)		FS 0228	*	*	*	*	*	*	*	*	£16.33
FUEL SYST	needle, SB, all, Tri	MK1, carb No 3116, needle No 6J (1966-69)		FS 0	*	*	*	*	*	*	*	*	£16.33
FUEL SYST	needle, valve, SB, all, Tri	MK1 & 2		FS 0227	*	*	*	*	*	*	*	*	£16.97
FUEL SYST	nut & olive, for fuel pump or fuel tank	Tri	MK1&2	FS 0225	*	*	*	*	*	*	*	*	£5.81
FUEL SYST	orifice, (jet) S/B carb	MK1&2		FS 0256	*	*	*	*	*	*	*	*	£13.53
FUEL SYST	panel, support flexible air filter hoses			FS 0064	*	*	*	*	*	*	*	*	£4.16
FUEL SYST	pedal, rubber accelerator			FS 0035	*	*	*	*	*	*	*	*	£8.92
FUEL SYST	pipe, petrol pipe tank to petrol pump	Tri	MK1	FS 0252	*	*	*	*	*	*	*	*	£27.65
FUEL SYST	pump, fuel (AC) Tri	MK 1, recon, exchange		FS 0047	*	*	*	*	*	*	*	*	£138.81
FUEL SYST	pump, fuel (AC) Tri	MK 2, recon, exchange		FS 0045	*	*	*	*	*	*	*	*	£138.81
FUEL SYST	pump, fuel, AC, surcharge			FS 0046	*	*	*	*	*	*	*	*	£81.16
FUEL SYST	rebuild kit, SU, HS4 for 2 carbs	2000/2500, AUD 604/607		FS 0311	*	*	*	*	*	*	*	*	£136.72
FUEL SYST	rebuild kit, SU, HS6 for 2 carbs	2000, FZX 1264		FS 0314	*	*	*	*	*	*	*	*	£142.60
FUEL SYST	rebuild kit, SU, HS6 for 2 carbs	2000/2500, AUD 676/678		FS 0312	*	*	*	*	*	*	*	*	£148.97
FUEL SYST	rebuild kit, SU, HS6 for 2 carbs	2500TC, FZX1263		FS 0313	*	*	*	*	*	*	*	*	£161.48
FUEL SYST	rebuild kit, S/B	2000 MK1, 1966-69, carb No C1854, 3116 (for 2 carbs, no needs in kit)		FS 0054	*	*	*	*	*	*	*	*	£100.58
FUEL SYST	repair kit, pump fuel	AC type		FS 0048	*	*	*	*	*	*	*	*	£27.65
FUEL SYST	seal & ring kit, for sender, petrol tank			FS 0382	*	*	*	*	*	*	*	*	£12.72
FUEL SYST	seal, petrol cap housing to body, estate car only			FS 0315	*	*	*	*	*	*	*	*	£16.97
FUEL SYST	seal, petrol cap, estate car only			FS 0316	*	*	*	*	*	*	*	*	£6.30
FUEL SYST	sender, petrol tank	MK 1 & 2 saloon, exch		FS 0024	*	*	*	*	*	*	*	*	£30.98
FUEL SYST	sender, petrol tank	MK1 & 2 estate, exch		FS 0025	*	*	*	*	*	*	*	*	£36.38
FUEL SYST	spacer tube, to suit J type	OD gearbox, stainless		FS 0317	*	*	*	*	*	*	*	*	£6.94



GEARBOX/AUT	switch, inhibitor & reverse BW 35	AT 0015	*	*	*	*	*	*	*	*	*	£46.60
GEARBOX/AUT	switch, inhibitor & reverse BW 65	AT 0022	*	*	*	*	*	*	*	*	*	£86.13
<b>Gearbox overdrive</b>												
GEARBOX/O/DR	bearing, thrust	GOD 001	*	*	*	*	*	*	*	*	*	£51.86
GEARBOX/O/DR	bracket, s/drive to gearbox	GOD 007	*	*	*	*	*	*	*	*	*	£21.23
GEARBOX/O/DR	gear, speedo pinion (non s/drive) 24 teeth	GOD 009	*	*	*	*	*	*	*	*	*	£14.84
GEARBOX/O/DR	gear, speedo pinion A type 2.5Pi MK1 & 2500 MK 2	GOD 011	*	*	*	*	*	*	*	*	*	£21.23
GEARBOX/O/DR	gear, speedo pinion A type 2000 MK1 & 2	GOD 010	*	*	*	*	*	*	*	*	*	£21.23
GEARBOX/O/DR	gear, speedo pinion J type (blue/green 18 teeth)	GOD 012	*	*	*	*	*	*	*	*	*	£14.84
GEARBOX/O/DR	gear, speedo pinion J type s/hand 2000 (red 18 teeth)	GOD 002	*	*	*	*	*	*	*	*	*	£18.11
GEARBOX/O/DR	gear, speedo pinion J type s/hand 2500 (nylon 17 teeth)	GOD 003	*	*	*	*	*	*	*	*	*	£31.91
GEARBOX/O/DR	selenoid A type	GOD 004	*	*	*	*	*	*	*	*	*	£77.42
GEARBOX/O/DR	selenoid, J type	GOD 013	*	*	*	*	*	*	*	*	*	£165.81
<b>Ignition</b>												
IGNITION	barrel & key (ignition switch) 11/13MK1/2, A40, A55 etc	IG 0047	*	*	*	*	*	*	*	*	*	£15.80
IGNITION	cap, distributor 1963-66 (screw terminal type)	IG 0028	*	*	*	*	*	*	*	*	*	£28.99
IGNITION	cap, distributor 25D 63-73 (push in type)	IG 0029	*	*	*	*	*	*	*	*	*	£16.91
IGNITION	cap, distributor 45D 74-77 (push in type)	IG 0030	*	*	*	*	*	*	*	*	*	£17.84
IGNITION	coil, MK 1 1963-69	IG 0031	*	*	*	*	*	*	*	*	*	£32.28
IGNITION	coil, MK 2 1969-77	IG 0032	*	*	*	*	*	*	*	*	*	£33.60
IGNITION	condenser, 25D distributor 1963-73	IG 0024	*	*	*	*	*	*	*	*	*	£6.36
IGNITION	condenser, 45D distributor 1974-77	IG 0025	*	*	*	*	*	*	*	*	*	£8.41
IGNITION	contact set, 25D distributor (points) 1963-73	IG 0022	*	*	*	*	*	*	*	*	*	£6.92
IGNITION	contact set, 45D distributor (points) 1974-77	IG 0023	*	*	*	*	*	*	*	*	*	£7.89
IGNITION	distrib, Tri 2.5Pi MK2 45D, 125 BHP (non-vacumm)	IG 0081	*	*	*	*	*	*	*	*	*	£103.59
IGNITION	H.T lead set silicone MK1 & 2 2000/2.5	IG 0035	*	*	*	*	*	*	*	*	*	£25.11
IGNITION	H.T lead set silicone MK2, 2.5Pi (from MG 8320)	IG 0085	*	*	*	*	*	*	*	*	*	£49.77
IGNITION	H.T lead set silicone MK2, 2.5Pi (to MG 8320)	IG 0084	*	*	*	*	*	*	*	*	*	£25.11
IGNITION	lead, low tension connector for 25D distributor	IG 0036	*	*	*	*	*	*	*	*	*	£10.57
IGNITION	resistor, ballast resistor	IG 0063	*	*	*	*	*	*	*	*	*	£25.50
IGNITION	rotor arm, 25D distributor 1963-73	IG 0026	*	*	*	*	*	*	*	*	*	£6.30
IGNITION	rotor arm, 45D distributor 1974-77	IG 0027	*	*	*	*	*	*	*	*	*	£6.94
IGNITION	spark plug, NGK, Tri 2000, carb 03/63 to 12/74	IG 0073	*	*	*	*	*	*	*	*	*	£6.31
IGNITION	spark plug, NGK, Tri 2500 Pi, injection	IG 0069	*	*	*	*	*	*	*	*	*	£6.31
IGNITION	spark plug, NGK, Tri 2500, carb 05/74 to 5/77	IG 0074	*	*	*	*	*	*	*	*	*	£6.31
IGNITION	switch, ignition switch s/hand Tri MK 2 early	IG 0064	*	*	*	*	*	*	*	*	*	£23.49
IGNITION	switch, ignition switch s/hand Tri MK 2 late	IG 0065	*	*	*	*	*	*	*	*	*	£23.49
IGNITION	switch, ignition, Tri MK 1	IG 0072	*	*	*	*	*	*	*	*	*	£38.78
<b>Internal Trim</b>												
INT TRIM	carpet set, boot, black, estate	IT 0010	*	*	*	*	*	*	*	*	*	£188.44
INT TRIM	carpet set, boot, chestnut brown, estate	IT 0011	*	*	*	*	*	*	*	*	*	£188.44
INT TRIM	carpet set, boot, grey, estate	IT 0013	*	*	*	*	*	*	*	*	*	£188.44
INT TRIM	carpet set, boot, red, estate	IT 0014	*	*	*	*	*	*	*	*	*	£188.44
INT TRIM	carpet set, boot, wedgewood blue, estate	IT 0012	*	*	*	*	*	*	*	*	*	£188.44
INT TRIM	carpet set, car, black	IT 0004	*	*	*	*	*	*	*	*	*	£199.61
INT TRIM	carpet set, car, chestnut brown	IT 0005	*	*	*	*	*	*	*	*	*	£199.61
INT TRIM	carpet set, car, grey	IT 0007	*	*	*	*	*	*	*	*	*	£199.61
INT TRIM	carpet set, car, red	IT 0008	*	*	*	*	*	*	*	*	*	£199.61
INT TRIM	carpet set, car, wedgewood blue	IT 0006	*	*	*	*	*	*	*	*	*	£199.61
INT TRIM	carpet, boot, black, sal MK2 Pi, bound, ORIGINAL	IT 0070	*	*	*	*	*	*	*	*	*	£46.84
INT TRIM	carpet, boot, black, sal MK2, net bound, ORIGINAL	IT 0069	*	*	*	*	*	*	*	*	*	£34.78
INT TRIM	carpet, boot, black, saloon MK 2	IT 0009	*	*	*	*	*	*	*	*	*	£82.85
INT TRIM	carpet, footwell L-H front black	IT 0028	*	*	*	*	*	*	*	*	*	£45.52
INT TRIM	carpet, footwell R-H front black	IT 0029	*	*	*	*	*	*	*	*	*	£45.52
INT TRIM	clip, interior door panel, (fr door 17 re door 12)	IT 0052	*	*	*	*	*	*	*	*	*	£6.74
INT TRIM	console, centre console, MK1 & 2, s/hand	IT 0154	*	*	*	*	*	*	*	*	*	£66.00
INT TRIM	edge trim, black push on fr/re door aperture	IT 0015	*	*	*	*	*	*	*	*	*	£39.31
INT TRIM	edge trim, grey blue push on fr/re door aperture	IT 0017	*	*	*	*	*	*	*	*	*	£39.31
INT TRIM	edge trim, red push on fr/re door aperture	IT 0018	*	*	*	*	*	*	*	*	*	£39.31
INT TRIM	edge trim, tan (brown) push fr/re door aperture	IT 0016	*	*	*	*	*	*	*	*	*	£39.31
INT TRIM	fastener, carpet, clip, stud, fastener & pop rivet	IT 0030	*	*	*	*	*	*	*	*	*	£2.54
INT TRIM	felt, soundproofing felt kit for under carpet	IT 0037	*	*	*	*	*	*	*	*	*	£82.85
INT TRIM	gear stick, black vinyl cover cone manual	IT 0003	*	*	*	*	*	*	*	*	*	£34.04
INT TRIM	grille, for surround inner tailgate trim panel est	IT 0026	*	*	*	*	*	*	*	*	*	£3.09
INT TRIM	handle, roof grab handle L-H rear	IT 0024	*	*	*	*	*	*	*	*	*	£12.70
INT TRIM	handle, roof grab R-H re (use L-H and convert)	IT 0025	*	*	*	*	*	*	*	*	*	£12.69
INT TRIM	handle, roof grab handle 3 of L-H rear convert 1 two R-H	IT 0024	*	*	*	*	*	*	*	*	*	£28.74
INT TRIM	headlining, estate	IT 0002	*	*	*	*	*	*	*	*	*	£237.70
INT TRIM	headlining, saloon	IT 0001	*	*	*	*	*	*	*	*	*	£186.66
INT TRIM	parcel shelf, Tri MK2, L-H	IT 0143	*	*	*	*	*	*	*	*	*	£62.11
INT TRIM	parcel shelf, Tri MK2, R-H	IT 0142	*	*	*	*	*	*	*	*	*	£41.37
INT TRIM	surround, inner tailgate trim panel est	IT 0027	*	*	*	*	*	*	*	*	*	£10.57
<b>Lamps</b>												
LAMPS	adjuster screw kit, headlamp QTY REQ 4 per car	LP 0030	*	*	*	*	*	*	*	*	*	£41.46
LAMPS	bulb, flasher front & rear / reverse lamps	LP 0070	*	*	*	*	*	*	*	*	*	£1.60
LAMPS	bulb, headlamp, dip, halogen bulb	LP 0226	*	*	*	*	*	*	*	*	*	£7.72
LAMPS	bulb, headlamp, main, halogen bulb	LP 0227	*	*	*	*	*	*	*	*	*	£8.52
LAMPS	bulb, interior lamp front & rear (estate & saloon)	LP 0067	*	*	*	*	*	*	*	*	*	£9.96
LAMPS	bulb, No plate lamp single	LP 0076	*	*	*	*	*	*	*	*	*	£1.18
LAMPS	bulb, No plate lamp twin	LP 0074	*	*	*	*	*	*	*	*	*	£8.96
LAMPS	bulb, repeater B post & twin No plate lamps	LP 0069	*	*	*	*	*	*	*	*	*	£6.96
LAMPS	bulb, side lamp front	LP 0068	*	*	*	*	*	*	*	*	*	£1.60
LAMPS	bulb, stop & tail lamp	LP 0071	*	*	*	*	*	*	*	*	*	£1.60
LAMPS	gasket, fr, flasher/side lamp MK 1 lens to lamp	LP 0063	*	*	*	*	*	*	*	*	*	£6.94
LAMPS	gasket, re, flasher/tail lamp lens to lamp MK1 all ESTATE	LP 0154	*	*	*	*	*	*	*	*	*	£6.94
LAMPS	gasket, twin No plate, lamp MK2	LP 0380	*	*	*	*	*	*	*	*	*	£17.06
LAMPS	lamp assy, fr, flasher & side lamp MK 1 L-H	LP 0060	*	*	*	*	*	*	*	*	*	£66.88
LAMPS	lamp assy, fr, flasher & side lamp MK 1 R-H	LP 0059	*	*	*	*	*	*	*	*	*	£82.85
LAMPS	lamp assy, fr, flasher & side lamp MK 2 L-H	LP 0032	*	*	*	*	*	*	*	*	*	£82.85
LAMPS	lamp assy, fr, flasher & side lamp MK 2 R-H	LP 0031	*	*	*	*	*	*	*	*	*	£82.85
LAMPS	lamp assy, No plate lamp boot lid, single MK 1 & 2	LP 0058	*	*	*	*	*	*	*	*	*	£91.25
LAMPS	lamp assy, No plate lamp boot lid, twin MK 2 late	LP 0016	*	*	*	*	*	*	*	*	*	£16.78
LAMPS	lamp assy, re, flasher & stop/tail MK 1 sal, all est MK1 & 2	LP 0041	*	*	*	*	*	*	*	*	*	£6.16
LAMPS	lamp assy, re, flasher & stop/tail MK 2 saloon L-H	LP 0050	*	*	*	*	*	*	*	*	*	£63.94
LAMPS	lamp assy, re, flasher & stop/tail MK 2 saloon R-H	LP 0049	*	*	*	*	*	*	*	*	*	£36.89
LAMPS	lamp assy, side, flasher repeater L-H (door pillar)	LP 0043	*	*	*	*	*	*	*	*	*	£21.28
LAMPS	lamp assy, side, flasher repeater R-H (door pillar)	LP 0042	*	*	*	*	*	*	*	*	*	£53.64



LAMPS	lens, fr, flasher & side lamp MK 2 L-H	LP 0034		*	*	*	*	*	*	*	£31.91
LAMPS	lens, fr, flasher & side lamp MK 2 R-H	LP 0033		*	*	*	*	*	*	*	£31.91
LAMPS	lens, fr, flasher & side lamp s/hand MK 2 L-H	LP 0035		*	*	*	*	*	*	*	£21.23
LAMPS	lens, fr, flasher & side lamp s/hand MK 2 R-H	LP 0036		*	*	*	*	*	*	*	£21.23
LAMPS	lens, fr, flasher lamp MK 1 L-H	LP 0038		*	*	*	*	*	*	*	£21.23
LAMPS	lens, fr, flasher lamp MK 1 R-H	LP 0037		*	*	*	*	*	*	*	£21.23
LAMPS	lens, fr, side lamp MK 1 L-H	LP 0040		*	*	*	*	*	*	*	£21.23
LAMPS	lens, fr, side lamp MK 1 R-H	LP 0039		*	*	*	*	*	*	*	£21.23
LAMPS	lens, re, flasher lamp MK 1 saloon & all est	LP 0046	*	*	*	*	*	*	*	*	£16.97
LAMPS	lens, re, flasher lamp MK 2 saloon L-H	LP 0052		*	*	*	*	*	*	*	£16.97
LAMPS	lens, re, flasher lamp MK 2 saloon R-H	LP 0051		*	*	*	*	*	*	*	£16.97
LAMPS	lens, re, interior roof lamp est	LP 0057	*	*	*	*	*	*	*	*	£25.55
LAMPS	lens, re, reverse lamp MK 1 saloon all estates	LP 0048	*	*	*	*	*	*	*	*	£16.57
LAMPS	lens, re, reverse lamp MK 2 saloon L-H	LP 0056		*	*	*	*	*	*	*	£8.32
LAMPS	lens, re, reverse lamp MK 2 saloon R-H	LP 0055		*	*	*	*	*	*	*	£8.32
LAMPS	lens, re, stop/tail lamp MK 2 saloon L-H	LP 0054		*	*	*	*	*	*	*	£8.32
LAMPS	lens, re, stop/tail lamp MK 2 saloon R-H	LP 0053		*	*	*	*	*	*	*	£8.32
LAMPS	lens, re, stop/tail lamp MK1 saloon all estates	LP 0047	*	*	*	*	*	*	*	*	£12.70
LAMPS	lens, repeater flasher lamp (side) L-H (door pillar)	LP 0045	*	*	*	*	*	*	*	*	£14.84
LAMPS	lens, repeater flasher lamp (side) R-H (door pillar)	LP 0044	*	*	*	*	*	*	*	*	£14.84
LAMPS	light unit, dip conversion to bulb type halogen	LP 0228	*	*	*	*	*	*	*	*	£41.37
LAMPS	light unit, main conversion to bulb type halogen	LP 0229	*	*	*	*	*	*	*	*	£41.37
LAMPS	light unit, seal beam type, dip outer QTY REQ 2 (use conversion)	LP 0066	*	*	*	*	*	*	*	*	POA
LAMPS	light unit, seal beam type, main inner QTY REQ 2	LP 0065	*	*	*	*	*	*	*	*	£23.38
LAMPS	screw, fixing flasher side lamp fr MK1 use with BP0323	LP 0062	*	*	*	*	*	*	*	*	£0.62
<b>Nuts &amp; Bolts</b>											
NUTS & BOLTS	nut, nylon lock nut steel zinc/hex 1/4" UNF	NB 0020	*	*	*	*	*	*	*	*	£1.02
NUTS & BOLTS	nut, nylon lock nut steel zinc/hex 3/8" UNF	NB 0025	*	*	*	*	*	*	*	*	£1.47
NUTS & BOLTS	nut, nylon lock nut steel zinc/hex 5/16" UNF	NB 0024	*	*	*	*	*	*	*	*	£1.20
NUTS & BOLTS	nut, nylon lock nut steel zinc/hex 7/16" UNF	NB 0026	*	*	*	*	*	*	*	*	£1.67
NUTS & BOLTS	nut, plain steel zinc/hex 1/4" UNF	NB 0017	*	*	*	*	*	*	*	*	£0.11
NUTS & BOLTS	nut, plain steel zinc/hex 3/8" UNF	NB 0002	*	*	*	*	*	*	*	*	£0.16
NUTS & BOLTS	nut, plain steel zinc/hex 5/16" UNF	NB 0008	*	*	*	*	*	*	*	*	£0.13
NUTS & BOLTS	nut, plain steel zinc/hex 7/16" UNF	NB 0003	*	*	*	*	*	*	*	*	£0.20
NUTS & BOLTS	set screw, H/tensile steel zinc/hex 1/4" UNF x 1"	NB 0018	*	*	*	*	*	*	*	*	£0.25
NUTS & BOLTS	set screw, H/tensile steel zinc/hex 1/4" UNF x 1/2"	NB 0015	*	*	*	*	*	*	*	*	£0.22
NUTS & BOLTS	set screw, H/tensile steel zinc/hex 1/4" UNF x 3/4"	NB 0023	*	*	*	*	*	*	*	*	£0.24
NUTS & BOLTS	set screw, H/tensile steel zinc/hex 3/8" UNF x 1"	NB 0021	*	*	*	*	*	*	*	*	£0.45
NUTS & BOLTS	set screw, H/tensile steel zinc/hex 3/8" UNF x 1/2"	NB 0022	*	*	*	*	*	*	*	*	£0.53
NUTS & BOLTS	set screw, H/tensile steel zinc/hex 5/16" UNF x 1"	NB 0020	*	*	*	*	*	*	*	*	£0.33
NUTS & BOLTS	set screw, H/tensile steel zinc/hex 5/16" UNF x 3/4"	NB 0019	*	*	*	*	*	*	*	*	£0.29
NUTS & BOLTS	washer, flat steel zinc ID 1/4"	NB 0012	*	*	*	*	*	*	*	*	£0.04
NUTS & BOLTS	washer, flat steel zinc ID 3/8"	NB 0001	*	*	*	*	*	*	*	*	£0.07
NUTS & BOLTS	washer, flat steel zinc ID 5/16"	NB 0013	*	*	*	*	*	*	*	*	£0.04
NUTS & BOLTS	washer, spring H/D steel zinc ID 1/4"	NB 0006	*	*	*	*	*	*	*	*	£0.07
NUTS & BOLTS	washer, spring H/D steel zinc ID 3/16"	NB 0005	*	*	*	*	*	*	*	*	£0.04
NUTS & BOLTS	washer, spring H/D steel zinc ID 3/8"	NB 0014	*	*	*	*	*	*	*	*	£0.09
NUTS & BOLTS	washer, spring H/D steel zinc ID 5/16"	NB 0007	*	*	*	*	*	*	*	*	£0.07
NUTS & BOLTS	washer, spring H/D steel zinc ID 7/16"	NB 0009	*	*	*	*	*	*	*	*	£0.13
<b>Propshaft</b>											
PROPSHAFT	bolt & locking nut, propshaft	PS 0003	*	*	*	*	*	*	*	*	£2.34
PROPSHAFT	nut, locking for propshaft bolt	PS 0011	*	*	*	*	*	*	*	*	£2.34
PROPSHAFT	propshaft, good s/hand TRI	PS 0009	*	*	*	*	*	*	*	*	£62.22
PROPSHAFT	propshaft, recondition auto BW 35 TRI MK 1 & 2	PS 0005	*	*	*	*	*	*	*	*	£116.03
PROPSHAFT	propshaft, recondition auto BW 65 TRI MK 2	PS 0006	*	*	*	*	*	*	*	*	£116.03
PROPSHAFT	propshaft, recondition manual Q/Drive TRI	PS 0008	*	*	*	*	*	*	*	*	£116.03
PROPSHAFT	propshaft, recondition manual only TRI MK 1 & 2	PS 0007	*	*	*	*	*	*	*	*	£116.03
PROPSHAFT	propshaft, surcharge	PS 0010	*	*	*	*	*	*	*	*	£62.22
PROPSHAFT	U/J joint, with grease nipple (propshaft)	PS 0002	*	*	*	*	*	*	*	*	£13.80
<b>Speedo</b>											
SPEEDO	angle drive, manual A type & auto	SP 0013	*	*	*	*	*	*	*	*	£82.85
SPEEDO	angle drive, s/hand manual A type & auto TRI	SP 0014	*	*	*	*	*	*	*	*	£60.15
SPEEDO	cable, speedo MK 1 & 2 man Q drive 2000 1963-5/65	SP 0004	*	*	*	*	*	*	*	*	£28.04
SPEEDO	cable, speedo MK 1 auto 2000/2.5 Pi	SP 0028	*	*	*	*	*	*	*	*	£28.04
SPEEDO	cable, speedo MK 1 man Q drive 2000/2.5 Pi 1965-69	SP 0006	*	*	*	*	*	*	*	*	£28.04
SPEEDO	cable, speedo MK 1 man Q/drive 2000/2.5 Pi 1965-69	SP 0005	*	*	*	*	*	*	*	*	£28.04
SPEEDO	cable, speedo MK 1 manual 2000/2.5 Pi 1963-69	SP 0002	*	*	*	*	*	*	*	*	£28.04
SPEEDO	cable, speedo MK 1 manual Q drive 2000 1963-64	SP 0003	*	*	*	*	*	*	*	*	£28.04
SPEEDO	cable, speedo MK 2 auto 2000/2.5 Pi 1970-4/70 BW35	SP 0011	*	*	*	*	*	*	*	*	£25.13
SPEEDO	cable, speedo MK 2 auto 2000/2.5 Pi 5/1970-6/76 BW35	SP 0012	*	*	*	*	*	*	*	*	£25.13
SPEEDO	cable, speedo MK 2 man Q/dr 2000/2.5 Pi 1970-4/70	SP 0008	*	*	*	*	*	*	*	*	£25.13
SPEEDO	cable, speedo MK 2 man Q/dr 2000/2.5 Pi 5/1970-73	SP 0009	*	*	*	*	*	*	*	*	£25.13
SPEEDO	cable, speedo MK 2 man Q/drive J type 1973-77	SP 0010	*	*	*	*	*	*	*	*	£25.13
SPEEDO	cable, speedo MK 2 man only 2000/2.5 Pi 1970-77	SP 0007	*	*	*	*	*	*	*	*	£25.13
SPEEDO	cable, speedo MK2 man Q/drive J type 73-77 L-H drive	SP 0049	*	*	*	*	*	*	*	*	£42.37
<b>Steering</b>											
STEERING	arm, steering L-H s/hand manual steering TRI MK1 & 2	ST 0047	*	*	*	*	*	*	*	*	£21.23
STEERING	arm, steering R-H s/hand manual steering TRI MK1 & 2	ST 0045	*	*	*	*	*	*	*	*	£21.23
STEERING	bearing, Trn MK1, upper & lower	ST 0118	*	*	*	*	*	*	*	*	£62.11
STEERING	bearing, Trn MK2, lower steering column	ST 0017	*	*	*	*	*	*	*	*	£62.11
STEERING	bearing, TRI MK2, upper steering column	ST 0016	*	*	*	*	*	*	*	*	POA
STEERING	bolt, & locking nut steering coupling U/J (manual)	ST 0074	*	*	*	*	*	*	*	*	£2.14
STEERING	bolt, lock steering	ST 0036	*	*	*	*	*	*	*	*	£4.16
STEERING	bolt, steering arm to vertical link	ST 0029	*	*	*	*	*	*	*	*	£4.80
STEERING	bush, steering column to bulkhead MK2 (polyurethane)	ST 0073	*	*	*	*	*	*	*	*	£12.70
STEERING	column, steering recon, exch, TRI MK2	ST 0033	*	*	*	*	*	*	*	*	£82.85
STEERING	column, steering, surcharge, TRI MK2	ST 00	*	*	*	*	*	*	*	*	£27.46
STEERING	coupling U/J, lower MANUAL with out shaft	ST 0023	*	*	*	*	*	*	*	*	£41.37
STEERING	coupling U/J, lower MANUAL with out shaft, surcharge	ST 0117	*	*	*	*	*	*	*	*	£21.34
STEERING	coupling U/J, upper MANUAL with shaft, NEW	ST 0022	*	*	*	*	*	*	*	*	£103.59
STEERING	coupling U/J, upper MANUAL with shaft, recon, exch	ST 0115	*	*	*	*	*	*	*	*	£69.28
STEERING	coupling U/J, upper MANUAL with shaft, surcharge	ST 0116	*	*	*	*	*	*	*	*	£32.02
STEERING	dust cover, for track rod end (drag link ends)	ST 0063	*	*	*	*	*	*	*	*	£2.67
STEERING	gaiter, rack MANUAL sold in pairs with 4 clips	ST 0028	*	*	*	*	*	*	*	*	£13.83
STEERING	lock & keys, steering lock, Trn MK2, R-H-D, s/hand	ST 0101	*	*	*	*	*	*	*	*	£74.56
STEERING	mounting, rubber, rack (standard)	ST 0015	*	*	*	*	*	*	*	*	£6.22
STEERING	mounting, rubber, rack (standard) SPECIAL PRICE FOR 2	ST 0015	*	*	*	*	*	*	*	*	£5.80

STEERING	rack, MANUAL R-H drive recon exch	ST 0031	*	*	*	*	*	*	*	*	£124.33
STEERING	rack, MANUAL surcharge	ST 0032	*	*	*	*	*	*	*	*	£62.22
STEERING	track rod end, manual	ST 0020	*	*	*	*	*	*	*	*	£9.35
STEERING	U bolt & locking nuts, for manual rack clamp Tri	ST 0033	*	*	*	*	*	*	*	*	£6.30
STEERING	X member, man steering recon blasted coated black	ST 0031	*	*	*	*	*	*	*	*	£51.86
<b>Steering PAS</b>											
STEERING PAS	arm, steering L-H s/hand P.A.S. TRI MK2	STP 016			*	*	*	*	*	*	£21.23
STEERING PAS	arm, steering R-H s/hand P.A.S. TRI MK2	STP 015			*	*	*	*	*	*	£21.23
STEERING PAS	belt, pump P.A.S.	STP 011			*	*	*	*	*	*	£12.70
STEERING PAS	belt, & locking nut steering coupling U/J (P.A.S.)	STP 018			*	*	*	*	*	*	£2.14
STEERING PAS	bracket, PAS pump to engine, refurbished	STP 020			*	*	*	*	*	*	£21.23
STEERING PAS	bracket, PAS pump to front plate, refurbished	STP 021			*	*	*	*	*	*	£19.11
STEERING PAS	coupling, P.A.S. U/J and shaft, recon, exch	STP 031			*	*	*	*	*	*	£69.28
STEERING PAS	coupling, P.A.S. U/J and shaft, surcharge	STP 030			*	*	*	*	*	*	£41.48
STEERING PAS	coupling, P.A.S. U/J complete exchange recon TRI MK2	STP 012			*	*	*	*	*	*	£112.47
STEERING PAS	coupling, U/J P.A.S. surcharge	STP 013			*	*	*	*	*	*	£51.86
STEERING PAS	coupling, upper rubber P.A.S.	STP 004	*	*	*	*	*	*	*	*	£34.66
STEERING PAS	dust cover, track rod end PAS steering	STP 017			*	*	*	*	*	*	£2.34
STEERING PAS	gaiter, rack P.A.S.	STP 003			*	*	*	*	*	*	£6.38
STEERING PAS	mounting bush, for P.A.S. rack cross member QTY REQ 4	STP 014			*	*	*	*	*	*	£23.38
STEERING PAS	pipe, H.P. pump to rack P.A.S.	STP 002			*	*	*	*	*	*	£53.14
STEERING PAS	pipe, L.P. pump to rack P.A.S.	STP 001			*	*	*	*	*	*	£43.18
STEERING PAS	plate, s/hand for PAS pump & engine fir mounts TRI	STP 019			*	*	*	*	*	*	£48.73
STEERING PAS	pump, P.A.S. repair kit, Tri 2000/2500	STP 032			*	*	*	*	*	*	£13.21
STEERING PAS	pump, P.A.S. steering, recon, exchange	STP 009			*	*	*	*	*	*	£171.10
STEERING PAS	pump, P.A.S. surcharge SEE INSIDE COVER	STP 010			*	*	*	*	*	*	£32.02
STEERING PAS	rack, P.A.S. repair kit, Tri 2000/2500	STP 033			*	*	*	*	*	*	£21.25
STEERING PAS	rack, P.A.S. steering, recon, exchange	STP 006			*	*	*	*	*	*	£331.72
STEERING PAS	rack, P.A.S. surcharge SEE IN SIDE COVER	STP 007			*	*	*	*	*	*	£114.07
STEERING PAS	track rod end, P.A.S.	STP 003			*	*	*	*	*	*	£12.55
STEERING PAS	x member, power steering recon blasted coated black	STP 005			*	*	*	*	*	*	£60.15
<b>Suspension Front</b>											
SUSP FR	anti roll bar, recon shot blasted black coated TRI 2	SUF 041			*	*	*	*	*	*	£38.71
SUSP FR	arm, track control recon new joint & poly bush TRI	SUF 219	*	*	*	*	*	*	*	*	£62.11
SUSP FR	arm, track control surcharge	SUF 037	*	*	*	*	*	*	*	*	£25.61
SUSP FR	ball joint, lower track control arm	SUF 038	*	*	*	*	*	*	*	*	£11.01
SUSP FR	bearing kit, front wheel	SUF 051	*	*	*	*	*	*	*	*	£27.65
SUSP FR	belt, front lower strut, Tri 2000/2500	SUF 199	*	*	*	*	*	*	*	*	£2.03
SUSP FR	belt, front suspension cross member (axle)	SUF 163	*	*	*	*	*	*	*	*	£3.41
SUSP FR	belt, tie rod (reinforced) with locking nut	SUF 090	*	*	*	*	*	*	*	*	£4.16
SUSP FR	belt, track control arm bush to cross member	SUF 085	*	*	*	*	*	*	*	*	£3.52
SUSP FR	buffer, cross member front	SUF 036	*	*	*	*	*	*	*	*	POA
SUSP FR	bush, anti roll bar clamp to chassis (rubber)	SUF 049			*	*	*	*	*	*	£4.49
SUSP FR	bush, anti roll bar link 2 per link (rubber)	SUF 050			*	*	*	*	*	*	£2.03
SUSP FR	bush, heavy duty for arm track control	SUF 040	*	*	*	*	*	*	*	*	£6.94
SUSP FR	bush, inner strut mounting top	SUF 066	*	*	*	*	*	*	*	*	£11.35
SUSP FR	bush, outer strut mounting top	SUF 067	*	*	*	*	*	*	*	*	£12.70
SUSP FR	bush, tie rod (rubber)	SUF 047	*	*	*	*	*	*	*	*	£3.77
SUSP FR	bush, tie rod (rubber) SPECIAL PRICE FOR 4	SUF 0	*	*	*	*	*	*	*	*	£7.99
SUSP FR	bush, tie rod (polyprop)	SUF 217	*	*	*	*	*	*	*	*	£8.93
SUSP FR	bush, track control arm (polyprop) easy to fit	SUF 218	*	*	*	*	*	*	*	*	£19.35
SUSP FR	circlip, lower ball joint, (track control arm) Tri	SUF 039	*	*	*	*	*	*	*	*	£2.11
SUSP FR	dustcover, ball joint lower track control arm	SUF 092	*	*	*	*	*	*	*	*	£3.52
SUSP FR	gaiter, strut	SUF 058	*	*	*	*	*	*	*	*	£11.54
SUSP FR	hub, front	SUF 082	*	*	*	*	*	*	*	*	£27.65
SUSP FR	insert, strut fir (shocker) monroe radial matic	SUF 073	*	*	*	*	*	*	*	*	£124.33
SUSP FR	insert, strut fir (shocker) Standard insert	SUF 250	*	*	*	*	*	*	*	*	£60.15
SUSP FR	insert, strut fir (shocker) Standard insert, SPECIAL PRICE FOR 2	SUF	*	*	*	*	*	*	*	*	£77.28
SUSP FR	link, anti roll bar surcharge	SUF 033			*	*	*	*	*	*	£21.34
SUSP FR	link, anti roll bar, recon, exch (4-1/2' long)	SUF 239			*	*	*	*	*	*	£25.50
SUSP FR	link, anti roll bar, recon, exch (6' long)	SUF 043			*	*	*	*	*	*	£47.60
SUSP FR	link, vertical front QTY REQ 2 per car	SUF 080	*	*	*	*	*	*	*	*	£36.18
SUSP FR	mounting, strut top	SUF 060	*	*	*	*	*	*	*	*	£124.33
SUSP FR	mounting, strut top S/HAND TRI MK 1 & 2	SUF 061	*	*	*	*	*	*	*	*	£62.11
SUSP FR	nut, locking for tie rod	SUF 044	*	*	*	*	*	*	*	*	£2.03
SUSP FR	pan, strut top mounting (cup shape)	SUF 068	*	*	*	*	*	*	*	*	£10.57
SUSP FR	rubber, seat btm of strut spring QTY REQ 1 per strut	SUF 070	*	*	*	*	*	*	*	*	£6.94
SUSP FR	rubber, seat top of strut spring QTY REQ 1 per strut	SUF 069	*	*	*	*	*	*	*	*	£4.16
SUSP FR	rubber, seat top & bottom of coil spring 2 top, 2 bottom	SUF 0	*	*	*	*	*	*	*	*	£21.07
SUSP FR	seal, oil front wheel hub	SUF 052	*	*	*	*	*	*	*	*	£8.32
SUSP FR	shaft, stub axle	SUF 075	*	*	*	*	*	*	*	*	£53.82
SUSP FR	spring, coil facelift Tri MK2 (140 lb)	SUF 077	*	*	*	*	*	*	*	*	£52.79
SUSP FR	spring, coil pre facelift Tri MK1 & 2 (140 lb)	SUF 076	*	*	*	*	*	*	*	*	£52.79
SUSP FR	strut ASSY, spr gaiter mon rad see inside cover	SUF 074	*	*	*	*	*	*	*	*	£186.55
SUSP FR	strut ASSY, surcharge	SUF 078	*	*	*	*	*	*	*	*	£51.86
SUSP FR	strut, recon exch fir strut (shocker) Monroe insert	SUF 249	*	*	*	*	*	*	*	*	£139.47
SUSP FR	strut, recon exch fir strut (shocker) STD insert	SUF 071	*	*	*	*	*	*	*	*	£89.26
SUSP FR	strut, surcharge (shock absorber)	SUF 072	*	*	*	*	*	*	*	*	£51.86
SUSP FR	stud, for wheel nut hub front	SUF 081	*	*	*	*	*	*	*	*	£6.30
SUSP FR	tie rod, L-H reinforced exch anti roll type S TRI	SUF 054	*	*	*	*	*	*	*	*	£45.67
SUSP FR	tie rod, reinforced exch non anti roll bar type TRI	SUF 055	*	*	*	*	*	*	*	*	£36.18
SUSP FR	tie rod, R-H reinforced exch anti roll type S TRI	SUF 053			*	*	*	*	*	*	£45.67
SUSP FR	tie rod, surcharge anti roll bar type S	SUF 057			*	*	*	*	*	*	£32.02
SUSP FR	tie rod, surcharge non anti roll bar type	SUF 056	*	*	*	*	*	*	*	*	£28.46
SUSP FR	washer cap, for top of strut gaiter s/hand	SUF 063	*	*	*	*	*	*	*	*	£3.20
SUSP FR	washer cup, tie rod for repairing chassis	SUF 048	*	*	*	*	*	*	*	*	£9.35
SUSP FR	washer inner, tie rod, use with tie rod bush	SUF 045	*	*	*	*	*	*	*	*	£6.30
SUSP FR	washer outer, tie rod use with tie rod bush	SUF 046	*	*	*	*	*	*	*	*	£6.30
SUSP FR	washer thrust, strut mounting 2 per strut	SUF 065	*	*	*	*	*	*	*	*	£5.29
SUSP FR	washer, strut top	SUF 064	*	*	*	*	*	*	*	*	£1.38
SUSP FR	washer, top of strut gaiter s/hand	SUF 198	*	*	*	*	*	*	*	*	£3.20
SUSP FR	X member, man steering recon blasted coated black TRI	SUF 083			*	*	*	*	*	*	£51.86
<b>Suspension Rear</b>											
SUSP RE	X member, power steering recon blasted coated black	SUF 020			*	*	*	*	*	*	£60.15
SUSP RE	arm, trailing TRI MK 1 L-H s/hand	SUR 028	*	*	*	*	*	*	*	*	£58.07
SUSP RE	arm, trailing TRI MK 1 R-H s/hand	SUR 027	*	*	*	*	*	*	*	*	£58.07
SUSP RE	arm, trailing TRI MK 2 L-H s/hand	SUR 024	*	*	*	*	*	*	*	*	£58.07
SUSP RE	arm, trailing TRI MK 2 R-H s/hand	SUR 025	*	*	*	*	*	*	*	*	£58.07

