

# Turny

**Autoadapt** | Seat lift

## Turny HD | Turny Orbit

SV	4	Bruksanvisning
EN	22	User manual
DE	40	Gebrauchsanweisung
FR	58	Instructions d'utilisation
ES	76	Instrucciones de uso
IT	94	Istruzioni per l'uso



Thank you for choosing a

# Turny from Autoadapt!

Thank you for choosing us as the supplier of your car adaptation. This product is designed to make it easier for you to drive your car, and we have focused particularly on safety, quality and functionality. The following manual is an integral and important part of the product, providing you with information on how to achieve maximum performance and safe operation. Keep the manual in a safe place so that you can refer to it when necessary.

If you have any questions about your adaptation, please feel free to contact your installation engineer. If you wish to share your opinions about the product or the company with us, you can register them on [www.autoadapt.com/register](http://www.autoadapt.com/register). That way, you will be helping us to become a better supplier.

Once again, thank you for placing your confidence in our products!

Autoadapt



Safe vehicle adaptation solutions

*For your safety Autoadapt products are designed and tested according to current directives and standards.*

---

**Safety**

---

24 Safety measures

**Operation**

---

26 Hand control

28 Manoeuvring outwards and inwards

**Emergency-mode operation**

---

30 Raise Turny Orbit/HD

32 Rotate the Turny Orbit inwards

**Care instructions**

---

34

**Troubleshooting**

---

35

**Technical specification**

---

37

**Introduction for users**

---

38

Servicing information and “Declaration of conformity” at the end of the manual.

## Safety

### Safety measures



*Max user weight is 150 kg.*



*Ensure that the car is standing on a level surface and that the parking brake is set before using Turny.*



*Ensure that nothing can fasten or get caught when manoeuvring Turny. Make sure that the cable to the hand control hangs freely to avoid it becoming damaged.*



*If possible, recline the back support to minimise the risk of the user's head bumping against the door opening whilst being moved.*



*Ensure the hand control's green LED light is constantly lit before setting off. This indicates the Turny is in a safe position for driving.*



*Any modifications, adjustments or repairs to a Turny may only be performed by authorised technicians.*

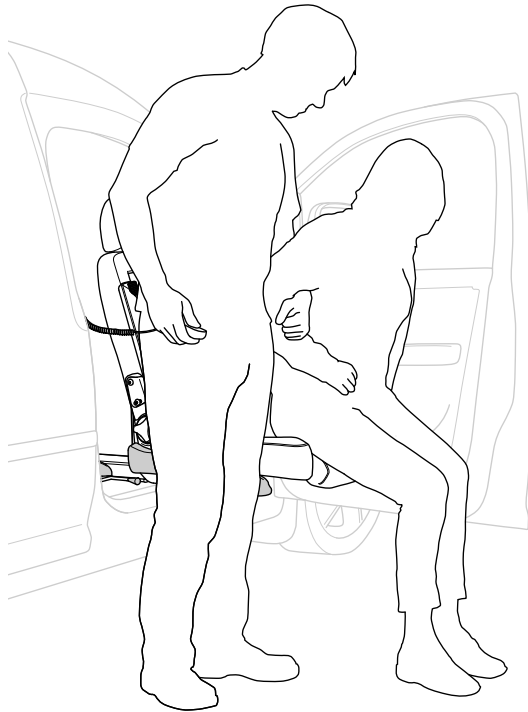

### **Getting up**

Turny can be used as a lifting aid for the user, if at the same a helper carefully moves the seat upwards, see illustration.

### **Transferring to and from wheelchair**

A transfer between car seat and wheelchair, or vice versa, becomes easier if the transfer is made from a higher to a lower position. By adjusting the Turny's height an optimal transfer position can be achieved.

## Operation

### Hand control

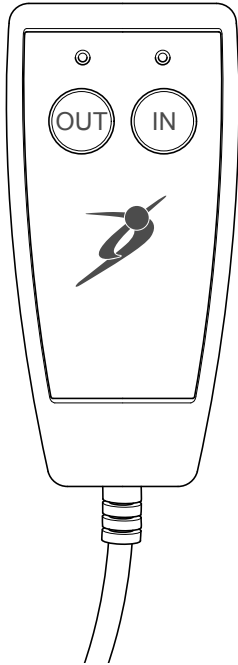

#### OUT /

In order to rotate outwards and lower Orbit, or lower HD, keep the left-hand button in. To interrupt the movement, release the button.

#### IN /

In order to raise and rotate Orbit inwards, or raise HD, keep the right-hand button in. To interrupt the movement, release the button.

When the green LED is constantly lit, Turny is in a safe position for driving.  
When the green LED is blinking, Turny is not in a safe position for driving.

- The standard model Turny is supplied with a cable connected hand control unit. Turny can be manoeuvred via a wireless hand control unit, available as an optional extra.
- For safety reasons the Turny can only be manoeuvred when the vehicle is stopped and/or the door is open.
- When not in use place the hand control in its holder.

## Hand control messages during normal operation.

Message	Cause
○ ○ No diode lit	The vehicle's engine is switched on and/or the door is closed. Turny cannot be manoeuvred.
○ -○- Green LED blinks slowly	Energy-saving mode.
○ ● Green LED lit	Rotated inwards to end position. Turny is in a safe position for driving.
○ -⊕- Green LED blinks	Not rotated inwards to end position. Turny is not in a safe position for driving.
● -⊕- Red LED lit Green LED blinks	End position reached and cannot be further lowered.
● -○- Red LED lit Green LED blinks slowly	Has reached the end position and is in energy saving mode.



*If Turny is overloaded or hits an obstacle, the hand control's red diode will blink, see chapter "Troubleshooting".*

## Manoeuvring outwards and inwards

### Rotate outwards



Grip the seat. Pull the release lever upwards and rotate the seat outwards to its locked end position.

Turny Orbit



Turny HD

### Lower

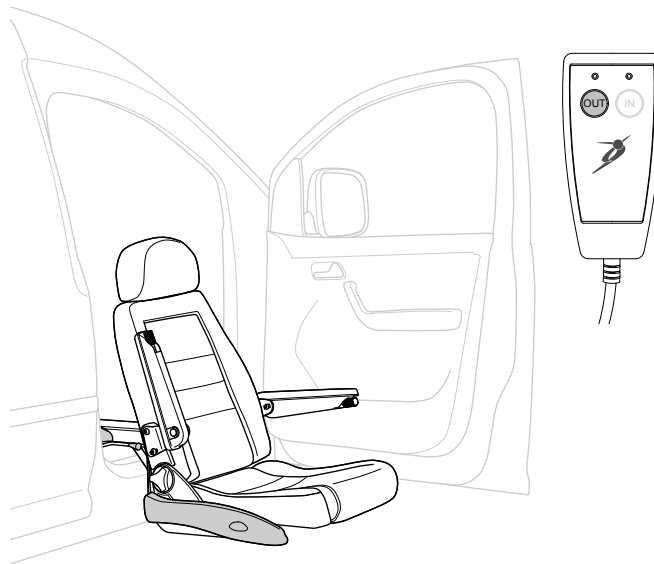

Lower the seat to the desired height.



## Raise

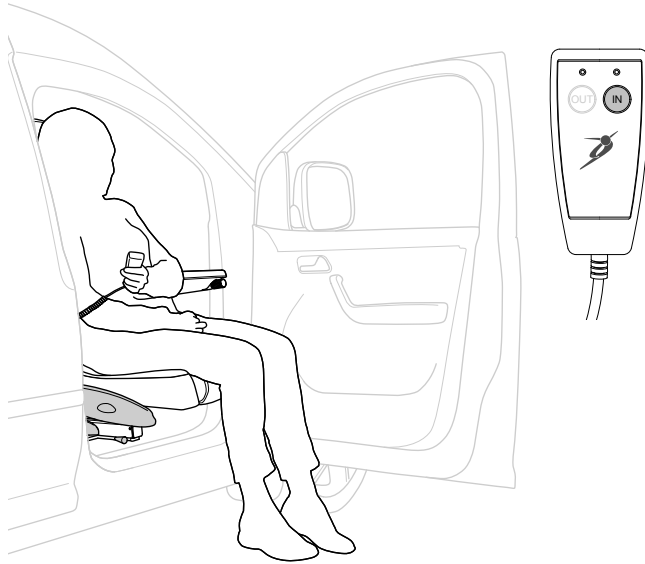

## Rotate inwards

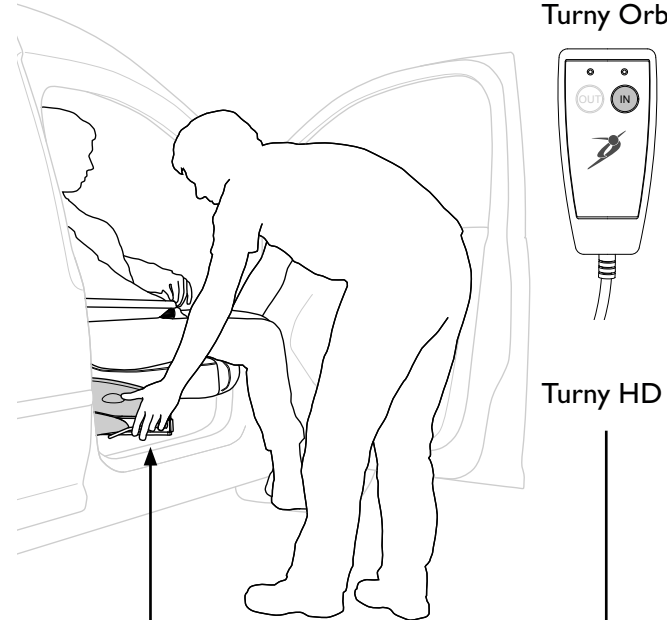

Grip the seat. Pull the release lever upwards and rotate the seat inwards to its locked end position. When the green LED is constantly lit, Turny is in a safe position for driving.



*If possible, recline the back support to minimise the risk of the user's head bumping against the door opening whilst being moved.*

## Emergency-mode operation

### Raise Turny Orbit/HD



*Remove the fuse, positioned close to the car's battery, before starting emergency-mode operation.*



*Contact your installer for overhaul. Any faults must first be rectified before reusing Turny.*



*Option A, stop at least 2 cm before the end position to prevent damage to the motor.*

### Option A - easy but slow

Take out the crank affixed to the plate behind the back support. Insert the crank behind the hexagonal keyhole at the Turny's rear section and fully crank the seat in.

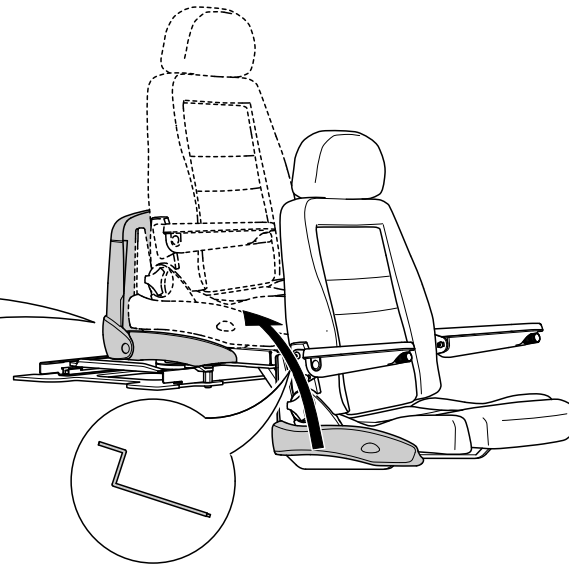
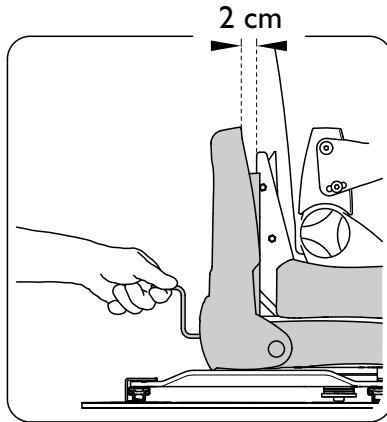

## Option B - difficult but quick

Remove the two cotter pins behind the seat. Lift and then push the chair all the way in. Be firm but careful.

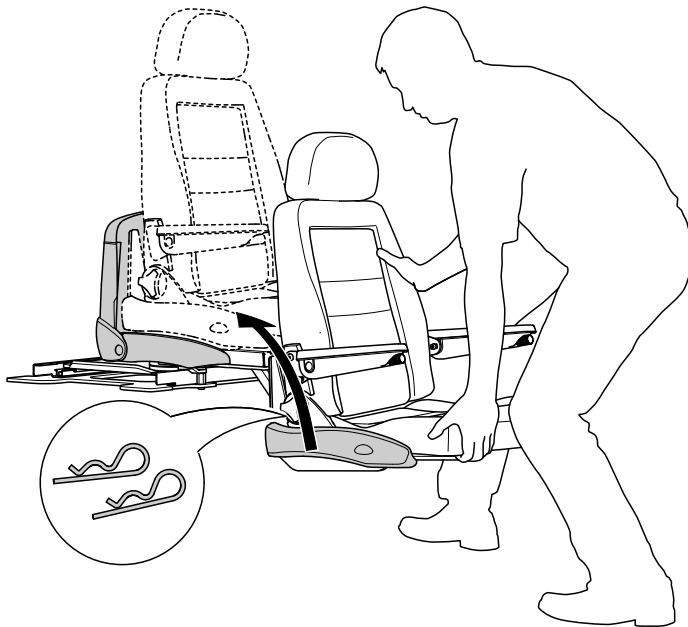

## Rotate the Turny Orbit inwards



*Remove the fuse, positioned close to the car's battery, before starting emergency-mode operation.*



*Contact your installer for overhaul. Any faults must first be rectified before reusing Turny.*

**1** Remove the locking pin to release the yellow lever at the front of Turny.

**2** Depress and push the lever to the side to release the seat. Push the lever to the right on a right model and to the left on a left model.

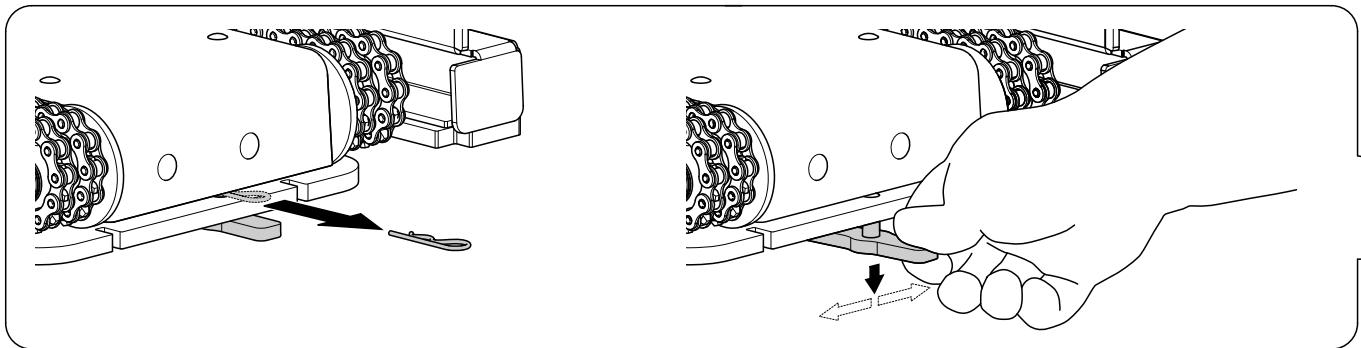

- 3** Swivel the seat all the way in. Now push the lever back to its original position and replace the locking pin.

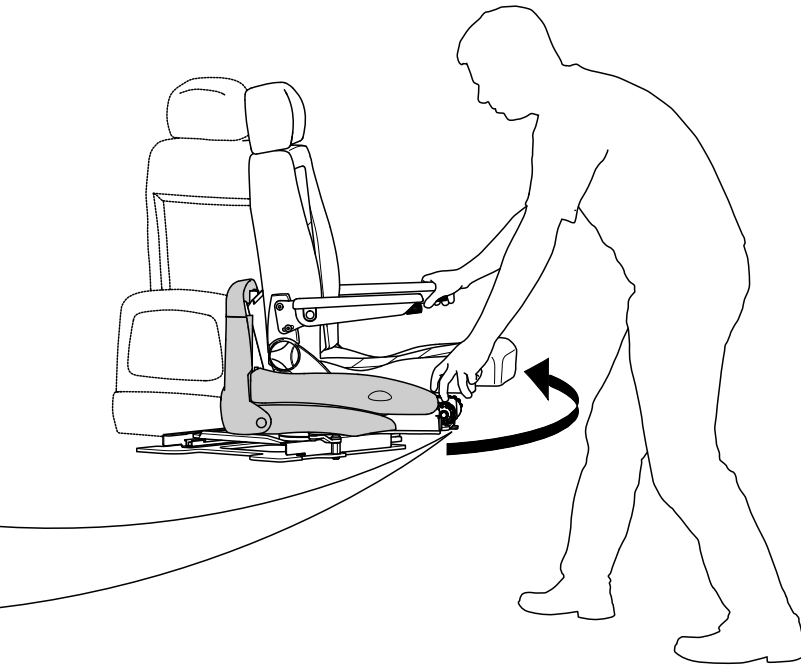

## Care instructions

If necessary.....

Carefully vacuum the Turny. Do not use any liquids.









Once a year .....

Contact your installer to book the annual service; see the end of the manual.

- The product documentation must always be available during inspection of the vehicle.
- Always contact your dealer for disassembly.

# Troubleshooting

## Hand control error messages

Message	Cause	Actions
 No diode lit	The vehicle's engine is switched on and/or the door is closed. Power supply interrupted.	Switch off ignition and check that fuse(s) and cable(s) are intact. For further help contact your installer.
 1 Red blink	Power surge or pinch protection. Turny stops with small amount of reverse movement.	Check for obstacle(s) in the way. Reactive Turny.
 2 Red blinks	Potentiometer broken or disconnected.	Contact your installation engineer.
 3 Red blinks	Potentiometer/lift motor not moving.	Contact your installation engineer.
 4 Red blinks	Faulty switch for inwards- or outwards-rotated position. Both affected simultaneously.	Contact your installation engineer.
 5 Red blinks	Upper limit position broken, constant fault.	Contact your installation engineer.
 6 Red blinks	Max limit for manoeuvring has been reached, 180 seconds.	Contact your installation engineer.
 Alternating Red and Green LEDs	Upper limit position not affected, and max outwards-rotation not affected. Turny cannot be manoeuvred.	Contact your installation engineer.

Please contact your installation engineer if you require further assistance or need to ask questions about warranty. We recommend keeping the following information to hand at all times:

Model / \_\_\_\_\_

Serial number / \_\_\_\_\_

Year of manufacture / \_\_\_\_\_

Date of purchase / \_\_\_\_\_

Contact details for the installation engineer / \_\_\_\_\_

\_\_\_\_\_

\_\_\_\_\_

\_\_\_\_\_

Notes / \_\_\_\_\_

\_\_\_\_\_

\_\_\_\_\_

\_\_\_\_\_

\_\_\_\_\_

\_\_\_\_\_

\_\_\_\_\_



# Technical specification

## Technical data

From above, rotated out towards the right.

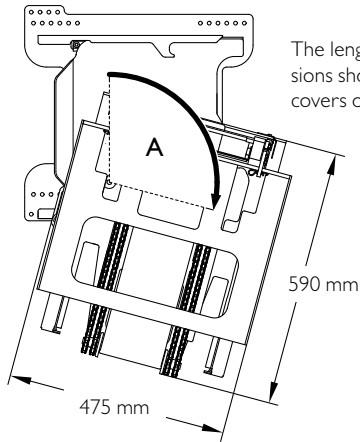

The length and width dimensions show Turny without covers or accessories.

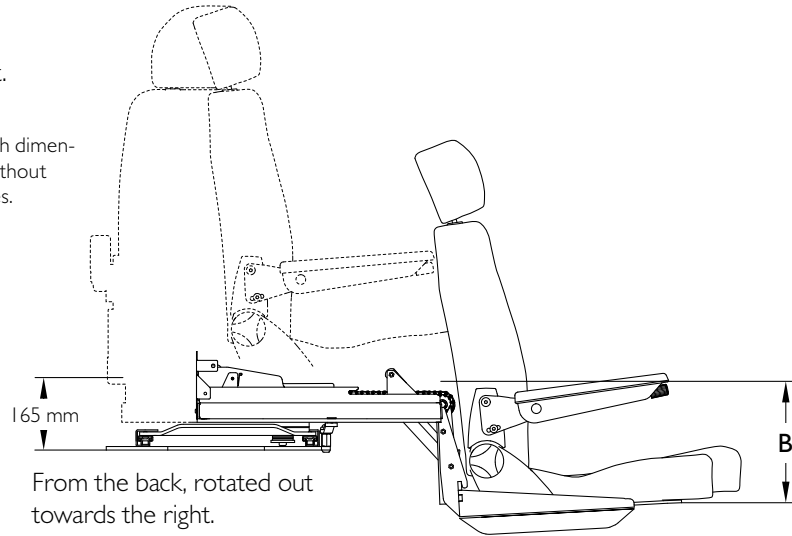

From the back, rotated out towards the right.

Length .....	590 mm
Width .....	475 mm
Installation height, up to chair attachment .....	165 mm
Maximum user weight .....	150 kg
Voltage .....	12 VDC
Fuse .....	30 A
Power consumption at maximum load .....	18 A
Power consumption in standby mode .....	approx. 15 mA

### A / Rotation angle

HD .....	78° - 105°
Orbit .....	68° - 97°

### B / Vertical movement

HD/Orbit 300 .....	300 mm
HD/Orbit 395 .....	395 mm
HD/Orbit 4801 .....	480 mm

## Introduction for users

Autoadapt would like you, as a user, to feel secure and comfortable with your new product. For that reason, it is your installer's duty to go through the following with you /

- Safety
- Operation
- Emergency-mode operation

If any questions about the product should come up later on, you are of course very welcome to contact your installation engineer again.

The above chapters have been gone through /

Date /

---

Name of dealer /

---

---

Signature, installation engineer

---

Signature, user



# Declaration of conformity

## Manufacturer /

Autoadapt AB  
Åkerivägen 7, 443 61 Stenkullen  
Sweden

Phone: +46 302 254 00  
E-mail: support@autoadapt.se  
www.autoadapt.com

## Declares that the product /

Turny HD/Orbit, model 300/395/480,  
incl mounting console made by  
Autoadapt

## Conforms to following Laws, Directives and Standards /

EN 292-2/A1  
72/245/EEC, 74/60/EEC, 77/541/EEC, ISO 7637-1, 74/408/EEC, 76/115/EEC-  
2005/41 EC, EN 12182, EN 55022, 93/42/EEC, 95/28/EC, 89/392/EEC. ECE R-10,  
ECE R-14, ECE R-17, ECE R-21, FMVSS 201, 207, 208, 209, 210, 225, 302.  
EN 60204-1, EN 61000-4-2:1995, ISO 3795, 2006/28/EC, 2006/42/EC  
2007/47/EEC, LVFS 2009:18

**We relate to comparing practical tests at Swedish National Testing and  
Research Institute with reference number 95H11227,**  
97H30472, 97H30473, 98H30540, 98H30542, 99F52587,  
P101522B, P105622, F1211612, P005826A, P203878,  
MKp P205854D, BMf P300994C, BMf P300994D, BMf P300994E, F121612.  
F903889, F916233, P806081, P901080, P603707, F609435, P906398

**The tests performed in USA are** MGA C00Q6-112.1,  
MGA C00S3-061, MGA C01S3-002.

**The original anchor points of the OEM-seat must be used.**

Autoadapt AB, Stenkullen 2013-08-01



Håkan Sandberg, CEO



Accredited by SWEDAC as testing laboratory in accordance with ISO/IEC 17025:2005  
Quality system certified in accordance with ISO 9001:2008

Illustrations, descriptions and specifications in the user manual are based on current product information.  
Autoadapt reserves the right to make alterations without previous notice.  
© 2014 Autoadapt AB





GETTING SEATED

**AT AUTOADAPT WE** help people do what so many take for granted; drive to work, pop down to the shops, drop in on friends or go on a great driving holiday. It is with great pride we design and manufacture solutions that people from all over the world put their trust in every day.

*To help you find the solution to suit your needs, simply look at the corresponding area of expertise at [autoadapt.com](http://autoadapt.com)*



WHEELCHAIR LIFTS



INDEPENDENT DRIVING



LIFTING AND STOWING



WHEELCHAIR RESTRAINTS

## AUTOADAPT AB

Åkerivägen 7  
S-443 61 Stenkullen  
Sweden  
Phone: +46 302 254 00  
E-mail: [info@autoadapt.com](mailto:info@autoadapt.com)

## AUTOADAPT UK LTD

Unit 1, Windsor Industrial Estate  
Rupert Street  
Aston, Birmingham B7 4PR, UK  
Phone: +44 121 33 35 170  
E-mail: [info@autoadapt.com](mailto:info@autoadapt.com)

 [www.autoadapt.com](http://www.autoadapt.com)

[facebook.com/autoadapt](https://facebook.com/autoadapt)  
[twitter.com/autoadapt](https://twitter.com/autoadapt)