

XTRONS

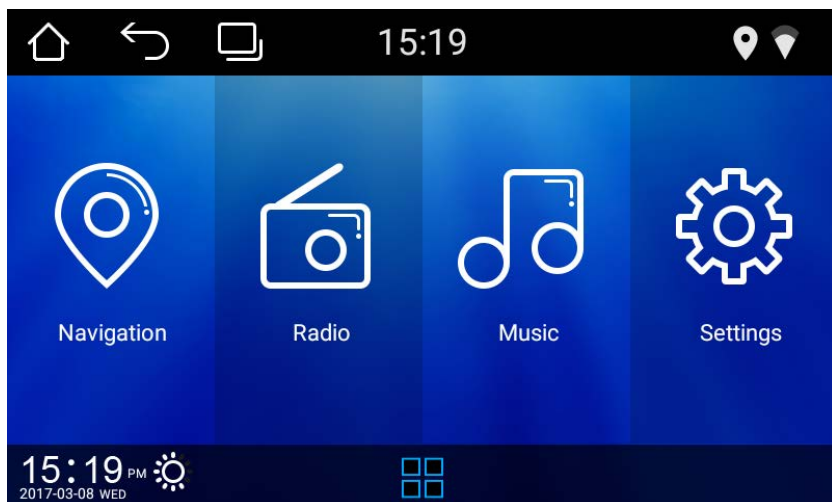

USER MANUAL

Thank you for buying this XTRONS product. Please read through these instructions so you will know how to operate this unit properly. After you have finished reading the instructions, keep this document in a safe place for future reference.

Contents

Precaution	1
Main Menu	4
Radio	6
USB/SD	7
AUX Input	7
Bluetooth	8
Bluetooth Music	11
Screen Mirroring	11
Navigation	13
Connect to the Internet	13
DVR	14
DAB+ (Optional)	14
TV (Optional)	15
Settings	15
Troubleshooting	22

Precaution

Before installing this product

- Use this unit with a 12-volt battery and negative grounding only. Failure to do so may result in a fire or malfunction.
- To avoid shorts in the electrical system, be sure to disconnect the (-) battery cable before installation.

Important safety information



WARNING

- Do not attempt to install or service this product by yourself. Installation or servicing of this product by persons without training and experience in electronic equipment and automotive accessories may be dangerous and could expose you to the risk of electric shock, injury or other hazards.
- Do not allow this product to come into contact with liquids. Electrical shock could result. Also, damage to the product, smoke and overheating could result from contact with liquids.
- If liquid or foreign matter should get inside this product, park your vehicle in a safe place, turn the ignition switch off (ACC OFF) immediately and consult your dealer. Do not use this product in this condition because doing so may result in a fire, electric shock, or other failure.
- If you notice smoke, a strange noise or odor from this product, or any other abnormal signs on the screen, turn off the power immediately and consult your dealer. Using this product in this condition may result in permanent damage to the system.

- Do not disassemble or modify this product, as there are high-voltage components inside which may cause an electric shock. Be sure to consult your dealer for internal inspection, adjustments or repairs.

Before using this product , be sure to read and fully understand the following safety information:

- Do not operate this product or any applications if doing so will divert your attention in any way from the safe operation of your vehicle. Always observe safe driving rules and follow all existing traffic regulations. If you experience difficulty in operating this product or reading the display, park your vehicle in a safe location and apply the parking brake before making the necessary adjustments.
- Never set the volume of this product so high that you cannot hear outside traffic and emergency vehicles.
- To promote safety, certain functions are disabled unless the vehicle is stopped and/or the parking brake is applied.
- Keep this manual handy as a reference for operating procedures and safety information.
- Do not install this product where it may (i) obstruct the driver's vision, (ii) impair the performance of any of the vehicle's operating systems or safety features, including air bags or hazard lamp buttons or (iii) impair the driver's ability to safely operate the vehicle.
- Please remember to fasten your seat belt at all times while operating your vehicle. If you are ever in an accident, your injuries can be considerably more severe if your seat belt is not properly buckled.
- Never use headphones while driving.

To ensure safe driving

WARNING

- **LIGHT GREEN LEAD AT POWER CONNECTOR IS DESIGNED TO DETECT PARKED STATUS AND MUST BE CONNECTED TO THE POWER SUPPLY SIDE OF THE PARKING BRAKE SWITCH. IMPROPER CONNECTION OR USE OF THIS LEAD MAY VIOLATE APPLICABLE LAW AND MAY RESULT IN SERIOUS INJURY OR DAMAGE.**
- **Do not take any steps to tamper with or disable the parking brake interlock system which is in place for your protection. Tampering with or disabling the parking brake interlock system could result in serious injury or death.**
- **To avoid the risk of damage and injury and the potential violation of applicable laws, this product is not for use with a video image that is visible to the driver.**
- In some countries the viewing of video image on a display inside a vehicle even by persons other than the driver may be illegal. Where such regulations apply, they be obeyed.
If you attempt to watch video image while driving, the warning **“Viewing of front seat video source while driving is strictly prohibited.”** will appear on the screen. To watch video image on this display, stop the vehicle in a safe place and apply the parking brake. Please keep the brake pedal pushed down before releasing the parking brake.

To avoid battery exhaustion

Be sure to run the vehicle engine while using this product. Using this product without running the engine can drain the battery.

WARNING

Do not install this product in a vehicle that does not have an ACC wire or circuitry available.

Main Menu

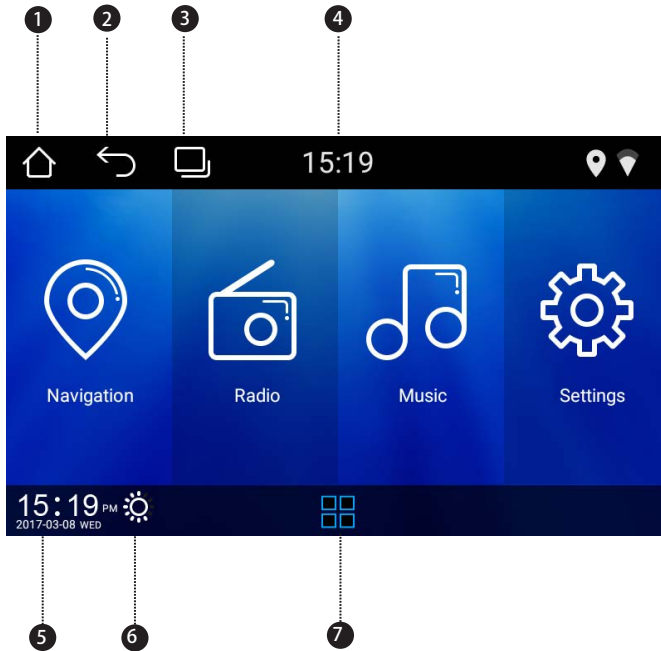

1. Home
2. Back
3. Recent apps
4. Time
5. Date and time
6. Brightness
7. Display all apps

Use apps

Tap "Display all apps" icon to display all apps and tap an app to open it.

Customize the unit

Change the wallpaper

You can set an image or photo as wallpaper for the Home screen. You can choose from the preset Live Wallpapers (dynamic) and Wallpapers (stills), or choose from images or photos stored on a USB storage device or an SD memory card.

Change the wallpaper. Go to Settings > Device Settings > Wallpaper

Adjust the screen brightness

Go to Settings > Brightness, then slide the pointer on the bar to adjust the brightness.

Radio



1. Perform seek tuning or non-stop seek tuning

2. Preset channel list

Use frequency slider to select a frequency you like, then touch and hold any of preset frequency keys to store it.

Up to 18 FM stations and 12 AM stations can be stored in memory.

3. Broadcast frequency slider

4. Band Chooser

5. Manual Scan

6. STEREO (mono/stereo switch)

7. DX/LOC (Local seek tuning/Distant seek tuning switch)

8. Key Pad

9. EQ (Equalizer)

10. TA (Traffic Announcement)

11. PTY (Program Type)

12. AF (Alternative Frequencies)

USB/SD

Plug a USB storage device or insert an SD memory card, then tap Music on the Home screen to play music, tap Video to play video files, or tap ES File Explorer to view images and photos.

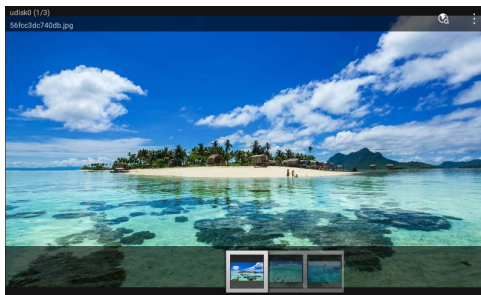
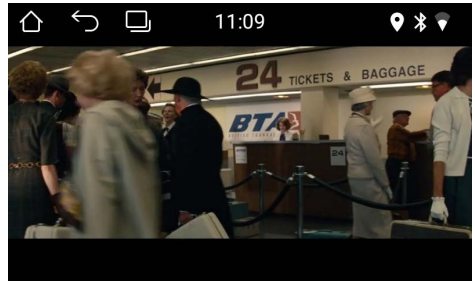
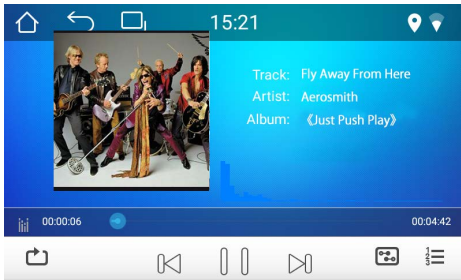

AUX Input

You can display the video image output by the device connected to this unit.

CAUTION

For safety reasons, video images cannot be viewed while your vehicle is in motion. To view video images, stop in a safe place and apply the parking brake.

Bluetooth

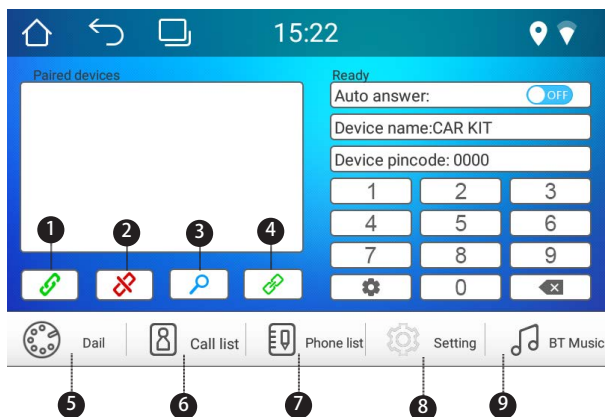

- | | | | |
|------------------------|--------|------------------------|--------------------|
| 1. Pair a device | Keypad | 4. Paired devices list | 7. Phone book |
| 2. Disconnect a device | | 5. Dial | 8. Settings |
| 3. Scan | | 6. Recent Calls | 9. Bluetooth music |

Connect your mobile phone to this unit via Bluetooth and use an external microphone to make and receive hands-free calls.

CAUTION

For your safety, avoid talking on the phone as much as possible while driving.

* Connect to a Bluetooth device Connection (Bluetooth pairing)

- The Bluetooth device must be within 1 meter of this unit. Turn on Bluetooth on the device.
- You can find this unit in the devices list of your Bluetooth device.
- If your Bluetooth device supports SSP (Secure Simple Pairing), a four-digit number password will be required. The default password is 0000.

1. Phone calls

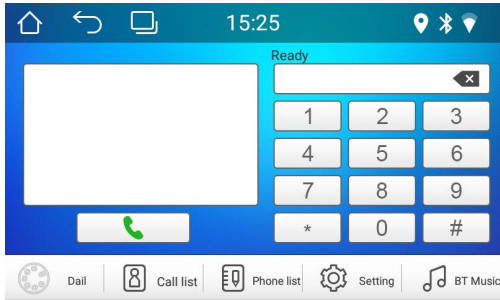

Enter the number to make a call. You can also choose a contact from the phone book to make a call.

2. Phone book

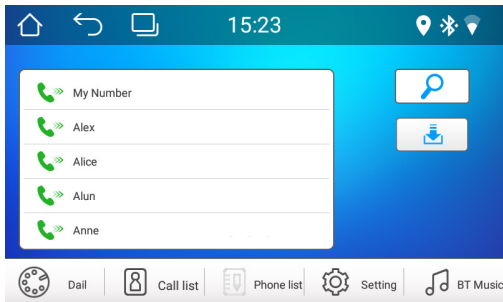

Tap  to synchronize the contacts from your Bluetooth device.

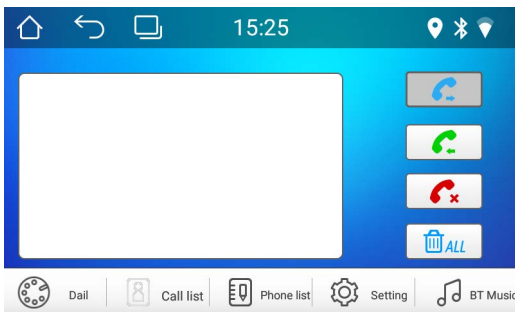

3. Recent calls

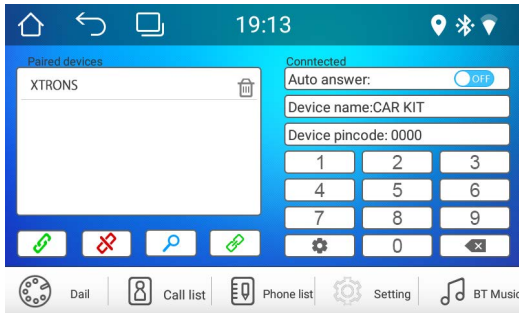

View recent outgoing calls, incoming calls or missed calls.

4. Devices list





Tap  to check paired devices or available devices, then tap  to pair the device.

Tap  to unpair the device.

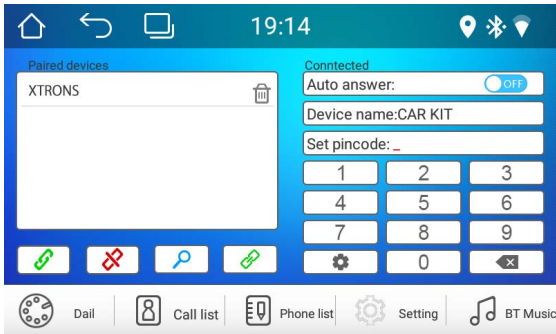
5. Bluetooth settings



- ① You can turn AutoAnswer on or off.
- ② You can change the Device Name of this unit. Tap "Device name" to enter a different name.
- ③ You can change the PIN Number (Bluetooth pairing password). Tap  to enter another four-digit number, then tap  again to set the new password. The default password is 0000.

Bluetooth Music

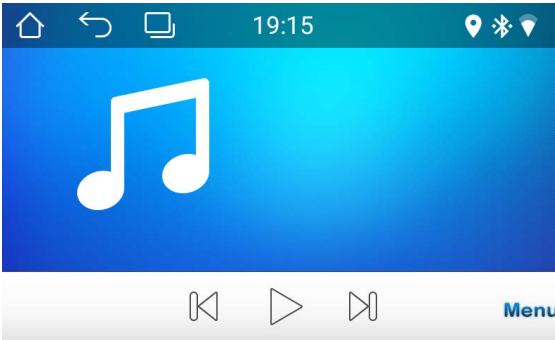

After the Bluetooth connection is established, tap A2DP on the Home screen, then you can play music stored in your Bluetooth device on this unit.

- ✘ **At first, you need to operate the music playback on your Bluetooth device. Then you can operate the Bluetooth music on the unit.**
- ✘ **Please note that the unit may not support the Bluetooth music function when some mobile phones are not quite compatible with the unit.**

Screen Mirroring

Tap EasyConnected on the apps menu screen to enter screen mirroring mode. When you connect a mobile phone with compatible applications installed, you can control the applications for the mobile phone directly from this unit.

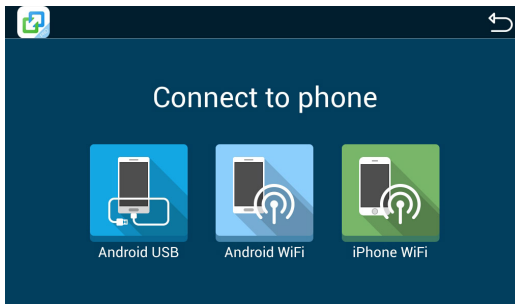

For Android smart phone:

1. Connect via a USB cable

- a. Go to Settings > About Device, then tap Build number 7 times to enable Developer options. Turn on USB debugging. A message *Allow USB debugging?* will pop up. Turn *Always allow from this computer* on, then tap OK.
- b. Connect your Android smart phone to this unit via a USB cable.

2. Connect via Wi-Fi

- a. Go to Settings > Wireless & networks > More > Tethering & portable hotspot, then turn Portable Wi-Fi hotspot on or tap Set up Wi-Fi hotspot.
- b. Tap Android WiFi, then select your Android device name from the hotspot list. Enter the password when prompted.

✘ **Please note this function is only applicable for the smart phones equipped with wireless mirroring function, and it only supports Android version above 4.0. Audio streaming requires a Bluetooth connection.**

For iPhone:

- a. Go to Settings > Personal Hotspot, then turn Personal Hotspot on.
- b. Tap iPhone WiFi, then select your iPhone name from the hotspot list. Enter the password when prompted.
- c. Tap AirDrop and choose "Everyone", then tap AirPlay in the Control Center on your iPhone. Select EC-Mirror.

✘ **On iPhone 4/4s, only photos can be streamed wireless to this unit. On iPhone 5 and other later iPhone models, both music and photos can be streamed wireless to this unit. Video streaming requires the appropriate Apple cable or adapter.**

Navigation



Built-in navigation offers detailed, reliable route guidance information to help you get where you want to go.

You can actually download a range of GPS Navigation apps via Google Play and run them on the unit. You can download Sat Nav apps like TomTom, Navigon, Route 66, Sygic, iGO, Google Maps and many more.

Connect to the Internet

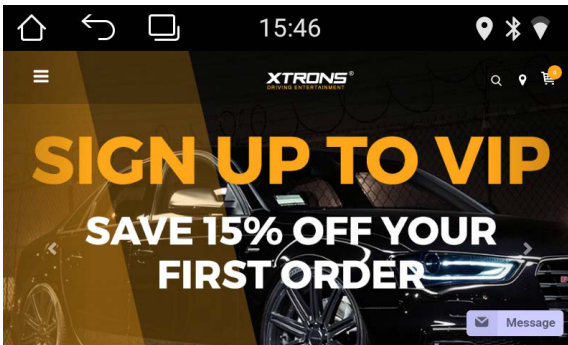

You can connect the unit to the Internet whenever necessary, using a Wi-Fi connection (if available) or 3G network (3G dongle is sold separately). You can browse the web, download apps via Google Play, play online games, etc. The possibilities are endless with the Internet in your car.

DVR

You can control a car DVR camera (sold separately) on this unit and use it to record all the events of a journey.

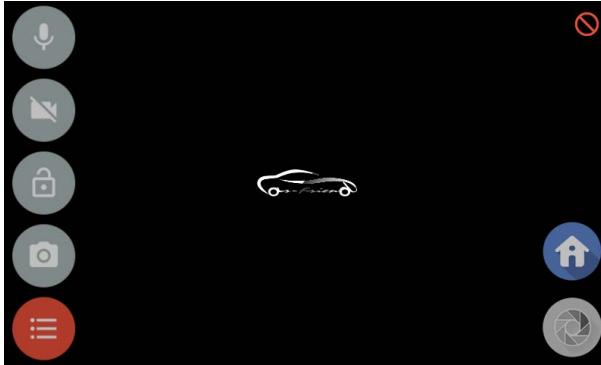

DAB+ (Optional)

With use of a DAB dongle (sold separately), DAB+ (Digital audio broadcasting) tuner lets you enjoy the convenience of digital radio, while Auto DAB+ Tuning makes sure there are less signal interruptions. DAB+ digital radio brings you high-detail, digital-quality sound, lots of stations, program information and more.

DAB antenna (sold separately) needs to be positioned on the windscreen of your vehicle. Tap DAB+ on the apps menu screen, then tap  to search all available services automatically.



TV (Optional)



With use of a Digital TV tuner (sold separately), MPEG-4 Digital TV enables you to watch DVB-T digital TV on this unit. Please check to ensure your country supports MPEG-4 DVB-T.

✘ **Please note this feature is not supported on all models.**

Settings

1. Common Settings

1. Navigation

The Bluetooth reception is poor. Move the mobile phone closer to the product or

2. Audio

Choose audio from user, classical, pop, rock, hall and movie . Tap any of them to adjust the equalizer.

3. Brightness

Drag the slider to adjust the backlight.

2. Device Settings

2.1 Wall paper

Choose wallpaper from Wallpaper / ES File Explorer / Gallery / Live Wallpaper

2.2 Date/Time

Automatic date & time: Use network provided time.

Select time zone: Tap it and select time zone.

Use 24-hour format: 12-hour format and 24-hour format switch

2.3 Language

Set the language for unit.

3. System Settings

3.1 Reversing Setting

3.1.1 Reversing setting

Turn Distance Line on or off

Turn Steering wheel track on or off

Mute

3.1.2 System settings

Beep

Turn Brake Detect on or off

Turn Assistive Touch on or off

3.2 System

Show system info.

3.3 Wheel

This allows you to use the steering wheel control of your vehicle to control the unit.

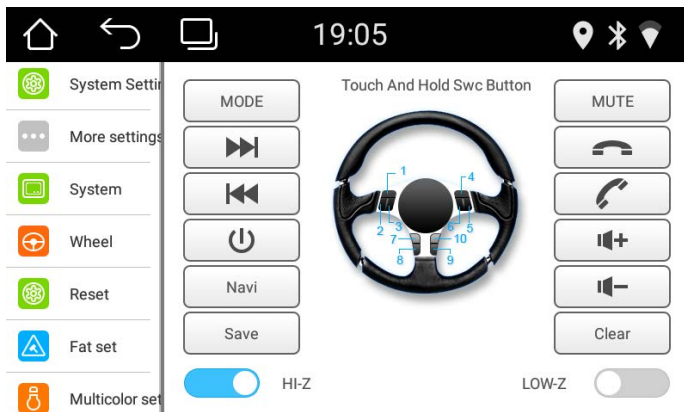

3.4 Reset

Tap "X" to restore to factory setting.

3.5 Factory Settings

Enter the password 7890 to go to Factory settings.

Power logo: Select one of the preinstalled car manufacturer logos as your start up screen.

3.6 Multicolor settings

This enables you to change the illumination color of the buttons to your personal preference. You can choose from 7 colors.

More Settings

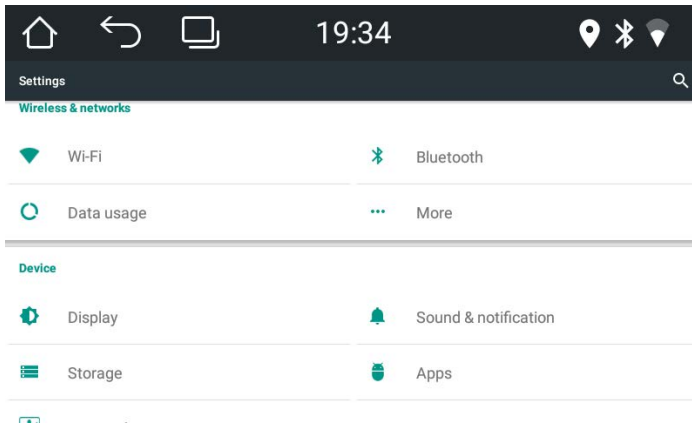

1. Wireless & networks

1.1 Wi-Fi

Turn Wi-Fi on or off.

Choose a network: Tap one of the listed networks, then enter the password, if asked.

1.2 Bluetooth

Turn Bluetooth on or off.

Tap a device on the Paired devices or on the Available devices list to pair or unpair it.

1.3 Data Usage

Shows apps data usage.

1.4 More

You can set up Portable Wi-Fi hotspot or VPN.

2.Device

2.1 Display

2.1.1 Wallpaper

Set an image or photo as wallpaper for the Home screen.

2.1.2 Daydream

Choose different mode from Clock, Colors, Photos and Photo album for Screen Saver

2.1.3 Font Size

Font size: Small, Normal, Large and Huge

2.1.4 When device rotated

2.1.5 Cast Screen

2.2 Sound & notification

2.2.1 Sound

Drag the slider to adjust Media volume, Alarm volume and Notification volume.

Interruptions

Set different ringtone for notifications.

Other Sounds - Turn screen locking sounds on or off

Turn vibrate on touch on or off

2.2.2 Notifications

Set apps notifications show or not when device is locked.

2.3 Storage

- Internal storage

- Total Spcae

- SD card

- USB storage

2.4 Apps

Manage all the apps downloaded on the unit or on an SD memory card.

2.5 Screenshot settings

- Select delay time to capture the screen

Choose from 15 seconds, 30 seconds, 1 minute, 2 minutes, 3 minutes, 4 minutes, and 5 minutes later.

- Set the location of screenshot storage

Choose from Nand Flash, SD Card, and USB Storage.

- Show the screenshot button in the status bar

Turn this on or off.

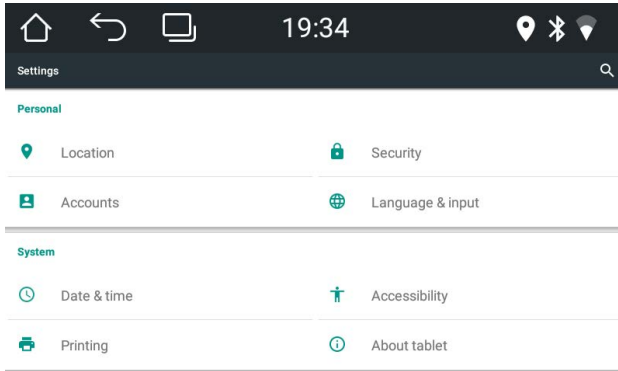

3. Personal

3.1 Location

Turn Location on or off.

Location mode: Choose from High accuracy, Battery saving, and Device only.

Show recent location requests

3.2 Security

- Screen lock
- Owner info
- Encrypt device
- Make passwords visible
- Device administrators
- Unknown sources
- Storage type
- Trusted credentials
- Install certificates from SD card
- Clear credentials
- Trust agents
- Screen pinning
- Apps with usage access

3.3 Accounts

Add account

Add a Google account or other accounts.

3.4 Language & input

3.4.1 Language

Set the language for the unit. Choose from English, French, German, Spanish, and many more.

3.4.2 Spell checker

Turn Spell checker on or off.

3.4.3 Personal dictionary

Add words in the user dictionary.

3.4.4 Keyboard & input methods

The default input method is English (US) - Android Keyboard.

3.4.5 Text-to-speech output

The supported languages are English, French, German, Italian and Spanish.

3.4.6 Pointer speed

Drag the slider to adjust the pointer speed.

4. System

4.1 Date and time

Date & time settings include:

- Automatic date & time
- Set date
- Set time
- Select time zone
- Use 24-hour format

4.2 Accessibility

- CarDvr -Auxiliary Operation
- Captions
- Magnification gestures
- Large text
- High contrast text
- Auto-rotate screen

- Speak passwords
- Accessibility shortcut
- Text-to-speech output
- Touch & hold delay
- Color inversion
- Color correction

4.3 Printing Accessibility

4.4 About device

See information about the unit. The items you can view include:

- System updates
- Status
- Legal information
- Model number
- Android version
- Android security patch level
- Kernel Version
- Build number

Troubleshooting

If you have problems operating this product, refer to this section. The most common problems are listed below, along with likely causes and solutions.

No power

- Car engine has not been started. Start the car engine.
- Incorrect wiring connection. Check the wiring.
- Fuse has been damaged. Replace fuse.

No sound

- Volume is too low. Adjust volume.
- Incorrect wiring connection. Check the wiring.

No image

- Parking brake wire connect is incorrect. Check the parking wiring.

Disc does not play

- The disc is inserted upside down. Insert the disc with the label upward.
- The disc is dirty. Clean the disc.
- The disc is cracked or otherwise damaged. Insert a normal, round disc.
- The files on the discs are in an irregular file format. Check the file format.
- The disc format cannot be played back. Replace the disc.
- The loaded disc is a type this product cannot play. Check what type of disc it is.

The screen is covered by a caution message and the video cannot be shown

- The parking brake lead is not connected or applied. Connect the parking brake lead correctly, and apply the parking brake.
- The parking brake interlock is activated. Park your vehicle in a safe place and apply the parking brake.

Image flashes or distorted

- Video DVD settings do not match with the DVD. Adjust video DVD settings.
- Video connection is incorrect.

Noise in broadcasts

- Signals are too weak. Select other stations with stronger signals.
- Check the connection of the vehicle antenna.
- Change broadcast from stereo to mono.

Preset station lost

- Battery cable is not correctly connected. Connect the battery cable to the terminal that is always live.

The iPod/iPhone's video image is disturbed

- Set the TV Signal settings (NTSC/PAL) of the iPod/iPhone correctly.

The paired mobile phone connects and disconnects constantly

- The Bluetooth reception is poor. Move the mobile phone closer to the product or remove any obstacle between the mobile phone and the product.
- Some mobile phones may connect and disconnect constantly when you make or end calls. This does not indicate any malfunction of the product.
- For some mobile phones, the Bluetooth connection may be deactivated automatically as a power-saving feature. This does not indicate any malfunction of the product.

For more information, please visit our websites



xtrons.com



xtrons.co.uk

For installation and technical advice please visit



www.forum.xtrons.co.uk.



Twitter:



https://twitter.com/xtrons_ug



Facebook:



<https://www.facebook.com/Xtrons/>



YouTube:



<https://www.youtube.com/user/ourxtrons/>



Google+:



<https://plus.google.com/+xtrons/>



RSS:



<http://xtrons.com/rss/>



XTRONS[®]

www.xtrons.com