

Uttern D68 exclusive model year 2009

Parts catalogue



Revision history

2003-12-12 First release

2004-12-23 Update for 2005 ready

2006-01-04 Update for 2006 ready

2007-02-06 Update for 2007 ready

2008-04-16 Update for 2008 ready

2009-02-05 Update for 2009 ready

Uttern D68 exclusive model year 2009

Cabin and steering panel



UTE100007	COMPASS 58F	1 PC
UTE 875135	STEERING CONSOLE D68 MPI 07-	1 PC
UTE 874488	STEERING HELM QC SAFE-T	1 PC
UTE 874489	BEXEL QC SAFE-T	1 PC
UTE 874359	SWITCH TRIMFLAP	2 PC
UTE 874358	SWITCH (ON)-OFF-(ON)	2 PC
Q/S 883709A03	REMOTE CONTROL SIDE MOUNTED	1 PC
Q/S 883720A15	CABLE ASSY II 15 FT PLATINUM	2 PC
UTE 874089	FUSE PANEL C68/D68	1 PC
UTE 874153	DRINK HOLDER A51,A56,C56	1 PC
UTE 871405	CE-PLATE UTTERN	1 PC
UTE 873465	INSPECTION LID 355X600 NOVARADE	1 PC
UTE 874706	FIRE EXTINGUISHER PRIMEX 2KG	2 PC

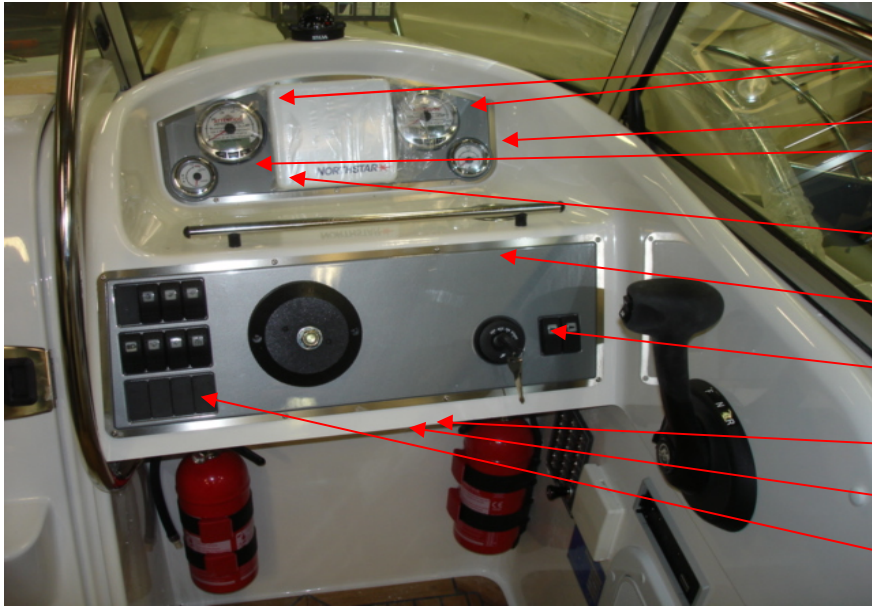

- | | | |
|---------------|--------------------------------|-------|
| Q/S879899K17 | RC OB TRIM-BLACK | 1 SET |
| Q/S 8590743 | BEZEL-85 MM CROME | 2 PC |
| Q/S 879910K11 | FUEL LEVEL-WHITE SMARTCRAFT | 1 PC |
| Q/S 879914K11 | TRIM-WHITE SMARTCRAFT | 1 PC |
| Q/S 8798713 | BEZEL-52 MM CROME | 2 PC |
| | | |
| UTE 874549 | INSTRUMENT PANEL UPPER D66 GPS | 1 PC |
| UTE 874348 | INSTRUMENT PANEL LOWER D68 MPI | 1 PC |
| Q/S 893353A03 | KEY SWITCH KIT | 1 PC |
| UTE 873634 | PORTABLE LIGHT 12V/W55 | 1 PC |
| UTE 873853 | CLAMP FOR PORTABLE LIGHT | 1 PC |
| UTE 873844 | SWITCH COVER CARLING SWITCH | 5 PC |



UTE 877167	NORTHSTAR EXPLORER 650	1 PC
UTE 871339	SWITCH NAVIGATION LIGHTS	1 PC
UTE 871337	SWITCH ENGINE BLOWER	1 PC
UTE 873473	SWITCH BILGE PUMP	1 PC
UTE 871338	SWITCH WINDSCREEN WIPER	2 PC
UTE 873840	SWITCH BOW LIGHT	1 PC
UTE 873606	SWITCH FAN	1 PC
UTE 871336	SWITCH ON-OFF	3 PC
UTE 874406	MAIN SWITCH OFF-ON-ON	3 PC
UTE 873474	MAIN SWITCH (ON)-OFF BILGE PUMP	1 PC
UTE 877101	STEER. WHEEL FERARRA 800 BLACK	1 PC

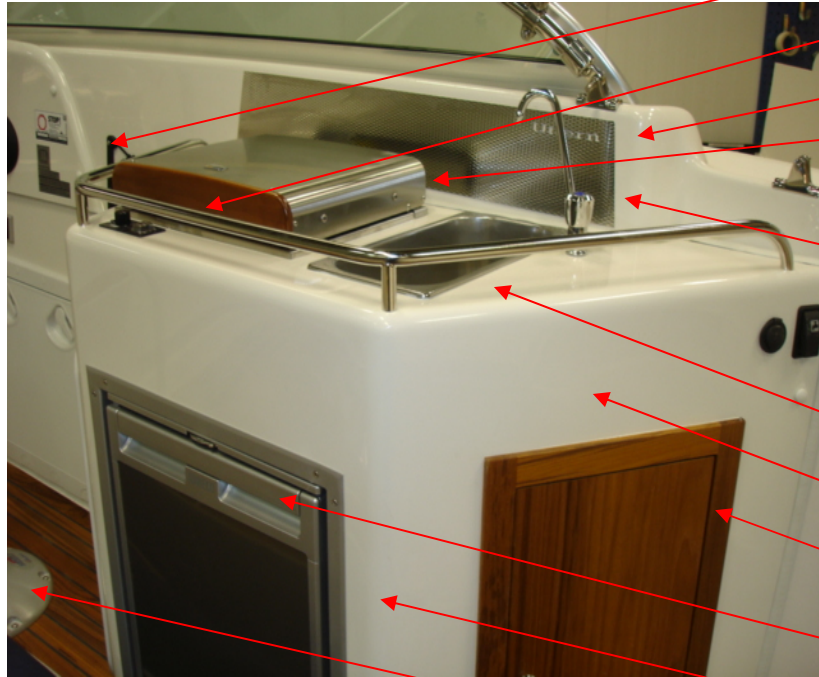

UTE 874819	STORAGE NET BLACK	1 PC
UTE 873881	BOW SS AROUND STOVE D68	1 PC
UTE 873835	FLAME COVER FOR SPIRIT HEATER D68	1 PC
UTE 874590	STOVE WALLAS 800	1 PC
UTE 874591	HEAT BLOWER LID WALLAS 800	1 PC
UTE 874592	TUBE WALLAS 800	1 PC
UTE 874627	DRAINSLEEVE WALLAS 800	1 PC
UTE 871946	FUELTANK 5 L WALLAS	1 PC
UTE 874722	WATER TAP	1 PC
UTE 874760	SWITCH WATER TAP	1 PC
UTE 871336	SWITCH ON-OFF	1 PC
UTE 873748	SOCKET 12V ROUND FLUSH BLACK	1 PC
UTE 873918	RECTANGULAR WASHING-UP SINK	1 PC
UTE 874850	PENTRY D68 PLASTIC PART ONLY	1 PC
UTE 875197	CUPBORD	1 PC
UTE 875192	COOLER 12V CR-50 COOLMATIC	1 PC
UTE 875193	FRAME FLUSH CR-50	1 PC
UTE 874781	DRIVER SEAT BASE 30/40	1 PC

Parts for heater, nothing visible in boat.

UTE 874851	HEATER WAECO	1 PC
UTE 872360	HOT-AIR HOSE 50 FOR HOT-AIR U	4,3 M
UTE 874852	50 GREY WAECO	1+1 PC
UTE 873846	MARINE WATER HOSE 16 MM	5 M
Q/S 806837	CONNECTOR-3/8-18 MALE	1 PC

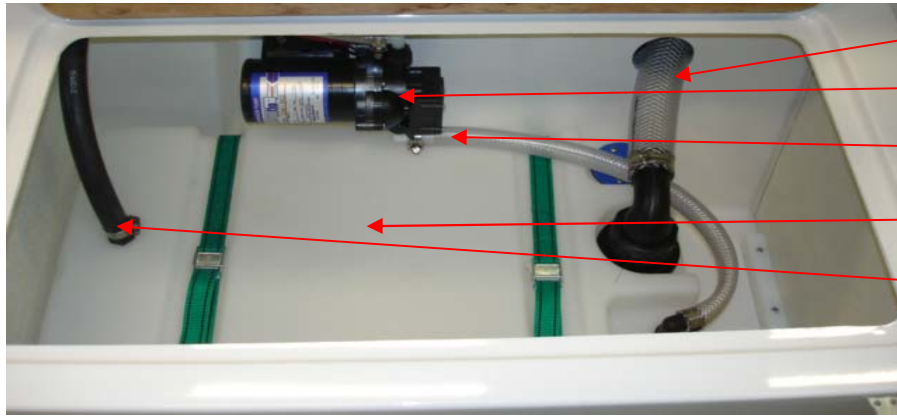

UTE 874732	HOSE 38 MM PVC	1,4 M
UTE 874723	FRESH WATER PUMP	1 PC
UTE 874756	HOSE CONNECTOR ANGL 3/8 TO 1/2	1 PC
UTE 874762	FRESH WATER TANK 45L	1 PC
UTE 873260	FUEL HOSE 16MM A1	0,7 M

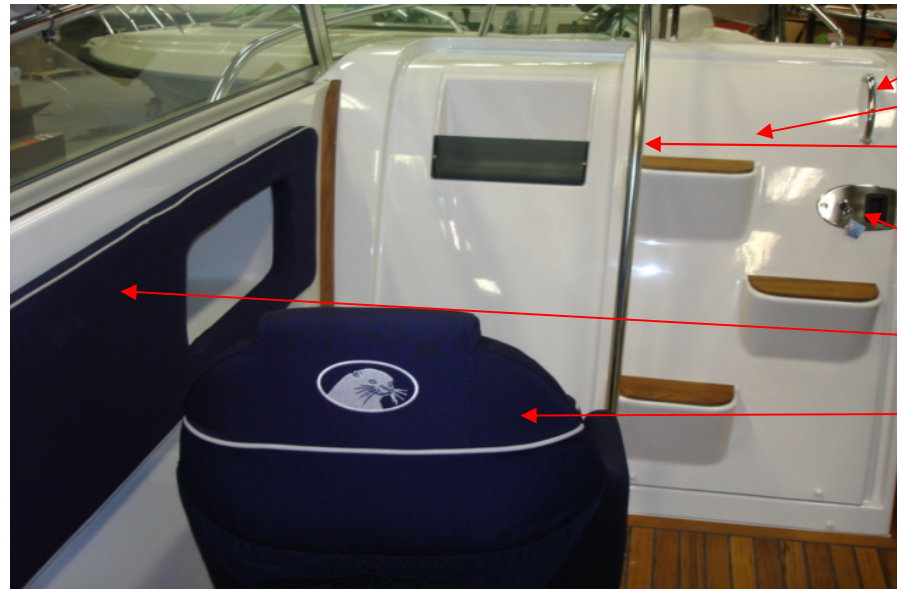

UTE 871758	HANDLE SS 200 MM	1 PC
UTE 874176	GLIDING-DOOR D68 NOT COMPLETE	1 PC
UTE 874138	WINDSHIELD SUPPORT PORT-03 D68	1 PC
UTE 874137	WINDSHIELD SUPPORT S/B-03 D68	1 PC
UTE 874133	LOCK MS FLUSH D68 OVAL	1 PC
UTE 875159	CUSHION D68 07- BACKFRONT L-SH	1 PC
UTE 874780	DRIVER SEAT BLUE 06-	1 PC

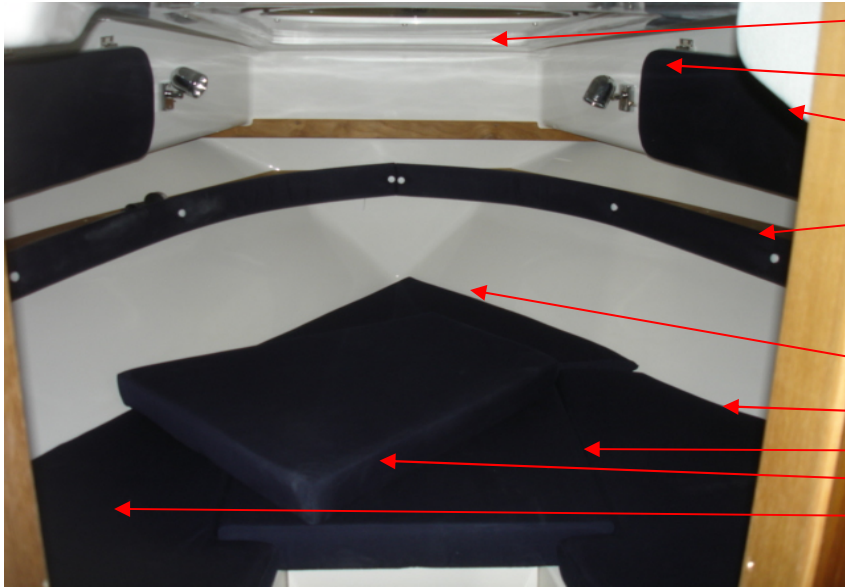

UTE 877204	LADDER PEAK BOW C68 08-	1 PC
UTE 873650	READING LAMP CHROMED BRASS	2 PC
UTE 874108	CUSHION CABIN C68/D68 HATCH (4 PCS)	1 SET
UTE 877208	CUSHION C68/D68 CABIN BACKR.	1 SET
UTE 877207	CUSHION D68/C68 CAB SIT 4 08-	1 SET
UTE 877207-1	CUSHION D68/C68 CAB SIT 4 08- FRONT	1 PC
UTE 877207-2	CUSHION D68/C68 CAB SIT 4 08- RIGHT	1 PC
UTE 877207-3	CUSHION D68/C68 CAB SIT 4 08- MID 1	1 PC
UTE 877207-4	CUSHION D68/C68 CAB SIT 4 08- MID 2	1 PC
UTE 877207-5	CUSHION D68/C68 CAB SIT 4 08- LEFT	1 PC
	ej i bild	
UTE 877209-6	(STICKLÅDA)	1 PC
UTE 873745	MIRROR WITH TEAKFRAME 280X380 MM	1 PC
UTE 873728	HOOK DOUBLE CHROME	2 PC



UTE 877205	HATCH 7205	1 PC
UTE 877009	TOILET	1 PC
not in picture		
UTE 877010	HOLDING TANK 50L	1 PC

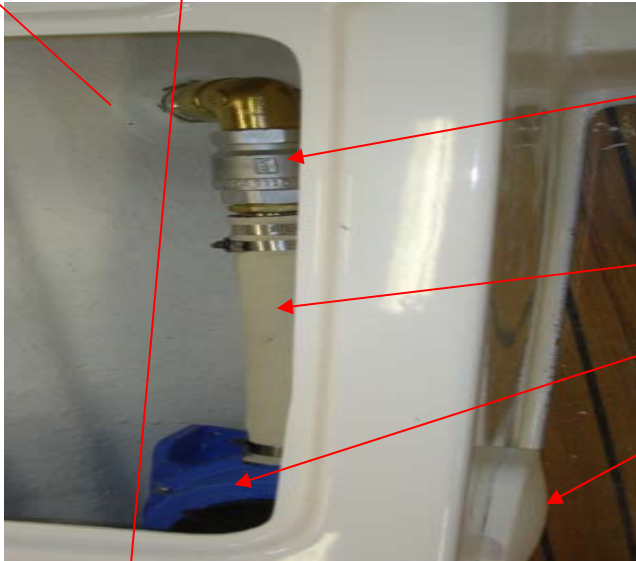

UTE 877126	NIPPLE 1 1/4"-38MM	1 PC
UTE 871621	SHUT OFF VALVE 1 1/4"	1 PC
UTE 873761	CORNER 1 1/4"	1 PC
UTE 877015	THRU-HULL FITTING 1 1/4" 60MM	1 PC
UTE 877019	HOSE WASTE 38MM	
UTE 877011	BAILING PUMP WC MANUAL	1 PC
UTE 877012	BAILING PUMP WC PLATE	1 PC



UTE 872175	HOSE 19 MM PVC	
UTE 877016	THROUGH HULL 3/4" FITT.+STRAIGHT	1 PC
UTE 877017	HOSE SOCKET 3/4"	1 PC
UTE 877018	SHUT OFF VALVE 3/4"	1 PC

Uttern D68 exclusive model year 2009

Aft

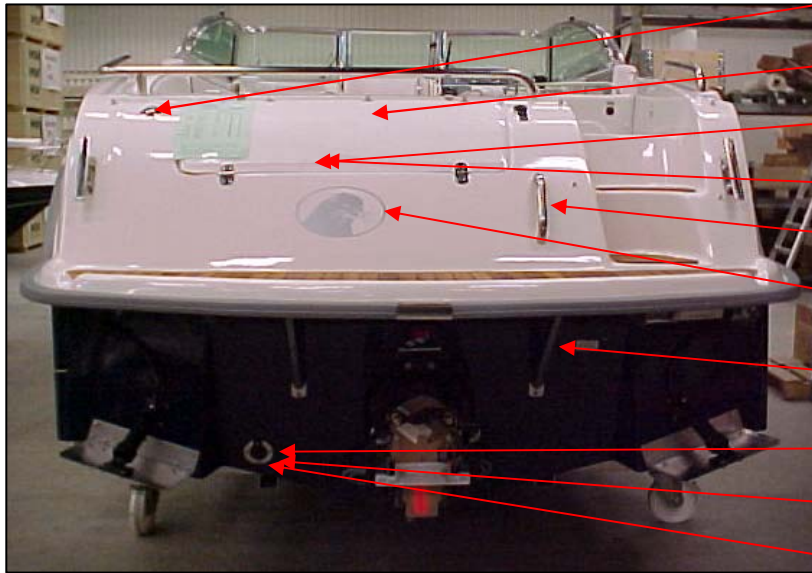

UTE 871702	FLAG HOLDER ATTACHMENT SS	1 PC
UTE 874370	HATCH ANCHOR BOX AFT C68/D68	1 PC
UTE 873939	STORAGE SPACE ANCHOR BOX	1 PC
UTE 873934	RUBBER MAT FOR ANCHOR BOX C68/D68	1 PC
UTE 871758	HANDLE SS 200 MM	1 PC
UTE 873497	DECAL UTTERN HEAD SILVER VERY BIG	1 PC
UTE 873623	SUPPORT TUBE FOR BATHING PLATFORM SS	2 PC
UTE 871642	ANTI-SYPHONE VALVE SELF-BAILING DEVICE	1 PC
UTE 871612	THRU HULL FITTINGS 1" CONVEX	1 PC
UTE 871629	TUBE SOCKET 1"	1 PC

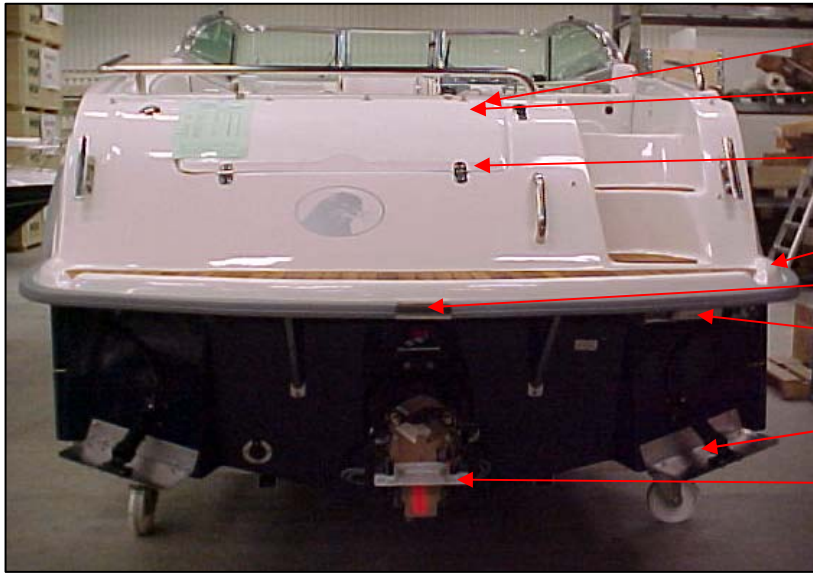

UTE 871694	ECCENTRIC LOCK ADJUSTABLE	4 PC
UTE 871821	LOCK FITTINGS FOR ECCENTRIC LOCK W. HOL	4 PC
UTE 871242	HINGE 38X37 2+2	8 PC
UTE 873386	GUNNEL RUBBER 632 15 M SILVER-REY	1 PC
UTE 873631	GUNNEL FITTINGS SS C68/D68	1 PC
UTE 874326	BOARDING LADDER 3-STEP COMPLETE	1 PC
UTE 871968	TRIM FLAP INSTA. 12X8	1 PAIR
Q/S 8306371	DRAIN & PLUG	1 PC



UTE 875155	CUSHION D68 07- REAR BACKREST	1 PC
UTE 875154	CUSHION D68 07- REAR SEAT	1 PC
UTE 875158	CUSHION D68 07- BACKREST REAR L-SH	1 PC
UTE 877228	CUSHION D68 08- SITT REAR L-SH	1 PC
UTE 877229	CUSHION D68 08- SITTFRONT L-SH	1 PC
UTE 875159	CUSHION D68 07- BACKFRONT L-SH	1 PC

For floor part numbers, see Teak floor

Uttern D68 exclusive model year 2009

Fore



UTE 873749	BOW RAIL S/B C68/D68	1 PC
UTE 873750	BOW RAIL PORT C68/D68	1 PC
UTE 873463	CLEAT 205X55 MM	6 PC/BOAT
UTE 872817	ANCHOR HATCH FORE	1 PC
UTE 871652	FITTING STRING WITH CLIP	1 PC
UTE 871250	HINGE 74X39 2+2	2 PC
UTE 873469	BOWEYE CLASS 3 12 MM LOCK NUT	1 PC
UTE 873564	WINDSHIELD D68 TAYLOR 5 PIECES	1 SET
UTE 873564-1	WINDSHIELD D68 SB SIDE WINDOW	1 PC
UTE 873564-2	WINDSHIELD D68 SB CURVE WINDOW	1 PC
UTE 873564-3	WINDSHIELD D68 CENTRE DOOR	1 PC
UTE 873564-4	WINDSHIELD D68 PORT CURVE WINDOW	1 PC
UTE 873564-5	WINDSHIELD D68 PORT SIDE WINDOW	1 PC



- UTE 874135 BOW WINDSHIELD PORT -03 D68 1 PC
- UTE 874138 WINDSHIELD SUPPORT PORT-03 D68 1 PC
- UTE 873331 WINDSCREEN WIPER BLADES 355 MM 2 PC
- UTE 873557 WINDSCREEN WIPER ARM 306 MM PARALI 2 PC
- UTE 871981 WINDSCREEN WIPER ENGINE 38L 2 PC
- UTE 874137 WINDSHIELD SUPPORT S/B-03 D68 1 PC
- UTE 874136 BOW WINDSHIELD S/B -03 D68 1 PC
- UTE 873496 HATCH D68 ROUND (ULTRA II HATCH) 1 PC



- UTE 875247 BARNEGET LIGHT HELLA STAINLESS 1 PAIR
- UTE 874779 BARNEGET LIGHT HELLA 1 PAIR
- UTE 871936 BOW EYE 12 MM SS 1 PC
- UTE 874770 CLAMSHELL COVER STAINLESS 1 PC

Uttern D68 exclusive model year 2009

Starboard side



UTE 873646	STREIP "68" SILVER FOR DECK	1 PC
UTE 874529	VENTILATION GRID SB	1 PC
UTE 874530	VENTILATION GRID PORT	1 PC
UTE 873592	STREIP "D68EXCL" SILVER	1 PAIR
UTE 873426	DECKFILL UNLEADED SS 38 MM	1 PC
UTE 872989	FUEL TANK VENT ATTWOOD	1 PC
UTE 873539	DECAL "BY M" LARGE MODEL	2 PC



UTE 875178	AFTCANVAS D68 W.BOWS 07-	1 PC
UTE 874502	NAVIGATIONS LIGHT PAI 3800 RED/GREEN	1 PC
UTE 873621	AFT RAIL S/B C68/D68	1 PC
UTE 873622	AFT RAIL PORT C68/D68	1 PC
UTE 873463	CLEAT 205X55 MM	6 PC/BOAT



UTE 877132	LOUVERED VENT 82X82 STAINLESS	1 PC
UTE 877133	LOUVERED VENT HOSE ADAP	1 PC
	Not in picture. Port.	
UTE 873642	THRU HULL FITTINGS 3/4" SS/PLASTIC	2 PC
	Not in picture. Port.	
UTE 871660	THRU HULL FITTINGS 3/4 PLASTIC	2 PC
	Not in picture. Port.	
UTE 875119	ROUND BASE FOR POLE WHITE	1 PC
UTE 873643	THRU HULL FITTINGS 1" SS/PLASTIC	4 PC

Uttern D68 exclusive model year 2009

Seats aft

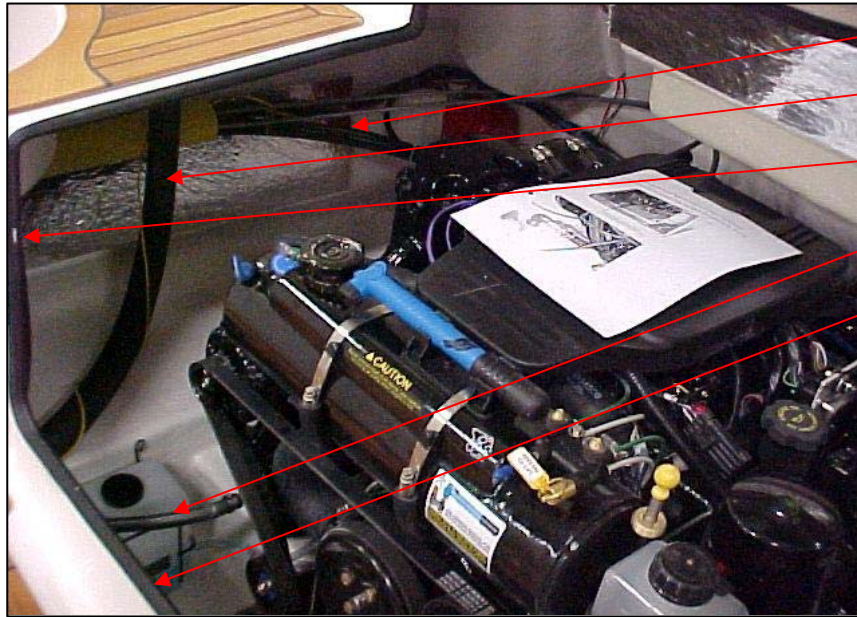

UTE 874491	STEERING CABLE 5,18 M (17 FT)	1 PC
UTE 873562	FUEL HOSE 38 MM A1 CUT 1,6 M	1 PC
UTE 873260	FUEL HOSE 16MM A1	2,35 M
UTE 873261	FUEL HOSE 10MM A1	0,45 M
UTE 872147	U-TRIM WITH SIDE TIGHTENING	4,2 m
Not in picture		
UTE 875377	FUELTANK 185L ALU DIES/PETR	1 PC
UTE 873752	ENGINE HATCH 752 C68/D68	1 PC
Q/S 883090	SENSOR-SPEED/TEMPERATURE	1 PC
UTE 877168	DEPTH TRANCDUCER THRU-HULL	1 PC

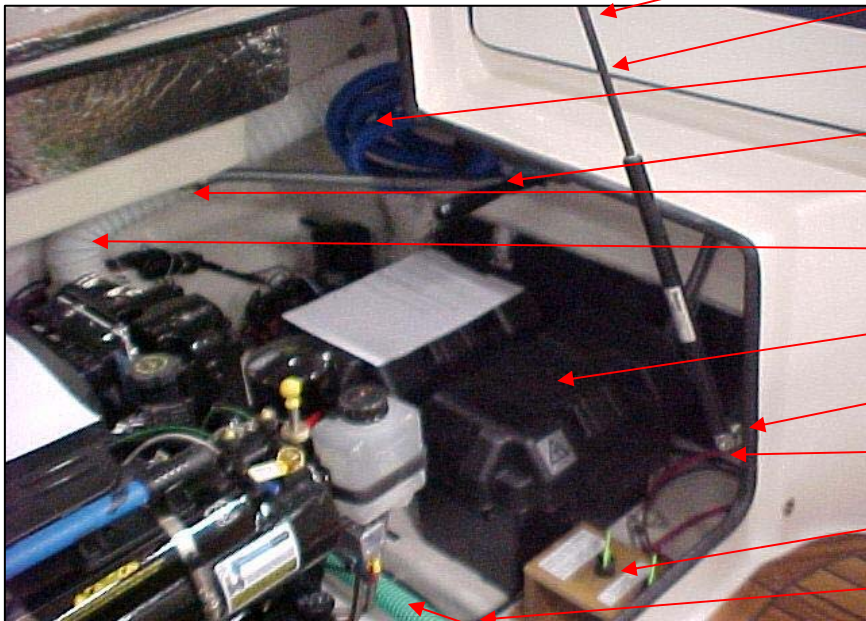

UTE 874389	BONDING EAR	2 PC
UTE 874374	HOLDER FOR GAS SPRING	2 PC
UTE 875248	GAS SPRING 150N	2 PC
UTE 872177	HOSE 25 MM BLUE (BAILING PUMP)	4,0 M
UTE 871851	BILGE PUMP MANUAL URSIN	1 PC
UTE 871857	FAN MOTOR COMPARTMENT	1 PC
UTE 872182	HOSE 75 MM GREY 6 M	2,0 M
UTE 871650	BATTERY BOX	1 PC
UTE 874375	BRACKET FOR GAS SPRING	2 PC
UTE 874376	PEG FOR GAS SPRING	2 PC
UTE 872704	MAIN POWER SWITCH	2 PC
UTE 871612	THRU HULL FITTINGS 1" CONVEX	1 PC
UTE 871632	HOSE ADAPTER 1" 32 MM HOSE	1 PC
UTE 871629	TUBE SOCKET 1"	1 PC
UTE 872178	HOSE 32 MM SELF BAILING	0,52 M

Not in picture:

UTE 875377	FUELTANK 185L ALU DIES/PETR	1 PC
UTE 873799	THRU HULL FITTINGS 1 1/4" WITH STRAIN	1 PC
UTE 873761	CORNER 1 1/4"	1 PC
UTE 871621	SHUT OFF VALVE 1 1/4"	1 PC
UTE 873762	HOSE NIPPLE 1 1/4"	1 PC
Q/S 883090	SENSOR-SPEED/TEMPERATURE	1 PC
UTE 877168	DEPTH TRANCDUCER THRU-HULL	1 PC

Uttern D68 exclusive model year 2009

Teak floor

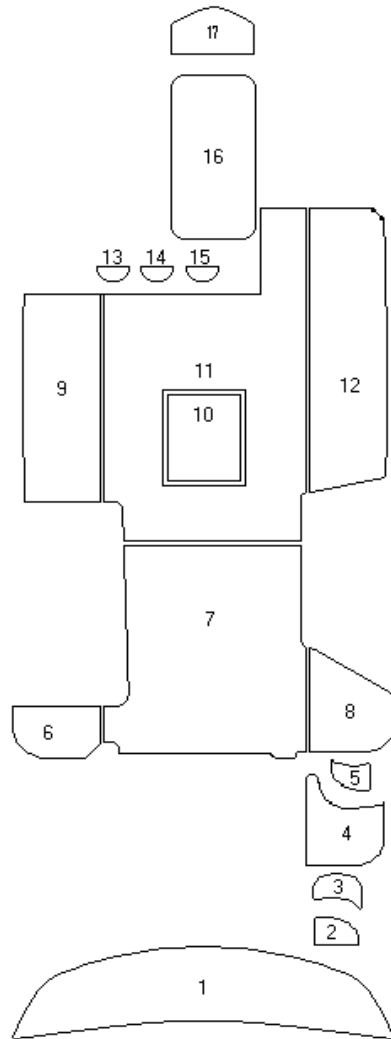

UTE 875101	TEAK FLOOR D68 NR 17
UTE 874316	TEAK FLOOR D68 NO 16
UTE 874315	TEAK FLOOR D68 NO 15
UTE 874314	TEAK FLOOR D68 NO 14
UTE 874313	TEAK FLOOR D68 NO 13
UTE 874312	TEAK FLOOR D68 NO 12
UTE 874311	TEAK FLOOR D68 NO 11
UTE 874310	TEAK FLOOR D68 NO 10
UTE 874309	TEAK FLOOR D68 NO 9
UTE 874308	TEAK FLOOR D68 NO 8
UTE 874307	TEAK FLOOR D68 NO 7
UTE 874306	TEAK FLOOR D68 NO 6
UTE 874305	TEAK FLOOR D68 NO 5
UTE 874304	TEAK FLOOR D68 NO 4
UTE 874303	TEAK FLOOR D68 NO 3
UTE 874302	TEAK FLOOR D68 NO 2
UTE 874301	TEAK FLOOR D68 NO 1

Additional information

Documents

UTE 871559	DECAL SET ALU-COLOURED W.BLACK PRINT	1 PC
UTE 873917	DECALS D68	1 PC
UTE 870547	FOLDER WITH ZIPPER	1 PC
UTE 873262	USER MANUAL SWEDISH POLY BOAT OG SUP UTTERN	1 PC
Q/S 8828553WU	UTTERN WARRANTY SUPPLEMENT	1 PC
Q/S 83004243	WARRANTY CARD	1 PC

UTE 875108 ACCESSORIES BAG D1 1 PC

Parts in bag:

UTE 873381	ANCHOR 10 KG	1 PC
UTE 871224	ANCHOR ROPE 35MX12MM	1 PC
UTE 873389	MOORING ROPE 4MX14MM	1 PC
UTE 873390	MOORING ROPE 10MX14MM	1 PC
UTE 871226	FENDER LINE 4x1,5MT	1 PC
UTE 871696	FENDER 15X63 CM WHITE F-1	4 PC
UTE 871955	ACCESSORY BAG	1 PC
UTE 874290	UTTERN BAG	1 PC

UTE 875118	ALL-ROUND POLE LIGHT 54"	1 PC
UTE 875225	TABLE VARNISHED	1 PC
UTE 874658	TABLE COLUMN 65/760	1 PC
UTE 875249	FLOOR FITTING W/O BOLT SPRING	1 PC
UTE 875250	BOLT FLOOR FITTING (SPRING MOD)	1 PC