



FLOMATIC® VALVES
High Quality Valves Built To Last...



CONTROL VALVE PRICE LIST 2020

MEETS ANSI/AWWA C530 STANDARDS

MEETS THE REQUIREMENTS OF THE AMERICAN IRON STEEL ACT

Manufacturer under a certified ISO 9001-2015 and
ISO 14001-2015 quality and environmental systems



TABLE OF CONTENTS

AUTOMATIC CONTROL VALVES

THIS CATALOG IS NO WAY INDICATIVE OF ALL POSSIBLE MODELS AND CONFIGURATIONS. PLEASE CONTACT THE FACTORY IF YOU DO NOT SEE WHAT YOU NEED OR FOR ANY SPECIALTY APPLICATIONS.

IMPORTANT INFORMATION	PAGE
Standard Features	1
Features and Benefits	2
Materials of Constructions	3
Dimensions	4
Important Features	5
Control Valve Options	23
Control Valve Accessories	24 - 25
Pilot Control Valve: (Back-Pressure Pilot (BPP) and Pressure Reducing Pilot (PRP)	26
Repair Kits	27
Order Form	28
Conditions and Terms of Sale	30
Contact Information	32

VALVE TYPE	DESCRIPTION	MODEL	PAGE
BASIC VALVE	Basic Valve	C000	7
PRESSURE REDUCING VALVE Series C100	Pressure Reducing	C101	9
	Pressure Reducing w/ low flow bypass	C101B	9
	Pressure Reducing & Check	C103	10
	Pressure Reducing & Back Pressure (Sustaining)	C104	10
	Pressure Reducing w/ solenoid override	C105/6	11
ALTITUDE CONTROL VALVE Series C200	Altitude (One-Way) (modulating)	C201	11
	Altitude (One-Way) & Back Pressure (modulating)	C203	12
	Altitude (One-Way) (non-modulating)	C205	12
	Altitude (One-Way) w/ delayed open (non-modulating)	C207	13
	Altitude (Two-Way Flow) (non-modulating)	C209	13
BACK PRESSURE VALVE Series C300	Back Pressure (Sustaining)	C301	14
	PRESSURE VALVE Back Pressure (Sustaining) & Check	C302	14
	Series C300 Back Pressure (Sustaining) w/ solenoid override	C303/4	15
	Differential Back Pressure	C306	15
PRESSURE RELIEF VALVE - Series C400	Pressure Relief	C401	16
SURGE ARRESTOR VALVE - Series C500	Surge Arrestor (hydraulic)	C501	16
PUMP CONTROL VALVE Series C600	Pump Control	C601	17
	Pump Control & Back Pressure	C603	17
	Pump Control & Pressure Reducing	C604	17
	Pump Control Back Pressure & Pressure Reducing	C605	17
	Pump Control w/Dual Power Chamber & Built-in Check	C611	17
	Pump Control Deep Well	621	18
FLOAT CONTROL VALVE Series C700	Float (pilot operated) -Modulating	C701	18
	Float (direct acting)- Vertical- Non-Modulating	C705	19
SOLENOID CONTROL VALVE Series C800	Solenoid Control (Normally closed N.C.) C801	C801	20
	Solenoid Control (Normally Open N.O.)	C802	20
FLOW CONTROL VALVE Series C900	Flow Control	C901	20
	Flow Control & Pressure Reducing	C902	21
	Flow Control w/ solenoid override	C903/4	21
CHECK VALVE	Hydraulic Check	C1001	22

MODEL C & CA

STANDARD FEATURES

- Fusion Epoxy Coating
- EZ off Jack Screws (Covers & Seat Rings)
- Body Drain Plug
- Rugged Dependability
- 3 Year Warranty

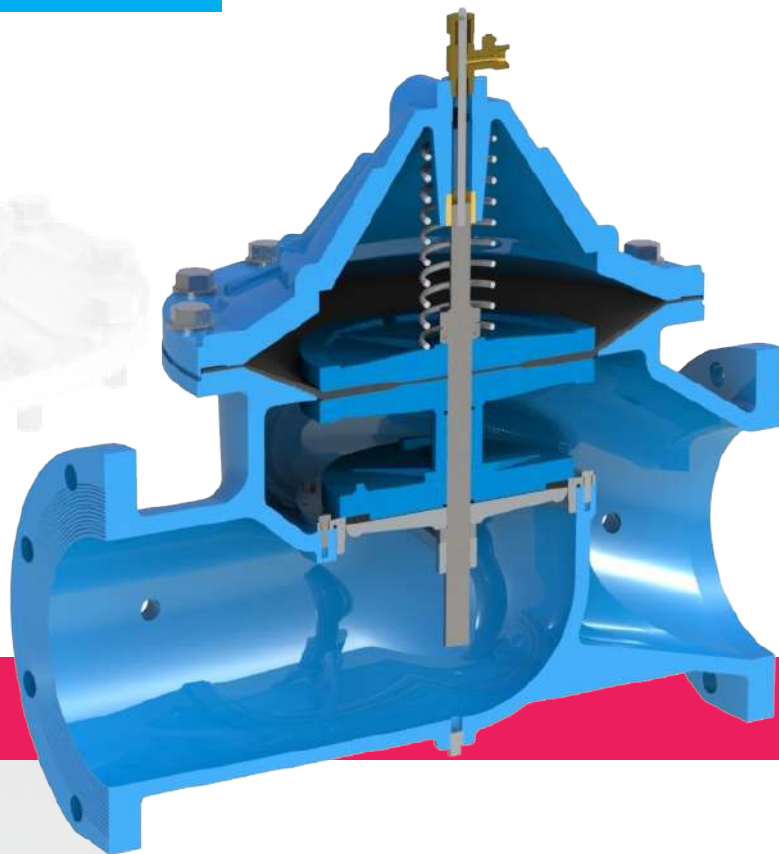

ANSI COMPLIANT - MADE IN THE USA

Must specify at time of quote and order.

The Flomatic Model C000/CA000 Main Valve is a self contained hydraulically operated, single diaphragm-actuated globe or angled body valve with no pilot controls. The valve has three major components: the body with a removable seat, the cover with bushing, and the diaphragm assembly.

The diaphragm assembly is the only moving part. The cover forms a sealed chamber above the diaphragm to separate operating pressure from line pressure. Long service life and dependable operation are ensured due to packless construction.

The valve is designed for use with various types of pressure and/or electric controls to provide the desired control of pressure or flow for a variety of water system applications. The Flomatic Model C000/CA000 is the basic valve used for all Flomatic full port automatic control valves.

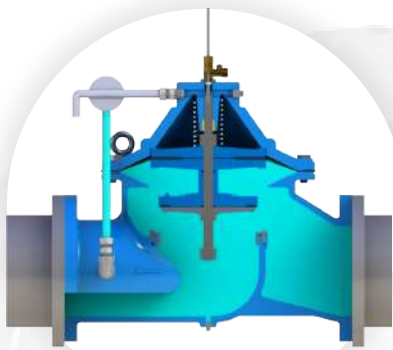

FULL FLOW

Full flow is achieved by releasing control pressure from the cover chamber to a lower pressure zone which allows line pressure to open the diaphragm assembly.

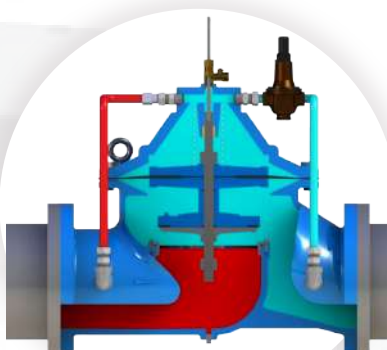

MODULATED FLOW

Modulating control is achieved by utilizing a pressure regulating control valve to automatically compensate for line pressure fluctuations.

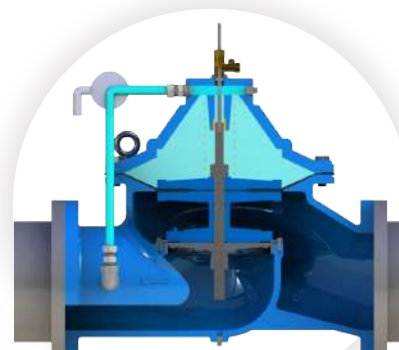

TIGHT CLOSURE

Tight closure is achieved by applying inlet pressure to the cover chamber to leverage the differential force of the larger diaphragm surface area against the smaller seat area.

10 REASONS TO SELECT FLOMATIC AUTOMATIC CONTROL VALVES

- 1 NSF/ANSI 61 APPROVED** (Consult factory for configuration)
Fusion Bonded Epoxy Inside & Out for Superior Corrosion Resistance.
- 2 PILOT TUBING ISOLATION VALVES STANDARD**
For Ease of Maintenance and Service.
- 3 DRAIN PLUG STANDARD**
For Draining During Service or For Seasonal Applications.
- 4 TEST COCKS STANDARD**
For Easy Installation and Removal of Pressure Gauges.
- 5 ALL SS FASTENERS STANDARD**
Superior Corrosion Resistance and Ease of Maintenance.
- 6 JACK SCREWS STANDARD**
For easy removal of bonnet and seat (6" and Up)
- 7 INDICATOR ROD STANDARD** (6" and Up)
For Visual Indication of Valve Movement.
- 8 AIR BLEED VALVE STANDARD**
For Releasing Air From Diaphragm Chamber on Startup or After Service.
- 9 LOW HEADLOSS**
Superior Flow Efficiencies. Higher CV Values. Lower Friction Losses.
- 10 100% WATER TESTED**
All Valves Hydrostatically Tested For Leaks and Proper Operation.



MATERIALS OF CONSTRUCTION

AVAILABLE SIZES

PATTERN	FLANGED	THREADED	GROOVED
Globe	1-1/2" - 36"	1-1/4" - 3"	1-1/4" - 1-1/2"
Angle	1-1/2" - 12"	1-1/4" - 2"	N/A

PRESSURE MAX (Maximum Pressure - PSI)

ANSI STANDARD† B16.42				BRITISH STANDARD† BS4504			
Ductile Iron Grade ASTM A536	150 CLASS	300 CLASS	NPTF	Ductile Iron Grade BS 2789	PN10	PN16	BSPPF
	250 PSI	400 PSI	400 PSI		250 PSI	400 PSI	400 PSI

MATERIAL (Standard)

COMPONENT	VALVE SIZE		
	1-1/4" - 4"	6" - 10"	12" - 36"
Body, Cover & Top Cover	ASTM A 536 65-45-12 Ductile Iron		
Spool & Diaphragm Plate	ASTM A 536 65-45-12 Ductile Iron		
Seat Ring & Seat Plate	316 Stainless Steel		
Stem Bushings	Unleaded Bronze		
Seat Seal	Buna-N		
Diaphragm	Nylon Reinforced Buna-N		
Stem & Seat O-rings	Buna-N		
Stem	304 Stainless Steel		
Stem Spring	302 Stainless Steel		
Fasteners	18-8 Stainless Steel		
Coating	NSF 61 Approved Fusion Epoxy		

MATERIAL (Optional)

COMPONENT	VALVE SIZE		
	1-1/4" - 4"	6" - 10"	12" - 36"
Seat Ring & Seat Plate	Unleaded Bronze		
Stem Bushings	316 Stainless Steel		
Seat Seal	EPDM / Viton (Limited Sizes)		
Diaphragm	EPDM / Viton (Limited Sizes)		
Stem & Seat O-rings	EPDM / Viton		

OPERATING TEMPERATURE (Maximum)

SEAL MATERIAL	BUNA-N	EPDM	VITON
Max Temp ° F	180° F	225° F	350° F

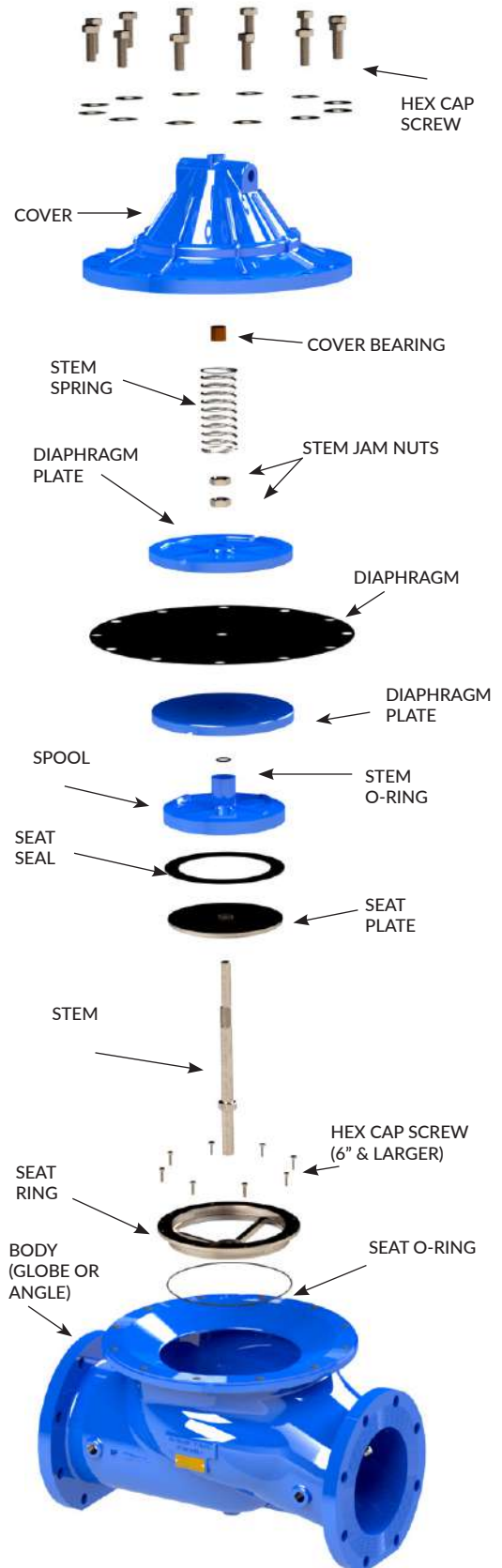

VALVE DIMENSIONS

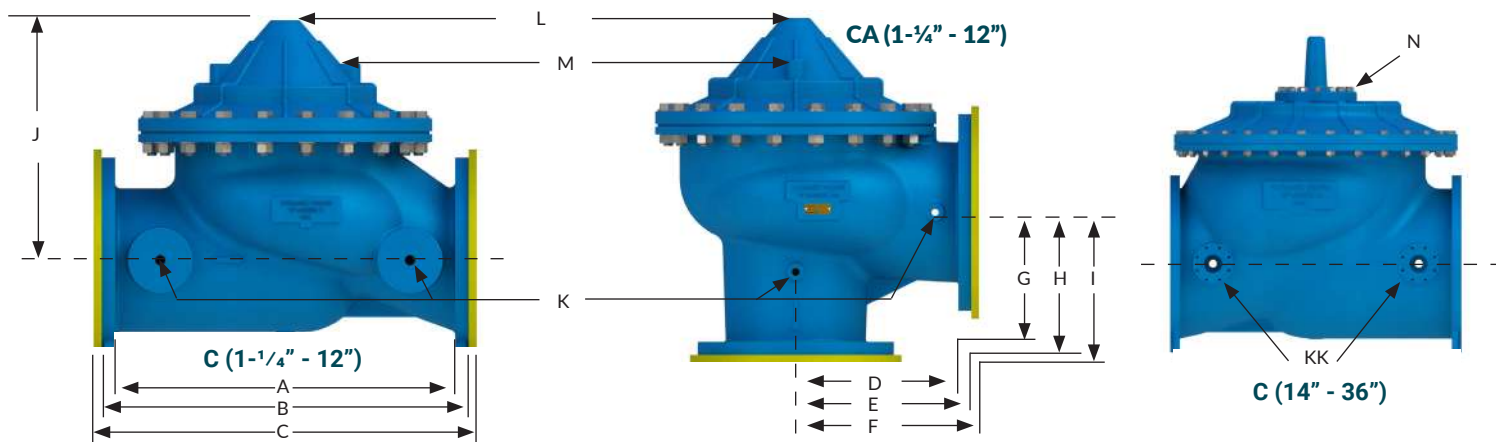

VALVE SIZE (INCHES)		1-1/4	1-1/2	2	2-1/2	3	4	6	8	10	12	14	16	18	20	24	30	36
A	Globe Grooved	8.50	8.50															
A	Globe Threaded	7.25	7.25	9.38														
B	Globe 150#		8.50	9.38	11.00	12.00	15.00	20.00	25.38	29.75	34.00	39.00	41.38	46.00	52.00	61.50	63.75	76.00
C	Globe 300#		9.13	10.00	11.63	13.25	15.38	21.00	26.38	31.13	35.50	40.50	43.50	47.63	53.63	63.24	65.50	76.00
D	Angle Threaded	3.25	3.25	4.75														
E	Angle 150#		4.00	4.75	5.50	6.00	7.50	10.00	12.75		17.00							
F	Angle 300#			5.00		6.38	7.81	10.50	13.25		17.75							
G	Angle Threaded	1.88	1.88	3.25														
H	Angle 150#		4.00	3.25	4.00	4.00	5.00	6.00	8.00		13.75							
I	Angle 300#			3.50		4.38	5.31	6.50	8.50		14.50							
J	Cover to Center	5.75	5.75	4.69	6.38	6.44	8.00	15.81	17.06	17.19	19.50	24.00	29.25	39.00	42.00	44.00	49.75	62.00
K	Body Tapping (NPT)	3/8	3/8	3/8	3/8	3/8	3/8	3/8	3/8	3/8	1	1	1	1	1	1	1-1/2	2
KK	Body Flange (ANSI 300#)										1-1/4	2	2	2	2	2	4	4
L	Cover Center Port (NPT)	1/4	1/4	1/2	1/2	1/2	1/2	1/2	1/2	1/2	1/2	1/2	3/4	3/4	3/4	3/4	1-1/2	1-1/2
M	Cover Port Size (NPT)	3/8	3/8	3/8	3/8	3/8	3/8	3/8	3/8	3/8	3/4	3/4	3/4	3/4	1	1	1-1/2	1-1/2
N	Cover Flange (ANSI 300#)											3	4	4	6	8	10	12
Approx. Ship Wt. (Pounds)		16	16	24	57	59	127	303	500	815	1040	1360	1750	2535	3315	5270	8034	12223

VALVE SIZE (MM)		32	40	50	65	80	100	150	200	250	300	350	400	450	500	600	750	900
A	Globe Grooved	216	216															
A	Globe Threaded	184	184	238														
B	Globe 150#		216	238	279	305	381	508	645	756	864	991	1051	1168	1321	1562	1619	1930
C	Globe 300#		232	254	295	337	391	533	670	791	902	1029	1105	1210	1362	1606	1664	1930
D	Angle Threaded	83	83	121														
E	Angle 150#		102	121	140	152	191	254	324		432							
F	Angle 300#			127		162	198	267	337		451							
G	Angle Threaded	48	48	83														
H	Angle 150#		102	83	102	102	127	152	203		349							
I	Angle 300#			89		111	135	165	216		368							
J	Cover to Center	146	146	119	162	164	203	402	433	437	495	610	743	991	1067	1118	1264	1575
K	Body Tapping (NPT)	3/8	3/8	3/8	3/8	3/8	3/8	3/8	3/8	3/8	1	1	1	1	1	1	1-1/2	2
KK	Body Flange (ANSI 300#)										1-1/4	2	2	2	2	2	4	4
L	Cover Center Port (NPT)	1/4	1/4	1/2	1/2	1/2	1/2	1/2	1/2	1/2	1/2	1/2	3/4	3/4	3/4	3/4	1-1/2	1-1/2
M	Cover Port Size (NPT)	3/8	3/8	3/8	3/8	3/8	3/8	3/8	3/8	3/8	3/4	3/4	3/4	3/4	1	1	1-1/2	1-1/2
N	Cover Flange (ANSI 300#)											3	4	4	6	8	10	12
LBS.	Approx. Ship Wt. (Kgs.)	7	7	11	26	27	58	137	227	370	472	617	794	1150	1504	2390	3644	5544

AVAILABLE SIZES AND TECHNICAL DATA

AVAILABLE SIZES

U.S. System: CV = U.S. GPM @ 1 PSI Differential with 60° F Water
Metric System: Cv = LPS @ 1 kPa with 15° C Water
Equivalent Lengths of Pipe are determined from the formula: $L = Kd/12f$

VALVE SIZE	Inches	1.5	2	2.5	3	4	6	8	10	12	14	16	18	20	24	30	36
	mm	40	50	65	80	100	150	200	250	300	350	400	450	500	600	750	900
CV FACTOR	Gal/Min	29	48	110	110	205	462	980	1165	1234	2546	3465	4125	5917	9000	12000	16500
	Liters/Sec	1.83	2.96	6.94	6.94	12.93	29.15	61.8	73.5	103.34	160.63	218.6	260.25	373.31	567.82	757.1	1041.01
EQUIVALENT LENGTH OF PIPE	Feet	42	57	70	85	113	170	228	286	338	395	450	513	569	683	932	1118
	Meters	12.8	17.4	21.3	25.9	34.4	51.8	69.5	87.2	103	120.4	137.2	156.4	173.4	208.2	284	340.8

HEADLOSS CHART

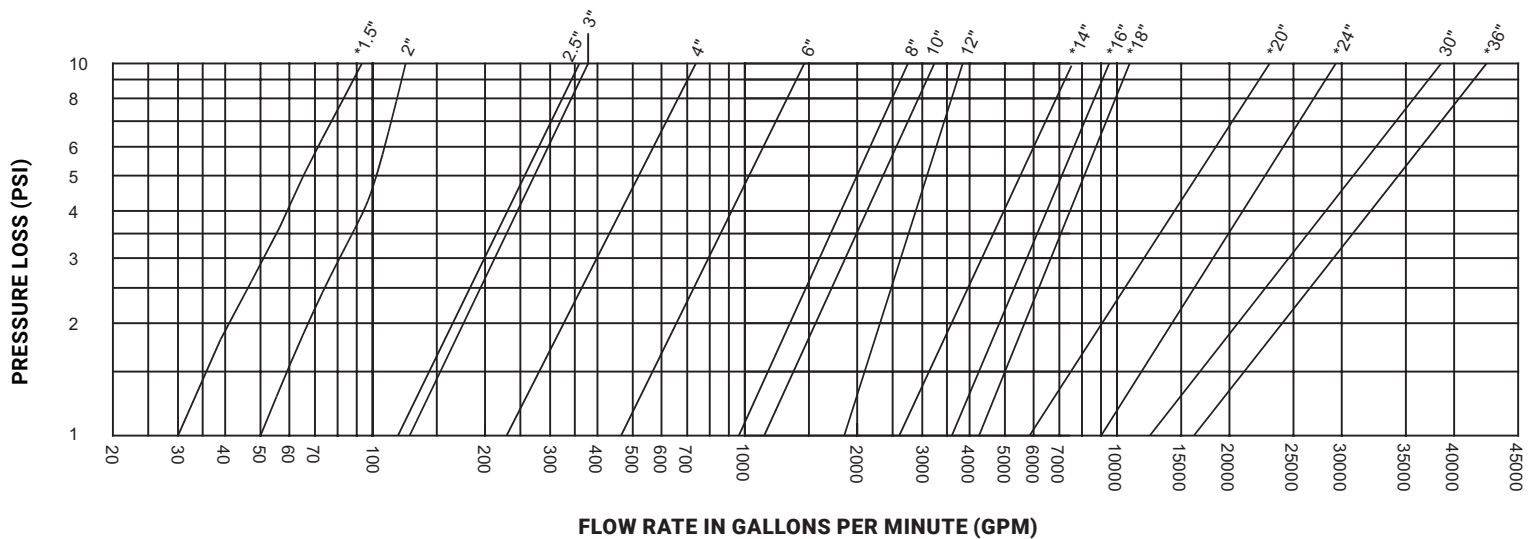

CAVITATION CHART (Inlet Pressure VS. Outlet Pressure)

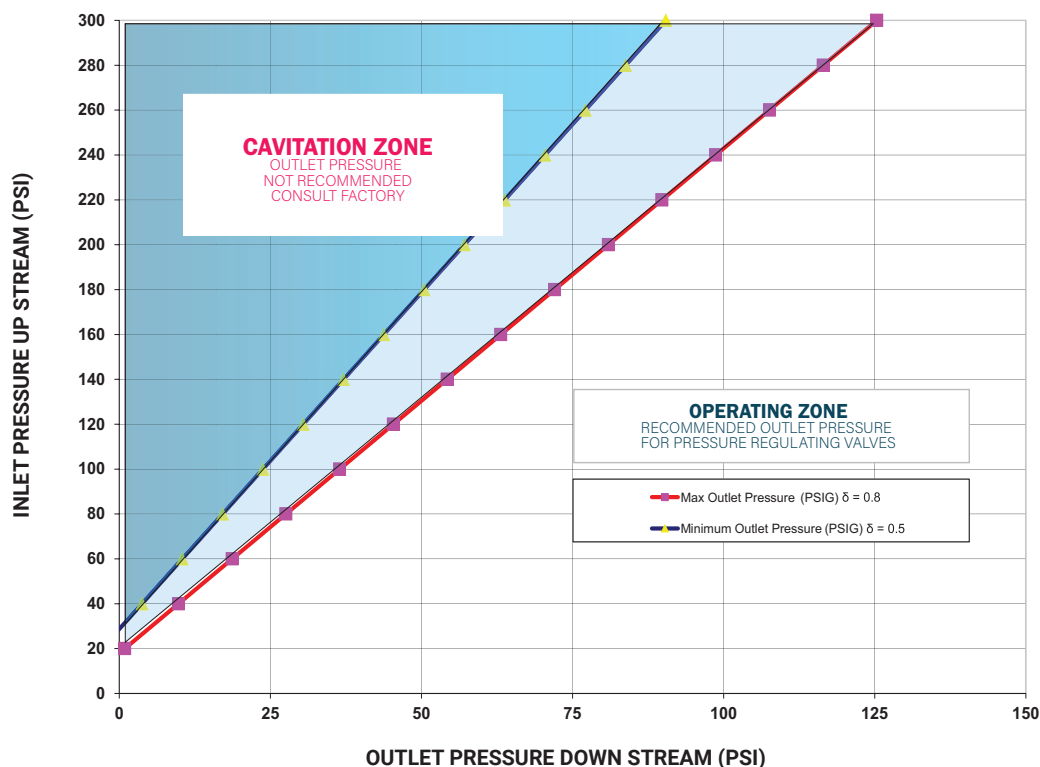

MODEL C & CA

IMPORTANT FEATURES



AIR BLEED VALVE

CORROSION RESISTANT
302 SS SPRING

FUSION BONDED EPOXY
LINED & COATED
DUCTILE IRON BODY

CORROSION RESISTANT
304 SS STEM
FULLY GUIDED TOP AND BOTTOM

ALL 316 SS FASTENERS AND
HARDWARE FOR EASE OF
MAINTENANCE

JACK SCREWS FOR
EASY BONNET REMOVAL

NYLON REINFORCED BUNA-N EPDM OR
VITON DIAPHRAGMS AVAILABLE. FULLY
SUPPORTED DIAPHRAGMS REDUCE
FATIGUE ALLOWING FOR LONGER
LIFETIME

316 SS
SEAT RING

BODY DRAIN
PLUG

EASY REMOVAL AND DISASSEMBLY
OF INNER VALVE SPOOL ASSEMBLY

IN-LINE SERVICE:
REPLACEABLE SEAT AND INTERNALS
WITHOUT REMOVING VALVE FROM
PIPELINE

FLOMATIC CONTROL VALVES

2020 PRICING

Pilot operated control valves designed and built in compliance with AWWA C530 standards. NSF/ANSI 61 approved fusion boded epoxy coated ductile iron globe or angle style bodies in full or reduced port configuration. Valves are fitted with various pilot control systems to control conditions in pressurized pipeline systems.

Many other models and features available please consult factory and/or our expanded control valve price catalogue for more details.



MODEL C000 BASIC VALVE ASSEMBLY

SIZE (INCHES)	THREADED 400#	CF FLANGED 150#	C/CA FLANGED 150#	C/CA FLANGED 300#
1-1/4"	\$673	-	\$833	\$894
1-1/2"	\$687	-	\$850	\$912
2"	\$715	-	\$901	\$959
2-1/2"	\$1,053	-	\$1,097	\$1,306
3"	\$1,077	-	\$1,208	\$1,331
4"	-	\$1,754	\$2,076	\$2,283
6"	-	\$2,456	\$3,387	\$3,725
8"	-	\$3,970	\$6,232	\$6,855
10"	-	\$7,025	\$8,633	\$9,498
12"	-	\$12,534	\$14,789	\$15,423
14"	-	Consult Factory	Consult Factory	Consult Factory
16"	-	Consult Factory	Consult Factory	Consult Factory
18"	-	Consult Factory	Consult Factory	Consult Factory
20"	-	Consult Factory	Consult Factory	Consult Factory
24"	-	Consult Factory	Consult Factory	Consult Factory
30"	-	Consult Factory	Consult Factory	Consult Factory
36"	-	Consult Factory	-	-

- Control tubing isolation valves
- Body drain plug
- Test cocks on backside of valve
- All SS fasteners
- Jack screw cover and seat ring (6" and up)
- Indicator rod assembly (6" and up)
- Air bleed valve on main valve cover
- Copper control tubing
- SS Seat/Stem/Ring

AVAILABLE BODY OPTIONS



MODEL C
FULL PORT GLOBE STYLE
(Flanged or Threaded)



MODEL CF
REDUCED PORT GLOBE STYLE
(Flanged or Threaded)



MODEL CA
ANGLE BODY STYLE
(Flanged or Threaded)

AVAILABLE SERIES

- Pressure Reducing
- Modulating Altitude Valve
- Non-Modulating Altitude Valve
- Back Pressure Sustaining Valve
- Pressure Relief Valve
- Surge Arrestor Valve
- Pump Control Valve
- Pilot Operated Float Valve
- Solenoid Control Valve
- Flow Control
- Hydraulic Check Valve

POPULAR OPTIONS

- Built-In Check Feature
- Stainless Steel Pilots
- Electronic Controls
- Position Indicator (Standard 6" and up)
- Solenoid Override

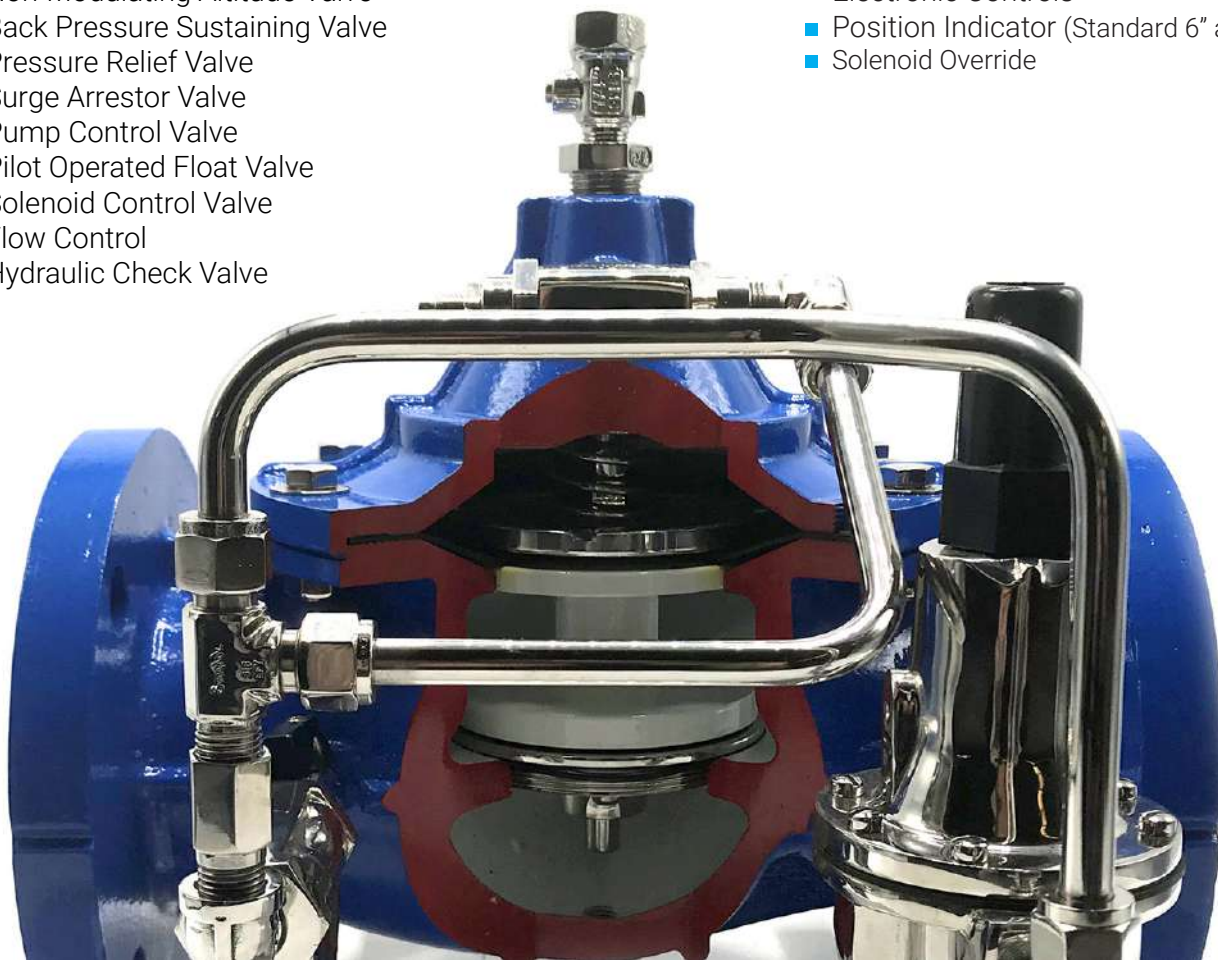



MODEL C100 MINI HYDRAULIC CONTROL VALVE

Water or Air operated. Temp Max: 180° F (80° C) and Pressure Max: 400 PSI (27.5 Bar)

SIZE	PART NUMBER	WEIGHT (LBS)	LIST PRICE
3/8"	C000AAA	2	\$194
1/2"	C000AA	2	\$220
3/4"	C000AA	3	\$234
1"	C000A	5	\$240
1 1/4"	C000B	5	\$259



MODEL C101/CF101 PRESSURE REDUCING

Pressure reducing valve. Automatically reduces higher unregulated upstream pressure to a lower steady downstream pressure (adjustable) regardless of fluctuations in inlet pressure or flow.

SIZE (INCHES)	THREADED 400#	CF FLANGED 150#	C/CA FLANGED 150#	C/CA FLANGED 300#
1-1/4"	\$1,572	-	\$1,679	\$1,933
1-1/2"	\$1,600	-	\$1,712	\$1,972
2"	\$1,611	-	\$2,032	\$2,125
2-1/2"	\$2,008	-	\$2,131	\$2,417
3"	\$2,151	-	\$2,180	\$2,465
4"	-	\$2,231	\$2,804	\$3,027
6"	-	\$3,384	\$4,428	\$4,790
8"	-	\$5,484	\$7,426	\$8,094
10"	-	\$8,039	\$10,056	\$11,003
12"	-	\$12,984	\$16,215	\$17,267
14", 16", 18", 20", 24", 30", 36"	POA - Consult Factory			



MODEL C101B/CF101B PRESSURE REDUCING WITH LOW FLOW BY-PASS

Pressure reducing valve with low flow by-pass. Automatically reduces higher unregulated upstream pressure to a lower steady downstream pressure (adjustable) regardless of fluctuations in inlet pressure or flow. The low flow by-pass is accomplished by using the Model C150E as a primary part of the main valve.

SIZE (INCHES)	THREADED 400#	CF FLANGED 150#	C/CA FLANGED 150#	C/CA FLANGED 300#
2"	\$2,360	-	\$2,801	\$2,897
2-1/2"	\$2,775	-	\$2,905	\$3,204
3"	\$2,925	-	\$2,957	\$3,254
4"	-	\$3,023	\$3,610	\$3,843
6"	-	\$4,230	\$5,311	\$5,690

Standard includes 3/4" Model C150E as bypass Consult factory for larger sizes



MODEL **C103/CF103**

PRESSURE REDUCING WITH EXTERNAL CHECK FEATURE

Pressure reducing valve with external check feature. Same features as C101 with the added safety of a check valve feature which will close the valve and prevent reverse flow in the event of pressure reversal.

SIZE (INCHES)	THREADED 400#	CF FLANGED 150#	C/CA FLANGED 150#	C/CA FLANGED 300#
1-1/4"	\$1,885	-	\$1,990	\$2,239
1-1/2"	\$1,912	-	\$2,025	\$2,285
2"	\$1,924	-	\$2,344	\$2,437
2-1/2"	\$2,320	-	\$2,444	\$2,729
3"	\$2,463	-	\$2,493	\$2,778
4"	-	\$2,428	\$3,116	\$3,340
6"	-	\$3,526	\$4,740	\$5,102
8"	-	\$5,691	\$7,908	\$8,577
10"	-	\$8,125	\$10,515	\$11,463
12"	-	\$12,834	\$16,675	\$17,727
14", 16", 18", 20", 24", 30", 36"		POA - Consult Factory		



MODEL **C104/CF104**

PRESSURE REDUCING AND BACKPRESSURE SUSTAINING

Allows flow as long as upstream pressure exceeds backpressure setting. Maintains a lower steady downstream pressure regardless of fluctuations in the inlet pressure or flow, as long as backpressure on system is maintained.

SIZE (INCHES)	THREADED 400#	CF FLANGED 150#	C/CA FLANGED 150#	C/CA FLANGED 300#
1-1/4"	\$2,122	-	\$2,230	\$2,528
1-1/2"	\$2,148	-	\$2,267	\$2,606
2"	\$2,163	-	\$2,591	\$2,687
2-1/2"	\$2,566	-	\$2,689	\$2,976
3"	\$2,710	-	\$2,743	\$3,033
4"	-	\$3,209	\$3,378	\$3,604
6"	-	\$4,061	\$5,034	\$5,286
8"	-	\$6,053	\$8,235	\$8,917
10"	-	\$8,713	\$10,887	\$11,850
12"	-	\$14,512	\$17,163	\$18,236
14", 16", 18", 20", 24", 30", 36"		POA - Consult Factory		

MODEL C105/CF105 & C106/CF106

PRESSURE REDUCING WITH SOLENOID OVERRIDE

Same function as C101 with solenoid override. 105 - energize to open valve, 106 - energize to close valve.



SIZE (INCHES)	THREADED 400#	CF FLANGED 150#	C/CA FLANGED 150#	C/CA FLANGED 300#
1-1/4"	\$2,197	-	\$2,313	\$2,554
1-1/2"	\$2,233	-	\$2,346	\$2,606
2"	\$2,246	-	\$2,666	\$2,758
2-1/2"	\$2,642	-	\$2,765	\$3,050
3"	\$2,785	-	\$2,815	\$3,099
4"	-	\$2,877	\$3,438	\$3,661
6"	-	\$4,030	\$5,061	\$5,424
8"	-	\$6,130	\$8,060	\$8,729
10"	-	\$8,684	\$10,659	\$11,607
12"	-	\$14,013	\$16,819	\$17,871
14", 16", 18", 20", 24", 30", 36"		POA - Consult Factory		

* Price subject to change based on solenoid requirements

MODEL C201/CF201

MODULATING ALTITUDE VALVE - SINGLE ACTING FOR 1-WAY FLOW

Single acting modulating altitude valve. Closes at a preset maximum water level to prevent overflow of a ground storage tank or reservoir and opens to refill when the water level in the tank or reservoir lowers. The modulating effect is evident only over the last few inches of filling so that a very gradual closure is achieved. Because of this modulating effect, the filling rate will be relatively slow as the tank or reservoir water level approaches shut off elevation.



SIZE (INCHES)	THREADED 400#	CF FLANGED 150#	C/CA FLANGED 150#	C/CA FLANGED 300#
1-1/4"	\$3,887	-	\$4,125	\$4,386
1-1/2"	\$3,967	-	\$4,476	\$4,788
2"	\$4,371	-	\$4,955	\$5,302
2-1/2"	\$4,734	-	\$5,015	\$5,243
3"	\$5,134	-	\$5,870	\$6,279
4"	-	\$6,220	\$7,263	\$7,772
6"	-	\$7,954	\$9,944	\$10,642
8"	-	\$10,746	\$10,972	\$11,739
10"	-	\$14,012	\$16,681	\$17,848
12"	-	\$16,307	\$16,819	\$17,871
14", 16", 18", 20", 24", 30", 36"		POA - Consult Factory		



MODEL **C203/CF203**

MODULATING ALTITUDE AND BACKPRESSURE SUSTAINING VALVE SINGLE ACTING FOR 1-WAY FLOW

Same function as C201. Only allows flow when upstream pressure exceeds backpressure setting.

SIZE (INCHES)	THREADED 400#	CF FLANGED 150#	C/CA FLANGED 150#	C/CA FLANGED 300#
1-1/4"	\$4,550	-	\$4,788	\$5,049
1-1/2"	\$4,630	-	\$5,139	\$5,451
2"	\$5,034	-	\$5,618	\$5,965
2-1/2"	\$5,397	-	\$5,678	\$5,906
3"	\$5,797	-	\$6,533	\$6,942
4"	-	\$6,970	\$8,013	\$8,522
6"	-	\$8,704	\$10,694	\$11,392
8"	-	\$11,496	\$11,722	\$12,489
10"	-	\$14,762	\$17,431	\$18,598
12"	-	\$17,057	\$17,569	\$18,621
14", 16", 18", 20", 24", 30", 36"		POA - Consult Factory		



MODEL **C205/CF205**

NON-MODULATING ALTITUDE SINGLE ACTING FOR 1-WAY FLOW

Single acting non-modulating altitude valve for 1-way flow. Closes at a preset maximum water level to prevent overflow of a standpipe, elevated tank, or reservoir and opens to refill when the water level lowers. As a non-modulating altitude valve, it is either fully open or fully closed.

SIZE (INCHES)	THREADED 400#	CF FLANGED 150#	C/CA FLANGED 150#	C/CA FLANGED 300#
1-1/4"	\$3,980	-	\$4,268	\$4,437
1-1/2"	\$4,061	-	\$4,355	\$4,528
2"	\$4,476	-	\$4,583	\$4,766
2-1/2"	\$4,848	-	\$5,075	\$5,276
3"	\$5,258	-	\$5,137	\$5,341
4"	-	\$5,661	\$6,009	\$6,243
6"	-	\$6,369	\$7,439	\$7,732
8"	-	\$8,146	\$10,695	\$11,116
10"	-	\$11,005	\$11,237	\$11,680
12"	-	\$16,698	\$17,277	\$17,761
14", 16", 18", 20", 24", 30", 36"		POA - Consult Factory		



MODEL **C207/CF207**

NON-MODULATING ALTITUDE VALVE W/DELAYED OPENING SINGLE ACTING FOR 1-WAY FLOW

Same function as C205. Allows for a drop in tank level before opening to refill.

SIZE (INCHES)	THREADED 400#	CF FLANGED 150#	C/CA FLANGED 150#	C/CA FLANGED 300#
1-1/4"	\$5,093	-	\$5,407	\$5,584
1-1/2"	\$5,196	-	\$5,517	\$5,698
2"	\$5,303	-	\$5,630	\$5,814
2-1/2"	\$5,896	-	\$6,122	\$6,322
3"	\$6,305	-	\$6,480	\$6,692
4"	-	\$6,728	\$7,055	\$7,290
6"	-	\$7,435	\$8,487	\$8,779
8"	-	\$9,213	\$11,183	\$11,585
10"	-	\$12,072	\$12,234	\$12,678
12"	-	\$17,766	\$18,274	\$18,889
14", 16", 18", 20", 24", 30", 36"		POA - Consult Factory		



MODEL **C209/CF209**

NON-MODULATING ALTITUDE VALVE DOUBLE ACTING FOR 2-WAY FLOW

Same as 205. Will open to allow reverse flow back to the system if the inlet pressure drops below the tank head pressure.

SIZE (INCHES)	THREADED 400#	CF FLANGED 150#	C/CA FLANGED 150#	C/CA FLANGED 300#
1-1/4"	\$4,802	-	\$4,904	\$4,577
1-1/2"	\$4,900	-	\$5,004	\$4,671
2"	\$5,000	-	\$5,106	\$4,766
2-1/2"	\$5,371	-	\$5,599	\$5,799
3"	\$5,781	-	\$5,931	\$6,144
4"	-	\$6,194	\$6,533	\$6,767
6"	-	\$6,903	\$7,963	\$8,255
8"	-	\$8,679	\$11,218	\$11,640
10"	-	\$11,538	\$12,322	\$12,788
12"	-	\$17,231	\$17,775	\$18,260
14", 16", 18", 20", 24", 30", 36"		POA - Consult Factory		



MODEL **C301/CF301**

BACK PRESSURE SUSTAINING

Backpressure sustaining valve. Installed directly in the main line. Maintains a minimum upstream pressure (backpressure) regardless of change in demand downstream.

SIZE (INCHES)	THREADED 400#	CF FLANGED 150#	C/CA FLANGED 150#	C/CA FLANGED 300#
1-1/4"	\$1,648	-	\$1,912	\$1,972
1-1/2"	\$1,658	-	\$1,951	\$2,012
2"	\$1,697	-	\$1,986	\$2,079
2-1/2"	\$2,109	-	\$2,256	\$2,409
3"	\$2,179	-	\$2,437	\$2,549
4"	-	\$2,606	\$3,291	\$3,509
6"	-	\$3,627	\$4,841	\$5,201
8"	-	\$5,699	\$7,918	\$8,583
10"	-	\$8,385	\$10,420	\$11,343
12"	-	\$13,995	\$16,163	\$16,822
14", 16", 18", 20", 24", 30", 36"		POA - Consult Factory		



MODEL **C302/CF302**

BACK PRESSURE SUSTAINING WITH EXTERNAL CHECK FEATURE

Same as C301 with added safety of a check valve feature which will close the valve and prevent reverse flow in the event of a pressure reversal.

SIZE (INCHES)	THREADED 400#	CF FLANGED 150#	C/CA FLANGED 150#	C/CA FLANGED 300#
1-1/4"	\$2,029	-	\$2,284	\$2,345
1-1/2"	\$2,039	-	\$2,331	\$2,393
2"	\$2,077	-	\$2,366	\$2,460
2-1/2"	\$2,490	-	\$2,637	\$2,790
3"	\$2,560	-	\$2,817	\$2,928
4"	-	\$2,994	\$3,672	\$3,889
6"	-	\$4,013	\$5,222	\$5,581
8"	-	\$6,147	\$8,358	\$9,023
10"	-	\$8,833	\$10,839	\$11,762
12"	-	\$14,444	\$16,581	\$17,241
14", 16", 18", 20", 24", 30", 36"		POA - Consult Factory		



MODEL **C303/CF303 & C304/CF304**

BACK PRESSURE SUSTAINING WITH SOLENOID OVERRIDE

303 - ENERGIZE TO OPEN VALVE, 304 - ENERGIZE TO CLOSE VALVE

Same as C301 with solenoid override.

SIZE (INCHES)	THREADED 400#	CF FLANGED 150#	C/CA FLANGED 150#	C/CA FLANGED 300#
1-1/4"	\$2,283	-	\$2,533	\$2,593
1-1/2"	\$2,292	-	\$2,585	\$2,646
2"	\$2,331	-	\$2,620	\$2,713
2-1/2"	\$2,743	-	\$2,891	\$3,043
3"	\$2,813	-	\$3,070	\$3,183
4"	-	\$3,253	\$3,925	\$4,142
6"	-	\$4,273	\$5,475	\$5,835
8"	-	\$6,345	\$8,551	\$9,217
10"	-	\$9,031	\$11,024	\$11,947
12"	-	\$13,683	\$16,766	\$17,425
14", 16", 18", 20", 24", 30", 36"		POA - Consult Factory		

* Price subject to change based on solenoid requirements



MODEL **C306/CF306**

DIFFERENTIAL BACK PRESSURE VALVE

Modulates to maintain a constant pressure differential between any 2 points in a system.

SIZE (INCHES)	THREADED 400#	CF FLANGED 150#	C/CA FLANGED 150#	C/CA FLANGED 300#
1-1/4"	\$1,675	-	-	-
1-1/2"	\$1,842	-	\$2,048	\$2,107
2"	\$1,882	-	\$2,082	\$2,174
2-1/2"	\$2,316	-	\$2,351	\$2,503
3"	\$2,365	-	\$2,533	\$2,645
4"	-	\$2,836	\$3,395	\$3,616
6"	-	\$3,907	\$4,930	\$5,289
8"	-	\$6,079	\$8,000	\$8,664
10"	-	\$8,891	\$10,808	\$11,528
12"	-	\$14,769	\$17,027	\$18,452
14", 16", 18", 20", 24", 30", 36"		POA - Consult Factory		

* Price subject to change based on solenoid requirements



MODEL C401/CF401 PRESSURE RELIEF VALVE

Pressure relief valve. Mounted in a tee off of the main pipeline. Protects against system over-pressure in pump stations, distribution systems and transmission mains by relieving high pressure to waste.

SIZE (INCHES)	THREADED 400#	CF FLANGED 150#	C/CA FLANGED 150#	C/CA FLANGED 300#
1-1/4"	\$1,648	-	\$1,912	\$1,972
1-1/2"	\$1,658	-	\$1,951	\$2,012
2"	\$1,697	-	\$1,986	\$2,079
2-1/2"	\$2,109	-	\$2,256	\$2,409
3"	\$2,179	-	\$2,437	\$2,549
4"	-	\$2,606	\$3,291	\$3,509
6"	-	\$3,627	\$4,841	\$5,201
8"	-	\$5,699	\$7,918	\$8,583
10"	-	\$8,385	\$10,420	\$11,343
12"	-	\$13,995	\$16,163	\$16,822
14", 16", 18", 20", 24", 30", 36"		POA - Consult Factory		



MODEL C501/CF501 SURGE ARRESTOR

Surge anticipating valve. Mounted in a tee off of the main pipeline. Remains closed under normal system operating conditions. Protects pumping systems and long distribution pipelines from pressure surges caused by abrupt changes in flow velocity. Valve will begin to open upon initial low pressure wave in anticipation of the high pressure surge.

SIZE (INCHES)	THREADED 400#	CF FLANGED 150#	C/CA- FLANGED 150#	C/CA- FLANGED 300#
1-1/4"	\$4,049	-	\$4,808	\$5,079
1-1/2"	\$4,131	-	\$4,906	\$5,183
2"	\$4,702	-	\$5,163	\$5,455
2-1/2"	\$5,149	-	\$5,476	\$5,760
3"	\$5,203	-	\$5,493	\$5,780
4"	-	\$5,652	\$5,853	\$6,062
6"	-	\$6,438	\$7,218	\$7,558
8"	-	\$8,319	\$10,084	\$10,715
10"	-	\$11,086	\$12,962	\$13,837
12"	-	\$17,250	\$19,059	\$19,718
14", 16", 18", 20", 24", 30", 36"		POA-Consult Factory		



MODEL **C601/CF601** PUMP CONTROL VALVE – SINGLE CHAMBER

Flomatic pump control valves are pilot operated valves designed for installation on the discharge of booster pump systems to eliminate pressure surges upon pump startup and shutdown. The Model 601 pump control valve allows for adaptation of supplemental modulating features (see below). With no additional modulating features it should be noted that initial closing speed will be slow due to low pressure differential across the valve. Under this condition the Model C611 should be utilized.

SIZE (INCHES)	CF FLANGED 150#	C FLANGED 150#	C FLANGED 300#
1-1/4"	-	\$3,906	\$4,152
1-1/2"	-	\$3,986	\$4,237
2"	-	\$4,313	\$4,625
2-1/2"	-	\$4,786	\$5,123
3"	-	\$5,064	\$5,570
4"	\$5,409	\$5,598	\$6,415
6"	\$6,745	\$7,527	\$8,053
Consult Factory for this configuration			

Additional models (consult factory for pricing):

C603 – Pump Control with Backpressure Sustaining Feature

C604 – Pump Control with Pressure Reducing Feature

C605 – Pump Control with Backpressure Sustaining and Pressure Reducing Features

OPTIONS: External Check or Built-in Check Feature



MODEL **C611/CF611** PUMP CONTROL VALVE – DUAL CHAMBER W/ INTERNAL DROP CHECK

Booster pump control valve with dual power chamber and internal drop check feature. Mounted in-line with pump discharge. Protects system against pressure surges associated with the starting and stopping of pumps. Should a catastrophic event occur, such as power failure or locked motor, the internal drop check feature will close as soon as flow stops preventing reverse flow regardless of main valve diaphragm assembly position.

SIZE (INCHES)	CF FLANGED 150#	C FLANGED 150#	C FLANGED 300#
3"	-	\$7,184	\$7,690
4"	\$7,569	\$7,720	\$8,542
6"	\$8,973	\$9,694	\$10,307
8"	\$11,141	\$13,284	\$13,995
10"	\$17,003	\$19,722	\$21,827
12"	\$23,950	\$24,912	\$26,514
14", 16", 18", 20", 24", 30", 36"	POA - Consult Factory		



MODEL C621/CF621 DEEP WELL PUMP CONTROL VALVE

Deep well pump control valves are utilized to eliminate pipeline pressure surges during pump startup and shut down. The valve is installed off line, discharging to atmosphere. The pump starts against an open valve. When energized, the solenoid switches and begins to slowly close the valve as air and sediment is discharged to atmosphere. This results in a slow and controlled increase in pipeline pressure.

Upon signal to shut down, the solenoid is de-energized resulting in a slow and controlled opening of the valve as the pump continues to run. As pressure in the main pipeline decreases, the main line check valve will begin to close. When the control valve has fully opened, discharging all pressure to atmosphere, a limit switch is tripped which disengages the pump starter.

SIZE (INCHES)	CF FLANGED 150#	C FLANGED 150#	C FLANGED 300#
3"	-	\$6,193	\$6,700
4"	\$6,560	\$6,728	\$7,545
6"	\$7,897	\$8,656	\$9,183
8"	\$9,737	\$11,907	\$12,616
10"	\$15,592	\$18,335	\$20,446
12"	\$22,560	\$24,688	\$26,370
14", 16", 18", 20", 24", 30", 36"	POA - Consult Factory		

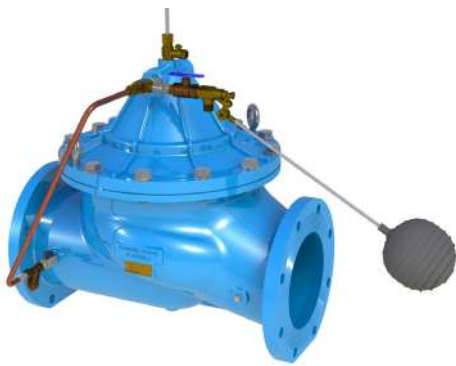

MODEL C701/CF701 FLOAT VALVE – HORIZONTAL (MODULATING)

A modulating level control Valve closes at high water levels to prevent overflow of a ground storage tank, basin or reservoir and opens to refill when the water level drops. Normally this valve is either full open or full closed, however the design characteristics of its controls causes the main valve diaphragm assembly to modulate (close slowly) over the last few inches of filling.

SIZE (INCHES)	THREADED 400#	CF FLANGED 150#	C/CA FLANGED 150#	C/CA FLANGED 300#
1-1/4"	\$1,953	-	\$2,064	\$2,306
1-1/2"	\$1,953	-	\$2,106	\$2,353
2"	\$1,987	-	\$2,409	\$2,497
2-1/2"	\$2,373	-	\$2,503	\$2,673
3"	\$2,415	-	\$2,549	\$2,766
4"	-	\$2,605	\$3,305	\$3,516
6"	-	\$3,701	\$4,669	\$5,010
8"	-	\$5,678	\$7,496	\$8,128
10"	-	\$8,085	\$9,974	\$10,850
12"	-	\$13,485	\$16,100	\$16,759
14", 16", 18", 20", 24", 30", 36"	POA - Consult Factory			



MODEL **C705/CF705**

FLOAT VALVE – VERTICAL (NON-MODULATING)

A non-modulating Level Control Valve which maintains the level in ground storage tank, basin or reservoir. The valve opens fully when the level falls a preset (adjustable) amount and closes tightly at the high water (adjustable) level.

SIZE (INCHES)	THREADED 400#	CF FLANGED 150#	C/CA FLANGED 150#	C/CA FLANGED 300#
1-1/4"	\$2,416	-	\$2,666	\$2,907
1-1/2"	\$2,465	-	\$2,721	\$2,966
2"	\$2,573	-	\$3,023	\$3,110
2-1/2"	\$2,597	-	\$3,117	\$3,287
3"	\$2,867	-	\$3,164	\$3,381
4"	-	\$3,455	\$3,893	\$4,121
6"	-	\$4,327	\$5,284	\$5,625
8"	-	\$6,303	\$8,110	\$8,743
10"	-	\$8,710	\$10,559	\$11,434
12"	-	\$14,111	\$16,685	\$17,344
14", 16", 18", 20", 24", 30", 36"		POA - Consult Factory		



MODEL **C801/CF801 & C802/CF802**

SOLENOID CONTROL VALVE

801 - NORMALLY CLOSED, 802 - NORMALLY OPEN

Solenoid controlled valve. Responds to an electrical signal to provide on/off operation. The valve is available with the main valve closed when the solenoid is de-energized (C801) or with the main valve open when the solenoid is de-energized (C802). closing speed will be slow due to low pressure differential across the valve.

SIZE (INCHES)	THREADED 400#	CF FLANGED 150#	C/CA FLANGED 150#	C/CA FLANGED 300#
1-1/4"	\$1,953	-	\$2,064	\$2,306
1-1/2"	\$1,953	-	\$2,106	\$2,353
2"	\$1,987	-	\$2,409	\$2,497
2-1/2"	\$2,373	-	\$2,503	\$2,673
3"	\$2,395	-	\$2,549	\$2,766
4"	-	\$2,605	\$3,305	\$3,516
6"	-	\$3,701	\$4,669	\$5,010
8"	-	\$5,678	\$7,496	\$8,128
10"	-	\$8,085	\$9,974	\$10,850
12"	-	\$13,485	\$16,100	\$16,759
14", 16", 18", 20", 24", 30", 36"		POA - Consult Factory		

* Price subject to change based on solenoid requirements. Price includes standard 3-way 110VAC 60 Hz solenoid with 150 psi max. differential pressure.

Upon each cycle of the solenoid valve, a volume of water equal to the capacity of the area over the diaphragm will be discharged out of the solenoid exhaust. Provisions should be made to discharge the water to drain. An air gap should be utilized to prevent any potential for cross-contamination.

MODEL **C901/CF901**

MAX RATE OF FLOW CONTROL VALVE

Maximum rate of flow control valve. Limits flow in a pipeline to a maximum rate regardless of fluctuations in upstream pressure and flow.



SIZE (INCHES)	CF FLANGED 150#	C FLANGED 150#	C FLANGED 300#
2"	-	\$2,519	\$2,584
2 1/2"	-	\$3,638	\$3,883
3"	-	\$3,760	\$3,902
4"	\$3,320	\$4,489	\$4,700
6"	\$4,895	\$5,999	\$6,341
8"	\$7,053	\$9,052	\$9,683
10"	\$9,187	\$11,884	\$12,763
12"	\$14,597	\$17,472	\$18,131
14", 16", 18", 20", 24", 30", 36"		POA - Consult Factory	



MODEL **C902/CF902**

MAX RATE OF FLOW AND PRESSURE REDUCING

Same as C901 with threaded feature of a reduced steady downstream pressure regardless of fluctuations in inlet pressure or flow.

SIZE (INCHES)	CF FLANGED 150#	C FLANGED 150#	C FLANGED 300#
2"	-	\$3,056	\$3,126
2 1/2"	-	\$4,151	\$4,408
3"	-	\$4,278	\$4,429
4"	\$3,823	\$5,045	\$5,267
6"	\$5,476	\$6,630	\$6,989
8"	\$7,745	\$9,834	\$10,499
10"	\$9,984	\$12,794	\$13,717
12"	\$15,136	\$18,076	\$19,353
14", 16", 18", 20", 24", 30", 36"	POA - Consult Factory		



MODEL **C903/CF903 & C904/CF904**

MAX RATE OF FLOW W/SOLENOID OVERRIDE

903 - NORMALLY OPEN, 904 - NORMALLY CLOSED

Same as C901 with solenoid override.

SIZE (INCHES)	CF FLANGED 150#	C FLANGED 150#	C FLANGED 300#
2"	-	\$3,149	\$3,218
2 1/2"	-	\$4,271	\$4,515
3"	-	\$4,393	\$4,536
4"	\$3,965	\$5,123	\$5,333
6"	\$5,723	\$6,812	\$7,156
8"	\$7,884	\$9,865	\$10,498
10"	\$10,017	\$12,659	\$13,539
12"	\$15,426	\$18,075	\$18,907
14", 16", 18", 20", 24", 30", 36"	POA - Consult Factory		



MODEL **C1001/CF1001** HYDRAULIC CHECK VALVE

Hydraulic check valve. Permits one-way flow through the valve with adjustable opening and closing speeds. Upon pressure reversal the valve will close tight.

SIZE (INCHES)	THREADED 400#	CF FLANGED 150#	C/CA FLANGED 150#	C/CA FLANGED 300#
1-1/4"	\$1,384	-	\$1,463	\$1,704
1-1/2"	\$1,413	-	\$1,493	\$1,739
2"	\$1,498	-	\$1,794	\$1,883
2-1/2"	\$1,816	-	\$1,941	\$2,204
3"	\$1,926	-	\$2,045	\$2,307
4"	-	\$2,117	\$2,665	\$2,875
6"	-	\$3,289	\$4,055	\$4,396
8"	-	\$5,405	\$7,277	\$7,909
10"	-	\$7,980	\$9,389	\$10,265
12"	-	\$13,759	\$15,695	\$16,354
14", 16", 18", 20", 24", 30", 36"		POA - Consult Factory		

CONTROL VALVE OPTIONS

DESCRIPTION AND ADDER

OPTION DESCRIPTION	VALVE SIZE	2020 LIST PRICE ADDER
External Hydraulic Check	1 1/2" - 6"	\$345.00
	8" - 12"	\$525.00
	14" - 36"	Consult Factory
SS - Hard piping (Stainless Steel Pilot Piping)		List + 10%
SS - Braided piping		List + 15%
EPDM elastomers (NSF Approved)		Consult Factory
Viton Elastomers		Consult Factory
Double Epoxy Coating		Consult Factory
Position Indicator Rod, 1 1/2-4" (6" and up Standard)		\$225
% Open Indicator	1 1/2" - 4"	\$175.00
	6" - 12"	\$239.00
	14" - 36"	Consult Factory
Opening/Closing Speed Control	1 1/2" - 12"	\$298
	14" - 36"	Consult Factory
Solenoid Override (NO or NC)	1 1/2" - 36"	Consult Factory
Pressure gauge (2 1/2") installed on valve (per 2)	1 1/2" - 12"	\$50
	14" - 36"	Consult Factory
Limit Switch Assembly		
SPDT (Single Pole Double Throw)	1 1/4" - 4"	\$820.00
	6" - 12"	\$609.00
	16"	\$769.00
Dual SPDT	1 1/4" - 4"	\$1,371.00
	6" - 12"	\$1,218.00
	16"	\$1,628.00

CONTROL VALVE (ACV) Accessories





3/8" BPP
(Back-Pressure
Pilot)

1/2" ACV
Accelerating
Pilot

CONTROL VALVE PILOTS	SIZE	MATERIAL	PART #	LIST PRICE
PRP (Pressure Reducing Pilot)*	3/8"	Unleaded Bronze	152100 (A,B,C,D)	\$331.00
PRP (Pressure Reducing Pilot)*	3/8"	316SS	152100S (A,B,C,D)	\$513.00
BPP (Back-Pressure Pilot)*	3/8"	316 SS	160100S (A,B,C,D)	\$592.00
AMP (Altitude, Modulating Pilot)	3/8"	Bronze	9375498	\$1,543.00
ANP (Altitude, Non-Modulating 5' to 75')	1/4"	Bronze	8376001	\$2,694.00
ANP(Altitude, Non-Modulating 70' to 200')	1/4"	Bronze	8376002	\$2,694.00
PDP (Pressure Differential Pilot)*	3/8"	Bronze	9375302	\$410.00
FCP (Flow Control Pilot)	3/8"	Bronze	9375397	\$526.00
ACP (Accelerating Pilot)	1/2"	Unleaded Bronze	165200	\$867.00
FMP assembly (Modulating Float Valve)	1/2" Male	Horizontal	8430	\$109.00
FNP assembly (Non-Modulating Float Valve)	1/4"	Vertical	8434	\$1,176.00

*NOTE: Specify Spring Range "A" = 5-80 PSI, "B" = 25-125 PSI, "C" = 2-35 PSI, "D"=30-250 PSI

FLOW CONTROL DEVICES	SIZE	MATERIAL	PART #	LIST PRICE
 (Free Flow In and Adjustable Out)	3/8"	Stainless Steel	FC4	\$305.00
	1/4"	Bronze	8973	\$134.00
	3/8"	Bronze	9056	\$142.00
	1/2"	Bronze	9057	\$273.00

NEEDLE VALVES	SIZE	MATERIAL	PART #	LIST PRICE
 (Metered In and Out)	1/4"	Bronze	8984	\$123.00
	3/8"	Bronze	9037	\$168.00
	1/2"	Bronze	9038	\$265.00
	3/4"	Bronze	9068	\$278.00

FLOW CONTROL ORIFICE	SIZE	ORIFICE DIA	PART #	LIST PRICE
 (Fixed Orifice Stainless Steel)	1/4"M x 1/4"F	.073	8670097-3	\$38.00
	1/4"M x 1/4"F	.125	8670097-1	\$38.00
	1/4"M x 1/4"F	.171	8670097-2	\$38.00

PILOT SPRING	SPRING COLOR	SPRING RANGE	PART #	LIST PRICE
 (Epoxy Color Coded)	Silver	2-35 PSI	9676000	\$19.00
	Green	5-80 PSI	9600397A	\$19.00
	Blue	25-125 PSI	9600397B	\$19.00
	Yellow	30-250 PSI	9600397D	\$19.00



3/8" Back-Pressure Pilot
(Cut-away)

CONTROL VALVE (ACV) Accessories

		DESCRIPTION	SIZE	PART #	LIST \$
		Check Valve (CV80S6) 316SS	3/8"	5159	\$121.00
			1/2"	4029	\$176.00
		Isolation Valve	3/8"	149B5369	\$13.00
			1/4"	SSBV1000-02	\$39.00
			3/8"	SSBV1000-03	\$39.00
			1/2"	SSBV1000-05	\$42.00
			3/4"	SSBV1000-07	\$56.00
			1"	SSBV1000-10	\$95.00
			1 1/4"	SSBV1000-12	\$142.00
			1 1/2"	SSBV1000-15	\$188.00
			2"	SSBV1000-20	\$238.00
					Test Cocks (unleaded bronze)
1/8" x 1/4"	9383395E	\$11.00			
		Y-Strainer	3/8" x 1/4"	8710E	\$28.00
			3/8" x 3/8"	8711E	\$32.00
			1/2" x 1/2"	8712E	\$34.00
		1/4" Pressure Gauge (2-1/2" Dia.)	0-100 PSI	2-PG25-100G	\$25.00
			0-200 PSI	2-PG25-200G	\$25.00
			0-300 PSI	2-PG25-300G	\$25.00
		Flow Limiter Device	for 2" CV	CIS00D-1	\$250.00
			FP 1-1/2"	CIS00C	\$149.00
			FP 2", RP 3"	CIS00D	\$149.00
			FP 2/12", 3", RP 4"	CIS00F	\$149.00
			FP 4", RP 6"	CIS00G	\$152.00
			FP 5", 6", RP 8"	CIS00J	\$181.00
			FP8", RP 10"	CIS00K	\$228.00
			FP 10", RP 12"	CIS00L	\$292.00
			FP 12", RP 14"	CIS00M	\$352.00
			FP 16"	CIS00P	\$374.00

PILOT CONTROL VALVE

Back-Pressure Pilot (BPP) and Pressure Reducing Pilot (PRP)

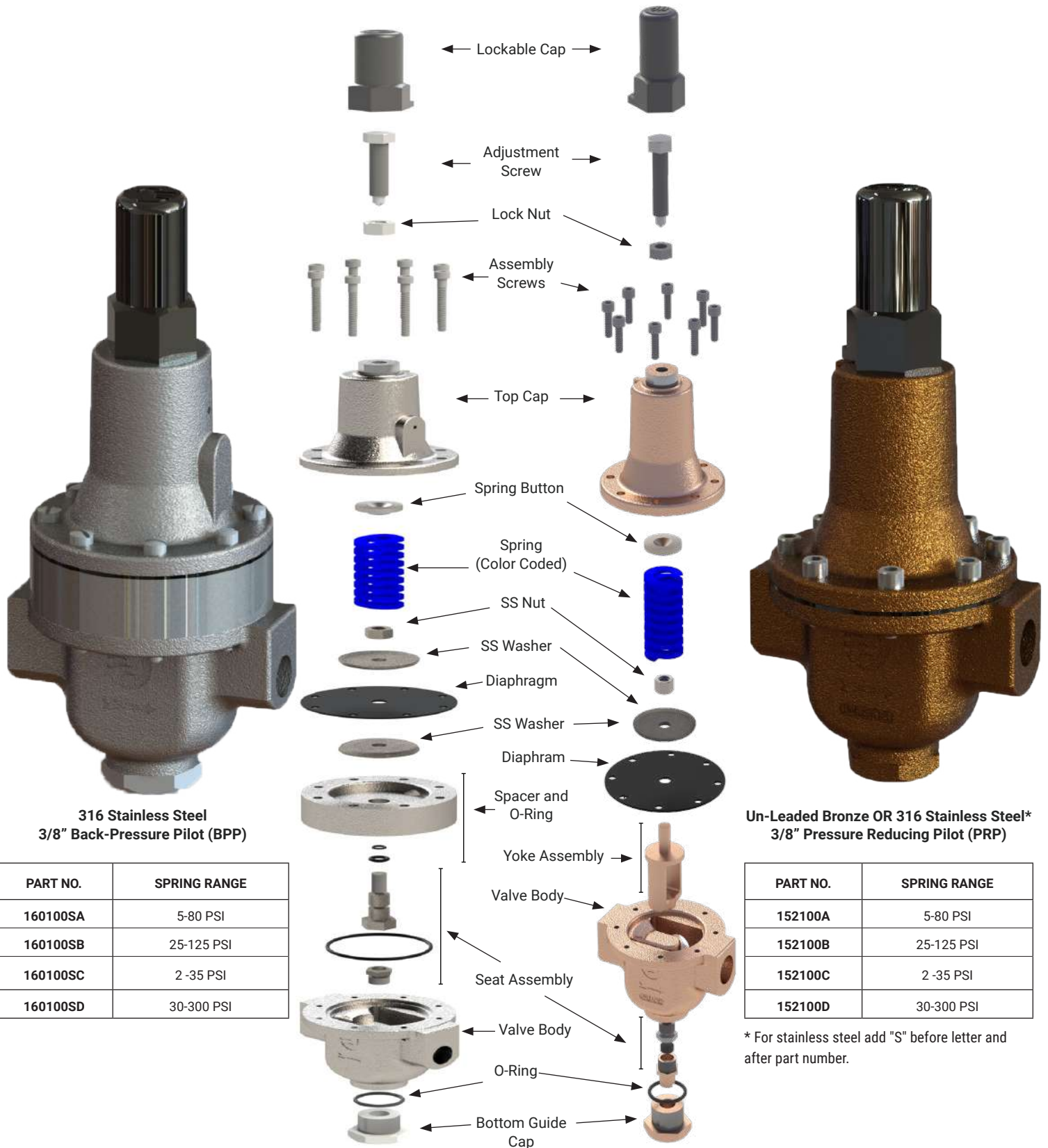

REPAIR KITS **Control Valves**

NOTE: PLEASE SPECIFY CONTROL VALVE S/N WHEN ORDERING REPAIR KITS

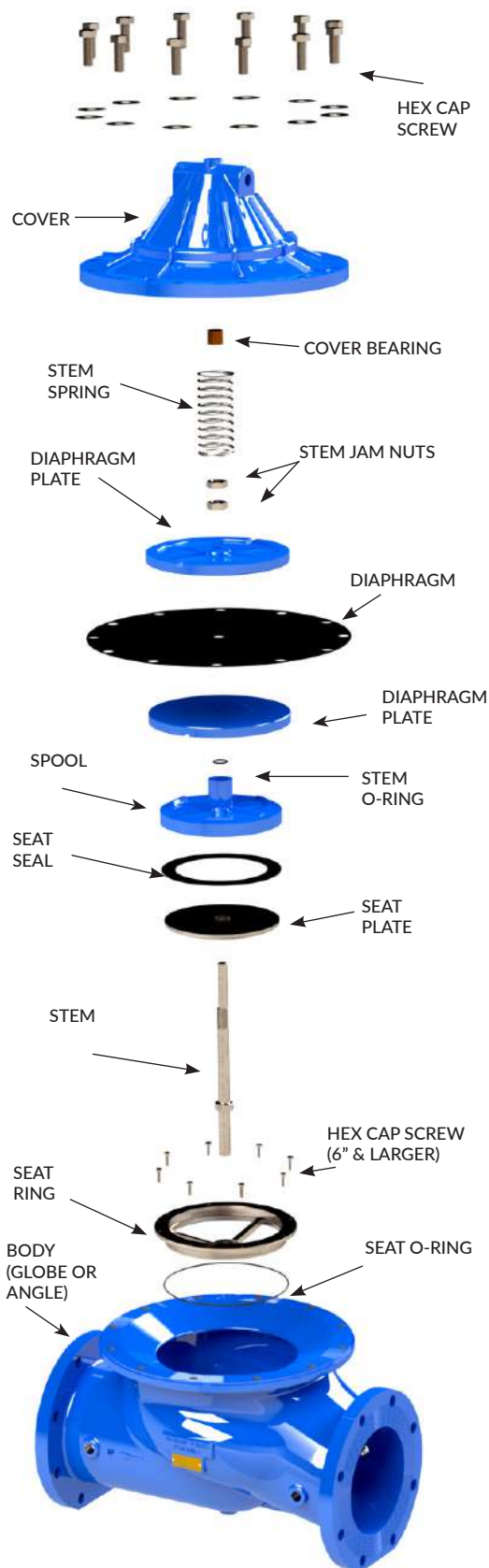

BODY **Rubber BUNA/Viton Kits**

(INCLUDES: "O"-RINGS, DIAPHRAGM, AND SEAT SEAL)

CONSULT FACTORY FOR LARGER 12" SIZE THRU 36" SIZES

PART #	DESCRIPTION	LIST \$
CRK201	CV repair kit, BUNA, FP 1-1/2"	\$49.00
CRK202	CV repair kit, BUNA, FP 2",RP 3"	\$53.00
CRK203	CV repair kit, BUNA, FP 2-1/2", FP 3",RP 4"	\$70.00
CRK204	CV repair kit, BUNA, FP 4",RP 6"	\$103.00
CRK206	CV repair kit, BUNA, FP 6",RP 8"	\$139.00
CRK208	CV repair kit, BUNA, FP 8",RP 10"	\$205.00
CRK210	CV repair kit, BUNA, FP 10"	\$398.00
CRK212	CV repair kit, BUNA, FP 12"	\$544.00
CRV015	CV repair kit, Viton, FP 2",RP 3"	\$92.00
CRV003	CV repair kit, Viton, FP 3",RP 4"	\$172.00
CRV004	CV repair kit, Viton, FP 4",RP 6"	\$316.00
CRV006	CV repair kit, Viton, FP 6",RP 8"	\$526.00

PILOT **Repair Kits**

PART #	DESCRIPTION	LIST \$
CRKALT	Altitude pilot repair kit, BUNA (must specify spring range)	\$520.00
152100KIT	PRP repair kit, BUNA, bronze	\$32.00
152100VKIT	PRP repair kit, Viton, bronze	\$93.00
152100SKIT	PRP repair kit, BUNA, SS	\$34.00
152100SVKIT	PRP repair kit, Viton, SS	\$94.00
160100KIT	BPP repair kit, BUNA, Bronze or SS	\$115.00
160100VKIT	BPP repair kit, Viton, Bronze or SS	\$127.00

FACTORY ASSEMBLED **Spool Assemblies**

(INCLUDES STEM, SEAT PLATE, SEAT SEAL, STEM "O"-RING, SPOOL, UPPER & LOWER DIAPHRAGM PLATE, DIAPHRAGM AND STEM JAM NUTS)

PART #	DESCRIPTION	LIST \$
SPOOLKIT03	Spool replacement kit FP 1-1/4" & 1-1/2"	\$273.00
SPOOLKIT04	Spool replacement kit FP 2"	\$219.00
SPOOLKIT06	Spool replacement kit FP 2-1/2" & 3" RP 4"	\$372.00
SPOOLKIT07	Spool replacement kit FP 4" RP 6"	\$526.00
SPOOLKIT09	Spool replacement kit FP 6" RP 8"	\$1,014.00
SPOOLKIT10	Spool replacement kit FP 8" RP 10"	\$1,599.00
SPOOLKIT11	Spool replacement kit FP 10" RP 12"	\$2,749.00
SPOOLKIT12	Spool replacement kit FP 12"	\$4,034.00

HOW TO ORDER FLOMATIC CONTROL VALVES

AUTOMATIC CONTROL VALVE PROJECT INSTALLATION

REQUIRED AT TIME OF ORDER

CUSTOMER: _____ ATTN: _____ DATE: _____
 ADDRESS: _____ STATE: _____ ZIP: _____
 PHONE: _____ EMAIL: _____
 PURCHASE ORDER #: _____ PROJECT REFERENCE: _____

REQUIRED SYSTEM INFO

PIPELINE SIZE: _____ INCHES MEDIA: _____ TEMPERATURE: _____
 FLOW RATE MIN: _____ GPM MAX: _____ GPM NORM: _____ GPM
 VALVE INLET PRESSURE (STATIC): _____ PSI VALVE OUTLET PRESSURE (STATIC): _____
 PUMP HP/MODEL: _____
 MAX PUMP PRESSURE: _____ PSI SYSTEM TDH: _____ VALVE ORIENTATION: ☐ HORIZONTAL ☐ VERTICAL

VALVE SPECIFICS

CONNECTION REQUIRED: ☐ FLANGED ANSI 150# ☐ FLANGED ANSI 300# ☐ FNPT BODY STYLE: ☐ MODEL 'C' – FULL PORT
☐ MODEL 'CF' – REDUCED PORT ☐ MODEL 'CA' – FULL PORT ANGLE
 VALVE TRIM: ☐ STAINLESS STEEL (STANDARD) ☐ UNLEADED BRONZE VALVE COATING: ☐ STANDARD EPOXY ☐ DOUBLE EPOXY ELASTOMERS: ☐ BUNA-N
☐ EPDM ☐ VITON

VALVE REQUIRED FUNCTION(S)

MODEL REQUESTED: _____ SIZE: _____ inch

SERIES 100 PRESSURE REDUCING OUTLET PRESSURE SETTING: _____ PSI
 SERIES 200 ALTITUDE VALVE FILL HEIGHT (FROM CENTERLINE OF VALVE): _____ FEET
 SERIES 300 BACKPRESSURE SUSTAINING SETTING: _____ PSI
 SERIES 400 PRESSURE RELIEF SETTING: _____ PSI
 SERIES 500 NOMINAL OPERATING PRESSURE: _____ PSI SURGE RELIEF SETTING: _____ PSI
 LENGTH OF DISCHARGE PIPE: _____ FT. PIPE MATERIAL: _____
 SERIES 600 INLET STATIC PRESSURE: _____ PSI OUTLET STATIC PRESSURE: _____ PSI
 SERIES 700 ☐ HORIZONTAL FLOAT ☐ VERTICAL FLOAT
 SERIES 800 SOLENOID VOLTAGE: _____ VOLTS ☐ AC or ☐ DC
 WHEN SOLENOID IS DE-ENERGIZED SHOULD MAIN VALVE BE: ☐ OPEN or ☐ CLOSED
 SERIES 900 MAXIMUM RATE OF FLOW ALLOWED: _____ GPM

IF YOUR VALVE REQUIRES MULTIPLE FUNCTIONS PLEASE FILL IN ALL INFORMATION AS NEEDED

OTHER COMMENTS OR REMARKS: _____

SPECIAL SHIPPING INSTRUCTIONS: _____

SUBMITTED AND SIGNED BY:

PRINT NAME: _____ SIGNATURE: _____ DATE: _____

TAKE CONTROL

No Matter How Complex The Application

FLOMATIC CORPORATION

CONDITIONS AND TERMS OF SALE



PRICE

Prices at date of shipment will apply. Prices are subject to change without notice.

ACCEPTANCE

Orders are accepted subject to approval of credit. Delivery is subject to strikes, accidents, or other causes beyond our control.

ERRORS, SHORTAGES, ETC.

All claims for errors, shortages, etc. must be made within 10 days of delivery.

CANCELLATIONS OF ORDERS

Orders for standard catalog products may be cancelled only if notice is received prior to the date of shipment.

RETURNS

Merchandise in new and saleable condition may be returned within one year after purchase on a freight prepaid basis for credit upon return authorization approval number, subject to inspection and acceptance at our plant. A 25% restocking charge and original freight allowance, if any, will be deducted from the credit. Special order products are nonreturnable, or at manufacturer's option.

MINIMUM NET ORDER TERMS FREIGHT

\$75.00 1% ten days, net 30 "A" & "C" Code \$1,500 an "B" Code F.O.B Factory

WARRANTIES

LIMITED THREE (3) - YEAR WARRANTY (Automatic Control Valves Only)

Flomatic Corporation warrants that its Automatic Control Valves are free from defects in materials and workmanship for the period of three (3) years after shipment. Flomatic will repair or replace any parts or components that are found to be defective within three years from the time of its shipment. Components utilized by Flomatic but manufactured by others will be warranted only to the extent of the guarantee of that manufacturer. This warranty will be void if the valve or its controls have been modified without factory authorization or if it is subjected to unusual operating conditions or if it is used for an application other than which it is intended which were not described or specified at the time of purchase. This warranty will be void if the product has been modified in any way by the purchaser, or is subjected to unreasonable use. These limited warranties extend to the original purchase from Flomatic only; they do not extend to any other purchaser or transferee.

EXCLUSION OF WARRANTIES

Flomatic makes no warranties, expressed or implied, with respect to its valves, other than the expressed limited warranties described herein. The implied warranties of merchantability and fitness for a particular purpose are hereby disclaimed by Flomatic. There are no warranties that extend beyond the description on the face hereof.

WARNING-NOT DESIGNED, INTENDED OR PERMITTED IN NUCLEAR FACILITY APPLICATIONS. FLOMATIC VALVES ARE NOT DESIGNED OR ENGINEERED FOR USE IN ANY NUCLEAR FACILITY OR IN CONJUNCTION WITH ANY NUCLEAR FACILITY OR SUPPORT FACILITY. USE OF ANY OF FLOMATIC'S PRODUCTS IN ANY SUCH APPLICATION IS A MISUSE OF THESE PRODUCTS AND VOIDS ALL WARRANTIES CONTAINED HEREIN, EXPRESSED AND IMPLIED, OF MERCHANTABILITY AND FITNESS FOR PARTICULAR PURPOSE.

EXCLUSION OF INCIDENTAL AND CONSEQUENTIAL DAMAGES

In no event shall Flomatic be liable for incidental or consequential damages, including but without limitation, damages of personal injuries resulting from the negligence of Flomatic, which may arise from the manufacture, sale, purchase and/or use of Flomatic valves. It being intended that purchaser's exclusive remedy is limited to replacement of defective products. Some states do not allow the exclusion or limitation of incidental or consequential damages, or limitation on how long an implied warranty lasts, so that the above limitations may not apply to you. Contact your distributor or Flomatic at address shown if you have any questions about the coverage of this warranty or service under this warranty. This warranty gives you specific legal rights, and you may have other rights which vary from state to state.

NOTE: Flomatic reserves the right the change and/or alter valve products without prior notice. Consult factory for valve specifications.

FLOMATIC CORPORATION

15 Pruy's Island Drive, Glens Falls, NY 12801

PH: 800-833-2040 Fax: 518-761-9798

Web Site: www.flomatic.com e-mail: flomatic@flomatic.com

Pricing and specification subject to change without notice.

© Copyright Flomatic 2020



FLOMATIC® VALVES

Flomatic is a U.S. valve manufacturer founded in 1933 which has expanded operations to better serve you, our customer.

This year, we have increased our manufacturing capacity by nearly 50%, along with our new customer training facility, which includes a brand new, state of the art training center and R&D lab to better address your growing needs.

Flomatic is a diversified U.S. valve manufacturer producing valve products in sizes ranging from ¼" through 36", in various types for the Municipal, Industrial, Domestic and Irrigation Markets.

Our valve products are specified and installed in some of the largest water and wastewater projects in the country from the "Big Dig" in Boston, Potable Water and Wastewater systems in New York City, pumping system in Los Angeles to fuel systems associated with the Space Shuttle in Texas and irrigation systems in the heartland of our nations farm lands.

In addition, Flomatic® Automatic Control Valves are in operation in some of the largest reclaim water systems in the City of Orlando, Florida and in the State of New York.

Most of our products are both NSF/ANSI 61 & 372 listed. Nearly 15% of our valve production are exported to over 40 countries.

Flomatic is one of the few valve manufacturer in U.S. that has earned both ISO9001-2015 and ISO 14001-2015 International Quality Management certification, as quality and performance are the most important part of our business, just as you are.



Bo Andersson

President - Flomatic Valves.





CONTACT FLOMATIC

DOMESTIC CALLERS DIAL
INTERNATIONAL CALLERS DIAL

800.833.2040
+1-518-761-9797

FOR SALES AND ORDERS
FOR THE MARKETING DEPT.
FOR TECHNICAL SUPPORT

PRESS 2
PRESS 3
PRESS 4

FAX ORDERS

518-761-9798

MANUFACTURING FACILITY &
CORPORATE OFFICES

15 PRUYN'S ISLAND DR
GLENS FALLS, NY
12801

CONTACT BY E-MAIL
WEBSITE

FLOMATIC@FLOMATIC.COM
WWW.FLOMATIC.COM



For a complete listing of all National and International Sales Representatives please visit our website at www.flomatic.com/rep/ or call our customer service representatives at 800.833.2040



FLOMATIC® VALVES

Since 1933, Manufacturing
The Most Complete Line of Valve Products for Water and Wastewater
in The United States



FIND OUR COMPLETE VALVE OFFERING AT

WWW.FLOMATIC.COM

FLOMATIC CORPORATION

15 Pruyn's Island Drive,
Glens Falls, New York 12801
Phone: (800) 833-2040
Fax: (800) 314-3155

WWW.FLOMATIC.COM

LIMITED THREE YEAR WARRANTY: The Flomatic Corporation warrants that its Automatic Control Valves in all sizes are free from defects in materials and workmanship. Flomatic will replace any valve covered by this warranty found to be defective within three years from time of sale. This warranty will be void if the product has been modified in any way by the purchaser, or is subject to unreasonable use.

