

Pioneer

VSX-1023-K VSX-823-K VSX-523-K

AV Receiver

Quick Start Guide

Thank you for buying this Pioneer product. This Quick Start Guide includes instructions for basic connections and operations to allow simple use of the receiver. For detailed descriptions of the receiver, see the "Operating Instructions" provided on the included CD-ROM (📀).

Merci pour l'achat de ce produit Pioneer. Ce guide rapide contient les instructions relatives aux raccordements et opérations de base permettant une utilisation simple de ce récepteur. Pour des descriptions plus détaillées du récepteur, référez-vous au "Mode d'emploi" sur le CD-ROM (📀) fourni.

Muchas gracias por haber adquirido este producto de Pioneer. Esta Guía de inicio rápido incluye instrucciones para hacer las conexiones y operaciones básicas que le permitirán hacer un uso sencillo del receptor. Para conocer una descripción detallada del receptor, consulte el "Manual de instrucciones" suministrado con el CD-ROM (📀) incluido.



What's in the box Contenu du carton d'emballage Contenido de la caja



Remote Control
Télécommande
Mando a distancia



FM wire antenna
Antenne filaire FM
Antena de hilos de FM

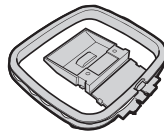

AM loop antenna
Antenne cadre AM
Antena de cuadro de AM



CD-ROM (Operating instructions)
CD-ROM (Mode d'emploi)
CD-ROM (Manual de instrucciones)

SPEAKER CAUTION Sheet (English only)
Note d'avertissement relative aux enceintes (en anglais uniquement)
Hoja de PRECAUCIONES ACERCA DE LOS ALTAVOCES (solo en inglés)

Warranty card
Carte de garantie
Tarjeta de garantía

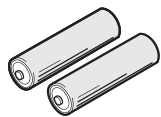

AAA size IEC R03 dry cell batteries x2
Piles à anode sèche AAA IEC R03 x 2
Pilas secas AAA, IEC R03 x 2

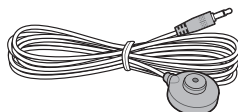

Setup microphone
Microphone de configuration
Micrófono de configuración



Safety Brochure
Brochure sur la Sécurité
Folleto de Seguridad

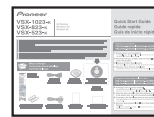

These quick start guide
Le présent Guide de démarrage
Esta guía de inicio rápido

● Protect your new investment

The details of your purchase will be on file for reference in the event of an insurance claim such as loss or theft.

● Receive free tips, updates and service bulletins on your new product

● Improve product development

Your input helps us continue to design products that meet your needs.

● Receive a free Pioneer newsletter

Registered customers can opt in to receive a monthly newsletter.

Enregistrez votre produit sur le site Web :

<http://www.pioneerelectronics.com> (États-Unis)

<http://www.pioneerelectronics.ca> (Canada)

● Protégez votre nouveau matériel

Les renseignements relatifs à votre matériel seront conservés pour référence en cas de sinistre, tel que la perte ou le vol.

● Recevez des conseils, des informations d'entretien et de mise à jour sur votre nouveau matériel

● Contribuez au développement de nos produits

Votre participation nous aide à concevoir des produits qui répondent à vos besoins.

● Recevez gratuitement le bulletin d'informations de Pioneer

Les clients enregistrés peuvent, s'ils le désirent, recevoir un bulletin d'informations mensuel.

STEP 1 Connecting up

Connecting the speakers

The receiver will work with just two stereo speakers (the front speakers in the diagram) but using at least three speakers is recommended, and a complete setup is best for surround sound.

To achieve the best possible surround sound, install your speakers as shown below.

5.1 channel surround system:

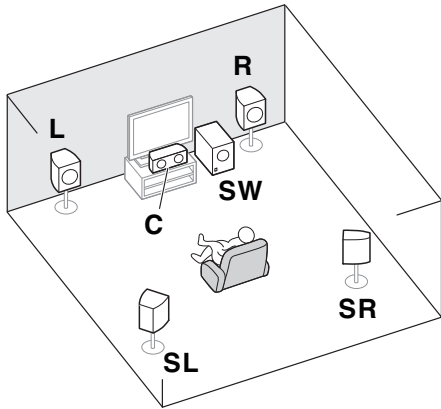

- L** – Front Left
- C** – Center
- R** – Front Right
- SL** – Surround Left
- SR** – Surround Right
- SW** – Subwoofer

- In addition, surround back speakers, front height speakers or Speaker B (VSX-1023 only) can also be connected.

Connecting the speaker cables

Make sure you connect the speaker on the right to the right (R) terminal and the speaker on the left to the left (L) terminal. Also make sure the positive (+/-) terminals on the receiver match those on the speakers.

CAUTION

- Before making or changing connections, switch off the power and disconnect the power cord from the AC outlet.
- These speaker terminals carry **HAZARDOUS LIVE** voltage. To prevent the risk of electric shock when connecting or disconnecting the speaker cables, disconnect the power cord before touching any uninsulated parts.

- 1** Twist exposed wire strands together.
- 2** Loosen terminal and insert exposed wire.
- 3** Tighten terminal.

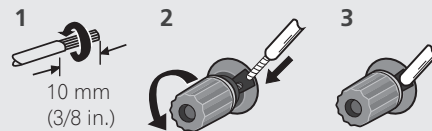

Connect the wires to the B-Speaker terminals of VSX-1023 and the center and surround speaker terminals of VSX-523 as shown below:

- 1** Twist exposed wire strands together.
- 2** Push open the tabs and insert exposed wire.
- 3** Release the tabs.

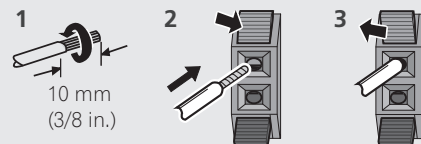

After installing the speakers, connect them as shown below.

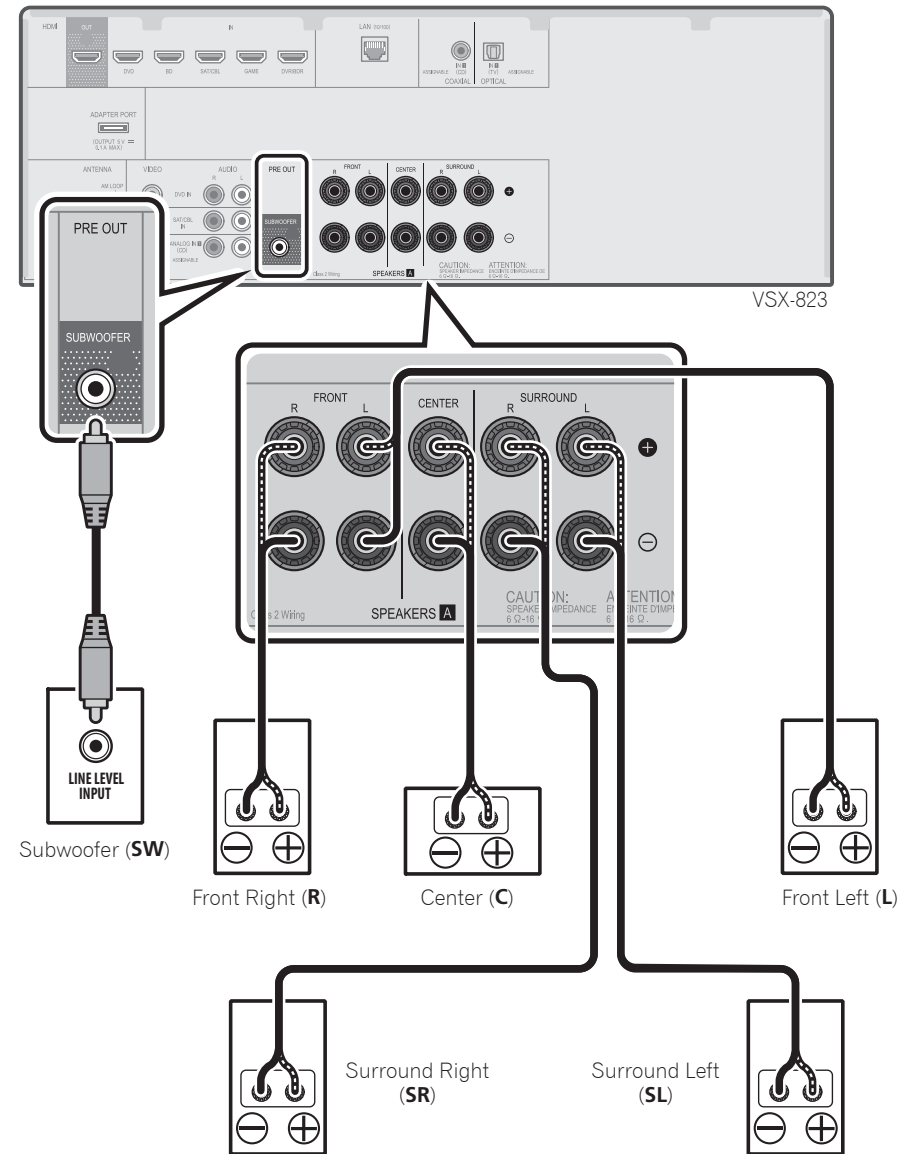

The type of center and surround speaker terminals for VSX-523 is different from this diagram. You can use speakers with a nominal impedance between 6 Ω and 16 Ω.

Connecting a TV and playback components

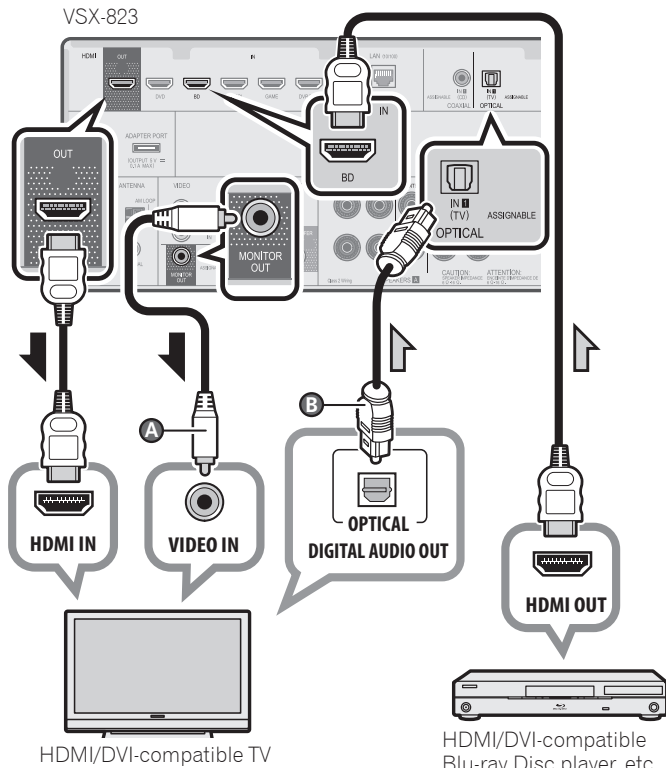

HDMI/DVI-compatible TV

HDMI/DVI-compatible Blu-ray Disc player, etc.

- *VSX-523 only:* Composite video cable (A) connection is necessary in order to see the OSD of the unit on the TV.
- *VSX-1023/VSX-823 only:* The OSD will only be output from the HDMI OUT terminal.
- If the TV does not support the HDMI Audio Return Channel function, optical digital cable (B) connection is required to listen to the TV sound over the receiver.
- If the TV supports the HDMI Audio Return Channel function, the sound of the TV is input to the receiver via the HDMI terminal, so there is no need to connect an optical digital cable (B). In this case, set **ARC** at **HDMI Setup** to **ON** → **The HDMI Setup menu** on page 32 (*VSX-523*), "**HDMI Setup**" on page 52 (*VSX-1023/VSX-823*)
- Please refer to the TV's operation manual for directions on connections and setup for the TV.

Connecting antennas

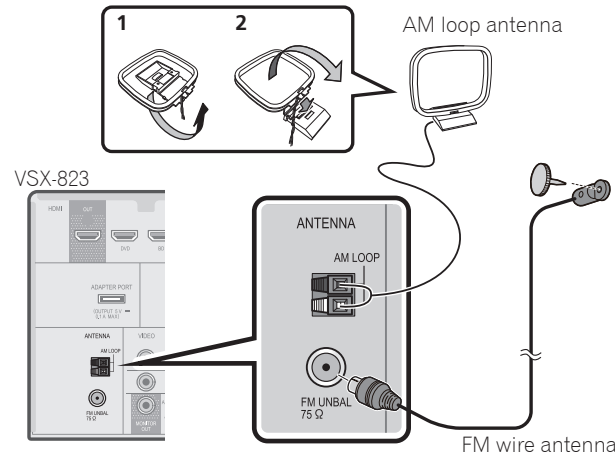

Connecting to the network through LAN interface

VSX-1023/VSX-823 only

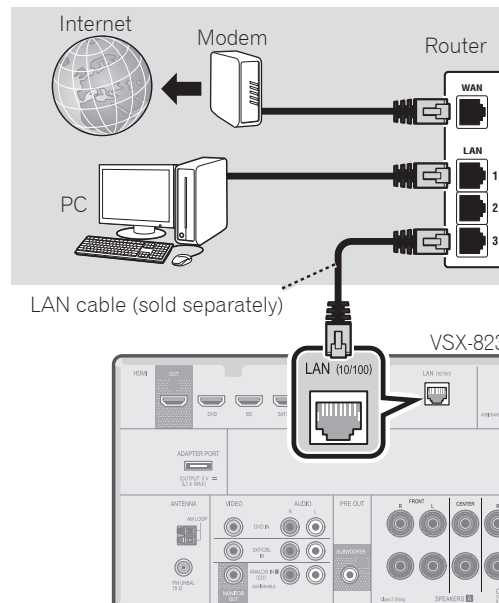

Note

- Refer to the operating instructions in the included CD-ROM if you wish to connect a TV or playback component in a method other than an HDMI connection.
- Refer to the operating instructions in the included CD-ROM for other device connections.

CAUTION

- Handle the power cord by the plug part. Do not pull out the plug by tugging the cord, and never touch the power cord when your hands are wet, as this could cause a short circuit or electric shock. Do not place the unit, a piece of furniture, or other object on the power cord or pinch the cord in any other way. Never make a knot in the cord or tie it with other cables. The power cords should be routed so that they are not likely to be stepped on. A damaged power cord can cause a fire or give you an electric shock. Check the power cord once in a while. If you find it damaged, ask your nearest Pioneer authorized independent service company for a replacement.

VENTILATION CAUTION

When installing this unit, make sure to leave space around the unit for ventilation to improve heat radiation (at least 40 cm at top, 20 cm at rear, and 20 cm at each side).

WARNING

Slots and openings in the cabinet are provided for ventilation to ensure reliable operation of the product, and to protect it from overheating. To prevent fire hazard, the openings should never be blocked or covered with items (such as newspapers, table-cloths, curtains) or by operating the equipment on thick carpet or a bed.

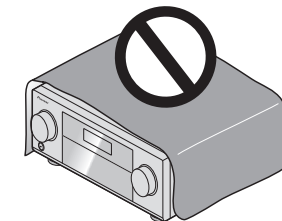

STEP 2 Initial Setup

Before you start

1 Put the batteries in the remote control.

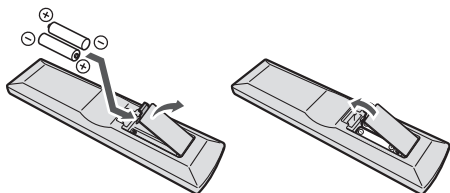

The batteries included with the unit are to check initial operations; they may not last over a long period. We recommend using alkaline batteries that have a longer life.

2 Switch on the receiver and your TV.

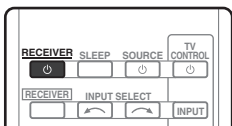

3 Switch the TV input so that it connects to the receiver.

4 Turn the subwoofer on and turn up the volume.

⚠ CAUTION

- Do not use or store batteries in direct sunlight or other excessively hot place, such as inside a car or near a heater. This can cause batteries to leak, overheat, explode or catch fire. It can also reduce the life or performance of batteries.
- When inserting the batteries, make sure not to damage the springs on the battery's (-) terminals. This can cause batteries to leak or overheat.
- When disposing of used batteries, please comply with governmental regulations or environmental public institution's rules that apply in your country/area.

Automatically setting up for surround sound (MCACC)

The Auto Multi-Channel ACoustic Calibration (MCACC) setup uses the supplied setup microphone to measure and analyze the test tone that is outputted by the speakers. This setup enables automatic high precision measuring and settings; utilizing it will create an optimum user listening environment.

📌 Important

- Measure in a quiet environment.
- If you have a tripod, use it to place the microphone so that it's about ear level at your normal listening position. Otherwise, place the microphone at ear level using a table or a chair.
- Accurate measurements may not be possible if there are obstacles between the speakers and the listening position (microphone).
- When measuring, step away from the listening position, and operate using the remote control from the external side of all the speakers.

1 Connect the supplied setup microphone.

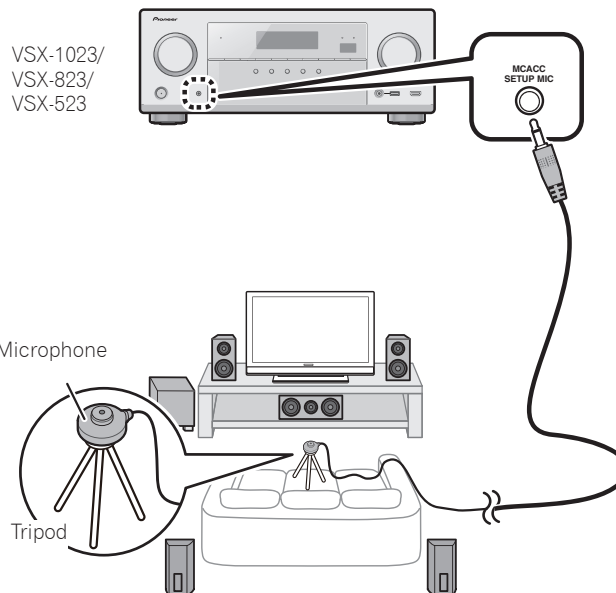

VSX-1023/
VSX-823/
VSX-523

2 Press **RECEIVER** on the remote control, then press the **HOME MENU** button.

The Home Menu appears on your TV.

3 Select 'Auto MCACC' from the Home Menu, then press **ENTER**.

Automatic measuring will start.

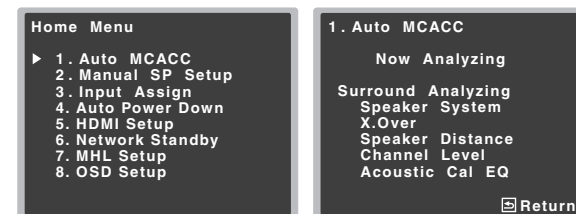

VSX-823

- Measuring will take about 3 to 12 minutes.
- #### 4 Follow the instructions on-screen.
- Automatic setting is complete when the Home Menu screen appears.
- #### 5 Make sure the setup microphone is disconnected.

STEP 3 Basic playback

Multichannel playback

VSX-523

VSX-1023 / VSX-823

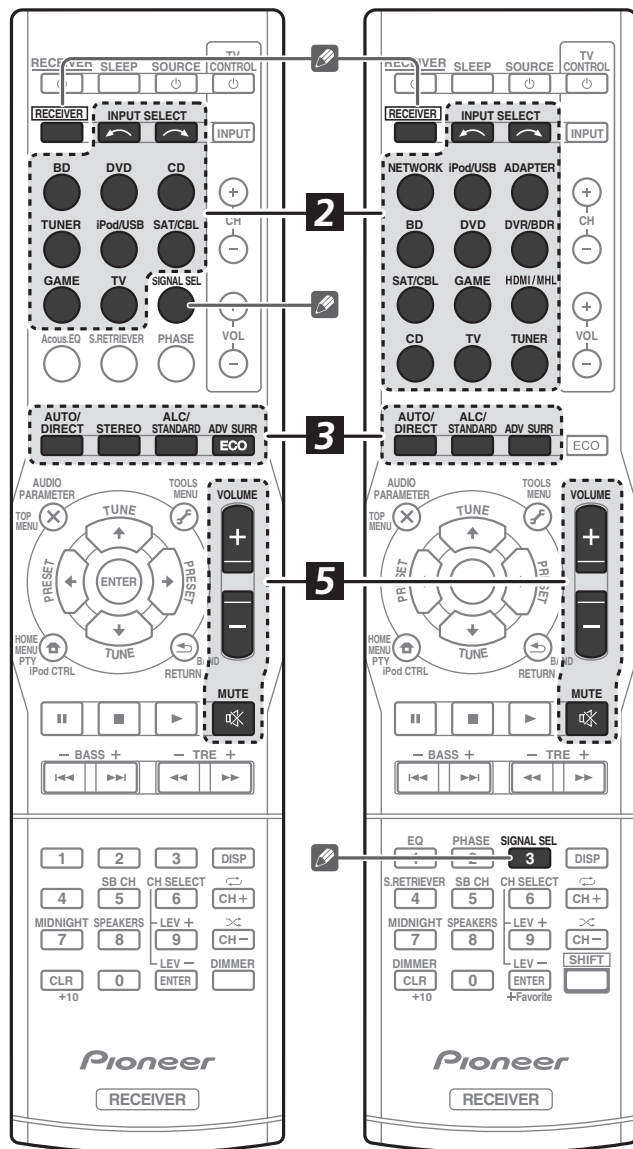

1 Switch on the playback component.

E.g. Turn the Blu-ray Disc player connected to the **HDMI BD IN** terminal on.

2 Switch the input of the receiver.

E.g. Press **BD** to select the **BD** input.

3 Press **AUTO/DIRECT** to select 'AUTO SURROUND'.

Also press **ALC/STANDARD** or **ADV SURR** for multichannel playback. Select your preferred listening mode.

4 Start the playback component's playback.

E.g. Start playback of the Blu-ray Disc player.

5 Use **VOLUME +/-** to adjust the volume level.

Sound can be switched off by pressing **MUTE** button.

Note

- In order to listen to the audio from the source component that is connected to this receiver using a coaxial or an optical cable, choose the **C1** (coaxial) or **O1** (optical) input. (VSX-523: Press **SIGNAL SEL**. VSX-1023/VSX-823: Press **RECEIVER** then press **SIGNAL SEL**.)
- The input of the receiver will switch over, and you will be able to operate other components using the remote control. To operate the receiver, first press **RECEIVER** on the remote control, then press the appropriate button to operate.

Listening to the radio

1 Press **TUNER** to select the tuner.

If necessary, press **BAND** to change the band (FM or AM).

2 Press **TUNE ↑/↓** to tune to a station.

- Press and hold **TUNE ↑/↓** for about a second. The receiver will start searching for the next station.
- If you're listening to an FM station but the reception is weak, press **BAND** to select FM MONO and set the receiver to the mono reception mode.

Saving station presets

If you often listen to a particular radio station, it's convenient to have the receiver store the frequency for easy recall whenever you want to listen to that station.

1 Press **TOOLS** while receiving a signal from the station you want to store.

The preset number is blinking.

2 Press **PRESET ←/→** to select the station preset you want, then press **ENTER**.

The preset number stop blinking and the receiver stores the station.

Listening to station presets

You will need to have some presets stored to do this.

- Press **PRESET ←/→** to select the station preset you want.

Playing an iPod

- About one minute is required between turning the power on and completion of startup.

1 Connect your iPod.

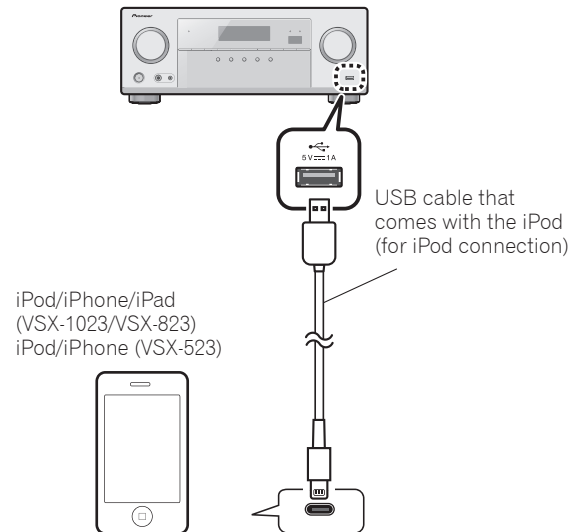

2 Press iPod/USB to select the iPod/USB input.

When the display shows the names of folders and files, you're ready to play music from the iPod.

3 Use **↑/↓** to select a category, then press **ENTER** to browse that category.

- To return to the previous level any time, press **RETURN**.

4 Use **↑/↓** to browse the selected category (e.g., albums).

- Use **←/→** to move to previous/next levels.

5 Continue browsing until you arrive at what you want to play, then press **▶** to start playback.

Listening to Internet radio stations

VSX-1023/VSX-823 only

- About one minute is required between turning the power on and completion of startup.

! Important

- When using a broadband Internet connection, a contract with an Internet service provider is required. For more details, contact your nearest Internet service provider.
- To listen to Internet radio stations, you must have high-speed broadband Internet access. With a 56 K or ISDN modem, you may not enjoy the full benefits of Internet radio.
- Access to content provided by third parties requires a high speed internet connection and may also require account registration and a paid subscription. Third party content services may be changed, suspended, interrupted, or discontinued at any time without notice, and Pioneer disclaims any liability in connection with such occurrences. Pioneer does not represent or warrant that content services will continue to be provided or available for a particular period of time, and any such warranty, express or implied, is disclaimed.

1 Press **NETWORK** repeatedly to select the **NETRADIO** input.

It may take several seconds for this receiver to access the network.

2 Use **↑/↓** to select the Internet radio station to play back, and then press **ENTER**.

To enjoy the many functions of the unit to the fullest extent

Load the CD-ROM into your computer and download the PDF manual from the menu screen to read.

Functions

■ Playing a USB device

→ page 24 (*VSX-523*), page 28 (*VSX-1023/VSX-823*)

■ Bluetooth ADAPTER for Wireless Enjoyment of Music

→ page 31 (*VSX-1023/VSX-823 only*)

■ Playback with NETWORK features

→ page 39 (*VSX-1023/VSX-823 only*)

■ Setting the Audio options

→ page 28 (*VSX-523*), page 37 (*VSX-1023/VSX-823*)

■ Using the Home Menu

→ page 30 (*VSX-523*), page 49 (*VSX-1023/VSX-823*)

Troubleshooting

→ page 34 (*VSX-523*), page 62 (*VSX-1023/VSX-823*)