



Human Factors and Ergonomics in Health Care

PROGRAM

March 26–28, 2018

Boston Marriott Copley Place
Boston, Massachusetts



HFES 2018

International Annual Meeting

October 1–5
Philadelphia Marriott, Philadelphia, PA



Forward-thinking research and application for **YOU**

Immerse yourself in new discoveries and breakthroughs in the field of human factors /ergonomics and benefit from opportunities to partner with colleagues from around the world.

- Attend daily dedicated plenary sessions in critical HF/E areas
- Boost your knowledge with more than 120 technical sessions encompassing hundreds of panels, papers, and posters
- Hear from UX experts during User Experience Day sessions and events
- Gain hands-on experience with skill-building workshops
- See HF/E in action on technical site tours

HFES 2018 allows you to explore, network, and participate in programs presented by a community of trusted peers through:

- Technical Group meetings and receptions
- Networking events for early-career professionals
- Student Career and professional development day
- Mentor/mentee events with professionals from industry and academia

Keep up with the accelerated pace of HF/E research and applications to lead, grow, and bring innovation to your field.

hfes.org



HUMAN FACTORS AND ERGONOMICS SOCIETY

WELCOME

Welcome to the HFES 2018 International Symposium on Human Factors and Ergonomics in Health Care. The symposium offers a unique program of human factors/ergonomics (HF/E) perspectives on health-care human factors, technology, and patient safety, divided among four main tracks:

- Clinical and Consumer Health-Care IT
- Hospital Environments
- Medical and Drug Delivery Devices
- Patient Safety Research and Initiatives

The meeting is designed to enable HF/E professionals to disseminate their science, principles, and best practices to the health-care product and provider communities, and to enable these communities to provide HF/E professionals with the proper context, requirements, and perspectives to better focus future HF/E efforts.

The 2018 program starts with our keynote speaker, Sorrel King. A nationally renowned patient safety advocate, King will focus how to create a culture of patient safety, based on her family's experience, as a tool to help inspire, educate, and create a call to action.

A panel on Monday from 1:30 to 3:00 p.m. honors the contributions of Robert Wears, MD, a leader in patient safety.

Gold Sponsor Ximedica will host a reception on Tuesday evening following the poster session. All attendees are invited.

We thank our symposium track chairs and their committee members for creating such a diverse and timely program. Special thanks also to our sponsors, exhibitors, advertisers, student volunteers, session chairs, and all the other individuals who supported the effort to produce this symposium.

We hope that this year's symposium will enable all attendees to reach new heights in applying the perspectives and science of human factors/ergonomics to the future of health care.



A handwritten signature in blue ink, appearing to be 'JK'.

Joseph R. Keebler, PhD
Symposium Chair



A handwritten signature in blue ink, appearing to be 'A. Andre'.

Anthony D. (Tony) Andre,
PhD, CPE
Symposium Cochair

PROGRAM COMMITTEE

The Program Committee of the 2018 International Symposium on Human Factors and Ergonomics in Health Care consists of experts in a wide variety of domains and organizations.

Joseph R. Keebler, Embry-Riddle Aeronautical U. – Chair
Anthony D. (Tony) Andre, Interface Analysis Associates/San Jose State U. – Cochair

CLINICAL AND CONSUMER HEALTH-CARE IT TRACK

Farzan Sasangohar, Texas A&M U. – Cochair
Emily S. Patterson, Ohio State U. – Cochair

Janey Barnes, User-View
Ellen J. Bass, Drexel U.
Kelly Caine, Indiana U.
Barrett Caldwell, Purdue U.
Jane M. Carrington, U. of Arizona
Roger J. Chapman, Collaborative Work Systems (CWS),
Inc.
R. Darin Ellis, Wayne State U.
Ila J. Elson, Abbott Laboratories
Jennie J. Gallimore, Wright State U.
A. Zachary Hettinger, National Center for Human Factors
in Healthcare - MedStar Health
Richard Holden, Indiana U.-Indianapolis
Richard L. Horst, UserWorks, Inc.
Heidi Kramer, U. of Utah
Michelle Lenox, SA Technologies/IUPUI Health Informatics

Gregory Liddell, Human Interfaces
Karen Dunn Lopez, U. of Illinois Chicago
Laura G. Militello, Applied Decision Science, LLC
Anne Miller, Vanderbilt U.
S. D. Miller, Siemens Healthcare HS Innovation Center
Prithima R. Mosaly, U. of North Carolina, Chapel Hill
Priya R. Pennathur, U. of Iowa
Michelle L. Rogers, Drexel U.
Kaden Rushford, Athena Health
Rupa S. Valdez, U. of Wisconsin-Madison
Wayne Zachary, CMZ Health Technologies
Lauren Zack, GfK
Teresa Zayas Cabán, Agency for Healthcare Research
and Quality
Sam Zheng, Siemens Corporate Research

HOSPITAL ENVIRONMENTS TRACK

Brandan Kennedy, Children's Mercy Hospitals – Cochair
Raymond Chan, Children's Mercy Hospitals – Cochair
Russell J. Branaghan, Arizona State U. – Cochair

Laura Barnes, U. of Virginia
Albert J. Boquet, Embry-Riddle Aeronautical U.
Stephanie Burrus, Children's Mercy Hospital
Ken Catchpole, Cedars-Sinai Medical Centre
Nicholas Clark, Children's Mercy Hospital
Sam Curtis, Intuitive Surgical
Eric Del Rio, Lextant
Ellen S. Deutsch, ECRI
Savitri Dhiman, Steris
Cindy Dominguez, Applied Research Associates
Peter A. Doyle, The Johns Hopkins Hospital
David Eibling, U. of Pittsburgh/VA Pittsburgh
Thomas Ferris, Texas A&M U.
Bryant Foster, Research Collective
M. Susan Hallbeck, Mayo Clinic/U. of Nebraska

Gyusung Lee, Johns Hopkins U. School of Medicine
Huiyang Li, State U. of New York at Binghamton
Kang Li, Rutgers U.
Bernadette McCrory, U. of Nebraska-Lincoln
Kathryn L. Momtahan, The Ottawa Hospital, U. of Ottawa
Jeff Morang, Ximedica
Sarah Henrickson Parker, Virginia Tech Varilion Research
Institute
Avi Parush, Carleton U.
Douglas E. Paull, VA National Center for Patient Safety
Farzan Sasangohar, Texas A&M U.
Scott A. Shappell, Embry-Riddle Aeronautical U.
Eric Shaver, Human Factors MD
Linda Shay, Allina Health
Bruce D. Spiess, VCU Medical Center

Sophia Sterner, Children's Mercy Hospital
Thoralf Sundt, Harvard Medical School/Massachusetts
General Hospital
Matthew B. Weinger, Vanderbilt U. Medical Center
Douglas A. Wiegmann, U. of Wisconsin-Madison
Linda C. Williams, VA National Center for Patient
Safety

Jason Wise, GE Healthcare Surgery
Anping Xie, Armstrong Institute for Patient Safety and
Quality, Johns Hopkins U.
Shanqing "SQ" Yin, KK Women's & Children's Hospital,
Singapore

MEDICAL AND DRUG-DELIVERY DEVICES TRACK

Beth A. Loring, Loring Human Factors, LLC – Cochair
Deepti Surabattula, FujiFilm Sonosite – Cochair

Anthony D. (Tony) Andre, Interface Analysis Associates
Pat Baird, Baxter Healthcare
Scott Barton, Regeneron Pharmaceuticals
Eric Bergman, Fresenius Medical Care
Paul A. Blowers, Abbvie
Joe Cafazzo, U. Health Network
Christy Calder, FCA Fiat Chrysler Automobiles
Chris Carles, Kaleidodcope
Mike Clem, Kaleidodcope
Tressa Daniels, Becton Dickinson
Conall Dempsey, Unilife
Julian Dixon, Team Consulting
James (Jay) E. Duhig, Abbvie
Sami Durrani, Fresenius Health Care
Evan T. Edwards, Kaleo, Inc.
David Eibling, U. of Pittsburgh and VA Pittsburgh
Ila Elson, Abbott Labs
Rollin J. (Terry) Fairbanks, National Center for Human
Factors in Healthcare - MedStar Health
Valerie Fenster, Amgen
Tara Feuerstein, Farm
Amanda Fonville, Kestra Medical Technologies, Inc.
Erika Franzen, Philips Respironics
Bobby Garfield, Radius Innovation
John Gosbee, Red Forest Consulting, LLC
Michael Gross, Chimera Consulting
Sean Hagen, BlackHagen Design
Amanda Hall, Physio-Control/Stryker Medical
Reade Harpham, Battelle
Shannon Hoste, Stryker
Edmond W. Israelski, Abbvie
Carolynn R. Johnson, Daedalus
Korey R. Johnson, Bold Insight Inc.
Keith Karn, Human Factors in Context, LLC
Cheryl Kwinn, Farm Product Development
Merrick Kossack, UL-Wiklund
Michael Lau, Insight Product Development

Melissa R. Lemke, Agilis Consulting Group
Vicki R. Lewis, Healthcare Safety Strategies, LLC
Beth A. Loring, Loring Human Factors, LLC
Joy Matsumoto, Monterey Technologies
Natalia Mazaeva, Medtronic
Susan McDonald, Ximedica
Heidi Mehrzad, Radius Innovation
Christina C. Mendat, Human Factors MD
Anne Mickelson, Equilogix, LLC
Cindy A. Miller, GE Healthcare
Robert A. North, Human Centered Strategies
A. Ant Ozok, U. of Maryland Baltimore County
Sandhya Pillalamarri, Insulet Corporation
Janine A. Purcell, Independent Consultant
Mick Rakauskas, Baxter Healthcare
Laurie Reed, Farm Design
Tim Reeves, Human Factors MD
Valerie J. Rice, U.S. Army
Dawn Rountree, Bayer HealthCare
John M. Rovnan, Tele Tracking Technologies
George M. Samaras, Samaras & Associates, Inc.
Adam R. Shames, Core Human Factors, Inc.
Eric F. Shaver, Human Factors MD
S. Noel Simpson, Newell-Rubbermaid
Savannah Sleicher, Worrell Inc.
Olivier St-Cyr, University Health Network
Robert Stephens, Medtronic
Molly Follette Story, Sanofi
Deepti Surabattula, Fujifilm Sonosite
Melanie Turieo, Cambridge Consultants
Denise Wagner, Johnson & Johnson
Stephen B. Wilcox, Design Science
Jason Wise, Siemens Healthineers
Hanniebey D. Wiyor, U.S. Food and Drug Administration
Audra Wright, Halyard Health
Steven A. Zilber, Saza Consulting

PATIENT SAFETY RESEARCH AND INITIATIVES TRACK

Elizabeth Papautsky, U. of Illinois at Chicago – Cochair

Natalie Abts, National Center for Human Factors in Healthcare - MedStar Health – Cochair

Shilo Anders, Vanderbilt U.
Brittany Anderson-Montoya, Carolinas Healthcare System
Laura Barg-Walkow, Children's Hospital Colorado
Conne Bazley, Pfizer
Wendy L. Bedwell, PACE Consulting Solutions
Nat Benda, National Center for Human Factors in Healthcare
Yuval Bitan, Ben-Gurion U. of the Negev
Elizabeth Blickensderfer, Embry-Riddle Aeronautical U.
Sylvain Bruni, Aptima
Shannon Clark, UserWise
Ellen Deutsch, ECRI
Jay Duhig, Abbvie
Katie Ernst, Purdue U.
Katie Forsyth, Mayo Clinic
Sarah Fouquet, Children's Mercy Kansas City
Helen Fuller, Department of Veterans Affairs
Paul Gorman, Oregon Health & Science U.
Sarah Henrickson-Parker, Virginia Tech Carilion School of Medicine and Research
Emily Hildebrand, Arizona State U.
Robert Hubal, UNC Eshelman School of Pharmacy
Ellie Hunt, Wester Governors U.
Kate Kellogg, National Center for Human Factors in Healthcare
Adjhaporn (Nana) Khunlertkit, Bumrungrad International Hospital, Thailand
Fran Kistner, Massachusetts College of Pharmacy and Health Sciences

Anil Kumar, San Jose State U.
Elizabeth H. Lazzara, Embry-Riddle Aeronautical U.
Beth Meyer, Allscripts
Enid Montague, DePaul U.
Laura E. Moody, Mercer U.
Mustafa Ozkaynak, U. of Colorado
Liza Papautsky, U. of Illinois at Chicago
Mary Patterson, Children's National Medical Center
Priyadarshini Pennathur, U. of Iowa
Beatrice Podtchshaske, Stanford Healthcare
Janine Purcell, independent HFE contractor
Joy Rivera, Children's Hospital of Wisconsin
Edmond Ramly, U. of Wisconsin-Madison
John Rice, Retired
Michael Rosen, Johns Hopkins U. School of Medicine
F. Jacob Seagull, U. of Michigan
Noa Segall, Duke U. Medical Center
Jason Slagle, Vanderbilt U.
Peter Sneeringer, Design Science
Shirley C. Sonesh, Tulane U.
Linsey M. Steege, U. of Wisconsin-Madison
Katie Tippey, Design Science
Monifa Vaughn-Cooke, U. of Maryland
Nicole Werner, U. of Wisconsin-Madison
Deborah Woodcock, Oregon Health & Science U.
Yushi Yang, Drexel U.
Shanqing (SQ) Yin, KK Women's & Children's Hospital, Singapore

“MOBILE HEALTH APPLICATIONS FOR CONSUMERS” STUDENT DESIGN COMPETITION

Richard Holden, Indiana U.-Indianapolis – Chair

STUDENT VOLUNTEERS

Tiffany Leverenz, Wichita State U.
Changwon Son, Texas A&M U.
Cristina Roy, Embry-Riddle Aeronautical U.
Shimeng Du, U. of Wisconsin-Madison

HUMAN FACTORS AND ERGONOMICS SOCIETY OFFICERS

President
Valerie J. Berg Rice

Secretary-Treasurer
Carolyn M. Sommerich

Executive Council At-Large
Members

Immediate Past President
Nancy J. Cooke

Immediate Past
Secretary-Treasurer
S. Camille Peres

Ellen Bass
Sara J. Czaja
Paul A. Green
M. Susan Hallbeck
Richard J. Holden
David M. Rempel

President-Elect
Kermit G. Davis

Secretary-Treasurer-Elect
Christopher R. Reid

HUMAN FACTORS AND ERGONOMICS SOCIETY DIVISION CHAIRS

Education
Beth Blickensderfer

Outreach
Karen Jacobs

Technical Standards
Robert R. Fox

Internal Affairs
Jennifer M. Riley

Scientific Publications
William J. Horrey

HUMAN FACTORS AND ERGONOMICS SOCIETY STAFF

Interim Executive Director
Julie Freeman

Communications Director
Lois Smith

Member Services Director
Carlos de Falla

Administrative Assistant
Susan Marschner

Senior Production Editor
Steve Stafford

Member Services Coordinator
Stefanie Alexander

SPONSORS

HFES thanks the following organizations for their support:

GOLD SPONSORS



HEALTHcare
HumanFACTORS



EXHIBITORS

The following companies invite you to visit their exhibits in the Grand Ballroom Foyer from 10:00 a.m. to 6:00 p.m. on Monday and from 8:00 a.m. to 6:00 p.m. on Tuesday.



A Flex Company

Table 1

BOARD OF CERTIFICATION IN
PROFESSIONAL ERGONOMICS



Table 2



Table 3



Table 4



Designing the future of healthcare.

Table 5



Table 6



Table 7



Table 8



Table 9



Table 10



Table 11

REGISTRATION & FACILITIES

REGISTRATION DESK LOCATION AND HOURS

Registration is open during the following hours at Registration Desk B:

Sunday	7:00 a.m.–6:30 p.m.
Monday	7:00 a.m.–5:00 p.m.
Tuesday	7:30 a.m.–5:00 p.m.
Wednesday	8:00 a.m.–2:00 p.m.

WIFI ACCESS

Complimentary WiFi is provided in the meeting space for HFES attendees. To connect to the Internet, please select the HFES wireless network and enter HCS2018 for the password.

LUNCH AND REFRESHMENT BREAKS

Lunch and refreshment breaks are included in the cost of registration and will take place at the following times and locations:

Refreshment Breaks

Sunday: for workshop attendees only: Salon H; 7:30–8:00 a.m., 10:00–10:30 a.m., and 3:00–3:30 p.m.

Monday–Tuesday: Grand Ballroom Foyer; 8:00–8:30 a.m., 10:00–10:30 a.m., and 3:00–3:30 p.m.

Wednesday: Grand Ballroom Foyer & Back Bay Foyer; 8:00–8:30 a.m., 10:00–10:30 a.m.; and 3:30–3:45 p.m.

Lunch

Monday and Tuesday: Salon G; 12:00–1:30 p.m.

POSTER RECEPTIONS

Poster receptions will be held from 4:30 to 6:00 p.m. on Monday and Tuesday in Gloucester. All attendees are invited to network and view the posters.

Posters may be set up on Monday and Tuesday between 1:00 and 4:00 p.m. Presenters can enter the poster area at 4:15 p.m. to staff their boards before attendees arrive.

Posters should be removed by 6:30 p.m. on their respective presentation days.

XIMEDICA RECEPTION

A reception sponsored by Ximedica will take place following the Tuesday poster reception from 6:00 to 9:00 p.m. in the 3rd Floor Atrium. Attendees will receive one complimentary drink ticket. Light appetizers will be served.

RESOURCES

HFES MEMBER SERVICES

HFES staff will be present at Registration Desk B to provide information on membership, publications, and services.

JOB NOTICES AND OTHER MATERIALS

Organizations that are offering positions may post a flyer on the corkboard adjacent to Registration Desk B. Attendees who are seeking a job may also post a one-page notice on the board. A materials table is also provided in this area for attendees to place information about events, programs, and other activities of interest to other attendees.

AUDIOVISUAL PREVIEW ROOM

Room MIT has been reserved for presenters who wish to preview their audiovisual materials. Computers will be available for AV preview only. Preview hours are as follows:

Monday	8:00 a.m.–5:00 p.m.
Tuesday	7:30 a.m.–5:00 p.m.
Wednesday	7:30 a.m.–2:00 p.m.

POLICIES

ATTENDEE BADGES

All persons attending any event at the symposium must wear their registration badges. Attendees and guests may register at Registration Desk B.

AUDIOTAPING, PHOTOGRAPHING, AND VIDEOTAPING POLICIES

Attendees are not permitted to take photos or make audiotape or videotape recordings of speakers or their visual aids, or exhibitors and their displays, without prior written permission from HFES and the speakers or exhibitors. Please submit written permission at Registration Desk B.

HFES reserves the right to use photographs of attendees for promotional purposes. If you do not want HFES to use your photo, please send an opt-out message to Lois Smith at lois@hfes.org.

SMOKING POLICY

All public areas of the Boston Marriott Copley Place Hotel are non-smoking.

Note: An asterisk (*) to the left of a presentation in this program indicates that a proceedings paper is available. Log in to your HFES account for access or follow this link for more information: <http://journals.sagepub.com/toc/hcsa/current>.

PROGRAM

SUNDAY, MARCH 25

REGISTRATION SERVICES

7:00 a.m.–6:30 p.m.

Location: Registration Desk B

REFRESHMENT BREAK

7:30–8:00 a.m.

For Workshop Attendees Only

Location: Salon H

PRE-SYMPOSIUM FDA MORNING WORKSHOP: Validation of Combination Drug Products: An FDA Workshop

(separate registration fees apply)

Sunday, March 25, 8:00 a.m.–12:00 p.m.

Location: Salon H

Chair: Anthony D. (Tony) Andre, Interface Analysis Associates

Presenters: Irene Z. Chan, PharmD, BCPS, CDR, U.S. Public Health Service, Deputy Director, Division of Medication Error Prevention and Analysis, FDA/CDER/OSE/OMEPRM/DMEPA; Nicole Garrison, PharmD, BCPS, Safety Evaluator, Division of Medication Error Prevention and Analysis, FDA/CDER/OSE/OMEPRM/DMEPA

REFRESHMENT BREAK

10:00–10:30 a.m.

For Workshop Attendees Only

Location: Salon H

LUNCH BREAK

12:00–1:15 p.m.

PRE-SYMPOSIUM FDA AFTERNOON WORKSHOP: Improving the Safety and Effectiveness of Medical Devices Through Human Factors Considerations: An Interactive Workshop (separate registration fees apply)

Sunday, March 25, 1:30–5:30 p.m.

Location: Salon H

Chair: Anthony D. (Tony) Andre, Interface Analysis Associates

Presenters: Hanniebey Wiyor, LT, U.S. Public Health Service, Human Factors Reviewer, Human Factors Pre-market Evaluation Team, FDA/CDRH/DAGRID/HFPMET; Xin Feng, Human Factors Reviewer, Human Factors Pre-market Evaluation Team, FDA/CDRH/DAGRID/HFPMET; Rita Lin (Human Factors Reviewer, Human Factors Pre-market Evaluation Team, FDA/CDRH/DAGRID/HFPMET

Sunday, March 25 – Monday, March 26

REFRESHMENT BREAK

3:00–3:30 p.m.

For Workshop Attendees Only

Location: Salon H

OPENING NETWORKING RECEPTION

5:30–6:30 p.m.

Location: 3rd Floor Atrium

MONDAY, MARCH 26

REGISTRATION SERVICES

7:00 a.m.–5:00 p.m.

Location: Registration Desk B

REFRESHMENT BREAK

8:00–8:30 a.m.

Location: Grand Ballroom Foyer

OPENING PLENARY SESSION

Monday, March 26, 8:30–10:00 a.m.

Location: Salon F

Chairs: Joseph R. Keebler, Embry-Riddle Aeronautical U.; Anthony D. (Tony) Andre, Interface Analysis Associates

Keynote Address: Josie's Story: Family-Centered Approaches to Patient Safety, Sorrel King, Patient Safety Advocate

REFRESHMENT BREAK

10:00–10:30 a.m.

Location: Grand Ballroom Foyer

EXHIBITS

10:00 a.m.–6:00 p.m.

Location: Grand Ballroom Foyer

SESSIONS

10:30 a.m.–12:00 p.m.

CCITI – Cognitive Engineering Applications

Clinical and Consumer Health Care IT Track

Monday, March 26, 10:30 a.m.–12:00 p.m.

Location: Exeter

Lecture Session

Chair: Plinio Morita, U. of Waterloo

- * 1. **Decision-Making for Alternative Procedures: Navigating the Tradeoffs Between Clinical Effectiveness, Patient Safety, Financial and Organizational Pressures, and Patient Comfort**, Mike Rayo, Chandni Pawar, Elizabeth Sanders, Beth Liston, and Emily Patterson, Ohio State U.

* Proceedings paper available

2. **Using Cognitive Engineering Methods to Evaluate IT Systems: Developing User Feedback Questionnaires Around Cognitive Support Design Objectives**, Emilie Roth, Roth Cognitive Engineering; Ann Bisantz, U. at Buffalo, SUNY; A. Zachary Hettinger, Medstar Inst. for Innovation

- * 3. **More Than Information Access: A Cognitive Work Analysis on Physician-Pharmacist Collaboration Through Electronic Medical Records**, Jessie Chin, U. of Illinois at Chicago; Melissa Yu, Kelly Grindrod, and Catherine Burns, U. of Waterloo

HE1 – Electronic Health Records Hospital Environments Track

Monday, March 26, 10:30 a.m.–12:00 p.m.

Location: Arlington (Panel) and Suffolk (Lecture) Panel and Lecture

1. **Panel: Surveillance Methods for EHR Safety Risks: A Panel Discussion**

Chair: Naveen Muthu, Children’s Hospital of Philadelphia

Panelists: Evan Orenstein, Children’s Hospital of Philadelphia; Allan Fong and A. Zachary Hettinger, Medstar National Center for Human Factors in Healthcare; Lorraine Possanza, ECRI Inst.

2. **Lecture: Once More, With Feeling: Emotional Design**, Paul Weaver, Cerner

Chair: Brandan Kennedy, Children’s Mercy Kansas City

MDD1 – Demystifying HF Considerations – FDA’s 2017 Generics and Interchangeable Biosimilars Guidance Documents

Medical and Drug-Delivery Devices Track

Monday, March 26, 10:30 a.m.–12:00 p.m.

Location: Salon F

Panel Session

Chairs: Rachel Aronchick and Allison Strohlic, UL-Wiklund

Panelists: Irene Z. Chan, FDA; Brian Holly, Pfizer; Valerie Fenster, Amgen; Lee Wood, medHF; Sherri Biondi, Genentech

- * **PSRII – Human Factors Approaches to Improving Health Equity: Where Have We Been and Where Should We Go Next?**

Patient Safety Research and Initiatives Track

Monday, March 26, 10:30 a.m.–12:00 p.m.

Location: Clarendon

Panel Session

Chair: Natalie Benda, MedStar Health

Panelists: Angela Thomas, MedStar Health; Rupa Valdez, U. of Virginia; Enid Montague, DePaul U.; Deliya Wesley, MedStar Health

LUNCH (Provided)

12:00–1:30 p.m.

Location: Salon G

SESSIONS

1:30–3:00 p.m.

CCIT2 – Understanding Work

Clinical and Consumer Health-Care IT Track

Monday, March 26, 1:30–3:00 p.m.

Location: Exeter

Lecture Session

Chair: Farzan Sasangohar, Texas A&M U.

1. **Optimizing Rounds in the ICU: Applying Workflow-Centric Human Factors to the Prototyping of a Decision-Support System**, Sylvain Bruni, Aptima
2. **Clinical Decision Making in a Sea of Displays**, MaryBeth Privitera, HS Design/U. of Cincinnati
- * 3. **Improving Discharge Documents to Better Support Care Transitions**, Patrice Tremoulet, Rowan U.; Ramya Krishnan, ECRI Inst.
4. **Characterizing Workflow in Nursing Homes**, Mustafa Ozkaynak, Cynthia Drake, Blaine Reeder, and Peter Ferrarone, U. of Colorado-Anschutz Medical Campus; Barbara Trautner, Baylor College of Medicine; Heidi Wald, U. of Colorado-Anschutz Medical Campus

HE2 – Hospital Environments Hospital

Environments Track Monday, March 26, 1:30–3:00 p.m.

Location: Arlington (Panel) and Suffolk (Lecture)

Panel and Lecture Session

1. **Panel: Survival and Success in Clinically Embedded Human Factors Practice**
Chair: Ken Catchpole, Medical U. of South Carolina
Panelists: Tara Cohen, Cedars-Sinai Medical Center; Joy Rivera, Children’s Hospital of Wisconsin; Brittany Anderson-Montoya, Carolinas HealthCare System; Shelley Jeffcott, National Health Service Scotland (NHSS)
2. **Lecture: Challenges in Pediatric Hospital Medicine – Transitions From Training and Challenges Within the Workforce**, Sophia Sterner and Lisa Carney, Children’s Mercy Hospital and Clinics; Sonia Chaudhry, Connecticut Children’s Medical Center; Heather Dahlquist, Yale-New Haven Children’s Hospital; Angie Etzenhouser, Children’s Mercy Hospital and Clinics; Alexander Hogan and Beth Natt, Connecticut Children’s Medical Center
Chair: Raymond Chan, Children’s Mercy Hospitals

MDD2 – Artificial Pancreas Technologies

Medical and Drug-Delivery Devices Track

Monday, March 26, 1:30–3:00 p.m.

Location: Salon F

Lecture Session

Chair: Mike Dunkley, Continuum

1. **Designing Across the User Spectrum for the Hybrid-Closed-Loop Artificial Pancreas System**, Sandhya Pillalamarri, Insulet Corporation
2. **Using a Commercially Available Smartphone as the Primary User Interface for a Class 3 Medical Device**, Jaclyn Baron, Bigfoot Biomedical

PSRI2 – The Historic Scientific Contribution of the Late Robert Wears, MD

Patient Safety Research and Initiatives Track

Monday, March 26, 1:30–3:00 p.m.

Location: Clarendon

Panel Session

Chair: Shawna Perry, U. of Florida

Panelists: Ann Bisantz, U. at Buffalo, SUNY; A.

Zach Hettinger, National Center for Human Factors

in Healthcare-MedStar Health; Pascale Carayon, U.

of Wisconsin-Madison; Emilie Roth, Roth Cognitive

Engineering; David Woods, Ohio State U.; Richard Cook,

Ohio State U.

REFRESHMENT BREAK

3:00–3:30 p.m.

Location: Grand Ballroom Foyer

SESSIONS

3:30–4:30 p.m.

CCIT3 – Mobile Health Applications for Consumers Student Design Competition

Clinical and Consumer Health-Care IT Track

Monday, March 26, 3:30–4:30 p.m.

Location: Exeter

Lecture/Award Session

Chair: Richard Holden, Indiana U.-Indianapolis

Following presentation of the finalists listed below, the award will be presented.

1. **Care Connect**, Kristen Webster, Johns Hopkins
2. **EasyHealth – An Integrated Health Monitoring and Management App for Seniors**, Sommayah Soliman, Harshada Tupe, Mai Chee Vang, and Javy Wang, San Jose State U.
3. **Recordr. – Facilitating Patient Self-Advocacy and Enabling Large-Scale Human Factors Research**, Marisa Grayson, Ohio State U.

HE3 – Burnout

Hospital Environments Track

Monday, March 26, 3:30–4:30 p.m.

Location: Arlington

Lecture Session

Chair: Raymond Chan, Children's Mercy Kansas City

1. **How LEAN Can Reduce Provider Stress as Well as Improve Organizational Efficiency**, Michael Beck, Penn State Pediatric Hospital Medicine
2. **Understanding Primary Care Clinician Burnout Through Physiologic Response, Workflow, and the Environment**, Akhila Iyer, MedStar Inst. for Innovation; Jordan Smith, Steelcase Health; Joseph Blumenthal, MedStar Inst. for Innovation; Michelle Ossmann, Steelcase Health

MDD3 – Increasing Realism in Human Factors Testing

Medical and Drug-Delivery Devices Track

Monday, March 26, 3:30–4:30 p.m.

Location: Salon F

Lecture Session

Chairs: Elizabeth Roche, Ximedica; Molly Story, Sanofi

1. **Leveraging AR/VR in Human Factors Research to Increase Realism and Reduce Time and Cost**, Laura Chang, Radius Innovation & Development
2. **Applying the Lens to the Examiner: Using Ethnography to Uncover and Correct Flaws in Validation Testing of Complex Robotic Systems**, Kathryn Rieger, Cognitive Design; Kate Knudsen and Daniel Nissenbaum, Intuitive Surgical, Inc.

PSRI3 – Communication

Patient Safety Research and Initiatives Track

Monday, March 26, 3:30–4:30 p.m.

Location: Clarendon

Lecture Session

Chairs: Allen Fong, National Center for Human Factors in Healthcare; Shilo Anders, Vanderbilt U.

1. **Identifying and Classifying Communication Failures in Healthcare: Developing Methods to Reduce Communication-Related Incidents**, Milisa Manojlovich, Elizabeth Umberfield, and Amir Ghaferi, U. of Michigan; Sarah Krein, Department of Veterans Affairs
- * 2. **Neurodynamic and Communication Analysis of Healthcare Teams During Simulation Debriefings**, Ron Stevens, UCLA School of Medicine / The Learning Chameleon; Ann Willemsen-Dunlap, Order of Saint Francis Hospital; Jamie Gorman, Georgia Tech; Trysha Galloway, The Learning Chameleon, Inc.; Donald Halpin, Order of Saint Francis Hospital

3. **Information Management Goals and Process Failures During Home Visits for Older Adults Receiving Skilled Home Health Care Services After Hospital Discharge: A Multisite, Qualitative Study**, Alicia Arbaje and Ashley Hughes, Johns Hopkins U.; Nicole Werner, U. of Wisconsin-Madison; Bruce Leff and Ayse Gurses, Johns Hopkins U.

POSTER RECEPTION

4:30–6:00 p.m.

Location: Gloucester

CCIT-POSI – Poster Reception

Clinical and Consumer Health-Care IT Track

Monday, March 26, 4:30–6:00 p.m.

Location: Gloucester

1. **Poorly Designed Health Apps Can Do More Harm Than Good**, Arathi Sethumadhavan and Adam Shames, Core Human Factors, Inc.
- * 2. **Understanding Individual Differences in Use of Historical-Data-Based Decision Support Tools for Time Estimation in Medical Dispatch**, Wayne Giang, Canmanie Teresa Ponnambalam, Xiaonian He, and Birsen Donmez, U. of Toronto
- * 3. **Preoperative Medication Management: Reconciling Differences Across Clinical Sites**, Benjamin Duncan, Lu Zheng, Bradley Doebbeling, Andrew Solomon, and Stephanie K. Furniss, Arizona State U.; Adela Grando, Mayo Clinic; M. M. Burton, Arizona State U.; Karl A. Poterack, Timothy Miksch, and Richard A. Helmers, Mayo Clinic; David R. Kaufman, Arizona State U.
- * 4. **Triage Nurses Decision Support Application Design**, Tamari Levis, Dagan Schwartz, and Yuval Bitan, Ben-Gurion U.
5. **Utilizing the User Centered Design Process to Build a Novel Interruption Management Tool for Noncritical Tasks in the Emergency Department**, Hannah O’Toole, CapTech Consulting; Jessica Howe, Katie Adams, Allan Fong, and Kathryn Kellogg, MedStar Inst. for Innovation
6. **Visualizing the Determinants of Health**, Edwin Choi, Involution Studios
- * 7. **Evaluating the Persuasiveness of a Corporate Wellness Program’s Web-Based Learning Interfaces**, L. S. Platt, SUNY Binghamton/UMNSystems; Huiyang Li, SUNY Binghamton; Catherine Bass, Onlife Health
8. **Design Thinking, As Applied to New Products in the Physician-Consumer Space**, Jack Fleming, athenahealth | Epocrates
9. **System Analysis of an Intervention to Improve Opioid Prescribing in Emergency Medicine**, Enid Montague and Mary Bungum, DePaul U.; D. Mark Courtney, Stephanie Gravenor, Ryan McConnell, Alyssa Czerniak, and Mike Wolf, Northwestern U.; Lauren Sherman, DePaul U.; Danielle McCarthy, Northwestern U.
10. **Qualitatively Assessing Influences on the Medication Management Strategies of Older Adults With Hypertension**, Kenneth Blocker and Wendy Rogers, U. of Illinois at Urbana-Champaign
11. **The Development of the Healthcare Technology Acceptance Model (H-TAM) for Older Adults: A Conceptual Model**, Maurita T. Harris and Wendy A. Rogers, U. of Illinois at Urbana-Champaign
12. **Myoelectric Prosthesis Training for Children: A Gamification and User Experience Approach**, Paul Barclay, Matt Dombrowski, Peter Smith, and Ryan Buysens, U. of Central Florida
- * 13. **Minimizing the Impact of Interoperability Errors on Clinicians**, Jolie Dobre and Tippy Carter, CSRA; Jennifer Herout and Amanda Cournoyer, U.S. Department of Veterans Affairs
14. **How Human Factors Can Contribute to the Design of Standards for Ambient Assisted Living (AAL) Technology**, Laura Fadrique and Dia Rahman, U. of Waterloo; Helene Vaillancourt and Tania Donovska, CSA Group; Plinio Morita, U. of Waterloo
15. **“Too Busy to Tell Where the Alarms Are Coming From”: A Study on the Relationship Between Workload and Alarm Localizability**, Judy Edworthy, Scott Reid, Katie Peel, Samantha Cox, Jessica Williams, Chloe Newbury, Joseph Foster, and Martin Farrington, Plymouth U.
16. **Using Smart Thermostat Data for Remote Monitoring**, Kirti Sundar Sahu, Arlene Oetomo, Raphael Nobrega, Marc Ryan Ting, and Plinio Morita, U. of Waterloo
17. **Studio 1 Labs: User-Centered Evaluation of a Functional Bedsheet: Benefits, Change in the Routine, Impact, Behavior Change**, Laura Fadrique and Yevgeniy Davletshin, U. of Waterloo; Olivia Y.-H. Lin and Edward S. Shim, Studio 1 Labs; Plinio Morita, U. of Waterloo
18. **Information Fragmentation in the Electronic Health Record: The Case of Pulmonary Embolism Diagnosis in the ED**, Yudi Wang, U. of Wisconsin-Madison; Brian Patterson and Shashank Ravi, U. of Wisconsin-Madison School of Medicine and Public Health; Douglas Wiegmann, Ann Hundt, and Peter Hoonakker, U. of Wisconsin-Madison; Peter Kleinschmidt, U. of Wisconsin-Madison School of Medicine and Public Health; Megan Salwei, Emily Wirkus, and Pascale Carayon, U. of Wisconsin-Madison
19. **Parental Awareness of Schoolbag Carriage: A Comparative Study of Irish and United States Parents**, Karen Jacobs, Boston U.; Sara Dockrell,

School of Medicine, Trinity College; Dagny Barclay and Sabrina Rodriguez, Boston U.

20. **Toward the Design of mHealth Technologies to Support Holistic Wellness Among Older Adults**, Christina Harrington and Jon Sanford, Georgia Inst. of Technology; Wendy Rogers, U. of Illinois Urbana-Champaign
- * 21. **A Systematic Method for Using Critical Decision Method Interviews to Generate a Garden Path Scenario for Human-in-the-Loop Simulations for Training and Evaluation of New Technologies**, Laura Militello and Christen Sushereba, Unveil, LLC; Simon Fernandez, David Bahner, and Emily Patterson, Ohio State U.
22. **A Framework for Designing an Ergonomic Point of Care (POC) Cart for Medical Documentation Management**, Michelle Murphy, Partners Healthcare
23. **Design of a Multimodal Interface Solution to Facilitate Nonmedical User Mediation of TBI Screening Using Virtual Reality**, Michael Jenkins, David Young, and Arthur Wollocko, Charles River Analytics

HE-POSI – Poster Reception

Hospital Environments Track

Monday, March 26, 4:30–6:00 p.m.

Location: Gloucester

- * 24. **Patient Decompensation and Alarm Technology: An Observational Study**, Chelsea R. Horwood, Michael F. Rayo, Morgan Fitzgerald, E. Asher Balkin, and Susuan Moffatt-Bruce, Ohio State U.
25. **Understanding the Noise: Categorizing the Impact of Clinical Workflow, Behavioral and Environmental Factors on Physiological Sensors**, Tracy Kim and Kathryn Kellogg, National Center for Human Factors in Healthcare, MedStar Health; Matthew Nare, California State U.; Joseph Blumenthal and Allan Fong, National Center for Human Factors in Healthcare, MedStar Health
26. **Investigation of Ergonomic Guideline Awareness Among Surgeons**, Kiana Kia and Xinhui Zhu, Oregon State U.
27. **The Influence of Spatial Layouts on the Frequency of Usage of Hand Sanitizing Stations in Health-Care Environments**, Jun Rong Jeffrey Neo and Rana Sagha Zadeh, Cornell U.; Srisatish Devapatla and Ramesh Vidavalur, Cayuga Medical Center
28. **A Targeted Assessment of Hospitalists Simulation-Based Educational Needs**, Lisa Carney and Chris Kennedy, Children’s Mercy Hospital
29. **Participatory Redesign of a NICU Feeding Delivery System**, Leah Konwinski and Leanne Wendt, Spectrum Health Helen DeVos Children’s Hospital
30. **Collaborative Design: Interprofessional Perspectives on Incorporating Human Factors and Simulation in the Design and Renovation of Health-Care Facilities**, Jessica Ray and Stephanie Sudikoff, Yale New Haven Health; Ben Smuckler, Shepley Bulfinch; Peter Majewski, Bridgeport Hospital
- * 31. **Evidence-Based Sourcing: How to Select Health Care Products Using Human Factors Techniques**, Helen Fuller, Timothy Arnold, and Tandi Bagian, Veterans Health Administration
32. **Bringing the UX Momentum to Health-Care Facilities – Be a Part of It!** Shannon Halgren and Jody Solem, Sage Research & Design
33. **Communicating Effectively With Clinical End-Users About Desired Performance Outcomes During the Health-Care Facility Design Process**, Anjali Joseph, Deborah Wingler, Herminia Machry, and Sara Bayramzadeh, Clemson U.
34. **Assessing Nontechnical Skills in Gastrointestinal Endoscopy: Do Better Skills Improve Patient Outcomes?** Charlotte Hitchins, Plymouth Hospitals NHS Trust; Judy Edworthy, Plymouth U.; Magdalena Metzner and Catherine Ward, Plymouth Hospitals NHS Trust
- * 35. **I’m Lost: An Evaluation of An Interactive Wayfinding System**, Tyler Duke and Angie Avera, U. of Houston-Clear Lake; Christy Harper, End To End User Research; Andrea Crosser and Spencer Jefferies, U. of Houston-Clear Lake
36. **Understanding Medication Reconciliation in the Ambulatory Setting Using a Systems Approach**, Leah Konwinski and Emily D’Anna, Spectrum Health Helen DeVos Children’s Hospital
37. **Developing and Testing a Pediatric Resuscitation Memory Prompt**, Robert Schremmer, Children’s Mercy Hospital
38. **Future Scenarios: The Intersection of Design and Story**, Ryan Sohlden, Medtronic
39. **Interruptions as Experienced by Attendings, Nurses, and Residents in the Emergency Department: A Comparison**, Hunter J. Hawthorne, Katherine L. Forsyth, and Renaldo C. Blocker, Mayo Clinic
40. **Developing Evidence-Based Ergonomics Guidelines for Med/Surg Patient Room Design to Meet the Needs of All Occupational Stakeholders, Patients, and Visitors**, Steven Lavender, Carolyn Sommerich, Elizabeth Sanders, Kevin Evans, Jing Li, and Emily S. Patterson, Ohio State U.
41. **Macro-cognition: A Framework for Optimal ICU Design and Interprofessional Team Interactions – From Method to Theory Development – mHCBE**, Susan O’Hara, Clemson U.; Emily S. Patterson, Ohio

State U.; Robin Toft Klar, New York U.; Jim Fackler, Johns Hopkins U. School of Medicine; Judy Ascenzi, Johns Hopkins Hospital

42. **Feasibility and Acceptability of Text Messaging as a Supplementary Channel of Communication Between Parents and NICU Staff**, Hernan Sierra, Michelle Cora, Jose Urbina, Paula Zafra, Susie Kim, and Ben Gerber, UIC

MDD-POSI – Poster Reception

Medical and Drug-Delivery Devices Track

Monday, March 26, 4:30–6:00 p.m.

Location: Gloucester

43. **Broaden Your Market: Follow Accessibility Standards**, Molly Story, Sanofi; Melissa Lemke, Agilis Consulting Group
44. **Developing and Testing User Interface Requirements**, Tara Feuerstein and Kelly GordonVaughn, Farm Design
45. **Overcoming Hospital Access Issues to Benefit Medical Device Design**, Natalie Abts and Rebecca Butler, MedStar Inst. for Innovation; Bidisha Roy, MedStar Inst. for Innovation, MedStar Health
46. **Anatomy of a Good Use Error Risk Assessment (UERA)**, Wende Dewing, Usensus LLC; Elizabeth Volk, Phillips-Medisize, LLC
47. **How “Smart” Are IV Smart Pumps?** Karen Giuliano, Northeastern U.; Kristi Campoe, Pasco-Hernando State College; Kristy Fitzgerald, Adventist Health Central Valley Network
48. **An Autoinjector Hold Time Formative Study for Immunology Patients**, Kevin Cluff and Chuan Li, AbbVie; Bryan Manis, GfK
49. **Challenges and Solutions in Home Care Human Factors**, Russell Branaghan, Arizona State U.; Molly Story, Sanofi; Angela Muriset, Shire; Sami Durrani, Fresenius Medical Care; Keith Karn, Human Factors in Context LLC
50. **Anticipating and Addressing Sources of Transfer in the Design Process**, Matthew Marber, Limor Hochberg, and Merrick Kossack, UL-Wiklund
51. **Color, Typography, and Composition: Effective Design for Medical Device User Documents**, Isabel Campos-Noonan and Kyle Carbone, UL-Wiklund
52. **Maximizing the Benefits of Contextual Inquiry**, Chris White, Kinneir Dufort
53. **Expert Elicitation of Use Error Probabilities for Combination Product Risk Assessment**, Nicholas Zampa, Biogen
54. **Team Communication: A Persistent Problem Across Hospital Environments**, Emily Hildebrand, Research Collective; Matthew Johnson, Children’s Mercy Kansas City; Elizabeth Lazzara, Embry-Riddle Aeronautical U.; Katherine Forsyth, Mayo Clinic

55. **Interaction With a Semiautomated Hearing Aid: A Field Study**, Qi Yang, GN Advanced Science; Shira Hahn, Aural Analytics, LLC; Bill Chang and Gregory Olsen, GN Advanced Science
56. **Balancing Aesthetics and Usability in Medical Device User Interface Design**, Valerie Ng and Jon Tilliss, UL-Wiklund
57. **Fine Tuning Heuristic Evaluations for Medical Devices of All Shapes and Sizes**, David Powers, Susan McDonald, and Meredith Schwarz, Ximedica

PSRI-POSI – Poster Reception

Patient Safety Research and Initiatives Track

Monday, March 26, 4:30–6:00 p.m.

Location: Gloucester

58. **Identifying and Classifying Flow Disruptions in Perioperative Orthopedic Care**, Jordan Hilgers, Embry-Riddle Aeronautical U.; Tracy Litzinger, Flagler College; Timothy Disher, Victoria Lew, Cristina Roy, Allison Larsen, Brett Nalezinski, and Albert Boquet, Embry-Riddle Aeronautical U.
59. **VTE Education and Prevention**, Kristen Webster, Elliott Haut, Michael Streiff, Brandyn Lau, Dauryne Shaffer, and Peggy Kraus, Johns Hopkins U.
60. **A Systems Approach to Designing Safer Opioid Prescribing Processes in Primary Care**, Annie Shutt and James Benneyan, Healthcare Systems Engineering Inst. of Northeastern U.
61. **Evaluating Clinical Decision Support in Emergency Medical Services**, Logan Gisick and Barbara Chaparro, Embry-Riddle Aeronautical U.; Tiffany Leverenz and Paul Misasi, Wichita State U.
62. **Effects of Communication Processes on Handoff Efficiency**, Kristen Webster, Johns Hopkins U.; Elizabeth Lazzara and Joseph Keebler, Embry-Riddle Aeronautical U.
63. **Assessing the Usability and Cognitive Load of an Electronic Safety Dashboard in the Context of Opioid Prescribing: Preliminary Results**, Theresa Fuller, Brigham and Women’s Hospital; Pamela M. Neri, Partners Healthcare Information Systems; Demetri Lemonias, Northeastern Healthcare Systems Engineering; Elizabeth Harry and Jeffrey L. Schnipper, Brigham and Women’s Hospital; Erin Joyce, Thomas Martell, and Nicole Nehls, Northeastern Healthcare Systems Engineering; David W. Bates and Anuj K. Dalal, Brigham and Women’s Hospital; James C. Benneyan, Northeastern Healthcare Systems Engineering
64. **Investigating Drivers of Clinician Workload in the Emergency Department: An Exploratory Study**, Natalie Benda, Joseph Blumenthal, Aaron Hettinger, Daniel Hoffman, and Ella Franklin, MedStar Health; David Lavergne, U. at Buffalo, SUNY; Emilie Roth,

- Roth Cognitive Engineering; Shawna Perry, U. of Florida – College of Medicine; Ann Bisantz, U. at Buffalo, SUNY
65. **Using HFACS-Healthcare to Investigate Near-Miss Events During Surgery**, Tara Cohen and Sarah Francis, Cedars-Sinai Medical Center; Douglas Wiegmann, U. of Wisconsin-Madison; Bruce Gewertz, Cedars-Sinai Medical Center
 - * 66. **These Aren't the Triads You're Looking For: Updating Clinician Mental Models of Acute Spinal Cord Compression**, Christine Jefferies, Danielle Mosby, Rebecca Kowalski, Joseph Blumenthal, and Allan Fong, MedStar Inst. for Innovation; Susan O'Mara, MedStar Washington Hospital Center; Rollin J. Fairbanks and Kristen Miller, MedStar Inst. for Innovation
 67. **From Safety-I to Safety-II: Using Systems Engineering to Redesign a Hospital Care to Home Care Transition Process**, Ashley Holmes and James Benneyan, Northeastern U.
 68. **Using Systems-Theoretic Process Analysis (STPA) to Design Safer Opioid Prescribing Processes**, Basma Bargal, Joseph Eisner, and Margo Jacobsen, Healthcare Systems Engineering Inst.; Alev Atalay, BWH; James Benneyan, Healthcare Systems Engineering Inst.
 - * 69. **It's Like Scanning the Spoon: Problems and Interventions in Insulin Pen Safety**, Susan Harkness Regli, Suzanna Ho, Margaret Yoho, Ilona Lorincz, Rebecca Stamm, Melissa Hibbs, and Terese Kornet, U. of Pennsylvania Health System
 70. **Examples and Experiences Using FMEA to Design Better Healthcare Processes**, Ashley Holmes, Demetri Lemonias, Melissa Cyr, and James Benneyan, Northeastern U.
 - * 71. **Identifying Improvements in Healthcare System Engineering Models for Chronic Care and Precision Medicine Applications**, Michelle Jahn, Siobhan Heiden, and Barrett Caldwell, Purdue U.
 72. **Now What? Determining and Implementing Solutions Post STS Analysis**, Vicki Lewis, Healthcare Safety Strategies, LLC; Andrea Fantegrossi and Jeremiah Schuur, Brigham and Women's Hospital
 73. **Translating Error Detection Into Patient Safety Action**, Isaac Lynch, UT Southwestern Medical Center
 74. **The Effects of Occupational Fatigue on Patient Handling Tasks Among Nurses and Patient Handlers**, Adam Piper and Lauren Estridge-Zwanzig, South Dakota School of Mines & Technology
 75. **Usability and Effectiveness of Medial Checklist Designs**, Anna Clebone, U. of Chicago; Barbara Burian, NASA Ames Research Center
 - * 76. **A Mixed-Methods Approach to Tailoring Evidence-Based Guidance for Antibiotic Stewardship to a Hospital**, Emily S. Patterson, Courtney Dewart, Kurt Stevenson, Mark Lustberg, and Erinn Hade, Ohio State U.; Nirav Shah, Northshore U. Health System; Courtney Hebert, Ohio State U.
 - * 77. **Applications of Psychophysiological Measures in Clinical Settings: Studies in Simulation, Surgery, and the Lab**, Sarah Henrikson Parker and Lauren Kennedy, Virginia Tech Carilion Research Inst.; Scott Pappada, U. of Toledo; Nathan Lau, Virginia Tech; Thomas Papadimos, U. of Toledo College of Medicine and Life Sciences
 78. **Examining the Event Review Process From a Patient Safety Professional's Point of View at MedStar Health**, Jessica Howe, Andrew Stets, and Kathryn Kellogg, MedStar Health
 - * 79. **Biomechanical Characterization of the Hand Touch Corrective Behavior in the Frail Elderly During Bed Egress**, Dorothy Taylor, Andrew Merryweather, and Janice Morse, U. of Utah
 80. **Improved Usability of a Multi-Infusion Setup Using a Centralized Control Interface**, Frank Doesburg, U. Medical Center Groningen
 81. **Simulation as a Tool to Support Adaptive Capacity at the Frontline**, Mary Patterson, Children's National Medical Center; Ellen Deutsch, ECRI/ Pennsylvania Safety Authority
 82. **Are EMS Providers Willing to Ride in a Self-Driving Ambulance?** Joseph Keebler, Stephen Rice, and Scott Winter, Embry-Riddle Aeronautical U.
 83. **Application of a SHERPA-Based Safety Case Methodology for Managing Risks in Healthcare Medication Pathways**, David Embrey, Human Reliability Associates
 - * 84. **An Objective Method to Pain Measurement Based on Physiological Signals**, Yingzi Lin, Northeastern U.; Yan Xiao, U. of Texas at Arlington; Li Wang and Anas Abou Allaban, Northeastern U.; Richard Dutton, US Anesthesia Partners; Michael Ramsay, Baylor U. Medical Center; Richard Urman, Brigham and Women's Hospital

TUESDAY, MARCH 27

REGISTRATION SERVICES

7:00 a.m.–5:00 p.m.

Location: Registration Desk B

REFRESHMENT BREAK

8:00–8:30 a.m.

Location: Grand Ballroom Foyer

EXHIBITS

8:00 a.m.–6:00 p.m.

Location: Grand Ballroom Foyer

SESSIONS

8:30–10:00 a.m.

CCIT4 – Addressing Alarm Fatigue and Information Overload

Clinical and Consumer Health-Care IT Track

Tuesday, March 27, 8:30–10:00 a.m.

Location: Exeter

Lecture Session

Chair: Wayne Giang, U. of Toronto

- * 1. **Updating an International Medical Device Standard: A Process for Audible Alarms**, Judy Edworthy, Plymouth U.; Richard McNeer, Christopher Bennett, and Roman Dudaryk, U. of Miami
2. **Combating Alarm Fatigue in Medicine**, Trent Bryson, UT Southwestern
3. **EHR Copy and Paste: What Have We Learned and What Can We Do?** Lana Lowry and Mala Ramaiah, National Inst. of Standards and Technology

HE4 – Systems Engineering

Hospital Environments Track

Tuesday, March 27, 8:30–10:00 a.m.

Location: Arlington

Panel Session

1. **The Dirty Human Factors of Reprocessing: Best Practices in Design, IFU, and Testing**
Chair: Russell Branaghan, Arizona State U. & Research Collective
Panelists: Anthony D. (Tony) Andre, Interface Analysis Associates; Stephanie Seraphina, Intuitive Surgical, Inc.; Emily Hildebrand, Research Collective; Hanniebey Wiyor, FDA
2. **Resilience Engineering: Evidence in the Health Care Setting**
Chair: Renaldo C. Blocker, Mayo Clinic
Panelists: Katherine L. Forsyth, Mayo Clinic; Elizabeth A. Lay, Applied Resilience; Shawna J. Perry, U. of Florida-Jacksonville

MDD4 – Human Factors in Design Process

Medical and Drug-Delivery Devices Track

Tuesday, March 27, 8:30–10:00 a.m.

Location: Salon F

Lecture Session

Chairs: Audra Wright, Halyard Health; Keith Karn, Human Factors in Context LLC

- * 1. **Making Human Factors Affordable for Medical Device and Global Health Start-Ups**, Elizabeth Johansen, Spark Health Design, LLC
2. **Tackling the Daunting Task of Evaluating Legacy Devices for Compliance to IEC:62366-1:2015 per Annex C**, Staci Bienenfeld and Maria Swenson, Ximedica
3. **Fast Thinking, Slow Thinking, and Good Design: Are We Doing Enough to Apply the Learnings From Behavioral Economics to Medical Device Design?** Elizabeth Roche, Ximedica

PSRI4 – Root Cause Analysis: The HFE Practitioner's Journey from Individual Blame to System Fixes

Patient Safety Research and Initiatives Track

Tuesday, March 27, 8:30–10:00 a.m.

Location: Clarendon

Panel Session

Chair: A. Joy Rivera, Children's Hospital of Wisconsin
Panelists: Adjhaporn Khunlertkit, Bumrungrad International Hospital; Andrea Cooks, Cincinnati Children's Hospital Medical Center; Shanqing Yin, KK Women's & Children's Hospital, Singapore; Jessica L. Howe and Kathryn M. Kellogg, National Center for Human Factors in Healthcare, MedStar Inst. for Innovation; Mary Patterson, Children's National Medical Center; Ellen S. Deutsch, Pennsylvania Patient Safety Authority and Children's Hospital of Philadelphia; Joseph R. Keebler, Elizabeth Lazzara, and Elizabeth Blickensderfer, Embry-Riddle Aeronautical U.; Thomas D. Looke, Florida Hospital

REFRESHMENT BREAK

10:00–10:30 a.m.

Location: Grand Ballroom Foyer

SESSIONS

10:30 a.m.–12:00 p.m.

CCIT5 – eHealth and mHealth

Clinical and Consumer Health-Care IT Track

Tuesday, March 27, 10:30 a.m.–12:00 p.m.

Location: Exeter

Lecture Session

Chair: Ashley Hughes, U. of Illinois

1. **Evaluating Provider Use and Perceptions of a New Electronic Clinical Decision Support Mobile**

Application for Febrile Infant Decisions, Tiffany Leverenz, Wichita State U.; Sarah Fouquet, Ellen Kerns, and Russell McCulloh, Children's Mercy Kansas City

- * 2. **Nursing Student Remote Performance Assessment Using a Novel Smartphone Application**, Uwe Reischl and Olga Salinas, Boise State U.; Ron Oberleitner, Behavior Imaging, Inc.; Budimir Mijovic, U. of Zagreb
- 3. **Commercialization of mHealth & eHealth Technology in Canada**, Dia Rahman, U. of Waterloo; Eman Alanazi, Saudi Electronic U.; Plinio Morita, U. of Waterloo

HE5 – Interruptions and Environments

Hospital Environments Track

Tuesday, March 27, 10:30 a.m.–12:00 p.m.

Location: Arlington

Lecture Session

Chair: Matt Johnson, Children's Mercy Kansas City

- * 1. **Interruptions Increase Time and Decrease Accuracy of Chest Radiograph Interpretation**, Rachel Wynn and Jessica Howe, MedStar Health Research Inst.; Linda Kelahan, Georgetown U. Medical Center; Allan Fong, MedStar Health Research Inst.; Ross Filice, Georgetown U. Medical Center; Raj Ratwani, MedStar Health Research Inst.
- 2. **Perceptions of Interruptions in the Emergency Department**, Katherine Forsyth, Hunter Hawthorne, and Renaldo Blocker, Mayo Clinic
- * 3. **Optimizing Electronic Medical Record User Experience: A Human Factors Approach to Hardware Assessment and Design for Inpatient and Emergency Units**, Catherine Dulude (Campbell), Children's Hospital of Eastern Ontario (CHEO) & Ottawa Children's Treatment Centre (OCTC); Chantal Trudel, Carleton U.; W. James King, Karen Macaulay, and Jennifer Gillert, Children's Hospital of Eastern Ontario (CHEO) & Ottawa Children's Treatment Centre (OCTC), Leilla Czunyi and Sanaz Hafezi, Carleton U.

MDD5 – User Research in Device Design

Medical and Drug-Delivery Devices Track

Tuesday, March 27, 10:30 a.m.–12:00 p.m.

Location: Salon F

Lecture Session

Chair: Sami Durrani, Fresenius Medical Care; Susan McDonald, Ximedica

- 1. **Tracking the User Over Time: How to Effectively Design for a Longitudinal Study and Best Practices for Observing in the Operating Room**, Kristyn Berry and Laurie Reed, Farm

- 2. **Conducting User Research in Emerging Markets**, Taryn Amatruda and Maureen Halligan, Cambridge Consultants
- 3. **Contextual Inquiry That Doesn't Break the Bank**, Lindsay Carrabine and Peter Sneeringer, Design Science

PSRI5 – Optimizing Team Performance and Resource Level in Diverse Health-Care Contexts: From Surgery in Rwanda to Medical Event Management in Deep Space

Patient Safety Research and Initiatives Track

Tuesday, March 27, 10:30 a.m.–12:00 p.m.

Location: Clarendon

Panel Session

Chair: Steven Yule, Harvard Medical School/Brigham and Women's Hospital

Panelists: Thoralf Sundt III, Harvard Medical School/Massachusetts General Hospital; Roger Dias, David Meguerdichian, and Jamie Robertson, Harvard Medical School/Brigham and Women's Hospital; and David Musson, Northern Ontario School of Medicine

LUNCH (Provided)

12:00–1:30 p.m.

Location: Salon G

SESSIONS

1:30–3:00 p.m.

CCIT6 – New Paradigms for Care Provision Using HIT

Clinical and Consumer Health-Care IT Track

Tuesday, March 27, 1:30–3:00 p.m.

Location: Exeter

Lecture Session

Chair: Kristen Miller, Medstar

- 1. **How I Learned to Stop Worrying & Love My Robot Doctor**, Juhan Sonin, MIT | goinvo
- 2. **Information Technology Gaps in Primary Care Management of Chronic Pain**, Shilo Anders, Vanderbilt U. Medical Center; Laura G. Militello, Applied Decision Science; Sarah M. Downs, Indiana U.; Robert W. Hurley, Wake Forest School of Medicine; Robert L. Cook, U. of Florida; Elizabeth C. Danielson and Christopher A. Harle, Indiana U.
- 3. **Role of Human Supervisors in Smarter Cold Chains**, Luca Bertuccelli, Sensitech
- * 4. **Personal Health Records Buck Traditional Medical Culture**, Melinda Jenkins and Melinda Jenkins, Rutgers U.

HE6 – Decision Making

Hospital Environments Track

Tuesday, March 27, 1:30–3:00 p.m.

Location: Arlington

Panel Session

1. **It Takes a Village: Development, Dissemination, and Adoption of a Pediatric Decision Support Tool**

Chair: Sarah Fouquet, Children's Mercy Kansas City

Panelists: Angela Cunningham, Robert Schremmer, and Ellen Kerns, Children's Mercy Kansas City

2. **Macro-cognition in the Health Care Built Environment: A New Model for Emergency Response Extending Macro-cognition Results in the Inpatient Setting to the Mexico 2017 Earthquake Disaster**

Chair: Susan O'Hara, Clemson U.

Panelists: Nathan J. McNeese, Clemson U.; Robin Toft Klar, New York U.; Laura Chavira-Razo, National Inst. of Public Health Mexico; Zafiro Andrade-Romo, National Inst. of Public Health Mexico

MDD6 – Usability Testing

Medical and Drug-Delivery Devices Track

Tuesday, March 27, 1:30–3:00 p.m.

Location: Salon F

Lecture Session

Chairs: Korey Johnson, Bold Insight Inc.; Evan Edwards, Kaleo, Inc.

1. **Testing in Medical Device Acquisition: Beyond Usability**, Jason Flint, Aaron Nelson, and Dana Miletic, Air Force Medical Evaluation Support Activity

* 2. **Order Effect When Comparing Usability of Two Telehealth Remote Monitoring Solutions**, Juuso Leinonen and Erin Sparnon, ECRI Inst.; Patrice Tremoulet, Rowan U.

* 3. **Can We Combine Human Factors Validation and Clinical Testing to Save Time & Resources?** Shannon Clark and Denise Forkey, UserWise, Inc.

* **PSRI6 – The Patient in Patient Safety: Starting the Conversation**

Patient Safety Research and Initiatives Track

Tuesday, March 27, 1:30–3:00 p.m.

Location: Clarendon

Panel Session

Chairs: Richard Holden, Indiana U.-Indianapolis; Rupa Valdez, U. of Virginia; Elizabeth Papautsky, U. of Illinois at Chicago

Panelists: Jeffery Belden, U. of Missouri School of Medicine; Naveen Muthu, Children's Hospital of Philadelphia; Jenna Marquard, U. of Massachusetts Amherst; Robin Mickelson, Vanderbilt U.; Matthew Weinger, Vanderbilt U. Medical Center

REFRESHMENT BREAK

3:00–3:30 p.m.

Location: Grand Ballroom Foyer

SESSIONS

3:30–4:30 p.m.

* **CCIT7 – Distributed Cognition for Improving Cancer Care Coordination**

Clinical and Consumer Health-Care IT Track

Tuesday, March 27, 3:30–4:30 p.m.

Location: Exeter

Panel Session

Chair: Brian Hazlehurst, Kaiser Permanente Northwest

Panelists: Gurveet Randhawa, National Cancer Inst.; Yan Xiao, U. of Texas at Arlington; Paul Gorman, Oregon Health & Science U.

HE7 – Research

Hospital Environments Track

Tuesday, March 27, 3:30–4:30 p.m.

Location: Arlington

Lecture Session

Chair: Bryant Foster, Research Collective

1. **Making the Most of Rapid Field Research: A Case Study in Acute Care**, Derek Dumolo and Adrienne Jones, Cambridge Consultants

2. **Examining Different Task-Based Layouts of an Anesthesia Workstation Based on Task Relationships and Task Sequencing**, Katherina Jurewicz and David Neyens, Clemson U.

MDD7 – Latest Advances in Human Factors for Surgical Robots

Medical and Drug-Delivery Devices Track

Tuesday, March 27, 3:30–4:30 p.m.

Location: Salon F

Panel Session

Chair: Beth Loring, Loring Human Factors, LLC

Panelists: Robert J. Stephens, Medtronic; Tara Feuerstein, Farm; Kate Knudsen, Intuitive Surgical

PSRI7 – Topics in Trauma

Patient Safety Research and Initiatives Track

Tuesday, March 27, 3:30–4:30 p.m.

Location: Clarendon

Lecture Session

Chairs: Ashley Hughes, U. of Illinois at Chicago; Natalie Benda, National Center for Human Factors in Healthcare

* 1. **Multilevel, Multidiscipline, and Temporally Diverse Handoffs in Traumatic Brain Injury Rehabilitation**, Siobhan Heiden and Barrett Caldwell, Purdue U.

2. **Methodology for Systematically Developing Data-Driven Interventions in Trauma Care**, Victoria Lew, Embry-Riddle Aeronautical U.; Tracy Litzinger, Flager College; Timothy Disher, Embry-Riddle Aeronautical U.; Tara Cohen, Cedars-Sinai Medical Center; Jennifer Cabrera, Embry-Riddle Aeronautical U.; Kevin Captain, Florida Hospital; Albert Boquet, Embry-Riddle Aeronautical U.
3. **Trauma Resuscitation Using in Situ Simulation Team Training (TRUST): Identifying Latent Safety Threats via a Human Factors Informed Framework Analysis of Video Recordings**, Mark Fan, North York General Hospital; Andrew Petrosoniak, St. Michael's Hospital; Sonia Pinkney, U. Health Network; Christopher Hicks and Kari White, St. Michael's Hospital; Ana Paula Siquiera Silva Almeida, Universidade Federal de Itajuba'; Douglas Campbell, Melissa McGowan, and Alice Gray, St. Michael's Hospital; Rodrigo Almeida, Universidade Federal de Itajuba'; Patricia Trbovich, North York General Hospital
- * 5. **Assessing Interaction Strategies for Health IT: An Entropy-Based Approach**, Xiaomei Wang and Rebecca Berg, U. at Buffalo, SUNY; Nicolette McGeorge, Johns Hopkins U.; David LaVergne, U. at Buffalo, SUNY; Natalie Benda, MedStar Health; Ann Bisantz, U. at Buffalo, SUNY
6. **Making Sense of Complexity: Using Causal Loop Diagramming in a Healthcare Context**, Athina Santaguida and Kathy Huynh, Healthcare Human Factors; Julian Goss, Baycrest Hospital; Mike Lovas, Healthcare Human Factors; Joseph A. Cafazzo, Healthcare Human Factors, U. Health Network
7. **Simulation-Based Usability Testing Methods Support Nurses' Safe Transition Between Bar-Code Medication Administration Systems**, Carrie Reale, Deborah Ariosto, Matthew B. Weinger, and Shilo Anders, Vanderbilt U. Medical Center
8. **Supporting Older Adults' Trust in Care Providers: Same for a Human or Robot Care Provider?** Rachel Stuck, Georgia Inst. of Technology; Wendy Rogers, U. of Urbana-Champaign
- * 9. **Use and Acceptance of Mobile Technologies in Health Care**, Sarahfaye Dolman, MedStar Health Research Inst.; Kristen Miller, MedStar Health System; Susan Smola, Christiana Care Health System; Rebecca Kowalski, U. of Delaware
10. **Designing Technologies for Caregivers in Pregnancy**, Shilo Anders, Hannah Arron, Gretchen P. Jackson, and Laurie L. Novak, Vanderbilt U. Medical Center
11. **Patient Perception of Interactive Mobile Health Care Apps: A Regression Analysis**, Emily Anania, Mattie Milner, Nathan Walters, and Stephen Rice, Embry-Riddle Aeronautical U.
12. **EHR-Supported Activities for VTE Prophylaxis: A Case Study**, Megan Salwei, Peter Kleinschmidt, Ann Hundt, Peter Hoonakker, Brian Patterson, and Pascale Carayon, U. of Wisconsin-Madison
13. **A Paradigm Shift: Design and Testing of an Innovative Computerized Provider Order Entry System**, Pamela Neri Garabedian, Partners HealthCare System, Inc.; Isabella Newbury and Alejandra Salazar, Brigham and Women's Hospital; Kevin Kron and Katherine Forsythe, Partners HealthCare System, Inc.; Aaron W. Nathan, Brigham and Women's Hospital; Samuel Karmiy, Partners HealthCare System, Inc.; Sara Myers, Brigham and Women's Hospital; Lynn A. Volk, Partners HealthCare System, Inc.; Mary G. Amato, Massachusetts College of Pharmacy and Health Sciences; Adam Wright, Brigham and Women's Hospital; Tewodros Eguale and Sarah McCord, Massachusetts College of Pharmacy and Health Sciences; Rosa Rodriguez Monguio, David W. Bates, and Gordon D. Schiff, Brigham and Women's Hospital

POSTER RECEPTION

4:30–6:00 p.m.

Location: Gloucester

CCIT-POS2 – Poster Reception

Clinical and Consumer Health-Care IT Track

Tuesday, March 27, 4:30–6:00 p.m.

Location: Gloucester

- * 1. **Modeling the Problem Space of Smartphone-Assisted Insulin Dose Self-Titration Interventions Targeting Patients With Type 2 Diabetes: A Human Factors Approach**, Hamzah Ibrahim, Claremont Graduate U.
- * 2. **A Linguistic Approach for Facilitating Interpretation of HFES Proceedings: An Efficient Method for Real-Time Literature Review**, Tim Arnold and Helen Fuller, VA
3. **Real-World Methods to Improve EHR Usability: Creating a Change Package Toolkit**, A. Zachary Hettinger and Katharine Adams, National Center for Human Factors in Healthcare, MedStar Health; Jonathan Wald and Laura Marcial, RTI International; Tracy Kim, National Center for Human Factors in Healthcare, MedStar Health; Stephanie Rizk, RTI International; Anita Samarth, Clinovations Government + Health; Rollin J. Fairbanks and Raj Ratwani, National Center for Human Factors in Healthcare, MedStar Health
4. **Virtual Environments as a Rehabilitation Intervention for Topographical Disorientation in Memory-Impaired Individuals: A Scoping Review**, David Gafni, U. of Toronto

14. **Involving Patients to Improve Documentation Accuracy: A New EHR Screen Design**, Onur Asan, Bradley Crotty, and Jeanne Tyszka, Medical College of Wisconsin
15. **Designing Effective Dashboards for Healthcare Providers, Patients, and Family Caregivers to Patients With Diabetes**, Jennifer Teves, Veritas Technologies; Barbara Chaparro and Alex Chaparro, Embry-Riddle Aeronautical U.
16. **Cognitive Task Analysis of a Primary Care Team: Exploring Cognitive Requirements for Addressing Preventive Care**, Shimeng Du, Douglas Wiegmann, Randi Cartmill, Amanda Hoffmann, Linsey Steege, Laura Farrell, and Tosha Wetterneck, U. of Wisconsin-Madison
- * 17. **Human Computer Interaction Trends in Healthcare: An Update and Call to Action**, Kimberly Stowers, U. of Alabama; Mustapha Mouloua, U. of Central Florida
- * 18. **Lost in Translation: Factors Influencing Successful Implementation of Evidence-Based Guidelines Into Clinical Decision Support**, Christopher Saikalis, Danielle Mosby, Rebecca Kowalski, and Kristen Miller, National Center for Human Factors in Healthcare, MedStar Health
- * 19. **Using a Narrative Format and Sociotechnical Systems Approach to Perform a User-Centered Problem Analysis of the HIT in Present-Day Clinical Environments**, Kurt Ruark, Danielle Hoover, and Jennifer Herout, VHA
20. **Exploring Primary Care RN & MA Cognitive Needs for EHR Design: A Qualitative Analysis**, Laura J. Farrell, Linsey M. Steege, Douglas A. Wiegmann, and Randi S. Cartmill, U. of Wisconsin-Madison; Amanda E. Hoffmann, U. of Wisconsin-Madison School of Medicine and Public Health; Shimeng Du and Tosha B. Wetterneck, U. of Wisconsin-Madison
21. **All Hands on Deck: Health IT Usability and Safety Challenges During Medication Reconciliation**, Lana Lowry and Mala Ramaiah, National Inst. for Standards and Technology; Danielle Mosby, Kristen Miller, Bidisha Roy, and Raj Ratwani, National Center for Human Factors in Healthcare, MedStar Health
22. **Establishing the Key Nontechnical Skills in Gastrointestinal Endoscopy: A Qualitative Study**, Charlotte Hitchins, Plymouth Hospitals NHS Trust; Judy Edworthy and Julie Griffin, Plymouth U.; Magdalena Metzner and Catherine Ward, Plymouth Hospitals NHS Trust
23. **ShadowBox Training to Advance Nursing Expertise: A Demonstration Project**, Helen Altman Klein, MacroCognition LLC; Emily Newsome, ShadowBox LLC
- * 24. **Designing Wayfinding Systems for Hospitals**, Christy Harper, End to End User Research; Angie Avera, U. of Houston-Clear Lake; Andrea Crosser, End to End User Research; Tyler Duke, U. of Houston-Clear Lake; Spencer Jefferies, End to End User Research
25. **The Pediatric Psychosocial Environment: How Psychosocial Risk Factors Are Associated With MSD Pain and Functional Consequences**, Francesca Macaluso, Nancy Daraiseh, Lauren Summerville, and Maurizio Macaluso, Cincinnati Children's Hospital Medical Center
- * 26. **Use Preferences for Continuous Cardiac and Respiratory Monitoring Systems in Hospitals: A Survey of Patients and Family Caregivers**, Emily S. Patterson, Chris Hritz, Liya Gebru, Kashvi Patel, Todd Yamokoski, and Susan Moffatt-Bruce, Ohio State U.
27. **Information Exchange in the Operating Room: Task Analysis and Multimodal Design Concepts**, Noemi Bitterman, Technion
28. **Preliminary Analysis of Surgeon Body Posture and Musculoskeletal Risk Based on Patient Positioning During Microsurgical Breast Reconstruction**, Jordyn Koenig, Amro Abdelrahman, Chris Curry, Anita Mohan, Valerie Lemaine, Shelley Noland, M. Susan Hallbeck, and Bethany Lowndes, Mayo Clinic
29. **Use of Friction-Reducing Devices to Reduce the Spine Loads During Repositioning of Patients**, Susan Kotowski and Kermit Davis, U. of Cincinnati
30. **A Guide for Installing Wall-Mounted Computers at Ergonomic Heights**, Aaron Ross, Partners Healthcare
- * 31. **Cardiac Arrhythmia Simulations for Comparing Remote Telemetry Monitoring Systems**, Noa Segall, Duke U. Medical Center; Ron'Nisha Franklin, North Carolina State Veterans Home; Melanie Wright, Trinity Health and Saint Alphonsus Health System
32. **A Work Systems Analysis of Sterile Processing**, Myrte de Alfred, Medical U. of South Carolina; Emily Huffer, Kevin Taafe, and Lawrence Friendendall, Clemson U.; Ken Catchpole, Medical U. of South Carolina
33. **Impact of Interruptions on Mental Demand and Reaction Time by Clinician Role**, Anna R. Linden, St. Olaf College; Hunter J. Hawthorne and

HE-POS2 – Poster Reception

Hospital Environments Track

Tuesday, March 27, 4:30–6:00 p.m.

Location: Gloucester

22. **Participatory Redesign of an Online Catalog for Laboratory Testing**, Leah Konwinski and Hayley Goward, Spectrum Health Helen DeVos Children's Hospital

- Katherine L. Forsyth, Mayo Clinic; Blake Young, U. of Minnesota-Rochester; Renaldo C. Blocker, Mayo Clinic
35. **Patterns of Resilience and Brittleness in Hospital-Based Emergency Care During Hurricane Harvey**, Changwon Son, Vu Hoang Le, S. Camille Peres, and Farzan Sasangohar, Texas A&M U.
 36. **A Systems Approach to Sharps Disposal Safety in a Malawian Hospital**, Morven Millar and Evridiki Fioratou, U. of Dundee; Emma Thomson, Malawi College of Medicine
 37. **Identifying Higher Ergonomic Risk During a Simulation Task**, Christopher Curry, Amro Abdelrahman, Bethany Lowndes, Melissa Morrow, and M. Susan Hallbeck, Mayo Clinic
 38. **The Patient's World in Critical Care: People, Spaces, and Processes of Family's Interactions**, Ummesalmah Abdulbaseer and Elizabeth Papautsky, U. of Illinois at Chicago
 39. **Workflow Analysis of Interprofessional Medical Education in the Clinical Learning Environments to Improve Learning Outcomes and Patient Safety**, Catarina Smith, Nicole Nehls, Adam Schleis, and Margo Jacobsen, Northeastern U.; Peter Bates, Robert Bing-You, Thomas Van der Kloot, and Paul Han, Maine Medical Center; Awatef Ergai and James Benneyan, Northeastern U.
 40. **Effects of Workflow Interruptions on ED Providers' Stress: An Observational Study on ED Physicians and Nurses**, Matthias Weigl and Anna Schneider, U. Hospital of LMU Munich
 - * 41. **Thematic Issues in Analysis and Visualization of Hospital Emergency Department Patient Flow**, Benjamin Bauchwitz, Spencer Lynn, and Peter Weyhrauch, Charles River Analytics; Raj Ratwani, Danielle Mosby, and Jessica Howe, National Center for Human Factors in Healthcare, MedStar Health; James Niehaus, Charles River Analytics
 42. **Outpatient Clinic Patient Exam Room – Provider Preferences**, Carolyn Sommerich, Steven Lavender, Kevin Evans, and Elizabeth Sanders, Ohio State U.
 43. **Applying Heuristics for Early Formative Evaluation: A New Structured Approach for Device User Interface Assessment**, Carolin A. Ruf, Katrin Rapp, and Florian Schauderna, Sanofi-Aventis Deutschland GmbH; Molly F. Story, Sanofi
 44. **How to Integrate Human Factors Engineering With Complaint Management**, Shannon Clark, UserWise, Inc.
 45. **Leveraging Efficiencies and Avoiding Pitfalls When Coupling a Human Factors Study With a Clinical Trial**, Cynthia Warman and Ross Lenzing, Ximedica
 46. **Case Study: Is This the Solution You Are Looking for? A Cross-Functional Approach to Development and Evaluation of a Label-Based Mitigation**, Young J. Chun, Angela Muriset, and Bharat Arora, Shire
 47. **How Can Human Factors Studies Conducted by a Medical Device Manufacturer Provide More Value for Pharmaceutical Companies to Succeed in their Combination Product Validations?** Karen Guerrero, Luc Marticou, and Sarah Baer, Becton Dickinson
 48. **Noninvasive Wearable Sensors to Detect Onset of Hypoglycemia: A Literature Review**, Karim Zahed, Yibo Zhu, Farzan Sasangohar, Ranjana Mehta, Madhav Erraguntla, and Mark Lawley, Texas A&M U.
 49. **Factors Affecting Consumers' Acceptance of Robotic Dentists**, Mattie Milner, Emily Anania, Nadine Ragbir, Matthew Pierce, Nathan Walters, and Stephen Rice, Embry-Riddle Aeronautical U.
 50. **KeyS: How to Design Beyond a Happy Flow**, Beant Kaur Dhillon and Jon Pluyter, Philips
 51. **A Usability Perspective on Current Industry Practice of Reprocessing for Medical Device Development**, Tara Daugherty and Robert Stephens, Medtronic
 - * 52. **Investigating the HbA1c Assessment Methods for a Smart and Connected Diabetes System**, Alexa Gutierrez and Farzan Sasangohar, Texas A&M U.; Khalid Qaraqe, Texas A&M-Qatar; Mark Lawley, Texas A&M U.
 53. **Pay No Attention to That Research Team Behind the One-Way Mirror: How to Transport Participants Into Simulations**, Samantha Sye, Jennifer Soosaar, and Marc Egeth, Core Human Factors, Inc.
 54. **Employing Remote Usability Testing Methods to Conduct Summative Usability Testing**, Michael Jenkins, UL-Wiklund; Eric Smith, Ivenix; Erin Davis, UL-Wiklund

PSRI-POS2 – Poster Reception

Patient Safety Research and Initiatives Track

Tuesday, March 27, 4:30-6:00 p.m.

Location: Gloucester

55. **Usability Design for Multiple Clinical End-Users: An Evaluation of Medication Labels**, Matthew N. Jesso, Carilion Clinic; Sarah Henrickson Parker, Virginia Tech Carillon Research Inst.
56. **Preventing Accidental Falls of the Newborn in Hospitals: A Review of Systematic Implementation of Evidence-Based Practices and Ergonomic Devices That Support Parent/Infant Skin-to-Skin Behaviors in Hospital Settings**, Yamile Jackson,

- Nurtured by Design; Phaidra Harper, Sentier Strategic Resources
- * 57. **Mobile Technology to Assess Balance During Sit-to-Stand Manuever Among Older Adults at Risk for Falling**, Deanna Gray-Miceli, Florida Atlantic U.; William Craelius and Kang Li, Rutgers U.
 - 58. **Evaluating Situation Awareness During a Simulated Active-Shooter Mass Casualty Incident: Lessons Learned**, Tiffany Leverenz and Paul Missasi, Wichita State U.; Barbara Chaparro, Embry-Riddle Aeronautical U.
 - 59. **First Human Factors Based Selection of Technology in the Spanish Healthcare System- EVAtec**, Laura Herrero, IDIVAL; Elena Rojo Santos, Hospital virtual Valdecilla; Marina Cano Iglesias, IDIVAL; Juan Pedraja Vidal, Hospital virtual Valdecilla; Lourdes Escobar Hoyos, Hospital Universitario Marqués de Valdecilla; José María Maestre, Hospital virtual Valdecilla; Carmen Sánchez Juan and Lorenzo Alonso Vega, Servicio Cántabro de Salud; Manuel Gómez Fleitas, Hospital Universitario Marqués de Valdecilla; Ignasi Maspons Molins, IDIVAL; Natalie Abts, Natalie Benda, and Lawrence Wolpert, MedStar Inst. for Innovation, MedStar Health; Ignacio del Moral Vicente-Mazariegos, Hospital virtual Valdecilla; Galo Peralta Fernández, IDIVAL
 - 60. **Developing Predictive Models of Flow Disruption Effect on Bypass Time in Cardiovascular Operating Rooms**, Timothy Disher, Jordan Hilgers, Albert Boquet, and William MacKunis, Embry-Riddle Aeronautical U.
 - 61. **The AHRQ Patient Safety Learning Laboratories: What Are We Learning?** James Benneyan, Healthcare Systems Engineering Inst., Northeastern U.
 - 62. **Informing Patient & Family-Centered Care: An HFE Approach to New Facility Design**, Ella Franklin and Akhila Iyer, National Center for Human Factors in Healthcare
 - * 63. **Increasing the Use of Evidence-Based Practices in Stroke Rehabilitation**, Joseph Laffoon and Dan Nathan-Roberts, San Jose State U.
 - 64. **An Objective Battery of Sensorimotor and Cognitive Tests to Assess Effects of Work Shift Length on Healthcare Workers: A Proof-of-Principle Study**, Harsimran Baweja, Emily Carper, Natalie Dib, Candace Edwards, Jessica Fellow, Alex Harrington, Ariana Middleman, and Andrew Stewart, San Diego State U.; Daniel Goble, Oakland U.; Matthew Mahar, San Diego State U.; Megan Conrad, U. of Detroit Mercy
 - 65. **Ergonomic Factors Contributing to Preventable Adverse Drug Events in Healthcare: A Grounded-Theory Approach**, Thomas Hilgers, Embry-Riddle Aeronautical U.
 - * 66. **A Novel Curriculum Framework for Education in Robotic Surgery**, Anthony Dwyer, David Crawford, Rayan Elkattah, and Richard Pearl, U. of Illinois College of Medicine
 - 67. **Building the Best Operating Room Team: Lessons in Leadership & Teamwork**, Jennifer Hauck, Jonathan Mark, and Atilio Barbeito, Duke U. & VA Medical Center
 - 68. **Optimization of EHR Clinical Data Visualization to Improve Clinical Accuracy and Patient Safety**, Vishal Patel, Christiana Care; Grace Tran, MedStar Health
 - * 69. **Time to Recognizing Out-of-Hospital Cardiac Arrest**, Omer Perry and Oren Wacht, Ben-Gurion U. of the Negev; Eli Yafe, Magen-David-Adom; Tzillah Sinuany-Shteren and Yuval Bitan, Ben-Gurion U. of the Negev
 - 70. **Hybrid Usability Methods: Practical Techniques for Evaluating Health Information Technology in an Operational Setting**, Blake Lesselroth and Kathleen Adams, VA Portland Health Care System; Ginnifer Mastarone, Oregon Health & Science U.; Stephanie Tallett, VA Portland Health Care System
 - * 71. **Optimizing the Design of Visual Patterns for Label Design**, Greg Fukakusa and Paul Milgram, U. of Toronto; Yuval Bitan, Ben Gurion U. of the Negev
 - * 72. **Development of Virtual Simulations for Medical Team Training: An Evaluation of Key Features**, Jessica Howe, Joseph Puthumana, Daniel Hoffman, Rebecca Kowalski, Danielle Mosby, and Kristen Miller, MedStar Health; Peter Weyhrauch, James Niehaus, Benjamin Bauchwitz, and Ashley McDermott, Charles River Analytics; Raj Ratwani, MedStar Health
 - 73. **Pilot Testing an Interruption Management Tool for Emergency Medicine Physicians**, Katharine Adams, Jessica Howe, and Kathryn Kellogg, MedStar Health
 - 74. **Designing High-Reliability Processes for Coordinating Perioperative Care for Medically Complex Children**, Joseph Salem and James Benneyan, Northeastern U.
 - 75. **Innovative Approaches to Consult Tracking Within the Veterans Health Administration**, Kathleen Adams, VA Portland Health Care System; Ginnifer Mastarone, Oregon Health & Science U.; Victoria Church and Blake Lesselroth, VA Portland Health Care System
 - * 76. **Qualitative Review of Wrong-Site Surgeries: What Side Will My Surgery Take Place?** Anoosha Moturu, Baylor College of Medicine; Grace Tran and Jessica Howe, National Center for Human Factors in Healthcare, MedStar Inst. for Innovation
 - 77. **Creativity in Practice: The Role of Human Factors for Innovating Patient Safety**, Sara Albolino, Giulia

Dagliana, Giulio Toccafondi, and Riccardo Tartaglia,
Centre for Clinical Risk Management and Patient
Safety

78. **VTE Patient Education: Created for Patients, by Patients**, Brandyn D. Lau, Michael B. Streiff, Peggy S. Kraus, Dauryne L. Shaffer, Deborah B. Hobson, Kristen L. W. Webster, Oluwafemi P. Owodunni, Katherine L. Florecki, and Elliott R. Haut, Johns Hopkins
79. **Preventing DVT Through Nursing Education**, Dauryne L. Shaffer, Brandyn D. Lau, Michael B. Streiff, Peggy S. Kraus, Deborah B. Hobson, Kristen L. W. Webster, Oluwafemi P. Owodunni, Katherine L. Florecki, and Elliott R. Haut, Johns Hopkins
80. **Providing Resident Feedback to Improve VTE Risk Assessment and Prophylaxis Ordering**, Brandyn D. Lau, Michael B. Streiff, Peggy S. Kraus, Dauryne L. Shaffer, Deborah B. Hobson, Kristen L. W. Webster, Oluwafemi P. Owodunni, Katherine L. Florecki, and Elliott R. Haut, Johns Hopkins

RECEPTION

Sponsored by Ximedica

6:00–9:00 p.m.

Location: 3rd Floor Atrium

Attendees will receive one complimentary drink ticket.
Light appetizers will be served.

WEDNESDAY, MARCH 28

REFRESHMENT BREAK

8:00–8:30 a.m.

Location: Grand Ballroom Foyer/Back Bay Foyer

REGISTRATION SERVICES

8:00 a.m.–2:00 p.m.

Location: Registration Desk B

SESSIONS

8:30–10:00 a.m.

CCIT8 – Innovative Interactive Technologies

Clinical and Consumer Health-Care IT Track

Wednesday, March 28, 8:30–10:00 a.m.

Location: Exeter

Lecture Session

Chair: Changwon Son, TAMU

- * 1. **Electronic Health Records: Solving the Little Data Problem**, John Flach, Phil Schanely, Luke Kuennke, Bennett Chidoro, Jad Mubaslat, and Brandon Howard, Mile Two LLC

2. **The Evaluation of Tactile Technology for Continuous Informing Displays in Anesthesia**, Kylie Gomes and Sara Riggs, Clemson U.
- * 3. **Evaluating Combat Medic Training**, Laura G. Militello and Christen E. Sushereba, Unveil; Simon Fernandez, David Bahner, and Emily S. Patterson, Ohio State U.

HE8 – Potpourri

Hospital Environments Track

Wednesday, March 28, 8:30–10:00 a.m.

Location: Arlington

Panel Session

1. **Inpatient Multidisciplinary Rounds for Medically Complex Pediatric Patients as an Example of Teamwork in Healthcare Settings**
Chair: Irina Trifonova, Children's Mercy Hospital Kansas City
Panelists: Troy Richardson, Leah Jones, and Raymond Chan, Children's Mercy Hospital Kansas City
2. **The Challenges and Rewards of Surgical Ergonomics**
Chair: M. Susan Hallbeck, Mayo Clinic
Panelists: Kristin Chrouser, U. of Minnesota Medical College; Victor Paquet, U. at Buffalo, SUNY; Ladin Yurteri-Kaplan, Columbia U. Medical Center; Bethany Lowndes, Mayo Clinic

MDD8 – Emerging Innovations

Medical and Drug-Delivery Devices Track

Wednesday, March 28, 8:30–10:00 a.m.

Location: Salon F

Lecture Session

Chairs: Robert Stephens, Medtronic; David Eibling, U. of Pittsburgh

- * 1. **Assessing Medical Device Usability With Eye-Tracking**, Jordan Hilgers, Embry-Riddle Aeronautical U.; Kevin Ten Brink, Intuitive Surgical Inc.
- * 2. **Human Factors Engineering in Development of Implantable Medical Devices**, Jayme Coates and Maria Jensen, iO life science
3. **Instructions for Use Development Using Heat Maps**, Katrin Rapp and Molly Story, Sanofi

PSRI8 – Patient Safety Potpourri I

Patient Safety Research and Initiatives Track

Wednesday, March 28, 8:30–10:00 a.m.

Location: Clarendon

Panel and Lecture Session

- * 1. **Panel: Creative Research Approaches for Complex Questions in Prehospital Emergency Medicine**
Chair: Yuval Bitan, Ben Gurion U.
Panelists: Eli Jaffe, Magen David Adom in Israel; Logan Gisick, Embry-Riddle Aeronautical U.; Greg Hallihan, U. of Calgary; Joseph Keebler, Embry-Riddle Aeronautical U.

- * 2. **Lecture: Emergency Usability Lab: Testing Usability of Products in Self-Care Emergencies**, Peter Rasche, Katharina Schäfer, Sabine Theis, Christina Bröhl, Matthias Wille, and Alexander Mertens, Institut of Industrial Engineering and Ergonomics

REFRESHMENT BREAK

10:00–10:30 a.m.

Location: Grand Ballroom Foyer/Back Bay Foyer

SESSIONS

10:30 a.m.–12:00 p.m.

CCIT9 – UX and Usability

Clinical and Consumer Health-Care IT Track
Wednesday, March 28, 10:30 a.m.–12:00 p.m.

Location: Exeter

Lecture Session

Chair: Janey Barnes, User-View Inc.

1. **UX Strategies for Health Information Systems: UX of Medicare**, Elizabeth Rosenzweig, Bentley U.
2. **Safeuristics! Do Heuristic Violation Severity Ratings Correlate With Patient Safety Severity Ratings for a Native EHR Mobile Application?** Sarah Fouquet, Y. Raymond Chan, and Ellen Kerns, Children's Mercy Hospital Kansas City; Barbara Chaparro, Embry-Riddle Aeronautical U.; Tiffany Leverenz, Wichita State U.
3. **A Multisite Project to Promote Cognitive Support Technology Use and Employment Success Among Postsecondary Students With Traumatic Brain Injuries**, Karen Jacobs and Amanda Nardone, Boston U.; Phillip Rumrill and Deborah Minton, Kent State U.; DJ Hendricks and Elaine Sampson, West Virginia U.; Eileen Elias and Anne Leopold, JBS International, Inc.; Marcia Scherer, U. of Rochester
4. **How Much Time (and Effort) Does a Timeline Save? Usability Testing of a Patient Asthma History Timeline**, Dean Karavite, Jeritt Thayer, Jeritt Thayer, Daria Ferro, and Joseph Zorc, Children's Hospital of Philadelphia

HE9 – User Experience and Teams

Hospital Environments Track

Wednesday, March 28, 10:30 a.m.–12:00 p.m.

Location: Arlington

Lecture Session

Chair: Emily Hildebrand, Research Collective

- * 1. **Engineering the Future of Sepsis Care: An Application of Fuzzy Logic Cognitive Mapping for Sepsis Diagnosis**, Kristen Miller, Danielle Mosby, and Joseph Blumenthal, MedStar Health; Kendall McKenzie, North Carolina State U.; Muge Capan

and Ryan Arnold, Christiana Care Health System; Rebecca Kowalski, MedStar Health; F. Jacob Seagull, U. of Michigan; Ken Catchpole, Medical U. of South Carolina; Ella Franklin, MedStar Health; Russell Branaghan, Arizona State U.

- * 2. **A Strategic Approach to Determining the Relative Impact of Team Behavior on Guideline Violations**, Aaron Ashby, Marshall Smith, Regina Gaines, and David Kaufman, Arizona State U.
- 3. **Unique Health and Safety Exposures in the Workplace: The Story of Home Healthcare Workers**, Kermit Davis, Noma Agbonifo, Beverly Hittle, Russell Suarez, and Susan Reutman, U. of Cincinnati

MDD9 – FDA CDRH / CDER Panel: Medical Device Human Factors

Medical and Drug-Delivery Devices Track

Wednesday, March 28, 10:30 a.m.–12:00 p.m.

Location: Salon F

Panel Session

Chair: Anthony D. (Tony) Andre, Interface Analysis Associates

1. CDER Panelists: Irene Z. Chan, PharmD, BCPS, CDR, U.S. Public Health Service, Deputy Director, Division of Medication Error Prevention and Analysis, FDA/CDER/OSE/OMEPRM/DMEPA; Nicole Garrison, PharmD, BCPS, Safety Evaluator, Division of Medication Error Prevention and Analysis, FDA/CDER/OSE/OMEPRM/DMEPA
2. CDHR Panelists: Hannibey Wiyor, LT, U.S. Public Health Service, Human Factors Reviewer, Human Factors Pre-market Evaluation Team, FDA/CDRH/DAGRID/HFPMET; Xin Feng, Human Factors Reviewer, Human Factors Pre-market Evaluation Team, FDA/CDRH/DAGRID/HFPMET; Rita Lin, Human Factors Reviewer, Human Factors Pre-market Evaluation Team, FDA/CDRH/DAGRID/HFPMET

PSRI9 – Patient Safety Potpourri II

Patient Safety Research and Initiatives Track

Wednesday, March 28, 10:30 a.m.–12:00 p.m.

Location: Clarendon

Lecture Session

Chairs: Rebecca Butler, National Center for Human Factors in Healthcare; Ella Franklin, National Center for Human Factors in Healthcare

1. **Co-Designing a Mobile Application for Patient Engagement: From Pain Points to Lessons Learned**, Sylvain Bruni, Aptima
- * 2. **Are Patient Admission Handoffs From ED to MICU PARfect?** Imade Ihianle, Shirley Burton, and Joanna Abraham, U. of Illinois

- * 3. **FUTURES: Forecasting the Unexpected Transfer to Upgraded RESources in Sepsis**, Rebecca Kowalski and Kristen Miller, MedStar Health; Muge Capan, Christiana Care Health System; Danielle Mosby, MedStar Health; Ryan Arnold, Christiana Care Health System
- * 4. **How Nurses Identify Hospitalized Patients on Their Personal Notes: Findings From Analyzing “Brains” Headers With Multiple Raters**, Ritesh Sarkhel, Jacob Socha, Susan Moffatt-Bruce, Simon Fernandez, Kashvi Patel, Arnab Nandi, Austin Mount-Campbell, and Emily S. Patterson, Ohio State U.

**POST-SYMPOSIUM WORKSHOPS
(Separate registration fees apply)**

CANCELED – Workshop 1: How to Design Effective Safety Information for Medical Devices

Workshop 2: Innovation, Not Just Evaluation: Leveraging Human Factors Tools to Inspire Innovation

Wednesday, March 28, 1:00–6:00 p.m.
 Location: Cambridge Consultants, Boston, MA, transportation provided
 Presenters: Karen Unterman and Serge Roux, Cambridge Consultants

Workshop 3: You’re Not Done Yet – Conducting a Residual Risk Analysis After a Summative Usability Test

Wednesday, March 28, 1:30–5:30 p.m.
 Location: Clarendon
 Presenters: Michael Wiklund, Erin Davis, and Andrea Dwyer, UL-Wiklund

Workshop 4: A Human Factors Approach to Root Cause Analysis

Wednesday, March 28, 1:30–5:30 p.m.
 Location: Dartmouth
 Presenters: Brittany Anderson-Montoya, Carolinas HealthCare System; Ken Catchpole, Medical U. South Carolina; T. Robert Turner, Anne Arundel Medical Center

**REFRESHMENT BREAK
3:30–3:45 p.m.**

Location: Back Bay Foyer
 For Workshop Attendees Only

HFES CAREER CENTER

Online and On-Site Employment Services Exclusively for Human Factors/Ergonomics Professionals

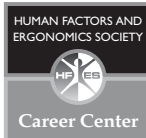

BENEFITS FOR EMPLOYERS

If you are an employer seeking full- or part-time staff or interns with expertise in human factors/ergonomics experience, HFES offers the leading online Career Center devoted exclusively to HF/E professionals around the world.

To recruit top HF/E professionals, visit our Web site at www.hfes.org/Web/CareerCenter/Career.aspx and post a job, search the résumés, or do both. Candidates searching the database can send their résumés directly to your desktop.

BENEFITS FOR CANDIDATES

This service is for HFES members only! Post your résumé at www.hfes.org/Web/CareerCenter/Career.aspx and search our database of available jobs. If you see a job posting that interests you, you can e-mail your résumé directly to the employer. If you prefer to remain anonymous, the “Confidential” selection protects your identity until you choose to become known to the employer.

ON-SITE CAREER CENTER

Each year, HFES hosts an On-Site Career Center at the Annual Meeting, where employers and candidates can schedule interviews, use the online Career Center, and find out about job opportunities and the pool of available job seekers. In order to reserve a booth and/or table, employers must have a current job posting or be registered to search résumés in the Online Career Center during the Annual Meeting.

THIRD FLOOR

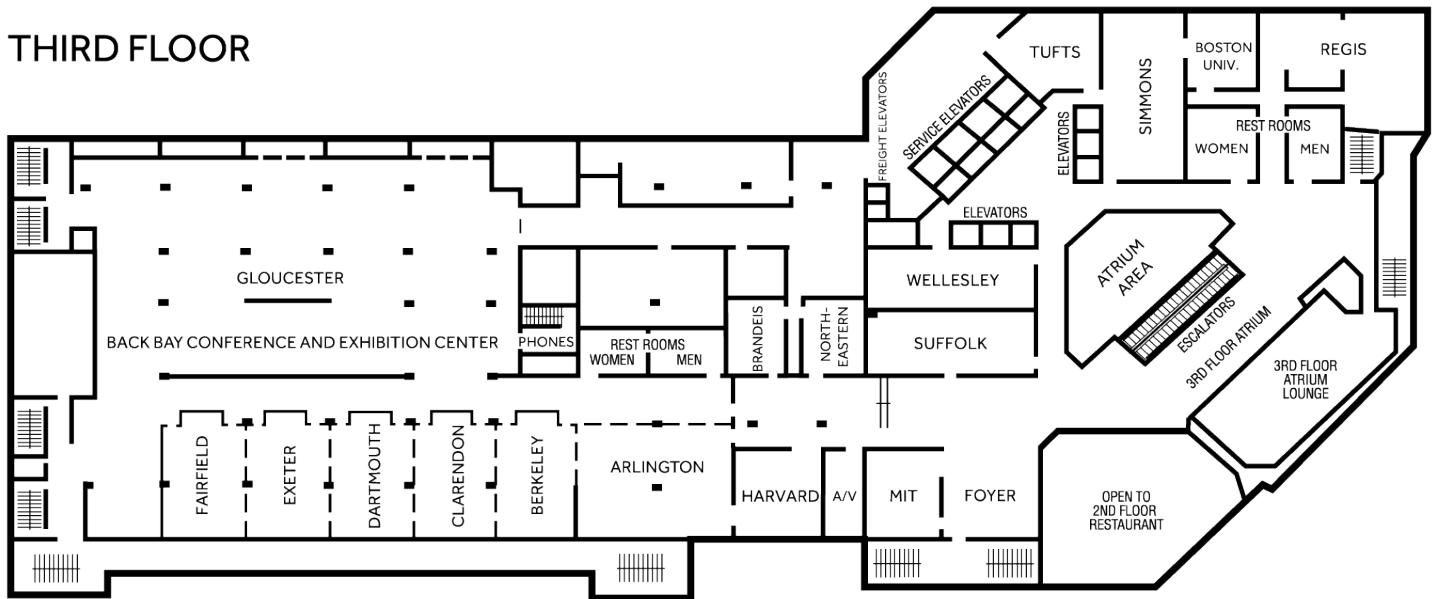

FOURTH FLOOR

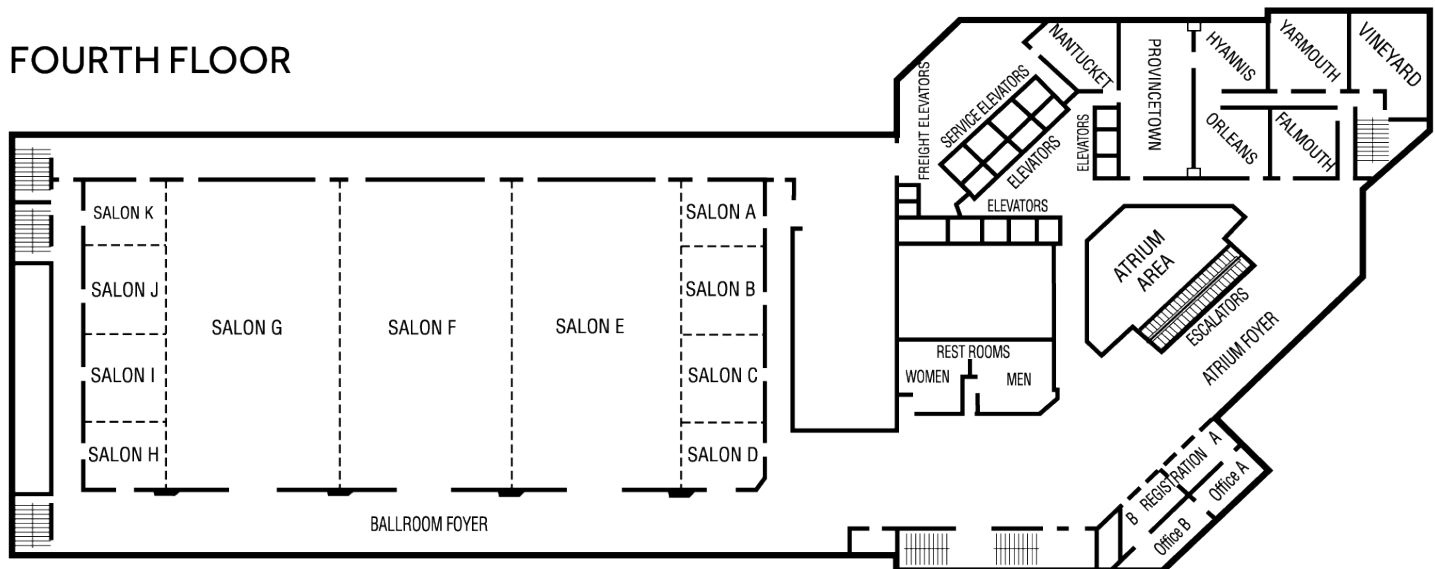

JUST RELEASED!

Workload Assessment: A Guide for Researchers, Practitioners, and Students

Volume 2, Users' Guides to Human Factors and Ergonomics Methods

Workload assessment is important wherever people perform under high levels of task demand, such as multitasking, time pressure, and interacting with complex interfaces. This accessible guide sets out a comprehensive, systematic approach to choosing and evaluating workload measures and to designing studies to maximize the value obtained from the measures.

No other single volume in the current literature deals exclusively with workload assessments. In this book, you'll find

- **Basic concepts in both workload theory and applications in a variety of domains**
- **A comprehensive survey of leading self-report, performance-based, and psychophysiological measures**
- **A checklist to ensure assessment quality**
- **Two detailed workload examples to illustrate practical applications.**

Workload Assessment has been written to be accessible to a wide audience and generally requires little specific background knowledge. This book will help guide **researchers** toward best practices in the use of workload measures to test theory-driven hypotheses in studies of cognitive psychology and cognitive neuroscience.

Practitioners in domains such as surface transportation, aerospace, industrial ergonomics, the military, cybersecurity, system design, education, and health care will be able to choose the most appropriate workload measures for applied problems, and use workload data in efforts to mitigate performance issues. *Workload Assessment* is essential reading for graduate **students** in human factors and applied cognitive psychology, as well as supplementary reading for undergraduate students in these topics.

ISBN 978-0-945289-51-7

128 pp., 7" x 10" paperback and e-book

<http://www.hfes.org/publications/>

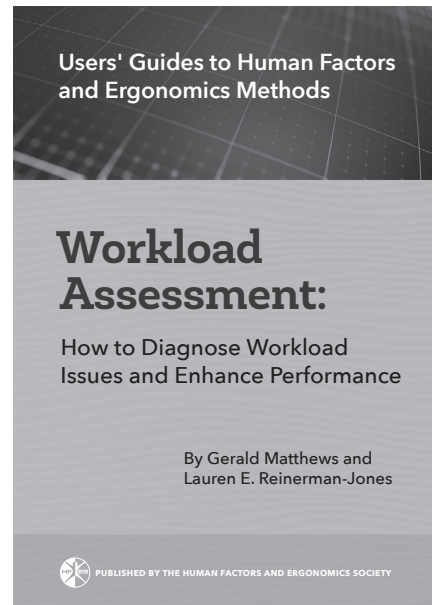

Gerald Matthews, PhD

(University of Cambridge), is a research professor in the Institute for Simulation and Training, University of Central Florida. He previously held faculty positions at the University of Cincinnati, University of Dundee, and Aston University. His research centers on various human performance issues, including workload, stress, fatigue, and individual differences factors.



Lauren Reinerman-Jones, PhD

(University of Cincinnati), is director of Prodigy, a lab at the University of Central Florida's Institute for Simulation and Training. Her research focuses on assessment for explaining, predicting, and improving human performance and system design in a variety of domains including nuclear, human-robot teaming, training and education, medical, aviation, and cyber.



JUST PUBLISHED!

Usability Assessment: How to Measure the Usability of Products, Services, and Systems

Volume 1, Users' Guides to Human Factors and Ergonomics Methods

By Philip Kortum

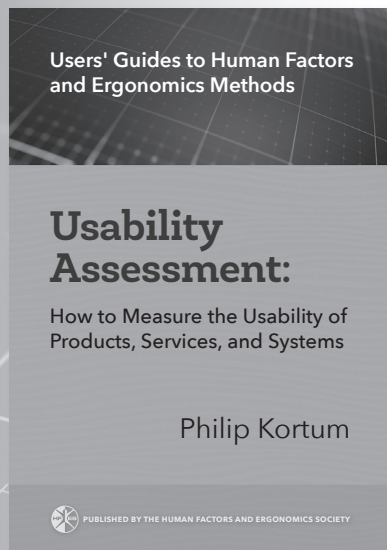

Usability Assessment is a concise volume for anyone requiring knowledge and practice in assessing the usability of any type of product, tool, or system *before* it is launched. It provides a brief history and rationale for conducting usability assessments and examples of how usability assessment methods have been applied, takes readers step by step through the process, highlights challenges and special cases, and offers real-life examples. By the end of the book, readers will have the knowledge and skills they need to conduct their own usability assessments without requiring that they read textbooks or attend workshops.

Table of Contents

1. What Is Usability Assessment?
2. Why Assess Usability?
3. Prepare to Perform the Usability Evaluation
4. Create Your Test Plan
5. Perform the Usability Test
6. Special Cases of Usability Assessment
7. Real-Life Example 1: Corporate Web Portal
8. Real-Life Example 2: High-Security Voting System
9. Some Parting Advice

This book will be valuable for undergraduate and graduate students; practitioners; usability professionals; human-computer interaction professionals; researchers in fields such as industrial design, industrial/organizational psychology, and computer science; and those working in a wide range of content domains, such as health care, transportation, product design, aerospace, and manufacturing.

ISBN 978-0-945289-49-4

120 pp., 7" x 10" paperback and e-book

<http://www.hfes.org/publications/>



PUBLISHED BY THE HUMAN FACTORS AND ERGONOMICS SOCIETY

ergoX

SYMPOSIUM

Exoskeletons in the Workplace – Assessing Safety, Usability, & Productivity

Join researchers, designers, and users as they share practical, usable, and evidence-based solutions to address the challenges in military, medical, and industrial domains

The ErgoX Symposium will

- Provide you with an update on human factors, safety, and ergonomics research methods for exoskeletons
- Highlight standards and technology on exoskeletons
- Bring you up-to-date about exoskeleton types and applications, and their potential to reduce injuries and improve human performance

Learn about approaches to the design of human factors research on exoskeletons to appropriately assess fit, usability, safety, ergonomics, work productivity and quality, and cost-effectiveness.

See demos of exoskeletons for different industries

Listen to candid evaluations, methods, expectations, and findings

Opening Presentation: Framing Exoskeleton Usage: Spectrum of Application; Active vs Passive; Business Case, and Device Certification

Visit hfes.org for program updates



HUMAN FACTORS AND ERGONOMICS SOCIETY



photo courtesy of The Boeing Company

SAVE THE DATE!



Human Factors and Ergonomics in Health Care

MARCH 24-27, 2019 | HILTON CHICAGO | CHICAGO, ILLINOIS

Experience the difference!

Expand your knowledge of human factors/ergonomics applied to health-care devices, environments, and end-users in a format that allows for interaction and exchange of knowledge among participants and presenters.

- Get insights on the latest science and best practices
- Understand innovations in the safety of health-care providers and patients
- Sharpen the focus of your HF/E initiatives
- Improve your regulatory approaches

The Health-Care Symposium offers leading human factors experts, pharmaceutical and medical device companies, biomedical engineers, health-care providers, FDA representatives, and patient safety researchers the opportunity to discuss real-world examples and experiences, and find solutions for issues and challenges in health-care.

The symposium is organized into four program tracks

- Consumer and Clinical Health-Care IT
- Health-Care Environments
- Medical and Drug-Delivery Devices
- Patient Safety Research and Initiatives

Stay ahead! Be a part of cutting-edge presentations, interactive posters, and workshops on emerging issues in health-care human factors and the challenges facing us in the near future.

Learn more at www.hfes.org



Photos courtesy of Choose Chicago