



VanDusen
BOTANICAL GARDEN

Plant Sale catalogue

“Focus on Planters and Patios”

Sunday, April 24, 2016

10 a.m. to 4 p.m.



\$2

Welcome to VanDusen Botanical Gardens' 38th Annual Plant Sale.

This catalogue will guide you through the thousands of wonderful plants that we have available for your purchase. We are proud to present the largest plant sale in the lower mainland. All the plants have been carefully selected for you by our many knowledgeable plant sale volunteers and gardening experts.

In recognition of the increasing number of people who are gardening in smaller spaces and containers, we are featuring plants suitable for planters, pots and patios. We want to help gardeners explore this whole new world of inspiring and endless design featuring stunning colours, style and impact.

Heartfelt thanks to the over 400 volunteers who work long, hard hours and contribute their vast collective gardening knowledge to make this plant sale such a success and therefore an important financial contribution to VanDusen Botanical Garden.

Thank you for your support!

Margaret Lord, Plant Sale Chair 2016

We wish to thank our sponsors and vendors for their support:

Alouette Nursery, B.C. Greenhouse Builders Ltd., Budget Printing, Canadian Springs Co. Ltd., Creperie La Boheme, DeVry Greenhouses, Erica Enterprises Ltd., GardenWorks, Harvest Power, Inline Nurseries, Los Beans Coffee Roasting Co., Mangal Kiss Street Food Services, MedTech EMS Doug House, Oriental Orchids Ltd., Pepsi Cola Canada Ltd., Pops Predatory Plants, Salmon's Rentals Ltd., Scouts Canada, Snow Mountain Organic Orchards, Solodko Ukrainian Bakery, Southlands Nursery, Taisuco Canada, Sunflower Creperie La Boheme, The Bean Buggy, The Chili Tank, The Mushroom Man Scott Henderson, Tropical Gardens Orchids, VanNoort Bulb Company, Way to Grow.

VANDUSEN BOTANICAL GARDEN

PLANT SALE CATALOGUE 2016

BERRIES.....	4
FRUIT TREES	5
HERBS	6
FUCHSIAS	8
BEGONIAS	8
ORCHIDS AND EXOTICS	9
GERANIUMS (PELARGONIUMS).....	9
PACIFIC NORTHWEST NATIVE PLANTS	10
PERENNIALS	13
RHODODENDRONS AND AZALEAS.....	20
VANDUSEN SEEDS	23
SUCCULENTS AND CACTI	24
POT LUCK	25
TREES AND SHRUBS.....	26
TROPICALS.....	33
TOMATOES	34
VEGETABLES	34
MUSHROOM KITS.....	34
VINES.....	35
VANDUSEN PLANT SALE MAP.....	36

BERRIES

Genus: Rubus	Size	Origin	Bloom	Pick	Description
Autumn Bliss Raspberry	#1	England	self-fertile	Aug-Oct	Fall fruiting, later than Heritage
Encore Raspberry	#1	Cornell Uni. USA	self-fertile	July-Aug	Vigorous, nearly spineless, firm fruit, good for freezer
Tulameen Raspberry	#1	BC, Canada	self-fertile	July-Aug	Late summer, tall canes, high yield, sweet large berries
Heritage Raspberry	#1	Cornell U. USA	self-fertile	Aug-Sept	Fall fruiting, very productive
Genus: Vaccinium					
Chandler Blueberry	#1 pot	Maryland, NJ	psf	July-Aug	Full, attractive plant with giant berries
Duke Blueberry	#1 pot	Maryland, NJ	psf	July-Aug	Large flavourful berry, sugars increase in freezing
Summer Breeze 3-in-1 Blueberry	#5 pot		sf	July-Aug	3 cultivars in one pot for maximum pollination, perfect for patios
Sweetheart Blueberry	#1 pot	NJ, 2010	psf	June-Aug	Two crops in mild winter years
Reka Blueberry	#1 pot	New Zealand	psf	July-Aug	Upright growth habit, dark flavourful berries
Delavayi Evergreen huckleberry	#1 pot	China, Burma	psf	Aug-Sept	Hardy, does well in shade. White flowers in spring. Blue-black berries
Thunderbird Evergreen huckleberry <i>Vaccinium ovatum</i>	#1 pot	West Coast USA/BC	psf	July	Blue-black berries. Tastes like a cross between huckleberry & blueberry
Genus: Fragaria					
Eversweet Strawberry	#1 pot		sf	June-Aug	Everbearing, large sweet dark-red berries, disease resistance, heat tolerant
All Star Strawberry	#1 pot	U of Maryland	sf	early June	Day-neutral, likes cool weather, firm glossy berries, excellent flavour
Albion Strawberry	#1 pot	U of California	sf	1.Aug-frost	Day-neutral, high yield, large berries
Honeoye Strawberry	#1 pot	Cornell U. USA	sf	Early mid	Mid sized bright-coloured fruit. Very productive
Genus: Ribes					
<i>Ribes nigrum</i> 'Ben Nevis' Blackcurrant	#1 pot		sf	July	Fruit med with high vitamin C, excellent for juice/jelly
<i>Ribes rubrum</i> 'Red Lake' Redcurrant	#1 pot		sf	early July	Fruit med red tangy, vitamin C, excellent for juice/jelly
<i>Ribes rubrum</i> White currant	#1 pot		sf	early June	White fruit, very productive
Genus: Sambucus					
Lacinata American elderberry	#1 pot	USA	sf	August	Showy, compact, attracts wildlife, medicinal, good for wine/juice/jelly
Genus: Aronia					
<i>Aronia</i> 'Viking' Black chokecherry	#1 pot		sf	August	Deep purple juice, sour, very high in anthocyanins and flavonoids
Genus: Vitis					
Sovereign Coronation Seedless grape	#1 pot	Summerland RS	sf	mid Oct	Blue grape, mid season, small amount of seeds, ex. concord-like flavour
Himrod Seedless Grape	#1 pot	New York, 1952	sf	late Sept	Long clusters, sweet, juicy grn grapes, early season, ex. for raisins. Hardy
Genus: Rheum					
Strawberry-Red Rhubarb	#1 pot		sf	spring	Bright red stalks with mild rhubarb flavour
Genus: Lycium					
Dynamite Goji Berry	#1	China	sf	June-Aug	Juicy sweet bright red berries, bears before Firecracker. Tall, wide habit
Firecracker Goji Berry	#1	China	sf	June-Aug	Brilliant red berries. High yield, later than Dynamite. Upright, arching

FRUIT TREES

Variety	R/s	Origin	Bloom	Pick	Description	Additional info
Genus: Malus (Apple)						
Akane	M26	Japan, 1937	mid	September	Med, bright red, sweet, juicy, crisp, slight strawberry	
Alexander	M26	Ukraine c 1700	mid	September	Large, yellow, rosy-red flushed, quite sweet, sl aromatic	
Belle de Boskoop, Goudrenet	M9	Holland, 1856	early *trip*	October	Large, greenish-gold, russeted, sharp, juicy, aromatic	for cider
Cox's Orange Pippin	M26	UK 1825	mid	Sept-Oct	Med, gr-yellow, sweet, aromatic, nutty, rich, honeyed	
Discovery	M26	UK 1949	mid	late Aug	Med, gr-yellow fl bright red, juicy, crisp, hint of strawb	
Egremont Russet	M9	UK 1872	early	September	Med, sl orange flush, sweet, aromatic, nutty, flavour gd	
Ildrod Pigeon	M9	Denmark 1840	mid	October	Med, heavily fl red, crisp, sl aromatic, hint of strawberry	
James Grieve	M26	Scotland, 1890	mid, psf	September	Med, green fl & striped red, sharp, juicy, excellent	
Jefferis	26,111-9	Penn, USA, 1830	mid	September	Sm, fl & striped dark red, sweet, pear-like, heavy crop	
Jonagold	M9, M26	NY USA 1943	mid *trip*	October	Med-lg, yellow striped, sw-sh, aromatic, rich, honeyed	
Liberty	M9, M26	NY 1978	mid, psf	October	Med, flushed burgundy, sweet-sharp, juicy, crisp	
Michelin	MM111	France	late	October	Small, yellow-green, sl astringent, med bittersweet	for cider
New Brunswick	M9	NB, Canada	early	August	Med, fl & striped red, firm, crisp, rather tart, exc cooker	
Northern Spy	M26	New York c1800	late	October	Med-lg, yell fl dark red, sweet-sharp, crisp, rich, intense	
Oaken Pin	M26	Exmoor c 1876	mid	September	Lg, fl dark orange-red, aromatic, flavour rich, intense	
Orin	M26	Japan, 1981	mid	October	Med, oblong, yellow, sweet, aromatic, fl very honeyed	
Rosa de Cluj	MM111	Romania,		September?	Med, red, very sweet	
Stoke Red	MM111	Somerset, UK	mid, sf	September	Small, fl orange, sweet-sharp, crisp, flavour intense	for cider
Genus: Malus (Crabapple)						
Hansen's Red Fleshed Crab	MM111	S Dakota, c 1920	mid	September	5 cm, rosy-bloom, red-fleshed, elongated	also for cider
John Downie crabapple	M9	England, 1891	mid	September	3-4 cm, peach-coloured	for jelly
Kerr crabapple	MM111	Manitoba 1938	early	Sept?	4-5 cm, oval, dark red	also for cider
Snowdrift crabapple	MM111	USA 1965	mid	n/a	Excellent pollenizer, robins love the fruit	
Genus: Pyrus (Perry Pear)						
Butt	OHF 87	England 1884	mid		Bitter-sharp	for perry
Hendre Huffcap	OHF 87	England		mid-season	Low acid, low tannin, excellent qualities for perry	for perry
Summer Blood Birne	OHF 87					for perry
Sangvinelle	OHF 87					for perry
Genus: Prunus)						
Cupid Dwarf sour cherry		U of Sask	early psf	mid sum	Latest variety. Large and black	
Valentine Dwarf sour cherry		U of Sask	psf	mid sum	Few suckers. Tart, best for pies	
Romeo Dwarf sour cherry		U of Sask	psf	late Aug	Dark red-black fruit. Flavourful, productive	
Juliet Dwarf sour cherry		U of Sask	psf	late sum	No suckers. Productive. Dark, sweet fruit	

trip = pollen sterile, sf = self-fertile, psf = partially self-fertile

HERBS

Plant Name	Height	Colour	Bloom	Information
<i>Agastache foeniculum</i> (anise hyssop)	90cm (36in)	lavender	summer	Leaves used for herbal teas. Flowers attractive to bees
<i>Allium sativum</i> (Russian red garlic)	40cm (16in)	lavender	summer	Purple-blotched bulbs, strong flavour
<i>Allium tuberosum</i> (garlic chives)	15cm (6in)	white	summer	Garlic flavour
<i>Aloysia triphylla</i> (lemon verbena)	1m (3ft)	white	e. summer	Fragrant leaves, tender
<i>Angelica archangelica</i> (angelica)	2m (6ft)	greenish-yellow	e. summer	Medicinal. Used in confectionary
<i>Artemisia dracuncululus</i> var. <i>sativa</i> (French tarragon)	50cm (20in)	blue-green foliage		Culinary
<i>Borago officinalis</i> (bush borage)	90cm (36in)	deep blue	summer	Culinary, hardy annual
<i>Calamintha grandiflora</i> (showy calamint)	40cm (16in)	red-purple bloom	summer	Culinary, requires good drainage and sunny location
<i>Cardamom</i>		foliage		Tropical Asian plant of the ginger family
<i>Chamaemelum nobile</i> (Roman camomile)	15cm (6in)	white	summer	Mat forming aromatic perennial
<i>Coriandrum sativum</i> (coriander, cilantro)	50cms (20in)	white to mauve	summer	Culinary, hardy annual. One of the oldest-known herbs
<i>Cymbopogon citratus</i> (lemon grass)	45cm (18in)		summer	Tender perennial, bring indoors for winter
<i>Cynara cardunculus</i> (cardoon)	150cms (60in)	purple	l. summer	Architectural plant, silver foliage. Edible leaf midribs
<i>Echinacea purpurea</i> (echinacea)	100cms (40in)	pink	summer	Medicinal
<i>Eucalyptus</i> varieties	container	grey-green foliage		Container, drought tolerant. Fragrant foliage
<i>Foeniculum vulgare</i> (fennel)	2m (6ft)	green-yellow/blue	l. summer	Culinary, leaves or seeds
<i>Foeniculum vulgare</i> 'Purpureum' (bronze fennel)	2m (6ft)	bronze foliage	l. summer	Culinary, leaves or seeds
<i>Fragaria vesca</i> (Alpine strawberries)	hanging bskt.	white	summer	Culinary
<i>Fragaria</i> spp. (ever-bearing strawberries)	hanging bskt.	pink	summer	Culinary
<i>Galium odoratum</i> (sweet woodruff)	groundcover	white	May	Shade lover. Dainty foliage and flowers
<i>Gaultheria procumbens</i> (wintergreen)	15cm (6in)	white/pale pink	summer	Aromatic scarlet berries persist through winter
<i>Helichrysum angustifolium</i> (curry plant)	60cm (24in)	grey foliage	summer-fall	Sunny location, well drained
<i>Levisticum officinale</i> (lovage)	150cms (60in)	yellow	summer	Celery-flavoured, hardy, culinary perennial
<i>Laurus nobilis</i> (sweet bay)	3m (10ft)	dark green foliage		Per. shrub from Mediterranean, leaves used in cooking
<i>Lavandula angustifolia</i> 'Hidcote'	45cm (18in)	deep purple	summer-fall	Small growing form
<i>Lavandula angustifolia</i> 'Munstead'	45cm (18in)	deep purple	summer-fall	Sunny location, well drained
<i>Lavandula dentata</i> (fringed lavender)	60cm (24in)	purple, pink	e. summer	Sunny location, well drained
<i>Lavandula</i> 'Grosso'	60cm (24in)	purple	e. summer	Sunny location, well drained
<i>Lavandula stoechas</i> (French lavender)	60cm (24in)	purple, pink	e. summer	Sunny location, well drained
<i>Melaleuca alternifolia</i> (melaleuca or tea tree)	6m (18ft)	white	summer-fall	Noted for essential oil, medicinal. Lime-free soil in full sun
<i>Melissa officinalis</i> (lemon balm)	45cm (18in)	bright green foliage	l. summer	Fragrant leaves, culinary, teas, spreads rapidly from seeds
<i>Mentha x piperita</i> 'Vulgaris' (peppermint)	30cm (12in)	purple-tinged foliage	summer	Partial shade, moist soil, can be invasive
<i>Mentha requienii</i> (Corsican mint)	groundcover	purple	summer	Peppermint smell
<i>Mentha x rotundifolia</i> (apple mint)	30cm (12in)	white	summer	Round, hairy leaves, use for flavouring summer drinks
<i>Mentha spicata</i> (spearmint)	45cm (18in)	mauve		Culinary use, as flavouring or in tea
<i>Mentha suaveolens</i> 'Variegata' (pineapple mint)	30cm (12in)	variegated foliage	summer	Use to decorate salads

HERBS

Plant Name	Height	Colour	Bloom	Information
<i>Monarda didyma</i> 'Panorama Mix' (bergamot)	60cm (24in)	red, purple, white		Attracts bees, use petals in teas
<i>Myrrhis odorata</i> (sweet cicely)	75cm (30in)	white	summer	Culinary. Sweet-scented, attractive perennial
<i>Nepeta cataria</i> (catmint or catnip)	90cm (36in)	blue, white	summer	Attractive to bees as well as cats
<i>Ocimum basilicum</i> (sweet basil)	45cm (18in)	bright green foliage	summer	Culinary, tender annual. Other varieties, Thai and lemon
<i>Ocimum camphorata</i> 'Dark Opal' (purple basil)	38cm (15in)	purple foliage	summer	Culinary, tender annual
<i>Ocimum</i> var. <i>minimum</i> (Greek basil)	20cm (8in)	tiny green foliage	summer	Dwarf variety, pot culture, tender annual
<i>Ocimum basilicum</i> var. <i>thyrsiflora</i> (Thai basil)	20cm (8in)	narrow leaves, purple flws	summer	Widely used throughout southeast Asia. Spicy flavour
<i>Origanum onites</i> (French or pot marjoram)	groundcover	bright green foliage	l. summer	Culinary, mild
<i>Origanum majorana</i> (sweet marjoram)	groundcover	white flowers	l. summer	Culinary. Mix of sweet pine and citrus flavour
<i>Origanum vulgare</i> 'Aureum'	groundcover	yellow-green foliage	l. sum-fall	Culinary, decorative
<i>Origanum vulgare</i> subsp. <i>hirtum</i> (Greek oregano)	60cm (24in)	pink, white	summer	Culinary, strong flavour. Compact habit
<i>Pelargonium</i> (scented geranium)	30cm (12in)	pink or white	summer	Easy to grow, fragrant and attractive plants
<i>Petroselinum crispum</i> (curled parsley)	30cm (12in)		summer	Culinary uses, main ingredient in French bouquet garni
<i>Petroselinum crispum</i> 'Italian' (Italian parsley)	30cm (12in)		summer	Culinary uses, flat leaf, with stronger flavour
<i>Polygonum odoratum</i> (Vietnamese coriander)	20cm (8in)			Lemony aroma. Leaves used in Southeast Asian cooking
<i>Rosmarinus officinalis</i> (rosemary)	60cm (24in)	blue	spring	Culinary uses
<i>Rumex acetosa</i> (common sorrel)	60cm (24in)			Leaves used in sauces, soups
<i>Ruta graveolens</i> (common rue)	60cm (24in)	yellow	summer	Attractive blue-green foliage. Cultivated for medicinal use
<i>Salvia officinalis</i> 'Berggarten'	60cm (24in)	purple	e. summer	Compact in habit
<i>Salvia elegans</i> (pineapple sage)	60cm (24in)	blue, purple	summer	Sunny location, culinary
<i>Salvia officinalis</i> (common sage)	60cm (24in)	purple, pink or white	summer	Sunny location, culinary
<i>Salvia officinalis</i> 'Purpurascens' (purple sage)	60cm (24in)	blue, purple	summer	Sunny location, culinary, decorative
<i>Salvia officinalis</i> 'Tricolor' (tri-colour sage)	60cm (24in)	purple	summer	Sunny location, culinary, decorative
<i>Sanguisorba minor</i> (salad burnet)	25cm (10in)	mauve	summer	Cucumber flavour
<i>Satureja ontana</i> (winter savory)	30cm (12in)	pale pink	summer	Sunny location, culinary
<i>Stevia rebaudiana</i> (stevia)	38cm (15in)		summer	Annual. Leaves are a natural sweetener
<i>Thymus x citriodorus</i> (lemon thyme)	15cm (6in)	purple w. golden foliage	summer	Culinary, hardy
<i>Thymus x citriodorus</i> 'Aureus' (gold lemon thyme)	15cm (6in)	purple	summer	Gold-splashed leaves
<i>Thymus x citriodorus</i> 'Silver Queen' (variegated thyme)	groundcover	purple with variegated foliage	summer	Culinary. Plant in any well-drained, sunny location. Looks good in front of a sunny perennial border
<i>Thymus herba-barona</i> (caraway thyme)	groundcover	mauve pink	summer	Hardy, mid-summer flowering
<i>Thymus pseudolanuginosus</i> (woolly thyme)	groundcover	pale pink	summer	Soft, grey-green woolly leaves
<i>Thymus serpyllum</i> 'Elfin'	5cms (2in)	magenta-pink	summer	Diminutive, glossy leaves, hummock-forming habit
<i>Thymus serpyllum</i> 'Pink Chintz'	groundcover	salmon-pink	summer	Vigorous cultivar
<i>Thymus vulgaris</i> (common thyme)	groundcover	purple or white	summer	Culinary. Well drained, sunny position
<i>Viola</i> (Johnny jump up, heart's ease)	15cm (6in)	purple, yellow & white	summer	Winter hardy. Use as salad garnish
<i>Wasabia japonica</i> (wasabi)	30cm (12in)			Grated root is commonly served with sushi & sashimi

FUCHSIAS

Fuchsias come in thousands of varieties, and can be grown as trailing annuals in baskets or planters, or as hardy plants directly into the garden. Fuchsias bloom from early summer to early autumn.

Although fuchsias are not fragrant, hummingbirds are attracted to nectar from the colourful flowers.

Growing requirements:

Morning sun, dappled or partial shade all day. Grow in moist soil, high in organic matter.

Feed with a quick-release water-soluble fertilizer every two weeks.

Hardy fuchsias:

Fuchsia magellanica, F. magellanica 'Aurea', F. 'Riccatoni', F. 'Genii', F. 'Gracilis'

Variegated leaf varieties:

Fuchsia magellanica 'Tricolor'; F. 'Golden Marinka' (yellow leaf); F. 'Autumnell'; F. 'Island Sunset'

Semi-hardy:

Fuchsia 'Otto' - Large, exuberant double flowers with very flared red sepals and purple corollas. Attractive to bees, butterflies and humming birds

Fuchsia 'Winston Churchill' - Flowers are double, with short, reflexed, pink sepals and tube, and bluish-lavender petals

Hardy fuchsias grow back late each spring. Pot up trailers and uprights into planters and baskets. Pinch back new growth tips until the end of June; this will promote new growth and more flower buds to form. To make a basket we recommend using up to eight, 2 ½" plants in a twelve inch basket. Planting the same variety in one basket makes a much nicer show.

We have added the following varieties available for 2016:

Fuchsia 'Dancing Flame' - Winner of the RHS Award of Garden Merit

Fuchsia (Diva Series) 'Midnight', 'Rose and Purple', 'White and Lilac'

Fuchsia 'Garden Meister' - Red tubular-shaped, honeysuckle fuchsia blossoms

Fuchsia 'Marinka' - Scarlet sepals and deep red petals, on this free flowering trailing fuchsia

Fuchsia 'Lottie Hobby' (aka 'Mini False Creek') - Bushy, upright, vigorous plant has very small serrated leaves and small, single flowers with dark pink sepals and tube, and deep pink petals

Fuchsia 'Pink Marshmallow' - Extra large double flowers, with long pale pink tube

Fuchsia x hybrida 'Sunbeam Ernie' - Compact fuchsia, heat tolerant, perfect for small pot

Fuchsia x hybrida 'Sunbeam Samba' - Very early-blooming, upright fuchsia

Fuchsia 'Voodoo' - Long blooming, dangling flowers in shades of intense red and purple have a delicate, silky appearance

Fuchsia 'Windchimes' - Pure white flowers shine against the green foliage

BEGONIAS

Fibrous begonias are annual plants. These brightly colored begonias are equally at home in full sun or shade, in containers or garden beds.

Angel Wing begonia is named for the shape of its leaves. With its attractive year round foliage, you can grow an Angel Wing begonia indoors as a houseplant, in bright, indirect light. These cane-type begonias are some of the world's best performing and easiest begonias to grow. They have interesting leaves and magnificent displays of pendant and drooping flowers.

Nonstop begonias can be planted in a flowerbed, hanging basket or patio container, in any well-drained soil.

Solenia begonias - These hiemalis-type begonias have been a popular semi-shade basket plant for years.

The new Solenia series are faster growing, mildew resistant and take full sun, and are a cross between a tuberous begonia and a wax begonia. They are 'self cleaning' and require no deadheading.

ORCHIDS AND EXOTICS

The orchids available at the sale are outstanding indoor plants, with attractive blooms; some types last for several months at a time. Orchids are far tougher and hardier than most people think, and are mostly extremely adaptable. All orchid plants at the sale come with detailed culture sheets, to provide information on how to nurture them.

Here are some examples of the types of orchids that are expected to be available at the sale:

- ***Phalaenopsis*** (moth orchid) – this is the most popular type of orchid because the blooms last for so long. There will be a big selection, perfect gifts for birthdays, Mother's Day or any special occasion. They feature flat, glossy, spreading leaves supporting arching spikes of white, pink, purple, yellow, or spotted/striped blooms.
- ***Oncidium*** – a variety of intergenerics; blooms with spikes of fancifully patterned flowers in shades of white, yellow, red and brown.
- ***Cattleya*** – several types of plants could be available, depending on what is 'in spike' at the time of the sale; large, showy flowers with a variety of colours.
- ***Dendrobium*** – a variety of plants could be available, depending on what is 'in spike' at the time of the sale; bloom in sprays with delicate florets that are 1 inch to 2 inches across, in an array of colors including purple, pink, fuchsia, white, yellow, green and bicolors.

There will be a large selection of fascinating carnivorous plants, some being hardy outdoor types. Here are some available varieties:

- ***Sarracenia*** – this is a large and varied family of North American Pitcher Plants. These incredible plants display a multitude of foliage colours.
- and are winter hardy in the Pacific Northwest. They also eat bugs.
- ***Dionaea*** – Venus Fly Traps are the only 'active' carnivorous plants.
- ***Drosera*** – Sundews are sticky plants, great for trapping fruit flies and fungus gnats in your house or greenhouse.
- ***Pinguicula*** – Attractive plants with colourful, violet-like flowers.
-

GERANIUMS (PELARGONIUMS)

Most of our plants this year are zonal geraniums, named for the dark, horse-shoe-shaped markings on the leaves.

Don't over-water geraniums as they prefer to be a little on the dry side. Geraniums are suitable for planting in the garden or in containers. They do well with some shade and bloom all summer and into the fall, until the first frost.

Zonal geranium colours are red, pink, salmon and white

Trailing or ivy geraniums - varied colours, for hanging baskets and containers

Scented geraniums – grown for leaf fragrance more than for flowers

Lemon-scented geranium, ever popular

Peppermint-scented geranium, all time favourite

'Pink Champagne' scented geranium. Dark green, leathery leaves with a citrusy scent. New this year

'Prince George', orange-scented geranium

Volunteering at VanDusen

We endeavour to provide our members with a variety of opportunities to build new skills, make friends and help the Garden grow. We have volunteer opportunities for all interests. Please join us at an upcoming volunteer orientation to find out more.

Opportunities include: Education, Guides, Master Gardeners, School Program Leaders, Summer Nature Program Leader, Teaching Assistants, Clerical Activities, Office Assistance, Garden Activities, Dried Flower Arrangers, Garden Guerillas, Garden Shop, Labellers, Library, Seed Collectors, Public Relations, Community Ambassadors, Customer Services, Membership, Visitor Services, Special Events, Compost Sale, Festival of Lights, Manure Sale and, of course, the Plant Sale.

PACIFIC NORTHWEST NATIVE PLANTS

Gardening with PNW Native Plants

- Plan according to the habitat conditions in which the plants naturally grow: sun exposure, slope (shedding or receiving water), soil moisture, soil nitrogen and soil texture - organic (add compost) to mineral (add sand and gravel)
- Plan for the mature size of the plant. Native plants are best when they can grow to a natural height and width without excessive pruning.
- Plant in descending layers. Many of our native plants are from forest habitats with multiple layers of trees that shade shrubs, perennials and ferns.
- Place plants together from the same habitats. They have evolved forms, leaf shapes and specific relationships to grow together successfully.
- Many perennials are spring-flowering when there is natural soil moisture available, and some go dormant in the summer.
- Plants in dry habitats usually prefer well-drained, low nitrogen soil; plants in very moist habitats usually prefer high nitrogen soil.
- Climate and habitats are changing; where possible use plants that prefer drier soils and that can survive dry summer conditions with watering restrictions.

Full Sun | Very Dry to Moderately Dry Soil or Summer-Dry Soil (SD)

Plant Name	Type Preferred Exposure	Max. Height	Flowers	Other Features
<i>Arbutus menziesii</i> (arbutus)	Broadleaf evergreen tree, SD	30m (100ft)	white or pinkish	aged bark brownish-red and peeling
<i>Quercus garryana</i> (Garry oak)	Deciduous tree, SD	25m (80ft)	inconspicuous	broad spread; produces acorns
<i>Ribes sanguineum</i> (red-flowering currant)	Deciduous shrub	3m (10ft)	light to dark rose, rarely white	blue-black fruit; leaves fragrant
<i>Achillea millefolium</i> (yarrow)	Perennial	1m (3ft)	white to cream to pinkish-red	leaves fragrant, used in teas
<i>Camassia leichtlinii</i> (great camas)	Perennial, SD	1m (3ft)	pale to deep blue, rarely white	bulbs edible when cooked
<i>Lomatium nudicaule</i> (barestem desert-parsley)	Perennial, some shade	90cm (36in)	yellow	young leaves edible raw or cooked
<i>Fritillaria affinis</i> (chocolate lily)	Perennial	80cm (32in)	brownish-purple to yellowish-green;	bulbs edible when cooked
<i>Camassia quamash</i> (common camas)	Perennial, SD	70cm (28in)	pale to deep blue, rarely white	bulbs edible when cooked
<i>Delphinium menziesii</i> (Menzies' larkspur)	Perennial	70cm (28in)	purple to blue to white	
<i>Triteleia hyacinthina</i> (white triteleia)	Perennial	60cm (24in)	white often tinged with blue, to light blue, with green mid-veins	
<i>Allium cernuum</i> (nodding onion)	Perennial	50cm (20in)	pink to rose-purple or whitish	bulb, leaves, flowers and seeds edible
<i>Dodecatheon pulchellum</i> (few-flowered shooting-star)	Perennial, SD	45cm (18in)	multi-coloured: pink to reddish-purple, yellow and white	
<i>Penstemon fruticosus</i> (shrubby penstemon)	Broadleaf evergreen shrub	40cm (16in)	blue-lavender to light purple	
<i>Erythronium oregonum</i> (white fawn lily)	Perennial, SD	35cm (14in)	white with yellow-orange base	
<i>Allium acuminatum</i> (Hooker's onion)	Perennial	30cm (12in)	rose-pink to whitish	bulb, leaves, flowers and seeds edible
<i>Olsynium douglasii</i> (satinflower)	Perennial, SD	30cm (12in)	reddish-purple	
<i>Potentilla villosa</i> (villous cinquefoil)	Perennial	30cm (12in)	yellow	
<i>Sedum spathulifolium</i> (broad-leaved stonecrop)	Perennial succulent	20cm (8in)	bright yellow	
<i>Arctostaphylos uva-ursi</i> (kinnikinnick)	Broadleaf evergreen shrub	15cm (6in)	pinkish-white	bright red fruit edible; groundcover
<i>Sedum oregonum</i> (Oregon stonecrop)	Perennial succulent	15cm (6in)	yellow becoming pinkish	
<i>Fragaria chiloensis</i> (coastal strawberry)	Evergreen perennial	trailing	white	need male and female plants to make fruit;
Warning: Species with edible bulbs should not be confused with <i>Zygadenus venenosus</i> or death camas which is poisonous.				

PACIFIC NORTHWEST NATIVE PLANTS

Part Sun - Part Shade | Moderately Dry to Moist Soil

Plant Name	Type Preferred Exposure	Max. Height	Flowers	Other Features
<i>Amelanchier alnifolia</i> (Saskatoon)	Deciduous shrub, sun or shade	6m (20ft)	white	purple to blackish fruit edible
<i>Sambucus cerulea</i> (blue elderberry)	Deciduous shrub	5m (16ft)	white or cream	powder blue fruit edible when cooked
<i>Ribes sanguineum</i> (red-flowering currant)	Deciduous shrub, sun	3m (10ft)	light to dark rose, rarely white	blue-black fruit not edible
<i>Vaccinium ovatum</i> (evergreen huckleberry)	Broadleaf evergreen shrub, sun	3m (10ft)	bright pinkish	deep purplish-black fruit edible
<i>Mahonia aquifolium</i> (tall Oregon-grape)	Broadleaf evergreen shrub	2.5m (8ft)	yellow	blue fruit edible
<i>Gaultheria shallon</i> (salal)	Broadleaf evergreen shrub	1.5m (5ft)	white to pinkish	purplish-black fruit edible
<i>Vaccinium membranaceum</i> (black huckleberry)	Deciduous shrub	1.5m (5ft)	pale yellowish-pink	purple or dark purplish-reddish fruit edible
<i>Lilium columbianum</i> (tiger lily)	Perennial, sun	1.2m (3ft)	yellow-red to reddish-orange with dark red or purple spots	
<i>Eurybia conspicua</i> (showy aster)	Perennial	1m (3ft)	blue to violet with yellow	
<i>Penstemon ovatus</i> (broad-leaved penstemon)	Perennial	1m (3ft)	deep blue	
<i>Campanula rotundifolia</i> (common harebell)	Perennial	80cm (32in)	blue	
<i>Mahonia nervosa</i> (dull Oregon grape)	Broadleaf evergreen shrub	60cm (24in)	yellow	blue fruit edible
<i>Sisyrinchium idahoense</i> (Idaho blue-eyed grass)	Perennial, sun	40cm (16in)	pale blue to purple, or deep violet-purple	
<i>Erythronium revolutum</i> (pink fawn lily)	Perennial, summer-wet	35cm (14in)	rose-pink with yellow base	
<i>Trientalis latifolia</i> (northern starflower)	Perennial	25cm (10in)	pinkish to whitish	
<i>Arctostaphylos uva-ursi</i> (kinnikinnick)	Broadleaf evergreen shrub	15cm (6in)	pinkish-white	bright red fruit edible; groundcover
<i>Fragaria vesca</i> (wood strawberry)	Perennial	trailing	white	red fruit edible
<i>Fragaria virginiana</i> (wild strawberry)	Perennial, sun	trailing	white	red fruit edible

Part Sun – Part Shade | Moist to Very Moist Soil

Plant Name	Type Preferred Exposure	Max. Height	Flowers	Other Features
<i>Tsuga mertensiana</i> (mountain hemlock)	Coniferous tree	40m (130ft)	not applicable	stays small for years; very slow growing
<i>Cornus nuttallii</i> (western flowering dogwood)	Deciduous tree, shade roots	20m (65ft)	white or pinkish bracts; petals greenish-white, purplish-tinged	
<i>Acer circinatum</i> (vine maple)	Deciduous tree, shade or sun	8m (26ft)	white and red, small	golden to bright red leaves in fall
<i>Rubus spectabilis</i> (salmonberry)	Deciduous shrub	4m (13ft)	rosy red to reddish-purple	yellow, salmon or dark red fruit edible
<i>Vaccinium parvifolium</i> (red huckleberry)	Deciduous shrub, shade	4m (13ft)	yellowish-pink	bright red fruit edible
<i>Rosa nutkana</i> (Nootka rose)	Deciduous shrub	3m (10ft)	pink	purplish-red fruit edible when cooked
<i>Rubus parviflorus</i> (thimbleberry)	Deciduous shrub	2.5m (8ft)	white	red fruit edible
<i>Vaccinium ovalifolium</i> (oval-leaved blueberry)	Deciduous shrub, shade	2m (7ft)	pinkish	purplish-black to bluish-black fruit edible
<i>Aruncus sylvester</i> (goatsbeard)	Perennial	2m (7ft)	white	
<i>Gaultheria shallon</i> (salal)	Broadleaf evergreen shrub	1.5m (5ft)	white to pinkish	purplish-black fruit edible
<i>Polystichum munitum</i> (sword fern)	Evergreen fern	1.5m (5ft)	not applicable	
<i>Streptopus amplexifolius</i> (clasping twistedstalk)	Perennial	1.2m (3ft)	greenish-white to yellowish-green	yellow to red fruit, aging to dark purple
<i>Aquilegia formosa</i> (Sitka or red columbine)	Perennial	1m (3ft)	pale to deep red and yellow	
<i>Maianthemum racemosum</i> (false Solomon's-seal)	Perennial	1m (3ft)	white, fragrant	mottled green to red fruit
<i>Mimulus lewisii</i> (pink monkey-flower)	Perennial	1m (3ft)	pink-purple to rose-red	
<i>Prosartes hookeri</i> (Hooker's fairybells)	Perennial, shade	1m (3ft)	creamy white	yellow turning to red fruit not edible
<i>Thalictrum occidentale</i> (western meadowrue)	Perennial	1m (3ft)	greenish-whitish, purplish-tinged	

PACIFIC NORTHWEST NATIVE PLANTS

Part Sun – Part Shade | Moist to Very Moist Soil

Plant Name	Type Preferred Exposure	Max. Height	Flowers	Other Features
<i>Castilleja miniata</i> (scarlet paintbrush)	Perennial	80cm (32in)	bright red or scarlet to orange bracts	
<i>Erigeron speciosus</i> (showy daisy)	Perennial, sun	80cm (32in)	blue, lavender or white and yellow	
<i>Mimulus guttatus</i> (yellow monkey-flower)	Perennial, sun	80cm (32in)	yellow with maroon markings	
<i>Tellima grandiflora</i> (tall fringe-cup)	Perennial	80cm (32in)	greenish-white to rose	
<i>Adiantum aleuticum</i> (northern maiden-hair)	Deciduous fern	75cm (30in)	not applicable	
<i>Penstemon serrulatus</i> (coast penstemon)	Perennial	70cm (28in)	deep blue to purple	
<i>Blechnum spicant</i> (deer fern)	Evergreen fern, shade	60cm (24in)	not applicable	
<i>Heuchera micrantha</i> (small-flowered alumroot)	Perennial	60cm (24in)	white	
<i>Polypodium glycyrrhiza</i> (licorice fern)	Evergreen fern	60cm (24in)	not applicable	rhizomes licorice-flavoured
<i>Allium geberi</i> (Geyer's onion)	Perennial, sun	50cm (20in)	pink, rarely white	bulb, leaves, flowers and seeds edible
<i>Tiarella trifoliata</i> (three-leaved foam-flower)	Perennial	50cm (20in)	white	
<i>Trillium ovatum</i> (western trillium)	Perennial	45cm (18in)	white aging to pale pink to purple	
<i>Iris tenax</i> (Oregon iris)	Perennial, sun	40cm (16in)	blue to purple or lavender, occas. white to pinkish or yellow	
<i>Erythronium revolutum</i> (pink fawn lily)	Perennial, summer-wet	35cm (14in)	rose-pink with yellow base	
<i>Maianthemum dilitatum</i> (False lily-of-the-valley)	Perennial, shade	35cm (14in)	cream to white	red fruit; groundcover
<i>Achlys triphylla</i> (vanilla leaf)	Perennial, shade	30cm (12in)	white	dried leaves fragrant
<i>Cornus canadensis</i> (bunchberry)	Perennial, shade	25cm (10in)	white to pinkish or purplish-tinge	bright coral red fruit edible; groundcover
<i>Gymnocarpium dryopteris</i> (oak fern)	Deciduous fern, shade	25cm (10in)	not applicable	
<i>Oxalis oregana</i> (redwood sorrel)	Perennial	20cm (8in)	white to pinkish	groundcover, spreads vigorously
<i>Vaccinium vitis-idaea</i> (lingonberry)	Broadleaf evergreen shrub	trailing	pinkish	bright red fruit edible; groundcover
<i>Asarum caudatum</i> (wild ginger)	Perennial, shade	mat forming	purplish-brown to greenish-yellow	roots and leaves edible

Part Sun – Part Shade | Very Moist to Wet Soil

Plant Name	Type Preferred Exposure	Max. Height	Flowers	Other Features
<i>Malus fusca</i> (Pacific crab apple)	Deciduous tree, sun	8m (26ft)	white to pink	yellow to reddish or purplish fruit edible
<i>Crataegus douglasii</i> (black hawthorn)	Deciduous tree	7m (23ft)	white	blackish-purple fruit edible cooked
<i>Rubus spectabilis</i> (salmonberry)	Deciduous shrub	4m (13ft)	rosy red to reddish-purple	yellow, salmon or dark red fruit edible
<i>Sidalcea hendersonii</i> (Henderson's checker-mallow)	Perennial, sun	1.5m (5ft)	deep pink	
<i>Matteuccia struthiopteris</i> (ostrich fern)	Fern	1.4m (4ft)	not applicable	young fiddlehead fronds edible cooked
<i>Mimulus lewisii</i> (pink monkey-flower)	Perennial	1.0m (3ft)	pink-purple to rose-red	
<i>Mimulus guttatus</i> (yellow monkey-flower)	Perennial, sun	80cm (32in)	yellow with maroon markings	
<i>Sanguisorba menziesii</i> (Menzies' burnet)	Perennial	80cm (32in)	reddish-purple to pink	
<i>Lysichiton americanum</i> (skunk cabbage)	Perennial	70cm (28in)	yellowish bracts	greenish to reddish fruit not edible
<i>Iris setosa</i> (wild flag)	Perennial	70cm (28in)	blue	
<i>Boykinia elata</i> (coast boykinia)	Perennial, shade	60cm (24in)	white	
<i>Sisyrinchium californicum</i> (golden-eyed grass)	Perennial, sun	60cm (24in)	yellow	
<i>Menyanthes trifoliata</i> (buckbean)	Perennial, sun	40cm (16in)	white, purple-tinged	trailing
<i>Maianthemum dilitatum</i> (False lily-of-the-valley)	Perennial, shade	35cm (14in)	cream to white	red fruit; groundcover

PERENNIALS

Plant Name	Height	Colour	Bloom	Expos.	Fragr.	Description
<i>Actaea simplex</i> 'Hillside Black Beauty'	125cm (50in)	pink	summer	☼○	yes	Very dark purple foliage
<i>Agastache</i> 'Golden Jubilee'	60cm (24in)	violet	summer	☼○	yes	Liquorice scented foliage, attracts butterflies
<i>Ajuga reptans</i> 'Black Scallop'	10cm (4in)	blue	e. spring	☼○		Ground cover, dark foliage, spikes of bright blue flowers
<i>Alyssum montana</i> 'Mountain Gold'	15cm (6in)	yellow	late spring	☼○		Terrific ground cover and trailing over walls
<i>Amsonia</i> 'Blue Ice' (blue star amsonia)	40cm (16in)	blue	late spring	☼		Clusters of starry blue flowers, good fall foliage colour
<i>Anemone nemorosa</i>	10cm (4in)	white/pink	e. spring	☼○		Summer dormant, woodland groundcover; plant with hosta
<i>Anemone nemorosa plena</i>	10cm (4in)	white	e. spring	☼○		Double form, not a fast spreader
<i>Anthemis tinctoria</i> 'Sauce Hollandaise'	60cm (24in)	cream	summer	☼		Long blooming, scented foliage; drought tolerant
<i>Anthriscus sylvestris</i> 'Vicar's Mead'	150cm (5ft)	white	summer	☼○		Purplish stems & foliage, an eye-catching border addition
<i>Aquilegia</i> 'Woodside Gold' (columbine)	50cm (20in)	purple	late spring	☼○		Chartreuse foliage, brightens shady area
<i>Aquilegia vulgaris</i> 'Blue Barlow'	60cm (24in)	blue	late spring	☼		Exquisite, fully double deep violet-blue
<i>Aralia cordata</i> 'Sun King'	75cm (30in)	white	l. summer	●●		Bright gold foliage remains throughout the season
<i>Arisaema concinnum</i> (Japanese cobra lily)	100cm (40in)	foliage	summer	○		Impressive plant with a single, large leaf
<i>Arisaema griffithii</i>	60cm (24in)	foliage	summer	○		Heavily lined and veined
<i>Arisaema sikokianum</i> (Japanese cobra lily)	30cm (12in)	foliage	summer	○		Dark brown "pulpit" and a snow white "jack"
<i>Arisarum proboscideum</i> (mouse plant)	10cm (4in)	brown	spring	○		Glossy leaves, mouse-tail-shaped flower
<i>Artemisia</i> 'Silver Mound'	30cm (12in)	cream	summer	☼○		Soft mounding foliage
<i>Arum italicum</i> 'Pictum'	25cm (10in)	foliage	fall	☼○		Summer dormant
<i>Aster oblongifolius</i> 'Raydon's Favorite'	60cm (24in)	blue	summer	☼		Attracts butterflies, 2016 Plant of the Year
<i>Aster x frikartii</i> 'Monch'	90cm (36in)	mauve	fall	☼○		Known for vigour, mildew resistance, long flowering time
<i>Astilbe x arendsii</i> 'Colour Flash'	30cm (12in)	pink	summer	☼○		Striking summer foliage, burgundy, purple, green
<i>Astilbe x arendsii</i> 'Fanal'	60cm (24in)	red	summer	☼○		Striking red stems
<i>Astilbe x crispa</i> 'Lilliput'	20cm (8in)	salmon-pink	summer	☼○		One of the smallest with crinkly, dark green foliage
<i>Astrantia major</i> 'Roma'	70cm(28in)	pink	summer	☼		Long lasting flowers, great for cutting
<i>Astrantia major</i> 'Sunningdale Variegated'	75cm (30in)	white	summer	☼		Long blooming, variegated foliage
<i>Aubrieta</i> 'Axcent Purple' (purple rock cress)	15cm (6in)	mauve	late spring	☼○		Ideal for front of borders, rock gardens, attracts butterflies
<i>Baptisia</i> 'Twilite Prairieblues'	100cm(40in)	violet	summer	☼		Attracts butterflies and bees; drought tolerant
<i>Bergenia</i> 'Eroica'	40cm (16in)	rich pink	spring	☼○		Glossy evergreen leaves, maroon in winter
<i>Berkheya multijuga</i>	60cm (24in)	gold	summer	☼		Spiky silver-grey foliage; drought tolerant
<i>Bletilla striata</i> 'Soryu Blue Dragon'	60cm (24in)	violet	summer	○		Best grown in moist soil, thrives in containers
<i>Brunnera</i> 'King's Ransom'	30cm (12in)	blue	late spring	☼○		Colourful silver foliage with green veins
<i>Calopsis paniculata</i>	100cm(40in)	foliage		☼		Handsome, reed-like plant, bright green, fine foliage
<i>Camassia esculenta</i>	30cm (12in)	blue	late spring	☼○		Moist meadows, perennial beds and borders
<i>Cardiocrinum giganteum</i> (giant Himalayan lily)	3m (10ft)	white	summer	○	yes	The largest species of all lily plants; spectacular in flower
<i>Centaurea bella</i>	20cm (8in)	pink	summer	☼		Showy flws; silver mat-forming foliage; bees & butterflies
<i>Chaerophyllum hirsutum</i> 'Roseum'	60cm (24in)	pink	e. summer	☼○		Finely divided leaves and umbels of small pink flowers
<i>Chelone oblique</i> (turtlehead)	60cm (24in)	pink	l. summer	☼○		Bears upright stems of hooded flowers; showy, long-lived
<i>Colchicum autumnale</i> (autumn crocus)	15cm (6in)	pink	l. summer	☼○		Well-drained soil; summer dormant

PERENNIALS

Plant Name	Height	Colour	Bloom	Expos.	Fragr.	Description
<i>Convallaria majalis</i> var. <i>rosea</i> (lily-of-the-valley)	15cm (6in)	pink	summer	☉	yes	Good ground cover in woodland setting
<i>Corydalis elata</i>	30cm (12in)	blue	late spring	☉	yes	Moist well-drained soil; foliage persists through the season
<i>Crambe maritima</i>	75cm (30in)	white	summer		yes	Bold, blue-green ruffled foliage; culinary
<i>Crocsmia</i> 'Lucifer'	60cm (24in)	red	summer	☼☉		Attracts butterflies; Alan Bloom hybrid; clump forming
<i>Cypripedium</i> 'Fasciolatum' (striped h. orchid)	30cm (12in)	white	summer	☉		Very rare in native habitat of western China
<i>Cypripedium</i> 'Kentucky Maxi' (hardy orchid)	45cm (18in)	yellow	summer	☉		Extra large creamy-white lady's slippers, red-brown sepals
<i>Cypripedium</i> 'Parkville' (hardy orchid)	25cm (10in)	yellow	summer	☉		All hardy orchids require well-drained, moist soil
<i>Cypripedium</i> 'Pink Blush' (hardy orchid)	40cm (16in)	white	summer	☉		Multi-stemmed; prefers sheltered spot, but loves early sun
<i>Cypripedium</i> 'Pueblo' (hardy orchid)	40cm (16in)	yellow	summer	☉		Likes a partially shaded area in which rhizome can spread
<i>Cypripedium</i> 'Regina White' (hardy orchid)	50cm (20in)	white	summer	☉		The rarer, pure white form of the species
<i>Dahlia</i> 'Bischof of Llandaff'	100cm(40in)	red	summer	☼		10cm bloom, deep bronze foliage
<i>Dahlia</i> 'City of Leiden'	60cm (24in)	deep pink	summer	☼		12cm bloom, bronze foliage, cactus dahlia
<i>Dahlia</i> 'Marble Ball'	45cm (18in)	purple white	summer	☼		9cm bloom, ball dahlia
<i>Dahlia</i> 'Tartan'	100cm (40in)	maroon white	summer	☼		25cm bloom, dinner plate dahlia
<i>Dahlia</i> 'Tsuki Yori'	90cm (36in)	white	summer	☼		15cm bloom, finely cut petal tips that curl uniquely
<i>Dahlia</i> 'Wizard of Oz'	80cm (32in)	pink	summer	☼		8cm bloom, pompom dahlia
<i>Deinranthe bifida</i> (false hydrangea)	40cm (16in)	white	summer	☉		Easily grown in cool, moist soil, afternoon shade
<i>Delphinium</i> NZ 'Blue Lace'	150cm (5ft)	blue	summer	☼		Tall stately spikes
<i>Delphinium</i> Pacific Giant 'Black Knight'	150cm (5ft)	dark violet	summer	☼		Tall stately spikes
<i>Dianthus</i> 'Neon Star' (pinks)	15cm (6in)	pink	summer	☼	yes	Popular as an edging plant
<i>Dianthus cruentus</i>	50cm (20in)	red	summer	☼		Grassy evergreen leaves; attracts bees and butterflies
<i>Dicentra</i> 'Sulphur Hearts' (bleeding heart)	25cm (10in)	yellow	summer	☉		New variety, frosty blue foliage, compact growth
<i>Dicentra spectabilis</i> 'Alba' (bleeding heart)	100cm (40in)	white	spring	☉		White form of bleeding heart
<i>Dicentra spectabilis</i> 'Goldheart' (bleeding heart)	70cm (28in)	pink	summer	☼☉		Golden yellow foliage
<i>Dicentra spectabilis</i> 'Valentine'	60cm (24in)	scarlet	spring	☉		Plum-green foliage with red stems and flowers
<i>Dichelostemma ida-maia</i> 'Pink Diamond'	45cm (18in)	bright pink	summer	☼		Long-blooming 'firecracker' flowers; hummingbirds
<i>Dictamnus albus</i> (gas plant)	100cm (40in)	white	summer	☼		Star shaped seed pods that remain to fall
<i>Dierema pendulum</i> (angel's fishing rod)	100cm (40in)	pink	summer	☼☉		Add gravel and compost when planting
<i>Digitalis grandiflora</i> (yellow foxglove)	60cm (24in)	yellow	summer	☼		Narrow, dainty flowers, attracts bees and butterflies
<i>Dodecatheon</i> 'Queen Victoria'	25cm (10in)	violet	late spring	☉		Dormant in summer, plant with Hostas
<i>Dryopteris erythrosora</i> 'Brilliance'	60cm (24in)	foliage	spring-fall	☉●		Young fronds are orange and mature to green
<i>Echinacea purpurea</i> 'Green Envy'	75cm (30in)	green	summer	☼		Eye catching, petals are pink blending to green
<i>Echinacea purpurea</i> 'Harvest Moon'	75cm (30in)	golden	summer	☼	yes	Strong branching stems, wide petals, profuse blooming
<i>Echinacea purpurea</i> 'Meringue'	45cm (18in)	white	summer	☼		Double-flowered; white petals surround pale yellow centre
<i>Echinacea purpurea</i> 'Ruby Star'	90cm (36in)	pink	summer	☼		Attracts bees and butterflies
<i>Echinops ritro</i> 'Veitch's Blue' (globe thistle)	80cm (32in)	blue	summer	☼		Repeat bloomer, a hot position in sandy soil is preferred
<i>Epimedium</i> 'Purple Pixie' (fairy wings)	25cm (10in)	purple	spring	☼☉		Drought tolerant, perfect for use as groundcovers
<i>Epimedium pubigerum</i> 'Orange Queen'	45cm (18in)	orange	spring	☼☉		Delicate shade plants, perfect for use as groundcovers

PERENNIALS

Plant Name	Height	Colour	Bloom	Expos.	Fragr.	Description
<i>Epimedium x versicolour</i> 'Sulphureum'	20cm (8in)	yellow	spring	●●		Bronze tinged foliage in spring turns more intense in Fall
<i>Eremurus stenophyllus</i> (fox tail lily)	90cm (36in)	yellow	summer	☼		Strong, upright spikes
<i>Erigeron pulchellus</i> 'Meadow Muffin'	25cm (10in)	white	late spring	☼		Hummocks of foliage, excellent for rock garden plant
<i>Eryngium</i> (sea holly)	50cm (20in)	foliage	summer	☼		Prefers drained sandy soil, spiny foliage
<i>Erysimum</i> 'Bowl's Mauve' (shrubby wallflower)	60cm (24in)	mauve	summer	☼	yes	Blooms for months
<i>Euphorbia characias</i> 'Wulfenii'	70cm (28in)	green/yellow	summer	☼●		Evergreen "adds excellent bones to the herbaceous border"
<i>Euphorbia x martinii</i> 'Tiny Tim'	25cm (10in)	green/yellow	summer	☼●		Outstanding compact selection
<i>Filipendula</i> 'Kahome'	50cm (20in)	rose	summer	☼●		Deer proof, prefers continuously moist soil
<i>Fritillaria acmopetala</i>	45cm (18in)	green brown	spring	☼●		Bell shaped blooms
<i>Fritillaria imperialis</i> 'Lutea maxima'	100cm (40in)	yellow	spring	☼●	yes	Circa 1590, this crown imperial carries up to ten blooms
<i>Fritillaria michailovskyi</i> (fritillary)	20cm (8in)	brown	spring	☼●		Will go dormant after bloom and naturalize with time
<i>Gaura lindheimeri</i> 'Snow Fountain'	75cm (30in)	white	summer	☼		Dense, upright red stems, drought tolerant
<i>Gentiana makinoi</i>	30cm (10in)	blue	summer	☼●		Highly treasured for rich flower display in summer
<i>Geranium</i> 'Ballerina'	15cm (6in)	pink	summer	☼●		Ground cover, pink veined petal with black centres
<i>Geranium</i> 'Giuseppi'	15cm (6in)	magenta	summer	☼●		Ground cover, chartreuse foliage
<i>Geranium</i> 'Havana Blues'	30cm (10in)	blue	summer	☼●		Huge flowers, blooms Spring to Fall, chartreuse foliage
<i>Geranium</i> 'Pink Spice'	15cm (6in)	pink	summer	☼		Spreading plant with bronze foliage, good for containers
<i>Geranium</i> 'Rozanne'	40cm (16in)	violet-purple	summer	☼		Large saucer-shaped flowers, white centres, long bloomer
<i>Geranium</i> 'Sandrine'	45cm (18in)	magenta	summer	☼●		New, similar to G. Ann Folkard but with larger flowers
<i>Geranium pratense</i> 'Hocus Pocus'	25cm (10in)	lavender	sum/fall	☼●		Dark foliage, mounding growth habit
<i>Geranium renardii</i>	30cm (10in)	violet	summer	●		Lovely soft textured leaves
<i>Gypsophila paniculata</i> 'Bristol Fairy'	90cm (36in)	white	summer	☼		Deep rooted, resents disturbance, cut back after flowering
<i>Helenium</i> 'Sahin's Early'	90cm (36in)	orange	summer	☼		Long flowering season
<i>Helenium autumnale</i> 'Helena Red Shades'	90cm (36in)	red	summer	☼●		Showy flowers, attracts hummingbirds, mixed colours
<i>Helenium autumnale</i> 'Moerheim Beauty'	100cm (40in)	copper red	summer	☼		Showy flowers, attracts butterflies
<i>Helianthus</i> 'Lemon Queen'	175cm (72in)	yellow	sum/fall	☼●		Tough, reliable plant, prolific flowers are long lasting
<i>Heliopsis helianthoides</i> 'Summer Nights'	100cm (40in)	gold	sum/fall	☼●		Stems purple red, foliage tinted red
<i>Helleborus orientalis</i> hybrids (Lenten rose)	60cm (24in)	white	e. spring	●		Shades of white or pink
<i>Hemerocallis</i> 'Black Stocking'	60cm (24in)	purple black	summer	☼		15cm (6in) bloom, ruffled, heavy blooming habit
<i>Hemerocallis</i> 'Blue Sheen'	20cm (8in)	lavender blue	summer	☼	yes	15cm (6in) bloom, extended bloom time
<i>Hemerocallis</i> 'Calgary Stampede'	55cm (22in)	red	summer	☼	yes	15cm (6in) bloom, very floriferous, late season bloomer
<i>Hemerocallis</i> 'Frans Hal'	70cm (28in)	yellow/orange	summer	☼	yes	10cm bloom, bicolour
<i>Hemerocallis</i> 'Happy Returns'	45cm (18in)	yellow	summer	☼	yes	7cm (3in) bloom, heavy blooming habit, re-blooms
<i>Hemerocallis</i> 'Jamaican Me Crazy'	90cm (36in)	cream violet	summer	☼	yes	12cm (5in) bloom, ripple edge, green throat
<i>Hemerocallis</i> 'Little Business'	35cm (13in)	red	summer	☼		9cm (3.5in) bloom, re-blooms

PERENNIALS

Plant Name	Height	Colour	Bloom	Expos.	Fragr.	Description
<i>Hemerocallis</i> 'Summer Wine'	60cm (24in)	wine red	summer	☼	yes	13cm (5in) bloom, re-blooms
<i>Hemerocallis</i> 'Tetrina's Daughter'	60cm (24in)	yellow	summer	☼	yes	15cm (6in) bloom, spider type flowers, very prolific
<i>Hemerocallis</i> 'Vanilla Fluff'	90cm (36in)	apricot	summer	☼	yes	15cm (6in) bloom, double blooms
<i>Heuchera</i> 'Blackberry Ice'	30cm (12in)	white	summer	☼☉		Intolerant of water logged conditions
<i>Heuchera</i> 'Crème Brule'	30cm (12in)	white	summer	☼☉		Intolerant of water logged conditions
<i>Heucherella</i> 'Solar Eclipse'	50cm (20in)	white	summer	☼☉		Red-brown foliage with lime green edge
<i>Hosta</i> hybrid 'Blue Wedgewood'	45cm (18in)	lavender	summer	☉●		Thick substance, container plantings
<i>Hosta</i> hybrid 'Brim Cup'	20cm (8in)	white	summer	☉●		Easy care, dramatic foliage
<i>Hosta</i> hybrid 'Carnival'	45cm (18in)	lavender	summer	☉●		Wavy cream edge, sport of 'Great Expectation'
<i>Hosta</i> hybrid 'Eskimo Pie'	60cm (24in)	white	summer	☉●		Chalky blue colour with white edge
<i>Hosta</i> hybrid 'Fire Island'	35cm (13in)	lavender	summer	☼☉		Chartreuse foliage with red stems
<i>Hosta</i> hybrid 'First Frost'	45cm (18in)	lavender	summer	☉●		Hosta of the Year 2010
<i>Hosta</i> hybrid 'Funny Mouse'	20cm (8in)	lavender	summer	☼☉		Dwarf, great for containers
<i>Hosta</i> hybrid 'Komodo Dragon'	75cm (30in)	lavender	summer	☼☉		Large blue quilted foliage
<i>Hosta</i> hybrid 'Lakeside Cupcake'	12cm (5in)	lavender	summer	☼☉		Dwarf, thick foliage
<i>Hosta</i> hybrid 'Lakeside Paisley Print'	25cm (10in)	lavender	summer	☼☉		Unique leaves with quilted foliage
<i>Hosta</i> hybrid 'Little Treasure'	20cm (8in)	lavender	summer	☼☉		Miniature, great for containers
<i>Hosta</i> hybrid 'Loyalist'	45cm (18in)	lavender	summer	☼☉		Sport of Patriot
<i>Hosta</i> hybrid 'Lucky Mouse'	20cm (8in)	lavender	summer	☼☉		Miniature, great for containers
<i>Hosta</i> hybrid 'Maui Buttercups'	45cm (18in)	white	summer	☼☉		One of the best sun tolerant
<i>Hosta</i> hybrid 'Mighty Mouse'	20cm (8in)	lavender	summer	☼☉		Dwarf, sport of H. 'Blue Mouse Ears'
<i>Hosta</i> hybrid 'Patriot'	60cm (24in)	lavender	summer	☼☉		Hosta of the Year 1997
<i>Hosta</i> hybrid 'Pizzazz'	50cm (20in)	white	summer	☼☉		Thick corrugated leaves
<i>Hosta</i> hybrid 'Praying Hands'	30cm (12in)	lavender	summer	☼☉		Hosta of the Year 2011, very upright habit
<i>Hosta</i> hybrid 'Rootin Tootin'	25cm (10in)	lavender	summer	☼☉		Cupped, quilted green leaves with cream centre
<i>Hosta</i> hybrid 'Snow Cap'	60cm (24in)	white	summer	☼☉		Large cupped green leaves with cream edge
<i>Hosta</i> hybrid 'Stained Glass'	40cm (16in)	lavender	summer	☼☉	yes	Hosta of the Year 2006, sun tolerant
<i>Hosta</i> hybrid 'Sun Power'	75cm (30in)	lavender	summer	☼☉		Sun tolerant, wavy edge
<i>Hosta</i> hybrid 'Valley's Glacier'	100cm (40in)	lavender	summer	☼☉		Blue heart shaped leaves with cream margin
<i>Hyssopus officinalis</i> ssp <i>aristatus</i>	30cm (12in)	bright blue	summer	☼		Aromatic leaves, compact, bushy form; bees and butterflies
<i>Impatiens omeiana</i>	40cm (16in)	yellow	summer	☉●		Good ground cover when grown in moist soil
<i>Iris chrysographes</i> Black form	45cm (18in)	black	May	☼☉		Stunning velvety-gold black flowers; fertile, moist soil
<i>Iris ensata</i> 'Queen's Tiara' (Japanese Iris)	80cm (32in)	white	summer	☼		Prefers moist soil, late blooming
<i>Iris foetidissima</i> 'Variegata'	60cm (24in)	purple	June	☼☉		Evergreen, grows well in shady areas
<i>Iris graminea</i> (plum tart iris)	25cm (10in)	violet	June	☼	yes	Charming small iris, grassy foliage, easy care

PERENNIALS

Plant Name	Height	Colour	Bloom	Expos.	Fragr.	Description
<i>Iris hollandica</i> 'Eye of the Tiger' (Dutch Iris)	60cm (24in)	purple/brown	June	☼		Good for bouquets
<i>Iris hollandica</i> 'Sapphire Beauty' (Dutch Iris)	60cm (24in)	blue	June	☼		Good for bouquets
<i>Iris louisiana</i> 'Jack Attack' (swamp iris)	90cm (36in)	pink	summer	☼●		Requires moist soil during growing months
<i>Iris pallida</i> 'Aureovariegata'	55cm (22in)	blue	June	☼		Creamy variegated foliage
<i>Iris pumila</i>	25cm (10in)	maroon	June	☼		Dwarf bearded iris
<i>Iris robusta</i> 'Gerald Darby'	80cm (32in)	violet blue	June	☼		Unique emerging purple foliage
<i>Iris siberica</i> 'Coronation Anthem'	75cm (30in)	blue	June	☼		Blooms profusely, re-blooms in Fall, large ruffled petals
<i>Iris sibirica</i> 'Teal Wood'	60cm (24in)	purple	June	☼		Easily grown in moist soil which does not dry in summer
<i>Kirengeshoma palmata</i>	90cm (36in)	soft yellow	Aug-Sept	●●		Clusters of butter-yellow bell shaped blooms in the fall
<i>Lathyrus vernus</i> (spring vetch)	25cm (10in)	blue-violet	spring	●		Non-climbing, clump-forming perennial sweet pea
<i>Lavendula angustifolia</i> 'Hidcote Blue'	45cm (18in)	purple	summer	☼	yes	Requires good drainage
<i>Leucanthemum x superbum</i> 'Real Dream'	40cm (16in)	yellow	summer	☼		Three layers of petals surrounded by a large centre
<i>Leucanthemum x superbum</i> 'Sunny Side Up'	50cm (20in)	white	summer	☼		Double-petal flowers with raised egg-yolk centres
<i>Ligularia</i> 'Britt-Marie Crawford''	100cm (40in)	gold	summer	☼●		Elegant solution for those boggy areas, long bloom time
<i>Ligularia przewalskii</i>	150cm(60in)	yellow	summer	☼●		Toothed foliage, best in moist soil
<i>Lilium</i> 'Beverly's Dream' (O/T Hyb)	90cm (36in)	red	summer	☼	yes	Outward facing trumpet flowers
<i>Lilium</i> 'Extravaganza' (oriental lily)	100cm (40in)	white	summer	☼●	yes	Pink freckles, huge blooms
<i>Lilium</i> 'Hiawatha' (tiger lily)	80cm (32in)	red	summer	☼	yes	Reflexed flowers, very hardy and long lived
<i>Lilium</i> 'Kiss Elodie'	110cm (44in)	pink	summer	☼●		Double blooms, pollen-free
<i>Lilium</i> 'Pink Flavour' (tiger lily)	80cm (32in)	pink	summer	☼	yes	Huge blooms, light pink with dark pink centre
<i>Lilium</i> 'Pink Perfection' (trumpet lily)	110cm (44in)	pink	summer	☼●	yes	Huge blooms
<i>Lilium</i> 'Purple Prince' (O/T Hyb)	90cm (36in)	purple	summer	☼	yes	Oriental x Trumpet hybrid
<i>Lilium</i> 'Roselily Annika' (double oriental)	90cm (36in)	white	summer	☼	yes	Upper facing, pollen free, double blooms
<i>Lilium</i> 'Salmon Star' (oriental lily)	110cm (44in)	soft orange	summer	☼●	yes	Pink freckles, huge blooms
<i>Lilium</i> 'Stargazer' (oriental lily)	100cm (40in)	pink	summer	☼●	yes	Pink with white edge
<i>Lilium</i> 'Sunny Bonaire' (oriental lily)	50cm (20in)	pink	summer	☼●	yes	Dwarf, compact growth, huge blooms
<i>Lilium</i> 'Tabledance' (O/T Hyb)	110cm (44in)	pink	summer	☼	yes	Award wing variety
<i>Lilium martagon</i> (Turk's cap lily)	70cm (28in)	pink	summer	☼●	yes	Reflexed flowers, attracts hummingbirds
<i>Lupinus</i> 'Woodfield Hybrids'	90cm (36in)	mixed	summer	☼		Deadhead to promote re-bloom
<i>Meconopsis betonicifolia</i> (Himalayan poppy)	60cm (24in)	blue	June-July	●		Requires woodland conditions, moist soil in summer
<i>Monarda</i> 'Jacob Kline' (bee balm)	90cm (36in)	red	summer	☼	yes	Mildew resistant, deep red
<i>Monarda</i> 'Prairie Night'	100cm (40in)	mauve	summer	☼●		Attracts butterflies and humming birds
<i>Nepeta racemosa</i> 'Walker's Low' (cat nip)	35cm (14in)	blue	summer	☼	yes	Rich blue flowers, good in rock gardens
<i>Nonea lutea</i>	30cm (12in)	yellow	e. spring	☼●		Biennial, gently reseeds; rough-textured hairy leaves
<i>Omphalodes verna</i>	10cm (4in)	blue	spring	●		Groundcover, woodland

PERENNIALS

Plant Name	Height	Colour	Bloom	Expos.	Fragr.	Description
<i>Ophiopogon japonicus</i> 'Gyoku Ryu' (mondo)	15cm (6in)	foliage		☼●●		Dwarf, tight, compact, mondo grass; dark green leaves
<i>Oxalis adenophylla</i> (silver shamrock)	10cm (4in)	pink	summer	☼●		Excellent ground cover, cold hardy
<i>Pachyphragma macrophyllum</i>	35cm (14in)	white	spring	☼●		Rounded, ruffled leaves form a weed-free ground cover
<i>Paeonia caucasica</i>	70cm (28in)	magenta	June-July	☼		Requires good drainage
<i>Paeonia Itoh</i> 'Julie Rose'	100cm (40in)	pink	June-July	☼	yes	Double form, unique
<i>Paeonia Itoh</i> 'Callie's Memory'	90cm (36in)	yellow	June-July	☼	yes	Herbaceous tree peony cross, 22cm (9in) blooms
<i>Paeonia Itoh</i> 'Cora Louise'	60cm (24in)	pink	June-July	☼	yes	Fragrant, can produce up to 50 blooms per season
<i>Paeonia lactiflora</i> 'Coral Sunset'	80cm (32in)	coral	June-July	☼	yes	Very unique bloom colour
<i>Paeonia lactiflora</i> 'Gold Mine'	70cm (28in)	yellow	June-July	☼	yes	Double, soft yellow
<i>Paeonia lactiflora</i> 'Green Halo'	70cm (28in)	green	June-July	☼	yes	Green outer petals, white inner petals
<i>Paeonia lactiflora</i> 'Immaculee'	80cm (32in)	white	June-July	☼	yes	Japanese type bloom
<i>Paeonia lactiflora</i> 'London'	50cm (20in)	pale pink	June-July	☼	yes	NEW, compact growth habit, good for container
<i>Paeonia lactiflora</i> 'Moon of Nippon'	90cm (36in)	white	June-July	☼	yes	Japanese type bloom
<i>Paeonia lactiflora</i> 'Rome'	50cm (20in)	dark pink	June-July	☼	yes	NEW, compact growth habit, good for container
<i>Paeonia lactiflora</i> 'Shirley Temple'	90cm (36in)	pale pink	June-July	☼	yes	Standout, prolific bloomer
<i>Paeonia potaninii</i> var <i>trolliodes</i>	100cm (40in)	apricot	June-July	☼	yes	Bushy tree peony; deep 'humusy' soil
<i>Paeonia tenuifolia</i> 'Itoba'	25cm (10in)	red	June-July	☼		Fern-leaf peony, deer resistant
<i>Paris quadrifolia</i>	25cm (10in)	green	June-July	●●		Attractive woodland plant with trillium-like foliage
<i>Persicaria affinis</i> 'Dimity'	18cm (7in)	pink shades	summer	☼●		Red spikes changing to pink, great ground cover
<i>Phlomis cashmeriana</i>	75cm (30in)	lilac-pink	summer	☼●		Flowers in whorls on woolly stems; felt-like green leaves
<i>Phlox paniculata</i> 'Sherbert Blend'	90cm (36in)	green pink	summer	☼	yes	Green edge with pink eye bloom
<i>Platycondon grandiflora</i> 'Sentimental Blue'	18cm (7in)	blue	summer	☼●		Bloom grow like a balloon then pops open
<i>Podophyllum pleanthum</i> (Chinese mayapple)	50cm (20in)	maroon-red	April-May	●●		Large, glossy leaves usually remain attractive all summer
<i>Polemonium caeruleum</i> 'Brise d'Anjou'	50cm (20in)	blue	summer	☼●		Variegated foliage
<i>Polygonatum odoratum</i> 'Variegatum'	60cm (24in)	white	June-Sep	●●	yes	Green leaves, edged white
<i>Polygonatum verticillatum</i>	150cm (60in)	white	June-Sep	☼●		Narrow leaves, architectural
<i>Polygonatum</i> x <i>hybridum</i> 'Striatum'	60cm (24in)	white	June-Sep	☼●		Variegated foliage
<i>Primulaenticulate</i> (drumstick primula)	30cm (12in)	violet	spring	☼●		Drumstick flower shape
<i>Primula vialii</i> (red hot poker primula)	30cm (12in)	red	spring	☼●		Emerges late, spike shaped flower
<i>Pulmonaria</i> 'Sissinghurst White'	25cm (10in)	white	spring	☼●		Evergreen, silver spotted leaves
<i>Pulsatilla vulgaris</i>	20cm (8in)	mauve	spring	☼●		Silvery fine-cut leaves; attractive silver seed heads
<i>Rhodiola rosea</i> (goldenroot)	10cm (4in)	yellow	summer	☼		Flowers are sometimes tipped with red
<i>Rodgersia aesculifolia</i>	75cm (30in)	pale pink	summer	●●		Imposing plant with bold-textured, chestnut-shaped leaves
<i>Rodgersia pinnata</i> 'Chocolate Wings'	75cm (30in)	pink	summer	☼●		Prefers damp woodlands and by streams
<i>Roscoea purpurea</i>	35cm (14in)	purple	summer	☼●		Hooded orchid-like flowers

PERENNIALS

Plant Name	Height	Colour	Bloom	Expos.	Fragr.	Description
<i>Rudbeckia fulgida</i> 'Goldsturm'	80cm (32in)	yellow	summer	☼		Easily adaptable coneflower
<i>Sanguinaria canadensis</i> 'Flore Plena'	25cm (10in)	white	spring	☼○		North American woodland wildflower
<i>Saxifraga x arendsii</i> 'Merlot'	15cm (6in)	red	spring	☼○		Fernlike foliage grows low to ground in an evergreen mat
<i>Saxifraga x arendsii</i> 'Pink'	15cm (6in)	pink	spring	☼○		Fernlike foliage grows low to ground in an evergreen mat
<i>Saxifraga x geum</i>	20cm (8in)	white	summer	☼		Evergreen, spoon-shaped leaves with scalloped edges
<i>Saxifraga x urbium</i> 'Variegata' (London pride)	10cm (4in)	white/pink	April-June	☼○●		Easily grown in moist soil, divide rosettes in spring
<i>Scilla peruviana</i> (Portugese squill)	15cm (6in)	blue	late spring	☼○		Unique flowers, dormant in summer
<i>Scutellaria altissima</i> (skull cap)	60cm (24in)	blue	summer	☼		Snapdragon-like flowers
<i>Sedum</i> 'Frosty Morn'	60cm (24in)	pink	l. summer	☼○		Clump forming, attracts butterflies. Rabbit resistant
<i>Sedum</i> 'Mr. Goodbud'	35cm (14in)	pink	summer	☼○		Very strong stems, remains upright
<i>Sedum</i> 'Ruby Glow'	10cm (4in)	rosy-red	l. summer	☼○		Low-growing, fleshy blue-green leaves
<i>Sedum cyaneum</i>	10cm (4in)	rose	summer	☼		Excellent groundcover for hot dry sites with poor soil
<i>Sedum rupestre</i> 'Angelina'	10cm (4in)	yellow	summer	☼		Chartreuse foliage, great in containers
<i>Sedum spurium</i> 'Dragon's Blood'	35cm (14in)	pink	summer	☼		Excellent ground cover for hot, dry sites
<i>Sisyrinchium palmifolium</i>	40cm (16in)	yellow	summer	☼		Long-blooming; needs good drainage
<i>Syneilesis aconitifolia</i> (shredded umbrella plant)	45cm (18in)	foliage	insig.	☼○		White woolly leaves push through the ground early spring
<i>Thalictrum</i> 'Elin' (meadow rue)	180cm (72in)	lavender	summer	☼○		Tallest meadow rue, but seldom needs staking
<i>Thalictrum delavayi</i> 'Hewitt's Double'	150cm (60in)	pink	summer	☼○		Sprays of double flowers
<i>Thalictrum rochebrunianum</i>	180cm (72in)	lavender	summer	☼○		Deep wine-purple stems topped with lavender flowers
<i>Tradescantia</i> 'Concord Grape' (spiderwort)	45cm (18in)	purple	summer	☼○		Continuous blooms, grey foliage
<i>Tradescantia andersonia</i> 'Blue and Gold'	45cm (18in)	blue	summer	☼○		Chartreuse grassy leaves, rich gentian-blue flowers
<i>Tricyrtis hirta</i> (toad lily)	75cm (30in)	white	fall	☼○●		Unique spotted shade-lover that flowers in the fall
<i>Tulipa humilis alba</i>	10cm (4in)	white	spring	☼○		Cold hardy
<i>Uvularia sessilifolia</i>	45cm (18in)	yellow	spring	☼○		Dainty tubular flowers, woodland
<i>Vancouveria hexandra</i>	40cm (16in)	white	summer	○●		Woodland ground cover
<i>Veronica peduncularis</i> 'Georgia Blue'	20cm (8in)	blue	summer	☼		Ground cover, blooms summer till fall
<i>Veronica whitleyi</i>	25cm (10in)	blue	summer	☼		Ground cover, blooms summer till fall
<i>Viola</i> 'Freckles'	10cm (4in)	blue	spring	☼○		Ground cover, freckled petals
<i>Viola adunca</i>	15cm (6in)	violet	spring	○		Woodland, moist dappled shade

The following symbols are used: Sun=☼ Part shade=○ Shade=●

RHODODENDRONS AND AZALEAS

Over 175 varieties of rhododendrons and azaleas (deciduous and evergreen) are available. Also available are species rhododendrons grown in VanDusen Gardens. Rhododendrons and Azaleas—Bloom times are approximate and will vary with location and season.

Plant Name	Height	Colour	Bloom	Information
<i>Rhododendron</i> ‘Anah Kruschke’	2m (6ft)	pale, lavender-blue to reddish-purple with purple-red spots	May 15-June 15	Attractive plant has compact habit, grows well in full sun. Dense and lush foliage with dark green leaves
<i>R. augustinii</i>	2m (6ft)	violet-blue	Apr 15-May 15	Long, narrow, smooth, dark-green leaves
<i>R. augustinii</i> ‘Hobbie’	90cm-1.2m (3-4 ft.)	light blue	Apr-May	Outstanding as a landscape accent
<i>R.</i> ‘Biskra’	1.5m (5ft)	rich vermilion bell-shaped flowers	May 1-Jun 1	Leaves are medium-sized on this upright grower which is hardy
<i>R.</i> ‘Black Sport’	1.5m (5ft)	purple-red with a deep black-red blotch on the upper lobe	June 1-Jun 15	The foliage is deep green and is quite upright, often showing the underside of the leaves. Unusual and different
<i>R.</i> ‘Blue Boy’	1.5m (5ft)	vibrant violet blooms with wavy edges and an almost black blotch	May 1-Jun 15	Heavy blooming, upright and open-growing well-shaped plant
<i>R.</i> ‘Blue Jay’	1.5m (5ft)	lavender-blue with brown dorsal blotch	May 1-Jun 15	Vigorous plant covered by bright green foliage
<i>R.</i> ‘Brocade’	90cm (3ft)	peachy-pink bells	May 1-Jun 1	The plant is open in habit, but attractive and rounded
<i>R.</i> ‘Blutopia’	1.5m (5ft)	vibrant purple with many greenish-yellow spots on dorsal lobes	June 1-Jun 15	Wavy flowers
<i>R.</i> ‘Calsap’	1.2m (4ft)	white with striking burgundy blotch	May 1-June 15	Hardy plant grows well in light shade. More wide than tall
<i>R. campylogynum</i>	60cm(2.5ft)	waxy pink flowers	Apr-May	An aromatic shrub with small leaves
<i>R. campylogynum</i> dwarf	60cm (2ft)	little waxy bell-shaped flowers of dusty rose	Apr-May	Very sweet dwarf with small, extremely aromatic leaves
<i>R. camtschaticum</i>	1.5m (5ft)	cerise-pink single star flowers	Mar 15-Apr 15	Deciduous
<i>R.</i> ‘Canadian Sunset’ (<i>yakushmanum</i> hybrid)	90cm (3ft)	deep pink fading to pale yellowish-pink	May 1-Jun 1	Compact, rounded bush with indumented leaves
<i>R.</i> ‘Capistrano’	1.2m (4ft)	chartreuse yellow	May 1-June 1	One of the best hardy yellow rhododendrons
<i>R.</i> ‘Catawbiense Album’	2m (6ft)	pure white with greenish-yellow spotting	May 1-Jun 15	A plant of extreme hardiness and vigor
<i>R.</i> ‘Checkmate’	2m (6ft)	masses of small, lavender-pink flowers	Mar 15-Apr 15	Dwarf plant that has beautiful dark, mahogany winter foliage
<i>R.</i> ‘Cilpinense’	90cm (3ft)	blush pink opening to white bell flowers	Mar 15-Apr 15	Leaves are small to medium sized and are deep forest green
<i>R.</i> ‘Cosmopolitan’	1.5m (5ft)	pink with deep red blotch	May 1-Jun 15	Hardy plant with glossy and attractive foliage
<i>R.</i> ‘Cream Crest’	90cm (3ft)	bright creamy-yellow	Apr 15-May 1	Compact in habit, likes the sun, has good foliage, is hardy and vigorous
<i>R.</i> ‘Crete’ (<i>yakushmanum</i> hybrid)	1.2m (4ft)	magenta-rose buds open to very light purple flowers with a few light spots	May 1-June 1	Has soft beige indumentum
<i>R.</i> ‘Cunningham’s White’	1.2m (4ft)	buds flush pink-mauve, fading to white, broad pale yellow-green-brown markings	May 1-June 15	Attractive, spreading, compact, well branched, will tolerate sunny position but prefers shade, sometimes blooms in autumn
<i>R.</i> ‘Dreamland’ (<i>yakushmanum</i> hybrid)	1.2m (4ft)	pale pink flowers bordered with deeper pink edges	May 1-June 1	Prolific bloomer; low and compact grower with attractive foliage

RHODODENDRONS AND AZALEAS

Plant Name	Height	Colour	Bloom	Information
<i>R.</i> 'English Roseum'	2m (6ft)	soft rosy-lavender	May 1-June 15	Vigorous and is tolerant of extremes in cold, heat and humidity
<i>R.</i> 'Elizabeth Ostbo Red'	90cm (3ft)	scarlet-red flowers	April & Sept	Red foliage when new, fading to deep green
<i>R.</i> 'Evening Glow'	1.5 m (5ft)	deep yellow	June 1-June 15	Compact growth habit supports narrow, shamrock green leaves which are bright and attractive all year
<i>R.</i> 'Ginny Gee'	60cm (2ft)	pink, dappled white both inside and out	Apr 15-May 1	Dwarf with very small leaves
<i>R.</i> 'Golden Gate'	90cm (3ft)	mixed pink-orange	May 1-Jun 1	Interesting and easy to grow with compact habit
<i>R.</i> 'Golden Torch'	1.2m (4ft)	warm pink buds open to a delightful soft yellow flower	May 1-Jun 15	Deep green foliage with a light kiss of brown indumentum on the underside
<i>R.</i> 'Golden Wedding' (<i>yakushmanum</i> hybrid)	90cm (3ft)	dark red buds open yellow	May 1-Jun 1	Plant is as broad as tall and has dark green foliage
<i>R.</i> 'Goldflimmer'	1.5m (5ft)	mauve, ruffled flowers	June 1-June 15	Neat compact plant with variegated foliage of emerald green, with touches of primrose yellow
<i>R.</i> 'Goldsworth Orange'	1.5m (5ft)	tropical orange	June 1-June 15	Late blooming plant is shapely and heat tolerant
<i>R.</i> 'Gomer Water'	2m (6ft)	delicate pink buds open white and retain hint of pink until mature	May 1-Jun 15	Old standby is one of the best whites ever hybridized; large deep green leaves are sun tolerant
<i>R.</i> 'Grumpy' (<i>yakushmanum</i> hybrid)	90cm (3ft)	cream flowers tinged with pink	May 1-June 1	Dark green foliage and indumentum on lower surface
<i>R.</i> 'Hachman's Marlis' (<i>yakushmanum</i> hybrid)	90cm (3ft)	rose-pink flowers with a pale centre	May 1-June 1	Compact plant with beautiful silvery foliage
<i>R.</i> 'Hachman's Polaris' (<i>yakushmanum</i> hybrid)	90cm (3ft) 1.2m (4ft)	ruffled, ruby-pink flowers with soft pink centres that bloom profusely in spring	Apr-May	Flowers heavily at young age; forms a low compact mound with dense, elliptic, very hairy foliage; wind and sun tolerant
<i>R.</i> 'Hansel'	90cm (3ft)	salmon-orange flowers	May 1-June 1	Very good foliage with buff-coloured indumentum under leaves
<i>R.</i> 'Hello Dolly'	90cm (3ft)	yellow flowers are brightened with warm tones of orange and rose	Apr 15-May 1	Well-branched rounded plant with medium green leaves and light beige indumentum on the undersides
<i>R.</i> 'Holy Moses'	1.2m (4ft)	sensational orange and yellow bicolor	May 15-June 15	Foliage and plant are exceptional
<i>R.</i> 'Honey Butter'	1.2m (4ft)	luscious tones of yellow with apricot edging	April	Beautiful plant with dome-shaped trusses
<i>R.</i> 'Hoppy' (<i>yakushmanum</i> hybrid)	90cm (3ft)	white-pink with yellow spots	May 1-June 1	Tight growing dense shrub
<i>R.</i> 'Hotei'	90cm (3ft)	terrific canary-yellow, darker yellow throat	May 1-June 1	Good, compact mound, multi-branched, very dense grower
<i>R.</i> 'Ilam Violet'	1.2m (4ft)	deep violet-blue	May 1-June 1	Bronze winter foliage. Needs good drainage
<i>R. impeditum</i>	30cm (1ft)	purple	Apr 15-May 1	Dwarf with attractive silver-grey foliage
<i>R.</i> 'Janet Blair'	2m (6ft)	frilled light-pink with distinctive green flare on upper petal	May 1-June 1	Vigorous, good looking plant
<i>R.</i> 'Jean Marie de Montague'	1.5m (5ft)	bright red flowers	May 1-June 1	Thick, heavy foliage is sun tolerant, and the deep emerald-green unmatched by many plants. Buds young
<i>R.</i> 'Kalinka' (<i>yakushmanum</i> hybrid)	90cm (3ft)	medium rose, pale pink at centre, with darker rims and marked with moderate yellow-green	May 1-June 15	Glossy foliage with brown indumentum on a dense. Mounding plant provides a background for bright red buds
<i>R. kelecticum</i>	30cm (1ft)	rose-purple flowers	Apr-May	Good for bonsai. Tight compact, semi-prostrate dwarf species

RHODODENDRONS AND AZALEAS

Plant Name	Height	Colour	Bloom	Information
<i>R.</i> 'Ken Janeck' (<i>yakushmanum</i> hybrid)	90cm (3ft)	richly colored pink	May 1-June 1	Appealing, heavily indumented foliage
<i>R.</i> 'Kodiak' (<i>yakushmanum</i> hybrid)	1.2m (4ft)	silvery white bell trusses with some slight spotting in throat	May 1-June 1	Plant that has been described as "terrific, just plain gorgeous"
<i>R.</i> 'Lavender Queen'	1.5m (5ft)	slightly frilled flowers are light bluish-lavender touched with a dim brown blotch	Apr 15-May 1	Excellent growth habit
<i>R.</i> 'Lavendula'	90cm (3ft)	lavender	May 1-June 1	Upright compact plant
<i>R.</i> 'Lee's Best Purple'	2m (6ft)	deep purple	June 1-June 15	Excellent smooth, dark and glossy foliage
<i>R.</i> 'Lee's Dark Purple'	2m (6ft)	deep, dark purple	May 1-June 15	This is an old reliable hybrid, popular for many years. The foliage is handsome, dark and wavy
<i>R.</i> 'Lem's Monarch'	2m (6ft)	wavy edges, pale pink to white with pink margins and two narrow rays of red spots in upper lobe	May 1-Jun 1	Large attractive foliage
<i>R.</i> 'Marie Forte'	1.2m (4ft)	huge trusses of lustrous purple-red blooms with a dark eye	May 1-Jun 15	Rich dark green foliage in an open, spreading habit
<i>R.</i> 'Medusa'	90cm (3ft)	beautiful shade of orange, cascading flowers are borne on long pedicels	May 1-June 1	Leaves are mid-sized and greyish-green, with a very light woolly indumentum on the undersides
<i>R.</i> 'Midsummer'	1.5m (5ft)	rosy pink with golden flare	Jun 15-Jul 15	Deep green foliage
<i>R.</i> 'Minnetonka'	1.2m (4ft)	red-purple with grn-yellow spots on upper petal	May 1-June 1	Compact. Grows a bit wider than tall. Hardy
<i>R.</i> 'Odee Wright'	1.2m (4ft)	deep clear yellow	May 1-Jun 1	Compact grower with waxy green leaves
<i>R.</i> 'Old Copper'	1.5m (5ft)	large copper-orange trusses	June 1-June 15	Attractive and perky foliage
<i>R.</i> 'Olin O. Dobbs'	1.2m (4ft)	very deep, waxy red-purple	May 1-Jun 15	The trusses are large, compact and a perfect conical shape
<i>R.</i> 'Paprika Spiced'	1.2m (4ft)	pale creamy-yellow surrounded by an explosion of paprika red spots	May 1-Jun 1	Showy plant when in flower
<i>R.</i> 'Patty Bee'	45cm(18in)	clear yellow	Apr 15-May 1	Dwarf variety that tolerates both heat and sun
<i>R.</i> 'Percy Wiseman' (<i>yakushmanum</i> hybrid)	90cm (3ft)	peach-yellow that gently fades to white	May 1-June 1	Compact with dark green foliage
<i>R.</i> 'President Roosevelt'	1.2m (4ft)	frilly trusses red, fading pink to white in centre	Apr 15-May 1	Green foliage, golden accents. Excellent plant all year round
<i>R.</i> 'Ramapo'	60cm (2ft)	tiny, inch-long flowers are lively, pink-violet	Apr 15-May 1	Hardy dwarf, grows well in sun or partial shade
<i>R.</i> 'Shamrock'	30cm (1ft)	chartreuse	Mar 15-Apr 15	Extremely compact and wider than high
<i>R.</i> 'Taurus'	2m (6ft)	glowing red with black speckling	Apr 15-May 1	Grows to be a magnificent shrub, vigorous and full in shape
<i>R.</i> 'Thor'	90cm (3ft)	bright, scarlet-red flowers have a large calyx	May 1-June 1	Good compact habit and thick indumentum on leaf underside
<i>R.</i> 'Trilby'	1.5m (5ft)	deep crimson, black markings	May 1-June 15	Matte green leaves set off by red stems, sun tolerant
<i>R.</i> 'Virginia Richards'	1.2m (4ft)	pink with gold and yellow tones	May 1-June 1	Plant has a compact habit with dark, glossy leaves
<i>R.</i> 'Whitney's Orange'	90cm (3ft)	orange	May 15-June 15	Low growth habit, has moss green rolling and curling leaves
<i>R.</i> 'Yaku Angel' (<i>yakushmanum</i> hybrid)	60cm (2ft)	light pink in bud, and open to white	May 15-June 1	A beautiful shrub in the garden at any season
<i>R.</i> 'Yaku Princess' (<i>yakushmanum</i> hybrid)	90cm (3ft)	apple-blossom pink	May 15-June 15	Medium size foliage

VANDUSEN SEEDS

CONTAINER PLANTS: This year we are featuring seeds of perennials and small shrubs suitable for planting in containers.

All seeds are collected from VanDusen Botanical Garden. Many seeds on sale are unusual and rarely available.

Plant Name	Description
For sunny locations:	
<i>Agapanthus</i> species	The lily of the Nile bears umbels of bright blue flowers in summer in this South African plant
<i>Aquilegia alpina</i>	The alpine columbine has finely-divided green leaves and bears nodding blue flowers with curving spurs in late spring
<i>Echinacea purpurea</i> ‘Alba’	The white coneflower has large daisy-like flowers with conical, orange-brown disks and white florets
<i>Festuca idahoensis</i>	This drought-tolerant bunchgrass has short, rolling blue leaves and bears buff-coloured ‘spikelets’ above the leaves in summer
<i>Helleborus argutifolius</i>	The Corsican hellebore has handsome toothed leaves and bears pale green flowers in late winter to early spring
<i>Knautia macedonica</i>	The Macedonian scabious bears dark red blooms from summer to fall and blends well with silver-leaved plants
<i>Papaver atlanticum</i>	This cheerful Atlas poppy bears cup-shaped soft orange flowers above green leaves in summer
<i>Pulsatilla vulgaris</i>	The pasque flower has feathery leaves and purple bell-shaped flowers in spring, followed by silvery seed-heads
<i>Salvia patens</i>	Gentian sage produces one of the purest blue flowers in mid to late summer

For shady sites:

<i>Beesia deltophylla</i>	Small starry white flowers float on wiry stems above glossy green heart-shaped leaves on maroon petioles
<i>Gaultheria hookeri</i>	This evergreen shrub bears sprays of white spring flowers followed by blue-purple berries
<i>Mahonia nervosa</i>	Bright yellow flowers followed by blue berries on this native BC evergreen shrub with glossy green pinnate leaves
<i>Milium effusum</i> ‘Aureum’	Golden millet grass has flat, strap-shaped leaves of rich golden yellow and bears tiny golden ‘spikelets’ in summer
<i>Myosotis sylvatica</i>	This is the Forget-Me-Not of old-fashioned gardens
<i>Polemonium caeruleum</i>	Jacob’s Ladder bears open bell-shaped lavender-blue flowers on erect, branched stems in summer
<i>Polystichum neolobatum</i>	The evergreen shield fern has glossy green, leathery fronds that are held upright in a vase shape
<i>Primula elatior</i>	The oxlip or primrose bears tubular, soft yellow flowers on stiff stems in early spring
<i>Tellima grandiflora</i>	Fringe Cups produce rosettes of scalloped basal leaves with erect stems bearing small white flowers that fade to pink

Native BC plants:

<i>Cornus canadensis</i>	Bunchberry has dogwood-like green flowers surrounded by white bracts, followed by bright red round fruit
<i>Corydalis scouleri</i>	Racemes of deep pink flowers on tall stems appear in late spring
<i>Dicentra formosa</i>	Pacific Bleeding Heart bears heart-shaped pink flowers above blue-green leaves in late spring
<i>Prosartes smithii</i>	Fairy bells bear pendent tubular white flowers in early spring, followed by orange berries
<i>Ribes sanguineum</i>	Flowering currant is an upright deciduous shrub that bears pendent, pinkish-red flowers in spring, followed by blue-black fruit
<i>Vaccinium ovatum</i>	Evergreen huckleberry bears pink urn-shaped flowers above glossy green leaves followed by small edible black berries

The Seed Collectors offer many more seeds of trees, shrubs, annuals, and perennials at the plant sale and online at www.vandusenseeds.org

SUCCULENTS AND CACTI

Plant Name	Height	Colour	Information
<i>Aeonium arboreum</i> 'Magnificum'	to 1m (3ft)	foliage	An impressive succulent with large spoon shaped pale green leaves
<i>Aeonium arboreum</i> 'Zwartkop' (black rose)	to 1m (3ft)	yellow	Long, bare stems hold large terminal rosettes of very dark, purple-black leaves
<i>Aeonium ciliatum</i>	to 1.5m (5ft)	foliage	Dr. Seuss like. Rare, true species forms a tall trunk topped by a foliar rosette
<i>Aeonium</i> 'Cyclops'	to 1m (3ft)	foliage	Beautiful tall succulent, with rosettes of dark reddish-bronze leaves on tall stems
<i>Aeonium haworthii</i> 'Kiwi'	30cm (12in)	foliage	Adds colour and texture with foliage of chartreuse, cream and red
<i>Aeonium</i> 'Sunburst' (copper pinwheel)	to 30cm (12in)	foliage	Large rosettes of variegated green and white leaves, edged in bright, coppery red
<i>Aeonium tabuliforme</i> (flat-topped aeonium)	10cm (4in)	foliage	Fleshy, hairy, bright-green leaves in flat rosettes, on short unbranched stems
<i>Aeonium undulatum</i> (saucer plant)	25cms (10in)	yellow	Terminal rosettes of fleshy, tongue-shaped, glossy leaves, tinged with red
<i>Agave americana</i>	to 1.5m (5ft)	yellow	Handsome rosettes of spiny-edged, grey-green leaves. Misnamed 'century plant'
<i>Agave americana</i> 'Marginata'	to 1.5m (5ft)	foliage	One of the prettiest and most sought after variegated succulents. A living sculpture
<i>Aloe barbadensis</i> (<i>Aloe vera</i>)	45cm (18in)	orange/yellow	A succulent plant species found only in cultivation. Medicinal, cosmetic use
<i>Aloe brevifolia</i> (short-leaved aloe)	45cm (18in)	orange/red	Compact, blue-green aloe
<i>Aloe striata</i> (coral aloe)	40cm (16in)	coral	'Striata' refers to long lines on its blue-green leaves, and smooth pink margins
<i>Crassula capitella</i> 'Campfire' (campfire crassula)	15cm (6in)	foliage	Fleshy propeller-like leaves mature from light green to bright red. Fiery highlights
<i>Crassula capitella</i> ssp. <i>thyrsiflora</i> 'Pagoda Village'	25 cm 'chains'	white	Pink tinged rosettes at first, later become pagoda-shaped and turn red
<i>Crassula falcata</i> (airplane plant, propeller plant)	to 60cm (24in)	scarlet	Gray-green foliage with striking texture. Tiny dense clusters of flowers in summer
<i>Crassula ovata</i> (jade tree)	15cm (6in)	white	(syn. <i>C. argentea</i>). Slow growing
<i>Crassula ovata</i> 'Coral'	to 1m (3ft)	white/pink	Unusual deep-green, tubular leaves edged in red. Great bonsai specimen
<i>Crassula perforata</i> (necklace vine)	sprawling	pale yellow	Relatively fast-growing 'stacked' Crassula. Margins often have reddish tinges
<i>Crassula pyramidalis</i> (princess pine)	10cm (4in)	foliage	Named for the tiny scale-like leaves that resemble those of the true club mosses
<i>Echeveria</i> 'Afterglow'		orange/red	Forms wide rosettes of large powdery-pink-lavender leaves edged in bright pink
<i>Echeveria</i> 'Black Knight'	to 15cm (6 in)	red	A dramatic cultivar with very dark-chocolate pointed leaves
<i>Echeveria</i> 'Black Prince'	to 15cm (6 in)	foliage	Slow, low growing succulent, with reddish-brown leaves in triangular shapes
<i>Echeveria</i> 'Domingo' (Domingo hen and chicks)	10cm (4in)	orange	Solitary rosettes of bluish leaves. White waxy cover gives a beautiful blue colour
<i>Echeveria</i> 'Dondo'	7cm (3in)	yellow-orange	Clumping succulent with pointed rosettes pale green leaves, tipped with pink
<i>Echeveria lilacina</i>	7cm (3in)	coral pink	Pale whitish-pink, silver-grey leaves. Slow growing. Flowers on reddish stems
<i>Echeveria minima</i>	7cm (3in)	foliage	Plump silver-grey leaves forming miniature rosettes. Leaves are tipped crimson
<i>Echeveria</i> 'Perle von Nurnberg'		foliage	Deep pink rounded leaves. A stunning cultivar with rosettes to 20cm across
<i>Echeveria prolifica</i>		yellow	Miniature rosettes to 3cm across, offsetting profusely. Silvery green leaves
<i>Echeveria secunda</i> (hen and chicks)		orange/pink	A fast growing, clump-forming succulent. Masses of flowers in summer
<i>Echeveria setosa</i> (Mexican firecracker)	7cm (3in)	yellow-red	Leaves are edged in fine white hairs. Off-sets form large clumps
<i>Echeveria</i> 'Topsy Turvy'	20cm across	orange	Almost tubular, distorted silver-grey, curly leaves covered in a fine white powder
<i>Echeveria</i> 'Violet Queen'	20cm across	foliage	Exquisitely shaped rosettes of silver leaves, curl up slightly to form lotus shape
<i>Fenestraria rhopalophylla</i> (baby toes)	7cm (3in)	white/yellow	Small club-shaped leaves with fenestrate ends form large clumps by offsetting
<i>Gasteria</i> (oxtongue)	to 15cm (6 in)	pink, red, yel	Thick, fleshy, tongue-shaped leaves, often with white, wart-like protuberances
<i>Graptopetalum amethystinum</i> (lavender pebbles)	under 15 cms	magenta-white	Rare species from Mexico that looks more like moon rocks than a plant
<i>Graptopetalum superbum</i> (beautiful graptopetalum)	under 15 cms	foliage	Fleshy, pale gray-lavender to pink-coloured leaves cluster at end of thick stems

SUCCULENTS AND CACTI

Plant Name	Height	Colour	Information
<i>Graptoveria</i> 'Alpenglow'	under 15 cms	foliage	Beautiful pink-mauve leaves in rosettes that become somewhat bushy
<i>Graptovaria</i> 'Debbie'		apricot	Lanceolate, frosty-pink leaves arranged in a rosette. Porous soil
<i>Graptoveria</i> 'Fred Ives'	30cm (12in)	white	Stiff pink to orange leaves form wide rosettes. Beautiful, mass planted in large pot
<i>Graptoveria</i> 'Opalina'	to 20cms (8in)	yellow-orange	Produces clusters of tight rosettes with a hint of mauve-purplish tones in sun
<i>Haworthia attenuata</i>	under 15 cms	white-green	Dark green, pointed leaves, strikingly banded or spotted
<i>Haworthia cooperi</i>	5cm (2in)	foliage	Pale green leaves with terminate bristle
<i>Haworthia cuspidata</i>	5cm (2in)	foliage	Charming plant with chunky lime green rosettes. Does well on a window sill
<i>Haworthia retusa</i>	under 10cms	white	Rosettes of very thick, triangular, translucent green leaves
<i>Kalanchoe daigremontiana</i> (thousand mother's plant)	under 50cms	greyish-pink	Upright succulent with triangular-lance-shaped, grey-green leaves, spotted brown
<i>Kalanchoe fedtschenkoi</i> 'Variegata'	30cms (12in)	foliage	Lavender gray-green leaves & cream coloured varieg. on scalloped leaf margins
<i>Kalanchoe tomentosa</i> (panda plant)	25cms (10in)	foliage	Grown for the interesting furry foliage
<i>Kalanchoe beharensis</i> 'Fang'	to 60cm (24in)	foliage	Leaves covered with dense white hairs, and undersides are highly textured
<i>Pachyphytum clavifolia</i> (syn. <i>Pachyveria clavifolia</i>)	under 15 cms	foliage	Grey-green leaves in somewhat untidy rosettes
<i>Pachyphytum compactum</i>	under 15 cms	foliage	Thick rounded, triangular leaves heavily veined with white, tipped with deep purple
<i>Pachyphytum oviferum</i> (moonstones)	under 15 cms	scarlet	Leaves are covered with a blue-white bloom
<i>Peperomia nivalis</i>	trailing	foliage	May be either rosette-forming or erect with trailing stems
<i>Portulacaria afra</i> (porkbush, elephant's food)	to 1.5m (5ft)	foliage	Similar in appearance to the jade plant, with smaller pads & more compact growth
<i>Sedeveria</i> 'Blue Mist'	trailing	golden/yellow	Cascading succulent with stems to 5cm. Good for hanging baskets
<i>Sedeveria</i> 'Harry Butterfield' (super burro tail)	trailing	foliage	Grows into long chains which tip over and hang like an animal's tail
<i>Sedeveria</i> 'Hummeli'	under 10 cms	yellow	Cross between <i>Sedum</i> and <i>Echeveria</i> . Attractive blue-green colouring with red tips
<i>Sedeveria</i> 'Jet Beads'	under 10 cms	yellow	Succulent green rosettes are tipped with dark purplish-black. Unusual hybrid
<i>Sedum clavatum</i>	under 15 cms	white	Frosty blue-green leaves tend to elongate to form creeping stems in time
<i>Sedum morganianum</i> (burro's tail)	trailing	foliage	Trailing plant with wiry stems covered with short thick silvery-lime-green leaves
<i>Sedum nussbaumerianum</i>	under 15 cms	white	Adds a brilliant coppery colour to your rock garden
<i>Sedum rubrotinctum</i> (blue jelly bean plant)	under 10 cms	yellow	Interesting succulent plant with jelly-bean-like leaves
<i>Sedum rubrotinctum</i> 'Aurora' (pink jelly beans)	under 15 cms	foliage	Leaves are pale green tinged pink, especially when grown in bright light
<i>Senecio rowleyanus</i> (string of pearls)	trailing	foliage	Plant 'string of pearls' succulent in a hanging basket for best effect
<i>Senecio serpens</i> (blue chalk sticks)	trailing	white	Trailing groundcover-type plant with succulent, blue-green, cylindrical foliage

POT LUCK

The Pot Luck section has many favourite, old-fashioned plants and some more unusual offerings. Plants have been collected from gardens of members and friends of VanDusen Botanical Garden Association, some come from VanDusen Garden, and some are donated by local nurseries. We are not always sure of the colour or exact botanical identity – hence the name Pot Luck. You will find a great selection of perennials, trees and shrubs. We have plants for all seasons – astilbes, geraniums, hostas, irises, grasses, ferns, hellebores, hemerocallis, rodgersia, peonies, primulas and sedums, to name a few. For your deck or patio we have baskets of perennials selected for specific areas (shade or sun), and pots of succulents for that sunny spot.

The Pot Luck group pots up donations throughout the year. If you would like to donate some of your plants for next year's sale, please call Jean McComb at 604.261.4556, or Margie Knox at 604.261.1868.

TREES AND SHRUBS

Plant Name	D/EG	Height	Colour	Bloom	Expos.	Frag	Z	Information
<i>Acer campbellii</i>	D	6m (18ft)	pink	spring	☼○		6	Huge thick olive green palmate leaves, vivid fall colour
<i>Acer cissifolium</i> (ivy-leaved maple)	D	4-6m (20-24ft)		spring	☼○		4	Trifoliolate ivy-like leaves, rounded form, vivid fall col
<i>Acer davidii</i> (David snake bark maple)	D	10m (30ft)		spring	☼○		5	White streaks on jade green bark. Simple leaf, fall col
<i>Acer griseum</i> (paperbark maple)	D	6m (18ft)		spring	☼○		5	Peeling crimson bark, vivid fall colour
<i>Acer japonicum</i> 'Aconitifolium'	D	5m (15ft)	scarlet	fall col	☼○		5	Upright, multi branch, deeply dissected leaf
<i>Acer palmatum</i> 'Aratama' *	D	1-2m (3-6ft)	yell/oran	fall col	☼○		5	Dwarf, bright red to light purple-red foliage, green ribs
<i>Acer palmatum</i> 'Chishio' *	D	2.5 m (8ft)	orange/red	fall col	☼○		5	Pink in spring, elegant branching habit
<i>Acer palmatum</i> 'Emperor 1' (red leaf maple)	D	5m (15ft)	dark crim	fall col	☼○		5	Compact, classic, upright red
<i>Acer palmatum</i> 'Ki Hachijo'	D	4-6m (20-24ft)	gold/rose	fall col	☼○		5	Well rounded, short tree, bright green palmate leaf
<i>Acer palmatum</i> 'Koto-no-ito' (dwarf Japan. maple)	D	2m (6ft)	yellow	fall col	☼○		5	Green linear leaf form, yellow fall colour
<i>Acer palmatum</i> 'Mikawa Yatsubusa'	D	1m (3ft)	golden	fall col	☼○		5	Dwarf, bonsai, leaf nodes very close together, dense
<i>Acer palmatum</i> 'Okagami' *	D	4-6m (20-24ft)	scarlet	fall col	☼○		5	Upright, spring purplish-red then shiny black-red leaf
<i>Acer palmatum</i> 'Orange Dream' *	D	2-4 m (6-14ft)	gold	fall col	☼○		5	Upright green form, spring foliage fresh orange/lemon
<i>Acer palmatum</i> 'Pixie' *	D	1-2m (3-6ft)	scarlet	fall col	☼○		5	Round form, red, spring foliage, then bright pinkish-red
<i>Acer palmatum</i> 'Red Pygmy'	D	1.5-2m (4-7ft)	yell/gold	fall col	☼○		5	Upright, rounded form, linear red leaf
<i>Acer palmatum</i> 'Red Spider'	D	3-6m (10-24ft)	blood red	fall col	☼○		5	Upright, branch tips curve down, linear red leaf
<i>Acer palmatum</i> 'Samurai' * (syn 'Aka shigitatsu sawa')	D	3-4m(10-18ft)	red	fall col	☼○		5	Upright, bushy, variegated green veins pink edges
<i>Acer palmatum</i> 'Shaina' *	D	2-4 m (6-14ft)	crimson	fall col	☼○		5	Compact upright, leaves cluster at tips of branches
<i>Acer palmatum</i> 'Shishigashira' * (lion's head maple)	D	2.5m (8ft)	burg/gold	fall col	☼○		5	Compact, stubby growth, looks like a lion's mane
<i>Acer palmatum</i> 'Tsukushigata'	D	4-6m (18-24ft)	fiery red	fall col	☼○		5	Black/purple foliage, green veins, wide grower
<i>Acer palmatum</i> 'Ukigumo' *	D	2-4 m (6-14ft)			☼○		5	Variegated, floating clouds, outstanding form
<i>Acer palmatum</i> 'Villa Taranto' *	D	2-4m (6-9ft)	gold/oran	fall col	☼		5	Green domed form, linear green/purple leaf, golden/orange fall colour
<i>Acer palmatum dissectum</i> 'Crimson Queen' *	D	2-4m (6-9ft)	scarlet	fall col	☼○		5	Mound, red leaf, ages into cascading form, holds red
<i>Acer palmatum dissectum</i> 'Garnet' *	D	4-5m(12-15ft)	red	fall col	☼		5	Cascading mounding habit, rich red leaf, red in sun
<i>Acer palmatum dissectum</i> 'Inaba Shidare'	D	4m (12ft)	purple/red	fall col	☼○		5	More upright growing, outstanding dissectum, red
<i>Acer palmatum dissectum</i> 'Seiryu' (lace leaf) *	D	4m (12ft)	gold	fall col	☼		5	Unusual, fine green foliage. Orange fall colour
<i>Acer palmatum dissectum</i> 'Tamuke Yama'	D	2-4m (6-9ft)	scarlet	fall col	☼○		5	Mound, cascading, new growth deep crimson, changing to dark purple
<i>Acer palmatum dissectum</i> 'Viridis'	D	2.5 m (8ft)	gold/crim	fall col	☼○		5	Green cascading, delicate lace leaf
<i>Acer palmatum dissectum</i> 'Water Fall' *	D	2-4m (6-9ft)	gold/crim	fall col	☼○		5	Strong cascading, takes full sun well, leaves flowing
<i>Acer rufinerve</i> (snake bark maple)	D	9m (40ft)			☼○		5	White streaks on bark, shallow trilobe leaf
<i>Acer shirasawanum</i> 'Aureum' *	D	4-8m (12-35ft)	gold/red	fall col	☼○		5	Golden full-moon maple, slow grower, best yellow
<i>Acer shirasawanum</i> 'Autumn Moon' *	D	2-3m (6-9ft)	orange/re	fall col	☼		5	Burnt orange foliage, shaded leaves yellow/green, slow
<i>Acer tegmentosum</i>	D	5-6m (15-20ft)	butter	fall col	☼○		5	White snake bark striations, fresh green leaf
<i>Araucaria araucana</i> (monkey puzzle tree)	EG	27m (90ft)			☼		7	Slow grower, female, large cone 18" edible nut
<i>Aucuba japonica</i> 'Picturata'	EG	1-2m(3-6ft)	maroon	spring	○		7	Gold blotch in centre of leaf, great in full shade; female

TREES AND SHRUBS

Plant Name	D/EG	Height	Colour	Bloom	Expos.	Frag	Z	Information
<i>Berberis sieboldii</i>	D	1.2m (4ft)	yellow	spring	☼		4?	Almost thornless berberis, green leaf, red fall colour
<i>Berberis thunbergii</i> 'Rose Glow' (barberry)	D	2m (6ft)	yellow	spring	☼		4	Slow grower, new foliage, red, pink, white
<i>Brachyglottis</i> 'Sunshine' syn. <i>Senecio</i> *	EG	1m (3ft)	yellow	summer	☼		7?	White hairs on foliage; drought resist; daisy flower
<i>Buddleia davidii</i> 'Nano Blue' syn. 'Petite Indigo' 'Mongo', 'Dwarf Blue'	D	2m (5-6ft)	lavender/ mauve	summer	☼●	yes	5	Grey-green foliage, compact, long, cone-shaped flower clusters; attracts butterflies; likes dry conditions
<i>Callistemon citrinus</i> * (crimson bottle brush)	EG	1-2m(3-5ft)	red	spring	☼		8	Borderline hardy; hummingbirds, lemon scented leaf
<i>Callistemon pallidus</i> * (lemon bottlebrush)	EG	1.25m (5ft)	yellow	spring	☼		8	Borderline hardy; attracts hummingbirds
<i>Calluna vulgaris</i> 'Arina' (Scottish heather)	EG	45cm (1.5ft)	mauve	sum-fall	☼		4	Mauve buds, orange tip on new growth
<i>Calluna vulgaris</i> 'Kinlochruel'	EG	18 cm (10 inc)	white	sum-fall	☼		4	Double white, lime green new growth, fades to bronze
<i>Calluna vulgaris</i> 'Reini'	EG	1.5m (18 inc)	white	sum-fall	☼		4	Compact, yellow tips on new growth,
<i>Calluna vulgaris</i> 'Silver Knight'	EG	1-1.15m(12-18)	lavender	sum-fall	☼		4	Downy grey foliage, purple grey in winter
<i>Calluna vulgaris</i> 'Spring Torch'	EG	.5m (18 inc)	lavender	sum-Fall	☼		4	Glowing red/orange new growth
<i>Camellia grijsii</i> *	EG	3-5m(10-17ft)	white	spring	☼●		7	Small, single, white, four-inch nodding flower
<i>Camellia japonica</i> 'Astronaut'	EG	2.5-4 m (8-12)	pink	spring	☼●		7	Semi double pink
<i>Camellia japonica</i> 'Red Lily'	EG	not known	red	spring	☼●		7	Tubular single, deep pink/red, mid season, very small
<i>Camellia japonica</i> ssp. <i>quercifolia</i> 'Pink Mermaid' *	EG	3m(10ft)	pink	spring	●		8	Fish-tail leaf tip, single flower, many stamens
<i>Camellia oleifera</i> *	EG	3m (10ft)	cream	spring	☼●	yes	7?	Tea oil camellia, scented may bloom early winter
<i>Camellia reticulata</i> 'Aunt Mavis'	EG	not known	red	spring	☼●		7?	Introduced and named by Vancouver plant expert, Alleyne Cook
<i>Camellia sasanqua</i> 'Kanjiro'	EG	2-3m (6-10ft)	rose-pink	winter	☼●	yes	8	Semi double flowers, drought resistant
<i>Camellia sinensis</i>	EG	2m (6ft)	white	fall	☼●	Yes	6	Famous plant where all tea originates; seed grown
<i>Camellia sinensis</i> 'Blushing maiden' *	EG	1-3m (3-10ft)	pink	fall	☼●	yes	7b	Single pink, red blush to leave, red seed pods
<i>Camellia sinensis</i> 'Teabreeze' *	EG	2-3m(7-10ft)	white	fall	☼●	yes	7b	Single nodding white fragrant flower; Piroche selection
<i>Carya illinoensis</i> (northern pecan)	D	10m (30ft)	white	spring	☼		5	Sweet edible nuts; hardy, tropical looking, self fertile
<i>Caryopteris x clandonensis</i> 'Blue Knoll'	D	.5-1m (2-3ft)	blue	sum-fall	☼	yes	6a	Sub shrub, grey foliage, drought, attracts pollinators
<i>Carya ovata</i> (shagbark hickory)	D	20m (60ft)	white	spring	☼		4	Sweet edible nuts; tropical looking; self fertile
<i>Castanea dentata</i> (American chestnut)	D	30m (90ft)	white	spring	☼		5	Sweet edible protein-rich nuts; 2 for pollination. Rare
<i>Ceanothus gloriosus</i> 'Point Reyes'	EG	.5m (2ft)	blue	spring	☼		7b ?	Small leathery holly like leaves, minimal water in summer, good drainage, -9C, endemic to bluffs
<i>Ceanothus thyrsiflorus</i> 'Victoria' (California lilac)	EG	3m (10ft)	blue	spring	☼●		7	Very hardy; grows to 10 ft with age
<i>Cephalotaxus harringtonia</i> 'Fastigiata' (chinese plum yew)	Con	2.5-3m(5-10ft)	foliage		☼●		6	Upright form, slow growth, dioecious
<i>Cercidiphyllum japonicum</i>	D	15-20m(40-60)	yellow	fall	☼●		4	Good fall colour, burnt sugar smell to falling leaves
<i>Chamaecyparis obtusa</i> 'Nana Gracilis' *	EG	1.5m (4ft)	conifer		☼●		6	Slow grower, foliage in shell-like sprays
<i>Choisya ternata</i> (Mexican mock orange)	EG	2.5m (8ft)	white	e. spring	☼●	yes	7	Likes fast drainage, sun; can be a bit leggy in shade
<i>Choisya ternata</i> 'Sundance'	EG	1.5-2.5m(4-6ft)	white	e. spring	☼●	yes	7	Bright yellow foliage, fragrant flower
<i>Choisya x dewitteana</i> 'Aztec Pearl'	EG	2.5m (8ft)	white	May	●	yes	7	Crow-foot leaf, narrow leaflets; large flowers
<i>Cinamomun japonicum</i> (Japanese camphor tree)	EG	10-12m(30-40f)	yellow	spring	☼●		7-	Frag camphor scent to lustrous leaf; sienna brown bark
<i>Cistus x purpureus</i> (orchid rockrose) *	EG	1.5-2.5m(4-6ft)	pink	summer	☼	yes	7	Magenta, dark blotch at base, hardiest, poor dry soil

TREES AND SHRUBS

Plant Name	D/EG	Height	Colour	Bloom	Expos.	Frag	Z	Information
<i>Clethra alnifolia</i> (sweet pepperbush)	D	1-2m (3-8ft)	white	summer	☼○	yes	3	OK in wet soils, upright panicle fragrant; butterflies
<i>Cornus omiense</i> 'Summer Passion'	EG	7-10m(23-33ft)	white	spring	☼○		7?	Sheltered site, glossy green leaf, red new foliage
<i>Cornus sanguinea</i> 'Midwinter Fire' *	D	2m (5-6ft)	yellow	fall col.	☼○		2	Colourful stems in winter, red/orange/yellow
<i>Cornus sericea</i> 'Kelsey' *	D	1m (3 ft)	insig	spring	☼○		2	Dwarf, good for container, red stems winter, fall colour
<i>Cornus walteri</i>	D	6m (20 ft)	white	spring	☼○	yes	6	Rare. Corymbose flowers; reddish-purple berries
<i>Corokia cotoneaster</i> *	EG	1-2m(3-6ft)	yellow	spring	☼		7-	Grown for the beautiful zig zag grey twigs
<i>Corylopsis pauciflora</i> *	D	2m (4-6ft)	p. yellow	wint-spr	☼○	yes	6	Cowslip scented, slow grower
<i>Cyclobalanopsis glauca</i> (syn <i>Quercus glauca</i>)	EG	8-10m(20-30ft)	acorns	fall	☼○		7?	Evergreen oak, very small acorns, sheltered site
<i>Davidia involucrata</i> (dove tree)	D	12m (40ft)	white	spring	☼○	yes	6	Flowers resemble doves in flight; textured bark
<i>Deutzia gracilis</i> 'Pink Pom Pom' (syn. <i>Deutzia</i> x hybrid 'Pink Pompom') *	D	1-1.5m (3-5ft)	pink	spring	☼○		6	Double pink, burgundy leaf in fall; long floral display
<i>Deutzia gracilis</i> 'Rosea' *	D	1m (3ft)	white	spring	☼○		6	Pink buds open white; low arching; can take damp soil
<i>Dipteronia sinensis</i> syn. <i>Acer sinensis</i> (money tree)	D	10m (30ft)	greenish	spring	☼○		8	Pinnately compound leaves. By waterfall at VanDusen
<i>Disanthus cercidifolius</i>	D	3m (8-10ft)	red	fall	○	yes	5	Witch hazel family, good fall colour in shade
<i>Distylium racemosum</i> (evergreen witchhazel)	EG	3 m (10ft)	red	winter	☼○		6-	Interesting red spidery flower in leaf axials,
<i>Elaeocarpus sylvestris</i>	EG	10m (40ft)	white		☼○	yes	8b	Small greeny-white fringed flowers in racemes, frag
<i>Epilobium canum</i> 'Catalina' (California fuchsia)	D	1-1.5m(3-4ft)	red/orange	summer	☼		7b	Sub Shrub, Good drainage, lean soil, grey green leaf
<i>Erica carnea</i> 'Pink Cloud' *	EG	15cm (6 inch)	heliotrope	winter	☼○		5	Pink darkening to heliotrope, feb-march,
<i>Erica carnea</i> 'Springwood Pink' *	EG	15-30cm(6-12)	pink	winter	☼○		5	Clear pink, jan-march, med moist, well drained soil
<i>Erica carnea</i> 'Vivelli' *	EG	15cm (6 inc)	violet	winter	☼○		5	Jan-May, purplish pink darken to magenta, (VD eval)
<i>Erica</i> x <i>darleyensis</i> 'Mediterranean Pink' (syn. 'Darley Dale') *	EG	30cm (12in)	purple /pink	winter	☼		6	One of the most heat tolerant heathers, likes open sunny spots, good drainage but not droughty
<i>Erica</i> x <i>darleyensis</i> 'Silberschmelze' *	EG	.5 m (18 inc)	white	winter	☼		6	Name means "molten silver"; good performer in PNW
<i>Erica</i> x <i>darleyensis</i> 'Ghost Hills' *	EG	26-30cm(1 ft)	heliotrope	winter	☼		6	Pink to heliotrope, Nov-May, new shoots cream tips
<i>Erica</i> x <i>darleyensis</i> 'Kramers Red' *	EG	40cm(16 inc)	violet	winter	☼		6	Compact and upright habit; Dec-April; (VD eval 2003)
<i>Escallonia</i> x <i>exoniensis</i> 'Pink Princess'	EG	2.5m (8ft)	pink	sum-fall	☼○	leaf	8	Compact growth, good for espaliers
<i>Eucommia ulmoides</i> (hardy rubber tree)	D	12m (40ft)	green	spring	☼○		5	Thick leaves, pyramidal. VanDusen Sino Him. TCM
<i>Euonymus hamiltonianus</i> ssp. <i>sieboldianus</i>	D	4m (12ft)	white	sum	☼○		4	Fruit 4 lobed, pink calyx around orange seed in fall
<i>Euonymus myrianthus</i>	EG	3m (9ft)	orange frt	fall	☼○		7	Arching, EG shrub, neat fruit, orange calyx/red seed
<i>Euonymus planipes</i>	D	5m (15ft)	insignif.		☼		4	Fall colour bright red, fruit red, orange aril
<i>Euryops pectinatus</i> 'Munchkin' *	EG	.5-1m (1.5-3ft)	yellow	summer	☼		8	-12C, dwarf, slow, long bloom, grey-blue ferny foliage
<i>Euryops pectinatus</i>	EG	1-1.5m (3-5ft)	yellow	summer	☼		8	South African native; rocky slopes; green ferny foliage
<i>Fagus sylvatica</i> 'Pendula' *BONSAI	D	10-15m(to 50ft)			☼○		4	Weeping form of beech; try as a bonsai
<i>Forsythia koreana</i> 'Kumson'	D	1.25-2m (4-6ft)	yellow	spring	☼○		4	Beautiful variegated netting on leaf
<i>Fothergilla gardenii</i> 'Mt. Airy' *	D	1-2m(4-5ft)	cream	spring	☼○	yes	5	Upright habit, great fall colour, orange/red/purple
<i>Franklinia alamahama</i>	D	6m (20ft)	white	fall	☼○	yes	8	Seed grown. Rare beauty. Vivid fall colour
<i>Fuchsia</i> 'San Leandro' *	D	1-2m (3-6ft)	carmine	sum	☼○		7a	Carmine sepals/magenta corolla, double, hummers
<i>Fuchsia</i> 'Erecta Novelty' *	D	1-2m (3-6ft)	white/pur	sum	☼○		7a	White sepals/pink corolla, single, hummers

TREES AND SHRUBS

Plant Name	D/EG	Height	Colour	Bloom	Expos.	Frag	Z	Information
<i>Fuchsia</i> 'Papoose' *	D	1-2m (3-6ft)	crimson	sum	☼○		6	Red sepals/dark purple corolla, single, hummers
<i>Gymnocladus dioicus</i> (Kentucky coffee tree)	D	12m (40ft)	white	spring	☼○		4	Bi-pinnate leaves, pointy leaflets, pest free
<i>Ginkgo biloba</i>	D	12m (36ft)		spring	☼		4	Whale-tail lobed leaves; yellow fall colour
<i>Hebe</i> 'Hinerua' *	EG	1 m (3ft)	white	summer	☼		7a	Rounded compact, very fine scale foliage
<i>Hebe buchananii</i> *	EG	18-30cm(8-12i	white	summer	☼		7a	Dwarf, blue-green foliage
<i>Hebe odora</i> (syn <i>H. buxifolia</i>) *	EG	1-1.2m (3-4ft)	white	summer	☼		7a	Compact upright, bright green leaf yellow edge
<i>Hibiscus syriacus</i> 'Blue Bird' (rose of Sharon)	D	4m (12ft)	blue	sum-fall	☼		5	Single, large sky-blue flowers with red eye
<i>Hydrangea macrophylla</i> 'Nikko Blue' *	D	1-3m (3-9ft)	blue	summer	○		5	Old cultivar, good bloomer in shade
<i>Hydrangea macrophylla</i> 'Thunbergii' (syn <i>H. serrata</i> 'Thunbergii') *	D	1.5m (5ft)	white /blue	summer	☼○		5	Lace cap, white sepals, purple/pink inner
<i>Hydrangea paniculata</i> 'Tardiva'	D	2-3m (6-10ft)	cream	sum-fall	☼○	yes	3	Conical head, loose sterile flowers
<i>Hydrangea quercifolia</i> 'Snow Giant' *	D	1-2m (4-6ft)	white	summer	☼○	yes	5	Double white, pyramidal, panicle fades to pink
<i>Hydrangea serrata</i> 'Bluebird' (lace cap hydrangea) *	D	1.2m (4ft)	blue	summer	●●		6	Dwarf. Pink flower, basic soil, blue on acid
<i>Illicium floridanum</i> 'Woodlanders Ruby' *	EG	2-3m (6-10ft)	ruby	summer	○		7?	Red starfish-like, waxy flower
<i>Itea ilicifolia</i>	EG	2-3m (6-10ft)	green	sum-fall	☼	yes	7?	Warm wall, long racemes, frag flowers, holly-like leaf
<i>Juglans ailantifolia</i> var. <i>cordiformis</i>	D	12m (36ft)	white	spring	☼		5	Sweet heart shaped kernels, mild, buttery flavour; 150nuts/kg 8-20 nuts/cluster; very productive, choice
<i>Juglans cinerea</i> (butternut)	D	20m (60ft)	white	spring	☼		4-	Sweet edible nuts; self fertile
<i>Juglans nigra</i> (black walnut)	D	20m (60ft)	white	spring	☼		4-	Sweet edible nuts; self fertile. Valuable timber
<i>Kerria japonica</i> 'Pleniflora'	D	2m (6ft)	yellow	spring	☼○		4	Double yellow flower
<i>Kolkwitzia amabilis</i> 'Pink Cloud'	D	2-3m (6-10ft)	pink	spring	☼○		4	Cascade form, trumpet-shape flower, fruit unique
<i>Koelreuteria paniculata</i> (golden rain tree)	D	8-12m(25-40ft)	yellow	summer	☼		5	Pinnate leaf, large ornamental bladdery bronze fruits
<i>Lavatera</i> 'Lilac Lady' *	D	1.2-2m(4-6ft)	mauve	summer	☼		7	Subshrub, long bloom period, silk texture flower
<i>Lavatera</i> 'Olbia Rosea' (syn. <i>L. x clementii</i> 'Rosea')	D	1-2m(3-6 ft)	pink	summer	☼		7	Subshrub, maple shaped grey-green leaves
<i>Lavatera</i> 'Red Rum' (<i>L. x clementii</i> 'Red Rum') *	D	1-1.2m(3-4ft)	red	summer	☼		7	Deep pink to near red, long bloom period, semi dwarf
<i>Lespedeza thunbergii</i> (bush clover)	D	1.2-1.5m(4-5ft)	rose-purp	summer	☼○		4	Arching fountain habit, purple pea flower
<i>Leucothoe fontanesiana</i> 'Scarletta'	EG	60cm (2ft)	cream	spring	☼○		5	Foliage, bright red-green-deep red; dry shade
<i>Leucothoe axillaris</i>	Eg	1.2m (2-4ft)	white	spring	○	yes	6	Slow grower, low. Leaves bronze/purple in winter
<i>Leycesteria formosa</i> (Himalayan honeysuckle)	D	2m (6ft)	white	sum-fall	☼○		7	Fast growing, purplish racemes
<i>Lindera obtusiloba</i> (Japanese spicebush)	D	2-3m (6-9ft)	yellow	spring	☼		6	Early spring flowers, lovely leaves, vivid yellow fall
<i>Liriodendron tulipifera</i> (tulip tree)	D	30m (90ft)	yellow	summer	☼○	yes	5-	Unique lobed leaves
<i>Loropetalum chinense</i> 'Daybreaks Flame' *	Semi	2-2.5m(6-8ft)	purp/pink	spring	☼○	yes	7?	New growth red/bronze, older foliage red to dark green
<i>Loropetalum chinense</i> 'Fire Dance' *	Semi	1-3m(3-6ft)	dark pink	spring	○		7/	Upright arching habit, rich ruby red new growth
<i>Magnolia denudata</i>	D	9m (27ft)	white	spring	☼○	yes	5	White flower, rounded shape. Yulan magnolia
<i>Magnolia</i> 'Galaxy'	D	10m (30ft)	red-purple	m.sprng	☼○	yes	5	Narrow conical. Flowers young, deep red-purple buds open to lighter red-purple outside, pale rose inside
<i>Magnolia grandiflora</i> 'Bracken's Brown Beauty' *	EG	10m (30ft)	cream	summer	☼○	yes	6	Compact, leaf rusty-brown indumentum
<i>Magnolia kobus</i> var <i>borealis</i>	D	10m (30ft)	white e	winter	☼○	yes	4	Very early, white & pink flowers; sinuous broad shape

TREES AND SHRUBS

Plant Name	D/EG	Height	Colour	Bloom	Expos.	Frag	Z	Information
<i>Magnolia kobus</i> var. <i>kobus</i>	D	7m (21ft)	white	spring	☼○	yes	5	Pyramidal form
<i>Magnolia lotungensis</i>	EG	10m (30ft)	ivory	summer	☼○	yes	7	Rare. Upright from, used as street tree
<i>Magnolia soulangeana</i>	D	5m (15ft)	pinks	spring	☼○	yes	5	Pink to near purple 15cm flowers, hybrid
<i>Magnolia stellata</i> 'Royal Star' *	D	2.5-6m (20ft)	white/pink	spring	☼○	yes	4	Flowers 5in across, star-shaped and faint pink
<i>Magnolia zenii</i>	D	10m (30ft)	white/pur	spring	☼○	yes	7?	White, upright, chalice flower, stained purple
<i>Mespilus germanica</i> (medlar)	D	5-7m(15-20ft)	white/pink	spring	☼○		5	Small tree, apple-like blossom, edible fruit once bletted
<i>Michelia figo</i> (syn. <i>Magnolia figo</i>) *	EG	2-3m(6-10ft)	yellow	summer	☼○	yes	8	Very frag, yellow-streaked purple, compact shrub
<i>Michelia platypetala</i> (syn <i>Magnolia cavaleri</i> var. <i>platypetala</i>)	EG	6-10m(20-30ft)	white	spring	☼○	yes	7	Very fragrant, white auxiliary blooming, blue-green foliage. VanDusen has one along the Rhodo Walk
<i>Michelia yunnanensis</i> (syn <i>Magnolia lavefolia</i>) *	EG	4 m (18ft)	white	spring	☼○	yes	7	Slow grower, brown indumentum leaves and buds
<i>Nandina domestica</i> 'Gulf Stream'	EG	1m (3ft)	cream	spr-sum	☼○	yes	7	Busy compact, new growth bronze with orange tints
<i>Nandina domestica</i> 'Moon Bay'	EG	1m (2-3ft)	cream	spr-sum	☼○	yes	7	Lighter green leaf, bright red in winter, dry shade
<i>Nandina domestica</i> 'Plum Passion' *	EG	1.2-1.5m(4-5ft)	cream	spring	☼○		7	New growth dp purple/red, then green; fall red-purple
<i>Nothofagus antarctica</i> 'Antarctic fire'	D	15m (50ft)	insig.		☼○	yes	7	Small scented leaf, yellow fall colour. Try as bonsai
<i>Nyssa sinensis</i> (Chinese tupelo tree)	D	9m(30ft)	orange/red	fall	☼○		7	Great fall colour, wet soils, pyramidal shape
<i>Nyssa sylvatica</i> 'Tupelo Tower'	D	12m (40ft)	yellow/or	fall	☼○		4	Very tight upright habit, good for small gardens
<i>Osmanthus delavayi</i> (Delavay osmanthus)	EG	2m (6ft)	white	spring	☼○	yes	7	Very fragrant white jasmine flower; slow grower
<i>Osmanthus fragrans</i> 'Thunbergii' *	EG	3-4m (9-12ft)	yellow	l.fall/spr	☼○	yes	8	Fragrant small flower, supposed to be very cold hardy
<i>Osmanthus heterophyllus</i> 'Purpureus'	EG	2.5m (8ft)	white	fall	☼○	yes	6	Spring growth deep purple, drought tol. when estab.
<i>Osmanthus x burkwoodii</i>	EG	2-3m (6-10ft)	white	spring	☼○	yes	6	Slow grower, compact, very fragrant
<i>Paeonia delavayi</i>	D	2m (6ft)	red	summer	☼○	yes	6	Single; colours from mid red to near black
<i>Paeonia delavayi</i> var <i>lutea ludlowii</i> (syn. <i>P. lutea</i> var <i>ludlowii</i> or <i>P. ludlowii</i>)	D	1.2-2.5m(4-6ft)	yellow	summer	☼○			Clear yellow saucer shaped bloom, golden yellow colour in fall. Do not prune tree peonies
<i>Paeonia rockii</i> hybrids (genus peony)	D	2m (6ft)	white	spring	☼○	yes		White to pink to magenta, with dark purple blotch
<i>Paeonia suffruticosa</i> 'Hanakisoi' (syn. 'Floral Rivaly')	D	1-1.75m(to5ft)	pink	spring	☼○	yes	7	Semi double, apricot/shell-pink, yellow stamens
<i>Paeonia suffruticosa</i> 'Kamatanishiki' * (syn 'Kamata Tapestries')	D	1.5m (4-5ft)	mauve	spring	☼○		7	Semi double, wisteria-blue fading at the edges
<i>Paeonia suffruticosa</i> 'Kinkaku' * (syn. 'Golden Temple of Nara')	D	1.5m (4-5 ft)	yellow	spring	☼○		7	Multitude of yellow petals edged in bright orange, fill the fully double blooms
<i>Paeonia suffruticosa</i> 'Renkaku' *	D	1.7m (3-4ft)	white	spring	☼○	yes	7	'Renkaku' translates "flight of the cranes". Very large, semi-double, white-fringed petals with orange stamens
<i>Paeonia suffruticosa</i> 'Shimadaijin' *	D	1.5m (3-5ft)	magenta	spring	☼○	yes	7	Rare, Imperial peony from Japan, translates to "Island Minister". Large, semi-double, rich magenta bloom
<i>Paeonia suffruticosa</i> 'Shima Nishiki' * (syn. 'Fire Flame')	D	1m (3ft)	red/white	spring	☼○	yes	7	Two toned striped with rose-red and white, double variety, yellow stamens
<i>Penstemon</i> 'Alice Hindley'	D	.5-1m(1.5-3ft)	lilac/white	summer	☼		6a	Subshrub, beautiful amethyst flower white throat,
<i>Penstemon</i> 'Garnet' *	D	.25-.5m(1-2ft)	garnet	summer	☼		7a	Subshrub, long bloom period, hummers and butterflies
<i>Penstemon</i> 'Midnight'	D	.5-1m(2-3ft)	dark purpl	summer	☼		6a	Subshrub, long lived, need excellent drainage

TREES AND SHRUBS

Plant Name	D/EG	Height	Colour	Bloom	Expos.	Frag	Z	Information
<i>Philadelphus x virginalis</i> 'Minnesota Snowflake'	D	1-2m (3-6ft)	white	spring	☼○	yes	5	Compact, double flower on old wood
<i>Phoebe sheareri</i>	EG	4m(12ft)	yellow	summer	☼○		7?	Interesting bluish/green foliage, tropical look, drip tip
<i>Phormenum tenax</i> *	EG	.2-2m(1-6ft)	red	late sum	☼○		7	Spiky upright thick grass looking agave family member
<i>Phygelius</i> 'Lemon Spritzer' *	D	1m (3ft)	coral	summer	☼		7a	Subshrub, variegated lemon yellow splashes, lime gree
<i>Phygelius</i> 'Salmon Leap' *	D	.4-.6m (18-24	salmon	summer	☼		7a	Subshrub, long bloom period,
<i>Phygelius x</i> 'Cherry Ripe' *	Semi	.5m (20 in)	red	summer	☼		6a	Subshrub, tubular red flower yellow throat, hummers
<i>Physocarpus opulifolius</i> 'Coppertina'	D	2-3m (6-8ft)	white/pink	summer	☼○		2	Copper orange new growth in summer changes to rich red-burgundy. Compact growth, difficult situations
<i>Physocarpus opulifolius</i> 'Diablo'	D	2-3.5m (-10ft)	white	summer	☼○		2	Intense red-purple leaf, low maintenance
<i>Pieris japonica</i> 'Blush' (lily-of-the-valley shrub) *	EG	1.5-2m(4-6ft)	pink/white	spring	○	yes	6	Rose-pink bud, opens to white, red sepal compact
<i>Pieris japonica</i> 'Katsura' *	EG	1m (3ft)	pink/white	spring	○	yes	6	Deep burgundy-red new growth
<i>Pieris japonica</i> 'Mountain Fire' *	EG	2-3m (6-8Ft)	white	spring	○	yes	6	Heavy flower clusters, bright red new growth changes to copper red. All Pieris are good for mason bees
<i>Pieris japonica</i> 'Valley Rose' *	EG	1.5m (5ft)	rose-pink	spring	○	yes	6	Deep rose-pink cap fades to blush at tip of flower
<i>Pinus koraiensis</i> (Korean pine nut)	EG	+7m (21ft)		spring	☼○			Most pine nuts come from this species, self fertile
<i>Pinus strobus</i> 'Pendula' *	Con	2-5m(6-15ft)	conifer		☼		3	Semi dwarf, Pendulous soft white pine
<i>Pittosporum heterophyllum</i> *	EG	2-3m(6-10ft)	white	spring	☼○	yes	7b ?	Very fragrant, white fades to yellow flwr. Supposed to be more cold hardy than P. tobira. Seashore tolerant
<i>Potentilla fruticosa</i> 'Day Dawn'	D	75cm (30in)	peach/pnk	spr-fall	☼		3	Compact, drought tolerant
<i>Potentilla fruticosa</i> 'Pink Beauty'	D	1m (3ft)	mid pink	spr-fall	☼		2	Semi double flower, compact, drought tolerant
<i>Rhodotypos scandens</i>	D	1-2m (3-5ft)	white	spring	☼○		5	Arching shoots, 4 petal flower, jet-black berry
<i>Rhus typhina</i>	D	5-8m(15-25ft)	red fruit	fall	☼○		3	Great fall colour, orange/red/yellow, small tree
<i>Rosa</i> 'Alexander MacKenzie' (Explorer series)	D	1.5-3m(5-10ft)	deep red	summer	☼	yes	3	Upright arching form, long bloom period, repeat bloom
<i>Rosa</i> 'Country Dancer'	D	1.5m (5ft)	pink	summer	☼	yes	3	Semi Double, Rosy red, long bloom season
<i>Rosa</i> 'David Thompson' (Explorer series)	D	1m (3.5 ft)	crimson	summer	☼	yes	3	Semi-dble, textured leaf, nearly thornless, long season
<i>Rosa</i> 'John Franklin' (Explorer series)	D	1-1.2m (3-4ft)	red	summer	☼	yes	3	Double, fringed like carnations, clusters, long season
<i>Rosa</i> 'Lambert Clossue' (Explorer series)	D	1m (2-3ft)	pink	summer	☼	yes	2	Silvery pink resemble hybrid teas, repeat
<i>Rosa</i> 'Morden Amorette' (Parkland rose)	D	.75m(2ft)	red/pink	summer	☼		2b	Compact, continual, semi double, petals curl inward
<i>Rosa</i> 'Prairie Princess'	D	1.5m (5ft)	pink	summer	☼	yes	4a	Double pink, repeat bloomer, bushy upright
<i>Rosa chinensis mutabilis</i>	D	1-2m (3-6ft)	yel-pink	summer	☼	yes	6	Single flower open yellow, orange, pink, to deep pink
<i>Rosa meidiland</i> 'Bonica'	D	1.3m (4.5 ft)	pink	summer	☼	light	4	Fully double, continual bloom, orange hips
<i>Rosa meidiland</i> 'Carefree Delight'	D	1.2-2m (4-6ft)	carmine	summer	☼	light	4	Single carmine pink with white eye, continual, red hips
<i>Rosa meidiland</i> 'Fuchsia'	D	1m (3ft)	deep pink	summer	☼	light	5b	Semi double, continual
<i>Rosa meidiland</i> 'Red'	D	.75-1m (2-3ft)	red	summer	☼		4	Single red with white centre, continual, orange hips
<i>Rosa rugosa</i> 'Alba'	D	1.3-2m (4-6ft)	white	summer	☼	yes	2	Pure white single, repeats, large orange hips
<i>Rosa rugosa</i> 'Belle Potevine'	D	1.3m (4 ft)	pink	summer	☼		4	Semi double, continual, orange red hips
<i>Rosa rugosa</i> 'Moje Hammarberg'	D	1-1.3m (3-4ft)	pink	summer	☼			Semi double, continual, bright red hips
<i>Rose</i> 'Reine Des Violettes'	D	1m (3ft)	red	summer	☼	yes	5	1860's French hybrid perpetual, own root, repeat
<i>Salix integra</i> 'Hakuro Nishiki'	D	1.5m (5ft)	foliage		☼○		6	Light green, blotched white foliage, wispy growth

TREES AND SHRUBS

Plant Name	D/EG	Height	Colour	Bloom	Expos.	Frag	Z	Information
<i>Salix magnifica</i>	D	2.5-4m (7-14ft)	yellow	spring	☼○		7	Large magnolia like foliage, very large upfacing catkin
<i>Salix purpurea</i> 'Nana'	D	1-1.4m (3-5ft)	white	spring	☼		4	Compact rounded shrub, blue green leaves,
<i>Salix</i> x 'Golden Curles'	D	6-9m (20-30ft)			☼○		4	Contorted, non invasive, used in floral displays
<i>Sambucus nigra</i> 'Madonna'	D	2-4m (6-8ft)	crm/pink	spring	☼○		5	Variegated form, yellow cream in spring, slow grower
<i>Sambucus nigra</i> 'Guincho Purple'	D	4-5m (8-15ft)	pink/white	spring	☼○	yes	5	New growth purple, purple /red fall, berries for wine
<i>Sarcococca confusa</i>	EG	1-2m (3-6ft)	cream	winter	●	yes	6	Drought tolerant. Fruit emerges red, changes to black
<i>Sarcococca hookerana</i> var. <i>humilis</i> (sweet box)	EG	45cm (18in)	cream	winter	●	yes	6	Mounding, dwarf shrub, black berries
<i>Sarcococca ruscifolia</i> (sweet box) *	EG	1.2m (3-4ft)	cream	winter	●	yes	8	Slow grower, dry shade. Violet frag. Red to black fruit
<i>Sassafras albidum</i>	D	5m (15ft)	yellow	spring	☼○	yes	5	Rare. Old-time culinary uses, sassafras tea, rootbeer
<i>Sciadopitys verticillata</i> (Japanese umbrella pine) *	Con	3m (10ft) 10yr	conifer		☼○		6	Very slow grower, pyramidal shape, reddish brown exfoliating bark, ok in container as long as kept moist
<i>Skimmia japonica</i> 'Dwarf Female' *	EG	1m (3ft)	white	winter	●	yes	7	Female. Very fragrant
<i>Skimmia japonica</i> 'Dwarf Male' *	EG	1m (3ft)	white	winter	●	yes	7	Male, red bud in winter, white flower, very fragrant
<i>Spirea nipponica</i> 'Snowmound'	D	1-1.5m (2-4ft)	white	summer	☼○		3	Arching branches, waterfall effect, blue-green foliage
<i>Spirea betulifolia</i>	D	1m (2-3ft)	white	May-July	☼○		5	Dwarf, dense mound, foliage blue-green
<i>Stewartia koreana</i> *	D	6-9m (20-30ft)	white	summer	☼○		5	Smaller than <i>S.pseudocamellia</i> , orange red fall
<i>Stewartia pseudocamellia</i>	D	6-12m(to40ft)	white	summer	☼○		5	Small, beautiful tree, flaking bark, great red/orange fall colour, sngl white, camellia-like flower, yellow stamen
<i>Stewartia serrata</i>	D	10m (30ft)	white/red	spr-sum	☼○		7	Small tree, flower stained blush-red, great bark
<i>Styrax japonicus</i>	D	8-12m (25-40ft)	white	spring	☼○	light	5	Nodding white bell flowers, yellow leaves fall
<i>Syringa meyeri palibin</i> (dwarf Korean lilac) *	D	2m (4-5ft)	lav-pink	spring	☼○	yes	5	Reddish-purple bud opens to pale pink; dwarf
<i>Syringa pubescens</i> ssp. <i>patula</i> 'Miss Kim' (lilac) *	D	2.7m (4-9ft)	purple	spring	☼○	yes	5	Small, slow growing, Korean lilac. Floriferous
<i>Syringa reflexa</i> (nodding lilac)	D	4m (12ft)	pink	summer	☼○		5	Wisteria-like flower cluster, arching multi stem
<i>Syringa</i> 'Tinkerbelle' *	D	2m (5-6ft)	wine	spring	☼	yes	3	Wine buds open to pink flowers, spicey frag, dwarf
<i>Syringa vulgaris</i> 'Charles Joly'	D	3-3.7m (10-12f)	purple	spring	☼	yes	5	Double purple, Lemoine hybrid, fantastic fragrance
<i>Syringa vulgaris</i> 'Monge'	D	2-4m(6-12ft)	deep purp	spring	☼	yes	5	Bright purple, sweet fragrance, Lemoine hybrid
<i>Syringa vulgaris</i> 'President Grevy'	D	4m (12ft)	lavender	spring	☼	yes	5	Highly fragrant, double light blue
<i>Syringa vulgaris</i> 'Sensation'	D	2-4m (6-12ft)	purple/wh	spring	☼	yes	5	Purple, edged in white, lighter in fragrance
<i>Syringa vulgaris</i> 'Wonderblue' syn.'Little Boy Blue'	D	1.2-1.5m(4-5ft)	sky blue	spring	☼	yes	4	Single, slower growing, compact
<i>Syringa</i> x <i>prestoniae</i> 'Red Wine'	D	2-3m (6-8ft)	magenta	summer	☼	yes	2	Blooms 2 weeks after <i>S.vulgaris</i> , spicy frag, single flws
<i>Viburnum</i> x <i>bodnatense</i> 'Dawn'	D	2.5-3m (-10ft)	pink	winter	☼○	yes	7	Vase-shaped, tubular flower, blooms in mild 'snaps'
<i>Viburnum carlesii</i> *	D	1-2m (4-6ft)	pink/white	spring	☼○	yes	4	Red fall colour, tolerates adverse cond. Slow grower
<i>Weigela</i> 'Magical Rainbow'	D	1.2m (3-4ft)	pink	spring	☼		5	Green/yellow with pink tints, variegated leaf
<i>Weigela</i> 'Red Prince'	D	2m (5-6ft)	red	spring	☼○		5	Arching, repeat bloomer, attracts hummers
<i>Weigela florida</i> 'Rosea'	D	2m (6-7ft)	pink	spring	☼○		5	Arching growth, pink bellflower, attracts hummers
<i>X Gordlinia grandiflora</i>	EG	9m (30ft)	white	summer	☼○		6	Franklinia x gordonia; more cold hardy than parents
<i>Zenobia pulverulenta</i>	Semi	1-3m (3-10ft)	white	spring	☼○	yes	6	Glaucous blue fol. Acidic soils, will take boggy cond.

The following symbols are used: Sun=☼ Part shade=○ Shade=● * Denotes that the tree or shrub is suitable for small gardens or for planting in pots.

TROPICALS

Plant Name	Height	Colour	Bloom	Zone	Information
<i>Actinidia deliciosa</i> (male & female kiwi vine)	5m (15ft)	white	summer	6	Fuzzy New Zealand kiwi vine. Canadian varieties
<i>Araucaria araucana</i> (monkey puzzle tree)	20m (slowly)			7	Ornamental, slow growing, Chilean evergreen tree
<i>Asimina triloba</i> (pawpaw) varieties: Mango, Davis, Mitchell	3.5m (10ft)			5-8	Mango-like sweet fruit. Hardy tree from East USA.
<i>Citrus australasica</i> (finger lime) NEW	1m (3ft)			9-11	Long tubular limes with caviar interior. Sweet, delicious. RARE
<i>Camellia sinensis</i> (Korean tea tree)	2m (6ft)	white	summer	8	Commercial green tea in Korea. The Asian tea tree
<i>Citrus x aurantifolia</i> (bear's lime)	1m (3ft)	white	summer	9-11	Large limes, fragrant flower. Leaves used in cooking
<i>Citrus limettioides</i> (Palistine sweet lime, Indian sweet lime)	1m (3ft)	white		9-11	Large limes for the home grower
<i>Citrus x aurantifolia</i> (Key lime)	1m (3ft)	white	summer	9-11	Small limes, fragrant flower. Limes used for cocktail drinks
<i>Citrus sinensis</i> (variegated pink lemon)	1m (3ft)	white		9-11	Variegated plant. Lemons with pink juicy interior
<i>Citrus junos</i> (Yuzu Ichandrin, hardy lemon)	1.5m (5ft)	white		7	Hardest, edible lemon tree. Good to - 16C
<i>Citrus junos</i> (Sudachi Ichandrin, hardy lemon)	1.5m (5ft)	white	fall	7	Super hardy lemon/lime citrus. Used for pickling and cooking
<i>Citrus</i> Cara Cara (navel orange)	1-2m (3ft-6ft)	white		9-11	Commercial sweet, large, pink-fleshed orange from Venezuela
<i>Citrus kinokuni mukakukishu</i> (Kishu mandarin orange)	1-2m (3ft-6ft)	white		8-11	Small, sweet, seedless mandarin. Peels easily
<i>Citrus</i> Flying Dragon	1-2m (3ft-6ft)	white		6	Hardest citrus in the world. Used for dwarf rootstock
<i>Citrus hystrix</i> (Thai or Kaffir lime)	1m (3ft)	white		9-11	Fragrant leaves used in Thai curries. Great fresh spice year-round
<i>Citrus limon</i> 'Meyer Lemon Improved'	2m (6ft)	white		(8) 9	Thin, yellow skin, mild, yellow flesh. Fragrant flowers
<i>Citrus microcarpa</i> (Variegated Calamondin)	1-2m (3ft-6ft)	white		9-11	Ornamental. Variegated foliage. Small mandarin kumquat cross
<i>Citrus</i> Weeping navel	1-2m (3ft-6ft)	white		9-11	Sweet orange with flowing weeping branches. Ornamental
<i>Citrus sinensis</i> (Blood orange)	1-2m (3ft-6ft)	white		9-11	Large, sweet orange, blood-red orange
<i>Diospyros virginiana</i> x 'Nikita's Pride', 'Prairie Star'	3m (9ft)	green/yell	1 spring	6-9	Non-astringent persimmons in late fall; Asian-American cross
<i>Eucomis Bicolor</i> (purple pineapple lily)	50cms (2ft)	maroon	summer	7-9	Rich maroon foliage. Flower and stalk resemble a pineapple
<i>Fargesia robusta</i> (Himalayan clumping mtn. bamboo)	5m (15ft)	bright grn		6	Fastest growing, tight-clumping bamboo
<i>Fargesia dracocephala</i> 'Rufa' (short clumping bamboo)	2m (6ft)			6	Dense, short, clumping bamboo, no maintenance
<i>Feijoa sellowiana</i> (pineapple guava)	2m (6ft)	red	summer	8	Red flowers and sweet edible fruit
<i>Ficus carica</i> 'Desert King' (fig)	4m (13ft)			7	Fast grower, produces large quantities of sweet green figs
<i>Morus nigra</i> (Illinois ever-bearing mulberry)	5m (15ft)			6	Large, 1½" tasty, black fruit. Extremely prolific
<i>Musa maurelli</i> (red banana)	3m (9ft)			9-11	Large 5' red and green leaves. Creates a striking bold specimen
<i>Olea europaea</i> 'Arbequina' (olive tree)	2.5m (8ft)			8-11	Black olives, the olive tree of the Mediterranean
<i>Olea europaea</i> 'Leccino' (olive tree)	2.5m (8ft)			8-11	Superior Italian olive variety, with weeping habit. Early ripening
<i>Olea europaea</i> 'Sea Breeze', 'Universal' (olive tree)	2.5m (8ft)				Large fruit. Used for oil production. NEW for 2016
<i>Persea americana</i> (avocado) 'Mexicola' & 'Brazos Belle'	2-3m (6ft-9ft)	yellow		8-11	Hardest of all avocados, producing tasty avocados in 2 years
<i>Phyllostachys</i> 'Spectabilis' (striped bamboo)	8m (25ft)	yellow		6	Yellow and green striped canes and poles
<i>Phyllostachys nigra</i> (black bamboo)	6m (18ft)	black canes		6	Black bamboo, the most popular variety
<i>Ribes uva-crispa</i> 'Hinnomaki Red' (gooseberry)	1m (3ft)				Large red fruit in summer. Excellent for cooking
<i>Trachycarpus fortunei</i> (Chinese windmill palm)	8m (25ft)			7	Medium-sized palm. Slow-growing when young
<i>Ugni molinae</i> (Chilean guava)	1m (3ft)	pale pink	summer	9-11	Small, sweet red guavas produced yearly on this bush guava
<i>Zanthoxylum piperitum</i> (Japanese pepper tree)	2m (6ft)	yellow	summer	8	Lemon-fragrant, edible leaves, spicy red peppercorns
<i>Ziziphus jujuba</i> 'Li' (Jujube, Chinese date)	2m (6ft)	yellow-grn		6-9	Small sweet fruit in fall. Loves dry heat. Cold hardy to -24C

TOMATOES

F1 Hybrid Types	Information
Beefsteak type	Best all round beefsteak from Stokes. Big and juicy
Chiquita	Sweet pink olive type, very good producer
Gold Nugget	Golden cherry. Very sweet. Good for hangers
Moneymaker	Long standing. Good producer, average size, old fashioned taste
New Girl	Improved. Replaces Early Girl. Good all round size and flavour
Orange Blossom	Sweet orange, 4 to 6 oz. tomatoes
Oregon Spring (early)	Excellent. Average size
Sungold	Awesome golden golf balls. A must grow, very, very sweet
Sweet Million	Sweet cherry type that produces tons! Replaces Sweet 100
Sweet Olive	Developed for greenhouse T O V (tomato on the vine). Olive shape, sweet and juicy. Does well in gardens
Suncherry	The sweetest-tasting, shiny red-skinned cherry variety available
Taxi	Sweet average size yellow, low acid
Tumbler	Brian Minter's favourite, a "no brainer". Always produces red golf balls. Excellent in hangers
Heirloom Tomato Varieties – 40 days is classed as early	
Black Prince; Cherokee Purple; Eva's Purple Ball; Green Zebra; Japanese Black Trifele; Moskvich (early); Nepal (early);	
Red Brandywine; Striped German; Valencia; Yellow Brandywine	

Protect your tomato plants until late May

Selections of Tomato and Vegetable varieties are dependent on our early spring weather

VEGETABLES

Mothers Day herb planters – will contain a selection of the following herbs; Bay, Thyme, Rosemary, Winter savory, Sage, Oregano, Parsley, or Chives
Soup Pot herb combinations – Bay, Thyme, Lovage, Rosemary, Winter savory, Sage, Oregano, Parsley
Salad garden mixed planter – assortment of greens eg Lettuce, Mesclun greens, Mustard, Chives, Rocket, Shallots, purple and green Basil
Vegetables – Arugula, Broccoli, Celery, Cabbage, Cucumbers, Egg plant (small size), Kale, Leeks, Peppers, Rainbow Chard, Radicchio, Rhubarb, Spinach

MUSHROOM KITS

Mushroom Name	Information
Oyster (king, pink, golden, white)	Fit the concept of designer mushroom, since they come in a wide variety of colours, shapes and sizes
Shitake (Black Forest or Chinese mushroom)	Next to Button, Shitake is the most cultivated mushroom in the world. Used in many Asian dishes

VINES

Plant Name	Height	Colour	Bloom	Expos.	Information
<i>Clematis</i> 'Allanah'	2-4m (6-8ft)	red	June to Sept	sun/shade	Pruning Gr C. Compact variety, good for pots
<i>C. alpina</i> 'Ruby'	2-3m (6-8ft)	mauve/red	April & May	sun/shade	Pruning Gr A. Bell-shaped flowers, attractive seed heads
<i>C. alpina</i> 'Willy'	2-2.5m (6-8ft)	mauve/pink	April & May	sun/shade	Pruning Gr A. Lovely spring colour
<i>C. armandii</i> 'Apple Blossom'	6-9m (20-30ft)	white/pink	March & April	sun	Pruning Gr A. Vigorous, evergreen, fragrant, frost-free spot
<i>C. armandii</i> 'Snowdrift'	6-9m (20-30ft)	white	March & April	sun	Pruning Gr A. Vigorous, evergreen, fragrant, frost-free spot
<i>C. 'Ascotiensis'</i>	2-5-3.5(8-12ft)	mid blue	July to Sept	sun/shade	Pruning Gr C. Good for cutting
<i>C. 'Bees Jubilee'</i>	2-2.5m (9ft)	mauve-red	May, June &Sept	sun/shade	Pruning Gr B1. Mauve-pink with carmine bars. Good cutting
<i>C. 'Comtesse de Bouchaud'</i>	2-4m (8-12ft)	mauve-pink	June to Sept	sun	Pruning Gr C. One of the most popular clematis ever grown
<i>C. 'Capitaine Thuilleaux'</i>	1.8m-2(6-7 ft)	pink and white	May-June & Sept	sun/shade	Pruning Gr B1. Good in pots and tolerates shade
<i>C. 'Daniel Deronda'</i>	2-2.5m (7-9ft)	purple-blue	May, June &Sept	sun	Pruning Gr B1. Cutting flower
<i>C. 'Danielle'</i> Vancouver Select Series	2-3m (6-8ft)	violet-blue	May, June &Sept	sun	Pruning Gr B1. Brilliant violet-blue. Containers
<i>C. 'Duchess of Edinburgh'</i>	2.5m (8ft)	double white	May, June &Sept	sun/shade	Pruning Gr B1. Cutting flower. Double white
<i>C. 'Dorothy Toliver'</i>	2.5-3.5 (8-12ft)	deep mauve	May -June	sun/shade	Pruning Gr B1. Good cutting flower
<i>C. 'Elsa Spath'</i> (aka 'Xerxes')	2-3m (8-10ft)	violet/purple	May, June &Sept	sun	Pruning Gr B1. Rich colour, and good for cutting
<i>C. 'Dr. Ruppel'</i>	2.5-3m (8-12ft)	rose red	June to Sept	sun/shade	Pruning Gr B1. Will tolerate more shade
<i>C. 'Kiri te Kanawa'</i>	2-3 m (6-9ft)	blue	June to Sept	sun/shade	Pruning Gr B2. From Japan. Blue flowers, golden stamens
<i>C. 'Guernsey Cream'</i>	2-2.5m (6-8ft)	white	May & June	sun/shade	Pruning Gr B. Good for pots , small spaces
<i>C. 'Hagley Hybrid'</i>	2-2.5m (6-8ft)	shell-pink	June to Sept	sun/shade	Pruning Gr B2 or C. Small spaces or pots
<i>C. 'John Paul 11'</i>	2.5;4 14ft	white	June to August	sun/shade	Pruning Gr C. Showy, deep purple-violet flowers
<i>C. 'Morning Mist'</i> Vancouver Select Series	2-3m (6-8ft)	blush pink	late spring to fall	sun/shade	Pruning Gr B2. Frilled hot-pink edges on large blooms
<i>C. 'Mme. Julia Correvon'</i>	3-4m (8-14ft)	deep wine-red	June to Sept	sun	Pruning Gr C. Free flowering a <i>Viticella</i> type
<i>C. 'Rhapsody'</i>	3.5m (8-ft)	violet-blue	June to Sept	sun	Pruning GrC. Will flower all summer
<i>C. 'Snow Queen'</i>	2-4m (8-12ft)	white	May, June &Aug	sun/shade	Pruning Gr B1. Good for cutting and pots
<i>C 'The Vagabond'</i>	1.5 (5ft)	deep purple	May to October	sun/shade	Pruning Gr B2. Compact plant, blooms all summer
<i>C. 'Teshio'</i>	3-4m (7-9ft)	lavender-blue	May and June	sun/shade	Pruning Gr B1. Frilly double flower. Ok for shade
<i>C. 'Fragrant Star'</i> Vancouver Select Series	2-4m (8-14ft)	white	late spring	sun/shade	Pruning Gr B1/C. Vanilla scent
<i>C. 'Walter Pennell'</i>	2-3m (8-10ft)	deep mauve-pink	spring	sun/shade	Pruning Gr B1. Wavy edges, cream stamens. Good cutting
<i>Campsis tagliabuana</i> 'Indian Summer'	climber	orange-red	summer	sun	Large trumpet-shaped flowers
<i>Campsis grandiflora</i>	10m (30ft)	orange-red	late summer-fall	sun	Very vigorous when established
<i>Hydrangea petiolaris</i> (climbing hydrangea)	15m (50ft)	creamy-white	summer	sun/shade	Suitable to grow up a tree or on a wall
<i>Jasminum officinale</i> (jasmine)	12m (40ft)	white	summer-fall	sun	Fragrant
<i>Jasminum polyanthum</i> (jasmine)	3m (10ft)	pink	spring-summer	sun	Fragrant
<i>Lonicera japonica</i> 'Halliana' (honeysuckle)	10m (30ft)	purple & white	spring-summer	sun or p/s	Fragrant Japanese variety, ages to yellow
<i>Passiflora caerulea</i> (blue passionflower)	10m (30ft)	purple,blue,white	summer bloom	sun	Striking blossom
<i>Schizophragma hydrangeoides</i> 'Rosa'	climber	assorted	summer	full sun	Prune to shape in spring. Good fall colour. Zone 5
RAYMOND EVISON CLEMATIS	pot variety	lilac/purple/blue	summer	sun	Assorted varieties. Excellent for pots, walls, fences. Zone 5
Climbing Roses	various heights	various colours	summer-fall	sun	Disease resistant, good for arbours, walls and fences

CLEMATIS PRUNING: Gr. A – no pruning required; Gr. B – light pruning in early spring; Gr. C – prune hard early spring

VANDUSEN PLANT SALE MAP

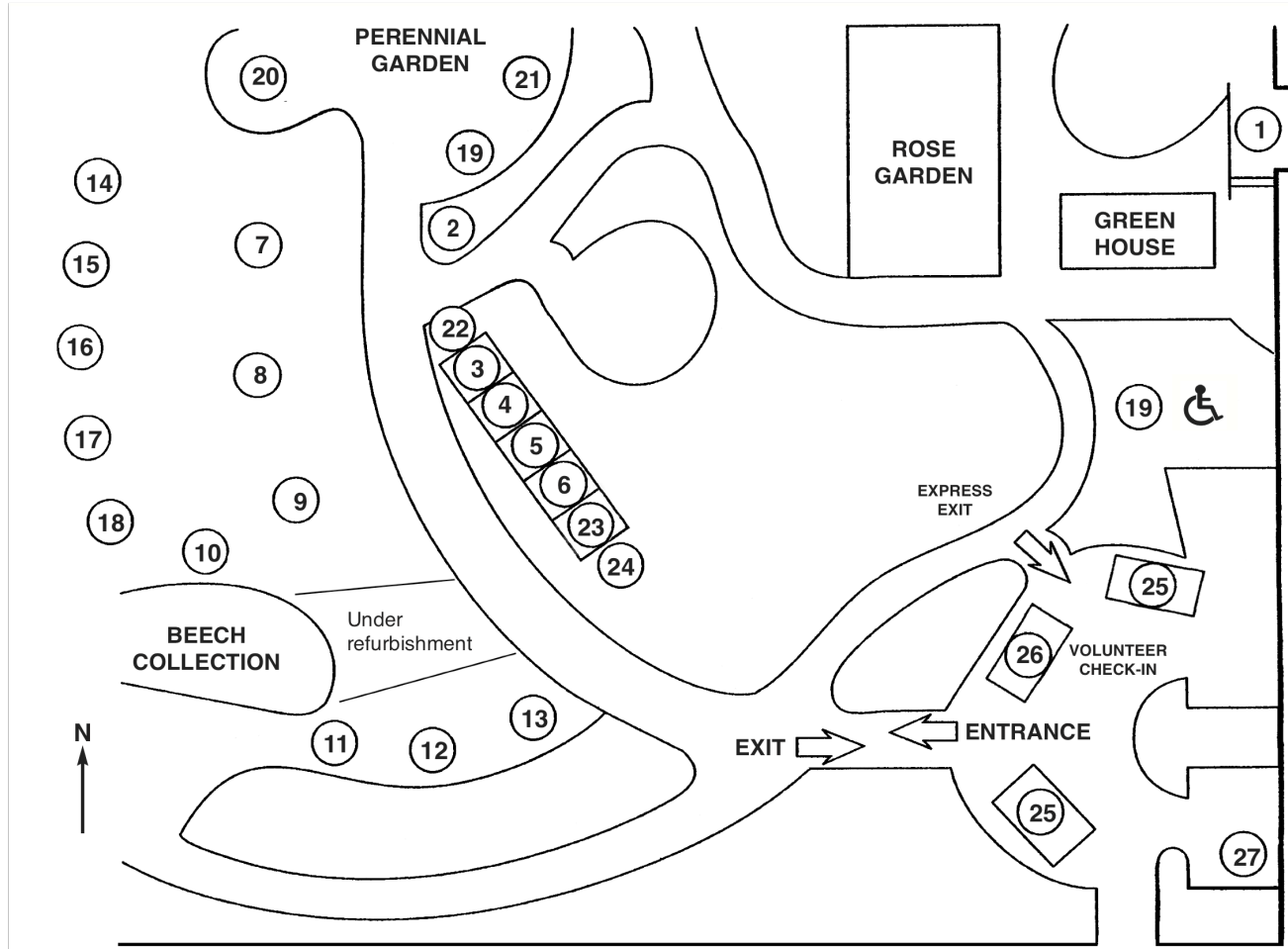

- 1 Visitor Centre, Guides
- Gift Shop, Truffles,
- Shaughnessy Restaurant
- 2 Seeds
- 3 Fuchsias
- 4 Orchids & Exotics
- 5 Geraniums
- 6 Succulents & Cacti
- 7 Rhododendrons
- 8 Pot Luck
- 9 Perennials/Grass/Ferns
- 10 PNW Natives
- 11 Trees & Shrubs
- 12 Fruit Trees & Berries
- 13 Tropicals
- 14 Vines
- 15 Herbs & Vegetables
- 16 Roses
- 17 Snow Mountain
- Organic Orchards
- 18 Mushrooms
- 19 Toilets
- 20 Food Vendors, Coffee
- 21 Plant Hold
- 22 Master Gardeners
- 23 Information, Membership
- 24 Food Vendors, Coffee
- 25 Exit - Cashiers
- MedTech EMS
- 26 Volunteer Check-In
- 27 Plant Check & Pickup

37th Avenue

Plant Hold (#21). Store your plants in this secure area while you continue to select plants or enjoy a stroll in the garden.

Plant Check and Pickup (#27). If you do not wish to carry your plants to your car, leave them in this secure area in the parking lot. Volunteers will give you a pass allowing you to bring your car into the parking lot. Trays, boxes and wheelbarrows are supplied to assist in carrying your purchases.