

Features

- NEW SUPER STREET 5-Speed with Overdrive
- Fully Rated at 600 ft. lbs. of torque
- Fits GM and Ford applications
- Features a Long Shifter for Performance & Durability
- Made in USA

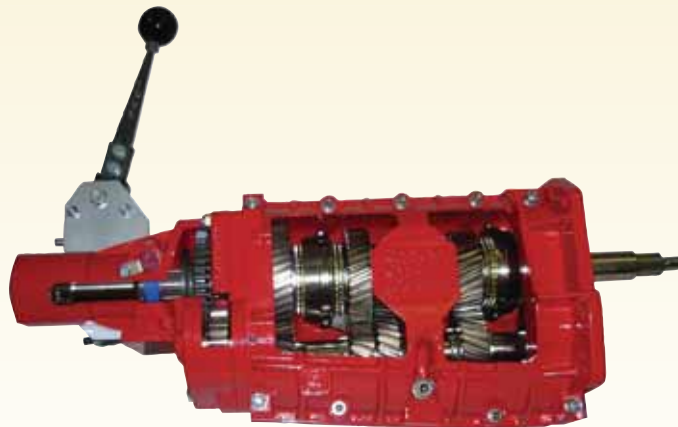

The SUPER STREET 5-Speed with Overdrive is the newest addition to the Richmond line of *Bullet Proof* transmissions. The SUPER STREET is fully rated at **600 ft. lbs. of torque** to confidently handle the demands of street performance, hot rods, muscle car, racing and other high performance applications.

Based on the successful Richmond NASCAR-type design and technology, the SUPER STREET is manufactured in the USA by skilled craftsmen using the best in CNC machining, gear cutting technology and race-proven in house treating. The transmission is built on the successful and dependable Richmond manual transmission housing. The design allows for more robust gears and components to give you the torque handling capacity higher horsepower cars require.

The SUPER STREET transmission comes complete with a Long Shifter for the ultimate in shift performance and durability. Designed to fit GM and Ford applications, the Richmond SUPER STREET is the answer for the performance enthusiasts who know that "Winners Run RICHMOND!"

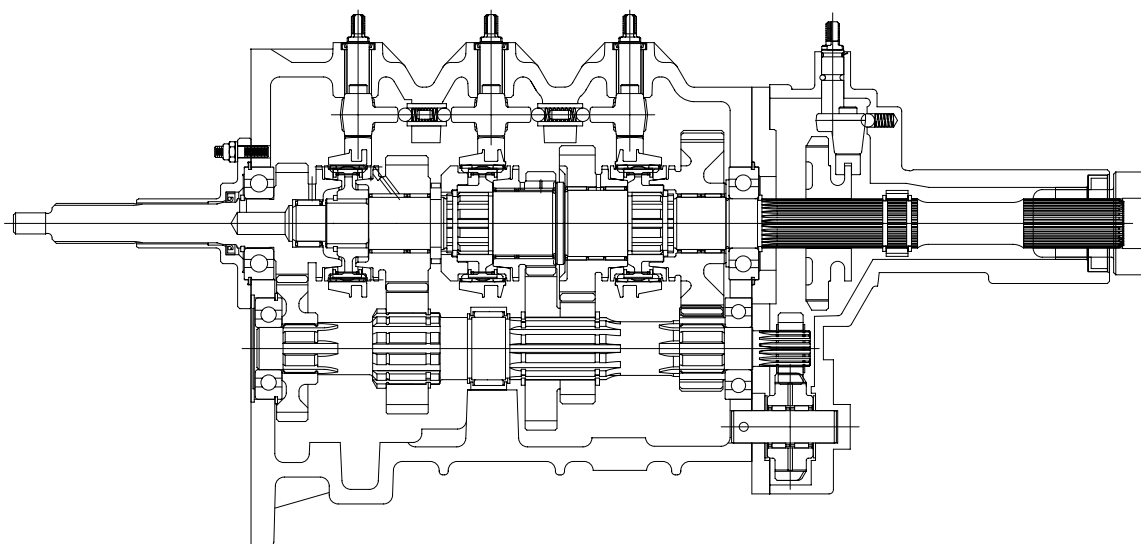

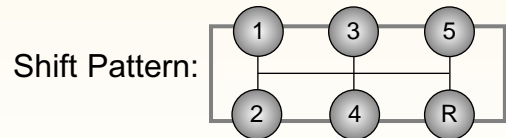
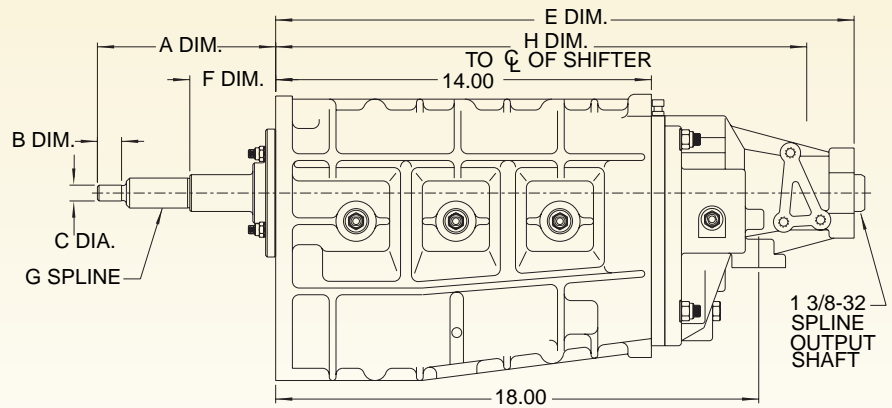
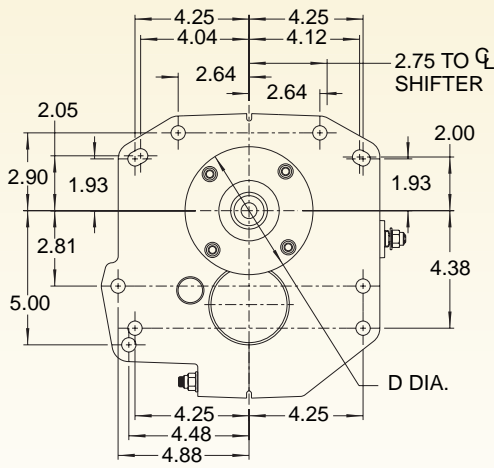

PART NUMBER AND MOUNTING SPECIFICATION GUIDE

APPLICATION	PART NO.	A DIM.	B DIM.	C DIA.	D DIA.	E DIM.	F DIM.	G SPLINE	H DIM.	J DIM.
GM 3.33 10-Spline*	7020510A	6.66	1.06	0.59	4.683	21.57	3.22	1 1/8-10	20.75	2.00
GM 2.89 10-Spline*	7020510B	6.66	1.06	0.59	4.683	21.57	3.22	1 1/8-10	20.75	2.00
GM 3.06 10-Spline*	7020510C	6.66	1.06	0.59	4.683	21.57	3.22	1 1/8-10	20.75	2.00
GM 3.33 26-Spline*	7020526A	6.66	1.06	0.59	4.683	21.57	3.22	1 1/8-10	20.75	2.00
GM 2.89 26-Spline*	7020526B	6.66	1.06	0.59	4.683	21.57	3.22	1 1/8-10	20.75	2.00
GM 3.06 26-Spline*	7020526C	6.66	1.06	0.59	4.683	21.57	3.22	1 1/8-10	20.75	2.00
Ford 3.33 10-Spline*	7040510A	7.18	1.14	0.668	4.849	24.00	4.37	1 1/16-10	20.75	2.00
Ford 2.89 10-Spline*	7040510B	7.18	1.14	0.668	4.849	24.00	4.37	1 1/16-10	20.75	2.00
Ford 3.06 10-Spline*	7040510C	7.18	1.14	0.668	4.849	24.00	4.37	1 1/16-10	20.75	2.00
Ford 3.33 26-Spline*(2)	7040526A	6.49	1.14	0.668	4.849	24.00	3.83	1 1/8-26	20.75	2.00
Ford 2.89 26-Spline*(2)	7040526B	6.49	1.14	0.668	4.849	24.00	3.83	1 1/8-26	20.75	2.00
Ford 3.06 26-Spline*(2)	7040526C	6.49	1.14	0.668	4.849	24.00	3.83	1 1/8-26	20.75	2.00
5.0 Mustang 3.33 (T-5), 10-Spline*(1)	7080510A	7.18	1.17	0.668	4.849	24.00	4.37	1 1/16-10	20.75	2.00
5.0 Mustang 2.89 (T-5), 10-Spline*(1)	7080510B	7.18	1.17	0.668	4.849	24.00	4.37	1 1/16-10	20.75	2.00
5.0 Mustang 3.06 (T-5), 10-Spline*(1)	7080510C	7.18	1.17	0.668	4.849	24.00	4.37	1 1/16-10	20.75	2.00
Corvette 3.33 26-Spline*	7070526A	6.66	1.06	0.59	4.683	23.50	3.22	1 1/8-26	22.38	2.00
Corvette 2.89 26-Spline*	7070526B	6.66	1.06	0.59	4.683	23.50	3.22	1 1/8-26	22.38	2.00
Corvette 3.06 26-Spline*	7070526C	6.66	1.06	0.59	4.683	23.50	3.22	1 1/8-26	22.38	2.00
GM 3.33 T-5*(3)	7050526A	6.66	1.06	0.59	4.683	24.00	3.22	1 1/8-26	23.25	1.50
GM 3.89 T-5*(3)	7050526B	6.66	1.06	0.59	4.683	24.00	3.22	1 1/8-26	23.25	1.50
GM 3.06 T-5*(3)	7050526C	6.66	1.06	0.59	4.683	24.00	3.22	1 1/8-26	23.25	1.50
MOPAR 3.33 18-Spline	7030518A	8.75	2.54	0.748	4.807	24.00	4.28	1 1/316-18	20.75	2.00
MOPAR 2.89 18-Spline	7030518B	8.75	2.54	0.748	4.807	24.00	4.28	1 1/316-18	20.75	2.00
MOPAR 3.06 18-Spline	7030518C	8.75	2.54	0.748	4.807	24.00	4.28	1 1/316-18	20.75	2.00

* With Long Shifter
 (1) 1984-1993 (5.0L) includes cross member and speedometer hook-up kit. Bellhousing must be replaced with Lakewood part # 15202, or equivalent. A 1979-1983 Mustang V-8 bellhousing may also be used
 (2) For small block engines. For big block engines, cut pilot (B dimension) by 0.38".
 (3) "F" body T-5 transmission comes with cross member, speedocable extension and special shifter for torque are hook-up



Always in stock at your local RICHMOND distributor



Phone: 864-843-9231 • Fax: 864-843-2964 • www.richmondgear.com

Input Sets & Selection Guide

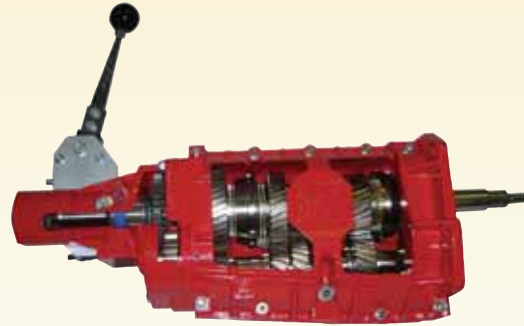

INPUT SETS

26/33 INPUT/CLUSTER	
GM 1-1/8" 26 Spline	4520526 / 5550533
GM 1-1/8" 10 Spline	4520510 / 5550533
Ford 1-1/8" 26 Spline	4540526 / 5550533
Ford 1-1/16" 10 Spline	4540510 / 5550533
Mopar 1-3/16" 18 Spline	4530518 / 5550533

TRANSMISSION PART NO. DESCRIPTION

Part no. (7 Digits) + Ratio Letter
Example 7020510A
 GM five speed 10 spline
 Input 3.33 or 7020510B

TRANSMISSION RATIO SELECTION GUIDE

			MASTER DRIVE SET		26/33
			DRIVE RATIO		1.269
GEAR	TOOTH COUNT	SET RATIO	MAINSHAFT GEAR	CLUSTER GEAR	RATIO
1st	42/16	2.625	1050542	1550516	3.33
	41/18	2.277	1050541	1550518	2.89
	41/17	2.411	1051541	1550517	3.06
2nd	35/24	1.458	2350535	2550524	1.85
3rd	30/29	1.034	2350530	2550529	1.31
4th	-	-	-	-	1.00
5th	22/36	.611	4150522	5150536	0.77

Use RICHMOND Transmission Lube Part # TLUBE (pg 126)

Performance Matched For WINNERS!

Center Distance	3.50 Inches
Oil Capacity	2 U.S Quarts
Approximate Dry Weight	106.5 lbs.
Case & Extension Housing	Aluminum
Controls	Side Lever



NEW Super Street 5-Speed with O.D.



Replacement Parts

For view number see drawing on page 53.

1ST GEAR (MAINSHAFT)

VIEW #	PART NO.	DESCRIPTION
1	1050542	42/16 Tooth Count
	1050541	41/18 Tooth Count
	1051541	41/17 Tooth Count

1ST GEAR (CLUSTERSHAFT)

VIEW #	PART NO.	DESCRIPTION
2	1550516	42/16 Tooth Count
	1550518	41/18 Tooth Count
	1550517	41/17 Tooth Count

2ND & 3RD GEAR (MAINSHAFT)

VIEW #	PART NO.	DESCRIPTION
3 & 5	2350535	35/24 Tooth Count
	2350530	30/29 Tooth Count

2ND & 3RD GEAR (CLUSTERSHAFT)

VIEW #	PART NO.	DESCRIPTION
6 & 8	2550524	35/24 Tooth Count
	2550529	30/29 Tooth Count

OVERDRIVE GEAR (MAINSHAFT)

VIEW #	PART NO.	DESCRIPTION
4	4150522	22/36 Tooth Count

OVERDRIVE GEAR (CLUSTERSHAFT)

VIEW #	PART NO.	DESCRIPTION
7	5150536	22/36 Tooth Count

INPUT SHAFT

VIEW #	PART NO.	DESCRIPTION
9	4520510	26/33
	4520526	26/33
	4540510	26/33
	4540526	26/33

INPUT DRIVE GEAR (CLUSTERSHAFT)

VIEW #	PART NO.	DESCRIPTION
10	5550533	26/33



Replacement Parts (con't)

For view number see drawing on page 53.

VIEW #	PART NO.	DESCRIPTION	VIEW #	PART NO.	DESCRIPTION
13	5271922	Reverse Idler Gear	51	6350005	Retainer O.D.
14	6560037	Reverse Mainshaft	52	8255132	Tailhousing Seal
15	5260013	Reverse Clustershaft Gear	53	8358112	Shift Arm Bushings 1-2, 3-4 & 5
16	1304093020	Keys (All)	54	1000127050	Tailhousing Bushing
17	4682AJ	Springs (All) (Not Shown)	55	1304110002	Speedo Gear (All)
18	1304091010	Synchro Brass 1-2 & O.D.	56	8622911	Front Bearing Retainer, GM (26T)
19	6460001	Synchro Brass 3 & 4		8644033	Front Bearing Retainer, Ford (26T)
20	6151600	Hub 1-2 & O.D.		8644035	Front Bearing Retainer, Ford (10T)
21	6150000	Hub 3 & 4		8635307	Front Bearing Retainer, Mopar (18T)
22	1304089006	Slider 1-2 & O.D.	57	6960000	Detent Kit
23	6520000	Slider 3 & 4	58	8060000	Small Parts Kit
24	6591600	Synchro Assem. 1-2	59	8260000	Case Plug Kit
25	6560002	Synchro Assem. 3 & 4		8260003P	Breather Assembly
26	1304096002	Shift Fork 1-2 & O.D.	60	9060000	Fastener Kit
27	6760000	Shift Fork 3 & 4	61	8180050	Tailhousing Gasket
28	T-1024	Shift Fork, Reverse	62	8260001	Shifter Arm Seal Kit
29	6660001	Shift Arm, Reverse	70	7899054	Overdrive Gear Bearing
30	6692012	Shift Arm 1-2	71	7899053	Overdrive Bearing
31	6650005	Shift Arm O.D.	72	8071400	Thrust Collar
32	6660050	Shift Arm 3 & 4	73	6350006	Thrust Ring Sleeve
33	7855112	Input I.D. Bearing	74	7899442	3rd Gear Bearing
34	7855716	Center Cluster Bearing	75	7855606	Rear Cluster Bearing
35	7855306	Front Cluster Bearing	76	6591601	Synchro Assy OD
36	1000130010	Front & Rear Mainshaft Bearing			
37	7871030	Rev. Idler Gear Bearing Assem.			
38	7871052	2nd Gear Bearing Assem. (Not Shown)			
39	7871142	1st Gear Bearing Assem. (Not Shown)			
40	7899142	3rd Gear Bearing			
42	8195086	Bearing Retainer Gasket (All)			
43	8225750	Input Seal, Ford, GM & Mopar			
	8245625	Input Seal, AMC			
44	103565	Taper Pin			
45	7168113	Maincase (2) Halves			
46	7226000	Tailhousing, GM			
	7246000	Tailhousing, Ford & Mopar			
	7276000	Tailhousing, Vette 4+3			
	7246001	Tailhousing, Mustang T-5 Rep.			
	7226001	Tailhousing, GM "F" Body, T-5 Rep.			
47	7360000	Mid-Plate			
48	7520532	Mainshaft, GM			
	7540532	Mainshaft, Ford, Mopar, Vette 4+3, GM T-5 Rep.			
49	7650000	Clustershaft (All)			
50	7760001	Rev. Idler Shaft			

ADDITIONAL ITEMS NOT SHOWN

PART NO.	DESCRIPTION
5980004	Reverse Back-Up Light Switch
5960000	Reverse Back-Up Switch Wire Harness
6360005-21	Ford/GM Speedo Adaptor Kit
15202	Ford Mustang "Lakewood" Steel Bellhousing (for T-5 replacement only with Richmond 5 or 6 speed)
Sy-1310	Slip Yoke Turbo 400
Sy-1330	Slip Yoke Turbo 400
6-SP 760003P	Breather
8260003-1	Vent
3630001	Ford Mustang Crossmember (T-5 replacement only)
9060026	Screw (Mustang T-5 replacement)
6360000	GM "F" Body Crossmember (T-5 replacement only)
6360002	Crossmember Spacer (Mustang T-5 replacement)
HR5000-0	5-Speed Shifter - All except GM T-5 replacement and Vette 4+3
HR5002-0	5-Speed Shifter (GM T-5 replacement only)
HR5003-0	5-Speed Shifter (Vette 4+3 replacement)



NEW Super Street 5-Speed with O.D.

**Richmond Super Street Five Speed with Overdrive
Exploded View:**

* USE SELECTIVE FIT DETENT SLAVES TO PROVIDE .001-.004 CLEARANCE OF SHIFT CAM STOP WHEN 1-2 OR 3-4 CAM IS ENGAGED

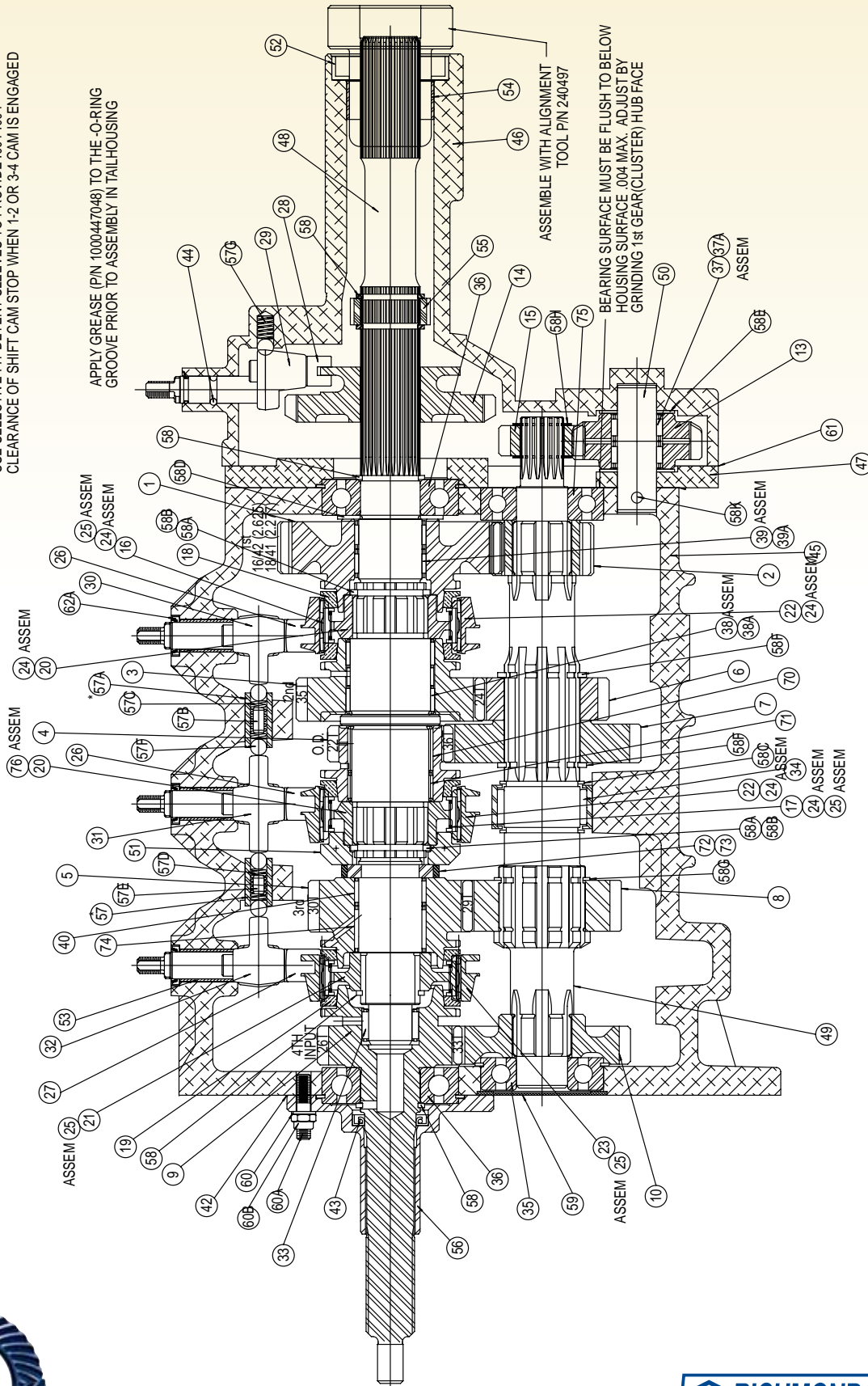

Always in stock at your local RICHMOND distributor

Phone: 864-843-9231 • Fax: 864-843-2964 • www.richmondgear.com