

Worksman Mover Industrial Tricycle Owner's Manual

Worksman Trading Corp - 94-15 100th Street - Ozone Park, NY 11416 - (888) 3-WHEELER or 718 322 2000

www.worksmancycles.com

Parts list M2020/26-08

Models M2020/26, M2020/26-NDB, M2020/26-CB, M2020/26-3CB

M2020/26=Drum Brake Only M2020/26-NDB=Coaster Brake Only M2020/26-CB=Drum & Coaster Brake M2020/26-3CB=Drum & 3 Spd Coaster



The Worksman Mover - The World's Finest Industrial Tricycle

Congratulations! You have purchased an American Made Worksman Mover Industrial Tricycle. The Mover is considered the flagship of the Worksman Business Cycle System, which is undoubtedly the finest line of industrial cycles. These durable tricycles are used around the world by leading companies and organizations to move personnel and supplies efficiently and safely in an environmentally friendly manner.

Before assembly and riding, make certain to read this manual and any other literature provided thoroughly. Always follow the rules of safe riding. Always keep your Mover Tricycle in tip-top shape by replacing worn parts as needed with genuine Worksman Cycles parts. (Do not use generic bicycle parts.) With simple maintenance, your Worksman Mover Tricycle will perform reliably day after day, year after year.

- *This manual is intended as an assembly and maintenance guideline for a professional and qualified bicycle mechanic. Failure to have this cycle professionally assembled could result in injury or death.*

Worksman Mover Parts List M2020/26-06 (For the entire M2020 and M2026 Series)

Frame, Fork and Related Parts

<u>Part #</u>	<u>Description</u>	<u>Part #</u>	<u>Description</u>
MF2020A	Mover 2020/2026 Frame (Specify color)	60STR	Fork Strap for Drum Brake
5020HD	Fork w/ Drum Brake Tab - Black	5020HD-YEL	Fork - w/ Drum Brake Tab - Safety Yel
5020HD-ORG	Fork w/ Drum Brake Tab - Safety Orange	5020HD-SP	Fork w/ Drum Brake Tab - Special color
48	Head Set Cups (pair)	49	Headset Bearings (pair)
50A	Headset Complete (48,49,52,53,54)	51	Bottom Cone (presses on Fork)
52	Top Adjusting Cone (threaded)	53	Key Washer
54	Fork Top Lock nut	55F	Handlebar-Junior High Rise
55H	Stem for Handlebar (Long for 2020/2026)	55B	Handgrips (pair)
3927M	Rear Platform		

Front Drum Brake Parts (Old style hubs have loose bearings. New style hub has pressed bearings.)

<u>Part #</u>	<u>Description</u>	<u>Part #</u>	<u>Description</u>
<u>OLD STYLE</u>			
L900	Drum Brake Hub	L709	Front Axle Set for Drum Brake
F817	Wheel Bearings - Loose 11 balls	L725	Drum Brake Plate Kit (Internal parts kit)
<u>NEW STYLE</u>			
L500-F	Hub - NEW STYLE w/ pressed bearing	L509	Axle - NEW STYLE for pressed bearing
L517	Pressed Bearing - NEW STYLE	L525	Drum Brake Plate Kit (NEW STYLE)
F719	Drum Brake Cable w/ F769 and F770	F816	Axle Washer
F769	Anchor Bolt Assembly for F719 Cable	F770	Adjusting Barrel for F719 Cable
L752R	Brake Lever (Right) w/ Parking Lock	160B	Fork Retention Clip (each)
L752L	Brake Lever (Left) w/ Parking Lock	L815	Outside Axle Nut (each)

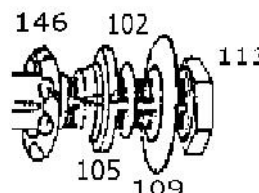
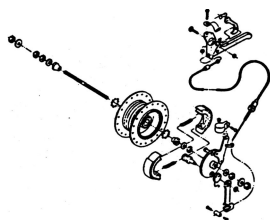

L900 Drum Brake- Exploded View with F719 Cable

Headset

Free Side Rear Wheel . Exploded View

Rear Axle and Related Parts

<u>Part #</u>	<u>Description</u>	<u>Part #</u>	<u>Description</u>
102	Key Washer	103	Cups for Free Side Hub
105	Adjusting Cone (threaded)	106	Stationary Cone (presses onto axle)
109	Dust Washer	113	Locknut - Left Hand Thread- Free Side)
146	Bearings (pair)	64M	Woodruff Key
59M	Locknut-Drive Side	132	Axle Parts Set (102,105,109,113,146,64M,59M)
M13966	Rear Axle	69	Fixed Drive Sprocket (CB, 3CB, NDB)
4129	Freewheel Sprocket . 22 tooth	63A	Bushing for 4129
63B	Set screw for 69 and 4129	63C	Keyway for Rear Sprocket
M13975	Side Bearing with Plate (each)	M13974	Center Axle Support Bearing
301M	Coaster Brake w/Dual Sprockets	404NM	3 Spd Coaster Brake w/ Dual Sprockets
SS721	Coaster Brake Internal Kit (for 301M)	SS13N-1	3 Speed Cable and Trigger for 404NM

Crank and Crank Parts (Pedal Section) and Chains (Chains shown are for 36 Tooth front sprocket.)

<u>Part #</u>	<u>Description</u>	<u>Part #</u>	<u>Description</u>
1265	Crank Parts (1266,1268,1269,1271,1272,1273,1274)	1265BMXS	Deluxe Sealed Crank Set (Upgrade)
1266	Crank Bearings (pair)	1267	Complete Crank Set 36T(1265,1275,1380D)
1267F	Complete Crank Set with 32 T Sprocket	1267H	Complete Crank Set with 28 T Sprocket
1268	Cups for crank housing (pair)	1269	Stationary washer (inside)
1271	Key Washer (outside)	1271	Key Washer (outside)
1272	Adjusting Cone (threaded, outside)	1273	Stationary Cone (inside)
1274	Crank Locknut	1275	Crank (one piece, forged - 6.5+)
1380D	Sprocket 36 Tooth	1380F	Sprocket 32 Tooth
1380H	Sprocket 28 Tooth	7217	Pedal Set (Pair) (Standard)
7218	Rat Trap Metal Pedal Set (Pair) (Upgrade)	4910M	Chainguard
4914A	Chain Connecting Link (1/2x3/16+)	4914U	Long Chain (2020-CB,3CB - 1/2x3/16x149 link)
4914UA	Long Chain (2026-CB,3CB - 1/2x3/16x151 link)	4914XX	Chain- Short (1/2x3/16x37 links)
4914T	Long Chain (1/2x3/16x135 links-Freewhl)	4915	Chain Adjusters (for Coaster Brake)

Note- The Mover comes standard with a 36T front sprocket and 1265 crank part set. Smaller sprockets in the front will reduce gear ratio, which makes it easier to start pedaling. The 1265BMXS is a sealed, heavier duty upgrade for crank parts.

Seats, Seatpost and Fenders, Baskets and Cabinets

<u>Part #</u>	<u>Description</u>	<u>Part #</u>	<u>Description</u>
6910V-5	Saddle (Padded w/ 5/8+clamp - standard)	6911V-5	Saddle (Padded w/ 5/8+clamp, springs)
4908M	Seatpost - Solid Steel	4909M	Square Head Bolt (Secures Seatpost)
M13970	Basket fits Rear Platform (23x23x12+)	M13E5	5+Platform Lip
M17350	Cabinet (23x22x11.5+)	M17350J	Jumbo Cabinet (23x22x18+)
7228	Front Wire Basket (21x15x9+w/ bracket)	139	Front Wire Basket (18x13x6+w/bracket)
8220	Front Fender	82K	Front Fender Hardware Kit (95, 4907, 4907A)
83A	Front Fender Brace	95	Front 1/2+Bracket (fender to fork)
4907	Bolts, nut, washer (for 83A Brace)	4907A	Bolt Set to attach 82 to fork
4902A	20+Side Fender (L or R)	M13995	20+Side Fender Brace (L or R)
4902	26+Side Fender (L or R)	M13996	26+Side Fender Brace (L or R)
4905	Bolt set (Side fender to top of brace)	4906	Bolt Set for bottom of M13996
MSF20	Complete 20+Side Fender Kit w/ braces	MSF26	Complete 26+Side Fender Kit w/ braces

Note- Movers come with a front fender as standard equipment. The side fender set maybe added as an option by ordering Part # MSF26. Baskets and Cabinets are optional.

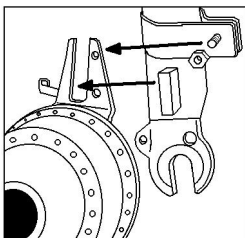

Drum Brake Fork Assembly



Seat



Rear Steel Basket



Rear 11+Steel Cabinet

Wheels and Tires (Left wheel is %Free.+ Right wheel is %Drive.+ Add "KVPR" to any wheel to get Kevlar tires and puncture resistant tubes!)

Part #	Description	Part #	Description
7720A	20+Front Wheel w/ Drum Brake w/o Tire	4130QA	20+Front Wheel w/o Drum Brake w/o Tire
7720	20+Front Wheel w/ Drum Brake w/Air Tire	4130Q	20+Front Wheel w/o Drum w/Air Tire
7720S	20+Front Wheel w/ Drum Brake w/Solid Tire	4130QS	20+Front Wheel w/o Drum w/Solid Tire
1008A	20+Free Side Wheel w/o Tire	M14022	20+Drive Side Wheel w/o Tire
1008	20+Free Side Wheel with Air Tire	M14023	20+Drive Side Wheel w/ Air Tire
1008S	20+Free Side Wheel with Solid Tire	M14024	20+Drive Side Wheel w/Solid Tire
8132SA	20+Free Side Mag Welded Wheel w/o Tire	8133MSA	20+Drive Side Mag Welded w/o Tire
8132	20+Free Side Mag Welded Wheel w/ Air tire	8133M	20+Drive Side Mag Welded w/ Air tire
8132S	20+Free Side Mag Welded Wheel w/ Solid tire	8133MS	20+Drive Side Mag Welded w/ Solid tire
78SA	26+Free Side Wheel w/o Tire	M14031	26+Drive Side Wheel w/o Tire
1007	26+Free Side Wheel with Air Tire	M14032	26+Drive Side Wheel w/ Air Tire
78S	26+Free Side Wheel with Solid Tire	M14032S	26+Drive Side Wheel w/Solid Tire
9178SA	26+Free Side Mag Welded Wheel w/o Tire	9179MSA	26+Drive Side Mag Welded w/o Tire
9178	26+Free Side Mag Welded Wheel w/ Air tire	9179M	26+Drive Side Mag Welded w/ Air tire
9178S	26+Free Side Mag Welded Wheel w/ Solid tire	9179MS	26+Drive Side Mag Welded w/ Solid tire
4922	Tire - 20x2.125+WTC Sup-r-Tire (standard)	4923	Tube - 20x2.125+(standard)
4922KV	Tire - 20x2.125+WTC KEVLAR Sup-r-Tire	6023	Tube - 20x2.125+Puncture Resistant
4922WSW	Tire - 20x2.125+Sup-r-Tire (White Wall)	4938A	Solid Rubber Nev-R-Fail Tire - 20+
49822BL	Tire - 20x1.95+Poly-Fill Non-Marking	4922GNM	Tire - 20x2.125+Grey Non-Marking
4922A	Tire - 26x2.125+WTC Sup-r-Tire (standard)	4923A	Tube - 26x2.125+(standard)
4922AKV	Tire - 26x2.125+WTC KEVLAR Sup-r-Tire	6023A	Tube - 26x2.125+Puncture Resistant
4922AWSW	Tire - 26x2.125+Sup-r-Tire (White Wall)	4939	Solid Rubber Nev-R-Fail Tire - 26+
49822A-BLK	Tire - 26x1.95+Poly-Fill Non-Marking		
101	Hub for Free Wheel w/ Cups	3980M	Hub for Drive Side Wheel
1017	26+Rim Strip	1017A	20+Rim Strip
1016	26+Rim Only (no spokes - outer rim only)	1015	20+Rim Only (no spokes - outer rim only)
1014A	Spoke (26+Rear)	1014XX	Spoke (20+Front w/ drum brake)
1014E	Spoke (20+Front w/o drum brake)	1014E	Spoke (20+Rear Wheel)

Safety and Comfort Accessories

Part #	Description	Part #	Description
3979	Ding Dong Chime Bell	303	Squeeze Bulb Horn
3973	Mega-Horn- Battery Operated- LOUD	201	Cable and Lock set
4963	Rear View Mirror	5030T	Reflector Set with Mounting Hardware
3978	Safety Flag on Pole	P19	Bicycle Helmet
P101710	Flashing Strobe Slight (Clear Lens)	P101714	Flashing Strobe Light (Red Lens)
7217-41197	Pedals with Velcro Foot Straps (Pair)	3975	Generator Light Set
1006	Air Pump for Tire Inflation (Manual)	1000	Spoke Tightening Tool
2000	Chain Rivet Remover Tool	1265TW	Crank Cone Wrench
1001	Pedal Wrench		

Key Component Exploded View of M2020/26 Series

Key #	Part #	Description
1	MF2020A	Frame
2	5020HD	Fork (or 6620HD for NDB Models)
3	55H	Stem for Handlebar- Long
4	L752L / L752R	Brake Hand Lever
5	7217	Pedal Set
6	8220	Front Fender
7	7720A*	Front Wheel w/Drum Brake
8	55F	Handlebar
9	55B	Hand Grips (pair)
10	4908M	Seatpost
11	6910V-5	Saddle (6911V-% w/ springs)
12	4910A	Chainguard
13	4914__	Chain (4914U-M2020-CB, 3CB) (4914UA-M2026-CB, 3CB, 4914T-Freewheel)
14	1267D	Sprocket & Crank Set 36T
15-16	69 / 4129	Fixed Drive Sprocket / Free wheel Sprkt
17	4914XX	Short Chain
18	301M or 404NM	Coaster Brake /or/ 3 Speed Coaster
20	4902	Side Fender(M2026)
or	4902A	Side fender (M2020)
22	M13975	Outer Axle Bearing Plate Assembly
24	69	Fixed Drive Sprocket for Rear Axle
25	M13966	Rear Axle
31	4909M	Bolt- Square Head for Seatpost

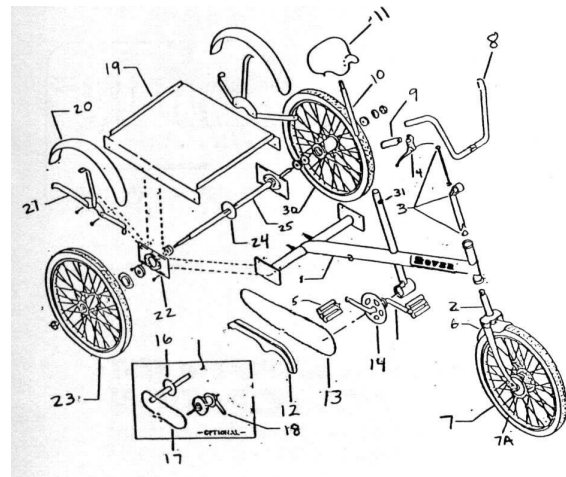

19	3927M	Rear Platform
21	M13996	Brace for Side Fender-M2026
or	M13995	Brace for Side fender-M2020
23	M14031*	Wheel-Drive Side 26+(M2026-Right)
or	M14022	Wheel-Drive Side 20+(M2020-Right)
28	132	Rear Axle Parts Set (Partial Image)

ASSEMBLY INSTRUCTIONS FOR THE WORKSMAN MOVER™ INDUSTRIAL TRICYCLE:

Your Worksmen Mover™ Industrial Tricycle has been hand made by American Craftspeople at our Ozone Park, New York City factory. We take great pride in each and every Worksmen Business Cycle that we manufacture and appreciate your support. Please read this manual carefully prior to performing the simple finishing assembly and prior to riding. Keep these instructions as our parts list is contained within this document which you will need for future reference.

Carefully remove the tricycle from the carton. You will notice the tricycle is mostly pre-assembled at the factory. Some finishing assembly is required.

The front wheel and the fork assembly is pre-assembled at the factory.

TO ATTACH FRONT FORK/WHEEL ASSEMBLY TO THE FRAME:

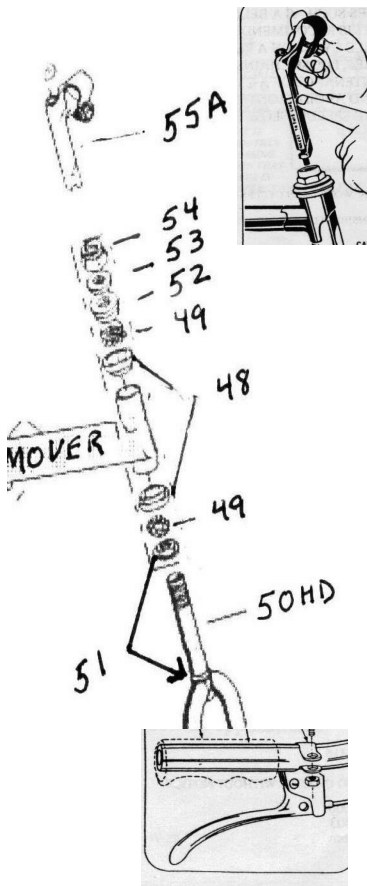

- 1) Grease cups (48) with Rustolene 200 lubricant or equal. Bearings (49) are pre-greased at the factory, but it is always a good idea to add lubrication prior to assembly.
- 2) Place one bearing (#49) onto the fork steering tube with the balls facing up.
- 3) Slide the threaded fork (50HD) steering tube into the frame head.
- 4) Place the other bearing on the top of the fork tube with the balls facing down towards the cup (#48), which is already pressed onto the frame.
- 5) Install the top adjusting cone (#52) onto the treaded fork steering tube. Hand-tighten, making certain the bearings do not bind. After hand tightening, turn back ¼ turn.
- 6) Install the fork key washer (#53) and reflector bracket (if reflectors were ordered) on top of the adjusting cone with tip of washer in slot on steering tube.
- 7) Install head lock nut (#54) and securely tighten. Make sure that the fork rotates freely without being loose. Excess play or resistance must be adjusted. Failure to adjust properly can lead to improper steering response.
- 8) Install handlebar stem (55A) into the fork steering tube with the handlebar clamp facing forward. The stem must be inserted far enough to reach the minimum insertion line. Tighten the stem bolt slightly at this point. Loosen the handlebar clamp nut and slide the handlebar through the clamp centering the knurled center section of the handlebar into the clamp. Position the handlebar to the desired angle and tighten clamp securely. Recommended torque is 300 IN. LBS. Adjust the handlebar rotation so that it is perpendicular to the front wheel when it is perfectly straight. Tighten stem bolt securely. Recommended torque 240 IN. LBS. Be sure not to over tighten as damage to the parts may occur causing steering failure.
- 9) Attach brake hand lever to the handlebar (either left or right depending upon the rider's preference) Make sure brake cable is not tangled in anyway.

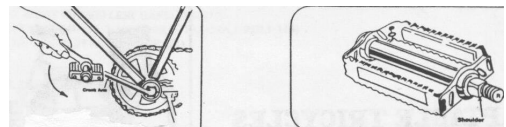

INSTALLING PEDALS:

Pedals are marked on the shaft with either an "L" or "R" denoting left or right. The "R" pedal fits on the right (sprocket side) of the crank arm. Tighten clockwise. The "L" pedal fits on the left side of the crank arm. Tighten counter-clockwise (left-hand thread). Securely tighten. Recommended torque 275 IN. LBS. *CAUTION: Tightening in the wrong direction will damage the crank and pedal threads.*

SEAT ADJUSTMENTS:

Although the seat is already installed at the factory, adjust the height to your desired level by loosening the seat clamp bolt at the top of the frame's seat tube. Re-tighten at desired height. Make sure a minimum of 3 1/2" of the post remains in the frame tube. Never adjust post above this level. Adjust angle of seat with nose raised slightly. Tighten seat clamp securely. (240 IN. LBS.)

REAR FENDERS:

Attach fender braces to fender, and fender braces to mounting bracket on frame using the provided nuts, bolts, and washers. Be sure to install the smaller fender brace in the middle. Bend braces slightly if tire is rubbing the brace.

MAINTENANCE TIPS:

Always inspect your Worksmen Cycle to ensure that all nuts, bolts, screws and hardware are tight and that no parts are worn or damaged. Do not attempt to straighten bent forks or frames.

Chain:

Lubricate chain once a month or as needed with light oil. Replace sprockets when teeth become worn, bent or broken. Keep chain adjusted so there is no more than 3/8" slack. Note that we make the chains tight at the factory, as we do know they will stretch during the break-in period.



Lubricate crank parts every six months. Replace pedals when the surface is worn or if axle becomes tight or frozen.

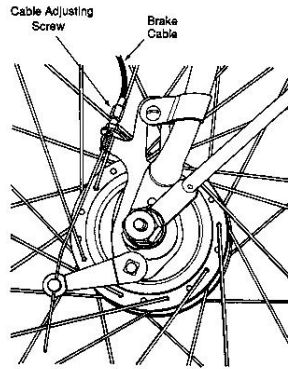

Drum Brake:

Your Worksmen Mover Tricycle may be equipped with an automotive type front drum brake. This brake is ideal for slowing your vehicle smoothly and reliably. It is engaged by squeezing the hand lever on the handlebar. To use Park+ feature, when cycle is completely stopped, squeeze hand lever and push in parking plunger button on lever. To disengage, simply squeeze lever until parking plunger button releases.

Drum brakes are pre-adjusted at the factory. Readjust the cable tension as necessary using the adjusting barrel so that wheel spins freely and stops when brake is applied. Always replace worn brake cables (F719) and damaged hand levers. Internal parts kits are available for your drum brake (L725 parts kits and L709 Axle set).

Coaster Brake (if applicable):

Foot activated coaster brakes are easy to use and reliable. To activate this internal brake, reverse the pedaling motion until the brake engages. To avoid skidding and maintain control, apply care when braking. This is especially true on wet surfaces. Apply brakes gently, gradually increasing pressure. Replace coaster brakes when they become worn. Check chain tension regularly. Coaster brake hubs may make a vibrating noise under braking until they are broken in. For three speed units, pause pedaling to help mesh gears. (Let the cycle coast.) This will make shifts smoother and will reduce wear and tear on the hub. Do not shift when pedals are not moving as damage could occur.

Tires:

Always check for worn or damaged tires. We recommend 40PSI as proper level of inflation. Replace tires that are worn or cut immediately. Replace or repair tubes that show leaks.

LIMITED WARRANTY:

This cycle is warranted against faulty parts under the following conditions: this warranty does not cover any failure due to accident, abuse, misuse, neglect or as the result of normal wear and tear, or improper assembly. The entire frame, including all welded joints, is warranted to be free from defects and material for one year while in possession of the original purchaser. All other parts on this cycle, except tires and tubes, are warranted for Ninety days from the date of purchase. Repair and replacement of these parts is to be according the Worksmen cycles parts and service procedures and must be handled directly through the source where the cycle was purchased. If upon examination of the parts in question, the Worksmen Cycle dealer determines that it is defective, either repair or replacement will be made at no cost except the cost of transportation and labor charges (if any). Unauthorized repairs or replacement automatically voids warranty. Proper maintenance is required for warranty to be valid. In the event that it was determined that the warranty claim is the result of misuse, abuse, improper maintenance or simply not defective or beyond the warranty period, Worksmen Cycles or the dealer will advise you as to the cost of repair, replacement or labor prior to performing any work or replacing any parts. If you choose not to have the dealer or Worksmen Cycles perform the work, the parts will be returned to you at your expense or discarded if no reply is received within 2 weeks of notification. The sole responsibility of the manufacturer to the terms of this warranty, if any, shall be the repair and/or replacement of the parts as indicated above. The liability of the manufacturer shall in no event exceed the original purchase price of the product, and the manufacturer shall not be responsible for any consequential damages of any nature, including, but not by way of limitation, damages for personal injury or property. This statement constitutes the exclusive expression of warranties by the manufacturer and is in lieu of any or all other warranties such as expressed warranties, implied warranties, including but not limited to warranties of merchantability, and fitness or purpose, are limited in duration for one year from the date of purchase of the frame only and 90 days for all other parts, except tires and tubes which are not warranted. Worksmen Trading Corporation is the manufacturer. Misuse of the cycles including off road riding, installation of motors or power assists, alterations, repairs using parts other than genuine Worksmen Cycle parts voids warranty. Worksmen Trading Corporation is not responsible for maintaining records of serial numbers. Void where prohibited by state law.

MAINTENANCE LOG

DATE MAINTAINED	MAINTENANCE PERFORMED

RULES FOR SAFE RIDING AND RESPONSIBLE OPERATION: Carefully read this manual before operating the cycle.

- It is the responsibility of the person who completes the assembly to properly install all parts included and to inspect the cycle prior to riding to insure proper operation.
- Operator is responsible for required maintenance to keep the cycle in good operation condition.
- Observe all traffic regulations in the operating environment. (Stop signs, etc.)
- Keep to the right and in a straight line. Ride in single file.
- Do not ride outdoors at night, and have appropriate signaling device as needed. (We recommend the 3973 Mega Horn.)
- Give pedestrians the Right of Way
- Always look around you to understand the riding environment and hazards.
- Do not carry passengers.
- Check brakes prior to riding.
- Slow down when approaching turns or intersections. Tricycles are meant for slow pace rides, not for racing.
- Use proper hand signals when turning or stopping.
- Recommended safety options include, but are not limited to, an approved helmet, audible warning device, front/rear lights and/or reflectors.
- Never ride the cycle if there are known repairs required.
- Do not exceed the recommended weight capacity of the cycle. (450 lbs., including the rider.)
- Place loads evenly on platform. Do not stack cargo too high and always secure cargo with appropriate tie down straps.
- Wipe surface of cycle clean and dry when exposed to corrosive substances or environment.
- Operate cycle at slow speeds, particularly in high traffic areas.
- Operators of cycles should be in good physical condition. Ride at your own risk.
- Wear proper riding attire. Check shoelaces and pant legs prior to riding so they do not become engaged in the chain and sprocket.
- Ride only on smooth, paved surfaces. Do not use off road.
- Do not operate a tricycle on steep grades. They are designed for relatively level, paved surfaces only.
- Always replace worn parts with genuine Worksmen Cycle Repair Parts.
- Always keep both hands on the handlebars. Tricycles have a tendency to pull slightly to one side.

HERE ARE SOME OTHER EXCITING PRODUCTS FROM WORKSMAN CYCLES...

Worksmen Front-Loaders



Worksmen Executive Trike



Worksmen Movers



Worksmen Heavy-Duty Industrial and Recreational Bicycles



Worksmen Recreational Tricycles



800BUYCART.com Vending Carts



Worksmen Trading Corporation . 94-15 100th Street . Ozone Park, NY 11416 . (718) 322-2000

www.worksmancycles.com

Parts list M2020/26-08

FAX THIS COMPLETED REGISTRATION FORM TO 718-529-4803 OR MAIL TO THE ADDRESS ABOVE:

Name of Purchaser: _____ Company Name: _____
Mailing Address: _____
Tel: _____
Fax: _____
Email: _____
Date of Purchase: _____
Dealer Name: _____
Address of Dealer: _____

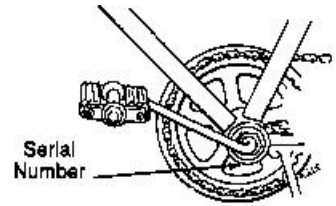

Serial Number (located under crank housing): _____ Color _____

NOTES

SIGNATURE: _____ DATE: _____



Worksmen Business Cycles are hard at work at most of the World's most respected companies. Worksmen Business Cycles are on the job 24-7/365 at this facility and many others around the world. Worksmen Business Cycles have set the industry standard for over a century!



How do Worksmen Business Cycles really help your business?

When you need an efficient method of transportation to move personnel around a large facility, the solution is simple! Many of the World's largest companies already know that Worksmen Business Cycles are the low cost alternative to motorized vehicles. They also realize that workers who spend time walking around a factory or warehouse are simply not as productive as they could be.

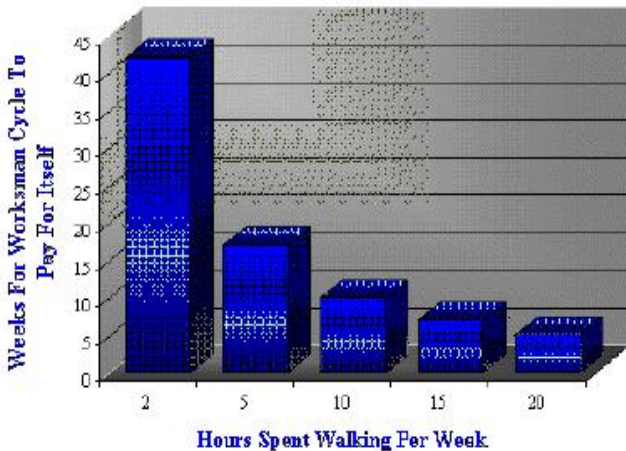

The simple chart above illustrates how Worksmen Business Cycles pay for themselves in a very short period of time when productivity gains are considered. The chart is actually conservative, but Worksmen Business Cycles are about far more than economics. Workers who ride them benefit through aerobic exercise and a healthier environment in which to work. People actually enjoy riding them, which often leads to improved worker morale. When you consider load carrying capacity, Worksmen Business Cycles are a great choice. Just think of how tired you would be walking on concrete floors, back and forth, often carrying tools or supplies.

Worksmen Business Cycles are ideal for and used in:

- *Warehouses
- *Factories
- *Campuses
- *Universities
- *Resorts
- *Refineries
- *Distribution Centers
- *Airports
- *Movie Studios
- *Mills
- *Chemical Plants
- *Amusement Parks
- *Delivery Services
- *Hospitals

Visit us online at www.worksmancycles.com or call us at 888-3WHEELER!