



ActronAir[®]

Australian for air conditioning[™]



Wall Hung Split Systems
Variable Capacity

Pages 4-5



Split Ducted
Standard Cycling

Pages 6-11



Split Ducted
Variable Capacity

Pages 12-15



Split Ducted
Tri-Capacity

Pages 16-17



Add On Air Conditioning

Pages 18-19



Package Units
Standard Cycling

Pages 20-21



Package Units
Tri-Capacity

Pages 22-23



Controls

Page 24



Accessories

Page 25



The ActronAir range of air conditioners provides a solution for most applications. On the following pages, you'll get a thorough overview of each model along with its capabilities.

From domestic to commercial applications – you'll find the detail you need to pinpoint which ActronAir system is most appropriate for your needs.

And when you choose the comfort of an ActronAir system, you have the latest, most innovative technology at your fingertips.

Innovation



Variable Capacity
Ability to vary the capacity of a compressor, allowing better temperature control and operating costs, whilst reducing energy consumption.



Variable Fan Technology
Adjusts the airflow based on the requirements of each zone



Variable Air Volume Technology
Delivers individual temperature zone control in up to 8 zones

Durability



Louvre Grille
External louvre grille protection for improved durability



Coil Protection
An external coil protection for improved durability and corrosion resistance

Performance



Vertical Discharge
Enables installation in confined space & minimises re-circulated air



Multi-Directional Air Flow
4-way automatic multi-directional airflow for improved air circulation.



Follow Me
'Follow Me' function uses remote control as a secondary temperature sensor for improved temperature control.



Sleep Mode
Sleep Program automatically adjusts temperature for better comfort during sleep time.



Turbo
Turbo function delivers faster cooling or heating.

Indoor Fan Type



Centrifugal Fan
Centrifugal forward curved fan for optimum air movement



ECM Fan
Centrifugal forward curved fan that uses an EC (Electronic Commutated) motor for superior air movement control, improved energy efficiency and easier commissioning



EC Plug Fan
Centrifugal backward curved fan that uses an EC (Electronic Commutated) motor for improved energy efficiency, faster commissioning and flexibility in air handling options

Electrical



Single Phase Electrical Supply
230V Power Supply with Neutral and Earth connections



Three Phase Electrical Supply
400V Power Supply with Neutral and Earth connections

Compressors



Scroll Compressor
Axial and radial compliant scroll compressor for improved performance and durability



Digital Scroll Compressor
Variable capacity compressor ranging from 10% to 100% for improved comfort control and energy efficiency



Tri-capacity Scroll Compressors
Used in commercial air conditioners, allowing 3 capacity stages (~33%, 66% and 100% compressor capacity) for improved building load matching and efficiency



Inverter Rotary Compressor
Rotary compressor for reliable operation all year round.

Outdoor Fan Type



Low Noise Axial Fan
Low noise Axial Fan for quieter operation

Wall Hung Split System Operating Range



Designed to keep operating at temperatures of -15°C to 50°C

Ducted System Operating Range



Engineered using high efficiency heat exchangers and superior components to deliver an operating range of -10 to 50°C



Engineered using high efficiency heat exchangers and superior components to deliver an operating range of -10 to 52°C

“Cool.”



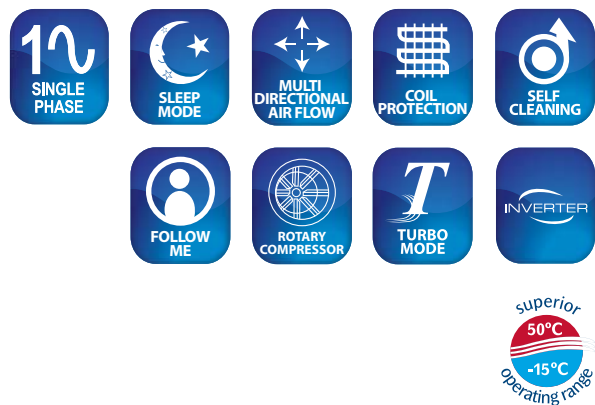

Features & Benefits

- Reverse cycle wall split system
- Superior operating range:
Cooling: up to 50°C DB
Heating: down to -15°C DB
- Quiet Operation
- Auto Restart
- Turbo Mode
- 24 hour timer on/off
- 4-way automatic multi-directional airflow*
- Adjustable airflow (SWA09 model only)
- HEPA Filter

- Dry mode operation
- Sleep program
- Fan Speed Auto, Low, Med, High
- Follow Me Function
- Powder Coated Panels
- Hydrophilic Indoor and Outdoor Coil protection
- Self Clean Function
- Conformal Coated PCB

*This feature is available for the SWA12/SWA18 and SWA24 models only.



Technical Information						
OUTDOOR MODEL		SWA09C	SWA12C	SWA18C	SWA24C	SWA28C
INDOOR MODEL		SWA09E	SWA12E	SWA18E	SWA24E	SWA28E
Nett (Rated) Capacity (kW) (AS/NZS3823.1.2)	Cooling (min-max)	2.40 (0.85-3.70)	3.30 (1.40-4.85)	5.00 (2.60-6.10)	6.40 (3.50-7.60)	7.60 (3.90-8.30)
	Heating (min-max)	2.50 (1.15-4.30)	3.30 (1.50-5.05)	5.30 (2.70-6.50)	7.00 (3.20-8.60)	8.50 (4.40-9.00)
Input Power (kW) (AS/NZS3823.1.2)	Cooling (min-max)	0.65 (0.22-1.42)	0.89 (0.32-1.61)	1.52 (0.53-2.21)	1.97 (0.82-2.57)	2.34 (1.15-2.60)
	Heating (min-max)	0.66 (0.26-1.55)	0.87 (0.36-1.58)	1.54 (0.49-2.01)	2.12 (0.80-2.70)	2.58 (1.05-2.80)
² EER Rated (AS/NZS3823.1.2)	Cooling	3.69	3.71	3.29	3.25	3.25
³ COP Rated (AS/NZS3823.1.2)	Heating	3.79	3.79	3.44	3.30	3.29
Power Supply (V / Ph / Hz)		220-240V / 1Ph + N / 50Hz				
Rated Load Amps (AS/NZS3823.1.2)	Rated (min-max)	3.21 (1.1-6.2)	4.30 (1.5-7.0)	6.96 (2.4-9.8)	9.02 (3.6-11.4)	10.80 (5.0-11.5)
Full Load Amps (AS/NZS3823.1.2)		9.5	12.0	13.5	16.5	16.5
Moisture Removal (L/hr)		1.0	1.2	1.7	2.3	2.8
Wiring Method ^a		10A 3 Pin Plug (to Indoor)	15A 3 Pin Plug (to Indoor)	15A 3 Pin Plug (to Indoor)	Hard Wire (to Outdoor)	Hard Wire (to Outdoor)
Suggested Minimum Mains Cable Size ^a		2.5mm ² (10A GPO)	2.5mm ² (15A GPO)	2.5mm ² (15A GPO)	2.5mm ²	2.5mm ²
Suggested Minimum Indoor to Outdoor Cable Size		1mm ² (4 Core)	1.5mm ² (4 Core)	1.5mm ² (4 Core)	1mm ² (5 Core)	1mm ² (5 Core)
IP Rating	Outdoor	IP24	IP24	IP24	IP24	IP24
	Indoor	IPX0	IPX0	IPX0	IPX0	IPX0
Compressor	Type / No. per unit Starting Method	Rotary / 1 DC Inverter Starting				
Capacity Range	Cooling	35-155%	40-145%	50-120%	55-120%	50-110%
	Heating	45-170%	45-155%	50-120%	45-120%	50-105%
Refrigerant		R410a				
Fans (Type x Number per unit)	Outdoor	Axial / 6 Pole / Direct Drive x 1				
	Indoor	Centrifugal / 4 Pole / Direct Drive x 1 (PULSE)	Centrifugal / 4 Pole / Direct Drive x 1			
Airflow Range Indoor (l/s)	Maximum	158	192	345	345	417
	Nominal	144	183	310	310	375
	Minimum	133	172	290	290	278
Outdoor Dimensions (mm)	Depth	285	285	320	315	315
	Height	590	590	700	860	860
	Width	760	760	845	900	900
Indoor Dimensions (mm)	Depth	165	200	221	221	258
	Height	290	295	320	320	340
	Width	850	995	1084	1084	1186
Outdoor Operating Range (°C)	Cooling	0 to 50				
	Heating	-15 to 34				
Nominal Weight (kgs)	Outdoor	37	41	51	76	76
	Indoor	11	14	18	18	22
Indoor Sound Pressure Level (Hi/Mi/Lo)	dB(A)	35 / 30 / 23	38 / 32 / 25	48 / 42 / 36	48 / 43 / 37	50 / 45 / 36
Sound Pressure Level (dB(A) at 1m		51 / 53	54 / 56	55 / 57	58 / 60	58 / 61
⁷ Sound Power Level (dB(A)	Outdoor (Low/High Fan)	60 / 62	63 / 65	66 / 68	67 / 70	67 / 70
MEPS Certified		Yes	Yes	Yes	Yes	Yes

Control Features						
OUTDOOR MODEL		SWA09C	SWA12C	SWA18C	SWA24C	SWA28C
INDOOR MODEL		SWA09E	SWA12E	SWA18E	SWA24E	SWA28E
Star Rating - Cooling		★★★★	★★★★	★★★★☆	★★★★	★★★★
Star Rating - Heating		★★★★	★★★★	★★★★☆	★★★★☆	★★★★
Remote Controller		RG35-A	RG35	RG35	RG35	RG35
Follow Me Function		Yes	Yes	Yes	Yes	Yes
Sleep Program		Yes	Yes	Yes	Yes	Yes
Turbo Mode		Yes	Yes	Yes	Yes	Yes
Self Clean Function		Yes	Yes	Yes	Yes	Yes
Timer On/Off		Yes	Yes	Yes	Yes	Yes
Dehumidification		Yes	Yes	Yes	Yes	Yes
4-way Automatic Multi-directional Airflow						
Vertical auto-swing (up/down)		Motorised Manual	Motorised	Motorised	Motorised	Motorised
Horizontal auto-swing (left/right)		Yes	Yes	Yes	Yes	Yes
Hydrophilic Aluminium Coil Protection	Indoor	Yes	Yes	Yes	Yes	Yes
	Outdoor	Yes	Yes	Yes	Yes	Yes

Options and Accessories						
Wired Controller**		Yes	Yes	Yes	Yes	Yes

Field Piping and Connections						
Refrigerant Charge	Factory Charge - (g)	1070	1200	1650	2200	2430
	Pre-Charge Length - (m)	5	5	5	5	5
	Additional Refrigerant Charge - (g/m)	20	20	40	40	40
Maximum Field Pipe Length Range - (m)		20	20	20	25	25
Maximum Vertical Height Differential (m) included in max length		8	8	8	10	10
Field Pipe Size	Liquid Pipe - mm (inch)	6.35 (1/4")	6.35 (1/4")	6.35 (1/4")	9.52 (3/8")	9.52 (3/8")
	Gas Pipe - mm (inch)	9.52 (3/8")	12.7 (1/2")	12.7 (1/2")	15.88 (5/8")	15.88 (5/8")
Outdoor Unit Connections	Liquid Pipe - mm (inch)	6.35 (1/4")	6.35 (1/4")	6.35 (1/4")	9.52 (3/8")	9.52 (3/8")
	Gas Pipe - mm (inch)	9.52 (3/8")	12.7 (1/2")	12.7 (1/2")	15.88 (5/8")	15.88 (5/8")
Indoor Unit Connections	Liquid Pipe - mm (inch)	6.35 (1/4")	6.35 (1/4")	6.35 (1/4")	9.52 (3/8")	9.52 (3/8")
	Gas Pipe - mm (inch)	9.52 (3/8")	12.7 (1/2")	12.7 (1/2")	15.88 (5/8")	15.88 (5/8")

⁶ Units supplied prior to February 2012 have 15 Amp/SAA Plugs.
* For more information refer to Controls and Accessories section.
0-13 Please see Product Foot Notes on Page 24-25





Features & Benefits

- Reverse cycle ducted split system
- Fixed speed – 100% capacity operation
- Superior operating range:
Cooling: up to 50°C DB
Heating: down to -10°C DB
- Zoning capability up to 8 zones
- Louvre grille protection
- Powder coated outdoor panels to withstand 1000-hour salt spray exposure AS/NZS 4506:2005
- 3 speed indoor fan with electronic commutated motor
- Vertical condenser air discharge (except for SRE091C)
- Slimline 24hr 8 zone wall controller included
- Manual inputs available for 3rd party control
- MEPS compliant



Technical Information					
OUTDOOR MODEL		SRE091C	SRA131C	SRA151C	SRA171C
INDOOR MODEL		SRG091E	SRG131E	SRG151E	SRG171E
¹ Total (Gross) Capacity (kW) (AS/NZS3823.1.2)	Cooling	9.40	12.75	15.29	17.38
	Heating	8.00	11.69	14.84	17.02
Nett (Rated) Capacity (kW) (AS/NZS3823.1.2)	Cooling	9.00	12.24	14.97	16.80
	Heating	8.50	12.17	15.12	17.57
Input Power (kW) (AS/NZS3823.1.2)	Cooling	2.77	3.75	4.56	5.15
	Heating	2.43	3.34	4.16	4.76
² EER Rated (AS/NZS3823.1.2)	Cooling	3.25	3.26	3.28	3.26
³ COP Rated (AS/NZS3823.1.2)	Heating	3.50	3.64	3.63	3.69
Power Supply (V / Ph / Hz)	Outdoor	230V / 1Ph + N / 50Hz			
	Indoor	230V / 1Ph + N / 50Hz			
Rated Load Amps (AS/NZS3823.1.2)	Outdoor / Indoor / Total	9.5 / 2.8 / 12.3	13.9 / 3.8 / 17.7	17.7 / 2.5 / 20.2	19.7 / 4.3 / 24.0
Full Load Amps (AS/NZS3823.1.2)	Outdoor / Indoor / Total	14.2 / 3.5 / 17.7	23.1 / 4.3 / 27.4	24.0 / 4.3 / 28.3	30.7 / 4.3 / 35.0
⁴ Circuit Breaker Amps (Suggested)		20.0	32.0	32.0	40.0
IP Rating	Outdoor	IP44			
	Indoor	IP20			
Compressor	Type / No. per Unit	Compliant Scroll / 1			
	Starting Method	Soft Starter			
No. Refrigeration Circuits/No. Capacity Stages (Capacity range)		1/1 (100% capacity)			
Refrigerant		R410a			
Fans (Type x Number per unit)	Outdoor	Axial x 1	Axial / 6 Pole External Rotor / Direct Drive x 2		
	Indoor	Single Deck Centrifugal / ECM Direct Drive x 1	Twin Deck Centrifugal / ECM Direct Drive x 1		
Airflow Range Indoor (l/s)	Maximum	520	750	880	900
	Nominal	450	650	770	850
	Minimum	380	590	690	770
External Static Pressure (Pa) at:	Maximum Airflow	108	120	120	116
	Nominal Airflow	153	206	218	164
Outdoor Dimensions (mm)	Depth	370	580	580	580
	Height	805	990	990	1045
	Width	1000	1320	1320	1460
Indoor Dimensions (mm)	Depth	595	615	615	615
	Height	410	412	412	412
	Width	850	1090	1290	1290
⁵ Nominal Weight (kgs)	Outdoor	83	135	136	176
	Indoor	41	56	59	60
⁶ Sound Pressure Level (dBA)	Outdoor (low/high fan)	50 / 52	50 / 52	50 / 52	52 / 54
⁷ Sound Power Level (dBA)	Outdoor (low/high fan)	67 / 69	67 / 69	67 / 69	69 / 71
MEPS Certified		Yes	Yes	Yes	Yes

Control Features					
LM7 Wall Controller (8 Zone)	Included	Included	Included	Included	Included
LM24 Wall Controller (8 Zone) - Secondary Master Controller	Optional	Optional	Optional	Optional	Optional
Remote Temperature Sensor	Optional	Optional	Optional	Optional	Optional
Home Automation ON / OFF Capability	Yes	Yes	Yes	Yes	Yes
Manual Inputs Capable for Third Party Control	Optional	Optional	Optional	Optional	Optional
Maximum Number of Zones	8	8	8	8	8

Options & Accessories					
OUTDOOR MODEL		SRE091C	SRA131C	SRA151C	SRA171C
INDOOR MODEL		SRG091E	SRG131E	SRG151E	SRG171E
Two Piece Fan Coil	Coil Section Model	–	SRA131A	SRA151A	SRA171A
	Fan Section Model	–	SRG131F	SRG151F	SRG171F
Compressor Soft Start - Included		Yes	Yes	Yes	Yes
Indoor Drain Kit (ADRKT) - Included		Yes	Yes	Yes	Yes
Indoor Unit Integral Fan Coil Safety Tray - Included		Yes	Yes	Yes	Yes
Optional Outdoor Drain Tray - Model		CDT11	CDT20	CDT20	CDT22
Hanging Kits (AHKFC)		Optional			
Duct Plates*		–	PLDP - 2/350 PLDP - 2/400	PLDP - 2/400	
				PL18R - 2/35S PL20R - 2/40S	
Return Air Plenum*		PL11R - 1/40S	PL13R - 2/35S	PL18R - 2/35S PL20R - 2/40S	
				PL18S - 2/35S PL20S - 2/40S	
Supply Air Plenum*	1-Way	PL11S - 1/35S		–	
	2-Way	PL11S - 2/30S PL11S - 2/35S		PL18S - 2/30S PL20S - 2/40S	
	3-Way	–	–	PL13S - 3/30S PL18S - 3/35S PL20S - 3/SPS	

Variations					
B - 3rd Party Manual Input (Indoor Unit)	Optional	Optional	Optional	Optional	Optional
H - Horizontal Discharge Fan (Outdoor Unit)	Standard	Optional	Optional	Optional	Optional
K - Coil Protection (Outdoor Unit)	Optional	Optional	Optional	Optional	Optional
R - ⁸ Demand Response Capability (AS4755.3)	Optional	Optional	Optional	Optional	Optional
V - Upright Fan Coil Vertical Discharge (Fan Coil Unit)	Optional	Optional	Optional	Optional	Optional
Z - Compressor Soft Starter (Outdoor Unit)	⁹ Standard	⁹ Standard	⁹ Standard	⁹ Standard	⁹ Standard

Field Piping and Connections					
Refrigerant Charge	Factory Charge - (g)	not pre-charged	5450	4650	6650
	Pre-Charge Length - (m)	0 ^a	15	15	15
	Additional Refrigerant Charge - (g/m)	50 ^a	50	50	50
Maximum Field Pipe Length Range - (m)		0 - 25	0 - 60	0 - 60	0 - 60
Maximum Vertical Height Differential - (m) included in max length		20	20	20	20
Field Pipe Size	Liquid Pipe - mm (inch)	9.52 (3/8)	9.52 (3/8)	9.52 (3/8)	9.52 (3/8)
	Gas Pipe - mm (inch)	15.90 (5/8)	15.90 (5/8)	19.05 (3/4)	19.05 (3/4)
Outdoor Unit	Liquid Pipe - mm (inch)	9.52 (3/8) swaged	9.52 (3/8) swaged	9.52 (3/8) swaged	9.52 (3/8) swaged
	Gas Pipe - mm (inch)	15.90 (5/8) swaged	19.05 (3/4) cut swage end	19.05 (3/4) swaged	19.05 (3/4) swaged
Indoor Unit	Liquid Pipe - mm (inch)	9.52 (3/8) to be cut and swaged in the field	9.52 (3/8) swaged	9.52 (3/8) swaged	9.52 (3/8) swaged
	Gas Pipe - mm (inch)	15.90 (5/8) swaged	19.05 (3/4) swaged	19.05 (3/4) swaged	19.05 (3/4) swaged
Condensate Drain Connection - Size		20mm OD			
Safety Tray Connection - Size		20mm ID			
Air Duct (Flange Connection)	Supply Duct H x W - (mm)	170 x 235 (no flange)	300 x 715		
	Return Duct H x W - (mm)	340 x 660	340 x 900	340 x 1100	

^aRefer to installation instruction for gas charge information.
*For more information refer to Controls and Accessories section. 0-10 Please see Product Foot Notes on Page 24-25





Features & Benefits

- Reverse cycle ducted split system
- Fixed speed – 100% capacity operation
- Superior operating range:
 - Cooling: up to 50°C DB
 - Heating: down to -10°C DB
- Zoning capability up to 8 zones
- Louvre grille protection
- Powder coated outdoor panels to withstand 1000-hour salt spray exposure AS/NZS 4506:2005
- 3 speed indoor fan with electronic commutated motor (except SRA230 & SRA260)
- Vertical condenser air discharge
- Slimline 24hr 8 zone wall controller included
- Manual inputs available for 3rd party control
- MEPS compliant



Technical Information							
OUTDOOR MODEL		SRA133C	SRA153C	SRA173C	SRA203C	SRA230C	SRA260C
INDOOR MODEL		SRG131E	SRG151E	SRG171E	SRG201E	SRA230E	SRA260E
¹ Total (Gross) Capacity (kW) (AS/NZS3823.1.2)	Cooling	13.00	15.27	17.56	19.69	23.48	25.15
	Heating	11.85	14.45	17.38	18.75	21.82	24.30
Nett (Rated) Capacity (kW) (AS/NZS3823.1.2)	Cooling	12.40	14.68	16.99	19.06	22.50	24.00
	Heating	12.30	15.00	17.92	19.34	23.00	25.50
Input Power (kW) (AS/NZS3823.1.2)	Cooling	3.68	4.43	5.04	5.86	7.14	7.65
	Heating	3.24	3.95	4.58	5.23	6.67	7.55
² EER Rated (AS/NZS3823.1.2)	Cooling	3.37	3.31	3.37	3.25	3.15	3.14
³ COP Rated (AS/NZS3823.1.2)	Heating	3.80	3.80	3.91	3.70	3.45	3.38
Power Supply (V / Ph / Hz)	Outdoor	400V / 3Ph + N / 50Hz					
	Indoor	230V / 1Ph + N / 50Hz					
Rated Load Amps (AS/NZS3823.1.2)	Outdoor / Indoor / Total	6.3 / 3.2 / 9.5	7.1 / 4.2 / 11.3	8.7 / 4.1 / 12.8	9.0 / 4.5 / 13.5	13.5 / 4.4 / 17.9	13.7 / 4.6 / 18.3
Full Load Amps (AS/NZS3823.1.2)	Outdoor / Indoor / Total	8.3 / 4.3 / 12.6	11.7 / 4.3 / 16.0	12.3 / 4.3 / 16.6	13.9 / 5.9 / 19.8	15.8 / 4.9 / 20.7	18.6 / 4.9 / 23.5
⁴ Circuit Breaker Amps (Suggested)		16.0	20.0	20.0	20.0	25.0	25.0
IP Rating	Outdoor	IP44					
	Indoor	IP20					
Compressor	Type / No. per Unit	Compliant Scroll / 1					
	Starting Method	D.O.L.					
No. of refrigeration Circuits/No of capacity stages (Capacity range)		1/1 (100% capacity)					
Refrigerant		R410a					
Fans (Type x Number per unit)	Outdoor	Axial / 6 Pole External Rotor / Direct Drive x 2					
	Indoor	Twin Deck Centrifugal / ECM Direct Drive x 1			Twin Deck Centrifugal / 4 Pole / Direct Drive x 1		
Airflow Range Indoor (l/s)	Maximum	750	880	900	1150	1380	1452
	Nominal	650	770	850	1000	1200	1320
	Minimum	590	690	770	900	1020	1122
External Static Pressure (Pa) at:	Maximum Airflow	120	120	116	146	175	135
	Nominal Airflow	206	218	164	188	235	200
Outdoor Dimensions (mm)	Depth	580	580	580	580	685	
	Height	990	990	1045	1045	1105	
	Width	1320	1320	1460	1460	1685	
Indoor Dimensions (mm)	Depth	615	615	615	680	695	
	Height	412	412	412	435	485	
	Width	1090	1290	1290	1420	1470	
⁵ Nominal Weight (kgs)	Outdoor	133	135	174	185	200	245
	Indoor	56	59	60	76	90	90
⁶ Sound Pressure Level (dBA)	Outdoor (low/high fan)	50 / 52	50 / 52	52 / 54	52 / 54	55 / 59	55 / 59
⁷ Sound Power Level (dBA)	Outdoor (low/high fan)	67 / 69	67 / 69	69 / 71	69 / 71	71 / 75	71 / 75
MEPS Certified		Yes	Yes	Yes	Yes	Yes	Yes

Control Features							
LM7 Wall Controller (8 Zone)	Included	Included	Included	Included	Included	Included	Included
LM24 Wall Controller (8 Zone) - Secondary Master Controller	Optional	Optional	Optional	Optional	Optional	Optional	Optional
Remote Temperature Sensor	Optional	Optional	Optional	Optional	Optional	Optional	Optional
Home Automation ON / OFF Capability	Yes	Yes	Yes	Yes	Yes	Yes	Yes
Manual Inputs Capable for Third Party Control	Optional	Optional	Optional	Optional	Optional	Optional	Optional
Maximum Number of Zones	8	8	8	8	8	8	8

Options & Accessories							
OUTDOOR MODEL		SRA133C	SRA153C	SRA173C	SRA203C	SRA230C	SRA260C
INDOOR MODEL		SRG131E	SRG151E	SRG171E	SRG201E	SRA230E	SRA260E
Two Piece Fan Coil	Coil Section Model	SRA131A	SRA151A	SRA171A	SRA201A	SRA230A	-
	Fan Section Model	SRG131F	SRG151F	SRG171F	SRG201F	SRA230F	-
Compressor Soft Start - Included		Optional	Optional	Optional	Optional	Optional	Optional
Indoor Drain Kit (ADRKT) - Included		Yes	Yes	Yes	Yes	No	No
Indoor Unit Integral Fan Coil Safety Tray - Included		Yes	Yes	Yes	Yes	Yes	Yes
Optional Outdoor Drain Tray - Model		CDT20	CDT20	CDT22	CDT22	CDT35	CDT35
Hanging Kit (AHKFC)		Optional				Standard	
Duct Plates*	PLDP - 2/350	PLDP - 2/400		PLDS - 2/400		PLDT - 2/450	-
	PLDP - 2/400	PL18R - 2/35S		PL19R - 2/40S		PL25R - 2/45S	
Return Air Plenum*	PL13R - 2/35S	PL18S - 2/35S		PL19R - 2/45S		PL25R - 2/45S	
		PL20R - 2/40S		PL19R - 2/45S		PL25R - 2/45S	
Supply Air Plenum*	2-Way	PL18S - 2/35S				PL34S - 2/45S	
		PL20S - 2/40S				PL22S - 3/35S	
	3-Way	PL13S - 3/30S				PL30S - 3/40S	
		PL18S - 3/35S				PL34S - 3/45S	
				PL20S - 3/SPS			

Variations						
B - 3rd Party Manual Input (Indoor Unit)	Optional	Optional	Optional	Optional	-	-
D - Fault Detection (Outdoor Unit)	-	-	-	-	Optional	Optional
H - Horizontal Discharge Fan (Outdoor Unit)	Optional	Optional	Optional	Optional	Optional	Optional
K - Coil Protection (Outdoor Unit)	Optional	Optional	Optional	Optional	Optional	Optional
R - Demand Response Capability (AS4755.3)	Optional	Optional	Optional	Optional	Optional	Optional
V - Upright Fan Coil Vertical Discharge (Fan Coil Unit)	Optional	Optional	Optional	Optional	Optional	Optional
Z - Compressor Soft Starter (Outdoor Unit)	Optional	Optional	Optional	Optional	Optional	Optional

Field Piping and Connections							
Refrigerant Charge	Factory Charge - (g)	5250	4650	7350	7450	8050	10100
	Pre-Charge Length - (m)	15	15	15	15	10	10
	Additional Refrigerant Charge - (g/m)	50	50	50	50	100	100
Maximum Field Pipe Length Range - (m)	0 - 60	0 - 60	0 - 60	0 - 20	20 - 60	0 - 60	0 - 60
Maximum Vertical Height Differential - (m) included in max length	20	20	20	20	20	20	20
Field Pipe Size	Liquid Pipe - mm (inch)	9.52 (3/8)	9.52 (3/8)	9.52 (3/8)	9.52 (3/8)	12.70 (1/2)	12.70 (1/2)
	Gas Pipe - mm (inch)	19.05 (3/4)	19.05 (3/4)	19.05 (3/4)	22.22 (7/8)	22.22 (7/8)	25.40 (1)
Outdoor Unit	Liquid Pipe - mm (inch)	9.52 (3/8) swaged	9.52 (3/8) swaged	9.52 (3/8) swaged	9.52 (3/8) swaged	12.70 (1/2) cut swage end	15.90 (5/8) swaged
	Gas Pipe - mm (inch)	19.05 (3/4) swaged	19.05 (3/4) swaged	19.05 (3/4) swaged	22.22 (7/8) swaged	22.22 (7/8) swaged	28.6 (1-1/8) ID to fit field pipe
Indoor Unit	Liquid Pipe - mm (inch)	9.52 (3/8) swaged	9.52 (3/8) swaged	9.52 (3/8) swaged	9.52 (3/8) swaged	12.70 (1/2) cut swage end	15.90 (5/8) swaged
	Gas Pipe - mm (inch)	19.05 (3/4) swaged	19.05 (3/4) swaged	19.05 (3/4) swaged	22.22 (7/8) swaged	22.22 (7/8) swaged	25.40 (1) to be swaged in field
Condensate Drain Connection - Size	20mm OD			20mm ID		25mm ID	
Safety Tray Connection - Size	20mm ID			20mm ID		25mm ID	
Air Duct (Flange Connection)	Supply Duct H x W - (mm)	300 x 715				380 x 825	
	Return Duct H x W - (mm)	340 x 900	340 x 1100	360 x 1140	410 x 1190		

*For more information refer to Controls and Accessories section. 0-10 Please see Product Foot Notes on Page 24-25



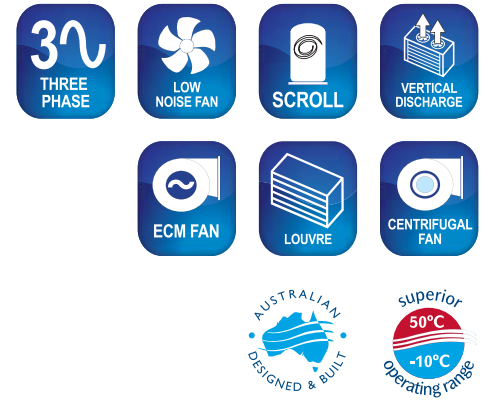

Features & Benefits

- Reverse cycle ducted split system
- Fixed speed – 100% capacity operation
- Superior operating range:
 - Cooling: up to 50°C DB
 - Heating: down to -10°C DB
- Two speed outdoor fan
- Indoor fan three speed - SCA series
- Indoor fan dial no air-flow adjustment - SCG series
- Single stage or two stage refrigeration circuits
- Interlaced evaporator coil for full face cooling on two stage systems
- Louvre grille protection
- Powder coated outdoor panels to withstand 1000-hour salt spray exposure AS/NZS 4506:2005
- Vertical condenser air discharge
- Optional C7-4 controller available
- Manual inputs available for 3rd party control
- MEPS compliant



Technical Information

OUTDOOR MODEL		SCA290C	SCA330C	SCA300C	SCA340C	SCA400C
INDOOR MODEL		SCG290E	SCA330E	SCA300E	SCA340E	SCG400E
¹ Total (Gross) Capacity (kW) (AS/NZS3823.1.2)	Cooling	29.50	34.66	28.90	35.22	40.80
	Heating	27.40	32.73	27.30	33.78	37.85
Nett (Rated) Capacity (kW) (AS/NZS3823.1.2)	Cooling	28.30	33.00	27.70	33.50	39.20
	Heating	28.60	34.50	28.50	35.50	39.50
Input Power (kW) (AS/NZS3823.1.2)	Cooling	8.45	10.48	8.50	10.55	12.76
	Heating	7.97	10.30	8.72	10.37	11.97
² EER Rated (AS/NZS3823.1.2)	Cooling	3.35	3.15	3.26	3.18	3.07
³ COP Rated (AS/NZS3823.1.2)	Heating	3.59	3.35	3.27	3.42	3.30
Power Supply (V / Ph / Hz)	Outdoor	400 - 415V / 3Ph + N / 50Hz				
	Indoor	230 - 240V / 1Ph + N / 50Hz				
Rated Load Amps (AS/NZS3823.1.2)	Outdoor / Indoor / Total	16.1 / 8.4 / 24.5	16.7 / 6.6 / 23.3	14.6 / 5.5 / 20.1	16.5 / 6.9 / 23.4	25.7 / 10.5 / 36.2
Full Load Amps (AS/NZS3823.1.2)	Outdoor / Indoor / Total	19.5 / 11.4 / 30.9	22.6 / 7.1 / 29.7	21.0 / 7.1 / 27.1	24.3 / 7.1 / 31.4	31.9 / 14.5 / 46.4
⁴ Circuit Breaker Amps (Suggested)		32.0	32.0	32.0	32.0	50.0
IP Rating	Outdoor	IP44				
	Indoor	IP20				
Compressor	Type / No. per Unit	Scroll / 1		Scroll / 2		
	Starting Method	D.O.L.		D.O.L.		
No. Refrigeration Circuits/No. Capacity Stages (Capacity range)		1/1(100%)		2/2(50%, 100%)		
Refrigerant		R410a				
Fans (Type x Number per unit)	Outdoor	Axial / 6 Pole External Rotor / Direct Drive x 2				
	Indoor	Twin Deck Centrifugal / ECM Direct Drive x 1	Twin Deck Centrifugal / 4 Pole / Direct Drive x 1			Twin Deck Centrifugal / ECM Direct Drive x 1
Airflow Range Indoor (l/s)	Maximum	1650	1892	1650	1892	2250
	Nominal	1500	1720	1500	1720	2050
	Minimum	1275	1462	1275	1462	1750
External Static Pressure (Pa) at:	Maximum Airflow	266	132	185	132	170
	Nominal Airflow	285	205	240	205	236
Outdoor Dimensions (mm)	Depth	875				
	Height	1330				
	Width	1875				
Indoor Dimensions (mm)	Depth	770				
	Height	535	620	535	620	680
	Width	1530	1735	1530	1735	1910
⁵ Nominal Weight (kgs)	Outdoor	290	305	300	335	332
	Indoor	110	125	115	130	125
⁶ Sound Pressure Level (dBA)	Outdoor (low/high fan)	55.9 / 59.9	57.8 / 61.8	55.9 / 59.9	57.8 / 61.8	61.0 / 64.0
⁷ Sound Power Level (dBA)	Outdoor (low/high fan)	72.9 / 76.9	74.8 / 78.8	72.9 / 76.9	74.8 / 78.8	78.0 / 81.0
MEPS Certified		Yes	Yes	Yes	Yes	Yes

Control Features

Control Feature	SCA290C	SCA330C	SCA300C	SCA340C	SCA400C
C7-4 Wall Controller (BCA Compliant)	Optional	Optional	Optional	Optional	Optional
Secondary Master Controller	No	No	No	No	No
Remote Temperature Sensor	Optional	Optional	Optional	Optional	Optional
Home Automation ON / OFF Capability	Optional	Optional	Optional	Optional	Optional
Manual Inputs Capable for Third Party Control	Optional	Optional	Optional	Optional	Optional
Maximum Number of Zones	4	4	4	4	4

Variations

OUTDOOR MODEL	SCA290C	SCA330C	SCA300C	SCA340C	SCA400C
INDOOR MODEL	SCG290E	SCA330E	SCA300E	SCA340E	SCG400E
D - Fault Detection (Outdoor Unit)	Optional	Optional	Optional	Optional	Optional
H - Horizontal Discharge Fan (Upright Indoor Unit)	Optional	Optional	Optional	Optional	Optional
H - Horizontal Discharge Fan (Outdoor Unit)	Optional	Optional	Optional	Optional	Optional
K- Coil Protection (Outdoor Unit)	Optional	Optional	Optional	Optional	Optional
R - ⁸ Demand Response Capability (AS4755.3)	Optional	Optional	Optional	Optional	Optional
V - Upright Fan Coil Vertical Discharge (Indoor Unit)	Optional	Optional	Optional	Optional	Optional
Z - Compressor 3-Phase Soft Starter (Outdoor Unit)	Optional	Optional	Optional	Optional	Optional

Field Piping and Connections

Refrigerant Charge	Factory Charge - (g)	11,050	12,800	2 x 4,725	2 x 7,050	2 x 7,850
Pre-Charge Length - (m)		5	5	5	5	5
	Additional Refrigerant Charge - (g/m)	165	165	50 per stage	50 per stage	100 per stage
Maximum Field Pipe Length Range - (m)		0 - 60	0 - 60	0 - 60	0 - 60	0 - 60
Maximum Vertical Height Differential - (m) included in max length		20	20	20	20	20
Field Pipe Size	Liquid Pipe - mm (inch)	15.9 (5/8)	15.9 (5/8)	9.52 (3/8)	9.52 (3/8)	12.70 (1/2)
	Gas Pipe - mm (inch)	28.6 (1-1/8)	28.6 (1-1/8)	19.05 (3/4)	19.05 (3/4)	22.22 (7/8)
Outdoor Unit	Liquid Pipe - mm (inch)	15.9 (5/8) swaged	15.9 (5/8) swaged	9.52 (3/8) swaged	9.52 (3/8) swaged	12.70 (1/2) swaged
	Gas Pipe - mm (inch)	28.6 (1-1/8) swaged	28.6 (1-1/8) swaged	19.05 (3/4) swaged	19.05 (3/4) swaged	22.22 (7/8) swaged
Indoor Unit	Liquid Pipe - mm (inch)	15.9 (5/8) swaged	15.9 (5/8) swaged	9.52 (3/8) swaged	9.52 (3/8) swaged	12.70 (1/2) swaged
	Gas Pipe - mm (inch)	28.6 (1-1/8) swaged	28.6 (1-1/8) swaged	22.22 (7/8) cut-off swage	22.22 (7/8) cut-off swage	22.22 (7/8) swaged
Condensate Drain Connection - Size		25mm ID				25.4mm ID BSP Female Thread
Safety Tray Connection - Size		25mm ID				25.4mm ID BSP Socket
Air Duct (Flange Connection)	Supply Duct H x W - (mm)	370 x 1065				
	Return Duct H x W - (mm)	435 x 1200	520 x 1440	435 x 1200	520 x 1440	575 x 1595

0-10 Please see Product Foot Notes on Page 24-25





Features & Benefits

- Award winning reverse cycle ducted split system
- Variable Fan Technology (VFT) to deliver improved energy efficiency and lower indoor noise
- High efficiency ECM indoor fan
- Variable capacity digital scroll compressor 10 to 100% operation
- Quick and precise temperature control
- Superior operating range:
Cooling: up to 50°C DB
Heating: down to -10°C DB
- Louvre grille protection
- Powder coated outdoor panels to withstand 1000-hour salt spray exposure AS/NZS 4506:2005
- Vertical condenser air discharge
- Sound Reduction System (SRS)
- Slimline 7 day 8 zone wall controller included
- Manual inputs available for 3rd party on/off control
- Three phase sequence relay
- MEPS compliant



Technical Information

		Single Phase			Three Phase		
OUTDOOR MODEL		SRD131C	SRD151C	SRD191C	SRD173C	SRD203C	SRD230C
INDOOR MODEL		SRV131E	SRV151E	SRV191E	SRV171E	SRV201E	SRV230E
¹ Total (Gross) Capacity (kW) (AS/NZS3823.1.2)	Cooling	12.75	14.67	19.33	17.45	20.10	23.59
	Heating	11.71	14.64	17.90	17.39	19.38	22.97
Nett (Rated) Capacity (kW) (AS/NZS3823.1.2)	Cooling (min - max)	12.27 (1.23-12.27)	14.37 (1.44-14.37)	18.64 (1.86-18.64)	16.88 (1.69-16.88)	19.32 (1.93-19.32)	23.00 (2.30-23.00)
	Heating (min - max)	12.16 (2.31-12.16)	15.00 (2.85-15.00)	18.52 (3.52-18.52)	17.93 (3.41-17.93)	20.09 (3.82-20.9)	23.50 (4.47-23.50)
Input Power (kW) (AS/NZS3823.1.2)	Cooling	3.68	4.29	5.73	5.02	5.78	6.76
	Heating	3.30	4.49	5.33	4.81	5.24	6.91
² EER Rated (AS/NZS3823.1.2)	Cooling	3.33	3.35	3.25	3.36	3.34	3.40
³ COP Rated (AS/NZS3823.1.2)	Heating	3.68	3.34	3.47	3.73	3.83	3.40
Power Supply (V / Ph / Hz)	Outdoor	230V / 1Ph + N / 50Hz			400V / 3Ph + N / 50Hz		
	Indoor	230V / 1Ph + N / 50Hz					
Rated Load Amps (AS/NZS3823.1.2)	Outdoor / Indoor / Total	13.5 / 3.6 / 17.1	17.5 / 2.3 / 19.8	20.8 / 5.1 / 25.9	8.7 / 4.1 / 12.8	9.2 / 5.4 / 14.6	14.0 / 4.0 / 18.0
Full Load Amps (AS/NZS3823.1.2)	Outdoor / Indoor / Total	23.6 / 4.3 / 27.9	27.1 / 4.3 / 31.4	32.5 / 5.4 / 37.9	12.3 / 4.3 / 16.6	13.5 / 5.9 / 19.4	16.2 / 4.9 / 21.1
⁴ Circuit Breaker Amps (Suggested)		32.0	32.0	40.0	20.0	20.0	25.0
IP Rating	Outdoor	IP44					
	Indoor	IP20					
Compressor	Type / No. per Unit	Digital Scroll / 1					
	Starting Method	Soft Starter			D.O.L.		
No. of refrigeration Circuits/No of capacity stages (Capacity range)		1/ Variable (10-100% capacity)					
Refrigerant		R410a					
Fans (Type x Number per unit)	Outdoor	Axial / 6 Pole External Rotor / Direct Drive x 2					
	Indoor	Twin Deck Centrifugal / ECM Direct Drive x 1					
Airflow Range Indoor (l/s)	Maximum	780	880	1180	900	1200	1440
	Nominal	650	770	980	850	1000	1200
	Minimum	130	155	195	170	200	240
External Static Pressure (Pa) at:	Maximum Airflow	120	120	128	116	120	80
	Nominal Airflow	225	218	192	164	188	170
Outdoor Dimensions (mm)	Depth	580	580	580	580	580	685
	Height	990	990	1045	1045	1045	1105
	Width	1320	1320	1460	1460	1460	1685
Indoor Dimensions (mm)	Depth	615	615	680	615	680	695
	Height	412	412	435	412	435	485
	Width	1090	1290	1420	1290	1420	1470
⁵ Nominal Weight (kgs)	Outdoor	135	136	190	176	185	220
	Indoor	58	61	76	62	76	90
⁶ Sound Pressure Level (dBA)	Outdoor (low/high fan)	47 / 50	50 / 52	52 / 54	52 / 54	52 / 54	54 / 59
⁷ Sound Power Level (dBA)	Outdoor (low/high fan)	64 / 67	67 / 69	69 / 71	69 / 71	69 / 71	70 / 75
MEPS Certified		Yes	Yes	Yes	Yes	Yes	Yes

Control Features

	Included	Included	Included	Included	Included	Included
LM7-D Wall Controller (8 Zone)	Included	Included	Included	Included	Included	Included
LM24 Wall Controller (8 Zone) - Secondary Master Controller	Optional	Optional	Optional	Optional	Optional	Optional
Remote Temperature Sensor	Optional	Optional	Optional	Optional	Optional	Optional
Home Automation ON / OFF Capability	Yes	Yes	Yes	Yes	Yes	Yes
Maximum Number of Zones	8	8	8	8	8	8

Options & Accessories

		Single Phase			Three Phase		
OUTDOOR MODEL		SRD131C	SRD151C	SRD191C	SRD173C	SRD203C	SRD230C
INDOOR MODEL		SRV131E	SRV151E	SRV191E	SRV171E	SRV201E	SRV230E
Two Piece Fan Coil	Coil Selection Model	-	-	SRV191A	-	SRV201A	-
	Fan Selection Model	-	-	SRV191F	-	SRV201F	-
Compressor Soft Start - Included		Yes	Yes	Yes	Optional	Optional	Optional
Indoor Drain Kit (ADRKT) - Included		Yes	Yes	Yes	Yes	Yes	No
Indoor Unit Integral Fan Coil Safety Tray - Included		Yes	Yes	Yes	Yes	Yes	Yes
Optional Outdoor Drain Tray - Model		CDT20	CDT20	CDT22	CDT22	CDT22	CDT35
Hanging Kit (AHKFC)		Optional					
Duct Plate*		-	-	PLDS - 2/400	-	PLDS - 2/400	-
Return Air Plenum*	PL13R - 2/35S	PL18R - 2/35S	PL19R - 2/40S	PL18R - 2/35S	PL19R - 2/40S	PL19R - 2/45S	PL25R - 2/45S
		PL20R - 2/40S	PL19R - 2/45S	PL20R - 2/40S	PL19R - 2/45S		
Supply Air Plenum*	2-Way	PL18S - 2/35S					PL34S - 2/45S
		PL20S - 2/40S					
	3-Way	PL13S - 3/30S					PL22S - 3/35S
		PL18S - 3/35S					PL30S - 3/40S
		PL20S - 3/SPS					PL34S - 3/45S

Variations

	Optional	Optional	Optional	Optional	Optional	Optional
H - Horizontal Discharge Fan (Outdoor Unit)	Optional	Optional	Optional	Optional	Optional	Optional
K - Coil Protection (Outdoor Unit)	Optional	Optional	Optional	Optional	Optional	Optional
R - ⁸ Demand Response Capability (AS4755.3)	Optional	Optional	Optional	Optional	Optional	Optional
V - Upright Fan Coil Vertical Discharge (Indoor Unit)	Optional	Optional	Optional	Optional	Optional	Optional
Z - Compressor Soft Starter (Outdoor Unit)	⁹ Standard	⁹ Standard	⁹ Standard	Optional	Optional	Optional

Field Piping and Connections

		5150	4850	7950	7050	7450	9700
Refrigerant Charge	Factory Charge - (g)	5150	4850	7950	7050	7450	9700
	Pre-Charge Length - (m)	15	15	15	15	15	10
	Additional Refrigerant Charge - (g/m)	50	50	50	50	50	100
Maximum Field Pipe Length Range - (m)		0 - 60	0 - 60	0 - 60	0 - 60	0 - 20	20 - 60
Maximum Vertical Height Differential - (m) included in max length		20	20	20	20	20	20
Field Pipe Size	Liquid Pipe - mm (inch)	9.52 (3/8)	9.52 (3/8)	9.52 (3/8)	9.52 (3/8)	9.52 (3/8)	12.70 (1/2)
	Gas Pipe - mm (inch)	19.05 (3/4)	19.05 (3/4)	19.05 (3/4)	19.05 (3/4)	¹⁰ 22.22 (7/8)	22.22 (7/8)
Outdoor Unit	Liquid Pipe - mm (inch)	9.52 (3/8) swaged	9.52 (3/8) swaged	9.52 (3/8) swaged	9.52 (3/8) swaged	9.52 (3/8) swaged	9.52 (3/8) cut swage end
	Gas Pipe - mm (inch)	19.05 (3/4) swaged	19.05 (3/4) swaged	19.05 (3/4) swaged	19.05 (3/4) swaged	22.22 (7/8) swaged	22.22 (7/8) swaged to fit 25.40 (1")
Indoor Unit	Liquid Pipe - mm (inch)	9.52 (3/8) swaged	9.52 (3/8) swaged	9.52 (3/8) swaged	9.52 (3/8) swaged	9.52 (3/8) swaged	9.52 (3/8) cut swage end
	Gas Pipe - mm (inch)	19.05 (3/4) swaged	19.05 (3/4) swaged	22.22 (7/8) cut swage end	19.05 (3/4) swaged	22.22 (7/8) swaged	22.22 (7/8) swaged
Condensate Drain Connection - Size		20mm OD		20mm ID	20mm OD	20mm ID	25mm ID
Safety Tray Connection - Size		20mm ID					
Air Duct	Supply Duct H x W - (mm)	300 x 715					
	Return Duct H x W - (mm)	340 x 900	340 x 1100	360 x 1140	340 x 1100	360 x 1140	410 x 1190

*For more information refer to Controls and Accessories section. 0-10 Please see Product Foot Notes on Page 24-25





Features & Benefits

- Incorporates the energy efficient design features of the award winning ESP Plus reverse cycle ducted split system
- Incorporates Variable Air Volume (VAV) technology to deliver individual temperature zone control
- High efficiency ECM indoor fan
- Variable capacity digital scroll compressor 10 to 100% operation
- Quicker, more precise temperature control
- Variable Fan Technology (VFT) to deliver improved energy efficiency
- Individual zone controllers set the temperature in each individual zone
- Superior operating range:
Cooling: up to 50°C DB
Heating: down to -10°C DB
- Louvre grille protection
- Powder coated outdoor panels to withstand 1000-hour salt spray exposure AS/NZS 4506:2005
- Vertical condenser air discharge
- Sound Reduction System (SRS)
- Slimline 7 day 8 zone wall controller included
- Manual inputs available for 3rd party on/off control
- Three phase sequence relay
- MEPS compliant



Technical Information

		Single Phase		Three Phase		
OUTDOOR MODEL		SRD151C	SRD191C	SRD173C	SRD203C	SRD230C
INDOOR MODEL		SRM151E	SRM191E	SRM171E	SRM201E	SRM230E
¹ Total (Gross) Capacity (kW) (AS/NZS3823.1.2)	Cooling	14.67	19.33	17.45	20.10	23.59
	Heating	14.64	17.90	17.39	19.38	22.97
Nett (Rated) Capacity (kW) (AS/NZS3823.1.2)	Cooling (min - max)	14.37 (1.44-14.37)	18.64 (1.86-18.64)	16.88 (1.69-16.88)	19.32 (1.93-19.32)	23.00 (2.30-23.00)
	Heating (min - max)	15.00 (2.85-15.00)	18.52 (3.52-18.52)	17.93 (3.41-17.93)	20.09 (3.82-20.09)	23.50 (4.47-23.50)
Input Power (kW) (AS/NZS3823.1.2)	Cooling	4.29	5.73	5.02	5.78	6.76
	Heating	4.49	5.33	4.81	5.24	6.91
² EER Rated (AS/NZS3823.1.2)	Cooling	3.35	3.25	3.36	3.34	3.40
³ COP Rated (AS/NZS3823.1.2)	Heating	3.34	3.47	3.73	3.83	3.40
Power Supply (V / Ph / Hz)	Outdoor	230V / 1Ph + N / 50Hz		400V / 3Ph + N / 50Hz		
	Indoor	230V / 1Ph + N / 50Hz				
Rated Load Amps (AS/NZS3823.1.2)	Outdoor / Indoor / Total	17.5 / 2.3 / 19.8	20.8 / 5.1 / 25.9	8.7 / 4.1 / 12.8	9.2 / 5.4 / 14.6	14.0 / 4.0 / 18.0
Full Load Amps (AS/NZS3823.1.2)	Outdoor / Indoor / Total	27.1 / 4.3 / 31.4	32.5 / 5.4 / 37.9	12.3 / 4.3 / 16.6	13.5 / 5.9 / 19.4	16.2 / 4.9 / 21.1
⁴ Circuit Breaker Amps (Suggested)		32.0	40.0	20.0	20.0	25.0
IP Rating	Outdoor	IP44				
	Indoor	IP20				
Compressor	Type / No. per Unit	Digital Scroll / 1				
	Starting Method	Soft Starter		D.O.L.		
No. Refrigeration Circuits/No. Capacity Stages (Capacity range)		1/Variable (10-100% capacity)				
Refrigerant		R410a				
Fans (Type x Number per unit)	Outdoor	Axial / 6 Pole External Rotor / Direct Drive x 2				
	Indoor	Twin Deck Centrifugal / ECM Direct Drive x 1				
Airflow Range Indoor (l/s)	Maximum	880	900	1200	1200	1440
	Nominal	770	980	850	1000	1200
	Minimum	155	195	170	200	240
External Static Pressure (Pa) at:	Maximum Airflow	120	128	116	120	80
	Nominal Airflow	218	192	164	188	170
Outdoor Dimensions (mm)	Depth	580	580	580	580	685
	Height	990	1045	1045	1045	1105
	Width	1320	1460	1460	1460	1685
Indoor Dimensions (mm)	Depth	615	680	615	680	695
	Height	412	435	412	435	485
	Width	1290	1420	1290	1420	1470
⁵ Nominal Weight (kgs)	Outdoor	136	190	176	185	220
	Indoor	61	76	62	76	90
⁶ Sound Pressure Level (dBA)	Outdoor (low/high fan)	50 / 52	52 / 54	52 / 54	52 / 54	54 / 59
⁷ Sound Power Level (dBA)	Outdoor (low/high fan)	67 / 69	69 / 71	69 / 71	69 / 71	70 / 75
MEPS Certified		Yes	Yes	Yes	Yes	Yes

Control Features

	Included	Included	Included	Included	Included
LM7-D Wall Controller (8 Zone)	Included	Included	Included	Included	Included
LM24 Wall Controller (8 Zone) - Secondary Master Controller	Optional	Optional	Optional	Optional	Optional
AM-ZC Zone Controller	Optional	Optional	Optional	Optional	Optional
AM-ZS Zone Sensor	Optional	Optional	Optional	Optional	Optional
Home Automation ON / OFF Capability	Yes	Yes	Yes	Yes	Yes
Maximum Number of Zones	8	8	8	8	8

Options & Accessories

		Single Phase		Three Phase		
OUTDOOR MODEL		SRD151C	SRD191C	SRD173C	SRD203C	SRD230C
INDOOR MODEL		SRM151E	SRM191E	SRM171E	SRM201E	SRM230E
Compressor Soft Start - Included		Yes	Yes	Optional	Optional	Optional
Indoor Drain Kit (ADRKT) - Included		Yes	Yes	Yes	Yes	No
Indoor Unit Integral Fan Coil Safety Tray - Included		Yes	Yes	Yes	Yes	Yes
Optional Outdoor Drain Tray - Model		CDT20	CDT22	CDT22	CDT22	CDT35
Hanging Kit (AHKFC)		Optional				Standard
Return Air Plenum*		PL18R - 2/35S	PL19R - 2/40S	PL18R - 2/35S	PL19R - 2/40S	PL25R - 2/45S
		PL20R - 2/40S	PL19R - 2/45S	PL20R - 2/40S	PL19R - 2/45S	
Supply Air Plenum*	2-Way	PL18S - 2/35S				PL34S - 2/45S
		PL20S - 2/40S				
	3-Way	PL13S - 3/30S				PL22S - 3/35S
		PL18S - 3/35S				PL30S - 3/40S
PL20S - 3/SPS				PL34S - 3/45S		

Variations

	Optional	Optional	Optional	Optional	Optional
H - Horizontal Discharge Fan (Outdoor Unit)	Optional	Optional	Optional	Optional	Optional
K - Coil Protection (Outdoor Unit)	Optional	Optional	Optional	Optional	Optional
R - Demand Response Capability (AS4755.3)	Optional	Optional	Optional	Optional	Optional
Z - Compressor Soft Starter (Outdoor Unit)	⁹ Standard	⁹ Standard	Optional	Optional	Optional

Field Piping and Connections

		4850	7950	7050	7450		9700
Refrigerant Charge	Factory Charge - (g)	4850	7950	7050	7450		9700
	Pre-Charge Length - (m)	15	15	15	15		10
	Additional Refrigerant Charge - (g/m)	50	50	50	50	100	100
Maximum Field Pipe Length Range - (m)		0 - 60	0 - 60	0 - 60	0 - 20	20 - 60	0 - 60
Maximum Vertical Height Differential - (m) included in max length		20	20	20	20	20	20
Field Pipe Size	Liquid Pipe - mm (inch)	9.52 (3/8)	9.52 (3/8)	9.52 (3/8)	9.52 (3/8)	12.70 (1/2)	12.70 (1/2)
	Gas Pipe - mm (inch)	19.05 (3/4)	19.05 (3/4)	19.05 (3/4)	¹⁰ 22.22 (7/8)	22.22 (7/8)	25.40 (1)
Outdoor Unit	Liquid Pipe - mm (inch)	9.52 (3/8) swaged	9.52 (3/8) swaged	9.52 (3/8) swaged	9.52 (3/8) swaged	9.52 (3/8) cut swaged end	12.70 (1/2) swaged
	Gas Pipe - mm (inch)	19.05 (3/4) swaged	19.05 (3/4) swaged	19.05 (3/4) swaged	22.22 (7/8) swaged	22.22 (7/8) swaged	22.22 (7/8) swaged to fit 25.40 (1")
Indoor Unit	Liquid Pipe - mm (inch)	9.52 (3/8) swaged	9.52 (3/8) swaged	9.52 (3/8) swaged	9.52 (3/8) swaged	9.52 (3/8) cut swage end	12.70 (1/2) swaged
	Gas Pipe - mm (inch)	19.05 (3/4) swaged	22.22 (7/8) cut swage end	19.05 (3/4) swaged	22.22 (7/8) swaged	22.22 (7/8) swaged	25.40 (1) swaged
Condensate Drain Connection - Size		20mm OD	20mm ID	20mm OD	20mm ID	20mm ID	25mm ID
Safety Tray Connection - Size		20mm ID					25mm ID
Air Duct	Supply Duct H x W - (mm)	300 x 715					380 x 715
	Return Duct H x W - (mm)	340 x 1100	360 x 1140	340 x 1100	360 x 1140		410 x 1190

*For more information refer to Controls and Accessories section. 0-10 Please see Product Foot Notes on Page 24-25



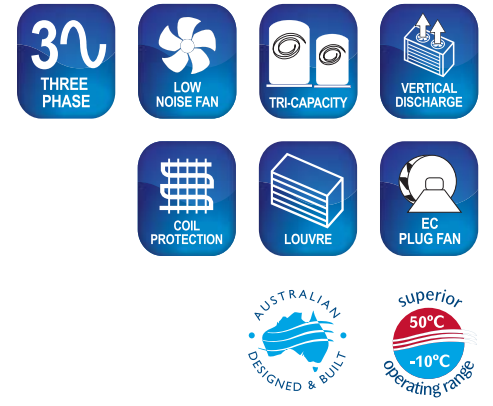

Features & Benefits

- Unique Tri-Capacity Operation
- Delivers 3 steps of cooling/heating (~33%, 66% or 100% capacity)
- High efficiency EC plug fan for improved energy efficiency
- User-friendly Electrical Control Board
- Dial up indoor air flow for faster and more accurate commissioning
- Blue fin hydrophilic coil protection
- High static evaporator fan (up to 500pa)
- High performance outdoor condenser coil
- Flexibility in supply air configurations
- TX Valve refrigerant control
- Lockable 3 Phase Load Break Isolation Switch
- Hyblade™ condenser fan
- Louvre grille protection
- Powder coated outdoor panels to withstand 1000-hour salt spray exposure AS/NZS 4506:2005
- Vertical condenser air discharge
- Optional C7-4 controller available
- Manual inputs available for 3rd party control
- 25mm Foil Faced Polyethylene Insulation - Indoor Unit
- MEPS compliant



Technical Information

OUTDOOR MODEL		CAY470T-6Q1	CAY470T-6Q1	CAY540T-6Q1	CAY540T-6Q1	CAY620T-6Q1	CAY620T-6Q1	CAY700T-6Q1	CAY700T-6Q1
INDOOR MODEL		EVY470T-6Q1	ELY470T-6Q1	EVY540T-6Q1	ELY540T-6Q1	EVY620T-6Q1	ELY620T-6Q1	EVY700T-6Q1	ELY700T-6Q1
		Std Profile	Low Profile	Std Profile	Low Profile	Std Profile	Low Profile	Std Profile	Low Profile
1 Total (Gross) Capacity (kW) (AS/NZS3823.1.2)	Cooling	47.00	47.00	53.50	53.50	63.00	63.00	71.00	71.00
	Heating	46.00	46.00	51.50	51.50	60.00	60.00	67.00	67.00
Nett (Rated) Capacity (kW) (AS/NZS3823.1.2)	Cooling	45.77	46.00	51.85	52.20	60.80	61.00	68.17	68.30
	Heating	47.37	47.20	53.20	52.96	62.47	62.30	70.20	70.00
Input Power (kW) (AS/NZS3823.1.2)	Cooling	15.40	15.42	17.57	17.57	20.50	20.35	24.12	23.94
	Heating	14.16	14.02	16.20	16.03	20.15	19.98	22.32	22.12
2 EER Rated (AS/NZS3823.1.2)	Cooling	2.97	2.98	2.95	2.97	2.97	3.00	2.83	2.85
3 COP Rated (AS/NZS3823.1.2)	Heating	3.35	3.37	3.28	3.30	3.10	3.12	3.15	3.16
Power Supply (V / Ph / Hz)	Outdoor	415V / 3Ph + N / 50Hz							
	Indoor	415V / 3Ph + N / 50Hz							
Rated Load Amps (AS/NZS3823.1.2)	Outdoor / Indoor / Total	25.9 / 2.1 / 28.0	25.9 / 1.7 / 27.6	28.3 / 2.7 / 31.0	28.3 / 2.2 / 30.5	35.7 / 3.5 / 39.2	35.7 / 3.2 / 38.9	40.6 / 4.5 / 45.1	40.6 / 4.2 / 44.8
	Full Load Amps (AS/NZS3823.1.2)	35.5 / 4.8 / 40.3	35.5 / 4.6 / 40.1	38.0 / 4.8 / 42.8	38.0 / 4.6 / 42.6	46.4 / 6.4 / 52.8	46.4 / 6.2 / 52.6	52.8 / 6.4 / 59.2	52.8 / 6.2 / 59.0
4 Circuit Breaker Amps (Suggested)		50.0		63.0		80.0			
IP Rating	Outdoor	IP44							
	Indoor	IP20							
Compressor	Type / No. per Unit	Compliant Scroll / 2							
	Starting Method	D.O.L.							
No. Refrigeration Circuits/No. Capacity Stages (Capacity range)		2 / Tri-Capacity (~33% 66% 100%)							
Refrigerant		R410a							
Fans (Type x Number per unit)	Outdoor	Axial Low Noise / 6 Pole External Rotor / Direct Drive x 3							
	Indoor	Variable Speed ECM Motor Direct Drive Backward Curve Plug Fan x 1 (EVY Models), 2 (ELY Models)							
Airflow Range Indoor (l/s)	Maximum	2900		3300		3900		4100	
	Nominal	2400		2700		3200		3600	
	Minimum	1900		2100		2500		2800	
External Static Pressure (Pa) at:	Maximum Airflow	305	325	125	75	155	175	75	
	Nominal Airflow	500		390	450	410	500	270	340
Outdoor Dimensions (mm)	Depth	1195				1195			
	Height	1465				1695			
	Width	2305				2305			
Indoor Dimensions (mm)	Depth	1450	1160	1450	1160	1450	1160	1450	1160
	Height	1280	770	1280	770	1510	895	1510	895
	Width	1590	2410	1590	2410	1590	2410	1590	2410
5 Nominal Weight (kgs)	Outdoor	532		542		577		604	
	Indoor	292	268	298	277	340	318	340	318
6 Sound Pressure Level (dBA)	Outdoor (low/high fan)	58 / 63				59 / 64			
7 Sound Power Level (dBA)	Outdoor (low/high fan)	75 / 80				76 / 81			
MEPS Certified		Yes	Yes	Yes	Yes	Yes	Yes	Yes	Yes

Control Features

Control Feature	CAY470T-6Q1	CAY470T-6Q1	CAY540T-6Q1	CAY540T-6Q1	CAY620T-6Q1	CAY620T-6Q1	CAY700T-6Q1	CAY700T-6Q1
	EVY470T-6Q1	ELY470T-6Q1	EVY540T-6Q1	ELY540T-6Q1	EVY620T-6Q1	ELY620T-6Q1	EVY700T-6Q1	ELY700T-6Q1
	Std Profile	Low Profile	Std Profile	Low Profile	Std Profile	Low Profile	Std Profile	Low Profile
C7-4 Wall Controller (BCA Compliant)	Optional	Optional	Optional	Optional	Optional	Optional	Optional	Optional
Remote Temperature Sensor	Optional	Optional	Optional	Optional	Optional	Optional	Optional	Optional
Commercial Control Interface - Third Party Controls	Standard	Standard	Standard	Standard	Standard	Standard	Standard	Standard
Adjustable Dial-Up Indoor Airflow	Standard	Standard	Standard	Standard	Standard	Standard	Standard	Standard
Adaptive Demand Defrost	Standard	Standard	Standard	Standard	Standard	Standard	Standard	Standard

Options & Accessories

OUTDOOR MODEL	CAY470T-6Q1	CAY470T-6Q1	CAY540T-6Q1	CAY540T-6Q1	CAY620T-6Q1	CAY620T-6Q1	CAY700T-6Q1	CAY700T-6Q1
INDOOR MODEL	EVY470T-6Q1	ELY470T-6Q1	EVY540T-6Q1	ELY540T-6Q1	EVY620T-6Q1	ELY620T-6Q1	EVY700T-6Q1	ELY700T-6Q1
	Std Profile	Low Profile	Std Profile	Low Profile	Std Profile	Low Profile	Std Profile	Low Profile
Low Ambient / High Static Outdoor Fans	Optional	Optional	Optional	Optional	Optional	Optional	Optional	Optional
Indoor Drain Kit (ADRK) - Included	No	No	No	No	No	No	No	No
Indoor Unit Integral Fan Coil Safety Tray - Included	Yes	Yes	Yes	Yes	Yes	Yes	Yes	Yes

Air Handling

Option	CAY470T-6Q1	CAY470T-6Q1	CAY540T-6Q1	CAY540T-6Q1	CAY620T-6Q1	CAY620T-6Q1	CAY700T-6Q1	CAY700T-6Q1
	EVY470T-6Q1	ELY470T-6Q1	EVY540T-6Q1	ELY540T-6Q1	EVY620T-6Q1	ELY620T-6Q1	EVY700T-6Q1	ELY700T-6Q1
	Std Profile	Low Profile	Std Profile	Low Profile	Std Profile	Low Profile	Std Profile	Low Profile
F - Front Discharge (EVY & ELY Models Only)	Standard	Standard	Standard	Standard	Standard	Standard	Standard	Standard
T - Top Discharge (CAY Models Only)	Standard	Standard	Standard	Standard	Standard	Standard	Standard	Standard
T - Top Discharge (EVY Models Only)	Optional	Optional	Optional	Optional	Optional	Optional	Optional	Optional

Variations

Option	CAY470T-6Q1	CAY470T-6Q1	CAY540T-6Q1	CAY540T-6Q1	CAY620T-6Q1	CAY620T-6Q1	CAY700T-6Q1	CAY700T-6Q1
	EVY470T-6Q1	ELY470T-6Q1	EVY540T-6Q1	ELY540T-6Q1	EVY620T-6Q1	ELY620T-6Q1	EVY700T-6Q1	ELY700T-6Q1
	Std Profile	Low Profile	Std Profile	Low Profile	Std Profile	Low Profile	Std Profile	Low Profile
D - Fault Detection (Outdoor Unit Only)	Optional	Optional	Optional	Optional	Optional	Optional	Optional	Optional
K - Additional Full Coil Coat Protection (Outdoor Unit Only)	Optional	Optional	Optional	Optional	Optional	Optional	Optional	Optional
L - Additional Full Coil Coat Protection (Indoor Unit Only)	Optional	Optional	Optional	Optional	Optional	Optional	Optional	Optional
P - IP44 Rated (Indoor Unit Only)	Optional	Optional	Optional	Optional	Optional	Optional	Optional	Optional
R - Demand Response Capability (AS4755.3)	Standard	Standard	Standard	Standard	Standard	Standard	Standard	Standard
U - Low Ambient +50C	Optional	Optional	Optional	Optional	Optional	Optional	Optional	Optional
W - Three-Phase Sequence Protection Relay (Outdoor Unit Only)	Optional	Optional	Optional	Optional	Optional	Optional	Optional	Optional
X - IP55 Rated (Outdoor Unit Only)	Optional	Optional	Optional	Optional	Optional	Optional	Optional	Optional
Y - Powder Coating (Indoor Unit Only)	Optional	Optional	Optional	Optional	Optional	Optional	Optional	Optional
Z - Compressor 3-Phase Soft Starter (Outdoor Unit Only)	Optional	Optional	Optional	Optional	Optional	Optional	Optional	Optional

Field Piping and Connections

Refrigerant Charge (Crt #1 & Crt #2)	Factory Charge - (g)	5200 & 10,900	7100 & 13,600	7900 & 15,400	9200 & 15,500				
Pre-Charge Length - (m)		5	5	5	5				
	Additional Refrigerant Charge - (g/m)	50 & 165	50 & 165	100 & 165	100 & 165				
Maximum Field Pipe Length Range - (m)		75							
Maximum Vertical Height Differential - (m) included in max length		20							
Field Pipe Size (Crt #1 & Crt #2)	Liquid Pipe - mm (inch)	9.52 (3/8) & 15.90 (5/8)	9.52 (3/8) & 15.90 (5/8)	12.70 (1/2) & 15.90 (5/8)	12.70 (1/2) & 15.90 (5/8)				
	Gas Pipe - mm (inch)	19.05 (3/4) & 28.6 (1-1/8)	22.22 (7/8) & 28.6 (1-1/8)	25.40 (1) & 28.6 (1-1/8)	25.40 (1) & 28.6 (1-1/8)				
Outdoor Unit Connection (Crt #1 & Crt #2)	Liquid Pipe - mm (inch)	9.52 (3/8) & 15.90 (5/8)	9.52 (3/8) & 15.90 (5/8)	12.70 (1/2) & 15.90 (5/8)	12.70 (1/2) & 15.90 (5/8)				
	Gas Pipe - mm (inch)	19.05 (3/4) & 28.6 (1-1/8)	22.22 (7/8) & 28.6 (1-1/8)	25.40 (1) & 28.6 (1-1/8)	25.40 (1) & 28.6 (1-1/8)				
Indoor Unit Connection (Crt #1 & Crt #2)	Liquid Pipe - mm (inch)	9.52 (3/8) & 15.90 (5/8)	9.52 (3/8) & 15.90 (5/8)	12.70 (1/2) & 15.90 (5/8)	12.70 (1/2) & 15.90 (5/8)				
	Gas Pipe - mm (inch)	19.05 (3/4) & 28.6 (1-1/8)	22.22 (7/8) & 28.6 (1-1/8)	25.40 (1) & 28.6 (1-1/8)	25.40 (1) & 28.6 (1-1/8)				
Condensate Drain Connection - (Size /Type)		25.4 mm (1") Ø/BSP Female Thread							
Safety Tray Connection - Size/Type		25.4 mm (1") Ø/BSP Socket							
Air Duct	Supply Duct H x W - (mm)	580 x 650	380 x 1000	580 x 650	380 x 1000	580 x 650	380 x 1000	580 x 650	380 x 1000
	Return Duct H x W - (mm)	1130 x 1135	620 x 2000	1130 x 1135	620 x 2000	1360 x 1135	745 x 2000	1360 x 1135	745 x 2000

0-8 Please see Product Foot Notes on Page 24-25



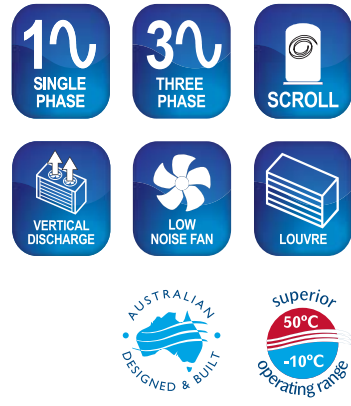

Features & Benefits

- Designed for use with gas ducted heating systems
- May be able to utilise the same duct work to remove heat and humidity
- Fixed speed –100% capacity operation
- Superior operating range:
Cooling: up to 50°C DB
- Louvre grille protection
- Powder coated outdoor panels to withstand 1000-hour salt spray exposure AS/NZS 4506:2005
- Vertical condenser air discharge
- Manual inputs available for 3rd party control
- MEPS compliant



Technical Information

		Single Phase			Three Phase				
OUTDOOR MODEL		SRA131C	SRA151C	SRA171C	SRA133C	SRA153C	SRA173C	SRA203C	SRA230C
INDOOR MODEL		SRA131A	SRA151A	SRA171A	SRA131A	SRA151A	SRA171A	SRA201A	SRA230A
° Nominal Capacity (kW)	Cooling	12.75	15.29	17.38	13.00	15.27	17.56	19.69	23.48
° Nominal Input Power (kW)	Cooling	3.24	4.24	4.58	3.08	3.84	4.47	5.23	6.16
° Nominal EER	Cooling	3.94	3.61	3.79	4.22	3.98	3.93	3.77	3.81
Nett (Rated) Capacity (kW) (AS/NZS3823.1.2)	Cooling	12.24	14.97	16.80	12.40	14.68	16.99	19.06	22.50
Nett (Rated) Input Power (kW) (AS/NZS3823.1.2)	Cooling	3.75	4.56	5.15	3.68	4.43	5.04	5.86	7.14
² Nett (Rated) EER Rated (AS/NZS3823.1.2)	Cooling	3.26	3.28	3.26	3.37	3.31	3.37	3.25	3.15
Power Supply (V / Ph / Hz)		230V / 1Ph + N / 50Hz			400V / 3Ph + N / 50Hz				
Outdoor Unit Rated Amps (AS/NZS3823.1.2)		13.9	17.7	19.7	6.3	7.1	8.7	9.0	13.5
Outdoor Unit Full Load Amps (AS/NZS3823.1.2)		23.1	24.0	30.7	8.3	11.7	12.3	13.9	15.8
⁴ Circuit Breaker Amps (Suggested)		32.0	32.0	40.0	16.0	20.0	20.0	20.0	25.0
IP Rating	Outdoor Unit	IP44							
Compressor	Type / No. per Unit	Compliant Scroll / 1							
	Starting Method	Soft Starter				D.O.L.			
No. of refrigeration Circuits/No of capacity stages (Capacity range)		1/1 (100% capacity)							
Refrigerant		R410a							
Fans (Type x Number per unit)	Outdoor	Axial / 6 Pole External Rotor / Direct Drive x 2							
Airflow Range Indoor (l/s)	Maximum	750	880	900	750	880	900	1150	1380
	Nominal	650	770	850	650	770	850	1000	1200
	Minimum	590	690	770	590	690	770	900	1020
Coil Static Pressure Drop Wet Coil / Dry Coil (Pa) at:	Maximum Airflow	107 / 88	102 / 76	106 / 85	107 / 88	102 / 76	106 / 85	132 / 106	126 / 95
	Nominal Airflow	86 / 70	83 / 62	97 / 78	86 / 70	83 / 62	97 / 78	106 / 85	101 / 76
Outdoor Dimensions (mm)	Depth	580	580	580	580	580	580	580	685
	Height	990	990	1045	990	990	1045	1045	1105
	Width	1320	1320	1460	1320	1320	1460	1460	1685
Indoor Dimensions (mm)	Depth	340	340	340	340	340	340	340	340
	Height	412	412	412	412	412	412	435	485
	Width	1050	1250	1250	1050	1250	1250	1355	1405
⁵ Nominal Weight (kgs)	Outdoor	135	136	176	133	135	174	185	200
	Indoor	27	30	32	27	30	32	38	41
⁶ Sound Pressure Level (dBA)	Outdoor (low/high fan)	50 / 52	50 / 52	52 / 54	50 / 52	50 / 52	52 / 54	52 / 54	55 / 59
⁷ Sound Power Level (dBA)	Outdoor (low/high fan)	67 / 69	67 / 69	69 / 71	67 / 69	67 / 69	69 / 71	69 / 71	71 / 75
MEPS Certified		Yes	Yes	Yes	Yes	Yes	Yes	Yes	Yes

Control Features

Home Automation ON / OFF Capability	Yes	Yes	Yes	Yes	Yes	Yes	Yes	Yes	Yes
Manual Inputs Capable for Third Party Control	Yes	Yes	Yes	Yes	Yes	Yes	Yes	Yes	Yes

Options & Accessories

		Single Phase			Three Phase					
OUTDOOR MODEL		SRA131C	SRA151C	SRA171C	SRA133C	SRA153C	SRA173C	SRA203C	SRA230C	
INDOOR MODEL		SRA131A	SRA151A	SRA171A	SRA131A	SRA151A	SRA171A	SRA201A	SRA230A	
Compressor Soft Start - Included		Yes	Yes	Yes	Optional	Optional	Optional	Optional	Optional	
Indoor Drain Kit (ADRKT) - Included		Yes	Yes	Yes	Yes	Yes	Yes	Yes	No	
Indoor Unit Integral Fan Coil Safety Tray - Included		Yes	Yes	Yes	Yes	Yes	Yes	Yes	Yes	
Optional Outdoor Drain Tray - Model		CDT20	CDT20	CDT22	CDT20	CDT20	CDT22	CDT22	CDT35	
Hanging Kit (AHKFC)		Optional								
Duct Plates*		PLDP-2/350	PLDP-2/400		PLDP-2/350	PLDP-2/400		PLDS-2/400	PLDT-2/450	
		PLDP-2/400			PLDP-2/400					
Supply Air Plenum*	1 - Way	PL18S-1/40S							n/a	n/a
	2 - Way	PL18S - 2/35S							n/a	n/a
		PL20S - 2/40S							n/a	n/a
	3 - Way	PL13S - 3/30S							n/a	n/a
PL18S - 3/35S							n/a	n/a		
		PL20S - 3/SPS							n/a	n/a

Variations

D - Fault Detection (Outdoor Unit)	N / A	N / A	N / A	Optional	Optional	Optional	Optional	Optional
H - Horizontal Discharge Fan (Outdoor Unit)	Optional	Optional	Optional	Optional	Optional	Optional	Optional	Optional
K - Coil Protection (Outdoor Unit)	Optional	Optional	Optional	Optional	Optional	Optional	Optional	Optional
R - ⁸ Demand Response Capability (AS4755.3)	Optional	Optional	Optional	Optional	Optional	Optional	Optional	Optional
Z - Compressor Soft Starter (Outdoor Unit)	⁹ Standard	⁹ Standard	⁹ Standard	Optional	Optional	Optional	Optional	Optional

Field Piping and Connections

		5450	4650	6650	5250	4650	7350	7450	8050	
Refrigerant Charge	Factory Charge - (g)	5450	4650	6650	5250	4650	7350	7450	8050	
	Pre-Charge Length - (m)	15	15	15	15	15	15	15	10	
	Additional Refrigerant Charge - (g/m)	50	50	50	50	50	50	50	100	
Maximum Field Pipe Length Range - (m)		0 - 60	0 - 60	0 - 60	0 - 60	0 - 60	0 - 60	0 - 20	20 - 60	
Maximum Vertical Height Differential - (m) included in max length		20	20	20	20	20	20	20	20	
Field Pipe Size	Liquid Pipe - mm (inch)	9.52 (3/8)	9.52 (3/8)	9.52 (3/8)	9.52 (3/8)	9.52 (3/8)	9.52 (3/8)	9.52 (3/8)	12.70 (1/2)	
	Gas Pipe - mm (inch)	19.05 (3/4)	19.05 (3/4)	19.05 (3/4)	19.05 (3/4)	19.05 (3/4)	19.05 (3/4)	22.22 (7/8)	25.40 (1)	
Outdoor Unit	Liquid Pipe - mm (inch)	9.52 (3/8) swaged	9.52 (3/8) swaged	9.52 (3/8) swaged	9.52 (3/8) swaged	9.52 (3/8) swaged	9.52 (3/8) swaged	9.52 (3/8) swaged	12.70 (1/2) swaged	
	Gas Pipe - mm (inch)	19.05 (3/4) swaged	19.05 (3/4) swaged	19.05 (3/4) swaged	19.05 (3/4) swaged	19.05 (3/4) swaged	19.05 (3/4) swaged	22.22 (7/8) swaged	22.22 (7/8) swaged to fit 25.4 (1")	
Indoor Unit	Liquid Pipe - mm (inch)	9.52 (3/8) swaged	9.52 (3/8) swaged	9.52 (3/8) swaged	9.52 (3/8) swaged	9.52 (3/8) swaged	9.52 (3/8) swaged	9.52 (3/8) swaged	12.70 (1/2) swaged	
	Gas Pipe - mm (inch)	19.05 (3/4) swaged	19.05 (3/4) swaged	19.05 (3/4) swaged	19.05 (3/4) swaged	19.05 (3/4) swaged	19.05 (3/4) swaged	22.22 (7/8) swaged	25.40 (1) to be swaged in field	
Condensate Drain Connection - Size		20mm OD							20mm ID	25mm ID
Safety Tray Connection - Size		20mm ID								25mm ID
Air Duct (Opening only, no flange)	Supply Duct H x W - (mm)	300 x 715								
	Return Duct H x W - (mm)	340 x 900	340 x 1100	340 x 900	340 x 1100	360 x 1140	410 x 1190			

*For more information refer to Controls and Accessories section. 0-10 Please see Product Foot Notes on Page 24-25





Package Model - Under/Over Configuration

Technical Information											
		PCG153U	PCG173U	PCG203U	PCA230U	PCA260U	PCG290U	PCA330U	PCA300U	PCA340U	PCG400U
¹ Total (Gross) Capacity (kW) (AS/NZS3823.1.2)	Cooling	15.27	17.56	19.69	23.48	25.15	29.50	34.66	28.90	35.22	40.80
	Heating	14.45	17.38	18.75	21.82	24.30	27.40	32.73	27.30	33.78	37.85
Nett (Rated) Capacity (kW) (AS/NZS3823.1.2)	Cooling	14.68	16.99	19.06	22.50	24.00	28.30	33.00	27.70	33.50	39.20
	Heating	15.00	17.92	19.34	23.00	25.50	28.60	34.50	28.50	35.50	39.50
Input Power (kW) (AS/NZS3823.1.2)	Cooling	4.43	5.04	5.86	7.14	7.65	8.45	10.48	8.50	10.55	12.76
	Heating	3.95	4.58	5.23	6.67	7.55	7.97	10.30	8.72	10.37	11.97
² EER Rated (AS/NZS3823.1.2)	Cooling	3.31	3.37	3.25	3.15	3.14	3.35	3.15	3.26	3.18	3.07
³ COP Rated (AS/NZS3823.1.2)	Heating	3.80	3.91	3.70	3.45	3.38	3.59	3.35	3.27	3.42	3.30
Power Supply (V / Ph / Hz)		400 - 415V / 3Ph + N / 50Hz									
Rated Load Amps (AS/NZS3823.1.2)		11.3	12.8	13.5	17.9	18.3	24.5	23.3	20.1	23.4	36.2
Full Load Amps (AS/NZS3823.1.2)		16.0	16.6	19.8	20.7	23.5	30.9	29.7	27.1	31.4	46.4
⁴ Circuit Breaker Amps (Suggested)		20.0	20.0	20.0	25.0	25.0	32.0	32.0	32.0	32.0	50.0
IP Rating		IP44									
Compressor	Type / No. per Unit	Compliant Scroll / 1					Compliant Scroll / 2				
	Starting Method	D.O.L.					D.O.L.				
No. Refrigeration Circuits/No. Capacity Stages (Capacity range)		1 / 1 (100% capacity)					2 / 2 (50%, 100% capacity)				
Refrigerant		R410a									
Fans (Type x Number per unit)	Outdoor	Axial / 6 Pole External Rotor / Direct Drive x 2									
	Indoor	Twin Deck Centrifugal / ECM Direct Drive x 1		Twin Deck Centrifugal / 4 Pole / Direct Drive x 1		Twin Deck Centrifugal / ECM Direct Drive x 1		Twin Deck Centrifugal / 4 Pole / Direct Drive x 1		Twin Deck Centrifugal / ECM Direct Drive x 1	
Airflow Range Indoor (l/s)	Maximum	880	900	1150	1380	1452	1650	1892	1650	1892	2250
	Nominal	770	850	1000	1200	1320	1500	1720	1500	1720	2050
	Minimum	690	770	900	1020	1122	1275	1462	1275	1462	1750
External Static Pressure (Pa) at:	Maximum Airflow	81	116	140	175	135	266	132	185	132	170
	Nominal Airflow	178	164	186	235	200	285	205	240	205	236
Unit Dimensions (mm)	Depth	1175	1185	1265	1115	1190	1330	1175	1330	1175	1315
	Height	995	1050	1050	1115	1115	1330	1115	1330	1115	1315
	Width	1320	1460	1685	1685	1685	1875	1685	1875	1685	1875
⁵ Nominal Weight (kgs)		227	236	283	310	355	450	470	460	500	510
⁶ Sound Pressure Level (dBA)	Outdoor (low/high fan)	51.0 / 53.0	52.0 / 54.0	52.0 / 54.0	55.0 / 59.0	55.0 / 59.0	56.9 / 60.9	58.8 / 62.8	56.9 / 60.9	58.8 / 62.8	62.0 / 65.0
⁷ Sound Power Level (dBA)	Outdoor (low/high fan)	68.0 / 70.0	69.0 / 71.0	69.0 / 71.0	72.0 / 76.0	72.0 / 76.0	73.9 / 77.9	75.8 / 79.8	73.9 / 77.9	75.8 / 79.8	79.0 / 82.0
MEPS Certified		Yes	Yes	Yes	Yes	Yes	Yes	Yes	Yes	Yes	Yes

Control Features											
C7-4 Wall Controller (BCA Compliant)	Optional	Optional	Optional	Optional	Optional	Optional	Optional	Optional	Optional	Optional	Optional
Home Automation ON / OFF Capability	Optional	Optional	Optional	Optional	Optional	Optional	Optional	Optional	Optional	Optional	Optional
Manual Inputs Capable for Third Party Control	Optional	Optional	Optional	Optional	Optional	Optional	Optional	Optional	Optional	Optional	Optional
Remote Temperature Sensor	Optional	Optional	Optional	Optional	Optional	Optional	Optional	Optional	Optional	Optional	Optional
Secondary Master Controller	No	No	No	No	No	No	No	No	No	No	No
Maximum Number of Zones	4	4	4	4	4	4	4	4	4	4	4

Variations											
D - Fault Detection	Optional	Optional	Optional	Optional	Optional	Optional	Optional	Optional	Optional	Optional	Optional
H - Horizontal Discharge Fan	Optional	Optional	Optional	Optional	Optional	Optional	Optional	Optional	Optional	Optional	Optional
K- Coil Protection (Fan Coil & Outdoor Unit)	Optional	Optional	Optional	Optional	Optional	Optional	Optional	Optional	Optional	Optional	Optional
R - Demand Response Capability (AS4755.3)	Optional	Optional	Optional	Optional	Optional	Optional	Optional	Optional	Optional	Optional	Optional
W - Phase Sequence Protection Relay	Optional	Optional	Optional	Optional	Optional	Optional	Optional	Optional	Optional	Optional	Optional
Z - Compressor Soft Starter	Optional	Optional	Optional	Optional	Optional	Optional	Optional	Optional	Optional	Optional	Optional

Installation Information											
Refrigerant Factory Charge - (g)	4050	6750	6850	7260	9310	10,430	12,320	2 x 4525	2 x 6910	2 x 7625	
Condensate Drain Connection - Size	20mm OD	25mm ID									25.4mm ID BSP Female Thread and 25.4mm ID BSP Socket
Air Duct	Supply Duct H x W - (mm)	300 x 715			300 x 850			300 x 1065			
	Return Duct H x W - (mm)	340 x 1100	350 x 1150	400 x 1200	450 x 1250	525 x 1450	450 x 1250	525 x 1450	575 x 1595		

0-10 Please see Product Foot Notes on Page 24-25

Features & Benefits

- Reverse cycle ducted packaged unit
- 1 step and/or 2 step of cooling/heating operation
- Superior operating range:
Cooling: up to 50°C DB
Heating: down to -10°C DB
- Two speed outdoor fan
- Indoor fan three speed - PCA series
- Indoor fan dial no air-flow adjustment - PCG series
- Interlaced evaporator coil for full face cooling on two stage systems
- High performance outdoor condenser coil
- Louvre grille protection
- Powder coated outdoor panels to withstand 1000-hour salt spray exposure AS/NZS 4506:2005
- Vertical condenser air discharge
- Optional C7-4 controller available
- Manual inputs available for 3rd party control
- MEPS compliant



Package Model - Side By Side Configuration

Technical Information						
		PCG290L/R	PCG330L/R	PCG300L/R	PCG340L/R	PCG400L/R
¹ Total (Gross) Capacity (kW) (AS/NZS3823.1.2)	Cooling	29.50	33.94	29.40	34.16	40.80
	Heating	27.40	31.53	27.20	31.82	37.85
Nett (Rated) Capacity (kW) (AS/NZS3823.1.2)	Cooling	28.30	32.50	28.20	33.00	39.20
	Heating	28.60	32.90	28.30	32.90	39.50
Input Power (kW) (AS/NZS3823.1.2)	Cooling	8.45	9.94	8.55	9.96	12.76
	Heating	7.97	10.13	8.15	9.82	11.97
² EER Rated (AS/NZS3823.1.2)	Cooling	3.35	3.27	3.30	3.31	3.07
³ COP Rated (AS/NZS3823.1.2)	Heating	3.59	3.25	3.47	3.36	3.30
Power Supply (V / Ph / Hz)		400V / 3Ph + N / 50Hz				
Rated Amps (AS/NZS3823.1.2)		24.5	27.6	22.2	25.5	36.2
Full Load Amps (AS/NZS3823.1.2)		30.9	34.4	31.4	36.1	46.4
⁴ Circuit Breaker Amps (Suggested)		32.0	40.0	32.0	40.0	50.0
IP Rating		IP44				
Compressor	Type / No. per Unit	Compliant Scroll / 1		Compliant Scroll / 2		
	Starting Method	D.O.L.		D.O.L.		
No. Refrigeration Circuits/No. Capacity Stages (Capacity range)		1 / 1 (100% capacity)		2 / 2 (50%, 100% capacity)		
Refrigerant		R410a				
Fans (Type x Number per unit)	Outdoor	Axial / 6 Pole External Rotor / Direct Drive x 2				
	Indoor	Single Deck Centrifugal / ECM Direct Drive x 2				
Airflow Range Indoor (l/s)	Maximum	1650	1900	1650	1900	2250
	Nominal	1500	1720	1500	1720	2050
	Minimum	1275	1450	1275	1450	1750
External Static Pressure (Pa) at:	Maximum Airflow	266	233	266	233	170
	Nominal Airflow	285	296	285	296	236
Unit Dimensions (mm)	Depth	1590				
	Height	1330				
	Width	1875				1315
⁵ Nominal Weight (kgs)		450	480	470	500	510
⁶ Sound Pressure Level (dBA)	Outdoor (low/high fan)	56.9 / 60.9	58.8 / 62.8	56.9 / 60.9	58.8 / 62.8	62.0 / 65.0
⁷ Sound Power Level (dBA)	Outdoor (low/high fan)	73.9 / 77.9	75.8 / 79.8	73.9 / 77.9	75.8 / 79.8	79.0 / 82.0
MEPS Certified		Yes	Yes	Yes	Yes	Yes

Control Features					
C7-4 Wall Controller (BCA Compliant)	Optional	Optional	Optional	Optional	Optional
Home Automation ON / OFF Capability	Optional	Optional	Optional	Optional	Optional
Manual Inputs Capable for Third Party Control	Optional	Optional	Optional	Optional	Optional
Remote Temperature Sensor	Optional	Optional	Optional	Optional	Optional
Secondary Master Controller	No	No	No	No	No
Maximum Number of Zones	4	4	4	4	4

Variations					
D - Fault Detection	Optional	Optional	Optional	Optional	Optional
H - Horizontal Discharge Fan	Optional	Optional	Optional	Optional	Optional
K- Coil Protection (Outdoor Coil)	Optional	Optional	Optional	Optional	Optional
P- Coil Protection (Indoor Coil)	Optional	Optional	Optional	Optional	Optional
R - Demand Response Capability (AS4755.3)	Optional	Optional	Optional	Optional	Optional
W - Phase Sequence Protection Relay	Optional	Optional	Optional	Optional	Optional
Z - Compressor Soft Starter	Optional	Optional	Optional	Optional	Optional

Installation Information					
Refrigerant Factory Charge - (g)	10,475	12,600	2 x 4525	2 x 6000	2 x 7625
Condensate Drain Connection - Size	25mm ID (2 Drain per unit)				25.4mm ID BSP Female Thread and 25.4mm ID BSP Socket
Air Duct	Supply Duct H x W - (mm)	830 x 400			
	Return Duct H x W - (mm)	850 x 670	850 x 900	850 x 670	850 x 900

0-8 Please see Product Foot Notes on Page 24-25





Features & Benefits

- Unique Tri-Capacity Operation
- Delivers 3 steps of cooling/heating (~33%, 66% or 100% capacity)
- High efficiency EC plug fan for improved energy efficiency
- User-friendly Electrical Control Board
- Dial up indoor air flow for faster & more accurate commissioning
- Blue fin hydrophilic coil protection
- High static evaporator fan (up to 500pa)
- High performance outdoor condenser coil
- Flexibility in supply and return air configurations
- TX Valve refrigerant control
- Lockable 3 Phase Load Break Isolation Switch
- Hyblade™ condenser fan
- Louvre grille protection
- Powder coated outdoor panels to withstand 1000-hour salt spray exposure AS/NZS 4506:2005
- Vertical condenser air discharge
- Optional C7-4 controller available
- Manual inputs available for 3rd party control
- 25mm Foil Faced Polyethylene Insulation - Indoor Unit
- MEPS compliant



Technical Information		PKY470T-6Q1	PKY540T-6Q1	PKY620T-6Q1	PKY700T-6Q1	PKY820T-3Q1	PKY960T-3Q1
1 Total (Gross) Capacity (kW) (AS/NZS3823.1.2)	Cooling	47.00	53.50	63.00	71.00	82.50	96.00
	Heating	46.00	51.50	60.00	67.00	80.00	92.00
Nett (Rated) Capacity (kW) (AS/NZS3823.1.2)	Cooling	45.77	51.85	60.80	68.17	80.04	92.96
	Heating	47.37	53.20	62.47	70.20	82.75	95.40
Input Power (kW) (AS/NZS3823.1.2)	Cooling	15.40	17.57	20.50	24.12	27.21	32.54
	Heating	14.16	16.20	20.15	22.32	24.55	27.20
2 EER Rated (AS/NZS3823.1.2)	Cooling	2.97	2.95	2.97	2.83	2.94	2.86
3 COP Rated (AS/NZS3823.1.2)	Heating	3.35	3.28	3.10	3.15	3.37	3.51
Power Supply (V / Ph / Hz)		400 - 415V / 3Ph + N / 50Hz					
Rated Load Amps (AS/NZS3823.1.2)	Outdoor / Indoor / Total	28.0	31.0	39.2	45.1	50.6	60.0
Full Load Amps (AS/NZS3823.1.2)	Outdoor / Indoor / Total	40.3	42.8	52.8	59.2	81.7	82.7
4 Circuit Breaker Amps (Suggested)		50.0	50.0	63.0	80.0	100.0	100.0
IP Rating		IP44					
Compressor	Type / No. per Unit	Compliant Scroll / 2 (470-700 Models), 3 (820-960 Models)					
	Starting Method	D.O.L.					
No. Refrigeration Circuits/No. Capacity Stages (Capacity range)		2 (470-700 Models), 3 (820-960 Models) / Tri-Capacity (~33% 66% 100%) All Models					
Refrigerant		R410a					
Fans (Type x Number per unit)	Outdoor	Axial Low Noise / 6 Pole External Rotor / Direct Drive x 3					
	Indoor	Variable Speed ECM Direct Drive Backward Curve Plug Fan x 1 (6Q1 Models), 2 (3Q1 Models)					
Airflow Range Indoor (l/s)	Maximum	2900	3300	3900	4100	4800	6000
	Nominal	2400	2700	3200	3600	4000	5000
	Minimum	1900	2100	2500	2800	3200	4000
External Static Pressure (Pa) at:	Maximum Airflow	305	125	155	75	410	100
	Nominal Airflow	500	390	410	270	500	365
Unit Dimensions (mm)	Depth	2305				2250	
	Height	1465	1695				2155
	Width	2365				2920	
5 Nominal Weight (kgs)		836	853	937	964	1263	1350
6 Sound Pressure Level (dBA)	Outdoor (low/high fan)	59 / 64		60 / 65		61 / 66	
7 Sound Power Level (dBA)	Outdoor (low/high fan)	76 / 81		77 / 82		78 / 83	
MEPS Certified		Yes	Yes	Yes	BCA Compliant	BCA Compliant	BCA Compliant

Control Features		PKY470T-6Q1	PKY540T-6Q1	PKY620T-6Q1	PKY700T-6Q1	PKY820T-3Q1	PKY960T-3Q1
C7-4 Wall Controller (BCA Compliant)		Optional	Optional	Optional	Optional	Optional	Optional
Remote Temperature Sensor		Optional	Optional	Optional	Optional	Optional	Optional
Commercial Control Interface - Third Party Controls		Standard	Standard	Standard	Standard	Standard	Standard
Adjustable Dial-Up Indoor Airflow		Standard	Standard	Standard	Standard	Standard	Standard
Adaptive Demand Defrost		Standard	Standard	Standard	Standard	Standard	Standard
Blue Hydrophilic Coil Fin Protection - Outdoor Coil		Standard	Standard	Standard	Standard	Standard	Standard
Louvred Outdoor Coil Guard		Standard	Standard	Standard	Standard	Standard	Standard





Field Information		PKY470T-6Q1	PKY540T-6Q1	PKY620T-6Q1	PKY700T-6Q1	PKY820T-3Q1	PKY960T-3Q1
Refrigerant Factory Charge -(g)		4600 & 8800	5800 & 12,000	7200 & 12,700	8300 & 12,800	8,300 (each)	11,000 (each)
Condensate Drain Connection - Size/Type	Indoor Section	25.4 mm (1") Ø BSP Female Thread				31.8 mm (1-1/4") Ø BSP Female Thread	
	Outdoor Section	25.4 mm (1") Ø BSP Socket				31.8 mm (1-1/4") Ø BSP Socket	
Air Duct	Supply Duct H x W - (mm)	650 x 580				1200 x 600	
	Return Duct H x W - (mm)	900 x 700				1200 x 600	

Variations		PKY470T-6Q1	PKY540T-6Q1	PKY620T-6Q1	PKY700T-6Q1	PKY820T-3Q1	PKY960T-3Q1
D - Fault Detection		Optional	Optional	Optional	Optional	Optional	Optional
E - Economy Starter Kit		Optional	Optional	Optional	Optional	Optional	Optional
G - Auto Outside Air Kit		Optional	Optional	Optional	Optional	Optional	Optional
H - Manual Outside Air Kit		Optional	Optional	Optional	Optional	Optional	Optional
K - Additional Full Coil Coat Protection (Outdoor Coil)		Optional	Optional	Optional	Optional	Optional	Optional
L - Additional Full Coil Coat Protection (Indoor Coil)		Optional	Optional	Optional	Optional	Optional	Optional
R - 8 Demand Response Capability (AS4755.3)		Optional	Optional	Optional	Optional	Optional	Optional
U - Low Ambient +50°C		Optional	Optional	Optional	Optional	Optional	Optional
W - Three-Phase Sequence Protection Relay		Optional	Optional	Optional	Optional	Optional	Optional
X - IP55 Rated		Optional	Optional	Optional	Optional	Optional	Optional
Z - Compressor 3-Phase Soft Starter (Outdoor Unit Only)		Optional	Optional	Optional	Optional	Optional	Optional

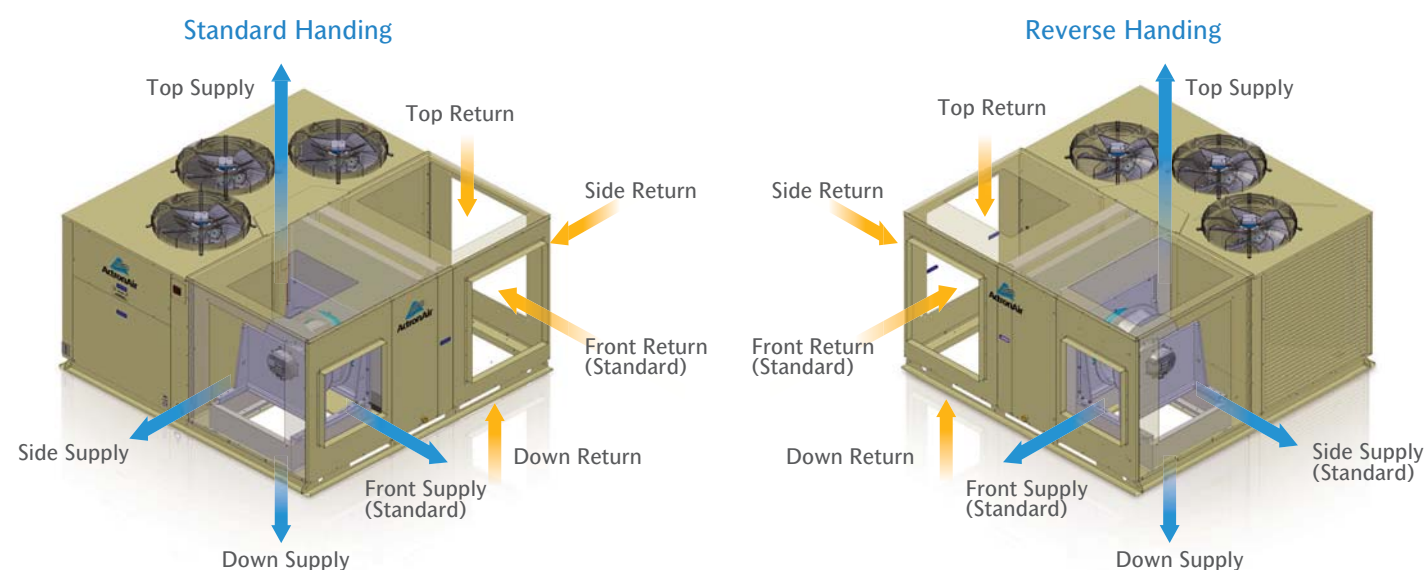
0-8 Please see Product Foot Notes on Page 24-25

Air Handling Options



Controller Model	24 hr ON/OFF timer	7 day ON/OFF timer	Auto Heat/Cool Modes	Auto/Continuous Fan	Fan Setting	ESP Mode	Max. No. of Zones capability	On Board Sensor	Mimic Logic	Filter Light Indicator	Last Zone Enable/Disable
LM24 	●	—	●	●	●	** ●	8	* ●	●	●	●
LM7 	●	●	●	●	●	—	8	●	●	●	●
LM7-D 	●	●	●	●	●	●	8	●	●	●	●
C7-4 	●	●	●	●	●	—	4	●	—	●	—
AM-ZC 	—	—	—	—	—	●	—	●	—	—	—
AM-ZS 	—	—	—	—	—	—	—	●	—	—	—
AERSN 	—	—	—	—	—	—	—	●	—	—	—

* On board sensor does not operate when used with ESP Ultima. ** ESP Mode is only available when used with ESP Plus or ESP Ultima.

Zone Cards (24V)

Features & Benefits

- Control up to 4-Zones Switching
- Easy to install
- Easy snap-in RJ45 plug connection
- Optional last zone enable/disable feature
- Optional to assign sensor
- Supports 24VAC ActronAir Zone Barrel Motor
- Includes 20VA, 240V to 24V transformer



Features & Benefits

- Control up to 8-Zones Switching
- Easy to install zone module
- Easy snap-in wiring connection
- Optional last zone enable/disable feature
- Optional to assign sensor
- Supplied with 20m data and main cable looms
- Supports 24VAC ActronAir Zone Barrel Motor



Zone Cards (240V)

Features & Benefits

- Control up to 4-Zones Switching
- Easy to install zone kit
- Optional to assign sensor
- Supports 240VAC Third Party Zone Barrel Motor
- Compatible with C7 controllers only



Features & Benefits

- Control up to 4-Zones Switching
- Easy to install
- Easy wiring connection
- Optional last zone enable/disable feature
- Optional to assign sensor
- Supports 240 VAC Third Party Zone Barrel Motor



Return Air Plenums

Model Number	Size
PL11R-1/40S	1 x 400mm (16")
PL13R-2/35S	2 x 350mm (14")
PL18R-2/35S	2 x 350mm (14")
PL19R-2/40S	2 x 400mm (16")
PL19R-2/45S	2 x 450mm (18")
PL20R-2/40S	2 x 400mm (16")
PL25R-2/45S	2 x 450mm (18")

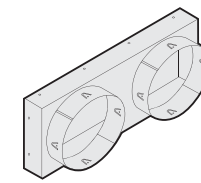

Duct Plates

Model Number	Size
PLDP-2/350	2 x 350mm (14")
PLDP-2/400	2 x 400mm (16")
PLDS-2/400	2 x 400mm (16")
PLDT-2/450	2 x 450mm (18")

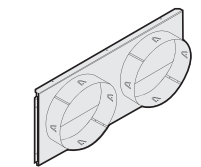

24V Zone Barrels

Features & Benefits

- Robust metal barrel construction
- 10 mm fire rated polyethylene insulation
- 7 m cable supplied
- Easy snap-in wiring connection
- Fast reaction time
- Safe low voltage (24VAC)
- High Torque motor (3 Nm)
- Damper position indicator
- Blade Seal Insulation
- 10", 12", 14" or 16" available
- 5 year warranty (parts only)

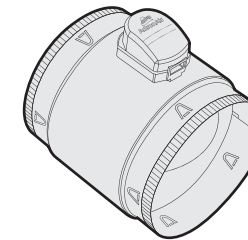

Hanging Kit

Features & Benefits

- Quick and easy to install
- ActronAir units are pre-drilled and ready for hanging kit
- Available up to the 400 Series only
- Rod and fixing nut not supplied by ActronAir

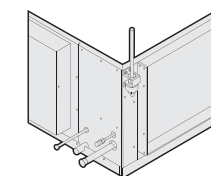

Supply Air Plenums

	Model Number	Size
1 Way	PL18S-1/40S	1 x 400mm (16")
	PL11S-1/35S	1 x 350mm (14")
2 Way Plain	PL11S-2/30S	2 x 300mm (12")
	PL11S-2/35S	2 x 350mm (14")
	PL18S-2/35S	2 x 350mm (14")
	PL20S-2/40S	2 x 400mm (16")
3 Way Plain	PL34S-2/45S	2 x 450mm (18")
	PL13S-3/30S	3 x 300mm (12")
	PL18S-3/35S	3 x 350mm (14")
	PL20S-3/SPS	1x(16")+2x(14")
	PL22S-3/35S	3 x 350mm (14")
	PL30S-3/40S	3 x 400mm (16")
	PL34S-3/45S	3 x 450mm (18")

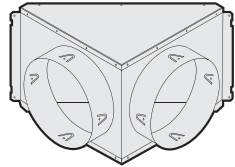

Condensor Drain Tray

Features & Benefits

- Reduces moss and mildew build-up from surrounding areas (e.g. concrete/tiles/pavers)
- Discharge point to suit site installed location
- Powder coated to match outdoor unit
- Prevent build-up of rust
- Available for models ranging from SRE091C – SRA260C only

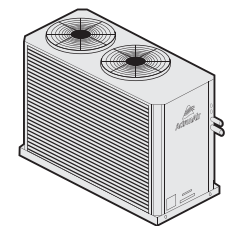

Cables & Joiners

Features & Benefits

- CAT5E With RJ45 Plug are available in 7, 12 and 20m length.
- 2 & 3-Way RJ45 Joiners are available.
- ActronAir CAT5E Cable with RJ45 plug must be used with ActronAir Zone Barrels to ensure system optimum operation and to ensure warranty remains valid.
- Zone Cables are not to be cut or re-terminated to maintain integrity and to ensure faults or warranty issues do not occur.

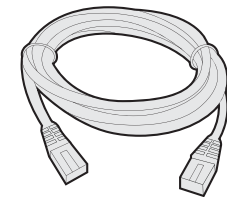

Foot Notes

- Nominal Capacity = Unit kW rating excluding indoor fan kW (Add-On Cooling model only).
Nominal Input Power = Input Power of the system less Indoor Fan Power (Add-On Cooling model only).
Nominal EER = Nominal Capacity | Nominal Input Power (Add-On Cooling model only).
- Based on unit rating excluding indoor fan kW.
- EER Rated = Energy Efficiency Ratio (Rated Capacity Cooling / Rated Input Cooling).
- COP Rated = Coefficient of Performance (Rated Capacity Heating / Rated Input Heating).
- Recommended circuit breaker size. This should be used as a guide only. Refer to AS/NZS 3000 "Australian/New Zealand Wiring Rules" for more details.
- Refer to Catalogue Unit Weight Distribution Guide section for details of weight points.
- Sound Pressure Level at 3m distance is determined as the measured sound pressure at 3m perpendicular to the coil side of the condenser.
- Determination of Sound Power Levels of Noise Sources, AS1217.2 - Precision Methods for Broad-Band Sources in Reverberation Rooms.
- When Demand Response capability is chosen, the air conditioner will fully comply with AS4755.3 in the following modes: DRM 1, 2, 3.
- Supplied as Standard with 1-Phase Compressor soft starter.
- For short pipe run of 0-20m or average 1-storey residential dwellings, 19.05mm (3/4") Gas Field Pipe and 9.52mm (3/8") Liquid Line may be used in place of the recommended 22.22mm (7/8") gas pipe and 12.7 (1/2") liquid line. Please refer to Capacity Selection Data & see Pipe Length Correction Multiplier for the drop in refrigeration capacity as a

consequence of change in Gas Field Pipe diameter. Swaged end of Indoor and Outdoor Units' gas pipe to be cut in the field to fit ID into 19.05mm (3/4") replacement Field Pipe. Swaged end to be cut-off in the field to fit into field pipe.

Important Notes:

- The Local Electricity Supply Authority may require limits on - starting current, running current and voltage drop, please check prior to purchase.
- When the outdoor temperature exceeds the rated conditions, the cooling/heating capacities may decrease the rated nett values.
- Specifications subject to change without notice.

Rated Conditions:

Cooling: 35°C DB Outdoor / Air Entering Indoor 27°C DB, 19°C WB
Heating: 7°C DB, 6°C WB Outdoor / Air Entering Indoor 20°C DB

Wall Hung Split System Operating Range:

Cooling: 15°C DB to 50°C DB Outdoor / Air Entering Indoor 29°C DB
Heating: -10°C DB to 21°C DB Outdoor / Air Entering Indoor 21°C DB

Ducted System Operating Range:

Cooling: 15°C DB to 50°C DB Outdoor / Air Entering Indoor 29°C DB
Heating: -10°C DB to 21°C DB Outdoor / Air Entering Indoor 21°C DB

Warranty:

For full terms and conditions of ActronAir warranty, please refer to warranty terms document - www.actronair.com.au



ActronAir®

Australian for air conditioning™

Trade, Sales and Technical Support Enquiries
1300 135 995

Service and Warranty Enquiries
1800 119 229

General Enquiries
1300 522 722

NSW/ACT
ActronAir® Head Office
5 Irvine Place
Bella Vista NSW 2153
Ph: (02) 8814 4000

QLD
ActronAir®
119 Benjamin Place
Portlink Industrial Park
Lytton QLD 4178
Ph: (07) 3348 2930

VIC/TAS
ActronAir®
Hallmarc Office Park
Unit 12/15 Ricketts Road
Mt Waverley VIC 3149
Ph: (03) 9544 0415

SA/WA/NT
ActronAir®
Unit 4A/69 Sir Donald
Bradman Drive
Hilton SA 5033
Ph: (08) 8352 6687