

Hallberg Rassy 36 for sale

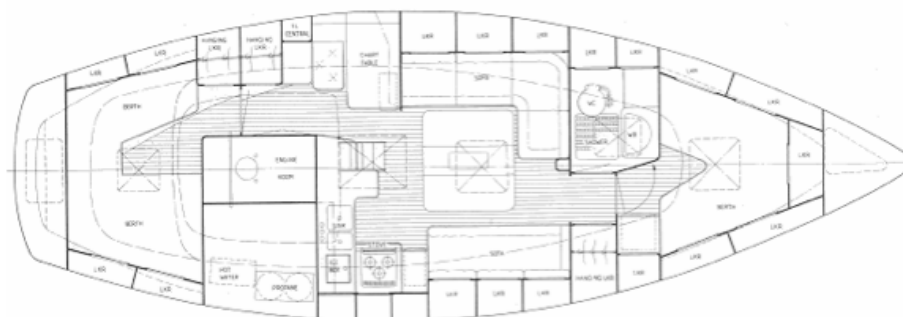

HR 36 MK1 Interior Layout

PALA
1994 Hallberg Rassy 36
Class A Ocean Cruising Yacht
Price: **Stg £120,000** - Tax Paid
Lying: Sant Carles Marina, East Coast Spain.
Flag of Registry: Ireland

Contact owner:
John Heron
T: +353 1 285 2513
M: +353 86 245 6086
E: yachtpala@hotmail.com

PALA: Specifications & Equipment

Overview

Model: Hallberg Rassy 36 Mk 1

Year: 1994

Builder: Hallberg Rassy, Sweden

Designer: Germán Frers

Lloyds Hull Construction Certificate: GOT 350122

Hull Number: 240

Hull Material: Fibreglass

Flag of Registry: Ireland

ISA Small Craft Register No: IE100349

Engine: Volvo Penta MD22 Diesel 57HP

Engine Hours: 1,550

Dimensions & Capacities

LOA: 10.87 m / 35' 8"

Beam: 3.55 m / 11' 8"

LWL: 9.35 m / 30' 8"

Draft: 1.70 m / 5' 7"

Displacement: 7,500 kg / 16,535 lbs

Ballast: Lead Keel – 3,400 kg / 7,495 lbs

Fresh Water Tanks: 355 litres / 78 gallons

Diesel Fuel Tanks: 345 litres / 76 gallons

Accommodation

- **1 Double Berth**
- **1 Twin/Double V-Berth**
- **3 Single Berths**
- **2 Cabins**
- **1 Bathroom/Heads**

- All interior woodwork is silk finish mahogany.
- Upholstery in practical hard-wearing Dralon material.
- Seats and mattresses zipped to enable cleaning of covers.
- Teak floor with inlaid holly stripe, matt finish, and carpeted in blue/grey throughout.
- Carpet fitted with press-studs to prevent slipping.
- Ceilings forward and aft have ivory headlining.
- Saloon ceiling has ivory paneling with decorative mahogany stripes.
- Grey/blue curtains on all portholes.
- Custom-made removal mosquito screens for all portholes, hatches and companionway.
- Ample and practical stowage throughout.
- All larger cupboard doors are louvered and boards under berth cushions have ventilation holes.
- Mahogany cladding with cavity space behind backrests of settee and berths allowing good ventilation.
- The hull is insulated against heat and cold.

Chart Table

- Chart table with seat including under seat stowage.
- 5 drawers, instrument shelf and various cupboards.
- Electric switch panel and navigation instruments.
- *Wempe* clock and barometer.
- Large rubber-sealed 2-door access to the engine room off the walk-through to the aft cabin.

Main Saloon

- 2 large settees around drop leaf dining table with bottle stowage in mid-section.
- 6 shelf lockers plus stowage below settees.
- Additional bookshelf mounted on bulkhead.
- Both settees convert to single berths.
- Lee cloth under starboard settee.
- Stereo radio/CD player with 2 speakers in main saloon.
- Opening skylight hatch and four portholes.
- 1 x 230V socket.

Galley

- Seagoing galley with work surfaces on both sides of stove and sink.
- Worktops in white plastic laminate with fiddle rail, including retractable worktop over gas cooker.
- Gimballed gas cooker with oven and 2 burners.
- Top opening icebox 110 litres with 12V Frigomatic refrigeration unit.
- Deep double sink with hot and cold pressure water.
- Reserve freshwater tap, which is foot pedal operated.
- Several cupboards and drawers.
- Wastebasket under sink.
- 1 x 230V socket.
- Complete kitchenware included.

Aft Cabin

- One single berth to port and one double berth to starboard.
- Lee cloth under portside single berth.
- Stowage above and below both berths.
- Engine and domestic battery banks are housed and vented under port and starboard berths respectively.
- 150W inverter installed under starboard double berth.
- 2 lockers – one hanging, one shelved.
- Opening skylight hatch and 3 portholes – 2 of which are opening.
- Electrolux ventilator.
- 1 x 12V socket.
- 1 x 230V socket

Forward Cabin

- Twin berths converting to double, if desired, with v-shape infill cushion.
- Ample stowage below berths.
- Hanging locker, 2 drawers and various shelf lockers.
- Large opening skylight hatch and one opening porthole.
- Electrolux ventilator.
- 1 x 12V socket.

Heads Compartment

- Spacious toilet compartment lined with white plastic laminate.
- Watertight shower stall with teak grating and drained by electric pump directly overboard without going into the bilge.
- Filter and pump are easily accessible.
- Pressurised hot and cold fresh water.
- China washbasin, retractable showerhead, shower bracket, toilet, mirror and various cupboards.
- Stainless steel holding tank with gravity discharge and pump out on deck.
- Opening skylight hatch, opening porthole and Electrolux ventilator.

Mechanical Systems

- Volvo Penta MD22 4-cylinder diesel engine, 42kW / 57 HP, direct drive, freshwater cooled.
- **Maxprop 3 bladed feathering propellor** with anode.
- **Hydrovane wind vane self-steering system.**
- **Bowthruster** with foot switches at steering position in cockpit.
- Pressurised hot & cold freshwater system to galley, heads and transom shower.
- Additional manual cold freshwater foot-pump in galley.
- Insulated hot water tank with 230V immersion heater.
- Webasto diesel powered central heating with silencer in engine room, thermostatically controlled. Air outlets in forward cabin, saloon and aft cabin.
- Electric and manual bilge pumps mounted forward of the engine room.

Electricity

- One battery, 12V x 75Ah for engine circuit.
- **Three** further 12V **batteries totaling 405Ah** for the **domestic system.**
- Batteries secured and vented under aft cabin berths.
- Batteries charged via 40A alternator and a blocking diode.
- **Mastervolt BTM I battery monitor system.**
- 150W inverter mounted under double berth aft.
- 5 x 12V sockets – one each in aft cabin, chart table, forward cabin and two in cockpit.
- **Full 230V shore power system** with circuit breaker, ring main, battery charger and immersion heater.
- Battery charger mounted in cockpit locker.
- Circuit breaker and distribution box located in engine room.
- All switches for navigation lights, deck lights, instruments etc. are accommodated on switch panel in chart table area.

Steering

- Wheel steering with hide covered stainless steel wheel on Solimar pedestal.
- Autohelm ST6000 electronic steering.
- **Hydrovane wind vane steering giving spare emergency rudder.**
- Emergency tiller.

Spars & Sails

- Double spreader sloop rig with all spars from Seldén.
- **All standing rigging new 2008**, including bronze rigging screws and insulated backstay.
- Mast is stepped on deck over reinforced bulkhead.
- **Seldén Furlin in-mast furling system allowing furling from cockpit.**
- Mainsail outhaul and in-mast continuous reefing line brought back to cockpit to Lewmar 30CST winch and triple Spinlock XT clutches.
- Main sheet 6:1 using heavy duty Harken triple blocks.
- Rodkicker.
- Spinnaker pole on track and stowed on mast.
- Two Lewmar 16CST self-tailing halyard winches on mast.
- Reckmann jib furling and reefing system.
- Backstay tensioner.
- In-mast furling mainsail 310 sq.ft. by Elvstrom.
- Furling genoa 380 sq.ft. by Elvstrom.
- Cruising chute with snuffer 475 sq.ft.
- Yankee 265 sq.ft.
- Storm jib and trisail.

Deck Equipment

- Teak deck, coachroof and cockpit seats.
- Two teak 'Gin & Tonic' pushpit mounted seats.
- Toe rail, handrails and all other woodwork on deck in solid teak.
- Stainless steel stemhead fitting with bow roller.
- Lofrans electric windlass with footswitch on foredeck.
- 45 lb CQR anchor with 40m of 8mm calibrated chain.
- 6 mooring cleats, 2 each forward, mid-ships and aft all with protective brass strips.
- Two Lewmar 48CST self-tailing winches.
- One Lewmar 30CST self-tailing winch with triple Spinlock XT clutches to enable furling of main from the cockpit.
- Four skylight hatches and nine portholes, four of which are opening.
- Two Dorade ventilators in saloon.
- Four Electrolux ventilators, one each in forward cabin, heads, aft cabin and aft deck lazarette.
- Three deck screw filler caps, one each for water, diesel and holding tank pumpout.
- Self-draining stowage locker on starboard side of cockpit for 3 gas bottles, 6kg ea.
- Fixed windscreen with toughened glass and practical opening middle section for ventilation.

- Sprayhood with pram hood extension, side and back panels to cover entire cockpit or part thereof as required.
- Large cockpit locker to starboard with special stowage slot for cockpit table and washboards.
- Lazarette locker on aft deck with hot and cold water taps for transom shower.
- Stainless steel pulpit, pushpit and guard rails.
- Stainless steel bathing ladder on transom.
- Teak outboard bracket.

Loose Equipment

- Quicksilver inflatable dinghy and oars.
- Washboards in solid teak.
- Fortress 9.5kg aluminium anchor, fisherman's anchor and two kedge anchors.
- Various warps and fenders.
- Three winch handles.
- Boat hook.
- Two cockpit cushions.

Navigation Equipment

- Hydrovane wind vane self-steering on transom.
- Autohelm ST6000 autopilot.
- Furuno 1721 Radar.
- Lowe HF-150 SSB radio receiver.
- Shipmate RS8300 VHF radio with cockpit extension speaker and additional radio mount for use in cockpit.
- Lo-Kata Navtex 1.
- Furuno GP-32 GPS/WAAS Navigator.
- Autohelm ST50 speed, wind, depth instruments.
- Autohelm ST50 multifunction display at chart table.
- Steering compass on binnacle.

Safety Equipment

- **Four person liferaft new 2008**, vacuum packed in canister, **mounted** in stainless cradle **on pushpit**.
- Radar reflector.
- Webbing lifelines with stainless steel deck fittings.
- Lifesling.
- Horseshoe lifebuoy with automatic light.
- Two stainless steel harness attachment points in cockpit.
- Various harnesses and lifejackets.
- Automatic fire extinguisher in engine room and other fire extinguishers.

Disclaimer:- The above information is supplied in good faith, however, there may be some inaccuracies contained in same resulting from gathering details from various sources. A buyer should instruct his agents, or his surveyors, to investigate such details as the buyer desires validated. This vessel is offered subject to prior sale, price change, or withdrawal without notice.