



ADW Corp

*Your North Texas Source  
for **Quality** Products*

**Commercial HVAC**

**Industrial HVAC**

**Architectural**

## WAREHOUSE LOCATION

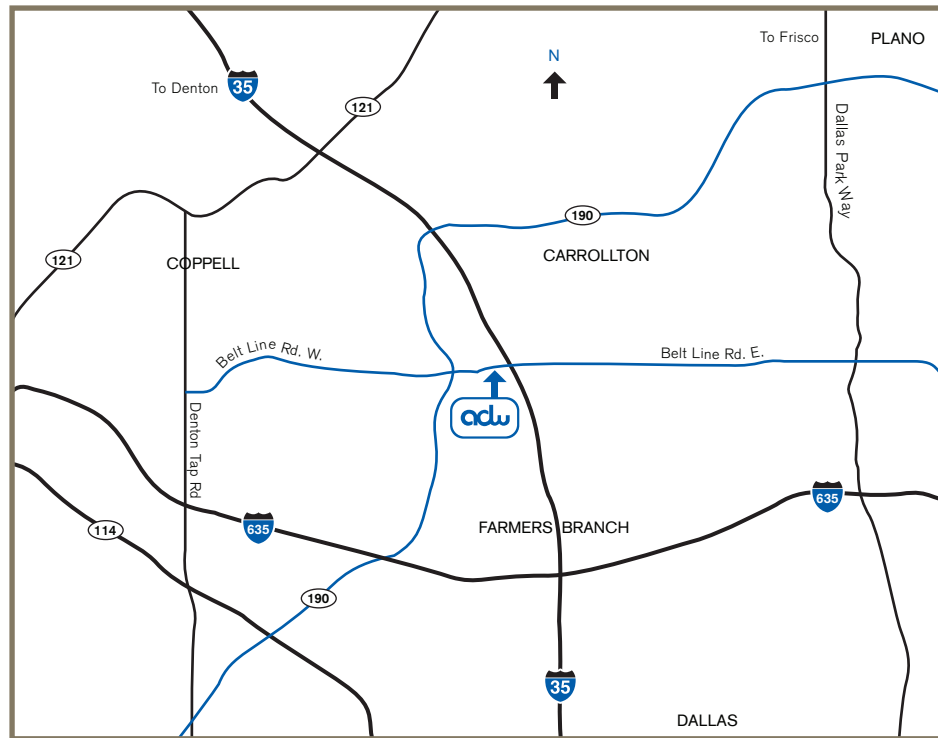

### Dallas

Sales Office and Warehouse  
1445 W. Belt Line Road  
Suite 104  
Carrollton, TX  
469-568-6300  
469-568-6311 (fax)

### Fort Worth

Sales Office  
5500 E. Loop 820 S  
Suite 211  
Fort Worth, TX  
817-483-4115  
817-483-8701 (fax)

## TERMS AND CONDITIONS

### Payment

Payment terms are net 30 from our invoice (shipment) time. Orders can not be shipped to an account having an undisputed invoice more than 30 days past due (60 days from invoice date).

### Credit Policy

Initial orders from new customers shall be on a C.O.D. basis via either cash or bank approved check. Credit can be extended based upon approval of a credit application including references.

### Freight

In most cases orders are shipped freight prepaid F.O.B. our warehouse. All goods become the customers' property when the freight carrier signs for them at our dock.

Responsibility for safe delivery is assumed by the carrier and any claims for lost or damaged goods must be made against the carrier. The customer is responsible for inspecting shipments for shortages and/or visible damage and seeing that the carrier notes any discrepancies on the delivery receipt.

Unless the customer specifies otherwise, all stock item orders will be shipped prepaid via the least expensive mode of transport (usually truck). Request for shipment by other means (air, UPS, etc.) will be sent freight charges collect unless specific prior arrangements have been made.

### Returns

No returns will be accepted without prior authorization.

# Contents

Titus Terminal Units	4
Titus Diffusers	13
Titus Grilles and Registers	20
Ruskin Fire Dampers	22
Sheet Metal Access Doors	23
Dry Wall Access Doors	24
Young Regulator Damper Controls	25
Exhaust Fans	28
Flex Duct	29
Roof Curbs	29
System Sensor Smoke Detectors	30

## ESV

### SINGLE DUCT TERMINALS - DIMENSIONAL DATA

MODEL:  
**PESV**  
Pneumatic Control

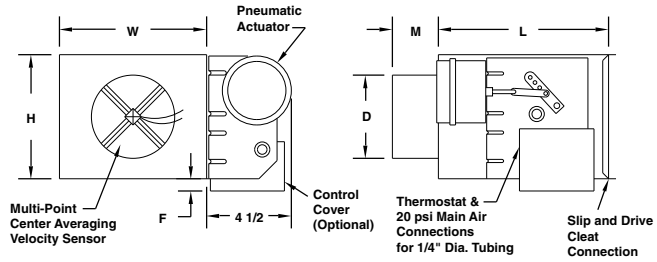

MODEL:  
**AESV**  
Electronic Control

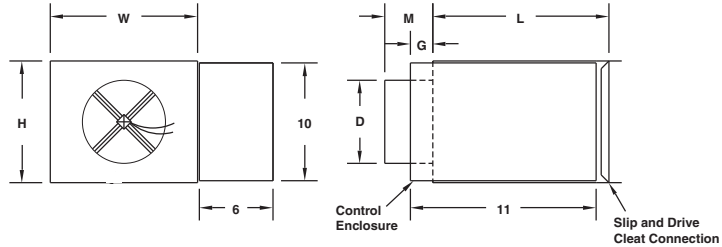

MODEL:  
**DESV**  
DDC Control

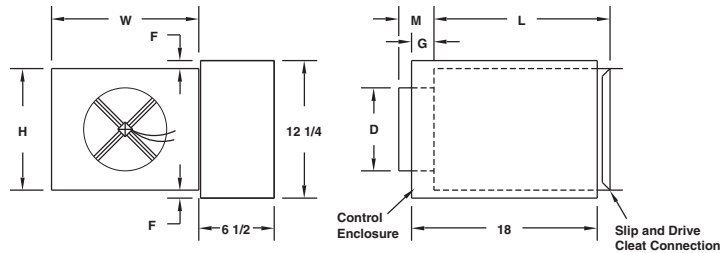

Inlet Size	cfm Range	D	L	W	H	G		F		M
						DESV	PESV	DESV	PESV DESV	
6	0 - 500	5 7/8	15 1/2	12	8	7 7/16	3 9/16	2 1/8	3 3/8	
8	0 - 900	7 7/8	15 1/2	12	10	5 7/16	2 9/16	1 1/8	3 3/8	
10	0 - 1400	9 7/8	15 1/2	14	12 1/2	5 7/16	9/16	—	3 3/8	
12	0 - 2000	11 7/8	15 1/2	16	15	5 7/16	—	—	3 3/8	
14	0 - 3000	9 7/8	15 1/2	20	17 1/2	3 7/16	—	—	3 3/8	
16	0 - 4000	11 7/8	15 1/2	24	18	3 7/16	—	—	3 3/8	

- For optimum control, the inlet duct must be the same size as the unit inlet.
- Right hand control location, as shown above, is standard. Left hand is optional.
- All dimensions are in inches.

### HOT WATER COILS FOR SINGLE DUCT TERMINALS

Note: All products are available with pneumatic or analog controls, or enclosure for field mounting of DDC controls.

Inlet Size	W	H	L (1-2 Row)
6	12	8	5
8	12	10	5
10	14	12 1/2	5
12	16	15	5
14	20	17 1/2	7 1/2
16	24	18	7 1/2

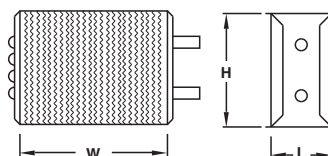

### HOT WATER COIL

The hot water coil is enclosed in a galvanized steel casing module to match the basic terminal unit.

- Water coil connections: Single circuit is 1/2" OD male solder. Multiple circuit is 7/8" OD male solder.
- Dimensions are in inches.
- Available in 1 and 2 rows.

## TQS

### SERIES FAN CONSTANT VOLUME TERMINALS

#### BASIC UNIT

- Quiet, Efficient Operation
- Pressure Independent Airflow Control
- Available from 300-3200 cfm Flow Range

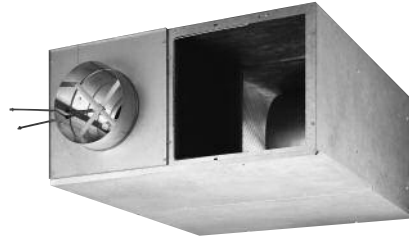

## TQP

### PARALLEL FAN CONSTANT VOLUME TERMINALS

#### BASIC UNIT

- Quiet, Efficient Operation
- Pressure Independent Airflow Control
- Available from 300-2000 cfm Fan Flow Range

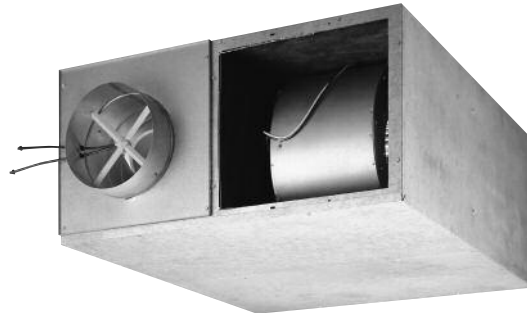

#### ACCESSORIES

Add for T-Stat and Transformer	
CTE 5101	Cooling Only
CTE 5103	Cooling/Heating/Auto Chg
CTE 5104	Cooling w/ Reheat/Aux Ht
Transformer 120v to 24v	
Transformer 277v to 24v	

Note: Analog Controller is Titus TA-1.

Sizes Currently Stocked	
Sizes	Heat (1)
206, 208, & 210	No Heat
306, 308, & 310	No Heat
312	No Heat
408 & 410	No Heat
412	No Heat
510 & 512	No Heat
514 & 516	No Heat
206, 208, & 210	5 KW
306, 308, & 310	7 KW
312	7 KW
408 & 410	10 KW
412 & 414 (2)	10 KW
510 & 512	15 KW
514 & 516	15 KW
206, 208, & 210	2 Row HWC
306, 308, & 310	2 Row HWC
312	2 Row HWC
408 & 410	2 Row HWC
412 & 414 (2)	2 Row HWC
510 & 512	2 Row HWC
514 & 516	2 Row HWC

All products are available with pneumatic or analog controls, or enclosure for field mounting of DDC controls.

(1) All electric heat is 2-stage.

(2) Size 414 not available with pneumatic controls.

Note: Fan Motor 277/1/60  
Electric Heat 460/3/60



# VAV Terminals/Fan Powered

## MODELS:

### PTQS

- Pneumatic Control

### ATQS

- Analog Control

### DTQS

- Digital Control (for field install of controls)

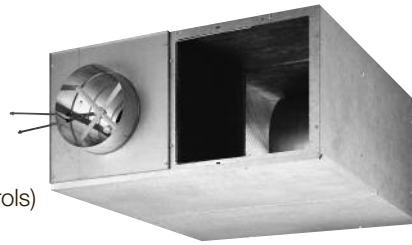

## TQS

### FAN POWERED SERIES TYPE - QUIET OPERATION

- Consistent, quiet design
  - 2 casings for easy design layout
  - Built-in sound baffle for low sound levels, both radiated and discharge
  - Pressure independent primary airflow control
  - Multi-point inlet velocity sensor with center averaging
  - Energy efficient fan motor, permanent split capacitor type, mounted with vibration isolators
  - Adjustable SCR fan speed control with minimum voltage stop
  - Single point electrical, pneumatic main, and thermostat connections
  - Dual density insulation, coated to prevent air erosion, meets requirements of NFPA 90A and UL 181
  - 20 gauge, galvanized steel casing
  - Rectangular discharge opening is designed for flanged duct connections
  - Bottom access panel can be removed for service
  - No external sound attenuators are required
- \* Size 414 not available with pneumatic controls.

### DTQS: Sizes 2-5

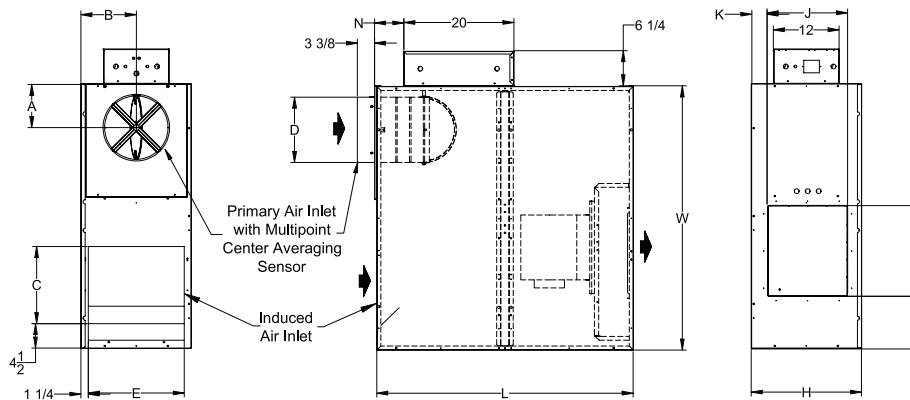

Model TQS Parallel Unit															
Size	Inlet Size	A	B	C	D	E	F	G	H	J	K	L	N	W	Filter Size
2, 3	6	6	8 9/16	13 1/4	5 7/8	14 1/2	14	8 1/2	17 1/8	11	4	40 7/8	2 7/8	36 1/8	19x17
	8	6			7 7/8								2 7/8		
	10	7			9 7/8								4 7/8		
4	8	6	10 1/16	21	7 7/8	17 1/2	16 1/2	9 1/2	20 1/8	14 1/2	2 1/2	46 7/8	2 7/8	48 1/8	27x20
	10	7			9 7/8								4 7/8		
	12	8			11 7/8								4 7/8		
	* 14	10			13 7/8								6 7/8		
5	10	7	10 1/16	21	9 7/8	17 1/2	16 1/2	9 1/2	20 1/8	14 1/2	2 1/2	46 7/8	4 7/8	48 1/8	27x20
	12	8			11 7/8								4 7/8		
	14	10			13 7/8								6 7/8		
	16	11			15 7/8								6 7/8		

All dimensions are in inches.

## TQS HOT WATER COIL SECTION STANDARD FEATURES

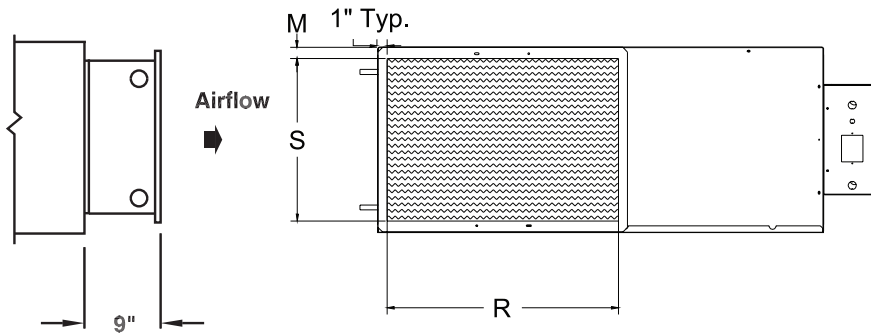

- 1/2" copper tubes
- Aluminum ripple fins
- Connections: Male solder; 5/8" for both 1-row and 2-row; left or right hand connections
- Galvanized steel casing
- Flanged duct connection
- Coil is installed at discharge of unit

\* Note: R and S are inside dimensions.

Hot Water Coil Section (Discharge Mounted)

Unit Size	M (2 ROW)	R	S
2, 3, 4	1 1/4	17	15
5	1 1/4	25	17 1/2

## Coil Rows

- 2-Row

## TQS ELECTRIC COIL SECTION STANDARD FEATURES

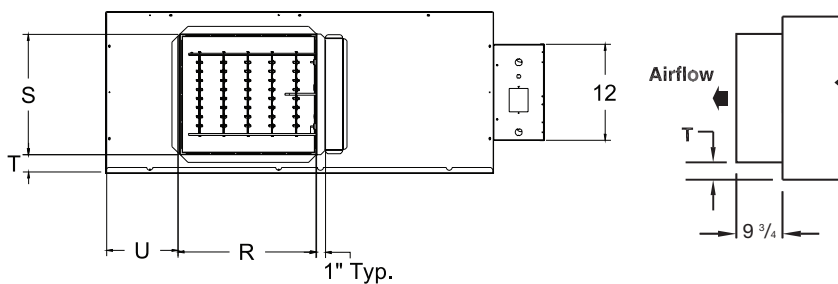

- Automatic reset thermal cutouts, one per element
- Single point electrical connection for entire unit, including coil
- Positive pressure airflow switch
- Flanged duct connection
- Coil is installed at discharge of unit
- Preset P/E switches with pneumatic units

## Supply Voltage

- 277V / 1 ph / 60 Hz.
- 480V / 3 ph / 60 Hz. (4 wire wye)

Electric Coil Section (Discharge Mounted)

Unit Size	R	S	T	U
2, 3, 4	14	11	2 1/8	3 1/2
5	16 1/2	14 1/2	3 1/8	9 1/2

\* Note: R and S are inside dimensions.

## Options

- Disconnect switch, door interlock type

## ELECTRICAL DATA

Unit Size	Motor HP	277V
		FLA
2	1/6	1.3
3	1/4	2.4
4	1/3	2.9
5	1/3	3.3

## ADDITIONAL ACCESSORIES (OPTIONAL)

- Induced air filter, 1" thick disposable construction type
- Fan disconnect switch (not available on units with optional electric coils)
- Metal controller cover.

All motors are single phase, 60(Hz).

FLA = Full Load Amperage, as tested in accordance with UL 1995. 277V motors are used with 480V 3 Phase coils (four wire wye).



# VAV Terminals/Fan Powered

## AIRFLOW VS. DOWNSTREAM STATIC PRESSURE

MODELS:

PTQS

ATQS

DTQS

No Coil or with Electric Coil ———  
 1 Row Water Coil - - - - -  
 2 Row Water Coil .....

Unit Size 2

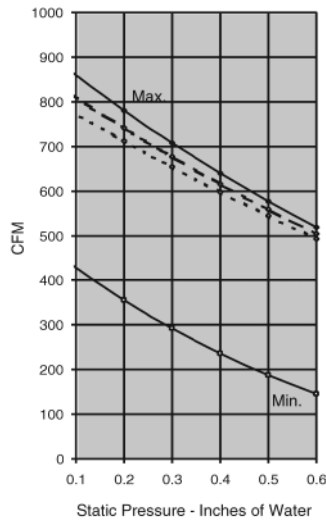

Unit Size 3

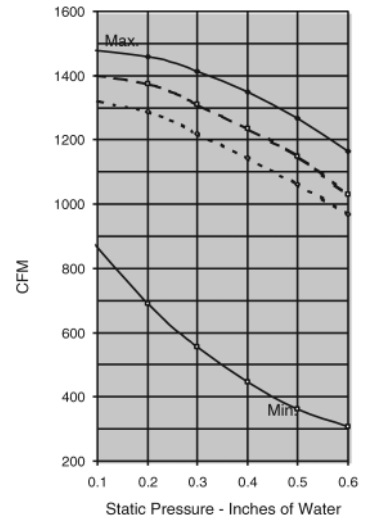

Unit Size 4

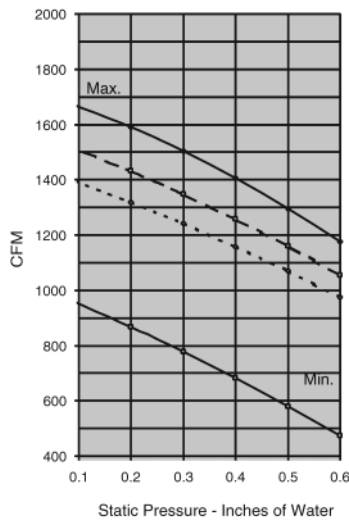

Unit Size 5

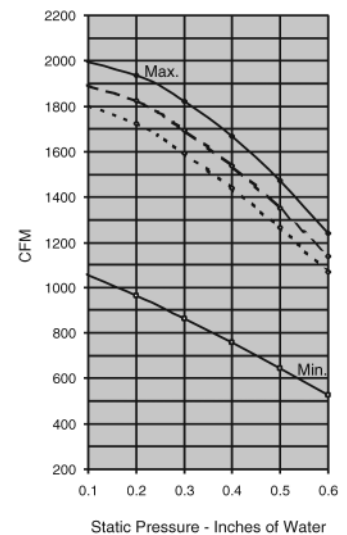

## PRIMARY AIR INLET PRESSURE

PTQS

ATQS

DTQS

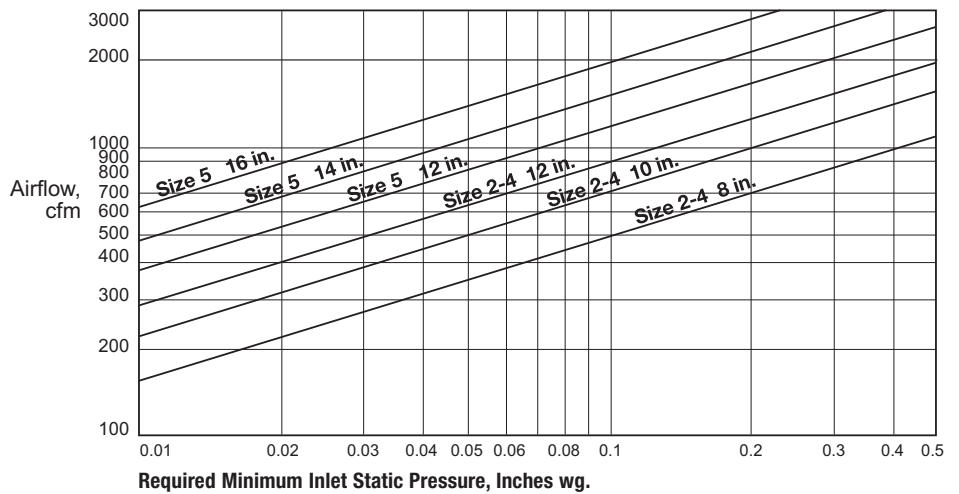





## TQP

### FAN POWERED PARALLEL TYPE – PARALLEL FLOW

#### MODELS:

- PTQP**
  - Pneumatic Control
- ATQP**
  - Analog Control
- DTQP**
  - Digital Control (for field install of controls)

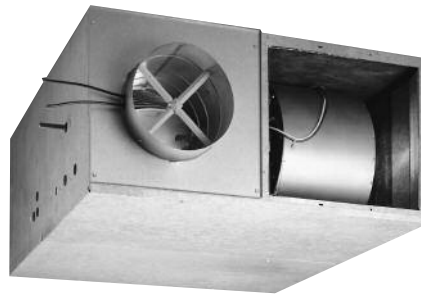

- 2 casing sizes ease in design layout
- Pressure independent primary airflow control
- Multi-point, center averaging inlet velocity sensor
- Primary airflow balancing connections
- Adjustments are easily accessible through ceiling opening
- Energy efficient fan motor, permanent split capacitor type mounted with vibration isolators
- Adjustable SCR fan speed control with minimum voltage stop
- Single point electrical, pneumatic main, and thermostat connections
- Dual density insulation, coated to prevent air erosion, meets requirements of NFPA 90A and UL 181
- 20 gauge, galvanized steel casing with leak resistant construction
- Rectangular discharge opening is designed for flanged duct connections
- Bottom access panel can be removed for service

#### DTQP: Sizes 2-5

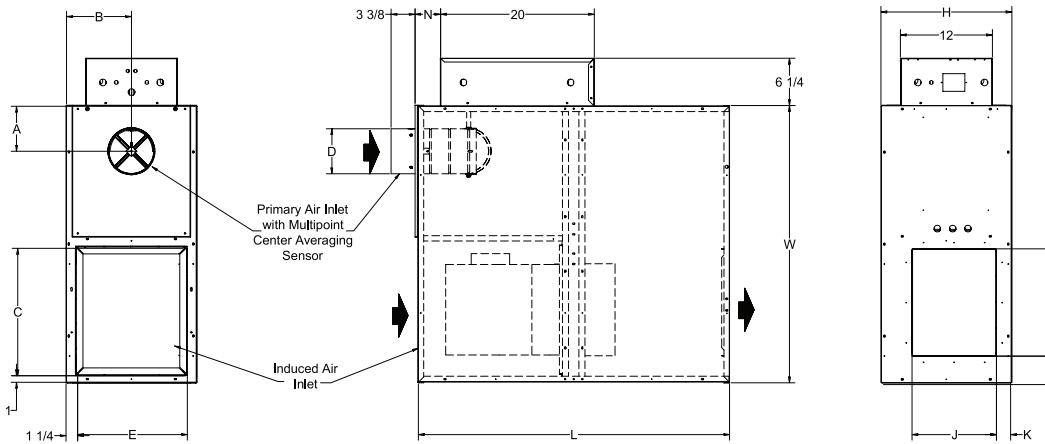

\* Size 414 not available with pneumatic controls.

All dimensions are in inches. Filter size is for unit without attenuator.

Model TQP Parallel Unit															
Size	Inlet Size	A	B	C	D	E	F	G	H	J	K	L	W	N	Filter Size
2, 3	6	6	8 9/16	16 3/4	5 7/8	14 1/2	14	3 1/2	17 1/8	11	2 1/8	40 7/8	36 1/8	2 7/8	19x17
	8	6			7 7/8									2 7/8	
	10	7			9 7/8									4 7/8	
4	8	6			7 7/8									2 7/8	
	10	7			9 7/8									4 7/8	
	12	8			11 7/8									4 7/8	
	*14	10	13 7/8	6 7/8											
5	10	7	10 1/16	24 1/2	9 7/8	17 1/2	16 1/2	9 1/2	20 1/8	14 1/2	3 1/8	46 7/8	48 1/8	4 7/8	27x20
	12	8			11 7/8									4 7/8	
	14	10			13 7/8									6 7/8	
	16	11			15 7/8									6 7/8	

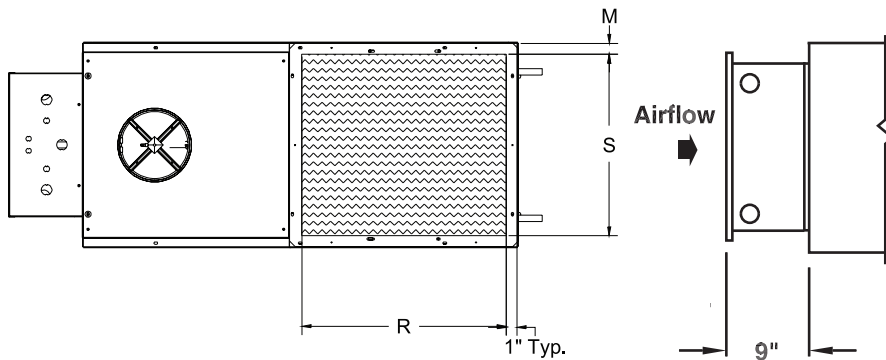

Hot Water Coil Section (Inlet Mounted)

\* Note: R and S are inside dimensions.

Unit Size	M (2 ROW)	R	S
2, 3, 4	1 1/4	17	15
5	1 1/4	25	17

All dimensions are in inches.

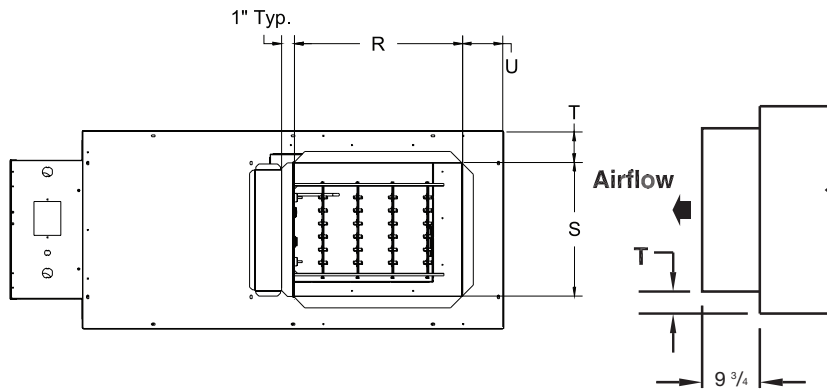

Electric Coil Section (Discharge Mounted)

### Supply Voltage

- 277V / 1 ph / 60 Hz
- 480V / 3 ph / 60 Hz (4 wire wye only)

\* Note: R and S are inside dimensions.

Unit Size	R	S	T	U
2, 3, 4	14	11	2 1/8	1
5	16 1/2	14 1/2	3 1/8	6

Note: Coil control box replaces standard terminal unit control box.  
All dimensions are in inches.

### TQP HOT WATER COIL SECTION

#### STANDARD FEATURES

- 1/2" copper tubes
- Aluminum ripple fins, 10 per inch
- Connections: Male solder, 1 row 5/8", 2 row 5/8"; right hand only
- Galvanized steel casing
- Flanged duct connection
- Coil is installed at induced air inlet

#### Coil Rows

- 2 Row

### TQP ELECTRIC COIL SECTION

#### STANDARD FEATURES

- Automatic reset thermal cutouts, one per element
- Single point electrical connection
- Positive pressure airflow switch
- Flanged duct connection
- Coil is installed at discharge of unit
- Disconnect switch, door interlock type
- Preset P/E switches with pneumatic units

### ELECTRICAL DATA

Unit Size	Motor Horse-power	Motor Amperage Ratings
		277/1/60 FLA
2	1/6	1.3
3	1/4	2.2
4	1/3	2.9
5	1/3	3.2

FLA = Full Load Amperage, as tested in accordance with UL 1995.

277 voltage motors are used with 480 volt / 3 phase coil (4 wire wye).



Inlet Size	Total cfm Range	TITUS II, IIA Pneumatic Controller		TITUS TA1 Analog Electronic Controller	
		Minimum	Maximum	Minimum	Maximum
6	0-500	*80-330	150-500	*80-500	80-500
8	0-900	*145-590	265-900	*145-900	145-900
10	0-1400	*230-925	415-1400	*230-1400	230-1400
12	0-2000	*325-1330	600-2000	*325-2000	325-2000
14	0-3000	*450-1800	840-3000	*450-3000	450-3000
16	0-4000	*580-2350	1100-4000	*580-4000	580-4000

## PRIMARY AIR CFM RANGES

\* Factory cfm settings (except zero) will not be made below this range because control accuracy is reduced. On pressure dependent units, minimum cfm is always zero and there is no maximum.

## PRIMARY AIR INLET PRESSURES • PTQP, ATQP, DTQP

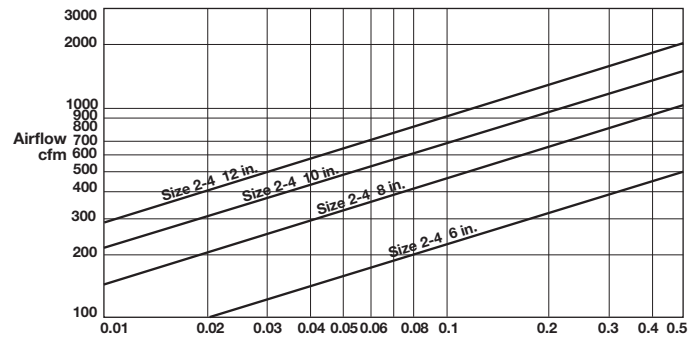
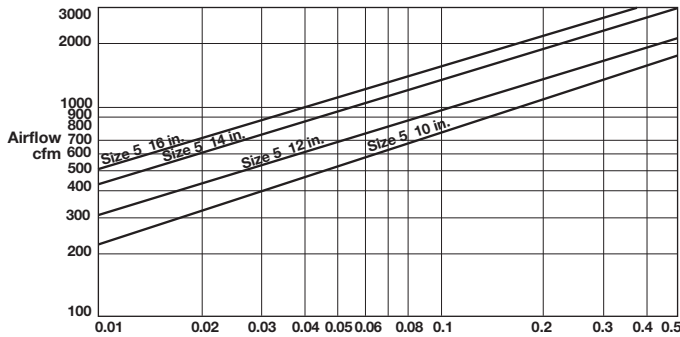

REQUIRED MINIMUM INLET STATIC PRESSURE, INCHES WG.

## MODELS: PTQP, ATQP, DTQP • AIRFLOW VS. DOWNSTREAM STATIC PRESSURE

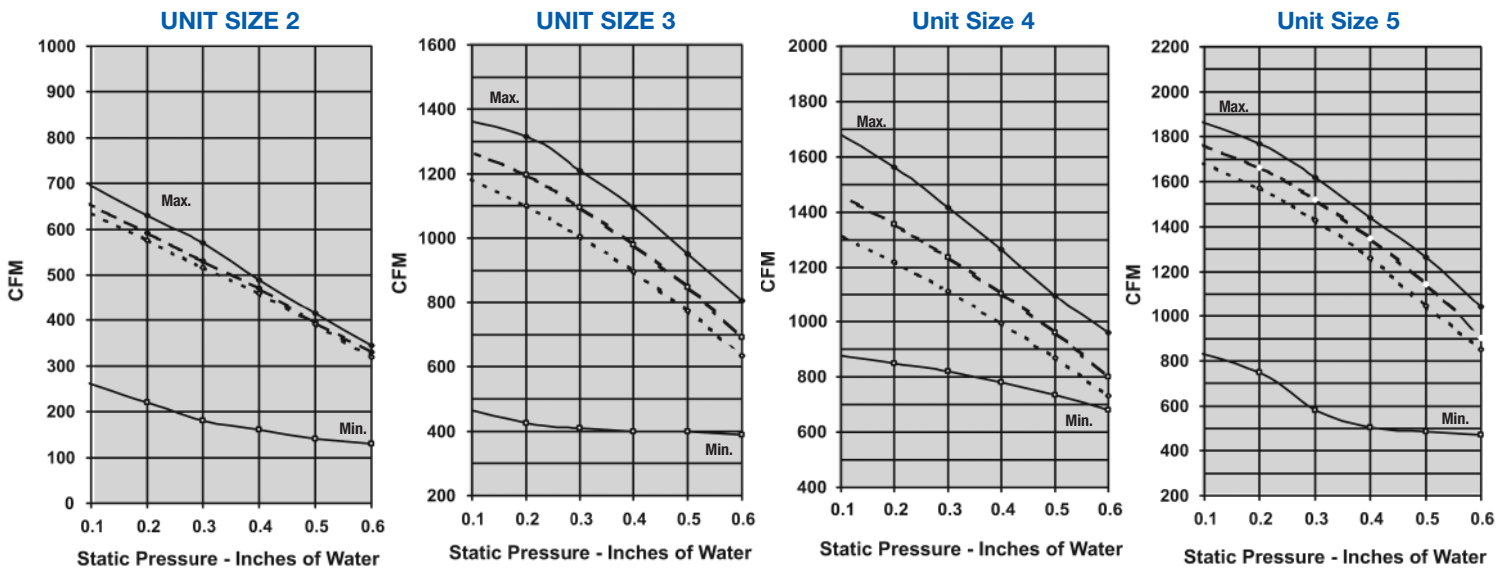

No Coil or with Electric Coil ———  
 1 Row Water Coil - - - - -  
 2 Row Water Coil ·····



# VAV Terminals/Digital, Analog Electronic and Pneumatic Controls

## DDC ELECTRONIC CONTROLS

### ADW MOUNTS AND WIRES DDC CONTROLS

Save money and time. Need a fast turnaround on single duct or fan-powered terminals, with DDC controls mounted, wired and ready to go? ADW has experience mounting almost every brand of DDC controls on Titus terminals, using factory-generated wiring diagrams. Call us today!

## ANALOG ELECTRONIC CONTROLS

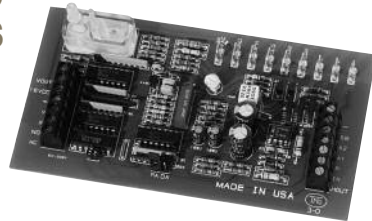

### CONTROLLER FEATURES

- Multi-point, center averaging velocity sensor for accuracy
- Platinum/ceramic flow through transducer for reliability
- Snaptrack mounting for easy serviceability
- One model handles all standard control strategies
- Pressure independent VAV damper control
- Constant or intermittent fan stage sequencing
- Operates up to three stages of reheat
- Controls 0–10 Vdc proportional hot water valves
- Controls 24 Vac on/off auxiliary heat
- Automatic changeover capability
- Temperature setback available

### THERMOSTAT FEATURES

- Contains all adjustments for easy balancing
- Bi-metallic temperature indicator
- Minimum, maximum, and auxiliary flow limit adjustments
- Live velocity readout terminal
- Tamper-proof cover with hidden setpoint sliders

### ACTUATOR FEATURES

- 24 Vac tri-state damper actuator
- Rugged construction
- No stall design featuring magnetic clutch
- Linkage release button
- 50 in.-lb. minimum torque rating
- 5 minute full stroke time

## PNEUMATIC CONTROLS



### CONTROLLER FEATURES

- Accurate control over a duct velocity range of 0–3000 fpm
- Operates at low system pressures; as effective at 0.03" Ps as at 6.0" Ps
- Pressure independent
- Reset span remains constant regardless of maximum and minimum cfm adjustments; the factory set 5 psi span is adjustable from 3 -10 psi to match any thermostat
- Reset start point is adjustable from 3–13 psi to work with accessories such as reheat coils (factory setting is 8 psi)
- Thermostat switch changes the action from direct acting to reverse acting without additional calibration; no additional relays required—great for quick retrofit installation
- Damper switch changes the operation of the control from normally open to normally closed without re-calibration; no additional relays required
- All adjustments are made with a hex shanked knob stored in the face of the TITUS II controller
- Operates on a control air pressure of 15–25 psi
- Control air consumption is no more than 1.2 scfh



## ML/MLF MODULINEAR ALUMINUM DIFFUSERS

**ML-38 • 3/4" Slot**  
**ML-39 • 1" Slot**

- Titus® modulinear diffusers are designed for variable air volume systems; they project a uniform blanket of air that adheres to the ceiling even at low flow rates
- Both the direction and volume of the discharge air can be adjusted gradually by moving the pattern controllers (see diagrams)
- Full 180° pattern controller adjustment means there are no "lefts" or "rights"; specifying, ordering, and installing are simplified
- Finish: White border, black pattern controllers

### BORDER TYPE 2A

- Flange border  
concealed mounting

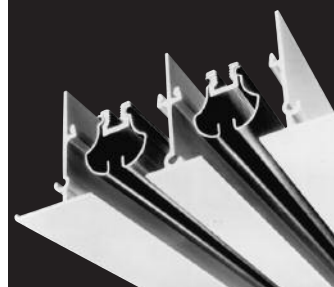

Type	A	O
2A	1 1/8"	D' + 3/4"

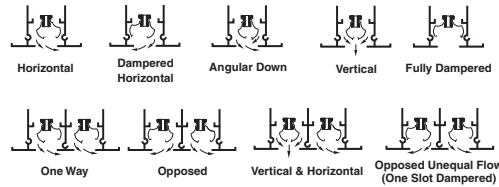
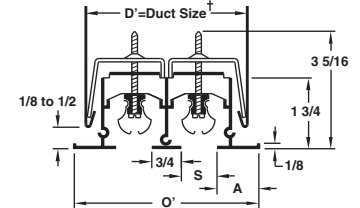

Model ML Border Type 2A (fits 4ft. T-bar span)	
ML38	4ft. 1-Slot
ML38	4ft. 2-Slot
ML39	4ft. 1-Slot
ML39	4ft. 2-Slot

Model MLF Field Cut Length Border Type 2A (includes field spacer kit)	
MLF38	6ft. 1-Slot
MLF38	6ft. 2-Slot
MLF39	6ft. 1-Slot
MLF39	6ft. 2-Slot

Individual End Borders (for hard ceilings)	
MLEB38	Brdr. 1-Slot
MLEB38	Brdr. 2-Slot
MLEB39	Brdr. 1-Slot
MLEB39	Brdr. 2-Slot

Field Spacer Kit (one req'd per cut)	
MLFS38	Kit 1-Slot
MLFS38	Kit 2-Slot
MLFS39	Kit 1-Slot
MLFS39	Kit 2-Slot

## MPI MODULINEAR DIFFUSER PLENUMS (INSULATED)

- Fits Models ML, MLF, MLR, and MLRF
- End caps can be turned to allow installing the MPI on continuous runs of ML diffusers
- Can be used as supply or ducted return
- Galvanized steel construction

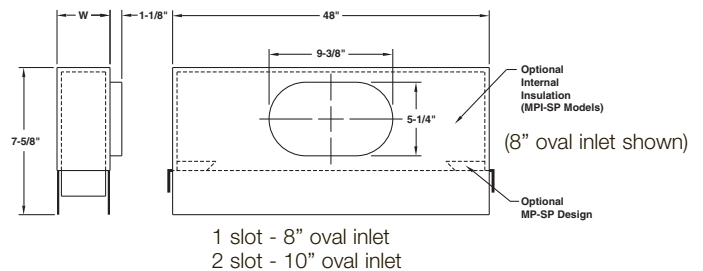
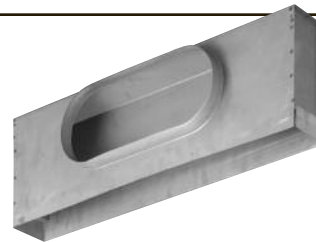

Model MP Border Type 2A	
MP38	4ft. 1-Slot
MP38	4ft. 2-Slot
MP39	4ft. 1-Slot
MP39	4ft. 2-Slot

ML	W Width	
	Number of Slots	
	1	2
MP38	2 7/16"	3 15/16"
MP39	2 11/16"	4 7/16"

## TBD-80

### MODEL TBD-80

- Adjustable pattern control
- Steel construction
- Face painted black
- Trim frames available - see page 19



Model	Size	Neck	Slot Width	Type	Width
TBD-80	24	6	1 1/2"	1-Slot	3"
TBD-80	24	8	1 1/2"	1-Slot	3"
TBD-80	36	8	1 1/2"	1-Slot	3"
TBD-80	48	8	1 1/2"	1-Slot	3"
TBD-80	48	10	1 1/2"	1-Slot	3"
TBD-80	48	12	1 1/2"	2-Slot	6"
TBD-80	60	12	1 1/2"	1-Slot	3"

# PAS

## MODEL PAS

- Adjustable pattern control
- Flush face
- Steel construction
- Border Type 3 - T-bar lay-in
- Finish is #26 white



Model	Size	Neck	Type	Border
PAS	12 x 12	6	Supply	3
PAS	20 x 20	6	Supply	3
PAS	20 x 20	8	Supply	3
PAS	20 x 20	10	Supply	3
PAS	20 x 20	12	Supply	3
PAS	20 x 20	14	Supply	3
PAS	24 x 24	6	Supply	3
PAS	24 x 24	8	Supply	3
PAS	24 x 24	10	Supply	3
PAS	24 x 24	12	Supply	3
PAS	24 x 24	14	Supply	3
PAS	24 x 24	16	Supply	3

# PCS

## MODEL PCS

- Adjustable pattern control
- Flush face
- Steel construction
- 4-way pattern
- Border Type 3 - T-bar lay-in
- Finish is #26 white

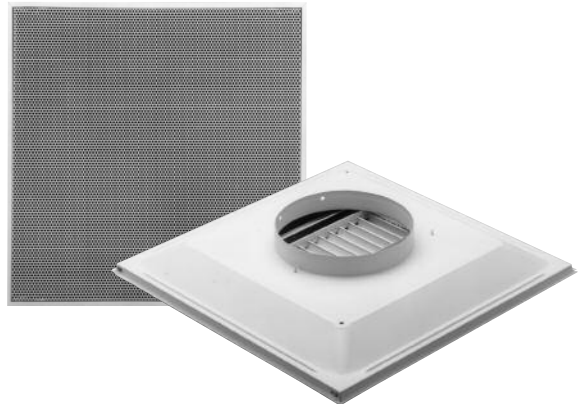

Model	Size	Neck	Type	Border
PCS	12 x 12	6	Supply	3
PCS	24 x 24	6	Supply	3
PCS	24 x 24	8	Supply	3
PCS	24 x 24	10	Supply	3
PCS	24 x 24	12	Supply	3
PCS	24 x 24	14	Supply	3
PCS	24 x 24	16	Supply	3



## PAR

### MODEL PAR

- Removable face
- Steel construction
- Flush face
- Border Type 3 - T-bar lay-in
- Finish is #26 white

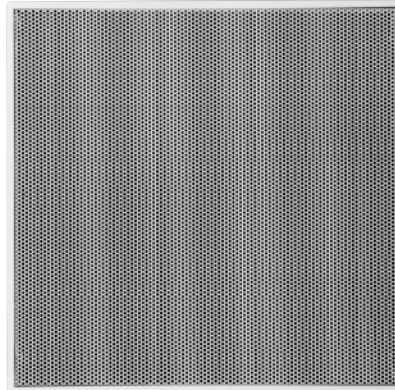

Model	Size	Neck	Type	Border
PAR	12 x 12	10 x 10	Return	3
PAR	20 x 20	18 x 18	Return	3
PAR	24 x 12	22 x 10	Return	3
PAR	24 x 24	22 x 22	Return	3

## PXP

### MODEL PXP

- Non-removable face
- Steel construction
- Flush face
- Border Type 3 - T-bar lay-in
- Return does not include pattern control
- Finish is #26 white

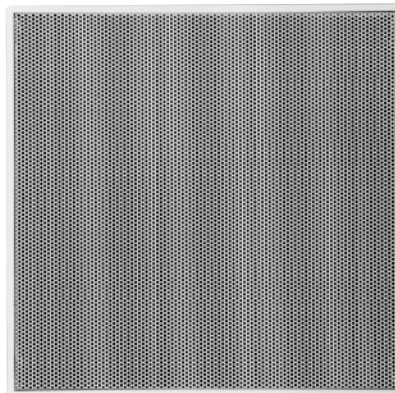

Model	Size	Neck	Type	Border
PXP	20 x 20	—	Return	3
PXP	24 x 12	—	Return	3
PXP	24 x 24	—	Return	3



## TMR

### ROUND CEILING-TWO HORIZONTAL DISCHARGE PATTERNS

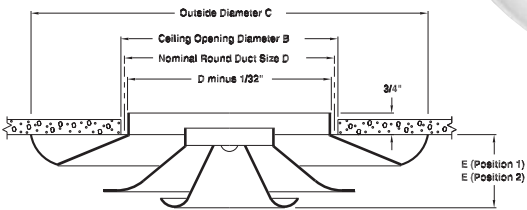

**Note:**

Position 1 is with cones down.  
Position 2 is with cones up.

Nominal Round Duct Size D	B	C	E (Pos. 1)	E (Pos. 2)
6	6 <sup>1</sup> / <sub>2</sub>	11 <sup>1</sup> / <sub>8</sub>	1 <sup>3</sup> / <sub>4</sub>	1 <sup>1</sup> / <sub>8</sub>
8	8 <sup>1</sup> / <sub>2</sub>	14 <sup>3</sup> / <sub>4</sub>	2 <sup>1</sup> / <sub>8</sub>	1 <sup>1</sup> / <sub>2</sub>
10	10 <sup>1</sup> / <sub>2</sub>	18 <sup>1</sup> / <sub>4</sub>	2 <sup>7</sup> / <sub>8</sub>	2 <sup>1</sup> / <sub>8</sub>
12	12 <sup>1</sup> / <sub>2</sub>	22	3 <sup>1</sup> / <sub>8</sub>	2 <sup>3</sup> / <sub>8</sub>
14	14 <sup>1</sup> / <sub>2</sub>	26	3 <sup>3</sup> / <sub>8</sub>	2 <sup>5</sup> / <sub>8</sub>
16	16 <sup>1</sup> / <sub>2</sub>	29	4	3 <sup>1</sup> / <sub>4</sub>

#### MODEL TMR

- All sizes have three cones, giving a uniform appearance where different sizes are used in the same area
- The two horizontal discharge settings allow the diffuser to be adjusted for two different flow rate conditions; at Position 1, maximum capacity is obtained; at Position 2, induction is increased
- Retainer cable provided to allow the inner core assembly to hang during maintenance of diffusers with a neck size of 12" or greater
- Material is steel with steel screws
- Standard finish: #26 white

#### MODEL TDC SQUARE DIFFUSERS • RECTANGULAR NECK

## TDC

- Removable core
- Steel construction
- Flush face
- 1, 2, 3 and 4-Way cores stocked. Call for availability.
- Border Type 1 - surface mount
- Border Type 3 - T-bar lay-in
- Border Type 6 - beveled
- Finish is #26 white

Model	Size	Neck	Border	Pattern
TDC	—	6 x 6	1	4-Way
TDC	—	9 x 9	1	4-Way
TDC	—	12 x 12	1	4-Way
TDC	—	15 x 15	1	4-Way
TDC	—	18 x 18	1	4-Way
TDC	24 x 24	6 x 6	3	4-Way
TDC	24 x 24	9 x 9	3	4-Way
TDC	24 x 24	12 x 12	3	4-Way
TDC	24 x 24	15 x 15	3	4-Way
TDC	24 x 24	18 x 18	3	4-Way
TDC	—	6 x 6	6	4-Way
TDC	—	9 x 9	6	4-Way
TDC	—	12 x 12	6	4-Way
TDC	—	15 x 15	6	4-Way
TDC	—	18 x 18	6	4-Way

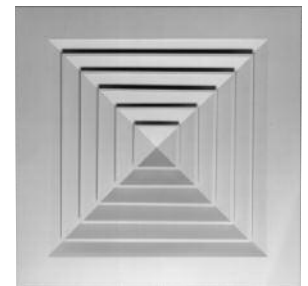

Standard 4-Way core

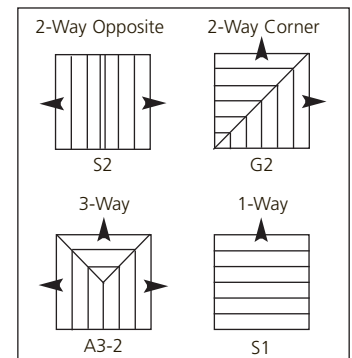

All dimensions are in inches.

## TMS/ TMSA

### MODELS TMS AND TMSA SQUARE DIFFUSERS

- Border Type 3 - T-bar lay-in
- Finish is #26 white
- TRM frame available for surface mount (see pg. 19)



Model	Size	Neck	Border
TMS	12 x 12	6	3
TMS	12 x 12	8	3
TMS	20 x 20	8	3
TMS	20 x 20	10	3
TMS	24 x 24	6	3
TMS	24 x 24	8	3
TMS	24 x 24	10	3
TMS	24 x 24	12	3
TMS	24 x 24	14	3
TMS	24 x 24	15	3

Model	Size	Neck	Border
TMSA	12 x 12	6	3
TMSA	12 x 12	8	3
TMSA	24 x 24	6	3
TMSA	24 x 24	8	3
TMSA	24 x 24	10	3
TMSA	24 x 24	12	3
TMSA	24 x 24	14	3
TMSA	24 x 24	15	3

## OMNI

### MODEL OMNI ARCHITECTURAL DIFFUSERS

- Border Type 3 - T-bar lay-in
- Finish is #26 white
- TRM frame available for surface mount (see pg. 19)

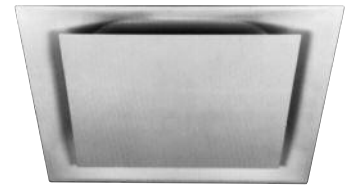

Model	Size	Neck	Border
OMNI	12 x 12	6	3
OMNI	12 x 12	8	3
OMNI	24 x 24	6	3
OMNI	24 x 24	8	3
OMNI	24 x 24	10	3
OMNI	24 x 24	12	3
OMNI	24 x 24	14	3
OMNI	24 x 24	15	3

## T3SQ

### MODEL T3SQ THERMAL VAV DIFFUSER

- Thermally powered, no power supply required
- Varies air volume to space based upon supply air temperature, cooling/heating setpoint, and room temperature setpoint
- Measures room temperature at diffuser, no wall thermostat required
- Adjustable minimum airflow
- Border Type 3- T-bar lay-in
- Finish is #26 White
- TRM frame available for surface mount (see pg. 19)



Model	Size	Neck	Border
T3SQ	24 x 24	8	3
T3SQ	24 x 24	10	3
T3SQ	24 x 24	12	3

# D-100

**MODEL D-100  
ROUND DAMPERS**

- Diffuser mounting
- Radial steel construction

Model	Size
D-100	6
D-100	8
D-100	10
D-100	12
D-100	14

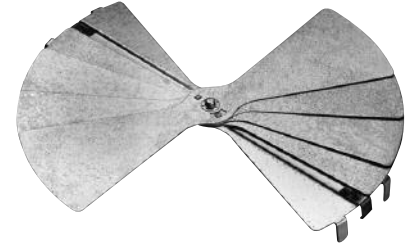

# D-75

**MODEL D-75  
ROUND DAMPERS**

- Neck mounting
- Opposed blade
- Steel construction

Model	Size
D-75	6
D-75	8
D-75	10
D-75	12



# AG-95

**MODEL AG-95  
SQUARE AND  
RECTANGULAR  
DAMPERS**

- Diffuser mounting
- Opposed blade
- Steel construction

Model	Size
AG-95	6 x 6
AG-95	9 x 9
AG-95	12 x 12
AG-95	15 x 15
AG-95	18 x 18



# TRM

**MODEL TRM  
RAPID MOUNT FRAME**

- Aluminum construction
- Finish is #26 white
- For adapting lay-in diffusers to hard ceilings

Model	Module Size
TRM	12 x 12
TRM	17 7/8 x 17 7/8
TRM	20 x 20
TRM	24 x 12
TRM	24 x 24
TRM	48 x 24
TRM	24 x 3
TRM	36 x 3
TRM	48 X 3

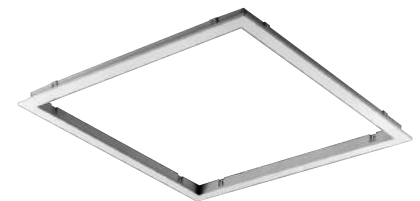

## 300RS

### MODEL 300RS

- Short front blades
- Double deflection
- Steel construction
- Adjustable blades

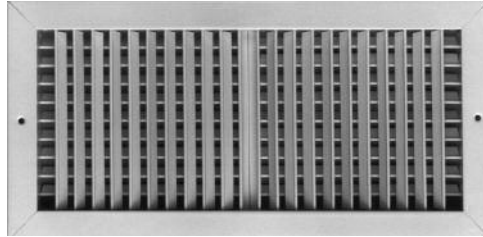

- Border Type 1 - 1 1/4" border; 3/4" blade spacing; steel AG-15 damper supplied when ordered with grille; surface mount with screw holes; finish is #26 white.

		W											
H	Model	Size	6	8	10	12	14	16	18	20	24	30	36
	300RS	4	x	x	x	x					x		
	300RS	6	x	x	x	x	x	x	x	x	x	x	x
	300RS	8		x	x	x	x	x	x	x	x	x	x
	300RS	10			x	x	x	x	x	x	x	x	x
	300RS	12				x	x	x	x	x	x	x	x

x = in stock

## 350RL

### MODEL 350RL

- Long front blades
- 35° deflection
- Steel construction

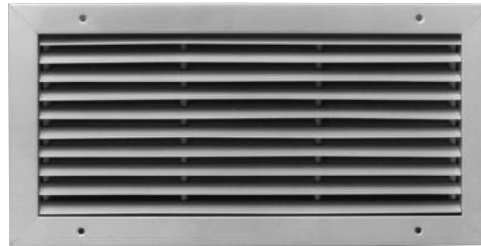

- Border Type 1 - 1 1/4" border; 3/4" blade spacing; surface mount with screw holes; finish is #26 white.
- Border Type 3 - same features as Border Type 1, less screw holes. Module size is +2".

Filter returns available in limited sizes.

#### Border 1

		W										
H	Model	Size	6	8	10	12	14	16	18	24	36	48
	350RL	4		x								
	350RL	6	x	x	x	x						
	350RL	8		x	x	x	x					
	350RL	10			x	x	x					
	350RL	12				x	x		x	x		
	350RL	14					x					
	350RL	16						x				
	350RL	18				x			x			
	350RL	24								x	x	x

#### Border 3

		W			
H	Model	Size	10	22	46
	350RL	10	x	x	
	350RL	22		x	x

x = in stock

## 50F

### MODEL 50F

- Grid core is 1/2" x 1/2" x 1/2"
- Aluminum construction

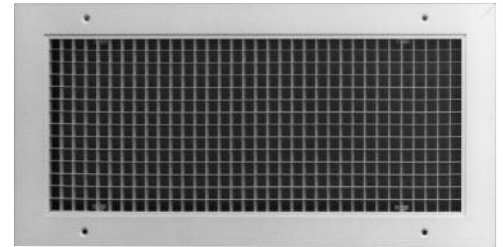

#### Border 1

H	W	
	Model	Size
	50F	6x6
	50F	8x8
	50F	8x14
	50F	10x8
	50F	10x10
	50F	10x12
	50F	10x14
	50F	10x18
	50F	12x12
	50F	14x14
	50F	16x16
	50F	18x12
	50F	18x14
	50F	18x18
	50F	20x20
	50F	24x24
	50F	48x24

#### Border 3

H	W	
	Model	Size
	50F	6x22
	50F	10x10
	50F	10x22
	50F	22x22
	50F	46x22

#### Filter Returns Lay-in

20 x 20    24 x 24

x = **in stock**  
Border = **1** or **3**

## AG-15

### MODEL AG-15

- Grille mounting
- Opposed blade
- Steel construction
- Mill finish



H	W	
	Model	Size
	AG-15	6x6
	AG-15	8x4
	AG-15	8x6
	AG-15	8x8
	AG-15	10x6
	AG-15	10x10
	AG-15	12x10
	AG-15	12x12
	AG-15	14x6
	AG-15	14x14
	AG-15	16x16
	AG-15	18x10
	AG-15	18x12
	AG-15	18x18
	AG-15	20x8
	AG-15	20x10
	AG-15	22x10
	AG-15	24x12

## CFDR

### CEILING RADIATION DAMPERS

Model CFDR
6" Ø
8" Ø
10" Ø
12" Ø
14" Ø

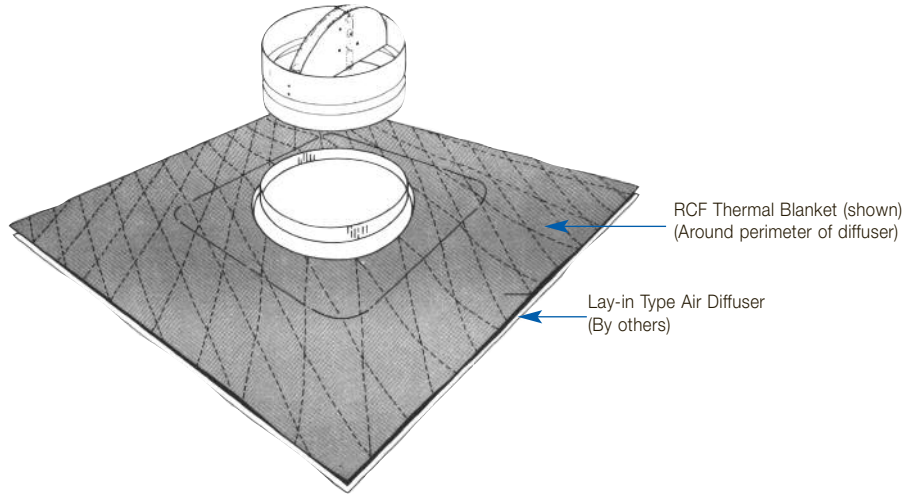

## IBD-20

### STYLE R CURTAIN TYPE FIRE DAMPERS

#### APPLICATION

The Model IBD-20 can be installed vertically in walls or horizontally in concrete floors with fire resistance ratings of less than 3 hours. The IBD-20 carries a 1-1/2 hour UL fire damper label and is classified as static damper for use in HVAC systems that shut down during a fire.

- Frame Sleeve or 20 gauge x 1/2" galvanized, steel channel
- Vertical or horizontal installation
- Closure Springs
- Fusible Link



SIZE
D
6
8
10
12
14

Duct collars are normally fabricated approximately 1/8" (3) less than given duct dimensions. Style R consists of duct collar centered on end of frame or sleeve as shown below.

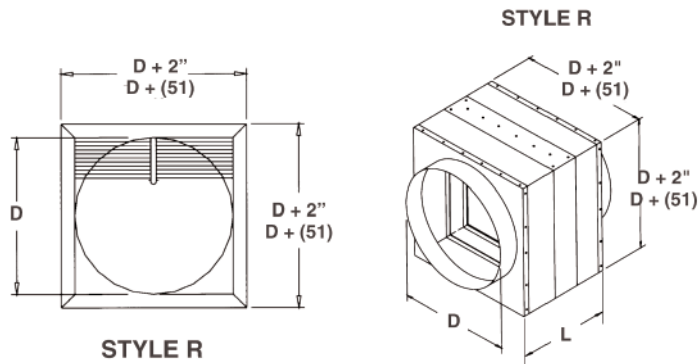

**HIGH PRESSURE  
ACCESS DOOR  
FOR  
SHEET METAL**

- Low leakage
- Quick installation
- Safe entry and exit

<b>Extremely Low Leakage</b>	
Operating Pressure	Leakage Rate* All door sizes
6" wg	less than .10 cfm
10" wg	less than .25 cfm
20" wg	less than .50 cfm
*Sheet metal access door. Tested by an independent ADC Certified Laboratory.	

<b>Nominal Door Size - A</b>	<b>Min. Hole Cut Size*</b>
8"	7 1/8"
10"	9 1/8"
12"	11 1/8"
18"	17 1/8"
24"	23 1/8"
*Tolerance = + 1/8"	



**ACCESS DOORS MODEL ADH/ADC  
HINGED OR DOUBLE  
CAM LOCK**

<b>Standard Specifications</b>	
Frame	22 ga. gal. steel
Door	24 ga. gal. steel
Insulation	1" thick fiberglass
Gaskets	1/4" X 1/2" polyurethane foam
Latches	Zinc plated sash type Zinc plated steel strikes
<b>Stock Doors</b>	
6 X 6	8 X 8 10 X 10
12 X 12	14 X 14 16 X 16
18 X 18	24 X 24

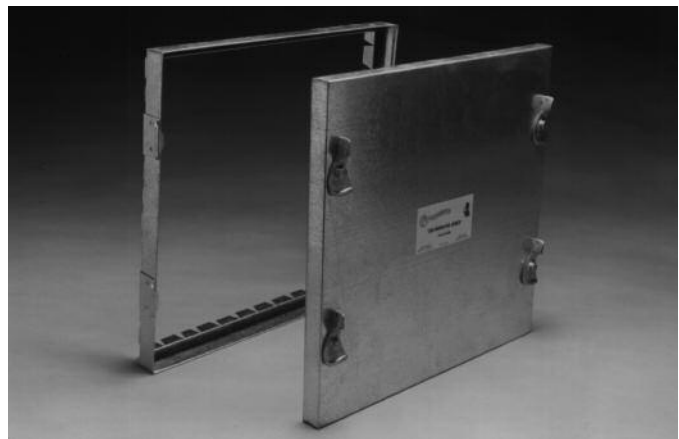

- Model ADC, double cam doors, in sizes larger than 14" X 14" have four cam latches
- Model ADH, hinged doors, in sizes larger than 14" X 14" have two cam latches
- Frame sizes shown are nominal, actual opening sizes are 1 1/4" smaller



- Doors are ideally suited for new installation or for remodeling, in masonry, tile, wood or other wall surfaces. Door features rounded safety corners.
- Door and frame are fabricated from 16 gauge, galvanized steel with a prime coat finish.
- Frame is one piece construction, 1" wide and provides perfect concealment of the rough wall opening. Wall frame is provided with 1/4" mounting holes for fastening within the furred spaces, allowing faster installation and giving maximum clearance.
- Concealed Pivoting Rod Hinge prevents distortion and closes door squarely. Doors 24" or larger are provided with a continuous piano hinge.
- Latch is screwdriver operated.
- Finish is a prime coat suitable for painting.

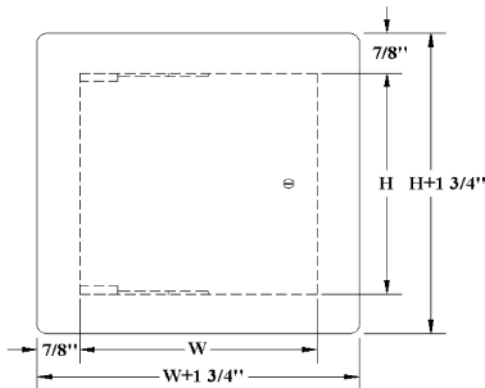
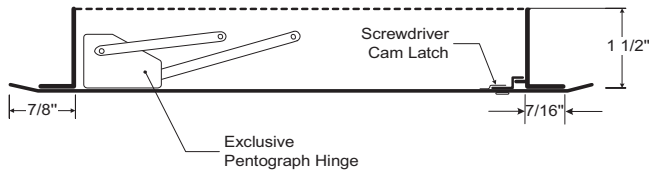

### MODEL NUMBER AND OPTIONS SELECTION

- -DW Dry Wall Access Door
- -CL Cylinder Lock (one per door)

### STANDARD AVAILABLE SIZES

NOMINAL DOOR SIZE (W x H)	WALL OPENING	NO. OF LATCHES	WT. PER DOOR (LBS)
DW 6" x 6"	6-1/2" x 6-1/2"	1	3
DW 8" x 8"	8-1/2" x 8-1/2"	1	3
DW 10" x 10"	10-1/2" x 10-1/2"	1	4
DW 12" x 12"	12-1/2" x 12-1/2"	1	5.5
DW 14" x 14"	14-1/2" x 14-1/2"	1	6
DW 16" x 16"	16-1/2" x 16-1/2"	1	7.5
DW 18" x 18"	18-1/2" x 18-1/2"	3	9
DW 24" x 24"	24-1/2" x 24-1/2"	3	15

NOTE: 1. Wall opening sizes are minimum required.  
2. Special sizes available upon request.

### NOTES:

1. Overall outside size
2. Concealed pivoting rod hinge
3. Wall frame
4. Screwdriver operated latch
5. 1/4" mounting holes

Dimensions are subject to manufacturer's tolerance of plus or minus 1/4" and change without notice.



## 240 REMOTE CABLE CONTROL SYSTEM

The 240 Remote Cable Control System by Young Regulator provides control of low pressure balancing dampers in inaccessible areas by a 1/4" rotary motion flexible steel shaft.

Applications include dampers in the inlet slot or square face diffusers and branch take-off. Radial round dampers or opposed rectangular dampers are controlled with cables in standard lengths of 3 and 8 feet. The cable runs in the airstream and is usually terminated in the opening of the air duct. The assembly is provided in one piece and is simple to install.

### FEATURES

- #240-RC Cable Control Assembly Controls round or rectangular dampers with heavy 1/4" flexible cable connected to 13/32" damper shaft
- #D100 Radial Dampers Sizes 6"-14"
- #821RC Rectangular Aluminum Opposed Blade Damper with individual blade bushings
- East adjustment with 031 Balancing Wrench

### OPTIONS

- Longer or odd size lengths of cable
- Other mounting controls and hardware
- Commercial dampers with 1/2" round shaft

### Note

For a locking type rack and pinion system, see #270 Bowden Controls. For optional dampers, see the Young Regulator catalog.

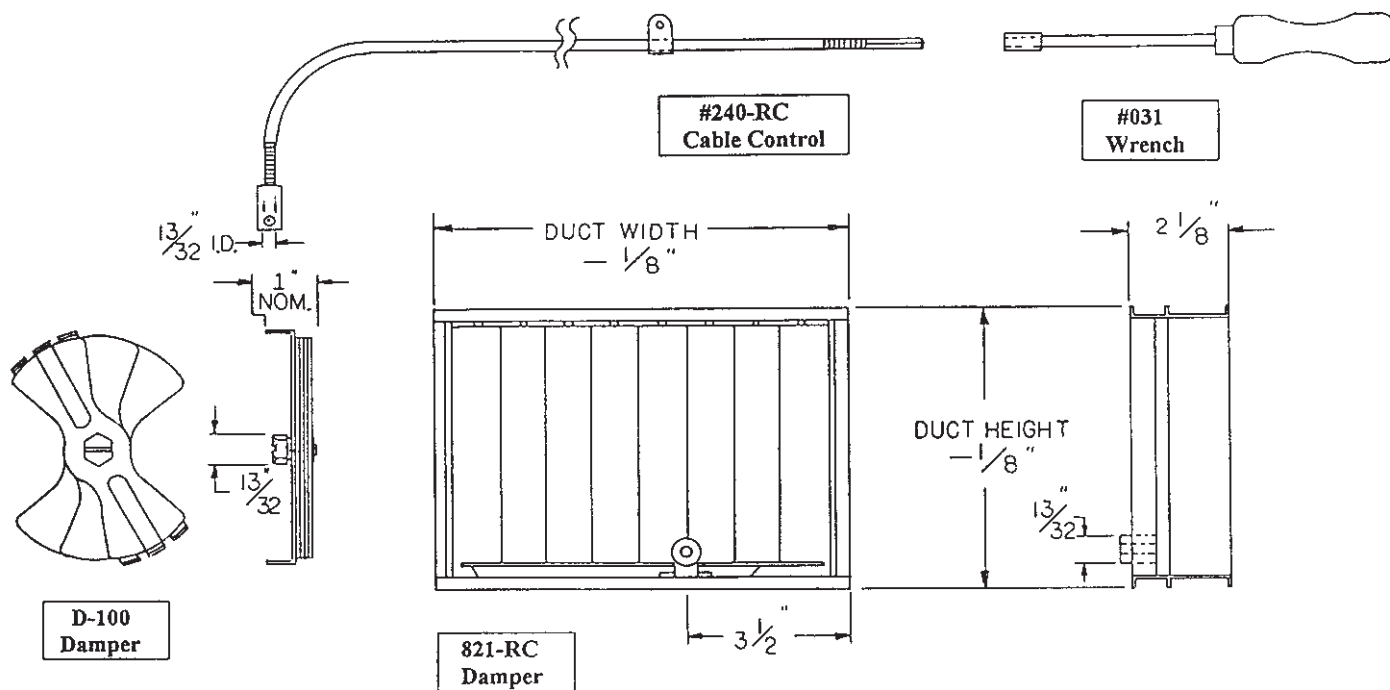

## 301

### 301 CONCEALED DAMPER REGULATORS

The Young 301 3/8" concealed locking regulator is designed to control dampers from the ceiling line. The 301 may be used with either our 820A-C rectangular or our 5020-B round bottom duct mounted damper. It may also be used in combination with our 927 and 1200 right angle controls on any round or rectangular side control damper, including Young 5020 and 820 Series. The 301 regulator is embedded in the ceiling so that the unit is flush with the finished surface. It is 2 5/8" in diameter and 15/16" deep, with a 3" cover plate which covers the joint between box and plaster. The cover plate, which should be removed before plastering, is held in place by two 6-32 x 5/8" machine screws that are easily removed for damper adjustment.

The 301 is operated by our 04 wrench, available separately, which fits the end of the 3/8" damper rod. 301 must be used with 3/8" rod. A variety of adapters and couplings for use with rods of other dimensions is available.

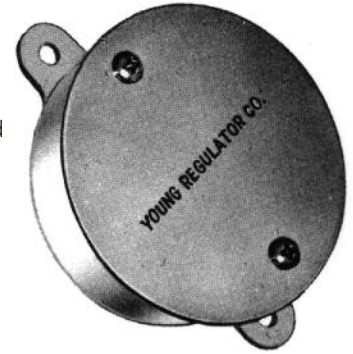

#### OPTIONS INCLUDE:

- Cover plate is available in either zinc plated or polished chrome finish. Please specify on your order.
- Cover plate can be furnished in 3-3/4" diameter for a small additional charge. Please specify on your order.
- Our 980 tamper-proof screws and 982 tamper proof screw tool (available separately) may be used to secure the cover plate when limited access to the control is desired.

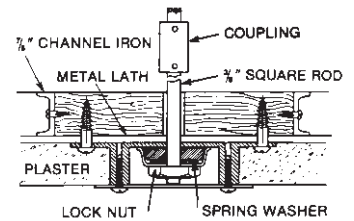

### 301 CONCEALED DAMPER REGULATORS

## 927 Miter Gears

Young 927 miter gears are used when the operating shaft must be carried down at a right angle to the damper shaft. Two models are available - 927C die cast gears for regular applications and 927B precision cut steel gears for longer life and a variety of heavy-duty applications.

Damper shaft can be either 3/8" square or 1/2" round. Four 1/4-20 mounting bolts and nuts are supplied with each set of miter gears.

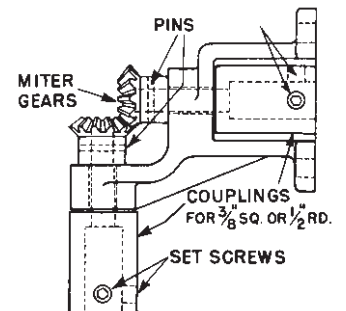

## ACCESSORIES

### COUPLINGS

617 3/8" square to 3/8" square



## REMOTE DAMPER CONTROL

Young Regulator 5020-CC Damper with Bowden damper control assembly

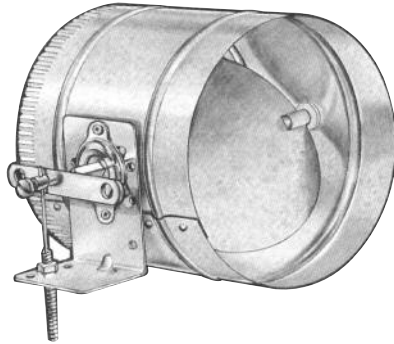

Rack and Pinion Cable Operator #270-275

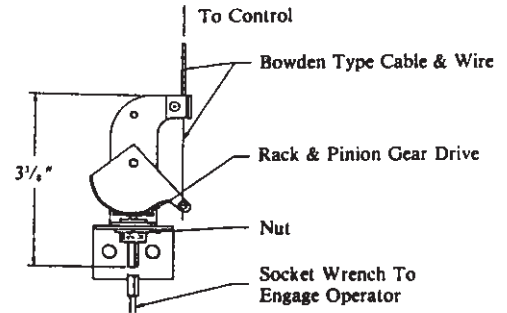

## BOWDEN CABLE CONTROL

BOWDEN CABLE CONTROL

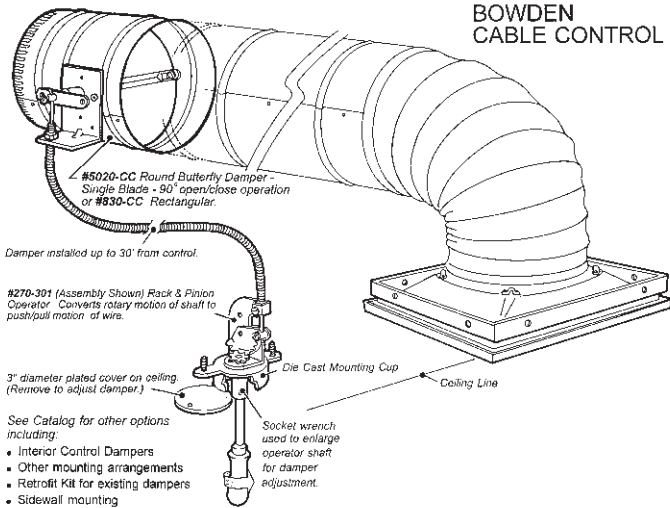

- See Catalog for other options including:
- Interior Control Dampers
  - Other mounting arrangements
  - Retrofit Kit for existing dampers
  - Sidewall mounting

The Bowden System has many features to ensure ease of installation, service and balancing. Its unique design performs optimally for a quiet, efficient and effective air damper system.

## CONTROL MOUNTING OPTIONS

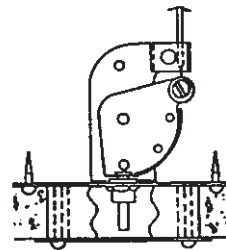

#270-301 Bowden control kit

### OPERATION

5020CC dampers are designed to be operated by any of our 3 Bowden cable control kits, but will also accommodate locking hand quadrant or an electric actuator (by others).

### AVAILABLE SIZES

6", 8", 10", 12"

### SHELL LENGTHS

10" up to 10" diameter dampers  
12" for 12" diameter dampers

**AVAILABILITY:** Warehouse Only

#5020-CC Dampers: 6", 8", 10", 12" and 14" Round

**OPERATORS:** 270-275, 270-301

Bowden Type Cable and Wire: Available in 3 ft., 6 ft., and 10 ft. lengths only.

## 5020 CC Damper

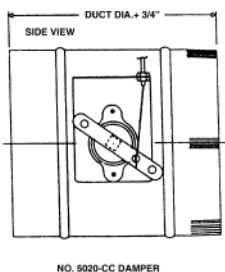

NO. 5020-CC DAMPER

Side View

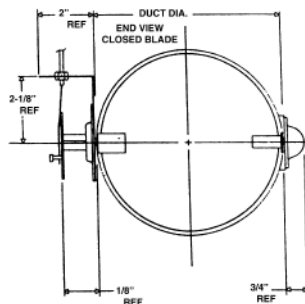

End View

## L100-L300 DIMENSIONS

### CONSTRUCTION FEATURES

Housing constructed of galvanized steel with 1/2" thick acoustic insulation

- Forward curved, dynamically balanced, polymeric centrifugal wheel for quiet, efficient performance
- Integral plug-type disconnect
- Thermal protected, permanently lubricated, continuous duty direct drive motor mounted on vibration isolators
- Ceiling or wall installation
- 8 position mounting bracket
- Integral back draft damper

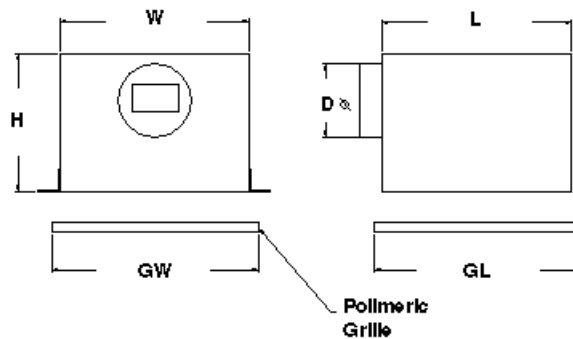
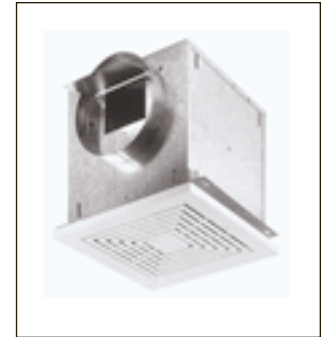

## L400-L500 DIMENSIONS

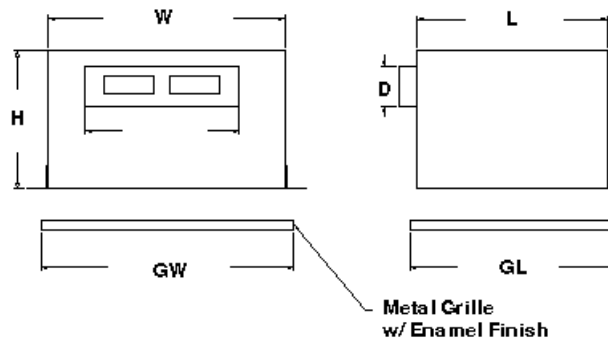

### Models

Model	Volt/Phase	FLA	CFM Range
L100	120/60/1	1.0	10-136
L150	120/60/1	1.2	30-181
L200	120/60/1	1.6	25-231
L250	120/60/1	2.0	75-272
L300	120/60/1	2.6	100-312
L400	120/60/1	1.3	25-480
L500	120/60/1	2.0	125-538
961L	Inline Kit for Model L100,150		
981L	Inline Kit for Model L200, 250, 300		
982L	Inline Kit for Model L400,500		
57W	Speed Control, White, for L100-500		

### Dimensions

Model	H	W	L	GW	GL	D
L100	11.75	12.25	12.25	14	14	6
L150	11.75	12.25	12.25	14	14	6
L200	11.75	12.25	12.25	14	14	8
L250	11.75	12.25	12.25	14	14	8
L300	11.75	12.25	12.25	14	14	8
L400	11.75	12.25	12.25	23.25	14	18.5 x 4.5
L500	11.75	12.25	12.25	23.25	14	18.5 x 4.5

## FLEX DUCT

Flexmaster flexible duct sets the standard in quality and dependability. Manufactured without glue or adhesives, the mechanical-locked inner core maintains its shape at all 90° bends and offsets. This flexible duct has the highest performance credentials of any flexible duct. Flexmaster USA's 20 year warranty is unsurpassed in the HVAC ductwork industry.

- UL181 Class 1
- Flame/Smoke: 25/50
- Operating Temp: -20 to +250 F
- Vapor Barrier: ASTM E96, Procedure A



### Flexmaster 8M Flex Duct - R6 Insulation

Model	Size
R68M06	6"
R68M08	8"
R68M10	10"
R68M12	12"
R68M14	14"
R68M16	16"
TYE Wrap B6-50	



## ROOF CURBS

SF12-12 x 12
SF12-14.5 x 14.5
SF12-17.5 x 17.5
SF12-19.5 x 19.5
SF12-22.5 x 22.5
SF12-26.5 x 26.5

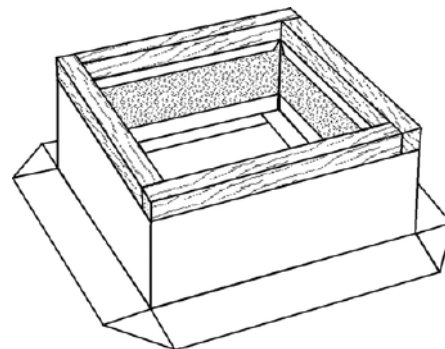

- 20 gauge galvanized steel construction
- With 2x2 wood nailer and damper tray
- With 1 1/2" internal insulation
- 12" standard height

## DH100

### DH100ACDCI SPECIFICATIONS

- [Ionization Technology](#)
- [Voltage](#)  
24VAC/DC or 120/240VAC
- [Two DPDT Form-C Relay Contacts](#)
- [Air Velocity Rating](#)  
500 - 4,000 feet per minute
- [Interconnectability for Multi-Fan Shutdown](#)
- [Transparent Cover](#)
- [Built-In Reset Button](#)
- [Dimensions](#)  
5.5"H x 14.38"W x 2.75"D
- [ST3/ST5 Sampling Tubes](#)  
3-foot and 5-foot lengths in stock



The **DH100ACDCI** ionization duct detector is ultra-responsive to submicron-sized smoke particles typically found near a fire source.

## RTS451

### RTS451 SPECIFICATIONS

- [Power Requirements](#)  
Alarm LED: 2.8-32VDC,  
10mA max. Total Current:  
105mA max.
- [Test Switch](#)  
10VA @ 32VDC
- [Reset Switch](#)  
10VA @ 32VDC
- [Alarm Response Time](#)  
40 seconds max.
- [Temperature Range](#)  
-10°C to 60°C (14°F to 140°F)
- [Wire Gauge](#)  
14 to 18AWG
- [Dimensions](#)  
4.6"H x 2.75"W x 1.8"D



The **RTS451** automatic fire detector accessory is designed to test remotely located duct detectors.

## SSK451

### SSK451 SPECIFICATIONS

- [Voltage](#)  
24VDC
- [Power Requirements](#)  
Standby: 8mA  
Trouble: 16mA  
Alarm without strobe: 40mA  
Alarm with strobe: 65mA
- [Sounder](#)  
87dBA at ten feet
- [Temperature Range](#)  
-10°C to 60°C (14°F to 140°F)
- [Wire Gauge](#)  
14 to 22AWG
- [Dimensions](#)  
4.8"H x 4.7"W x 1.5"D



The **SSK451** multi-signaling accessory is designed for use with System Sensor 4-wire conventional duct smoke detectors. Green, amber and red LEDs provide visual indication of power, trouble and alarm conditions, respectively.



# Line Sheet

Commercial / Industrial HVAC

Representing  
**Quality Products**  
for the HVAC  
Industry



- Air Distribution
- Terminal Units
- Fan Coil Units
- Fan Filter Units
- Displacement Ventilation
- Chilled Beam



- Dampers
- Louvers
- Air Doors
- Sound Attenuators
- Airflow Measurement for IAQ
- Energy Recovery Ventilators



- Commercial Centrifugal Fans
- Axial Style Roof, Wall & Inline Fans



- Split Systems
- Variable Refrigerant Systems



- Gas Fired Space Heaters
- Industrial Make-up Air Units



- Vehicle Exhaust
- FRP Ductwork and Fittings



- Architectural Round Registers
- Spot Diffusers



- Industrial Fans
- Dampers
- Louvers



Custom Operating Room Ceiling Systems



- Humidifiers
- Electric Duct Heaters
- Valves
- Actuators



Custom Fabric Duct Systems



Fire Resistant Ductwork Systems



Gas Detection Systems



- Pipe, Duct & Cable Tray Supports
- Equipment Supports
- Walkways, Stairs & Ramps



- Cable Operated Balancing Dampers
- Electronic Balancing Dampers

In addition to these exclusive manufacturers, ADW Corp also provides products from these other fine companies:

- Qmark
- Sterling
- Gripple
- CaptiveAire
- Zonex
- Warren Heaters
- Kees
- Roof Top Systems
- Chromalox
- Exhausto
- FlexmasterUSA

1445 W. Beltline Road,  
Suite 104  
Carrollton, Texas 75006  
Phone 469 568 6300  
Fax 469 568 6311  
www.adwcorp.com

5500 E Loop 820 S,  
Suite 211  
Fort Worth, Texas 76119  
Phone 817 483 4115  
Fax 817 483 8701  
www.adwcorp.com





## **ADW Corp**

1445 W. Beltline Road  
Suite 104  
Carrollton, Texas 75006  
Phone 469 568 6300  
Fax 469 568 6311

5500 E Loop 820 S  
Suite 211  
Fort Worth, Texas 76119  
Phone 817 483 4115  
Fax 817 483 8701

[www.adwcorp.com](http://www.adwcorp.com)