

Z533 SPEAKER SYSTEM WITH SUBWOOFER

Complete Setup Guide
完整设置指南

完整設定指南
설치 가이드

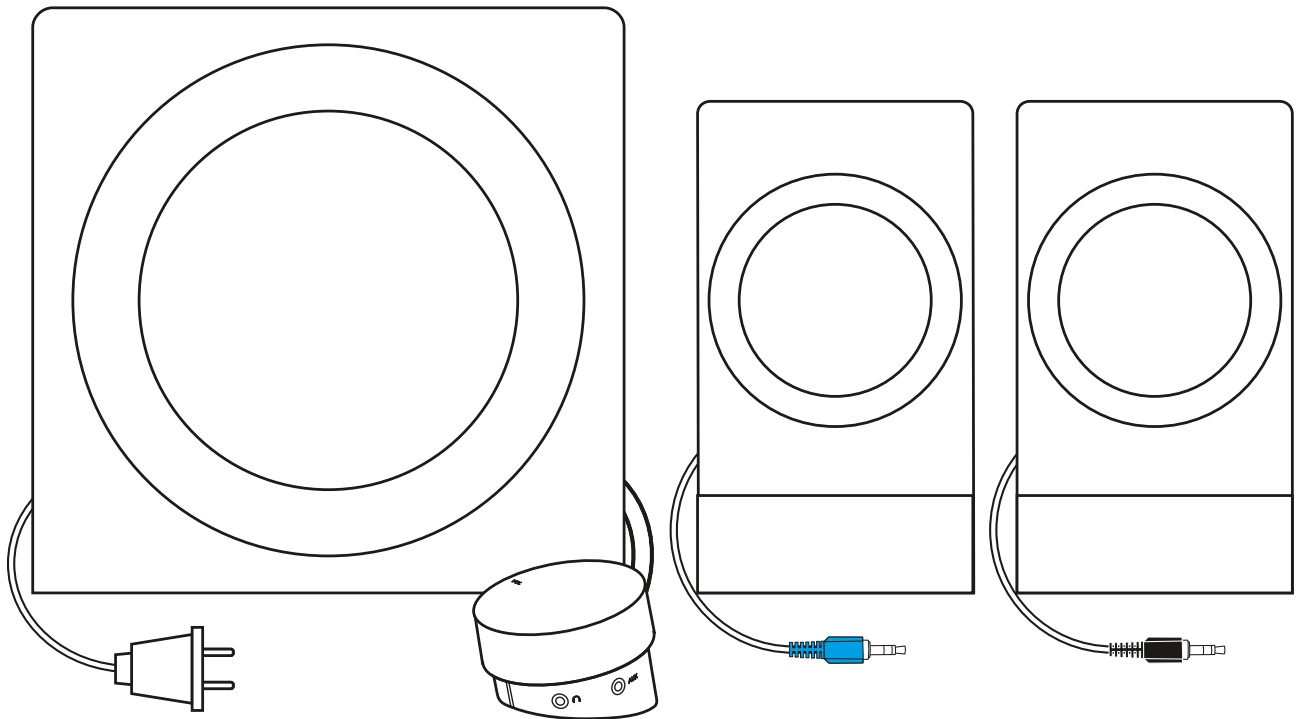

CONTENTS

English3

简体中文8

繁體中文 13

한국어. 18

KNOW YOUR PRODUCT

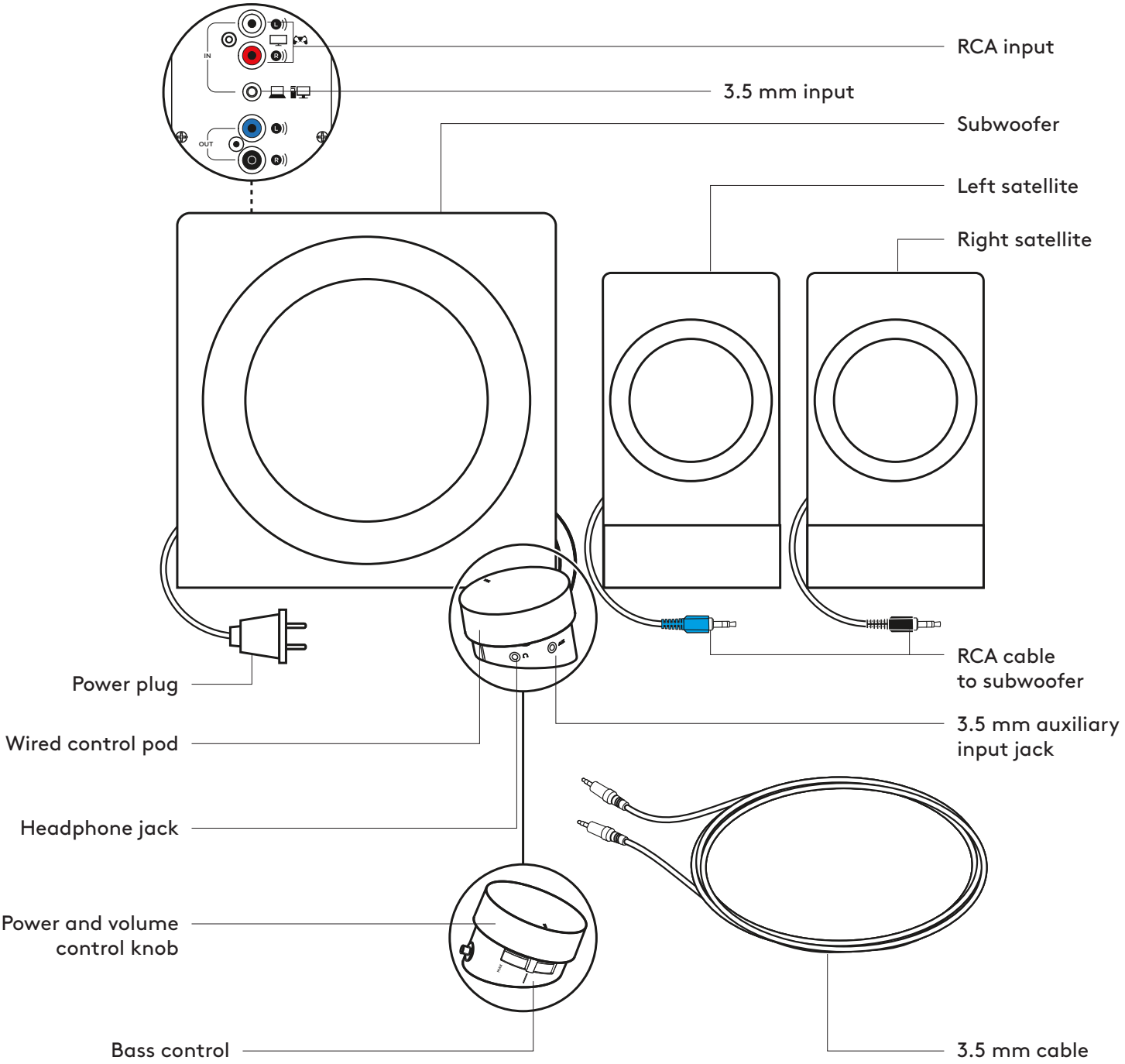

CONNECT THE SPEAKERS

1. Plug the black RCA connector on the right satellite into the black subwoofer jack.
2. Plug the blue RCA connector on the left satellite into the blue subwoofer jack.
3. Plug the power plug into an electrical outlet.

1

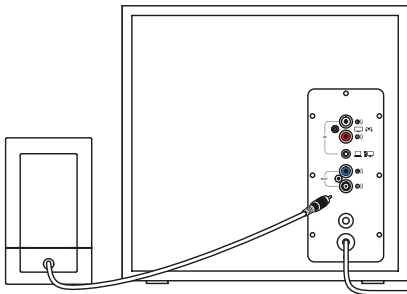

2

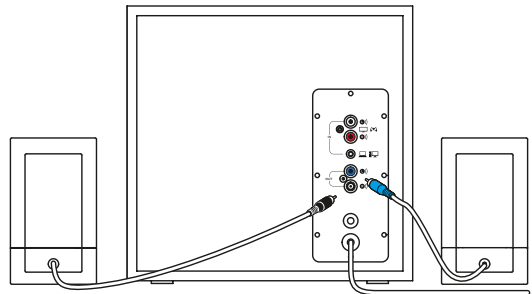

3

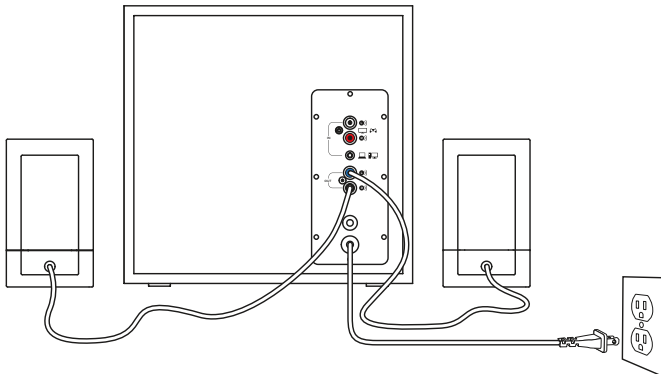

CONNECT TO AUDIO SOURCE

1A. For 3.5 mm connection:

Connect one end of the provided 3.5 mm cable to the corresponding jack on the back of subwoofer or the 3.5 mm jack on the control pod. Insert the other end of the 3.5 mm cable into the audio jack on your device (computer, smartphone, tablet, etc.)

1B. For RCA connection:

Connect one end of the RCA cable to the corresponding RCA jack on the back of subwoofer. Insert the other end of the RCA cable into the RCA outlet on your device (TV, gaming console, etc.)

Note: The RCA cable is not included in the box and must be purchased separately.

2. Plug your headphones into the headphone jack on the control pod. Adjust the volume either from the control pod or the audio source.
3. Power speakers on/off by turning clockwise the volume knob on the control pod. You will notice a “click” sound once the system is ON (the LED in front of the wired remote will also turn on).

1A

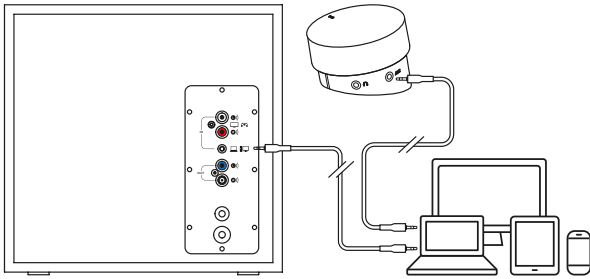

1B

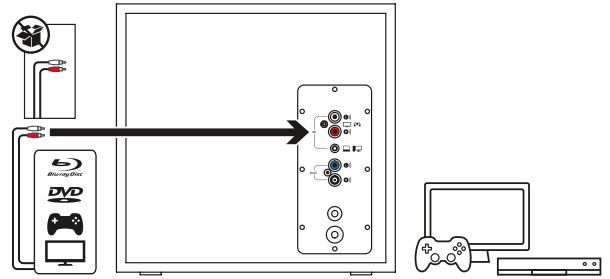

2

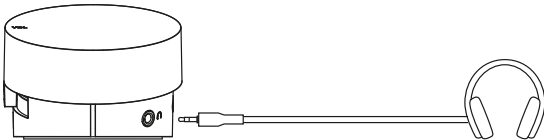

3

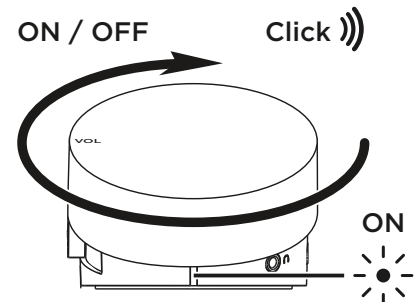

CONNECT TO TWO DEVICES SIMULTANEOUSLY

1. Connect to two devices at the same time through the RCA connector and 3.5 mm input on the back of subwoofer.
2. To switch between audio sources, just pause audio on one connected device and play audio from the other connected device.

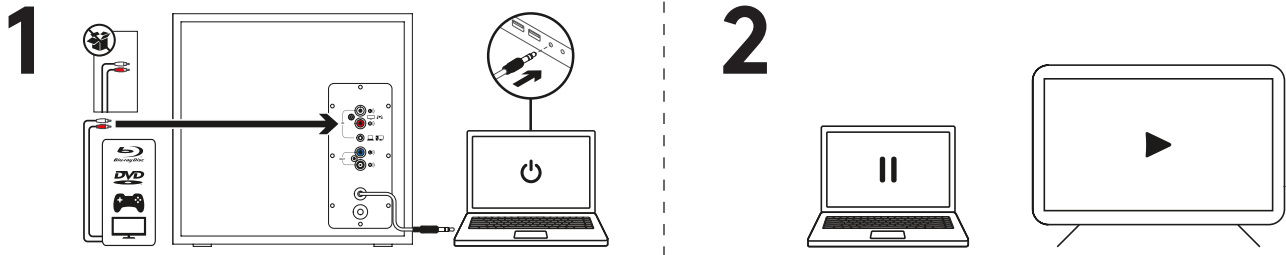

ADJUST THE VOLUME

1. Adjust the volume of Z533 with the knob on the control pod.
Turn the knob clockwise (to the right) to increase volume.
Turn the knob counter-clockwise (to the left) to decrease volume.

ADJUST THE BASS

2. Adjust the bass level by moving the bass slider on the side of the control pod.

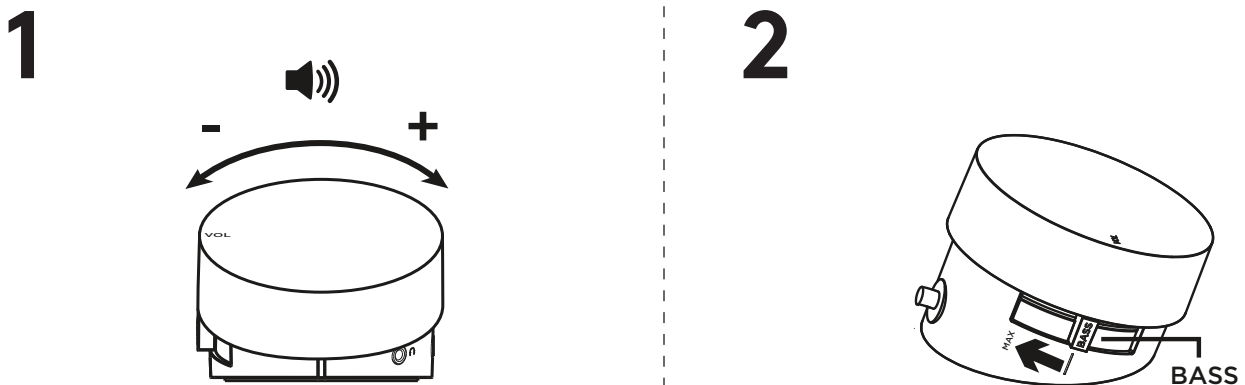

www.logitech.com/support/Z533

了解您的产品

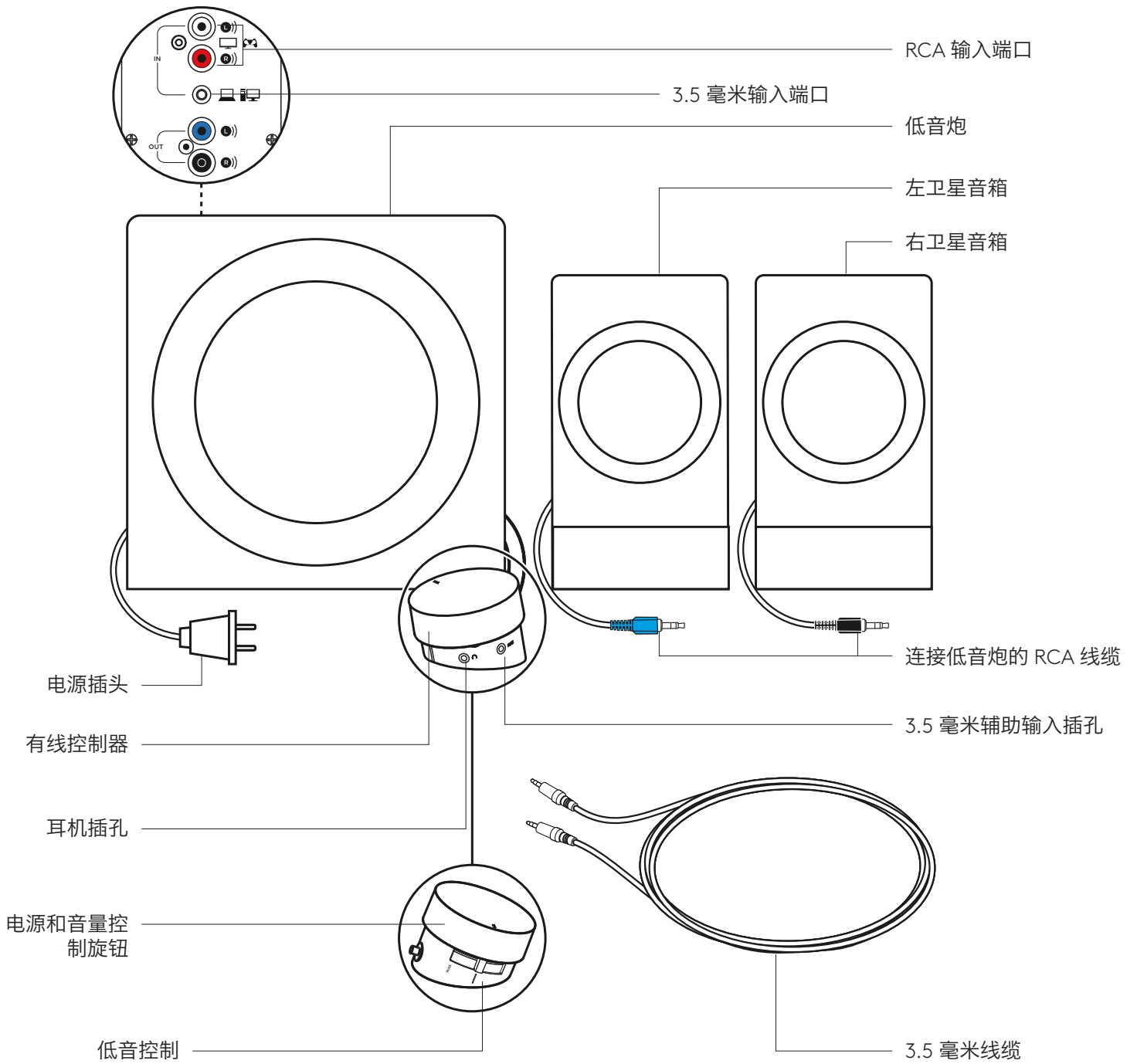

连接音箱

1. 将右侧卫星音箱上的黑色 VGA 插头插入黑色低音炮端口。
2. 将左侧卫星音箱上的蓝色 VGA 插头插入蓝色低音炮端口。
3. 将电源线插入电源插座。

1

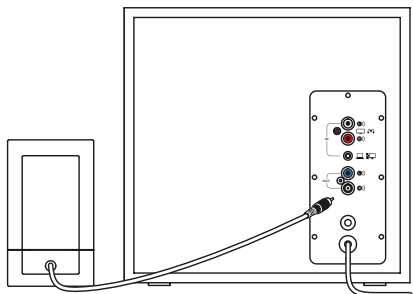

2

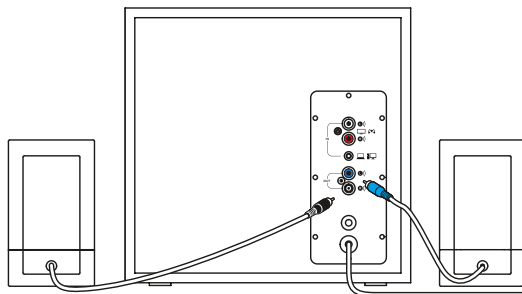

3

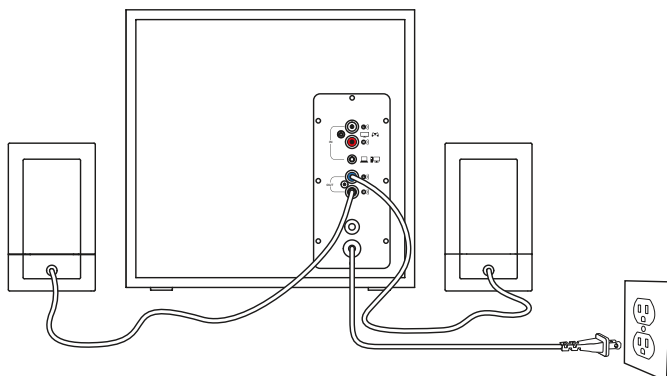

连接音源

1A. 3.5 毫米连接:

将随附的 3.5 毫米线缆的一端连接至低音炮背面的相应插孔或控制器上的 3.5 毫米插孔。

将 3.5 毫米线缆的另一端插入设备的音频插孔 (电脑、智能手机和平板电脑等)

1B. RCA 连接:

将 RCA 线缆的一端连接到低音炮背面的相应 RCA 插孔。将 RCA 线缆的另一端插入设备的 RCA 插孔 (电视、游戏主机等)

注: RCA 线缆未随附, 需另购。

2. 将耳机插入控制器上的耳机插孔。通过控制器或音源调节音量。

3. 顺时针转动控制器的音量旋钮以开启/关闭音箱。系统打开时, 您会听到“咔哒”声 (有线遥控器前方 LED 也会亮起)。

1A

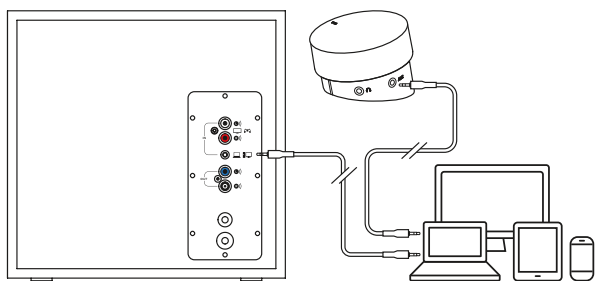

1B

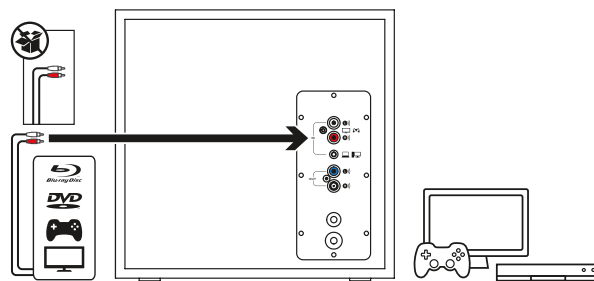

2

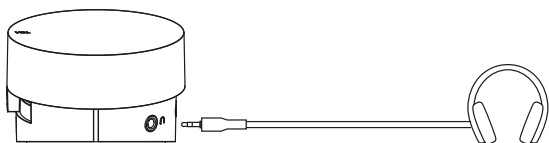

3

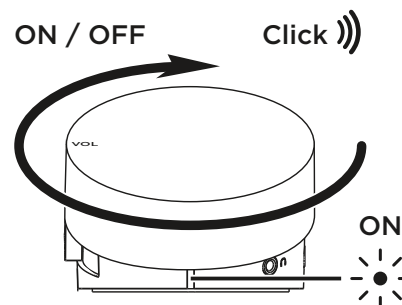

同时连接两台设备

1. 通过 RCA 端口和低音炮背面的 3.5 毫米输入端口可同时连接两台设备。
2. 要在音源之间切换, 只需暂停一台连接设备上的音频, 然后播放来自其他连接设备的音频。

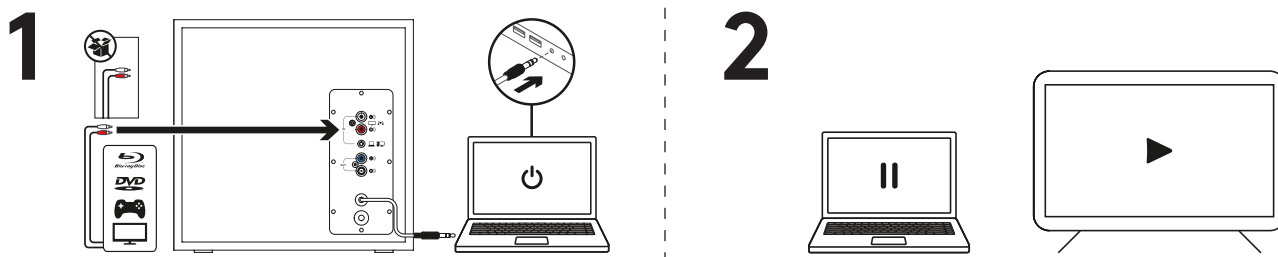

调节音量

1. 使用控制器旋钮调节 Z533 音量。顺时针 (向右) 旋转旋钮可提高音量。逆时针 (向左) 旋转旋钮可降低音量。

调节低音

2. 移动控制盒侧面的低音滑块调节低音音量。

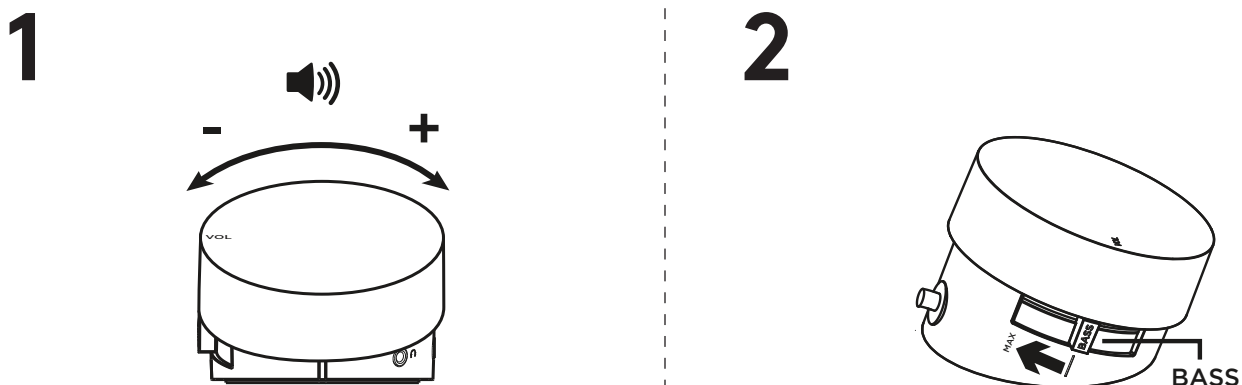

www.logitech.com/support/Z533

版权所有 © 2019 年罗技。罗技、Logi 和其他罗技商标均归罗技所有，并已注册。
所有其他商标均是其各自所有者的财产。罗技对于本手册中可能出现的任何错误不承担任何责任。
本手册中包含的信息如有更改，恕不事先通知。

瞭解您的產品

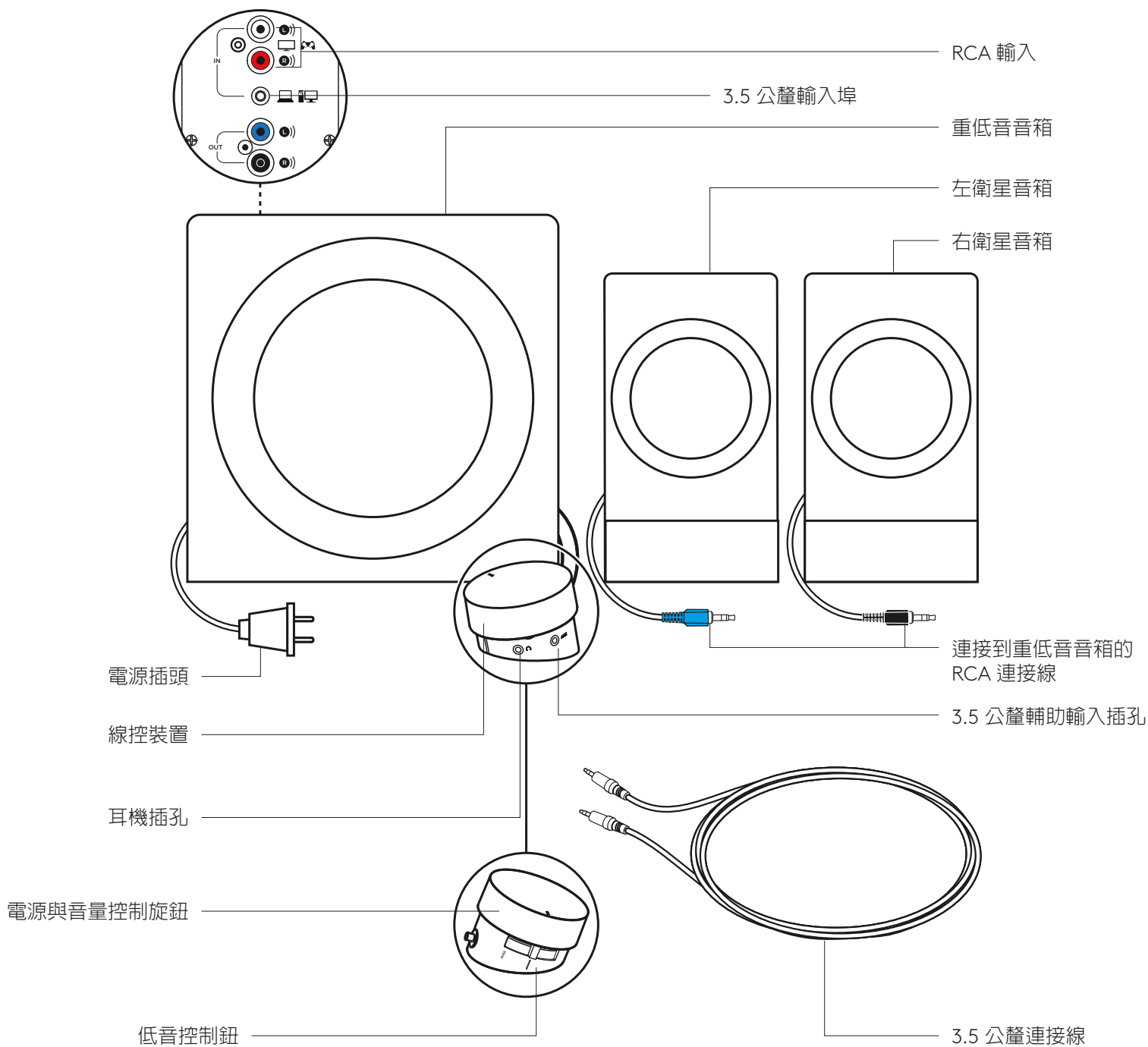

連接音箱

1. 將右衛星音箱的黑色 RCA 接頭插入到黑色重低音音箱插孔。
2. 將右衛星音箱的藍色 RCA 接頭插入到藍色重低音音箱插孔。
3. 將電源插頭插入到電氣插座。

1

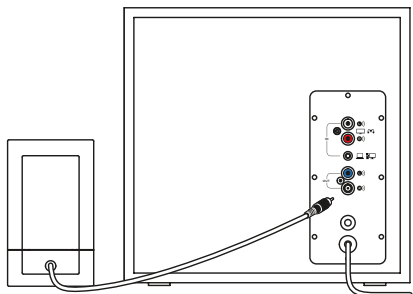

2

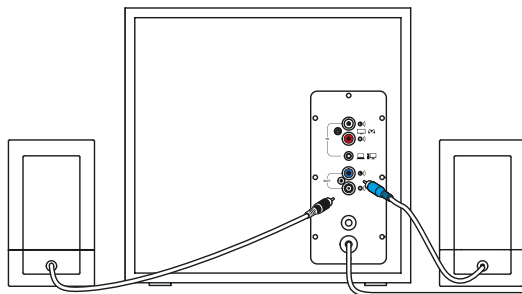

3

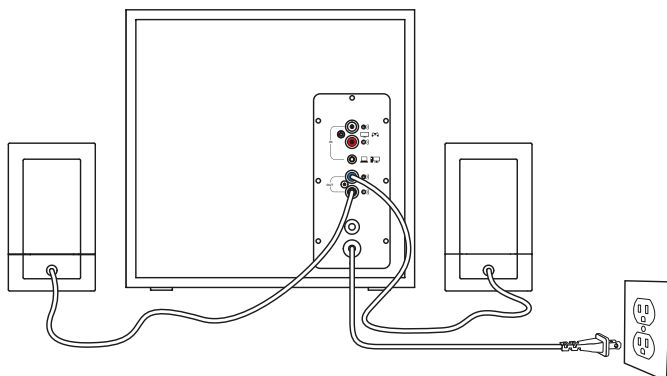

連接到音訊來源

1A. 3.5 公釐連接

將隨附之 3.5 公釐連接線連接到重低音音箱背面對應的插孔，或是線控裝置上的 3.5 公釐插孔。將 3.5 公釐連接線的另一端插入到您裝置 (電腦、智慧型手機、平板電腦等) 上的音訊插孔。

1B. RCA 連接：

將 RCA 連接線的一端連接到重低音音箱背面對應的 RCA 插孔。將 RCA 連接線的另一端，插入到裝置 (電視、遊戲主機等) 上的 RCA 插孔。

注意：包裝盒內未隨附 RCA 連接線，需另購。

2. 將耳機插入到線控裝置上的耳機插孔。利用線控裝置或音訊來源調整音量。

3. 順時針轉動線控裝置上的音量旋轉以開啓/關閉音箱電源。系統開啓電源時，您會聽到「喀嗒」聲 (有線遙控器正面的 LED 也會亮起)。

1A

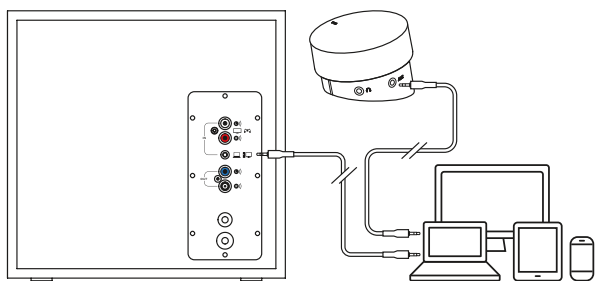

1B

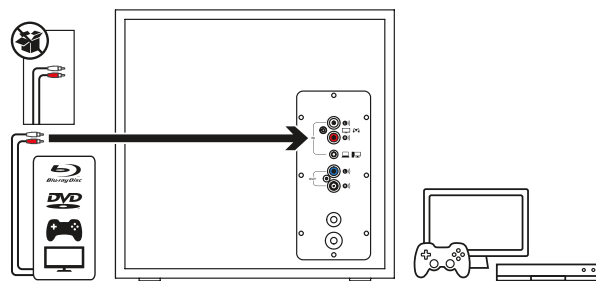

2

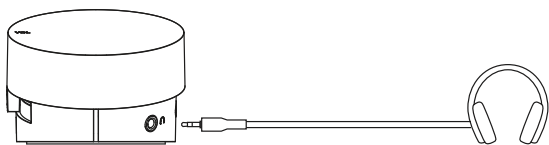

3

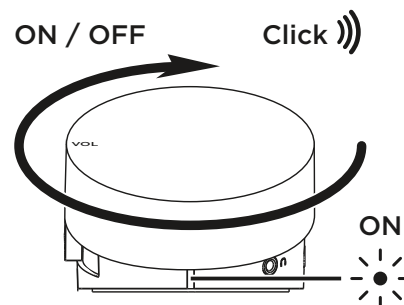

可同時連線到兩台裝置

1. 透過重低音音箱背面的 RCA 接頭和 3.5 公釐輸入埠，可同時連接到兩個裝置。
2. 若要切換音訊來源，只須暫停一個已連接之裝置上的音訊，然後從另一個已連接的裝置播放音訊。

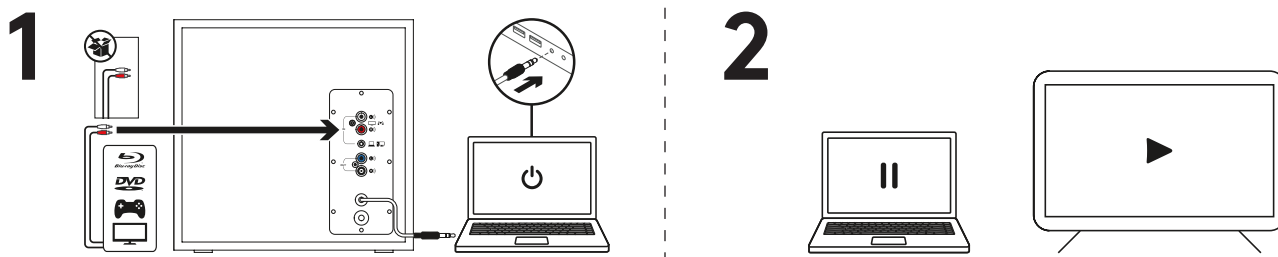

調整音量

1. 使用線控裝置上的控制鈕調整 Z533 的音量。順時針 (向右) 轉動轉鈕可增加音量。逆時針 (向左) 轉動轉鈕可減少音量。

調整低音

2. 滑動線控裝置上的低音滑桿可調整低音音量。

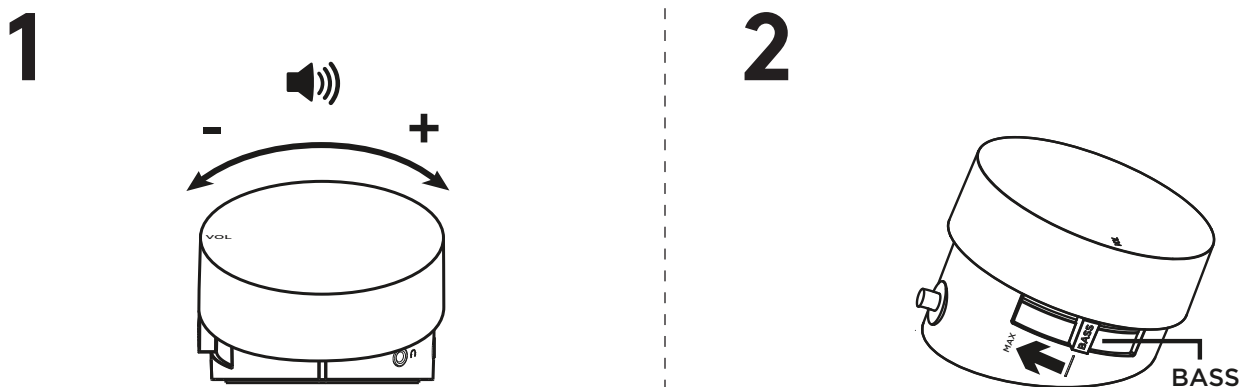

www.logitech.com/support/Z533

제품 설명

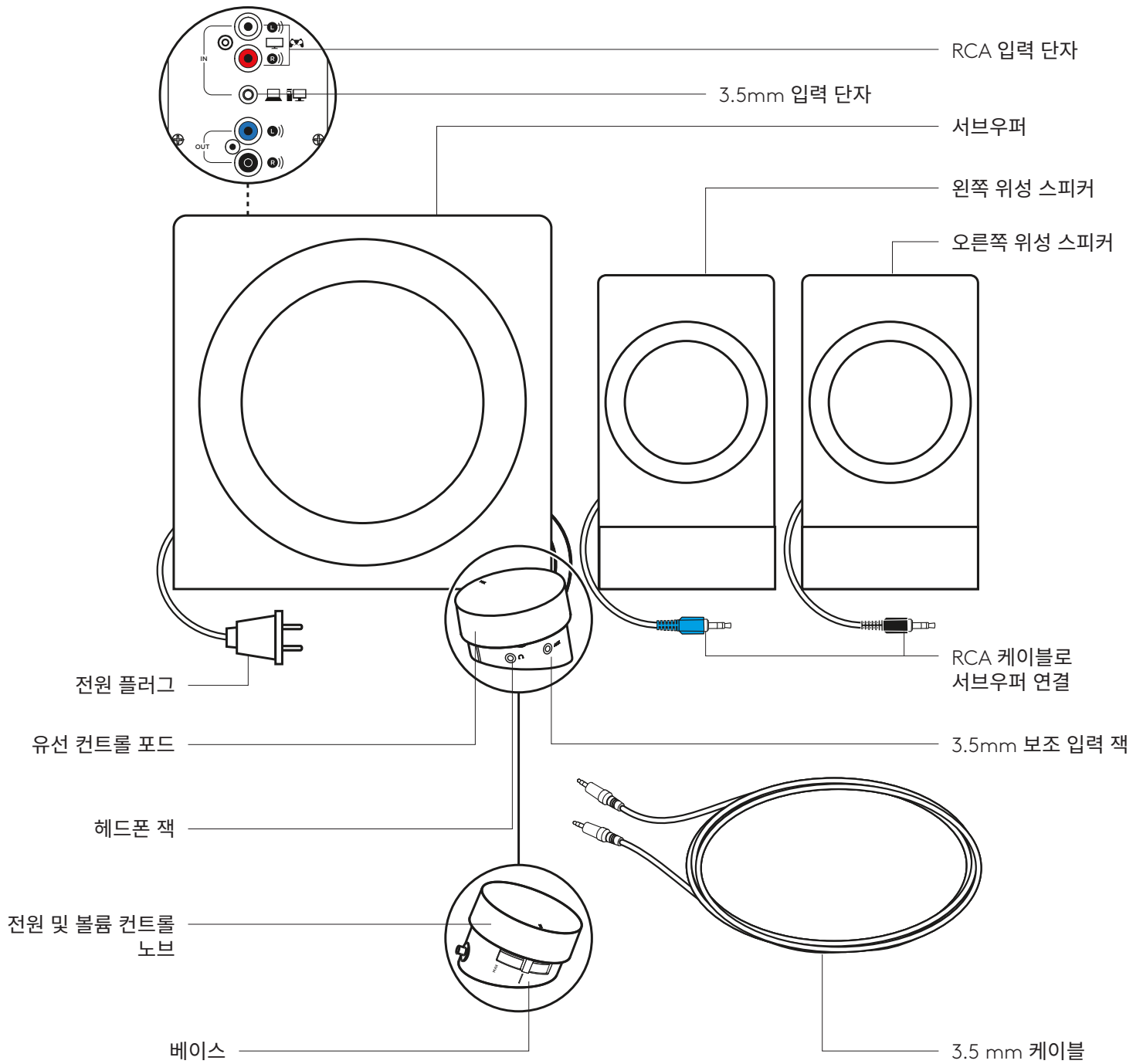

스피커 연결

1. 검은색 서브우퍼 잭에 우측 스피커의 검은색 RCA 커넥터를 연결합니다.
2. 파란색 서브우퍼 잭에 좌측 스피커의 파란색 RCA 커넥터를 연결합니다.
3. 전원 플러그를 전기 콘센트에 연결합니다.

1

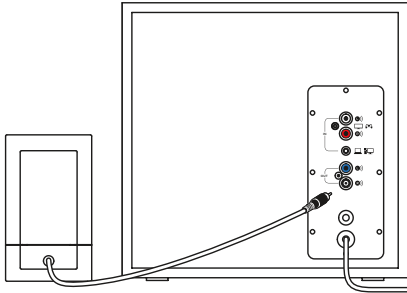

2

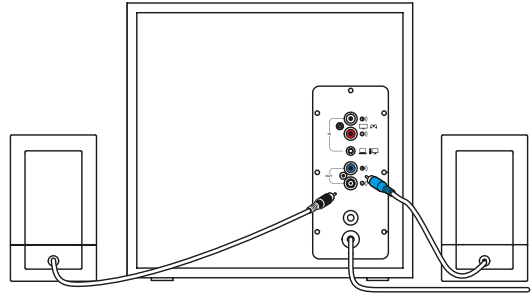

3

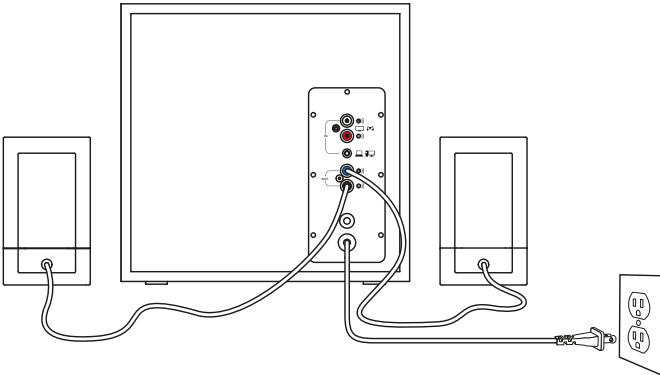

오디오 소스 연결

1A. 3.5mm 연결의 경우:

동봉된 3.5mm 케이블의 한쪽 끝을 서브우퍼 뒤쪽의 알맞은 잭에 연결하거나 3.5mm 잭을 컨트롤 포드에 연결합니다. 3.5mm 케이블의 다른 쪽 끝을 장치(컴퓨터, 스마트폰, 태블릿 등)의 오디오 잭에 연결합니다.

1B. RCA 연결의 경우:

RCA 케이블의 한쪽 끝을 서브우퍼 뒤쪽에 있는 해당 RCA 잭에 연결하십시오. RCA 케이블의 다른 쪽 끝을 장치의 RCA 콘센트에 연결하십시오(TV, 게임 콘솔 등).

참고: RCA 케이블은 박스에 포함되지 않으며 따로 구매하셔야 합니다.

2. 컨트롤 포드의 헤드폰 잭에 헤드폰을 연결합니다. 컨트롤 포드 또는 오디오 소스에서 볼륨을 조절하십시오.

3. 컨트롤 포드의 볼륨 노브를 시계 방향으로 돌려 스피커의 전원을 켜거나 끌 수 있습니다. 시스템이 켜지면 '찰칵'하는 소리가 납니다(유선 리모컨 전면의 LED도 켜집니다).

1A

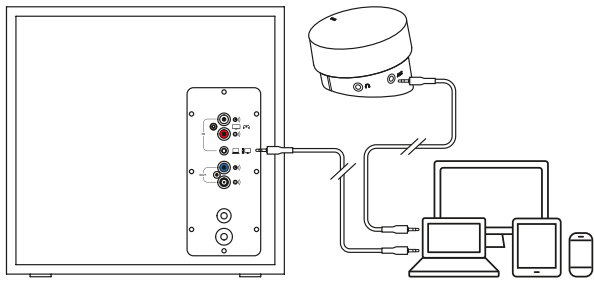

1B

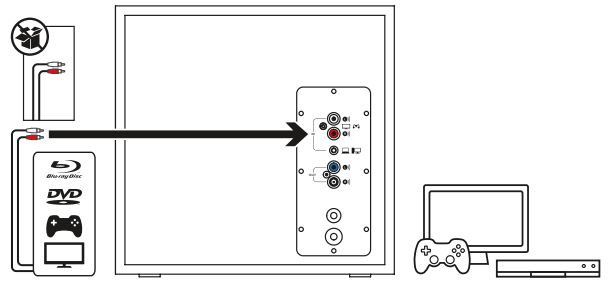

2

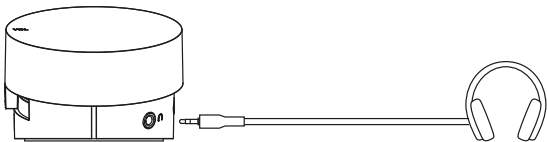

3

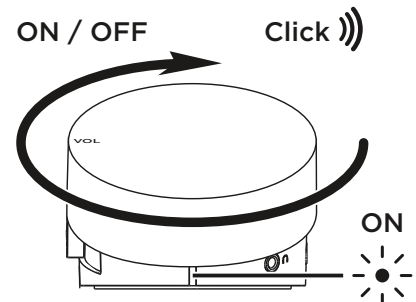

2개 장치에 동시 연결

1. 서브우퍼 뒷면에 있는 RCA 커넥터와 3.5mm 입력 단자를 연결하여 동시에 2개의 장치를 연결합니다.
2. 오디오 소스 사이를 전환하려면 연결된 장치 중 하나의 오디오를 일시 중지하고 연결된 다른 장치에서 오디오를 재생하십시오.

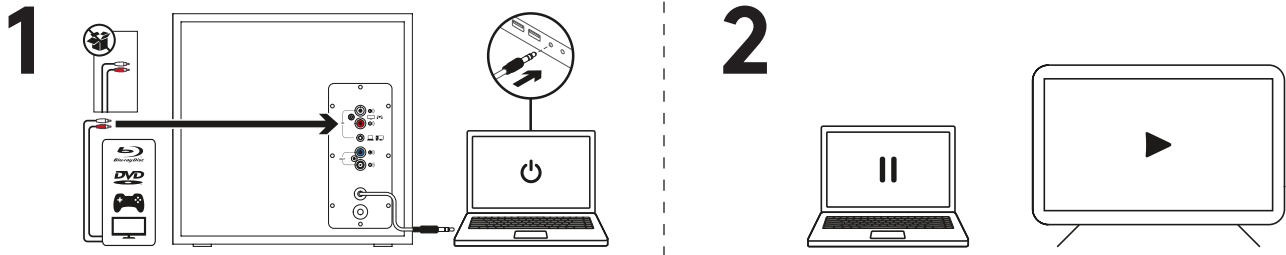

볼륨 조절

1. 컨트롤 포드의 노브를 사용하여 Z533의 볼륨을 조절하십시오. 볼륨을 높이려면 노브를 시계 방향(오른쪽)으로 돌리십시오. 볼륨을 줄이려면 노브를 시계 반대 방향(왼쪽)으로 돌리십시오.

베이스 조절

2. 컨트롤 포드의 측면에 있는 베이스 슬라이더를 이동하여 베이스 레벨을 조절합니다.

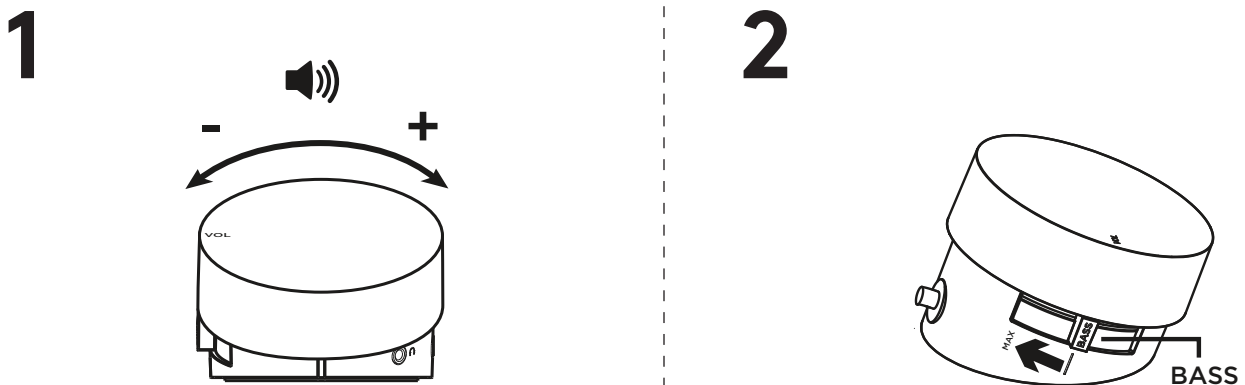

www.logitech.com/support/Z533

www.logitech.com/support/Z533